

27,854 SF
DISTRIBUTION
SPACE FOR
LEASE

CLASS A
OFFICE &
WAREHOUSE

END-CAP
SPACE

BELTWAY 8 &
HIGHWAY 225



TRANSWESTERN

REAL ESTATE
SERVICES

PORT 225 | BUILDING 6 - 27,854 SF

End-Cap Premises for Lease | 3009 Highway 225, Suite 170 - Houston, TX 77503



Building/Space Features:

- End-Cap premises
- 30' Clear height
- 4 Dock high loading doors
- 52' x 60' Column spacing
- Ramp access
- Strategic location on 225 and Beltway 8
- ESFR
- Close proximity to the Port of Houston
- 400 Amp electrical service
- 2 pit levelers
- Functional Office: 1,967 SF
- Warehouse: 25,887 SF
- Total: 27,854 SF

Leasing Information:

Brian Gammill
713.270.3321
brian.gammill@transwestern.com

Darryl Noon
713.270.3325
darryl.noon@transwestern.com

Jude Filippone
713.270.3318
jude.filippone@transwestern.com

The information provided herein was obtained from sources believed reliable; however, Transwestern makes no guarantees, warranties or representations as to the completeness of accuracy thereof. The presentation of this property is submitted subject to errors, omissions, change of price or conditions, prior to sale or lease, or withdrawal without notice. Copyright © 2022 Transwestern.

PROJECT OF

 CLARION PARTNERS

PORT 225 | BUILDING 6 - 27,854 SF

End-Cap Premises for Lease | 3009 Highway 225, Suite 170 - Houston, TX 77503

TRANSWESTERN

REAL ESTATE
SERVICES



Leasing Information:

Brian Gammill
713.270.3321
brian.gammill@transwestern.com

Darryl Noon
713.270.3325
darryl.noon@transwestern.com

Jude Filippone
713.270.3318
jude.filippone@transwestern.com

The information provided herein was obtained from sources believed reliable; however, Transwestern makes no guarantees, warranties or representations as to the completeness of accuracy thereof. The presentation of this property is submitted subject to errors, omissions, change of price or conditions, prior to sale or lease, or withdrawal without notice. Copyright © 2022 Transwestern.

PORT 225 | BUILDING 6 - 27,854 SF

End-Cap Premises for Lease | 3009 Highway 225, Suite 170 - Houston, TX 77503



REAL ESTATE
SERVICES

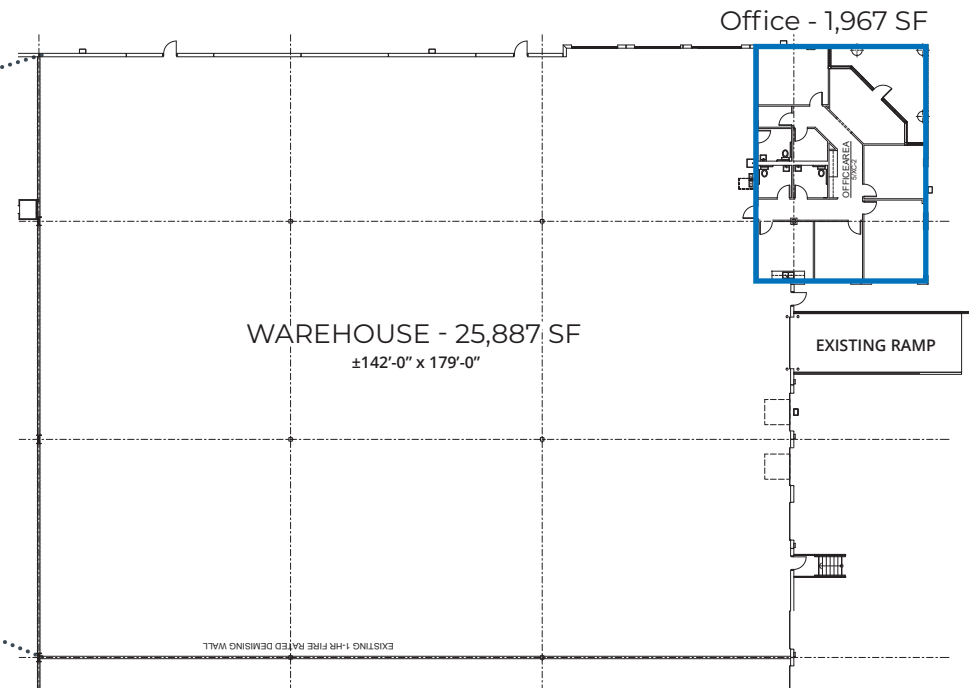
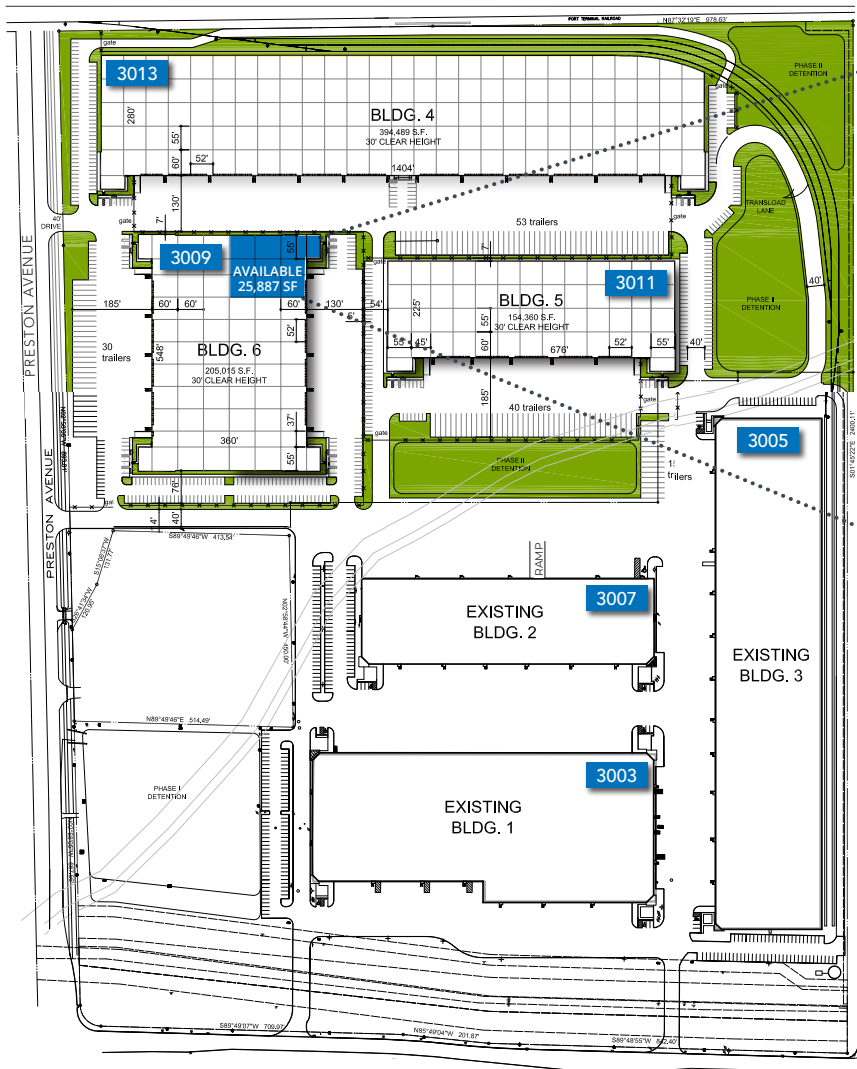

State Highway **225**

Building/Space Features:

- End-Cap premises
- 30' Clear height
- 4 Dock high loading doors
- 52' x 60' Column spacing
- Ramp access
- ESFR Sprinkler system
- 400 Amp electrical service
- 2 pit levelers

Leasing Information:

Brian Gammill
713.270.3321
brian.gammill@transwestern.com

Darryl Noon
713.270.3325
darryl.noon@transwestern.com

Jude Filippone
713.270.3318
jude.filippone@transwestern.com

The information provided herein was obtained from sources believed reliable; however, Transwestern makes no guarantees, warranties or representations as to the completeness of accuracy thereof. The presentation of this property is submitted subject to errors, omissions, change of price or conditions, prior to sale or lease, or withdrawal without notice. Copyright © 2022 Transwestern.