

OFFICE
LEASE

170,363 SF

CLASS A
OFFICE SPACE



TRANSWESTERN

REAL ESTATE
SERVICES

LONG LAKE CROSSING 1301

1441 LONG LAKE CROSSING | TROY, MI 48098

FLOOR PLAN

SUITE 310 | 5,998 SF

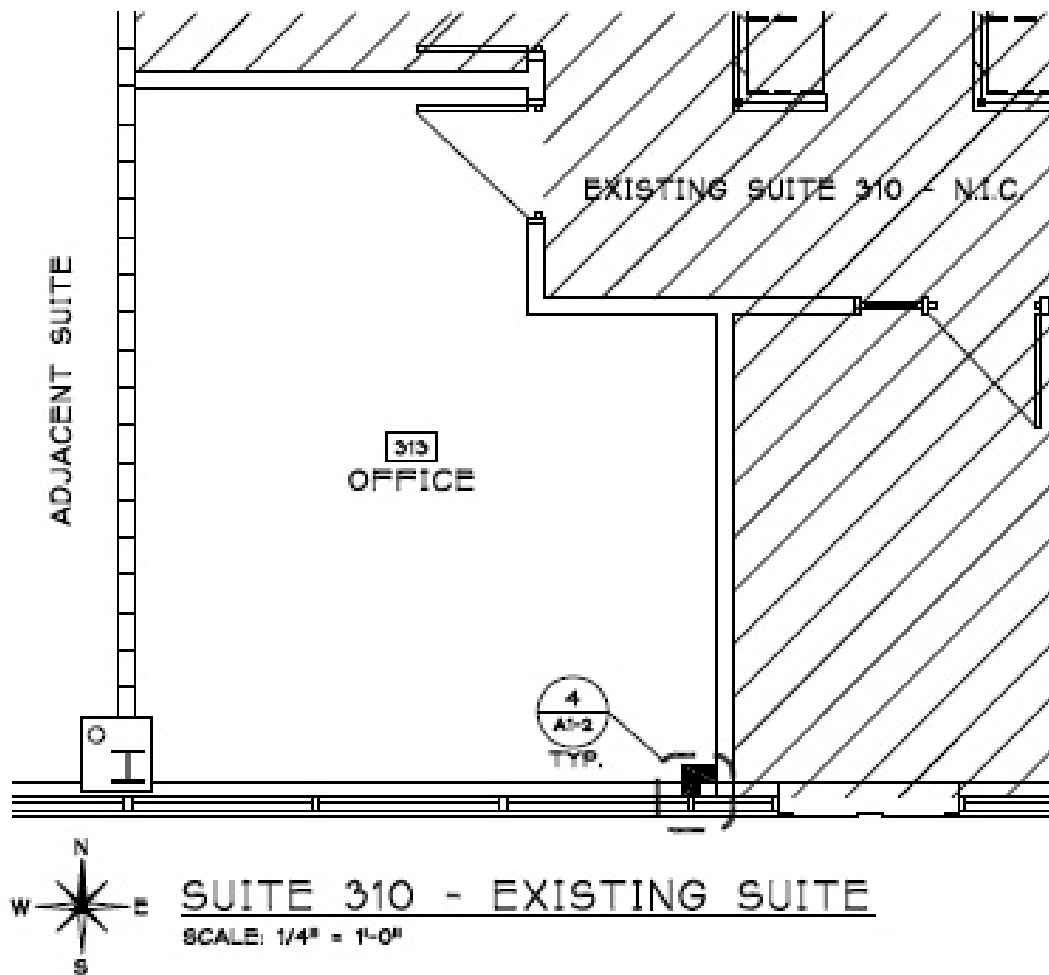

EXISTING SUITE IS EXISTING TO REMAIN. INSTALL NEW BUILDING STANDARD WALL CONSTRUCTED TO UNDERSIDE OF CEILING GRID AS INDICATED ABOVE IN OFFICE 313. PAINT NEW WALLS (P1) ONLY TO MATCH EXISTING.



TRANSWESTERN

REAL ESTATE
SERVICES

LEASING CONTACTS

William Harvey IV

248.797.9455

Bill.Harvey@Transwestern.com

Charles Howard

248.821.7722

Charles.Howard@Transwestern.com