

KEY PLAN

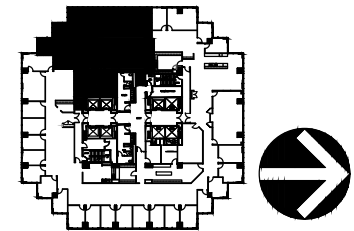

SUITE: 1020  
RSF: 4,290

TOWER  
909

KBS

KIM BROOKS  
972.361.1122  
kim.brooks@transwestern.com

JUSTIN MILLER  
972.361.1134  
justin.miller@transwestern.com

SCOTT WALKER  
972.774.2504  
scott.walker@transwestern.com

