



LG L21G

Guía del Usuario

ESPAÑOL



ENGLISH

User Guide

LG L21G

MFL00000000 (1.0)

# User Guide

ENGLISH

- Screen displays and illustrations may differ from those you see on actual phone.
- Some of the contents of this guide may not apply to your phone, depending on the software and your service provider. All information in this document is subject to change without notice.
- Due to the touch screen keyboard, this handset is not suitable for people who have a visual impairment.
- Copyright ©2015 LG Electronics, Inc. All rights reserved. LG and the LG logo are registered trademarks of LG Corp. and its related entities. All other trademarks are the property of their respective owners.
- Google™, Google Maps™, Gmail™, YouTube™, Hangouts™ and Google Play™ are trademarks of Google, Inc.

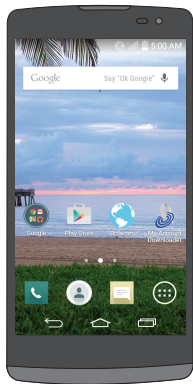

# Table of contents

|   |           |   |           |
|---|-----------|---|-----------|
| <b>Important notice .....</b>                   | <b>4</b>  | <b>Connecting to Networks and Devices 33</b>          |           |
| <b>Getting to know your phone.....</b>          | <b>9</b>  | Wi-Fi .....   | 33        |
| Phone overview .....                            | 9         | Bluetooth.....  | 34        |
| Installing the battery .....                    | 11        | Wi-Fi Direct .....                                    | 35        |
| Charging the phone .....                        | 13        | Transferring data between a PC and<br>the device..... | 35        |
| Using the memory card.....                      | 14        |   |           |
| Locking and unlocking the screen.....           | 14        | <b>Calls .....</b>                                    | <b>37</b> |
| <b>Your Home screen.....</b>                    | <b>16</b> | Making a call.....                                    | 37        |
| Touch screen tips .....                         | 16        | Calling your contacts .....                           | 37        |
| Home screen .....                               | 17        | Answering and rejecting a call .....                  | 37        |
| Returning to recently-used<br>applications..... | 19        | Adjusting the in-call volume.....                     | 38        |
| Notifications panel.....                        | 20        | Making a second call.....                             | 38        |
| On-screen keyboard .....                        | 24        | Viewing your call logs .....                          | 39        |
| <b>Special Feature .....</b>                    | <b>25</b> | Call settings.....                                    | 39        |
| Gesture shot.....                               | 25        | <b>Contacts .....</b>                                 | <b>40</b> |
| Knock Code .....                                | 25        | Searching for a contact.....                          | 40        |
| KnockON .....                                   | 26        | Adding a new contact .....                            | 40        |
| QuickMemo+.....                                 | 27        | Favorite contacts .....                               | 40        |
| QSlide.....                                     | 30        | Creating a group.....                                 | 41        |
| <b>Google account setup.....</b>                | <b>31</b> | <b>Messaging.....</b>                                 | <b>42</b> |
|   |           | Sending a message .....                               | 42        |
|   |           | View mode .....                                       | 43        |
|   |           | Changing your message settings .....                  | 44        |

|                                      |           |                                    |           |
|--------------------------------------|-----------|------------------------------------|-----------|
| <b>E-mail.....</b>                   | <b>45</b> | <b>The Web .....</b>               | <b>62</b> |
| Managing an email account.....       | 45        | Browser.....                       | 62        |
| Working with account folders.....    | 45        | Chrome .....                       | 64        |
| Composing and sending email .....    | 46        | <b>Settings.....</b>               | <b>65</b> |
| <b>Camera and Video.....</b>         | <b>47</b> | WIRELESS & NETWORKS .....          | 65        |
| Getting to know the viewfinder ..... | 47        | DEVICE .....                       | 67        |
| Using the advanced settings .....    | 48        | PERSONAL.....                      | 73        |
| Taking a quick photo .....           | 49        | SYSTEM.....                        | 77        |
| Once you've taken a photo.....       | 49        | <b>Phone software update .....</b> | <b>83</b> |
| Recording a quick video.....         | 50        | <b>About this user guide .....</b> | <b>85</b> |
| After recording a video.....         | 51        | About this user guide.....         | 85        |
| From your Gallery .....              | 51        | Trademarks .....                   | 86        |
| Gallery.....                         | 52        | <b>FAQ .....</b>                   | <b>87</b> |
| <b>Multimedia .....</b>              | <b>55</b> | <b>For your safety .....</b>       | <b>96</b> |
| Music .....                          | 55        |                                    |           |
| <b>Utilities .....</b>               | <b>58</b> |                                    |           |
| Clock.....                           | 58        |                                    |           |
| Calculator .....                     | 59        |                                    |           |
| Calendar.....                        | 59        |                                    |           |
| Voice Recorder .....                 | 60        |                                    |           |
| Tasks.....                           | 60        |                                    |           |
| Voice Search.....                    | 61        |                                    |           |
| Downloads .....                      | 61        |                                    |           |



## Important notice



### Please read this before you start using your phone!

Please check to see whether any problems you encountered with your phone are described in this section before taking the phone in for service or calling a service representative.

## 1. Phone memory

When there is less than 10MB of space available in your phone memory, your phone cannot receive new messages. You need to check your phone memory and delete some data, such as applications or messages, to make more memory available.

### To uninstall applications:

- 1 From the Home screen, tap  > **Apps** tab (if necessary) > **Settings**  > **Apps**.
- 2 Once all applications appear, scroll to and select the application you want to uninstall.
- 3 Tap **Uninstall**, then tap **OK** to confirm.

## 2. Optimizing battery life



Extend your battery's life between charges by turning off features that you don't need to have running constantly in the background. You can monitor how applications and system resources consume battery power.

### Extending your phone's battery life:

- Turn off radio communications that you're not using. If you are not using Wi-Fi, Bluetooth or GPS, turn them off.



- Reduce screen brightness and set a shorter screen timeout.
- Turn off automatic syncing for Gmail, Calendar, Contacts and other applications.
- Some applications you have downloaded may reduce battery power.

### **To check the battery power level:**

- From the Home screen, tap  > **Apps** tab (if necessary) > **Settings**  > **About phone** > **Battery**.

The battery status (charging or discharging) and battery level (percentage charged) is displayed at the top of the screen.

### **To monitor and control how battery power is being used:**

- From the Home screen, tap  > **Apps** tab (if necessary) > **Settings**  > **About phone** > **Battery** > **Battery use**.

Battery usage time is displayed on the screen. It tells you how long it has been since you last connected your phone to a power source or, if currently connected, how long the phone was last running on battery power. The screen shows the applications or services using battery power, listed in order from the greatest to smallest amount used.

## Important notice

### 3. Before installing an open source application and operating system (OS)



#### WARNING

If you install and use an OS other than the one provided by the manufacturer it may cause your phone to malfunction. In addition, your phone will no longer be covered by the warranty.

#### WARNING

To protect your phone and personal data, only download applications from trusted sources, such as Play Store. If there are improperly installed applications on your phone, the phone may not work normally or a serious error may occur. You must uninstall those applications and all associated data and settings from the phone.

### 4. Using a screen lock

Set a screen lock to secure your phone and prevent unauthorized use. From the Home screen, tap  > **Apps** tab (if necessary) > **Settings**  > **Lock screen** > **Select screen lock** > **Knock Code, Pattern, PIN, or Password**. You might be prompted to create a Backup PIN as a safety measure in case you forget your screen lock.

**Caution:** Create a Google account before setting a screen lock and remember the Backup PIN you created when creating your screen lock.

## WARNING



### Precautions to take when using a pattern lock.

It is very important to remember the screen lock you set. You will not be able to access your phone if you use an incorrect screen lock 5 times. If you have used all 5 opportunities, you can try again after 30 seconds.

## 5. Opening and switching applications

Multi-tasking is easy with Android because you can keep more than one application running at the same time. There is no need to quit an application before opening another one. Use and switch between several open applications. Android manages each application, stopping and starting them as needed to ensure that idle applications don't consume resources unnecessarily.

### To stop applications:

- 1 From the Home screen, tap  > **Apps** tab (if necessary) > **Settings**  > **Apps** > **RUNNING**.
- 2 Tap the desired application and tap **Stop** to stop it.

## Important notice

### 6. Transferring music, photos and videos using Media sync (MTP)

- 1 Connect the phone to your PC using the USB cable provided with your phone.
- 2 A USB connection type list will appear on your phone screen. Tap the **Media sync (MTP)** option.
- 3 Select the **Open device to view files** option on your PC. You can then view media contents on your PC and transfer the files.
- 4 Copy the files from your PC to the drive folder or vice versa.
- 5 Drag the Status Bar down and tap **USB connected > Charge phone**.
- 6 Disconnect the USB cable from your phone.

### 7. Hold your phone upright

Hold your cell phone vertically, as you would a regular phone. Your phone has an internal antenna. Be careful not to scratch or damage the back of the phone, as this may affect performance.

When making/receiving calls or sending/receiving data, avoid holding the lower part of the phone where the antenna is located. Doing so may affect call quality.

### 8. When the screen freezes

**If the phone does not respond to user input or the screen freezes:**

To turn the phone on, Remove the battery > Reinsert it > Press and hold the **Power/Lock Key**.

# Getting to know your phone

## Phone overview

**Earpiece**

**Proximity Sensor**

**Home Key**

Return to the Home screen from any screen.

**Back Key**

Return to the previous screen.

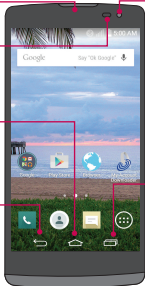

**Front Camera Lens**

Use to take a picture of yourself or to video chat on supported applications.

**Recent Apps Key**

Displays recently used applications. If you touch and hold this key, it opens available options menu.

### **NOTE: Proximity sensor**

When receiving and making calls, the proximity sensor automatically turns the backlight off and locks the touch screen by sensing when the phone is near your ear. This extends battery life and prevents you from unintentionally activating the touch screen during calls.



### **WARNING**

Placing a heavy object on the phone or sitting on it can damage the LCD and touch screen functions. Do not cover the LCD proximity sensor with protective film. This could cause the sensor to malfunction.

# Getting to know your phone

## Volume Keys

- **On the Home screen:** Control ringer volume.
- **During a call:** Control your earpiece volume.
- **When playing audio/video:** Control volume continuously.

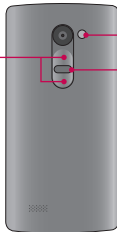

## Flash LED

## Power/Lock Key

Turn your phone on/off, restart, lock/unlock the screen, turn airplane mode on or off, and change the ringer type.

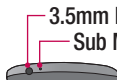

## 3.5mm Headset Jack

## Sub Microphone: Speakerphone



## Charger/USB Port

## Main Microphone: Call, Recording

**NOTE:** Please be careful not to block the main microphone with your hand when you call.

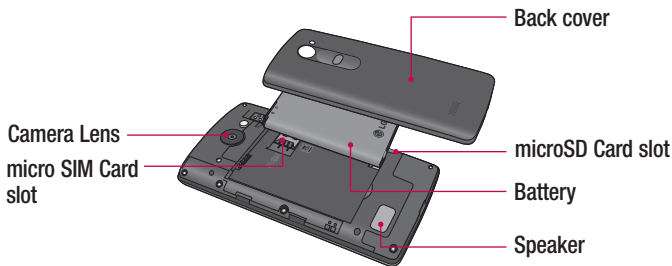

## Installing the battery

Before you can start exploring your new phone, you'll need to set it up.

- 1 To remove the back cover, hold the phone firmly in one hand. With your other hand, lift off the back cover with your thumbnail as shown in figure below.





## Getting to know your phone

- 2** Insert the battery into place by aligning the gold contacts on the phone and the battery (1) and pressing it down until it clicks into place (2).

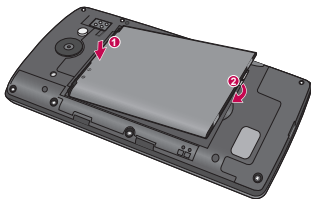

- 3** Align the back cover over the battery compartment (1) and press it down until it clicks into place (2).



## Charging the phone

The Charger/USB Port is at the bottom of the phone. Insert one end of the USB cable into the phone and plug the other end into an electrical outlet.

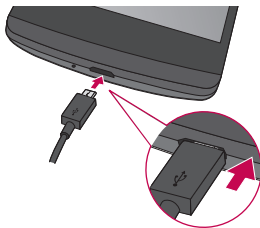

### NOTE:

- The battery must be fully charged initially to improve battery lifetime.
- Do not open the back cover while your phone is charging.

# Getting to know your phone

## Using the memory card

Make sure to unmount the SD card in the Storage menu before removing it.

- 1 Remove the back cover.
- 2 Insert the memory card into the slot. Make sure the gold contact area is facing downwards.

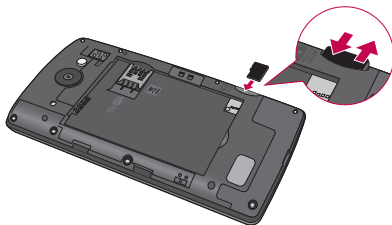

## Locking and unlocking the screen

If you do not use the phone for a while, the screen will be automatically turned off and locked. This helps to prevent accidental taps and saves battery power.

When you are not using your phone, press the **Power/Lock Key** to lock your phone. And you can also lock the phone by double-tapping the Status Bar or an empty area on the Home or Lock screen.

If there are any programs running when you lock your screen, they may be still running in Lock mode. It is recommended that you exit all programs before entering Lock mode to avoid unnecessary charges (e.g. phone calls, web access and data communications).

To wake up your phone, press the **Power/Lock Key** or double-tap the center of the screen. The Lock screen will appear. Touch and slide the Lock screen in any direction to unlock the screen. The last screen you viewed will open.

# Your Home screen

## Touch screen tips

Here are some tips on how to navigate on your phone.

**Touch or tap** – A single finger tap selects items, links, shortcuts and letters on the on-screen keyboard.

**Touch and hold** – Touch and hold an item on the screen by touching it and not lifting your finger until an action occurs.

**Drag** – Touch and hold an item for a moment and then, without lifting your finger, move your finger on the screen until you reach the target position. You can drag items on the Home screen to reposition them.

**Swipe or slide** – To swipe or slide, quickly move your finger across the surface of the screen, without pausing when you first touch it (so you don't drag an item instead).

**Double-tap** – Double-tap to zoom on a webpage or a map.

**Pinch-to-Zoom** – Use your index finger and thumb in a pinching or spreading motion to zoom in or out when using the browser, Maps or when viewing pictures.

**Rotate the screen** – From many applications and menus, the orientation of the screen adjusts to the device's physical orientation.

### NOTE:

- To select an item, tap the center of the icon.
- Do not press too hard; the touch screen is sensitive enough to pick up a light, yet firm tap.
- Use the tip of your finger to tap the option you want. Be careful not to tap any other keys.

## Home screen

The Home screen is the starting point for many applications and functions, and it allows you to add items like application shortcuts, or Google widgets to give you instant access to information and applications. This is the default canvas and accessible from any menu by tapping .



- 1 Shows phone's status information including the time, signal strength, battery status, and notification icons.
- 2 Widgets are self-contained applications that can be accessed through the Apps screen or on the Home screen or an extended home screen. Unlike a shortcut, the Widget appears as an on-screen application.
- 3 Tap an icon (application, folder, etc.) to open and use it.

## Your Home screen

- 4 Indicates which Home screen canvas you are viewing.
- 5 Provides one-touch access to the function in any home screen canvas.

### Extended home screen

The operating system provides multiple Home screen canvases to provide more space for adding icons, widgets, and more.

- Slide your finger left or right across the Home screen.

### Customizing the Home screen

You can customize your Home screen by adding apps, widgets or changing wallpapers.

#### Adding items on your Home screen

- 1 Touch and hold the empty part of the Home screen.
- 2 In the Add Mode menu, select the item you wish to add. You will then see this added item on the Home screen.
- 3 Drag it to the desired location and lift your finger.

**TIP!** To add an application icon to the Home screen from the Apps menu, touch and hold the application you want to add.

#### Removing an item from the Home screen

- **Home screen** > touch and hold the icon you want to remove > drag it to .

#### Adding an app as a Quick key

- From the Apps menu or on the Home screen, touch and hold an application icon and drag it to the Quick key area. Up to 7 apps can be added.

## Removing an app from the Quick key area

- ▶ Touch and hold the desired quick key and drag it to .

**NOTE:**  **Apps** key cannot be removed.

## Customizing apps icons on the Home screen

- 1 Touch and hold an application icon until it is unlocked from its current position. Then drop it on the screen. The editing icon  will appear in the upper right corner of the application.
- 2 Tap the application icon again and select the desired icon design and size.
- 3 Tap **OK** to save the change.

## Returning to recently-used applications

- 1 Tap . A list of recently used applications will be displayed.
- 2 Tap an icon to open the application. Or tap  to return to your previous screen.



# Your Home screen

## Notifications panel

Notifications alert you the arrival of new messages, calendar events, and alarms, as well as to ongoing events, such as when you are on a call.

When a notification arrives, its icon appears at the top of the screen. Icons for pending notifications appear on the left, and system icons such as Wi-Fi or battery strength shown on the right.

**NOTE:** The available options may vary depending on the region or service provider.

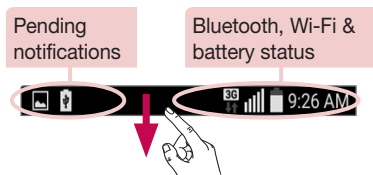

## Opening the notifications panel

Swipe down from the status bar to open the notifications panel. To close the notifications panel, touch and drag the screen toward the top of the screen.

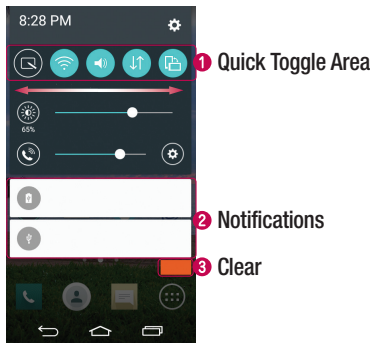

- 1 Tap each quick toggle key to turn it on/off. Touch and hold the key to access the settings menu of the function. To see more toggle keys, swipe left or right. Tap  to remove, add, or rearrange toggle keys.
- 2 The current notifications are listed, each with a brief description. Tap a notification to view it.
- 3 Tap to clear all the notifications.

# Your Home screen

## Indicator icons on the Status Bar

Notification icons appear on the Status Bar at the top of the screen to report missed calls, new messages, calendar events, device status and more.





The icons displayed at the top of the screen provide information about the status of the device. The icons listed in the table below are some of the most common ones.

| Icon | Description                      |
|------|----------------------------------|
|      | No signal                        |
|      | Airplane mode                    |
|      | Connected to a Wi-Fi network     |
|      | Wired headset                    |
|      | Call in progress                 |
|      | Receiving location data from GPS |
|      | Data is syncing                  |
|      | New Gmail message                |

| Icon | Description         |
|------|---------------------|
|      | Battery is charging |
|      | Downloading data    |
|      | Uploading data      |
|      | Acquiring GPS       |
|      | Missed call         |
|      | Bluetooth is on     |
|      | System warning      |
|      | An alarm is set     |

| Icon   | Description                            |
|--|--|
|  | New Hangouts message                   |
|  | New text or multimedia message         |
|  | Song is playing                        |
|  | Phone is connected to PC via USB cable |

| Icon  | Description         |
|---|---------------------|
|  | New voicemail       |
|  | Do not disturb      |
|  | Battery saver is on |





**NOTE:** The icons location in the status bar may differ according to the function or service.

## Your Home screen

### On-screen keyboard

You can enter text using the on-screen keyboard. The on-screen keyboard appears automatically on the screen when you need to enter text. To manually display the keyboard, simply tap a text field where you want to enter text.

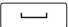
#### Using the keypad & entering text

-  Tap once to capitalize the next letter you type. Double-tap for all caps.
-  Tap to switch to the numbers and symbols keyboard.
-  Tap to access the keyboard settings. Tap and hold to access the clip tray or enter text by voice and handwriting.
-  Tap to enter a space.
-  Tap to create a new line in the message field.
-  Tap to delete the previous character.

#### Entering special characters

The LG Keyboard allows you to enter special characters (e.g. “á”) when entering text. For example, to enter “á”, touch and hold the “a” key. When the pop-up with its additional characters is displayed, slide your finger over the “á”, then lift your finger to enter it.

**NOTE:** A symbol at the top right corner of a key indicates that additional characters are available for that key.

## Special Feature

### Gesture shot

Take a picture with hand gesture. To take photo, raise your hand until front camera detects it and a box appears on the screen.

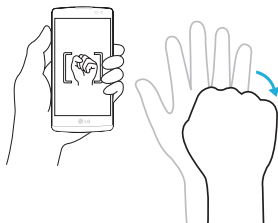
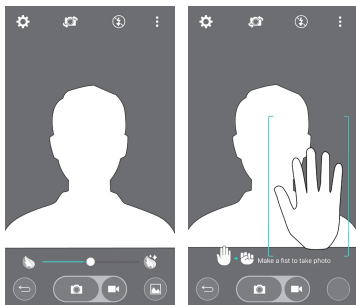

### Knock Code

You can unlock the screen when it is off by tapping the correct area and sequence.

#### To activate the Knock Code feature

- 1 From the Home screen, tap  > **Apps tab** > **Settings** > **Lock screen** > **Select screen lock** > **Knock Code**.
- 2 This opens a screen that will guide you through how to select the unlock sequence. You have to create a Backup PIN as a safety measure in case you forget your unlock sequence.

## Special Feature

**TIP!** The KnockON feature is not available when Knock Code is in use.

### KnockON

You can turn on/off the screen by just double-tap.

Double-tap the center of the screen quickly while it's off to turn it on. To turn the screen off, double-tap the Status Bar in any screen (except on the camera viewfinder) or an empty area on the Home screen.

**NOTE:** When turning the screen on, make sure you do not cover the proximity sensor. Doing so will turn the screen off immediately after turning it on in order to prevent abnormal turning on in your pocket or bag.

## QuickMemo+

The **QuickMemo+** allows you to create memos and capture screen shots. Capture screens, draw on them and share them with family and friends with QuickMemo+.

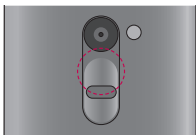

OR

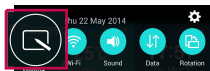

- 1 (While screen is switched off) Press and hold the Volume Up key.

OR

Touch and slide the status bar downward and tap .



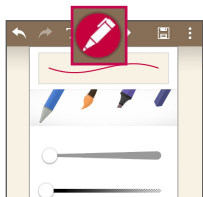

## Special Feature

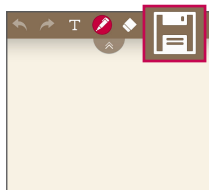

- 2 Select the desired menu option from **Pen type**, **Colour**, **Eraser** and create a memo.









- 3 Tap  in the Edit menu to save the memo with the current screen. To exit QuickMemo+ at any time, tap .

**NOTE:** Please use a fingertip while using the QuickMemo+. Do not use your fingernail.

## Using the QuickMemo+ options

You can easily use the editing tools when using the QuickMemo+.

|  |  |
|--|--|
|  | Undo or Redo.  |
|  | Use complex concept function.  |
|  | Select the pen type and the colour.  |
|  | Erase the memo that you created.   |
|  | Save the memo with the current screen in the <b>Gallery</b> or <b>QuickMemo+</b> . |
|  | <b>Option:</b> Tap to choose <b>Share</b> , <b>Paper style</b> for the memo.       |

## Viewing the saved QuickMemo+

From the Home screen, tap  > **QuickMemo+**.

Or tap **Gallery** and select the **Quickmemo+** album.

# Special Feature

## QSlide

From any screen, bring up a notepad, calendar, and more as a window inside your screen.

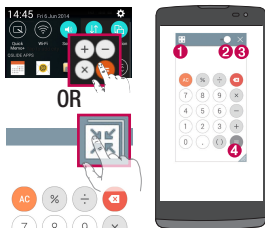

|   |  |   |
|---|--|---|
| 1 |  | Tap to exit the QSlide and return to full window. |
| 2 |  | Tap to adjust transparency.                       |
| 3 |  | Tap to end the QSlide.                            |
| 4 |  | Tap to adjust the size.                           |



- 1 Touch and slide the status bar downwards > tap QSLIDE APPS or while using applications that support QSlide, tap . The function will be continuously displayed as a small window on your screen.
- 2 You can make a call, browse the Web, or choose other phone options. You can also use and tap the screen under the small windows when the transparency bar is not full

**NOTE:** The QSlide can support up to two windows at the same time.

# Google account setup

The first time you open a Google application on your phone, you will be required to sign in with your existing Google account. If you do not have a Google account, you will be prompted to create one.

## Creating your Google account

- 1 From the Home screen, tap  to open the applications screen.
- 2 Tap **Settings**  > **Accounts & sync** > **Add account** > **Google** > **New** to start the Gmail set up wizard.
- 3 Tap a text field to open the keyboard and enter your name and username for your Google account. When entering text, you can move to the next text field by tapping **Next** on the keyboard.
- 4 When you have finished entering your name and username. Your phone then communicates with Google servers and checks for username availability.
- 5 Enter and re-enter your password. Then follow the instructions and enter the required and optional information about the account. Wait while the server creates your account.

## Google account setup

### Signing in to your Google account

- 1 On the Google Accounts & sync screen, enter your e-mail address and password.
- 2 After signing in, you can use Gmail and take advantage of Google services.
- 3 Once you have set up your Google account on your phone, it will be automatically synchronized with your Google account on the web (depending on your synchronization settings).



After signing in, you can use Gmail, and Play Store; back up your settings to Google servers; and take advantage of other Google services on your phone.

# Connecting to Networks and Devices

## Wi-Fi

You can use high-speed Internet access within the coverage of the wireless access point (AP).

### Connecting to Wi-Fi networks

- 1 Tap  >  > **Apps** tab >  > **Networks** > **Wi-Fi**.
- 2 Set **Wi-Fi** to **ON** to turn it on and start scanning for available Wi-Fi networks.
- 3 Tap a network to connect to it.
  - If the network is secured with a lock icon, you need to enter a password.
- 4 The status bar displays icons that indicate Wi-Fi status.

**NOTE:** If you are out of the Wi-Fi zone or have set Wi-Fi to **OFF**, additional charges may be applied by your mobile operator for mobile data use.

### TIP! How to obtain the MAC address

Tap  >  > **Apps** tab >  > **Networks** > **Wi-Fi** >  > **Advanced Wi-Fi** > **MAC address**.

# Connecting to Networks and Devices



## Bluetooth

You can use Bluetooth to exchange data between near devices.

### NOTE:

- LG is not responsible for the loss, interception or misuse of data sent or received via the Bluetooth feature.
- Always ensure that you share and receive data with devices that are trusted and properly secured. If there are obstacles between the devices, the operating distance may be reduced.
- Some devices, especially those that are not tested or approved by Bluetooth SIG, may be incompatible with your device.

### Pairing up your phone with another Bluetooth device

- 1 Tap  >  > **Apps** tab >  > **Networks** > **Bluetooth**.
- 2 Set **Bluetooth** to **ON** to turn it.
- 3 Tap **Search for devices** to view the devices in the Bluetooth Range.
- 4 Choose the device you want to pair with from the list. Once the pairing is successful, your device will connect to the other device.

**NOTE:** Some devices, especially headsets or hands-free car kits, may have a fixed Bluetooth PIN, such as 0000. If the other device has a PIN, you will be asked to enter it.



### Sending data via Bluetooth

- 1 Select a file or item such as a contact or media file.
- 2 Select the option for sending data via Bluetooth.

**NOTE:** The method for selecting an option may vary by data type.

3 Search for and pair with a Bluetooth-enabled device.

### Receiving data via Bluetooth

1 Tap  >  > **Apps** tab >  > **Networks** > **Bluetooth**.

2 Set **Bluetooth** to **ON** to turn it.

## Wi-Fi Direct

Wi-Fi Direct supports a direct connection between Wi-Fi enabled devices without an access point.

### Turning on Wi-Fi Direct:

1 Tap  >  > **Apps** tab >  > **Networks** > **Wi-Fi**.

2 Tap  > **Advanced Wi-Fi** > **Wi-Fi Direct**.

3 Select a device to connect with from the scanned device list.

## Transferring data between a PC and the device

You can copy or move data between a PC and the device.

### Transferring data

1 Connect your device to a PC using a USB cable.

2 Slide down the notifications panel, and select the **Media sync (MTP)**.

3 Transfer data between a PC and the device.



# Connecting to Networks and Devices





## NOTE:

- LG Android Platform Driver on your PC.
- Check the requirement to use **Media device (MTP)**.

| Items                       | Requirement                               |
|-----------------------------|---|
| OS                          | Microsoft Windows XP SP2, Vista or higher |
| Window Media Player version | Windows Media Player 10 or higher         |



# Calls

## Making a call

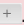

- 1 From the Home screen, tap  to open the dial pad.
- 2 Enter the number using the dial pad. To delete a digit, tap .
- 3 Tap  to make a call.
- 4 To end a call, tap .

**TIP!** To enter “+” to make international calls, touch and hold  .

## Calling your contacts

- 1 From the Home screen, tap  to open your contact list.
- 2 Scroll through the contact list or tap the **Search contacts** box and enter the contacts name. You can also scroll the alphabet bar along the right side of the screen.
- 3 In the list, tap  next to the desired contact to make the call.

## Answering and rejecting a call

- Swipe  in any direction to answer the incoming call.
- Swipe  in any direction to decline an incoming call.

**NOTE:** If you are using an app while you receive a call, the incoming call pop-up will be displayed. To enable or disable this feature, go to **System settings > Call** and tap the **Incoming voice call pop-up** checkbox.

# Calls





## TIP! Decline with message

You can send a message quickly using this function. This is useful if you need to reject a call with message during a meeting.

## Adjusting the in-call volume

To adjust the in-call volume during a call, use the Volume Up and Volume Down Keys on the left-hand side of the phone.

## Making a second call

- 1 During your first call, tap , touch **Add call** and dial the number. You can also go to the recently dialed numbers list by tapping **Call logs** or search contacts by tapping **Contacts** and selecting the contact you want to call.
- 2 Tap  to make the call.
- 3 Your initial call is placed on hold.
- 4 Tap  if you want to start a conference call.
- 5 To end active calls, tap .

**NOTE:** You may be charged for each call you make.

**TIP!** Tap **Manage members** to end or remove individual calls from the conference call.

## Viewing your call logs



From the Home screen, tap  and choose the **Call logs** tab. A complete list of all dialed, received and missed calls is displayed.

### TIP!

- Tap any call log entry to view the date, time and duration of the call.
- Tap , then tap **Delete all** to delete all the recorded items or tap **Delete** to delete individual items.

## Call settings

You can configure phone call settings such as call forwarding, as well as other special features offered by your carrier.

- 1 From the Home screen, tap .
- 2 Tap .
- 3 Tap **Call settings** and choose the options that you wish to adjust.



# Contacts

Add contacts to your phone and synchronize them with the contacts in your Google account or other accounts that support contact syncing.

## Searching for a contact

- 1 From the Home screen, tap  to open your contact list.
- 2 Tap the **Search contacts** box and enter the contacts name. You can also scroll the alphabet bar along the right side of the screen.

## Adding a new contact

- 1 From the Home screen, tap  and enter the new contact's number then tap New contact.
- 2 If you want to add a picture to the new contact, tap . Choose from **Take photo** or **Select from Gallery**.
- 3 Tap  at the top of the screen and select the account you want to save the contact to.
- 4 Tap a category of contact information and enter the details about your contact.
- 5 Tap **Save**.

## Favorite contacts

You can classify frequently called contacts as favorites.

### Adding a contact to your favorites



- 1 From the Home screen, tap  to open your contact list.
- 2 Tap a contact to view its details.

- 3 Tap the star to the right of the contact's name. The star will turn yellow color.

### Removing a contact from your favorites list

- 1 From the Home screen, tap  to open your contact list.
- 2 Tap the **Contacts** tab and choose a contact to view its details.
- 3 Tap the yellow color star to the right of the contact's name. The star turns grey color and the contact is removed from your favorites.

## Creating a group



- 1 From the Home screen, tap  to open your contact list.
- 2 Tap the **Groups** tab, then tap  > **New group**.
- 3 Enter a name for the new group. You can also set a ringtone and the account you want to save the newly created group to.
- 4 Tap **Save** to save the group.

**NOTE:** If you delete a group, the contacts assigned to that group will not be lost. They will remain in your contacts.

# Messaging

Your phone combines text and multimedia messages into one intuitive, easy-to-use menu.

## Sending a message

- 1 Tap  on the Home screen and tap  to compose a new message.
- 2 Enter a contact name or contact number in the **To** field. As you enter the contact name, matching contacts will appear. You can tap a suggested recipient. You can add more than one contact.

**NOTE:** You may be charged for a text message for every person you send the message to.

- 3 Tap the text field and begin composing your message.
- 4 Tap  to access the messaging options.

**TIP!** You can tap the  icon to attach a file you want to share.

**NOTE:** All functions of the Messaging app will be limited if the LG Messaging app is not set as the default SMS app. To set the default SMS app, from the Home screen, tap  > **System settings** > **Default SMS app** and choose **Messaging**.

- 5 Tap **Send** (or **Send MMS**) to send your message.

**NOTE:** Additional charges may apply when multimedia messages are downloaded while roaming.

### **WARNING**

- The 160-character limit may vary from country to country, depending on the language and how the text message is coded.
- If an image, video or audio file is added to a text message, it is automatically converted into a multimedia message and you may be charged accordingly.

## Using smilies

Liven up your messages using smilies and emojis.

When writing a new message, tap  > **Insert smiley**. To access emojis, tap  on the LG keyboard and choose an emoji category to view the available emojis.

## Changing the conversation theme

Sets how your conversations are displayed.

- 1 Open the Messaging app and tap  > **Settings > Conversation theme**.
- 2 Tap the **Wallpaper** tab to choose the conversation background. Choose from the 6 options provided, a photo from your Gallery, or take a picture to use.
- 3 Tap the **Bubble** tab to choose the conversation style. Choose from the 6 options provided.

## View mode

Unread messages are located at the top. Other messages exchanged with another party are displayed in threads and in chronological order so that you can conveniently see an overview of your conversation.



# Messaging

## Changing your message settings

Your phone message settings are pre-defined, so you can send messages immediately. You can change the settings according to your preferences.

- Open the **Messaging** app and tap  > **Settings**.

# E-mail



You can use the E-mail application to read emails from services like Gmail. The E-mail application supports the following account types: POP3, IMAP and Exchange. Your service provider or system administrator can provide you with the account settings you need.

## Managing an email account



The first time you open the **E-mail** application, a set-up wizard opens to help you to set up an email account.

After the initial set-up, E-mail displays the contents of your inbox.

### Adding another email account:

- Tap  >  > **Apps** tab > **E-mail** > tap  > **Settings** >  **Add account**.

### Changing an email account's settings:

- Tap  >  > **Apps** tab > **E-mail** > tap  > **Settings** > **General settings**.

### Deleting an email account:

- Tap  >  > **Apps** tab > **E-mail** > tap  > **Settings** > tap  > **Remove account** > Select the account to delete > **Remove** > select **Yes**.

## Working with account folders





Tap  >  > **Apps** tab > **E-mail** > tap  and select **Folders**.

Each account has an Inbox, Outbox, Sent and Drafts folder. Depending on the features supported by your account's service provider, you may have additional folders.

## E-mail

### Composing and sending email

#### Composing and send a message

- 1 While in the **E-mail** application, tap the .
- 2 Enter an address for the message's intended recipient. As you enter text, matching addresses will be proposed from your Contacts. Separate multiple addresses using semicolons.
- 3 Tap the  to add a Cc/Bcc and tap  to attach files, if required.
- 4 Enter the text of the message.
- 5 Tap .



**TIP!** When a new email arrives in your Inbox, you will be notified by a sound or vibration.

# Camera and Video

To open the Camera application, tap  >  > **Apps tab** > .

## Getting to know the viewfinder







- 1 Clear view on&off** – Tap this icon to clean the camera mode.
- 2 Flash** – Choose from **Off** , **On** , **Auto** .
- 3 Swap camera** – Switch between the rear-facing camera lens and the front-facing camera lens.
- 4 Settings** – Tap this icon to open the settings menu.
- 5 Gallery** – Tap to view the last photo you captured. This enables you to access your gallery and view saved photos while in camera mode.
- 6 Record** – Allows you to start recording.
- 7 Capture** – Allows you to take a photo.
- 8 Back key**

**NOTE:** Please ensure the camera lens is clean before taking pictures.

## Camera and Video

### Using the advanced settings

In the viewfinder, tap  to open the advanced options. You can change the camera settings by scrolling through the list. After selecting the option, tap .

|  |   |
|--|---|
|  | Selects photo resolution. If you choose high resolution, file size will increase, which means you will be able to store fewer photos in the memory. |
|  | To take a photo, say one of the following words: Cheese, Smile, Whiskey, Kimchi or LG.  |
|  | Sets a delay after the capture button is pressed. This is ideal if you want to be in the photo.   |
|  | It is easily used to take better pictures to keeping horizontal and verticals.  |
|  | Opens the help guide to know how a function operates.   |

#### TIP!

The setting menu is superimposed over the viewfinder, so when you change photo color or quality elements, you will see a preview of the changed image behind the Settings menu.

## Taking a quick photo

- 1 Open the **Camera** application and point the lens toward the subject you want to photograph.
- 2 Focus boxes will appear in the center of the viewfinder screen. You can also tap anywhere on the screen to focus on that spot.
- 3 When the focus box turns blue, the camera has focused on your subject.
- 4 Tap  to capture the photo.

## Once you've taken a photo

Tap the image thumbnail at the bottom of the Camera screen to view the last photo you took.



Tap to edit the photo.



Tap to take another photo immediately.



Tap to send your photo to others or share it via social network services.



Tap to delete the photo.



Tap to access the options that you wish to adjust.



Tap to add the photo to **Favourites**.

**TIP!** If you have an SNS account set up on your phone, you can share your photo with your SNS community.

# Camera and Video

**NOTE:** Additional charges may apply when MMS messages are downloaded while roaming.

## Recording a quick video

- 1 Open the **Camera** application.
- 2 Holding the phone, point the lens towards the subject you wish to capture in your video.
- 3 Tap  once to start recording.
- 4 A red light will appear at the top right corner of the viewfinder with a timer showing the length of the video.
- 5 Tap on the screen to stop recording.

### TIP!

-  – Tap to capture an image during recording a video.
-  – Tap to pause recording a video.

## After recording a video

In the viewfinder, tap the video thumbnail at the top of the screen to view the last video you took.



Tap to record another video immediately.



Tap to send your video to others or share it via social network services.



Tap to delete the video.



Tap to access the options that you wish to adjust.

**NOTE:** Additional charges may apply when MMS messages are downloaded while roaming.

## Multi-point Auto Focus

When you take a picture, the Multi-point Auto Focus (AF) function operates automatically and will allow you to see a clear image.

## From your Gallery

Tap .

- To view more photos, scroll left or right.
- To zoom in or out, double-tap the screen or place two fingers and spread them apart (move your fingers closer together to zoom out).
- Tap on video play icon to play the video.



# Camera and Video

## Gallery

Open the **Gallery** application to view albums of your pictures and videos.

1 Tap  >  > **Apps** tab > .

You can manage and share all your image and video files with Gallery.

### NOTE:

- Some file formats are not supported, depending on the software installed on the device.
- Some files may not play properly, depending on how they are encoded.

## Viewing pictures

Launching Gallery displays your available folders. When another application, such as E-mail, saves a picture, the download folder is automatically created to contain the picture. Likewise, capturing a screenshot automatically creates the Screenshots folder. Select a folder to open it.

Pictures are displayed by creation date in a folder. Select a picture to view it full screen. Scroll left or right to view the next or previous image.

## Zooming in and out

Use one of the following methods to zoom in on an image:

- Double-tap anywhere to zoom in.
- Spread two fingers apart on any place to zoom in. Pinch to zoom out, or double-tap to return.





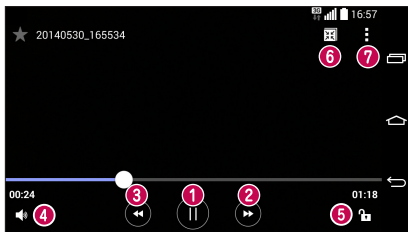

## Playing videos

Video files show the  icon in the preview. Select a video to watch it and tap . The Videos application will launch.

1 Tap  >  > **Apps** tab > .

2 Select the video you want to play.



|   |  |
|---|--|
| 1    | Touch to pause/resume video playback.              |
| 2    | Touch to go 10 seconds forward.                    |
| 3    | Touch to go 10 seconds backward.                   |
| 4    | Touch to manage the video volume.                  |
| 5    | Touch to lock/unlock a video screen.               |
| 6   | Touch to use QSlide.                               |
| 7  | Tap to access the options that you wish to adjust. |

## Camera and Video

To change the volume while watching a video, press the up and down volume keys on the back of the phone.

### Editing photos

When viewing an photo, tap .

### Deleting photos/videos

Use one of the following methods:

- In a folder, tap  and select photos/videos by ticking, and then tap on **Delete**.
- When viewing a photo, tap .

### Setting as wallpaper

When viewing a photo, tap  > **Set image as** to set the image as wallpaper or assign to a contact.

#### NOTE:



- Some file formats are not supported, depending on the device software.
- If the file size exceeds the available memory, an error can occur when you open files.

# Multimedia

## Music

Your phone has a built-in music player that lets you play all your favorite tracks. To access the music player, tap  >  > **Apps** tab > .

### Playing a song

- 1 Tap  >  > **Apps** tab > .
- 2 Tap **Songs**.
- 3 Select the song you want to play.

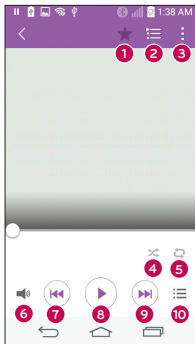

---









1  Tap to add the song to your favourites.

---

2  Tap to open the current playlist.

---

## Multimedia

- 3**  Tap to access **Search, Add to playlist, Delete, Share, Set as ringtone, Music video, Details** or **Settings**.
- 4**  Tap to play the current playlist in shuffle mode (tracks are played in random order).
- 5**  Tap to toggle through the repeat modes to repeat all songs, repeat current song, or repeat off.
- 6**  Tap to display the Volume slider bar, then adjust the playback volume on the slider bar.
- 7**  Tap to restart the current track or skip to the previous track in the album, playlist, or shuffle. Touch and hold to rewind.
- 8**  Tap to resume playback.
- 9**  Tap to skip to the next track in the album, playlist, or shuffle. Touch and hold to fast forward.
- 10**  Tap to go to the music library.

To change the volume while listening to music, press the up and down volume keys on the back side of the phone.

### NOTE:

- Some file formats are not supported, depending on the device software.
- If the file size exceeds the available memory, an error can occur when you open files.

**NOTE:** Music file copyrights may be protected by international treaties and national copyright laws.



Therefore, it may be necessary to obtain permission or a licence to reproduce or copy music.

In some countries, national laws prohibit private copying of copyrighted material. Before downloading or copying the file, check the national laws of the relevant country concerning the use of such material.

# Utilities

## Clock

The Clock app to access the Alarms, Timer, World clock and Stopwatch functions. Access these functions by tapping the tabs across the top of the screen or swiping horizontally across the screen.

Tap  >  > **Apps** tab > .

## Alarm

The Alarms tab allows you to set varying alarm clocks.

- 1 Open the **Clock** app, then select the **Alarm** tab.
- 2 Tap the **New alarm** icon to add a new alarm, tap an alarm time to modify that alarm or tap a current alarm icon to activate an existing alarm.

## Timer

The Timer tab can be used to alert you with an audible signal when a set amount of time has passed.

- 1 Open the **Clock** app, then select the **Timer** tab.
- 2 Set the time on the digital timer. Tap the **Hour**, **Minute** or **Second** field then enter the numbers as necessary.

## World clock

The World clock tab allows you to set up a list of cities to easily check current times in other time zones with a quick glance.

- 1 Open the **Clock** app, then select the **World clock** tab.
- 2 Tap the **New city** icon, search through the available cities, then tap the one you want.





## Stopwatch

The Stopwatch tab allows you to use your phone as a Stopwatch.

- 1 Open the **Clock** app, then select the **World clock** tab.
- 2 Tap the **Start** button and tap the **Stop** button to stop the time.  
You can use the Lap function by tapping the Lap button to record multiple milestone times within the same timing session.
- 3 Tap the **Reset** button to reset the Stopwatch or Tap the green **Resume** button to continue monitoring time.

## Calculator

The Calculator app allows you to perform mathematical calculations using a standard calculator or a scientific calculator.

- 1 Tap  >  > **Apps** tab > .
- 2 Tap the number keys to enter numbers.
- 3 For simple calculations, tap the function you want to perform (+, -, x or ÷) followed by =.
- 4 For more complex calculations, slide the left then choose sin, cos, tan, log etc.
- 5 To check the history, tap the icon .

## Calendar

The Calendar app allows you to track your schedule of events(That you created or that you've been invited to), organized by day, week, month, year or agenda.

- 1 Tap  >  > **Apps** tab > .





## Utilities

- 2 On the screen, you can find the different view types for the Calendar (Day, Week, Month, Year, Agenda).
- 3 Tap on the date for which you wish to add an event and tap .

## Voice Recorder

The Voice Recorder app records audible files for you to use in a variety of ways.

### Recording a sound or voice



- 1 Tap  >  > **Apps** tab > .
- 2 Tap  to begin recording.
- 3 Tap  to end the recording.
- 4 Tap  to listen to the recording.

**NOTE:** Tap  to access your album. You can listen to the saved recording. The available recording time may differ from actual recording time.

## Tasks

This task can be synchronized with MS Exchange account. You can create task, revise it and delete it in MS outlook or MS Office Outlook Web Access.

### Synchronizing MS Exchange

- 1 Tap  >  > **Apps** tab > .
- 2 Tap **General** > **Accounts & sync** > **Add account**.
- 3 Tap **Microsoft Exchange** to create Email address and Password.
- 4 Make sure if you checkmark Sync task.

**NOTE:** MS Exchange may not be supported depending on email server.

## Voice Search

Use this application to search webpages using voice.

- 1 Tap  >  > **Apps** tab > **Google** folder tab > .
- 2 Say a keyword or phrase when **Speak now** appears on the screen. Select one of the suggested keywords that appear.

**NOTE:** This application may not be available depending on the region or service provider.

## Downloads

Use this application to see what files have been downloaded through the applications.

- Tap  >  > **Apps** tab > .

**NOTE:** This application may not be available depending on the region or service provider.

# The Web

## Browser

Use this application to browse the Internet. Browser gives you a fast, full-color world of games, music, news, sports, entertainment and much more, right on your mobile phone wherever you are and whatever you enjoy.

**NOTE:** Additional charges apply when connecting to these services and downloading content. Check data charges with your network provider.

1 Tap  >  > **Apps** tab > .

## Using the Web toolbar

Tap slide it upwards with your finger to open.



Tap to go back one page.



Tap to go forward one page, to the page you connected to after the current one. This is the opposite of what happens when you tap , which takes you to the previous page.



Tap to go to the Home page.



Tap to add a new window.



Tap to access bookmarks.

## Viewing webpages

Tap the address field, enter the web address and tap **Go**.

## Opening a page

To go to new page, tap  → .

To go to another webpage, tap , scroll up or down, and tap the page to select it.

## Searching the web by voice

Tap the address field, tap , speak a keyword, and then select one of the suggested keywords that appear.

**NOTE:** This feature may not be available depending on the region or service provider.

## Bookmarks

To bookmark the current webpage, tap  > **Add to bookmarks** > **OK**.

To open a bookmarked webpage, tap  and select one.

## History

Tap  > **History** to open a webpage from the list of recently-visited webpages. To clear all history, tap  → **Yes**.

## Using Popup Browser

Use this feature to access the Internet without closing the current application.

While viewing content, such as contacts or notes that include web addresses, select a web address and then tap Popup Browser to open the pop-up browser. Touch and drag the browser to move it to another location.

To view the browser in full screen, tap .

To close the browser, tap .

# The Web

## Chrome

Use Chrome to search for information and browse webpages.

1 Tap  >  > **Apps** tab > .

**NOTE:** This application may not be available, depending on your region and service provider.

## Viewing webpages

Tap the Address field, and then enter a web address or search criteria.

## Opening a page

To go to a new page, tap  > **New tab**.

To go to another webpage, tap , scroll up or down and tap the page to select it.

## Syncing with other devices

Sync open tabs and bookmarks to use with Chrome on another device when you are logged in with the same Google account.

To view open tabs on other devices, tap  > **Recent tabs** > **Other devices**.

Select a webpage to open.

## Adding and viewing bookmarks

To add bookmarks, tap  > .

To open a bookmarked webpage, tap  > **Bookmarks** and select the desired page.

# Settings

This section provides an overview of items you can change using your phone's System settings menus.

## Accessing the Settings menu:

Tap  > **Tap and hold**  > **System settings**.

- or -

Tap  >  > **Apps tab** > .

## WIRELESS & NETWORKS

### < Airplane mode >

**Airplane mode** – Activating airplane mode disables all wireless connections.



### < Wi-Fi >

**Wi-Fi** – Turns on Wi-Fi to connect to available Wi-Fi networks.

#### **TIP! How to obtain the MAC address**

To set up a connection in some wireless networks with MAC filters, you may need to enter the MAC address of your phone in the router.

You can find the MAC address in the following user interface: tap 

>  > **Apps tab** >  **Settings** > **Networks tab** > **Wi-Fi** >  >

**Advanced Wi-Fi** > **MAC address**.

### < Bluetooth >

Turn the Bluetooth wireless feature on or off.

### < Mobile data >

Displays the data usage and allows you to set a mobile data usage limit.

# Settings

## < Call >

**Voicemail** – Allows you to select your carrier's voicemail service.

## OUTGOING CALL

**Fixed dialing numbers** – Turn on and compile a list of numbers that can be called from your phone. You'll need your PIN2, which is available from your operator. Only numbers within the fixed dial list can be called from your phone.

**Caller ID** – Use default operator settings to display your number in outgoing calls.

## INCOMING CALL

**Incoming voice call pop-up** – If you select this function, the Incoming voice call pop-up will be displayed when an app is in use.

**Decline with message** – When you want to reject a call, you can send a quick message using this function. This is useful if you need to reject a call during a meeting.

**Auto answer** – Allows you to enable or disable Auto answer with handsfree.

## ONGOING CALL

**Connection vibration** – Vibrates your phone when the other party answers the call.

**TTY mode** – Sets the TTY mode to communicate with other TTY devices.

**Hearing aids** – Checkmark to turn on hearing aid compatibility.

## END CALL

**Power button ends call** – Checkmark to allow you to end voice calls by pressing the Power/Lock Key.

## OTHERS

**Call duration** – Allows you to view the call duration for the last call, outgoing calls, incoming calls, and all calls.

**Sound settings** – Set the sound settings.

**Additional settings** – Set call forwarding and call waiting.

< More ... >

**Mobile networks** – Allows you to enable/disable data and set APNs.

**VPN** – Displays the list of Virtual Private Networks (VPNs) that you've previously configured. Allows you to add different types of VPNs.

**NOTE:** You must set a pattern, PIN or password before you can use credential storage.

## DEVICE

< Sound >

### BASIC

**Sound profile** – Set the sound profile to **Sound**, **Vibrate only**, or **Silent**.

**Volumes** – Manage the volume for **Ringtone**, **Notifications**, **Touch feedback & system**, and **Music, video, games & other media**.

### RINGTONES & VIBRATIONS

**Ringtone** – Sets the ringtone for calls. You can also add a ringtone by tapping the **New** icon  (at the upper-right corner of the screen).



## Settings

**Notification sound** – Sets the sound for notifications. You can also add a notification sound by tapping the **New** icon  (at the upper-right corner of the screen).

**Sound with vibration** – Checkmark to set the phone to vibrate in addition to the ringtone when you receive calls.

**Vibration type** – Sets the incoming call vibration options. Choose from **Long Lasting**, **Rapid**, **Short repeated**, **Standard**, and **Ticktock**. Tap the **New** icon  (at the upper-right corner of the screen) to create your own vibration pattern.

### NOTIFICATIONS

**Do not disturb** – Have no interruptions from notifications.

**Lock screen** – Set the lock screen for Show all notifications and Hide all notifications.

**Apps** – Set notifications for apps.

### ADVANCED SETTINGS

**Vibrate on tap** – Checkmark to vibrate when you touch the screen (e.g., touch keys and make selections).

**Sound effects** – Tap to set dial pad touch tones, touch sounds, screen lock sound, sound when roaming, or emergency tone.

**Message/call voice notifications** – Tap the Message/call voice notifications switch to toggle it On or Off. On allows your phone to automatically read your incoming calls and/or messages out loud. Checkmark Calls for caller information, Messages for sender information, and Read messages for message content. You can also set the readout language.

## < Display >

### SCREEN

**Brightness** – Adjust the screen brightness. Checkmark **Night brightness** to set brightness at 0% automatically between 12:00 AM ~ 06:00 AM.

**Screen timeout** – Set the amount of time before the screen times out.

**Screen-off effect** – Set the screen off effect used when the screen turns off.

**Auto-rotate screen** – Set to switch orientation automatically when you rotate the phone.

**Daydream** – Select the screensaver to display when the phone is sleeping while docked and/or charging.

### FONT

**Font type** – Change the type display font.

**Font size** – Change the size of the display font.

### ADVANCED SETTINGS

**Home touch buttons** – Sets the Touch Keys displayed at the bottom of all of the screens. Set which ones are displayed, their position on the bar, and what they look like. Select Button combination, Color.

# Settings

< Home screen >

## SCREEN

**Wallpaper** – Sets the wallpaper to use on your Home screen. Select it from **Gallery**, **Live Wallpapers**, **Photos**, or **Wallpaper gallery**.

**Screen swipe effect** – Sets the effect when you swipe to change screens. Choose from **Slide**, **Breeze**, **Accordion**, **Panorama**, **Carousel**, **Layer**, and **Domino**.

**Allow Home screen looping** – Checkmark to set the Home screen panels to scroll continuously, eliminating the need to scroll back in the opposite direction when you reach either end.

## DATA

**Home backup & restore** – Backup and restore the app, widget, and theme configurations.

## TIPS

**Help** – Displays some useful tips for the Home screen.

< Lock screen >

## SCREEN SECURITY

**Select screen lock** – Set a screen lock type to secure your phone. Set **None**, **Swipe**, **Knock Code**, **Face Unlock Pattern**, **PIN** or **Password**.

**Screen swipe effect** – Select the screen effect you want to use when unlocking the screen. Set **Dewdrop** or **White hole**.

## CUSTOMIZE

**Wallpaper** – Select the wallpaper for your lock screen from **Gallery** or **Wallpaper gallery**.

**Shortcuts** – Customize the shortcuts on the lock screen.

**Contact info for lost phone** – Show owner info on the lock screen in case your phone is lost.

## LOCK TIME

**Lock timer** – Set the lock time after the screen times out.

**Power button instantly locks** – Set the screen lock when the Power/Lock Key is pressed.

## < Gestures >

## ANSWER ME

**Silence incoming calls** – Flip the device to silence incoming calls.

## OTHERS

**Snooze or stop alarm** – Flip the device to snooze or stop the alarm.

**Pause video** – Flip the device to pause the video.

**Help** – Touch to get information on using the Gesture functions of your device.

## SENSOR

**Motion sensor calibration** – Improve the accuracy of the tilt and speed of the sensor.

## < Storage >

**INTERNAL STORAGE** – View the internal storage usage.

**Total space** – Displays the total amount of space in the phone's memory. It's listed in Gigabytes and also on a colored bar graph with a colorcoordinated list of the apps as well as the amount of space they use. Remaining memory space is gray-colored.

## Settings

**SD CARD** – Check total available SD card space. Tap **Unmount SD card** for safe removal. If no SD card is mounted, tap **Mount SD card**. Tap **Erase SD card** if you want to delete all data from the SD card.

### < Battery >

#### BATTERY INFORMATION

The Battery charge information is displayed on a battery graphic along with the percentage of the remaining charge and its status.

**Battery usage** – Tap the Battery charge icon to display the Battery use screen to see battery usage level and battery use details. It displays which components and applications are using the most battery power. Tap one of the entries to see more detailed information.

**Battery percentage on status bar** – Checkmark to display the battery level percentage on the Status Bar next to the battery icon.

#### Battery saver

Tap the switch  to toggle it On or Off.

#### TURN BATTERY SAVER ON

**Turn Battery saver on** – Choose to turn battery saver on when the battery charge gets to a certain battery level. Choose from **Immediately**, **5% battery**, **15% battery**.

**Help** - You can get more information about battery saving items.

### < Smart cleaning >

Display the space in use and free in your phone. Tap the Menu Key , then tap Settings to set notification interval and idle time period.

### < Apps >

Use the **Apps** menu to view details about the applications installed on your phone, manage their data, and force them to stop.

Swipe left and right to select one of the three tabs across the top of the screen to view detailed information for **DOWNLOADED**, **RUNNING**, and **ALL** applications.

Tap an entry to view more information, tap **Stop** (or **Force stop**), then **OK** to stop it from running.

### < Default message app >

Set Messaging or Hangouts as default app.

## PERSONAL

### < Accounts & sync >

Permits applications to synchronize data in the background, whether or not you are actively working in them. Deselecting the **Auto-sync data** setting can save battery power and lower (but not eliminate) data usage.

### < Location >

#### MODE

**High accuracy** – Use GPS, Wi-Fi and mobile networks to estimate location.

**Battery saving** – Use Wi-Fi and mobile networks to estimate location.

**Device sensors only** – Use GPS to pinpoint your location.

#### RECENT LOCATION REQUESTS

Displays apps that have recently requested location information.

# Settings

## LOCATION SERVICES

Allows you to view your Google location settings.

< **Security** >

## ENCRYPTION

**Encrypt phone** – Allows you to encrypt the phone to keep it secure. After encryption, a PIN or password needs to be entered each time you power the phone on.

**Encrypt SD card storage** – Allows you to encrypt the SD card data to keep it secure. After encryption, you will not be able to use it in other devices. Any data that is created or updated after disabling encryption will not be encrypted but the data that has been previously encrypted will remain encrypted.

## PASSWORDS

**Password typing visible** – Show the last character of the hidden password as you type.

## PHONE ADMINISTRATION

**Phone administrators** – View or deactivate phone administrators.

**Unknown sources** – Default setting to install non-Play Store applications.

**Verify apps** – Disallow or warn before installation of apps that may cause harm.

## CREDENTIAL STORAGE

**Storage type** – Displays the current storage type for credentials (e.g., Hardware-backed).



**Trusted credentials** – Display trusted CA certificates.

**Install from storage** – Choose to install encrypted certificates.

**Clear credentials** – Remove all certificates.

## ADVANCED

**Trust agents** – Select apps to use without unlocking screen.

**Screen pin** – Allows you to lock your device to a single app to keep your devices secure. To use it, Tap the switch  to turn it on. To activate it, tap Recent Apps Key  > . To exit, touch and hold Back Key + Recent Apps Key at the same time.

## < Language & input >

**Language** – Sets the language to use on your device.

## KEYBOARD & INPUT METHODS

**Default** – Sets the default on-screen keyboard to use when entering text.

**LG Keyboard** – Checkmark to select the LG Keyboard to enter data. Tap the **Settings** icon  to change the following settings:

## MY KEYBOARD

**Input language and keyboard layout:** Sets the keyboard language and layout (QWERTY and Phone).

**Keyboard height and layout:** Allows you to adjust various height and layout options for you keyboard to make it easier to use.

**Phone keyboard layout:** Sets customize symbol and setting keys in side columns.

**QWERTY keyboard layout:** Sets customize setting key, symbol keys, and more in the bottom row.

**Keyboard height:** Sets the height of the keyboard in comparison to the screen you're typing on.

**Keyboard theme:** Sets the Keyboard theme. Choose White or Black.



# Settings

## SMART INPUT

**Path input:** Checkmark to enter a word by drawing a path through all of the letters.

**Show word suggestion:** Checkmark to show words through text prediction.

**Show emoticon suggestions:** Checkmark to show word-related color emoticons.

**Auto correction:** Choose from **Off**, **Mild**, **Moderate**, and **Aggressive**.

**Update word suggestions:** Uses Swype Connect to provide more word suggestions. To use this feature, accept the Agreement Rights.

**Additional settings:** Sets advanced settings including checkboxes to enable

**Vibrate on keypress**, **Sound on keypress**, **Pop-up on keypress**, **Auto-capitalization**, **Auto-punctuation**, **Spell checker** and **Suggest next word**.

In addition, you can access **Clear word suggestion history** and **Personal dictionary**.

**Help:** Displays additional keyboard help information.

**Google voice typing** – Checkmark to select Google voice typing to enter data. Tap the **Settings** icon  to change the Google voice settings.

**Choose input languages:** Sets the languages supported with Google voice typing.

## GENERAL

**Block offensive words:** Checkmark to hide recognized offensive text.

**Offline speech recognition:** Enables voice input while offline.

## SPEECH

**Voice Search** – Sets the following options: **Language**, **Speech output**, **"Ok Google"** **Detection**, **Offline speech recognition**, **Block offensive words** and **Bluetooth headset**.

**Text-to-speech output** – Sets the preferred speech engine and speech rate (slow vs. fast). Also plays a short demonstration of speech synthesis.

## MOUSE/TRACKPAD

**Pointer speed** – Sets the pointer speed using a slide bar to select it.

### < Backup & reset >

## BACKUP & RESTORE

**Back up my data** – Backup your app data, Wi-Fi passwords, and other settings to Google servers.

**Backup account** – Allows you to set the account to which you want to backup data to.

**Automatic restore** – When reinstalling an app, restore backed up settings and data.

## PERSONAL DATA

**Factory data reset** – Reset your settings to the factory default values and delete all your data.

## SYSTEM

### < Shortcut key >

Tap the Shortcut key switch  to toggle it On or Off. On allows quick access to apps by pressing and holding the Volume Keys (on the back of the phone) when the screen is off or locked. Press and hold the Volume Up Key to access QuickMemo+. Press and hold the Volume Down Key access the Camera app.

## Settings

### < Date & time >

**Automatic date & time** – Checkmark to use network-provided time.

**Automatic time zone** – Checkmark to use network-provided time zone.

**Set date** – If you do not activate Automatic date & time, then set the date.

**Set time** – If you do not activate Automatic date & time, then set the time.

**Select time zone** – If you do not activate Automatic time zone, then set the time zone.

**Use 24-hour format** – Checkmark to display the time using the 24-hour time format (for example, 13:00 instead of 1:00 pm).

**Select date format** – Sets the format for displaying dates.

### < Accessibility >

Use the **Accessibility** settings to configure accessibility plug-ins you have installed on your phone.

## VISION

**TalkBack** – Allows you to set up the TalkBack function which assists people with impaired vision by providing verbal feedback. Tap the switch  to toggle it On or Off. Tap **Settings** at the bottom of the screen to adjust the TalkBack settings.

**Font size** – Checkmark to increase the size of the text.

**Invert color** – Sets the color contrast for better screen viewing. Tap the switch  to toggle it On or Off. Then tap the screen and drag across the screen in any direction until you see the color contrast you want to use.

**Color adjustment** – Set the adjustment screen and content colors.

**Touch zoom** – Set the zoom in and out by triple-tapping the screen.

**Message/call Voice notifications** – Tap the Voice notifications switch  to toggle it On or Off. On allows you to hear automatic spoken alerts for incoming calls and messages.



## READ OUT LOUD

**Calls:** Checkmark to read caller information out loud.

**Messages:** Checkmark to read sender information out loud.

**Read messages:** Checkmark to read messages out loud.

## LANGUAGE

**Message/call voice notifications Language:** Tap to set Text-to-speech output. Choose **Google Text-to-speech** or **LG TTS+**. If you choose **Google Text-to-speech**, tap the **Settings** icon  to set **Language** and **Settings for Google Text-to-speech Engine**, and **Install voice data**. If you choose **LG TTS+**, tap the **Settings** icon  to set **Language** and **Settings for LG TTS+**.

**Speech rate:** Sets the speech rate. Choose from **Very slow**, **Slow**, **Normal**, **Fast**, and **Very fast**.

**Listen to an example:** Tap to play a short demonstration of Text-to-speech.

**Default language status:** English (United States) is fully supported.

**Screen shades** – Activate to dim the screen's backlight.

**Accessibility shortcut** – Set the accessibility shortcut quickly on any screen.

**Text-to-speech output** – Sets the customize text-to-speech(TTS) settings.

## HEARING

**Audio type** – Sets the audio type. Choose **Mono** or **Stereo**.

## Settings

**Sound balance** – Routes the sound through both the right and left channel when a headset is connected. To manually set the audio route, move the slider on the sound balance slide bar to set it.

**Flash alerts** – Checkmark to allow a flash to blink for incoming calls and notifications.

**Turn off all sounds** – Checkmark to turn off all sounds.

**Captions** – Tap the **Captions** switch  to toggle it On or Off. On customizes caption settings for those with hearing impairments. Set **Language**, **Font size**, and **Caption style**.

### PHYSICAL AND MOTOR

**Touch feedback time** – Sets the touch and feedback time. Choose from **Short**, **Medium**, or **Long**.

**Touch assistant** – Tap the **Touch assistant** switch to toggle it On or Off. On allows you to replace the hardware keys with a **Touch assistant** board that is displayed on the touchscreen. Tap the **Touch assistant** icon to be able to tap its Power button, Home button, Volume down button, Volume up button, and the more button (**Screen capture** button, **Accessibility** button, and **Pinch** button). Draw a "C" ("call") on the board to automatically display the Dial tab. Draw an "M" on the board to automatically display the Messaging app. Draw a "W" ("web") on the board to automatically launch the Chrome app. Draw an "S" ("Settings") on the board to automatically display the settings app. Draw an "L" ("Lock screen") on the board to go directly to the Lock screen.

**Screen timeout** – Sets the screen timeout. Choose from **15 seconds**, **30 seconds**, **1 minute**, **2 minutes**, **5 minutes**, **10 minutes**, **15 minutes**, **30 minutes**, and **Keep screen turned on**.

## RECOGNITION

**Touch control areas** – Tap the **Touch control areas** switch  to toggle it On or Off. On allows you to select an area of the screen to limit touch control. Press the **Volume Down Key** and tap the **Home Key** at the same time to activate and deactivate this feature.

## SYSTEM

**Auto-rotate screen** – Checkmark to allow the phone to rotate the screen depending on the phone orientation (portrait or landscape).

**Password voice confirmation** – Checkmark so that your phone can read passwords you enter.

**Power key ends call** – Checkmark so that you can end voice calls by pressing the **Power/Lock Key**. When enabled, pressing the **Power/Lock Key** during a call does not lock the screen.

**Accessibility settings shortcut** – Sets quick, easy access to selected features when you triple-tap the **Home Key** . Choose from **Off**, **Show all**, **TalkBack**, **Invert colors**, **Universal touch**, and **Accessibility settings**.

**One-touch input** – Checkmark to enable one-touch input. It allows each finger touch to enter letter or character on the LG keyboard.

## SERVICES

**Switch access** – Allows you to interact with your device using one or more switches that work like keyboard keys. This menu can be helpful for users with mobility limitations that prevent them from interacting directly with the your device. Tap **Settings** at the bottom of the screen to adjust the Switch access settings.

# Settings

## < Printing >

### PRINT SERVICES

**Cloud Print** – This menu allows you to access your cloud print services.

## < About phone >

This menu allows you to manage your software updates and view various information relating to your device.

**Phone name** – Allows you to change your phone name. This will be your phone name for Bluetooth, Wi-Fi Direct, etc.

**Update Center** – Check updates for apps and software provided by LG Electronics.

**Network** – Allow you to view your network, network type and strength, service state, roaming status, mobile network state, and IP address.

**Status** – Allow you to view your phone number, MIN, PRL version, ESN, MEID HEX, MEID DEC.

**Battery** – Allows you to view the battery status, battery level, and battery use information.

**Hardware info** – Allows you to view the model number, up time, warranty date code, Wi-Fi MAC address and Bluetooth address.

**Software info** – Allows you to view the Android version, baseband version, kernel version, build number, and software version.

**Legal info** – Allows you to view LG apps rights agreement, open source licenses and Google legal information.

**Patent information** – Display LG patent information.

# Phone software update

## Update your smart phone without a PC (FOTA)

This feature allows you to conveniently update your phone's software to a newer version via Firmware Over-the-Air (FOTA), without connecting with to a USB cable.

**1** From the Home screen, tap  > **System settings > About phone > Update Center > Software Update.**

**2** Select the desired option.

**Update now** – You can check the new software update and conduct the update.

**Check current version** – You can check the current software version.

**Last update** – Displays the date of the last software update.

### NOTE

- After download, you can install the software immediately or select a later time for the installation.
- Each software version is updated sequentially. Even after the update is completed, check if there is any newer version available.
- LG reserves the right to make firmware updates available only for selected models at its own discretion and does not guarantee the availability of the newer version of the firmware for all phone models.



## Accessories

These accessories are available for use with your phone. **(Items described below may be optional and sold separately.)**

### Travel adapter



### Data cable

Connect your phone and PC.



### User Guide

Learn more about your phone.



### Battery

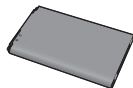

### NOTE:

- Always use genuine LG accessories. Failure to do this may void your warranty.
- Accessories may vary in different regions.

# About this user guide

## About this user guide

- Before using your device, please carefully read this manual. This will ensure that you use your phone safely and correctly.
- Some of the images and screenshots provided in this guide may appear differently on your phone.
- Your content may differ from the final product, or from software supplied by service providers or carriers. This content may be subject to change without prior notice. For the latest version of this manual, please visit the LG website at [www.lg.com](http://www.lg.com).
- Your phone's applications and their functions may vary by country, region, or hardware specifications. LG cannot be held liable for any performance issues resulting from the use of applications developed by providers other than LG.
- LG cannot be held liable for performance or incompatibility issues resulting from edited registry settings being edited or operating system software being modified. Any attempt to customize your operating system may cause the device or its applications to not work as they should.
- Software, audio, wallpaper, images, and other media supplied with your device are licensed for limited use. If you extract and use these materials for commercial or other purposes, you may be infringing copyright laws. As a user, you are fully and entirely responsible for the illegal use of media.
- Additional charges may be applied for data services, such as messaging, uploading and downloading, auto-syncing, or using location services. To avoid additional charges, select a data plan that is suitable for your needs. Contact your service provider to obtain additional details.

## About this user guide

### Trademarks



- LG and the LG logo are registered trademarks of LG Electronics.
- All other trademarks and copyrights are the property of their respective owners.

## FAQ

| Category<br>Sub-<br>Category      | Question   | Answer   |
|-----------------------------------|--|--|
| <b>BT</b><br>Bluetooth<br>Devices | What are the functions available via Bluetooth   | You can connect a Bluetooth audio device such as a Stereo/Mono headset or Car Kit.   |
| <b>BT</b><br>Bluetooth<br>Headset | If my Bluetooth headset is connected, can I listen to my music through my 3.5 mm wired headphones? | Yes, you can listen to your music through the last connected device.   |
| <b>Data</b><br>Contacts<br>Backup | How can I backup Contacts?   | The Contacts data can be synchronized between your phone and Gmail™.   |
| <b>Data</b><br>Synchronization    | Is it possible to set up one-way sync with Gmail?  | Only two-way synchronization is available.   |
| <b>Data</b><br>Synchronization    | Is it possible to synchronize all email folders?   | The Inbox is automatically synchronized. You can view other folders by tapping  and select <b>Folders</b> to choose a folder. |

# FAQ

| Category<br>Sub-<br>Category                    | Question   | Answer   |
|---|--|--|
| <b>Google™<br/>Service</b><br>Gmail Log-In      | Do I have to log into Gmail whenever I want to access Gmail?   | Once you have logged into Gmail, no need to log into Gmail again.          |
| <b>Google™<br/>Service</b><br>Google<br>Account | Is it possible to filter emails?   | No, email filtering is not supported via the phone.                        |
| <b>Phone<br/>Function</b><br>Email              | What happens when I execute another application while writing an email?                              | Your email will automatically be saved as a draft.                         |
| <b>Phone<br/>Function</b><br>Ringtone           | Is there a file size limitation for when I want to use MP3 file as ring tone?                        | There is no file size limitation.  |
| <b>Phone<br/>Function</b><br>Message<br>Time    | My phone does not display the time of receipt for messages older than 24 hrs. How can I change this? | You will only be able to see the times for messages received the same day. |

| Category<br>Sub-<br>Category                   | Question  | Answer  |
|--|---|---|
| <b>Phone<br/>Function</b><br>Navigation        | Is it possible to install another navigation application on my phone? | Any application that is available at Play Store™ and is compatible with the hardware can be installed and used.   |
| <b>Phone<br/>Function</b><br>Synchronisation   | Is it possible to synchronize my contacts from all my email accounts? | Only Gmail and MS Exchange server (company email server) contacts can be synchronized.  |
| <b>Phone<br/>Function</b><br>Wait and<br>Pause | Is it possible to save a contact with Wait and Pause in the numbers?  | <p>If you transferred a contact with the W &amp; P functions saved into the number, you will not be able to use those features. You will need to re-save each number.</p> <p>How to save with Wait and Pause:</p> <ol style="list-style-type: none"> <li>1. From the Home screen, tap the <b>Phone</b> icon .</li> <li>2. Dial the number, then tap .</li> <li>3. Tap <b>Add 2-sec pause</b> or <b>Add wait</b>.</li> </ol> |
| <b>Phone<br/>Function</b><br>Security          | What are the phone's security functions?                              | You are able to set the phone to require that an Unlock Pattern be entered before the phone can be accessed or used.  |



## FAQ

| Category<br>Sub-<br>Category                   | Question                               | Answer  |
|--|--|---|
| <b>Phone<br/>Function</b><br>Unlock<br>Pattern | How do I create the<br>Unlock Pattern? | <ol style="list-style-type: none"><li>1. From the Home screen, tap .</li><li>2. Tap <b>Settings</b> &gt; <b>Display</b> tab &gt; <b>Lock screen</b>.</li><li>3. Tap <b>Select screen lock</b> &gt; <b>Pattern</b>. The first time you do this, a short tutorial about creating an Unlock Pattern will appear.</li><li>4. Set up by drawing your pattern once, and once again for confirmation.</li></ol> <p>Precautions to take when using the pattern lock.</p> <p>It is very important to remember the unlock pattern you set. You will not be able to access your phone if you use an incorrect pattern five times. You have five chances to enter your unlock pattern, PIN or password. If you have used all 5 opportunities, you can try again after 30 seconds. (Or, if you preset the backup PIN, you can use the backup PIN code to unlock the pattern.)</p> |

| Category<br>Sub-<br>Category                   | Question  | Answer  |
|--|---|---|
| <b>Phone<br/>Function</b><br>Unlock<br>Pattern | What should I do if I forget the unlock pattern and I didn't create my Google account on the phone? | <p>If you have forgotten your pattern:<br/>If you logged into your Google account on the phone but failed to enter the correct pattern 5 times, tap the forgot pattern button. You are then required to log in with your Google account to unlock your phone. If you have not created a Google account on the phone or you have forgotten it, you will have to perform a hard reset.</p> <p>Caution: If you perform a factory reset, all user applications and user data will be deleted. Please remember to backup any important data before performing a factory reset.</p> |
| <b>Phone<br/>Function</b><br>Memory            | Will I know when my memory is full?   | Yes, you will receive a notification.   |



## FAQ

| Category<br>Sub-<br>Category              | Question  | Answer   |
|---|---|--|
| <b>Phone Function</b><br>Language Support | Is it possible to change my phone's language?   | <p>The phone has multilingual capabilities.</p> <p>To change the language:</p> <ol style="list-style-type: none"> <li>1. From the Home screen, tap  and tap <b>Settings</b>.</li> <li>2. Tap <b>General</b> tab &gt; <b>Language &amp; input</b> &gt; <b>Language</b>.</li> <li>3. Tap the desired language.</li> </ol> |
| <b>Phone Function</b><br>VPN              | How do I set up a VPN?  | <p>VPN access configuration is different for each company. To configure VPN access from your phone, you must obtain the details from your company's network administrator.</p>   |
| <b>Phone Function</b><br>Screen time out  | My screen turns off after only 15 seconds. How can I change the amount of time for the backlight to turn off? | <ol style="list-style-type: none"> <li>1. From the Home screen, tap .</li> <li>2. Tap <b>Settings</b> &gt; <b>Display</b> tab.</li> <li>3. Tap <b>Screen timeout</b>.</li> <li>4. Tap the preferred screen backlight timeout time.</li> </ol>   |

| Category<br>Sub-<br>Category                    | Question   | Answer   |
|---|--|--|
| <b>Phone Function</b><br>Wi-Fi & mobile network | When Wi-Fi and mobile network are both available, which service will my phone use? | When using data, your phone may default to the Wi-Fi connection (if Wi-Fi connectivity on your phone is set to On). However, there will be no notification when your phone switches from one to the other. To know which data connection is being used, view the mobile network or Wi-Fi icon at the top of your screen.       |
| <b>Phone Function</b><br>Home screen            | Is it possible to remove an application from the Home screen?                      | Yes. Just touch and hold the icon until the dustbin icon appears at the top and center of the screen. Then, without lifting your finger, drag the icon to the trash can.   |
| <b>Phone Function</b><br>Application            | I downloaded an application and it causes a lot of errors. How do I remove it?     | <ol style="list-style-type: none"> <li>1. From the Home screen, tap .</li> <li>2. Tap <b>Settings</b> &gt; <b>General</b> tab &gt; <b>Apps</b> &gt; <b>DOWNLOADED</b>.</li> <li>3. Tap the application, then tap <b>Uninstall</b>.</li> </ol> |

## FAQ

| Category<br>Sub-<br>Category         | Question  | Answer   |
|--------------------------------------|---|--|
| <b>Phone<br/>Function</b><br>Charger | Is it possible to charge my phone using a USB data cable without installing the necessary USB driver? | Yes, the phone will be charged by the USB cable regardless of whether the necessary drivers are installed or not.  |
| <b>Phone<br/>Function</b><br>Alarm   | Can I use music files for my alarm?   | Yes, when you set up an Alarm you can use a Music file as Alarm sound.<br>1. Add new Alarm.<br>2. From the <b>Set alarm</b> setting screen, tap <b>Alarm sound</b> then choose <b>Music</b> and tap on desired Music file. |
| <b>Phone<br/>Function</b><br>Alarm   | Will my alarm be audible or will it go off if the phone is turned off?                                | No, this is not supported.   |
| <b>Phone<br/>Function</b><br>Alarm   | If my ringer volume is set to Off or Vibrate, will I hear my alarm?                                   | Your alarm is programmed to be audible even in these scenarios.  |

| Category<br>Sub-<br>Category                                     | Question  | Answer   |
|--|---|--|
| <b>Recovery<br/>Solution</b><br>Hard Reset<br>(Factory<br>Reset) | How can I perform a factory reset if I can't access the phone's setting menu? | If your phone does not restore to its original condition, use a hard reset (factory reset) to initialize it. |

## For your safety

The highest SAR value for this model phone when tested for use at the ear is 0.XX W/kg and when worn on the body, as described in this user guide, is 0.XX W/kg (body-worn measurements differ among phone models, depending upon available accessories and FCC requirements).

While there may be differences between SAR levels of various phones and at various positions, they all meet the government requirement for safe exposure.

The FCC has granted an Equipment Authorization for this model phone with all reported SAR levels evaluated as in compliance with the FCC RF emission guidelines. SAR information on this model phone is on file with the FCC and can be found under the Display Grant section of <http://www.fcc.gov/oet/ea/fccid/> after searching on FCC ID ZNFL21G.

- To reduce risk of fire or burns, do not expose to temperature above 45°C / 113 °F, or dispose of in fire.
- To reduce risk of fire or burns, do not dispose of in fire or water.
- Do not disassemble or open crush, bend or deform, puncture or shred.
- There is a danger of explosion if battery is incorrectly replaced. To reduce risk of fire or burns, do not disassemble, crush, puncture, short external contacts, expose to temperature above 45°C / 113 °F, or dispose of in fire or water. Keep this product away from excessive moisture and extreme temperatures. Keep the battery or device dry and away from water or any liquid as it may cause a short circuit.
- Avoid using your phone near strong electromagnetic sources, such as microwave ovens, sound speakers, TV and radio.

- Use only original manufacturer-approved accessories, or accessories that do not contain any metal. Please only use an approved charging accessory to charge your LG phone. Improper handling of the Accessory/Charger Port, as well as the use of an incompatible charger, may cause damage to your phone and void the warranty.
- Only use the approved battery charger. Otherwise, you may cause serious damage to your phone.