

David Sabatini steps down at Whitehead Institute over sexual harassment reports

Sabatini remains professor at MIT; senior administration response may include the revocation of tenure

By Shelley Choi
NEWS EDITOR

David Sabatini, MIT biology professor, resigned as a Whitehead Institute member Aug. 20. He was further terminated from his employment as an investigator at the Howard Hughes Medical Institute (HHMI). Sabatini remains a tenured professor at MIT but has been placed on administrative leave according to his MIT Biology profile.

Whitehead Director Ruth Lehmann announced Sabatini's resignation in an email to staff Aug. 20. Sabatini "is no longer associated with either the Whitehead" or the HHMI, "effective immediately."

Sabatini's departure comes after an investigation found he "violated" the Whitehead's "policies on sexual harassment" and others "unrelated to research misconduct," Lehmann wrote.

Todd Golub, director of the Broad Institute, wrote in an email to staff Aug. 21 that Sabatini has also been placed "on leave at the Broad, where he is a senior associate member."

According to Lehmann's email, a "Diversity, Equity and Inclusion survey commissioned and conducted last winter" that "collected data and comments on the culture" across the

Whitehead "identified issues of particular concern in the Sabatini Lab." Hinkley Allen & Snyder LLP was appointed to investigate the lab.

Lehmann added that Sabatini's departure has "significant implications for the 39 members of his lab," where four are "HHMI employees" and "the remainder are Whitehead employees." "Whitehead human resources personnel will be conducting one-on-one meetings" with all 39 members to "help effectuate a plan to ensure their smooth transition to another lab setting so that they may continue their work in pursuit of their career goals."

MIT's News Office wrote in an email to *The Tech* that MIT takes "complaints regarding harassment seriously" and that the "senior administration is reviewing the report and determining next steps in response to these findings, up to and including revocation of tenure proceedings."

Sabatini has been funded by the HHMI since 2008, according to HHMI's profile on Sabatini. He is also a member of the Koch Institute for Integrative Cancer Research, member of the National Academy of Sciences, and research professor at the American Cancer Society. It is unclear if he still maintains these positions since the reports.



KEVIN LY - THE TECH

Orientation leaders give first years a warm welcome as Orientation Week kicks off for the class of 2025 Monday.

MIT Welcome Center set to open on Sept. 7 near Kendall Square

In-person tours and information sessions to resume this fall

By Kristina Chen
EDITOR IN CHIEF

MIT will open its new welcome center Sept. 7. The center will be located in Kendall Square on the first floor of Building E38 of Site 4.

The MIT Welcome Center is a gift of Tina and Hamid Moghadam (SB 1977, SM 1978) and will serve as a place for visitors to attend information sessions, take campus tours, and receive maps and guidance about visiting.

Director of Communications of the Office of the Executive Vice President and Treasurer Jennifer Burke wrote in an email to *The Tech* that MIT will begin holding

in-person campus tours and information sessions "later in September" while also continuing to hold online admission information sessions.

Burke wrote that the welcome center will be the first time that MIT provides "a dedicated space to welcome prospective students and their families."

The center has a 200-seat auditorium where information sessions for prospective students will take place and where campus tours will begin.

Burke added that the welcome center will "broadly support the needs of both visitors and Cambridge community members for

wayfinding and informational services about the campus and the local area."

The new center is near the inbound Kendall/MIT MBTA stop.

Design of E38, where the welcome center is located, took place from 2015 to 2017, "following a period of exploration and community engagement," Burke wrote. Construction of the building began in 2017 and ended in 2020.

Inside, visitors will find a range of visual elements that showcase the Institute's collaborative, eclectic, and lively culture, including an installation by MIT's Borderline artists, inspired by the phrase, "Here at MIT..."

IN SHORT

First quarter **physical education class** registrations open 8 a.m. Sept. 3.

Move-in for juniors, seniors, and sophomores who did not opt into Residence Exploration is Sept. 4–6.

Registration Day is Sept. 7.

Labor Day is Sept. 6.

The **first day of classes** is Sept. 8.

The **registration deadline** is Sept. 10.

Faculty, students, and staff should report their **vaccine status** at covidvaccine.mit.edu.

Interested in **joining *The Tech***? Email join@tech.mit.edu.

Send news and tips to news@tech.mit.edu.

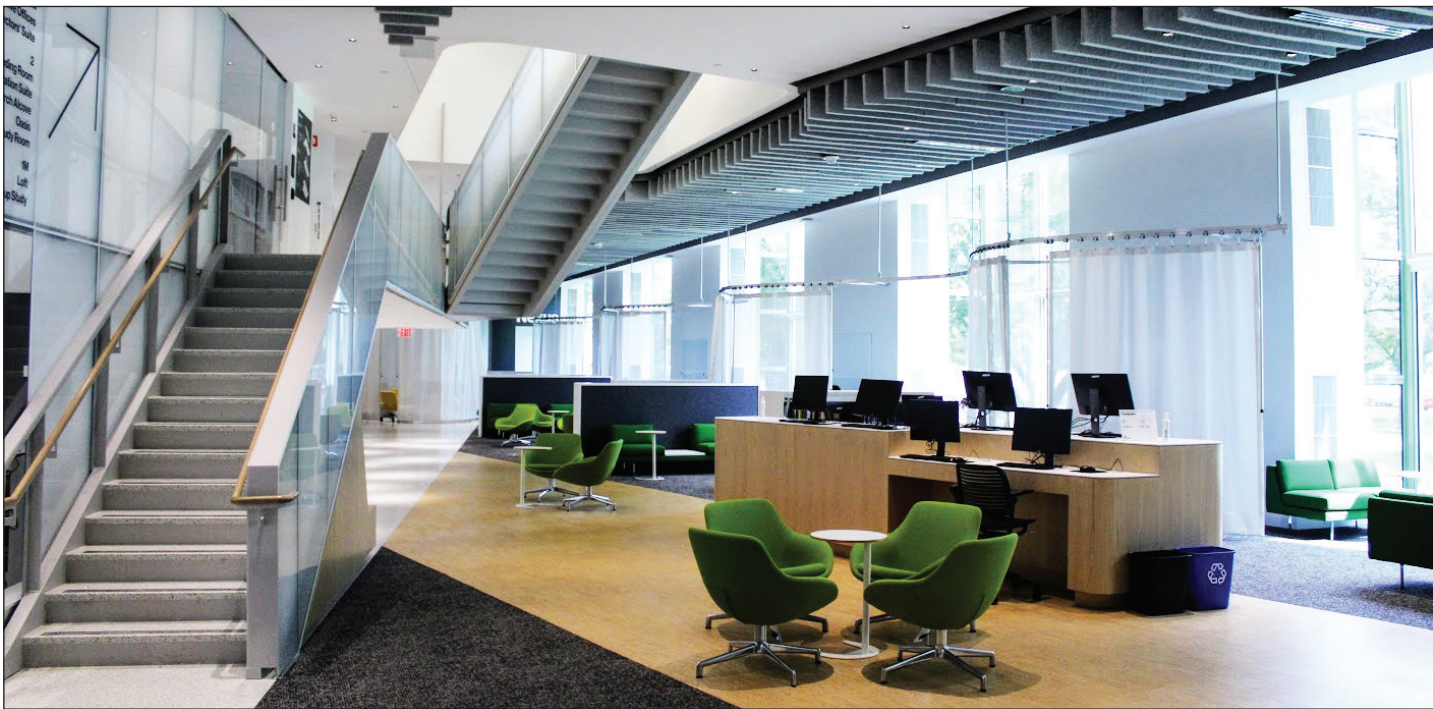

FRANKIE SCHULTE - THE TECH

The recently renovated Hayden Library has been open for the past month only for MIT community members on COVID Pass.

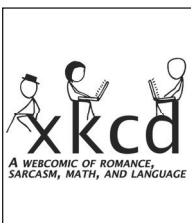

XKCD

All You Can Eat. **FUN, p. 6**



XKCD

Santa. **FUN, p. 6**

SECTIONS

Fun Pages 6



Publisher
Joanna Lin '21

Editor in Chief
Kristina Chen '23

Business Manager
Daniel Zhang '22

Managing Editor
Chloe McCreery '23

Executive Editor
Wenbo Wu '23

NEWS STAFF

News Editors: Shelley Choi '23, Srinidhi Narayanan '24; **Associate News Editors:** Grace Song '23, Nicole Chan '24; **Staff:** Edwin Song '22, Kylee Carden '23, Kerri Lu '23, Jennifer Ai '24, Mauricio Barba da Costa '24, Daisy Wang '24; **Meteorologist:** Sarah Weidman '21, Trinity Manuelito '23, Phoebe Lin '24.

PRODUCTION STAFF

Editors: Ana P. Reyes Sánchez '22, Arun Wongprommoon '23, William Xu '24; **Staff:** Yichi Zhang G, Laney Flanagan '22, Cristian Martinez-Herrera '22, Alexandra Li '23, Alexis Huang '24, Katherine L. Pan '24, Lydia Patterson '24, Alina Sarmiento '24, Frankie Schulte '24, Mannie Tilo '24; **Illustrator:** Gloria Lin '21, Farin Tavacoli '24.

SCIENCE STAFF

Staff: Albert Liu '23, Seung Hyeon Shim '23.

SPORTS STAFF

Editor: Suleman Thaniana '23.

ARTS STAFF

Editors: Lulu Tian '22, Liane Xu '23, Erika Yang '23; **Staff:** Vyshnavi Vennelakanti G, Johnson Huynh '21, Max Langenkamp '21, Lani Lee '21, Sharon Lin '21, Nyssa Miller '21, Rona Wang '21, Leah Yost '21, Alana Chandler '22, Rajiv Movva '22, Vaishnavi Phadnis '22, Victoria Dzieciol '23.

PHOTOGRAPHY STAFF

Editor: Kevin Ly '22; **Associate Editor:** Maxwell Yun '21, Cady Boronkay '24; **Staff:** Kidist Adamu '22, Katya Bezugla '22, Sophia Fang '22, Shinjini Ghosh '22, Assel Ismoldayeva '22, Alex Li '22, Stephany Pang '22, Kevin S. Chen '23, Maximo Machado '23, Zoe Pasetsky '24.

COPY STAFF

Copy Chief: Laura Schmidt-Hong '23; **Associate Copy Chiefs:** Kendall Yu '21, Caitlin Fukumoto '24; **Staff:** Yaseen Alkhafaji '21, Talia Blum '21, Ayomikun Ayodeji '22, Pranit Nanda '22, Clinton Reid '22, Sophia Zhi '22, Stuti Khandwala '23, Michael V. Bhopaul '24, Joseph Li '24, Denzel Segbefia '24, Alicia Yang '24, Sarah Zhao '24.

BUSINESS STAFF

Advertising Manager: Steven Ngo '22; **Operations Manager:** Caroline Bao '23; **Staff:** Asia Hypsher '21, Tafsia Shikdar '21, Leon Yu '21, Alvin Zhu '21, Pranit Nanda '22, Amber Liu '23, Irene Terpstra '23, Jamil Dellawar '24.

TECHNOLOGY STAFF

Director: Ben Kettle '22.

ADVISORY BOARD

Paul E. Schindler, Jr. '74, Barry S. Surman '84, Deborah A. Levinson '91, Karen Kaplan '93, Saul Blumenthal '98, Frank Dabek '00, Satwiksai Seshasai '01, Daniel Ryan Bersak '02, Eric J. Cholaneril '02, Nathan Collins SM '03, Tiffany Dohzen '06, Beckett W. Sterner '06, Marissa Vogt '06, Andrew T. Lukmann '07, Zachary Ozer '07, Austin Chu '08, Michael McGraw-Herdeg '08, Marie Y. Thibault '08, Ricardo Ramirez '09, Nick Semenkovich '09, Angeline Wang '09, Quentin Smith '10, Jeff Guo '11, Joseph Maurer '12, Ethan A. Solomon '12, Connor Kirschbaum '13, Jessica J. Pourian '13, Aislyn Schalck '13, Anne Cai '14, Jessica L. Wass '14, Bruno Faviero '15, Kali Xu '15, Leon Lin '16, Kath Xu '16, Anthony Yu '16, Colleen Madlinger '17, Lenny Martinez Dominguez '17, Charlie J. Moore '17, William Navarre '17, Katherine Nazemi '17, Emma Bingham '19, Vivian Zhong '19, Ivy Li '20, Josephine Yu '20, B.D. Colen.

EDITORS AT LARGE

Contributing Editor: Jack Dinsmore '22; **Senior Editors:** Nafisa Syed G, Áron Ricardo Perez-Lopez '20, Ivana Alardín '21, Adira Balzac '21, Lior Hirschfeld '21, Nathan Liang '21, Ethan Sit '21, Thomas Wang '21.

PRODUCTION STAFF FOR THIS ISSUE

Editors: Arun Wongprommoon '23, William Xu '24; **Copy Editors:** Laura Schmidt-Hong '23, Kendall Yu '21, Caitlin Fukumoto '24.

The Tech (ISSN 0148-9607) is published on Thursdays during the academic year (except during MIT vacations) and monthly during the summer by The Tech, Room W20-483, 84 Massachusetts Avenue, Cambridge, Mass. 02139. Subscriptions are \$50.00 per year (third class). **POSTMASTER:** Please send all address changes to our mailing address: The Tech, P.O. Box 397029, Cambridge, Mass. 02139-7029. **TELEPHONE:** Editorial: (617) 253-1541. Business: (617) 258-8324. Facsimile: (617) 258-8226. *Advertising, subscription, and typesetting rates available.* Entire contents © 2020 **The Tech**. Printed by Graphic Developments, Inc.

WEATHER

Remnants of Ida dump rain on orientation

By Phoebe Lin
STAFF METEOROLOGIST

Flash flood watches and wind advisories are again in place for much of the Northwest. Up to 3-5 inches of rain are possible starting at midnight on Thursday, and with the ground saturated with rain from recent hurricane Henri, flash flooding will be much more likely. Watch out on your morning commutes, and stay indoors for orientation events if possible! In addition, large gusts are expect-

ed to bring power outages to New England. After a couple days, we can expect the sun to clear things up a bit.

As Hurricane Ida has come barrelling through Louisiana, millions are without power and evacuation orders are still in place. It's been quite the hurricane season, and we must be prepared for additional storms to come-the hurricane season isn't over yet. As the gray clouds continue rolling in, though, we can warily look forward to the sunnier days ahead.

Extended Forecast

Today: Heavy rain and breezy. High around 70°F (21°C). North winds 16-22 mph, up to 34 mph.
Tonight: A slight chance of showers, then partly cloudy. Low around 57°F (14°C). Winds in the northwest, up to 9 mph.
Tomorrow: Mostly sunny and clear. High around 70°F (21°C) and low around 58°F (14°C). Winds in the northwest, around 7-10 mph.
Saturday: Sunny and then partly cloudy. High around 74°F (23°C) and low around 59°F (15°C). Northwest winds 7-9 mph, turning south in the evening.
Sunday: Chance showers and partly cloudy. High around 74°F (23°C) and low around 65°F (18°C). Winds in the south, 6-10 mph.

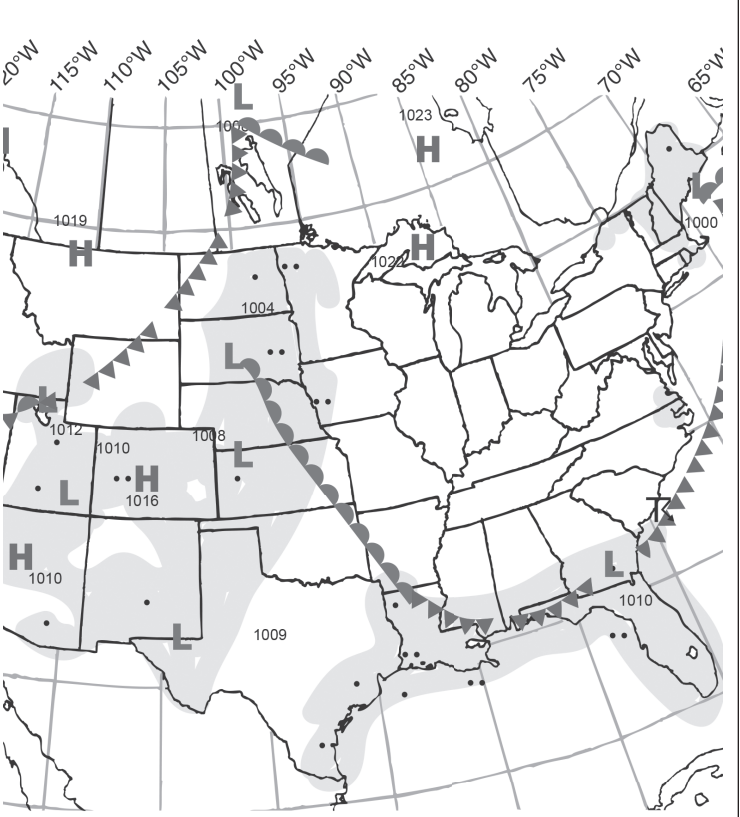

Situation for Noon Eastern Time, Thursday, September 2, 2021

Weather Systems	Weather Fronts	Precipitation Symbols		Other Symbols
H High Pressure	- - - Trough	Snow *	Rain ▽	☁ Fog
L Low Pressure	⌒ Warm Front	Light *	Light ▽	⚡ Thunderstorm
§ Hurricane	⌒ Cold Front	Moderate **	Moderate ▽	∞ Haze
	⌒ Stationary Front	Heavy ***	Heavy ▽	

Compiled by MIT Meteorology Staff and The Tech

Capture the Moment

Join Photo at The Tech

join@tech.mit.edu



HELLO!
WE MAKE *THE TECH*, MIT'S
STUDENT NEWSPAPER!

If you like writing, graphic design,
photography, business, technology,
(or pretty much anything else)

**there's a place
for you here!**

**NO EXPERIENCE
NECESSARY!**

**So if you think you might
be interested**, or even if
you just want to see what we
do, **join us for dinner** in our
office on the fourth floor of the
Student Center (**W20-483**) on
Sundays at 6 pm, or email us at
join@tech.mit.edu

ROW FOR MIT

No Experience Necessary; Only Drive & Desire Required



Startup Events @ Pierce Boathouse

Boathouse Barbeque

All Welcome

Thursday 9/2 @ 4:00pm

Informational Meeting

Required for those interested in trying out

Wednesday 9/8 @ 5:30pm

Or Email: novicecrew@mit.edu for more info





The Mind and Hand Book is the official guide to MIT's expectations of all undergraduate and graduate students, including the policies on academic integrity, alcohol, drugs, hazing, and sexual misconduct.

2021-2022 MIND & HAND BOOK



handbook.mit.edu



Solution, page 8

Instructions: Fill in the grid so that each column and row contains exactly one of each of the numbers 1–6. Follow the mathematical operations for each box.

Solution, page 8

Instructions: Fill in the grid so that each column, row, and 3 by 3 grid contains exactly one of each of the digits 1 through 9.

Solution, page 8

1 Secret agents
6 Keogh plan alternatives
10 Scandinavian capital
14 Of ocean motions
15 Small snack
16 On the summit of
17 Gig for a tenor
18 Bar assoc. member
19 Very funny person
20 Employee's free-food perk
23 CBS police franchise
24 Phone trio before Q was added
25 Beethoven's "Minuet ____"
26 Suffix for language names
27 Boyfriend of Barbie
28 Freeze, as a windshield
30 Frozen dessert chain
32 Dressed (in)
35 Campus teacher, for short
37 ____ Day (tree-planting time)
40 Ambassador's sealed mailbag
43 Scatter about
44 Temporary period of calm

DOWN

- 1 Step heavily (on)
- 2 Hamelin's rat remover
- 3 Concepts
- 4 Husband of a countess
- 5 Language family of Czech

and Polish
6 Presidential swearing-in
7 Coll. military program
8 __ crow flies (in a straight
line)
9 Most timid
10 Rower's implement
11 Breakfast sweet with nuts
12 Not at all tight
13 Choose to participate
21 Early afternoon hour
22 Newscast summary
28 Lazy person
29 Top DC VIP
31 Small stream
32 Some S&L accounts
33 Ignited
34 Day-after-March shout
36 Composer's cinematic
work
38 Autumn mo.
39 Greek letter after pi
41 Indebted (to)
42 What dresses are made of
47 Mexican shawl
49 Pantry, for instance

50 Seat for a parakeet	57 Be
51 Hawaiian greeting	60 Web surfer
53 "Apartment available" sign	61 Nonspeaking street performer
55 Arrested	
56 Give a formal speech	63 An hour after 21 Down



When you join Campus Life at *The Tech* and get to publish your secret diary



join@tech.mit.edu

Solution to Rush
from page 6

3	6	1	2	4	5
1	4	5	6	2	3
6	3	4	5	1	2
2	5	6	1	3	4
4	1	2	3	5	6
5	2	3	4	6	1

Solution to Recruitment
from page 6

3	1	2	5	4	6	8	7	9
6	9	4	8	7	2	3	1	5
8	5	7	3	9	1	6	2	4
2	3	6	9	1	5	7	4	8
1	7	5	6	8	4	9	3	2
9	4	8	7	2	3	1	5	6
5	8	3	4	6	7	2	9	1
7	2	9	1	5	8	4	6	3
4	6	1	2	3	9	5	8	7

Solution to FSILG
from page 7

4	5	2	1	9	3	7	8	6
2	3	9	8	7	1	5	6	4
6	7	4	3	2	5	9	1	8
5	6	3	2	1	4	8	9	7
9	1	7	6	5	8	3	4	2
1	2	8	7	6	9	4	5	3
7	8	5	4	3	6	1	2	9
8	9	6	5	4	7	2	3	1
3	4	1	9	8	2	6	7	5

Solution to This Won't
from page 6

SPIES	IRAS	OSLO	
TIDAL	NOSH	ATOP	
OPERA	ATTY	RIOT	
MEAL	VOUCHER	CSI	
PRS	ING	ESE	KEN
	ICEUP	TCBY	
CLAD	PROF	ARBOR	
DIPLO	MATIC	POUCH	
STREW	LULL	ONTO	
IRIS	SMOCK		
PAL	NET	STL	ROE
ELF	GROUCH	OMARX	
ROOT	ALSO	SINAI	
CHOW	PEER	EMITS	
HALO	ETRE	TENET	

Wanna make columns?

Not an architect?

Join
Campus Life
at *The Tech*!

join@tech.mit.edu

Hayden
Library

Now open
14S-100

Come see the newly renovated Hayden.
Stop by Sept. 7-10,
9am-5pm, for special giveaways!