



Ryan Rutledge Invitational at Reynolds February 14, 2026

I am honored to extend an invitation for the fourth year to the **Ryan Rutledge Invitational at Reynolds**. Fingers crossed for good weather this year!

The team has previously donated \$1,500 of tournament proceeds in the name of a tragically lost team member. See the photo above of the tribute tag mounted on the Oregon Humane Society's wall. Thank you for helping us make this contribution.

We are offering all Oregon speech and debate events in both the novice and open divisions and will run them all if numbers allow. See OSAA state rules, all events and limits below, and postings on Tabroom.com.

Pattern A: CX, LD, Public Forum, Parli, Big Questions (BQ)

No double entry permitted in Debate events. CX participants may not participate in Extemp (other IEs only at their own risk).

Pattern B: ADS, DI, Duo, Extemp, HI, Impromptu, Inform, LIELL, Oratory, Poetry, Prose, POI, Radio

Double entry is permitted in IE events. Extemp participants may not participate in CX debate nor other IEs.

Pattern C: Student Congress

Participants may not participate in other patterns.

Send legislation to kristine_igawa@beaverton.k12.or.us or vschiller@rsd7.net by Friday, February 6 at 8:00pm.

Limits: Students may compete in two individual events and one debate event. Each school is limited to 5 students per IE speaking event and 5 entries per debate event.

Deadlines: Initial registration is due **Tuesday, February 10 at 8:00pm**. Drops can be made until **5:00pm on Thursday, February 12**, when fees will freeze.

Payment: Please pay at the tournament or ASAP afterward. Thank you!

Topics:

We will use the February topic for LD (NO NOVICE TOPIC):

Resolved: The possession of nuclear weapons is immoral.

We will use the February topic for Public Forum:

Resolved: The Federal Trade Commission should establish a federal regulatory framework for sports betting.

CX will use the current year's topic (novice case limits apply):

Resolved: The United States federal government should significantly increase its exploration and/or development of the Arctic.

Big Questions (BQ) Debate will use the current year's topic:

Resolved: Moral systems rooted in theism are preferable to non-theistic moral systems.

Parli debate will be a mix of policy, value, and philosophical topics.

Awards: We will give awards to 1st, 2nd, and 3rd place speakers in each IE event and division and to finalists and semifinalists in each debate event and division. Finalists will receive an award. If an event collapses, novice finishers are recognized.

ALTERNATE QUALIFICATIONS:

à If at least 15 high schools attend our tournament, one leg for proven excellence would be demonstrated if in an open division event with 15 or more competitors a student earns 1st, 2nd, or 3rd in speech or reaches the semifinal round of debate.

à If at least 30 high schools attend our tournament, one leg for proven excellence would be demonstrated if in an open division event with 48 or more competitors reach quarterfinals in debate or finals in speech in the open division.

Fees: Please email vschiller@rsd7.net if fees prevent your team from participation.

\$25.00 per school registration fee

\$15.00 per debate entry (including LD and Congress, excluding BQ)

\$10.00 per individual event (including Duo and BQ)

Judging:

- Ⓟ One judge covers 5 entries, whether speech or debate. Each uncovered entry is charged \$30.00. However, a team may be denied entry without coverage.
- Ⓟ Judges are to be available the entire day or until excused. A ½ day judge should have another ½ day judge to cover the full day of the tournament.
- Ⓟ **If your head coach will not be present, indicate your adult in charge. Each school must have a responsible adult present the entire tournament.**
- Ⓟ Please advise students to adapt their speaking style to newer judges.

Food:

Coaches and judges are welcome to breakfast, lunch, and snack items throughout the day in the judges' lounge. Reynolds students will be selling small concessions: hot chocolate, granola bars, cups of noodles, pizza, and water. Cash and cards accepted.

Valerie Schiller

503-667-3186 x 1347 – school

503-380-1672 – cell

vschiller@rsd7.net

Reynolds High School, 1698 SW Cherry Park Rd, Troutdale, Oregon 97060

Reynolds Invitational Tournament Schedule Saturday, Feb. 14, 2026:

Congress Schedule

9:00 - 9:30 am: Setting the docket
10:00 - 12:00 pm: Session 1
2:30 - 4:30 pm: Session 2

7:00-7:30 am
7:30 am
8:00 - 9:30 am
9:30 - 11:00 am
11:00 - 12:30 pm
12:30 - 2:00 pm
2:00 - 3:30 pm
3:30 - 5:00 pm
5:00 - 6:30 pm
6:30 - 8:00 pm
8:00 pm

Registration
Basic judge training in the judge's lounge
Pattern A Round 1
Pattern B Round 1 - Extemp draw at 9:15 am
Pattern A Round 2
Pattern B Round 2 - Extemp draw at 12:15 pm
Pattern A round 3
Pattern B Round 3 - Extemp draw at 3:30 pm
(Semi-) Finals Pattern A
Finals Pattern B
Awards in Commons

All postings are on Tabroom.com.

Pattern A: CX, LD, Public Forum, Parli, BQ

**Pattern B: ADS, DI, Duo, Extemp, HI,
Impromptu, Inform, LIELL, Oratory, Poetry,
Prose, POI, Radio**

Pattern C: Student Congress

Extemp Prep: Room 200

Student Congress: Room 210

Judges Lounge: Library

Student Hangout: Commons

TAB Room: Staff Lounge

Bathrooms are located in the Commons, by the MPR, and in the 100-, 200-, 500-, and 700- hallways. (See attached map.)

Locked doors or missing judges? Please call or text 503-380-1672.



**NEW QR
code
coming
soon!**



**CHECK OUT OUR
SCHOOL MAP**

Cherry Park Road

Vehicle Entrance



MAIN
PARKING
LOT

Main Entrance

FRONT
DOORS

check in

COMMONS:
Student Hangout

JUDGE
LOUNGE

MPR Entrance

GYM

257th
Avenue

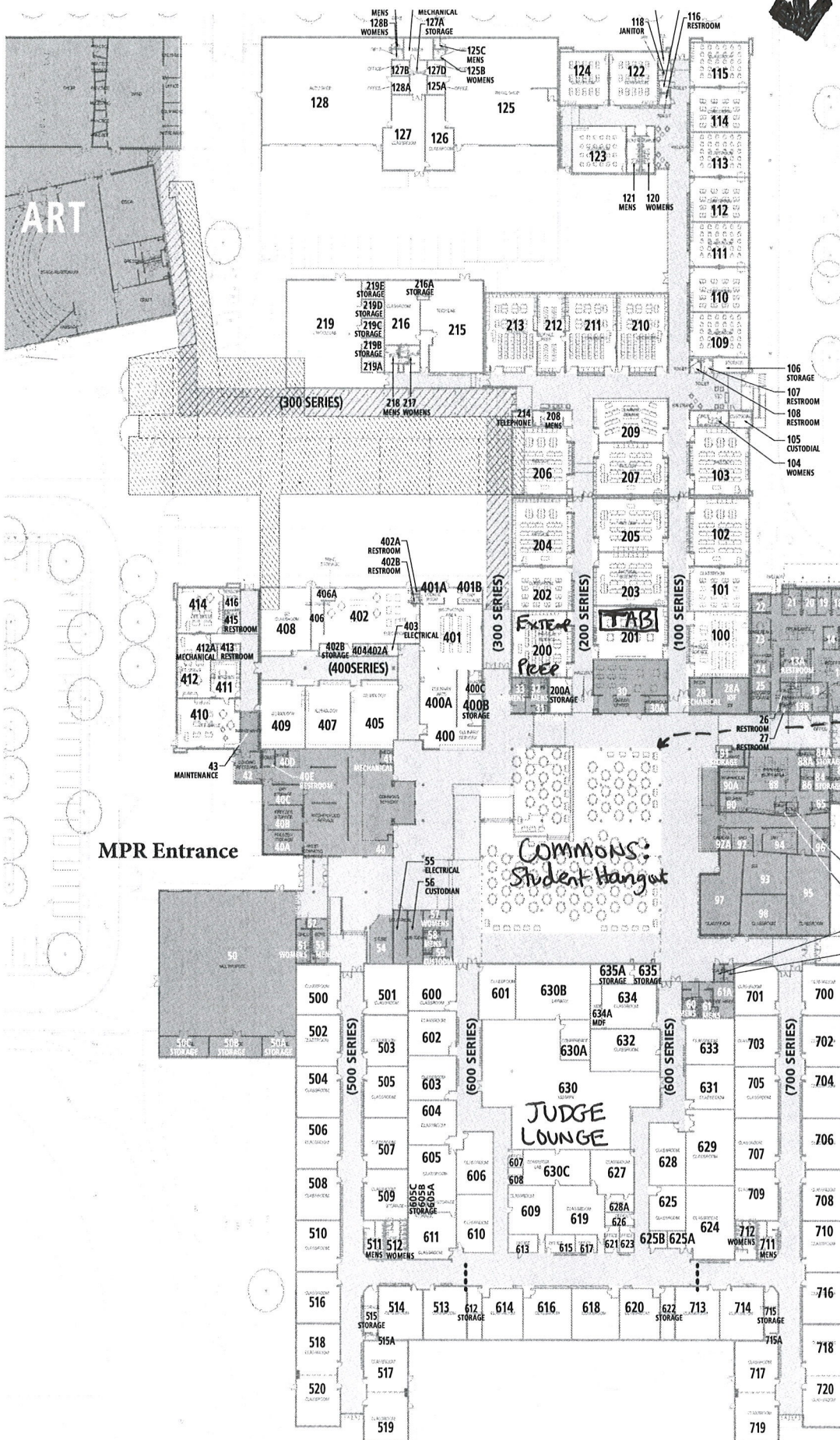

Reynolds High School Campus