



Total Blender™

Owner's Manual and User Guide



totalblender



TABLE OF CONTENTS

SECTION	PAGE #
SECTION 1: IMPORTANT SAFEGUARDS	4
SECTION 2: UNPACKING	6
SECTION 3: TOTAL BLENDER OVERVIEW	7
SECTION 4: INSTALLATION	7
SECTION 5: CARE AND CLEANING	7
SECTION 6: OPERATIONAL OVERVIEW	9
SECTION 7: TROUBLESHOOTING	14
SECTION 8: WARRANTY	16

SECTION 1

IMPORTANT INFORMATION

Read all instructions carefully before using your Total Blender™

1.1 SAFETY CERTIFICATION

The Total Blender is certified by ETL (Report No. 3018204-4, 3018204-2 & 3018204-3) to comply with UL standard 982 4th ed. 11-29-2001, and to CSA standard C22.2 No. 195-m 1987, Nov. 1990, R 1994



1.2 TOTAL BLENDER CERTIFICATION

The Total Blender and its accessories are certified by NSF International (NSF) under Blendtec in the NSF Official Listing.

1.3 AVOID CONTACT WITH MOVING PARTS

- Keep fingers, hands, hair and clothing away from all moving parts.
- Keep all utensils away from the drive socket and blender jar blades during operation. Metal utensils may damage blades.
- **NEVER** put hands into the blender jar or add substances by hand when the blender jar is on the motor base.
- **NEVER** touch the blade with your fingers whether it is on or off the motor base.
- **NEVER** place jar into drive socket if blender motor is operating.
- DO NOT rock the blender jar during operation.

These precautions will prevent personal injury and/or damage to the blender.

1.4 NEVER OPERATE THE BLENDER IF IT APPEARS DAMAGED

If the blender malfunctions call your service agent first. If it is dropped or damaged in any way, return the blender to a Blendtec service agent immediately for examination, repair, electrical or mechanical adjustment, or possible replacement.

1.5 NEVER OPERATE BLENDER IN LIQUID

To protect against the risk of electrical shock do not put the motor base in water or other liquid. Do not use the blender outdoors where it is subject to precipitation.

1.6 NEVER PUT NON-FOOD ITEMS INTO JAR

Metal utensils, rocks, and glass are dangerous if placed in jar. Damage caused by such foreign objects will void the warranty. Keep hands and utensils out of jar while blending to reduce the risk of severe injury to persons or damage to the blender. Utensils may only be used when the blender is not running.

1.7 NEVER OPERATE THE BLENDER WITHOUT THE LID IN PLACE

1.8 NEVER OPERATE THE BLENDER USING ATTACHMENTS NOT SOLD BY BLENDTEC

The use of any unauthorized attachments may cause fire, electric shock, and/or injury and will void the warranty.

1.9 CONTAINER MUST BE PROPERLY IN PLACE WHILE APPLIANCE IS OPERATING

1.10 BLADES ARE SHARP! HANDLE CAREFULLY!

1.11 WHEN BLENDING HOT LIQUIDS, THE VENTED LID WILL ALLOW PRESSURE RELIEF. BE CAREFUL NOT TO COME IN CONTACT WITH ANY STEAM COMING FROM THE CLEAR CENTER LID.

1.12 POWER CORD PRECAUTIONS

- NEVER operate with a damaged cord or plug. (If the supply cord is damaged it must be replaced by the manufacturer or authorized service agent to avoid a hazard.)
- DO NOT permit the cord to hang over the edge of the work surface.
- NEVER use an extension cord with the unit.
- Unplug the blender motor when not in use, before changing blender locations, or cleaning.

1.13 NEVER ATTEMPT TO REPAIR THE POWER UNIT

Never remove the blender motor cover. The blender motor does not contain self-adjustable or serviceable parts. A qualified service agent must make all service adjustments. Removing the cover or attempting to service the blender will void the warranty.

1.14 TURN THE POWER SWITCH OFF WHEN NOT IN USE

The Power Switch (ON/OFF switch) is located on the back of the blender motor cover.

1.15 AVOID TOUCHING THE BLENDER DRIVE SOCKET AFTER EXTENSIVE USE

The blender drive socket may become hot after numerous cycles.

1.16 CLOSE SUPERVISION IS NECESSARY WHEN APPLIANCE IS USED BY OR NEAR CHILDREN AND PERSONS WITH REDUCED CAPABILITIES. Further, children and persons with reduced capabilities should not play with the appliance at any time.

1.17 THE TOTAL BLENDER IS INTENDED FOR HOME USE ONLY! ANY USE OF THE TOTAL BLENDER™ FOR COMMERCIAL PURPOSES VOIDS ALL WARRANTIES.

SAVE THESE INSTRUCTIONS

SECTION 2 - UNPACKING

SAVE ALL PACKAGING MATERIALS AND INSTRUCTIONS FOR FUTURE USE

2.1 UNPACKING YOUR BLENDER

You should have received the following items:

- TOTAL BLENDER™ motor base
 - Blender jar with lid
 - Recipe book
1. Remove blender motor, blender jar, and lid from packaging.
 2. Unwind the power cord.
 3. Check for any packing material that may have blocked ventilation holes in the blender motor.
 4. Inspect all items to ensure no damage occurred in shipment.
 5. If any damage has occurred contact your Blendtec service agent immediately.

2.2 RECORDING YOUR SERIAL NUMBER AND DATE OF PURCHASE

Record your blender motor serial number and date of purchase in the space below. You will need these when contacting Blendtec for service or questions.

Motor Serial #: (Found on bottom of motor base)
Date of Purchase:
Purchased From:

2.3 REGISTRATION OF YOUR BLENDER

Register online at www.blendtec.com (select “Product Registration” under the ‘Service’ button) or return the registration card to the address provided.

SECTION 3 - BLENDER OVERVIEW

(Refer to Figures 1 and 2)

3.1 BLENDER MOTOR

- Touch Pad: Consists of nine buttons that contain pre-programmed settings for selective blender control, a pulse button, and two speed control buttons.
- Blender Drive Socket: This is where the jar couples with the motor to turn the blade assembly.
- LCD Information Center: Indicates status of unit as well as overload or over-temperature conditions.
- Power Unit: This unit is located with the blender motor and contains the machinery that runs the blender.

3.2 BLENDER JAR ASSEMBLY

The blender jar assembly consists of the blender jar, blade assembly, and lid.

- Jar: Made from a tough durable material to provide maximum efficiency and clear visibility of blender performance.
- Lid: Flexible rubber lid seals liquids within the jar during blending.
- Blade Assembly: Stainless steel designed to provide fast, consistent blending.
- Power Switch: Located on the back lower-right corner of the motor base cover.
- Power Cord: Located at the back of the motor base cover.
- Motor Base Cover: Houses the power unit in a durable, easy-to-clean polycarbonate.

NOTE: Filling the blender jar beyond the marked capacity is not recommended.

SECTION 4 - INSTALLATION

1. Place blender on a flat, clean, and dry surface.
2. Make sure a plug outlet is available within four feet of the blender motor.
3. Ensure the unit is turned off before plugging it into a separate 120-volt receptacle.
4. Ensure that blender vents are unobstructed to allow proper cooling during use.

We recommend that surge protection be placed between the receptacle and the blender motor.

SECTION 5 - CARE AND CLEANING

5.1 AFTER USE CLEANING

1. Add 1 cup of hot water and a drop of liquid dishwashing soap to the blender jar.
2. Place the lid tightly onto the jar. Place the blender jar on the blender base and, with your hand placed on top of the lid, press the pulse button for 5 seconds.

Figure 1 Front View
MOTOR BASE

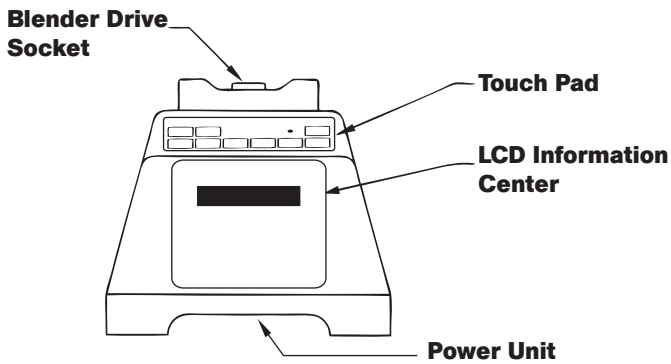
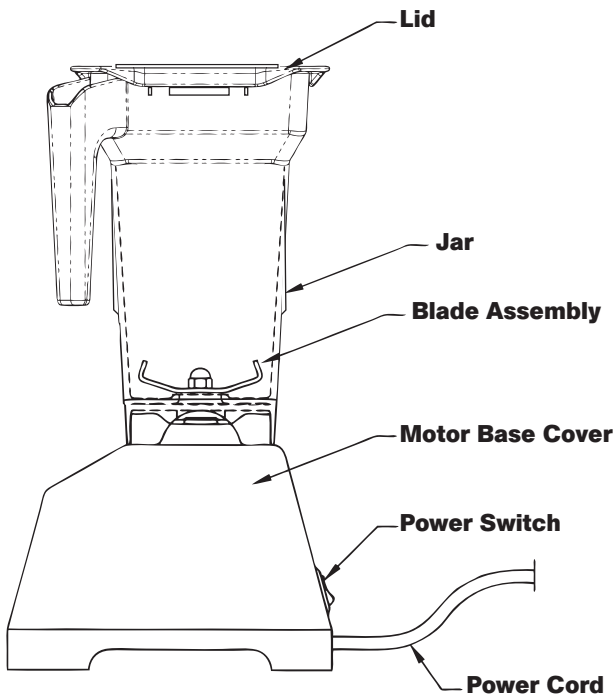

Figure 2 Side View
MOTOR BASE AND JAR ASSEMBLY



3. Rinse with clear water until all soap is rinsed from jar and lid.
4. Clean the blender base by simply wiping the base and touchpad with a damp cloth and water.

5.2 LONG-TERM SANITATION

1. For long-term sanitation, occasionally fill the blender jar half way with hot water.
2. Add one teaspoon of liquid chlorine bleach.
3. Stir for 10 seconds to mix water and bleach. Let mixture stand in blender jar for five minutes.
4. Empty water/bleach mixture and rinse the jar thoroughly to ensure that there is no bleach mixture left in the jar. Turn jar up side down on dish rack until dry.

5.3 CLEANING TIPS AND CAUTIONS

- Do not use abrasives or stiff brushes to clean the blender base or jar as this will dull or scratch the surface. Cosmetic damage is not covered by warranty.
- NEVER submerge the blender motor in water. Avoid submerging blender jars for more than 5 minutes. Water penetration through the lower jar seals will reduce the life of the jar. After cleaning, we recommend the blender jar be stored up-right.
- BLENDER JAR IS DISHWASHER SAFE—TOP RACK ONLY! Extreme temperatures damage the lower seal to the jar.

SECTION 6 OPERATIONAL OVERVIEW

6.1 MAIN POINTS OF OPERATION

1. Turn on the main power switch located on the back of the blender motor base in the lower right corner.
2. Place the blender jar on the base, making sure the jar is secure. Attach the blender lid.
3. Press the desired touch pad button once. You may press any button on the lower row to stop the cycle.
4. When cycle is complete, remove the blender jar and serve.

6.2 AUTOMATIC CYCLE OPERATION

The Blendtec Total Blender has automatic blending cycles for ice cream, frozen yogurt, ice crushing, milkshakes, soups, syrups, fondues, sauces, dips, dressings, batters, whole juice, and smoothies. These cycles have variable speed settings that will change during the course of the cycle. This allows the blender to draw the contents into the blending vortex, which creates the desired texture. The blender will run its pre-programmed cycle and automatically shut off. If at any point you want to stop the blender before it has completed its cycle press any lower row button.

6.3 BLEND CYCLES

The 6 pre-programmed blend cycles on your Total Blender have been carefully designed to produce optimum results for a range of blending tasks. The recipe book included with your machine will refer to a specific button to use, depending on what is being made. Feel free to experiment and try different cycles with your own recipes.

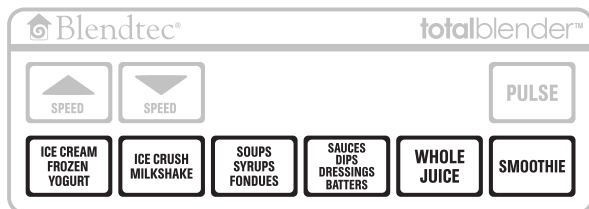

The 6 following charts correspond to the 6 buttons above on the touch pad. The Charts will show the speeds and duration of time which make up each pre-programmed blend cycle. This may be helpful to you in understanding what the Total Blender is doing when a specific cycle button is pushed.

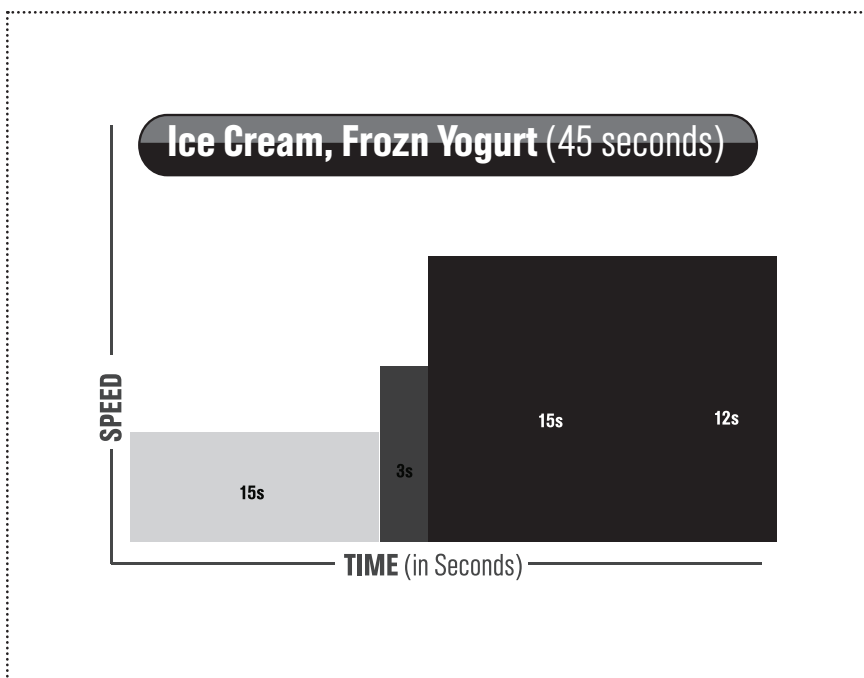

Ice Crush, Milkshake (35 seconds)

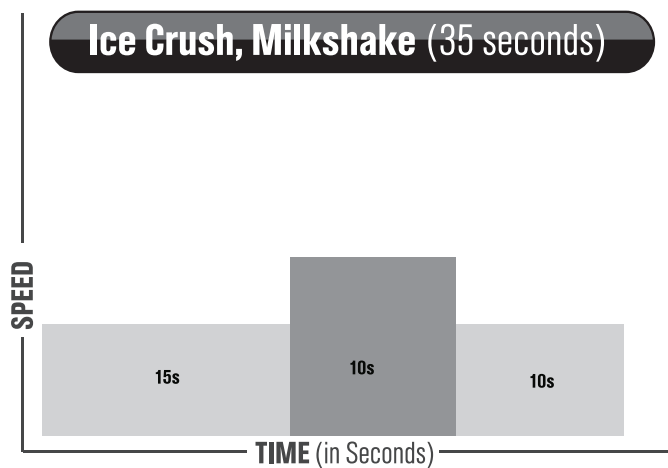

Soups, Syrups, Fondues (90 seconds)

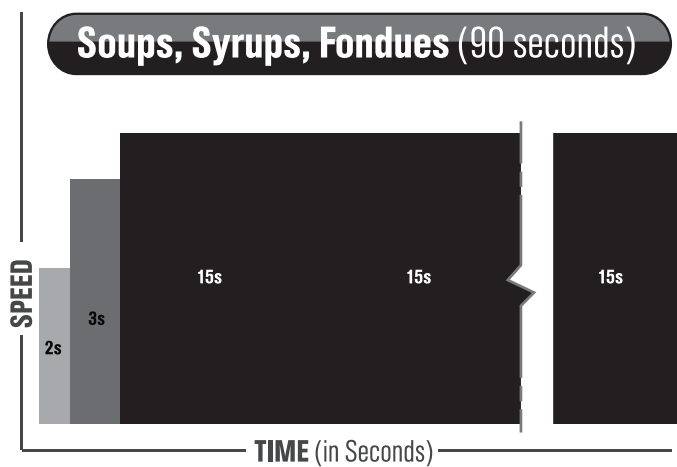

Sauces, Dips, Dressings, Batters (23 sec)

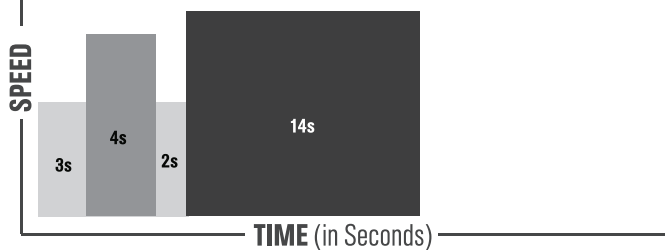

Whole Juice (50 seconds)

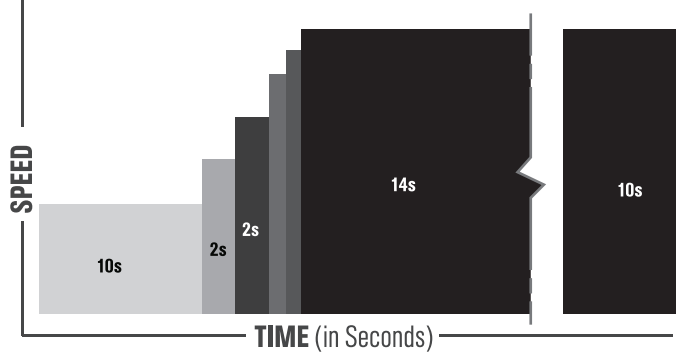

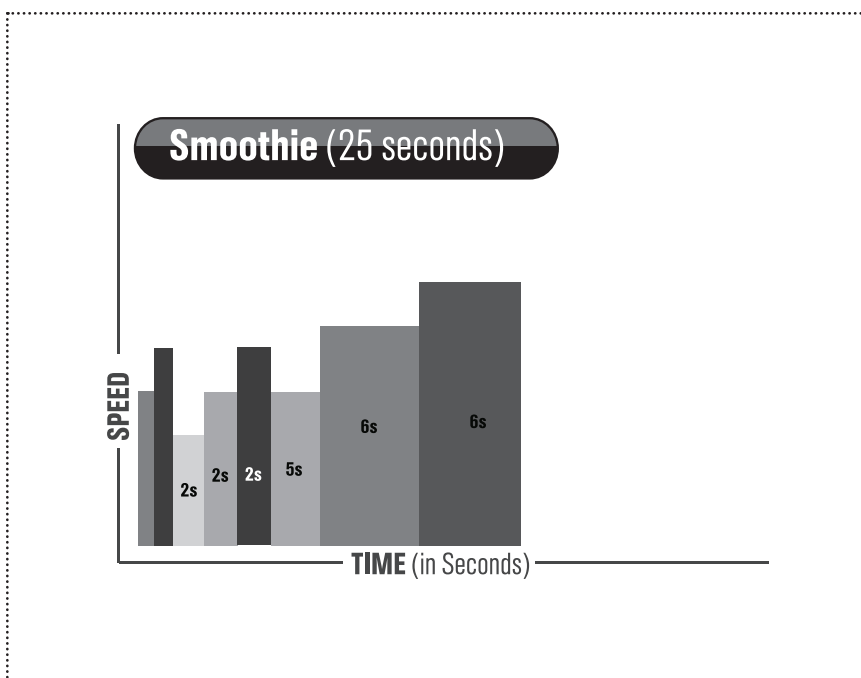

Why blend cycles?

In the world of professional blending, there are many factors which go into making a delicious and consistent blended product. It is from that world of professional results that the Total Blender derives its heritage. In order to blend many different things consistently well, Blendtec developed blend cycles to match the blending needs of the type of product being made.

Because different ingredients have different blending characteristics, each ingredient needs to be considered. Some things which are thicker or more fibrous will take longer to blend and need to be blended at higher speeds. For instance, think of the difference in thickness between strawberry juice, strawberry syrup, and a strawberry puree with lots of pulp and seeds. The first two will be on the thinner side, the puree on the thicker side. Now play the same game with fruits having more fiber such as pineapple or mango. You can see that different types of products (juice, syrup, puree) and different flavors (e.g., apple, mango) have different levels of thickness and fiber; the thicker the ingredients, the tougher the blend!

This is why you will hear the blender speeding up and slowing down at different times throughout the various blend cycles. Based on the type of foods the blend cycle is designed to handle, it will blend at higher or lower speeds for different lengths of time in order to produce the most consistent results.

The Total Blender was designed with many different food items in mind and blend cycles make it produce consistent results across a wider range of food items than any other home blender. However, things like the temperature of ice and the amount of

liquid in the various foods used in a recipe will create different blending characteristics.

The Total Blender recipe book is designed for an overall average in terms of ice temperature and the amount of liquid typically contained in various fruits and vegetables. Your experience may be different depending on local conditions and you may need to adjust certain recipes to have more or less ice, and higher or lower portions of fruits and vegetables or other ingredients. For example, if a drink is too thick to blend adequately, try reducing the ice a little and replacing the ice with a little water or other liquid. You will be amazed at the difference in blendability.

Whatever your experience with ingredients, the Total Blender will blend things faster and more easily than other blenders because of its unique combination of high speed motor, patented square jar, single prong wingtip blade, direct drive coupling, and computer controlled blend cycles.

6.4 MANUAL OPERATION

The speed buttons allow you to manually control the blender and choose any of the available 10 speed settings. Simply press the Speed Up button and the motor will begin. Continue pressing the Speed Up key to increase the speed, or press the Speed Down key at any time to decrease speed. After you have reached the desired speed release the button. Once you press a speed button, the blender will begin to run at the selected speed, and then shut off automatically after 50 seconds. To stop the cycle before the 50 seconds, press any button on the lower row.

The Pulse button is used when you want to chop, mince, whip, or do other momentary tasks which do not require a long blend cycle. When the Pulse button is pushed the motor will run only as long as the button is held down. As soon as the button is released the motor will shut off.

SECTION 7 - TROUBLESHOOTING

7.1 BLENDER MOTOR WILL NOT TURN ON

If the blender motor will not turn on, try the following:

- Make sure the main power switch on the back lower-right corner is turned ON.
- Check your house circuit breaker switch or fuse to make sure it is set to the ON position.
- Unplug the power cord from the wall receptacle, wait 5 seconds, then plug power cord back in.
- Determine if the Liquid Crystal Display (LCD) is lit. An absence of a lit LCD indicates a lack of power to the unit.
- Remove the blender jar from the blender motor and check to make sure the blade turns freely while unattached to the motor. If the blade does not move freely the problem may be the jar, not the motor. Check the jar by turning the shaft by hand to see if it rotates easily.

Look at the LCD:

- A reading of "OVERTEMP" indicates that the motor is overheating. The blender has been disabled until the unit cools to operating temperatures. Turn off and unplug the unit. Allow it to cool for at least 20 minutes.
- A reading of "OVERLOAD" indicates an overload on the motor. Turn off and unplug the unit. Check the blender jar for blockage and clear if necessary. Plug in the unit and turn the blender on again to clear the overload condition. If overload condition re-occurs, contact your Blendtec service agent.
- **BLADE STOPS:** If the overload condition stops the blender, remove the blender jar and carefully check for blockage of the blade. If no blockage is found, replace jar and use the Pulse button on the touch pad to quickly pulse the blade through the mixture. Once the blade spins freely a programmed button may be used.

7.2 NOISE LEVEL CHANGES

If the blender noise level has increased significantly from original levels, determine whether the sound is coming from the blender motor or jar.

- **Blender Motor:** Check to see if the excess noise is coming from the blender base. Remove the jar and press cycle number two or three. Listen to the motor sound without a jar attached. If it is excessively noisy contact your Blendtec service center.
- **Jar:** Check to see if the excess noise is coming from the jar. Place the jar back on the motor. Run the motor for a few seconds using the Pulse button. If you have more than one jar, test a different jar to determine whether the sound changes as different jars are used. If a jar is excessively noisy, or if the blade assembly seems loose or sounds "gravelly" when turned by hand, contact your Blendtec service center.

7.3 BLENDED TEXTURE UNSATISFACTORY

If the blended texture of product is lumpy or uneven, do the following:

- Ensure the mixture is not cavitating during the cycle. Cavitation is a condition in which the blender blade spins freely in an air pocket within the drink mix because the mix is too cold or too solid. This problem can be corrected by increasing the mix temperature by reducing ice, increasing liquid and/or ensuring that the frozen ingredients used in the recipe are never colder than 10 degrees Fahrenheit (-12 degrees Celsius).
- Increase cycle time. If the drink is mixing well but has not had enough time for complete blending, try a longer cycle or touch and hold the "Pulse" button for required extra blending time.
- **TRIED EVERYTHING?** If none of the preceding suggestions work, contact your Blendtec service agent for further assistance.

INSTRUCTIONS THAT APPEAR IN THIS USER GUIDE ARE NOT MEANT TO COVER EVERY POSSIBLE CONDITION OR SITUATION THAT MAY OCCUR. GOOD JUDGMENT MUST BE USED WHEN OPERATING THIS OR ANY OTHER MACHINERY.

SECTION 8 - WARRANTY

WARRANTY DESCRIPTION (US Domestic and Canada)

Your Blendtec Total Blender motor is warranted for 3 years. The jar assembly, including all moving jar parts, is covered against leaking or breakage for 3 years. Warranties begin from date of purchase.

Cosmetic damage, product abuse, unreasonable use, damage resulting from an accident, product tampering, servicing performed or attempted by unauthorized service agencies, units that have modifications, or have been or used for commercial purposes are not included under this warranty.

The quality of Blendtec blenders is unsurpassed. You will enjoy years of wonderful and reliable service from your Blendtec Total Blender.

THIS WARRANTY APPLIES ONLY TO PRODUCTS SOLD BY BLENDTEC OR ITS AUTHORIZED DEALERS

Limited Three-Year Warranty

Blendtec warrants the blender motor to be free of defect in material and workmanship for a period of three years. During this period, such defects will be repaired or the product replaced at Blendtec's discretion without charge. This warranty does not cover damage caused by misuse, accident, or negligence. All implied warranties, including but not limited to implied warranties of fitness and merchantability are limited in duration to a period of three years on motor and jar. Any unit submitted for repair must be accompanied by proof of original purchase and should be shipped prepaid to:

Blendtec
1206 South 1680 West
Orem, UT 84058
(800) 253-6383
(801) 222-0888

UNDER WARRANTY

1. Contact Blendtec immediately to diagnose the difficulty. Please have blender serial number ready as well as a description of the problem. Do not attempt to do your own repairs. Repairs made by persons other than Blendtec authorized service representatives will void the warranty. Many issues can be resolved simply and quickly over the phone.

2. If the difficulty cannot be resolved over the phone, your unit may require replacement. If blender is under warranty, Blendtec will repair or replace the unit at no cost. Cosmetic damage and abuse are not included.

3. Upon receiving instructions from Blendtec, box up your existing unit and enclose the following:

Your name:
Address:
Phone number:
The blender serial number: <small>(located on the bottom of the blender motor base)</small>
Cycle Count (from the LCD indicator):
Your purchase date:
Place of purchase:
An explanation of the problem:

OUT OF WARRANTY

1. Contact Blendtec to diagnose the difficulty. Please have the blender serial number ready along with a description of the problem. Do not attempt to do your own repairs. Many issues can be resolved simply and quickly over the phone.
2. If the blender is not under warranty and you wish to have it repaired, box up the blender motor and ship it to Blendtec and you will be billed for services rendered.
3. When you ship your unit please enclose the following:

Your name:
Address:
Phone number:
The blender serial number: <small>(located on the bottom of the blender base)</small>
Cycle Count (from the LCD indicator):
Your purchase date:
Place of purchase:
An explanation of the problem:

**FOR QUESTIONS REGARDING THIS WARRANTY
CONTACT CUSTOMER SERVICE AT
(800) 253-6383 OR (801) 222-0888.**

Products intended for sale in the United States and Canada are only covered by U.S. and Canadian warranty, repair policies, and procedures. Products used or sold outside the United States and Canada are subject to the applicable international warranty and service procedures.

**Using a machine outside the country it was
designed for will void the warranty.**





1206 South 1680 West
Orem, UT 84058
801-222-0888
blendtechome.com

©2007 K-TEC, Inc., All Rights Reserved Blendtec is a registered trademark of K-TEC, Inc.

OWN-RE-025 Manual, Total Blender v7 Aug 09