



4573 105 Chateau Boulevard (Pstall), Benchlands, Glacier Lodge

Status: **Sold** Built: Price: **\$22,000**
 Type: **Prk. Stall** List Co: **WREC** Size:
 L. Size: Bed: **.0** Bath: **0.00**
 List Date: **09/09/2005** MLS?: **N**
 Date Sold: **10/21/2005** Sld Price: **\$19,500** Includes Furniture?: **N** Includes GST?: **N**



4653 311 Blackcomb G4 Way, Benchlands, Horstman House

Status: **Sold** Built: **2000** Price: **\$121,900**
 Type: **Shared Owner** List Co: **WREC** Size: **627**
 L. Size: Bed: **1.0** Bath: **1.00**
 List Date: **06/23/2005** MLS?: **N**
 Date Sold: **10/03/2005** Sld Price: **\$115,000** Includes Furniture?: **Y** Includes GST?: **N**



4653 408 Blackcomb G1 Way, Benchlands, Horstman House

Status: **Sold** Built: **2000** Price: **\$128,900**
 Type: **Shared Owner** List Co: **RE/MAX** Size: **634**
 L. Size: Bed: **1.0** Bath: **1.00**
 List Date: **03/07/2005** MLS?: **N**
 Date Sold: **10/17/2005** Sld Price: **\$120,000** Includes Furniture?: **N** Includes GST?: **N**



4295 413 Blackcomb Way, Village, Holiday Inn

Status: **Sold** Built: **1995** Price: **\$148,000**
 Type: **Condominium** List Co: **RE/MAX** Size: **389**
 L. Size: Bed: **.5** Bath: **1.00**
 List Date: **09/08/2005** MLS?: **N**
 Date Sold: **10/17/2005** Sld Price: **\$140,000** Includes Furniture?: **N** Includes GST?: **N**



4653 304 Blackcomb G1 Way, Benchlands, Horstman House

Status: **Sold** Built: **2000** Price: **\$178,900**
 Type: **Shared Owner** List Co: **RE/MAX** Size: **971**
 L. Size: Bed: **2.0** Bath: **2.00**
 List Date: **04/27/2005** MLS?: **N**
 Date Sold: **10/04/2005** Sld Price: **\$170,000** Includes Furniture?: **N** Includes GST?: **N**



7001 14 Nesters Road, Nesters, Blackcomb Condos

Status: **Sold** Built: **1974** Price: **\$255,000**
 Type: **Condominium** List Co: **WREC** Size: **530**
 L. Size: Bed: **1.0** Bath: **1.00**
 List Date: **05/15/2005** MLS?: **N**
 Date Sold: **10/14/2005** Sld Price: **\$255,000** Includes Furniture?: **N** Includes GST?: **N**



4350 328 Lorimer Road, Village, Market Place Lodge

Status: **Sold** Built: **1995** Price: **\$319,000**
 Type: **Condominium** List Co: **RE/MAX** Size: **548**
 L. Size: Bed: **1.0** Bath: **1.00**
 List Date: **01/13/2003** MLS?: **N**
 Date Sold: **10/23/2005** Sld Price: **\$307,000** Includes Furniture?: **Y** Includes GST?: **N**



2005 113 Nordic Drive, Nordic, Nordic Court

Status: **Sold** Built: **1988** Price: **\$339,000**
 Type: **Condominium** List Co: **RE/MAX** Size: **709**
 L. Size: Bed: **2.0** Bath: **1.00**
 List Date: **08/05/2005** MLS?: **Y**
 Date Sold: **10/26/2005** Sld Price: **\$325,000** Includes Furniture?: **N** Includes GST?: **Y**



2300 5A Nordic Drive, Nordic, At Nature's Door

Status: **Sold** Built: **2002** Price: **\$339,500**
 Type: **Shared Owner** List Co: **RE/MAX** Size: **2,587**
 L. Size: Bed: **4.0** Bath: **4.00**
 List Date: **03/25/2005** MLS?: **N**
 Date Sold: **10/11/2005** Sld Price: **\$329,000** Includes Furniture?: **N** Includes GST?: **N**



8013 8 Timber Lane, Alpine Meadows, Snowbird Villas

Status: **Sold** Built: **1975** Price: **\$355,000**
 Type: **Townhouse** List Co: **WREC** Size: **1,058**
 L. Size: Bed: **2.0** Bath: **2.00**
 List Date: **07/18/2005** MLS?: **N**
 Date Sold: **10/11/2005** Sld Price: **\$337,500** Includes Furniture?: **N** Includes GST?: **N**



8052 4 Timberlane, Alpine Meadows, Wedel Inn

Status: **Sold** Built: **1980** Price: **\$369,900**
 Type: **Townhouse** List Co: **RE/MAX** Size: **879**
 L. Size: Bed: **2.0** Bath: **1.00**
 List Date: **09/18/2005** MLS?: **Y**
 Date Sold: **10/24/2005** Sld Price: **\$355,000** Includes Furniture?: **Y** Includes GST?: **N**



6127 25 Eagleridge Crescent, Whistler Cay Heights, Eagle Ridge

Status: **Sold** Built: **1989** Price: **\$399,000**
 Type: **Townhouse** List Co: **S to S** Size: **780**
 L. Size: Bed: **1.0** Bath: **1.00**
 List Date: **01/30/2005** MLS?: **N**
 Date Sold: **10/29/2005** Sld Price: **\$375,000** Includes Furniture?: **N** Includes GST?: **N**



4325 6 Northlands Boulevard, Village, Sunpath

Status: **Sold** Built: **1995** Price: **\$409,000**
 Type: **Townhouse** List Co: **WREC** Size: **623**
 L. Size: Bed: **1.0** Bath: **1.00**
 List Date: **06/23/2004** MLS?: **N**
 Date Sold: **10/14/2005** Sld Price: **\$380,000** Includes Furniture?: **N** Includes GST?: **N**



4355 32 Northlands Boulevard, Village, North Star

Status: **Sold** Built: **1997** Price: **\$449,000**
 Type: **Townhouse** List Co: **WREC** Size: **642**
 L. Size: Bed: **1.0** Bath: **1.00**
 List Date: **05/05/2005** MLS?: **N**
 Date Sold: **10/11/2005** Sld Price: **\$440,000** Includes Furniture?: **Y** Includes GST?: **N**



4355 98 Northlands Boulevard, Village, North Star

Status: **Sold** Built: Price: **\$459,000**
 Type: **Townhouse** List Co: **RE/MAX** Size: **642**
 L. Size: Bed: **1.0** Bath: **1.00**
 List Date: **09/21/2005** MLS?: **N**
 Date Sold: **10/28/2005** Sld Price: **\$445,000** Includes Furniture?: **Y** Includes GST?: **N**



4573 114/115 Chateau Boulevard, Benchlands, Glacier Lodge

Status: **Sold** Built: **1988** Price: **\$495,000**
 Type: **Condominium** List Co: **WREC** Size: **756**
 L. Size: Bed: **1.0** Bath: **2.00**
 List Date: **02/06/2005** MLS?: **N**
 Date Sold: **10/27/2005** Sld Price: **\$470,000** Includes Furniture?: **Y** Includes GST?: **N**



3309 127 Ptarmigan Place, Blueberry, Greyhawk

Status: **Sold** Built: **1992** Price: **\$559,000**
 Type: **Condominium** List Co: **WREC** Size: **1,194**
 L. Size: Bath: **2.00**
 List Date: **03/19/2004** MLS?: **N**
 Date Sold: **10/11/2005** Sld Price: **\$546,000** Includes Furniture?: **Y** Includes GST?: **N**



6117 110 Eagle Drive, Whistler Cay Heights, Sunrise

Status: **Sold** Built: **1985** Price: **\$579,000**
 Type: **Townhouse** List Co: **WREC** Size: **1,038**
 L. Size: Bath: **1.50**
 List Date: **09/24/2005** MLS?: **Y**
 Date Sold: **10/18/2005** Sld Price: **\$560,000** Includes Furniture?: **N** Includes GST?: **N**



2222 203 Castle Drive, Nordic, 2222 Castle

Status: **Sold** Built: **1996** Price: **\$588,000**
 Type: **Townhouse** List Co: **WREC** Size: **1,032**
 L. Size: Bath: **2.00**
 List Date: **08/12/2005** MLS?: **N**
 Date Sold: **10/18/2005** Sld Price: **\$570,000** Includes Furniture?: **Y** Includes GST?: **Y**



6127 6 Eagle Ridge Crescent, Whistler Cay Heights, Eagle Ridge

Status: **Sold** Built: **1989** Price: **\$640,000**
 Type: **Townhouse** List Co: **WREC** Size: **1,412**
 L. Size: Bath: **2.00**
 List Date: **05/17/2005** MLS?: **N**
 Date Sold: **10/28/2005** Sld Price: **\$596,001** Includes Furniture?: **Y** Includes GST?: **N**



35 Garibaldi Drive, Black Tusk,

Status: **Sold** Built: **1985** Price: **\$698,000**
 Type: **Chalet** List Co: **SWCR** Size: **2,100**
 L. Size: **7535** Bath: **2.00**
 List Date: **04/11/2005** MLS?: **Y**
 Date Sold: **10/04/2005** Sld Price: **\$657,000** Includes Furniture?: **N** Includes GST?: **N**



2093 Squaw Valley Crescent, Whistler Creek,

Status: **Sold** Built: **1986** Price: **\$699,000**
 Type: **Duplex** List Co: **RE/MAX** Size: **1,900**
 L. Size: Bath: **2.00**
 List Date: **07/31/2005** MLS?: **Y**
 Date Sold: **10/14/2005** Sld Price: **\$690,000** Includes Furniture?: **N** Includes GST?: **Y**



6339 Easy Street, Whistler Cay Estates,

Status: **Sold** Built: **1985** Price: **\$700,000**
 Type: **Chalet** List Co: **WREC** Size: **400**
 L. Size: Bath: **1.00**
 List Date: **01/19/2006** MLS?: **N**
 Date Sold: **10/31/2005** Sld Price: **\$700,000** Includes Furniture?: **N** Includes GST?: **N**



2235 Aspen Drive, Nordic,

Status: **Sold** Built: **1990** Price: **\$729,000**
 Type: **Triplex** List Co: **RE/MAX** Size: **1,600**
 L. Size: Bath: **3.00**
 List Date: **09/14/2005** MLS?: **N**
 Date Sold: **10/05/2005** Sld Price: **\$689,000** Includes Furniture?: **N** Includes GST?: **N**



2104 26 Nordic Drive, Nordic, Castle Ridge

Status: **Sold** Built: **1992** Price: **\$799,000**
 Type: **Townhouse** List Co: **WREC** Size: **1,287**
 L. Size: Bath: **2.50**
 List Date: **05/02/2005** Bed: **3.5** MLS?: **N**
 Date Sold: **10/11/2005** Sld Price: **\$772,000** Includes Furniture?: **N** Includes GST?: **N**



4800 351 Spearhead Drive, Benchlands, Aspens

Status: **Sold** Built: **1995** Price: **\$824,900**
 Type: **Condominium** List Co: **SWCR** Size: **807**
 L. Size: Bath: **2.00**
 List Date: **09/15/2005** Bed: **2.0** MLS?: **N**
 Date Sold: **10/05/2005** Sld Price: **\$815,000** Includes Furniture?: **Y** Includes GST?: **N**



4325 47 Northlands Boulevard, Village, Sunpath

Status: **Sold** Built: **1995** Price: **\$859,900**
 Type: **Townhouse** List Co: **RE/MAX** Size: **1,186**
 L. Size: Bath: **2.00**
 List Date: **06/02/2005** Bed: **3.0** MLS?: **Y**
 Date Sold: **10/25/2005** Sld Price: **\$824,000** Includes Furniture?: **Y** Includes GST?: **Y**



4644 23 Blackcomb Way, Benchlands, Blackcomb Greens

Status: **Sold** Built: **1993** Price: **\$889,000**
 Type: **Townhouse** List Co: **RE/MAX** Size: **1,070**
 L. Size: Bath: **2.00**
 List Date: **07/23/2005** Bed: **2.0** MLS?: **N**
 Date Sold: **10/14/2005** Sld Price: **\$845,000** Includes Furniture?: **N** Includes GST?: **N**



6243 Par Road, Whistler Cay Heights,

Status: **Sold** Built: **1982** Price: **\$999,999**
 Type: **Duplex** List Co: **WREC** Size: **1,960**
 L. Size: Bath: **3.50**
 List Date: **09/30/2005** Bed: **4.0** MLS?: **Y**
 Date Sold: **10/31/2005** Sld Price: **\$965,000** Includes Furniture?: **Y** Includes GST?: **Y**



8312 Needles Drive, Alpine Meadows,

Status: **Sold** Built: **1988** Price: **\$1,050,000**
 Type: **Chalet** List Co: **RE/MAX** Size: **2,700**
 L. Size: **11,379 Sq Ft** Bath: **2.00**
 List Date: **09/03/2005** Bed: **3.0** MLS?: **Y**
 Date Sold: **10/20/2005** Sld Price: **\$950,000** Includes Furniture?: **N** Includes GST?: **N**



8581 Drifter Way, Alpine Meadows,

Status: **Sold** Built: **1981** Price: **\$1,149,000**
 Type: **Chalet** List Co: **SWCR** Size: **3,050**
 L. Size: **722.98 sqm** Bath: **3.50**
 List Date: **05/18/2005** Bed: **4.0** MLS?: **N**
 Date Sold: **10/20/2005** Sld Price: **\$1,062,500** Includes Furniture?: **Y** Includes GST?: **N**



4894 16 Painted Cliff, Benchlands, Mountain Star

Status: **Sold** Built: **1998** Price: **\$1,295,000**
 Type: **Townhouse** List Co: **WREC** Size: **1,326**
 L. Size: Bath: **2.00**
 List Date: **08/13/2005** Bed: **3.0** MLS?: **N**
 Date Sold: **10/03/2005** Sld Price: **\$1,275,000** Includes Furniture?: **N** Includes GST?: **N**



4808 Casabella Crs, Village, Montebello

Status: **Sold** Built: **2001** Price: **\$1,390,000**
 Type: **Townhouse** List Co: **RE/MAX** Size: **1,508**
 L. Size: Bed: **3.0** Bath: **3.00**
 List Date: **08/24/2005** MLS?: **N**
 Date Sold: **10/14/2005** Sld Price: **\$1,245,000** Includes Furniture?: **Y** Includes GST?: **N**



4290 403 Mountain Square, Village, Carleton Lodge

Status: **Sold** Built: **1981** Price: **\$1,459,000**
 Type: **Condominium** List Co: **SWCR** Size: **960**
 L. Size: Bed: **2.0** Bath: **2.00**
 List Date: **07/14/2005** MLS?: **N**
 Date Sold: **10/07/2005** Sld Price: **\$1,320,000** Includes Furniture?: **Y** Includes GST?: **N**



3366 Panorama Ridge, Brio,

Status: **Sold** Built: **1999** Price: **\$1,595,000**
 Type: **Chalet** List Co: **RE/MAX** Size: **3,636**
 L. Size: **13830** Bed: **4.5** Bath: **3.50**
 List Date: **07/18/2005** MLS?: **Y**
 Date Sold: **10/19/2005** Sld Price: **\$1,486,000** Includes Furniture?: **Y** Includes GST?: **N**

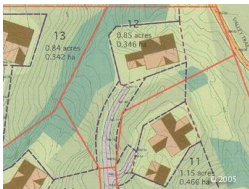

5152 12 Alta Lake Road, Whistler Creek, Residences at Nita Lake

Status: **Sold** Built: Price: **\$1,695,000**
 Type: **Vacant Land** List Co: **S to S** Size:
 L. Size: Bed: **.0** Bath: **0.00**
 List Date: **11/05/2004** MLS?: **N**
 Date Sold: **10/27/2005** Sld Price: **\$1,500,000** Includes Furniture?: **N** Includes GST?: **N**



6239 Palmer Drive, Whistler Cay Heights,

Status: **Sold** Built: **1997** Price: **\$1,799,000**
 Type: **Chalet** List Co: **S to S** Size: **3,200**
 L. Size: **8667** Bed: **4.0** Bath: **4.50**
 List Date: **07/19/2005** MLS?: **N**
 Date Sold: **10/26/2005** Sld Price: **\$1,700,000** Includes Furniture?: **Y** Includes GST?: **N**



8995 Trudy's Landing, Alpine Meadows,

Status: **Sold** Built: **n/a** Price: **\$1,890,000**
 Type: **Chalet** List Co: **WREC** Size: **1,600**
 L. Size: **16230** Bed: **3.0** Bath: **2.00**
 List Date: **06/18/2003** MLS?: **N**
 Date Sold: **10/08/2005** Sld Price: **\$1,637,000** Includes Furniture?: **N** Includes GST?: **N**



9297 Lakeshore Drive, Emerald Estates,

Status: **Sold** Built: **1998** Price: **\$2,395,000**
 Type: **Chalet** List Co: **RE/MAX** Size: **3,500**
 L. Size: **7966** Bed: **4.5** Bath: **4.50**
 List Date: **11/12/2004** MLS?: **N**
 Date Sold: **10/11/2005** Sld Price: **\$2,250,000** Includes Furniture?: **Y** Includes GST?: **N**



8019 Nicklaus Boulevard, Green Lake Estates,

Status: **Sold** Built: **1997** Price: **\$2,499,000**
 Type: **Chalet** List Co: **WREC** Size: **3,250**
 L. Size: **8848** Bed: **5.5** Bath: **3.50**
 List Date: **12/17/2004** MLS?: **N**
 Date Sold: **10/02/2005** Sld Price: **\$2,300,000** Includes Furniture?: **Y** Includes GST?: **N**



6669 Crabapple Drive, Whistler Cay Estates,

Status:	Sold	Built:	2003	Price:	\$4,450,000
Type:	Chalet	List Co:	S to S	Size:	4,300
L. Size:	12281	Bed:	4.0	Bath:	4.50
List Date:	01/19/2004	MLS?:	N		
Date Sold:	10/17/2005	Sld Price:	\$3,850,000	Includes Furniture?:	Y Includes GST?: N



2564 Snowridge Crescent, Whistler Creek,

Status:	Sold	Built:	2003	Price:	\$6,350,000
Type:	Chalet	List Co:	S to S	Size:	3,400
L. Size:		Bed:	5.0	Bath:	6.00
List Date:	06/01/2005	MLS?:	N		
Date Sold:	10/17/2005	Sld Price:	\$6,150,000	Includes Furniture?:	N Includes GST?: N