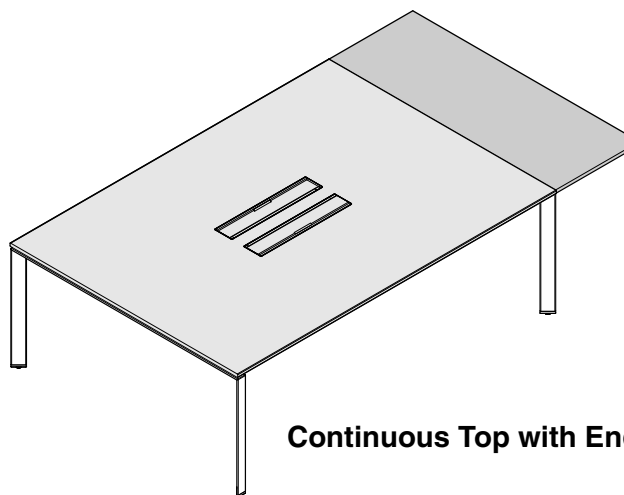
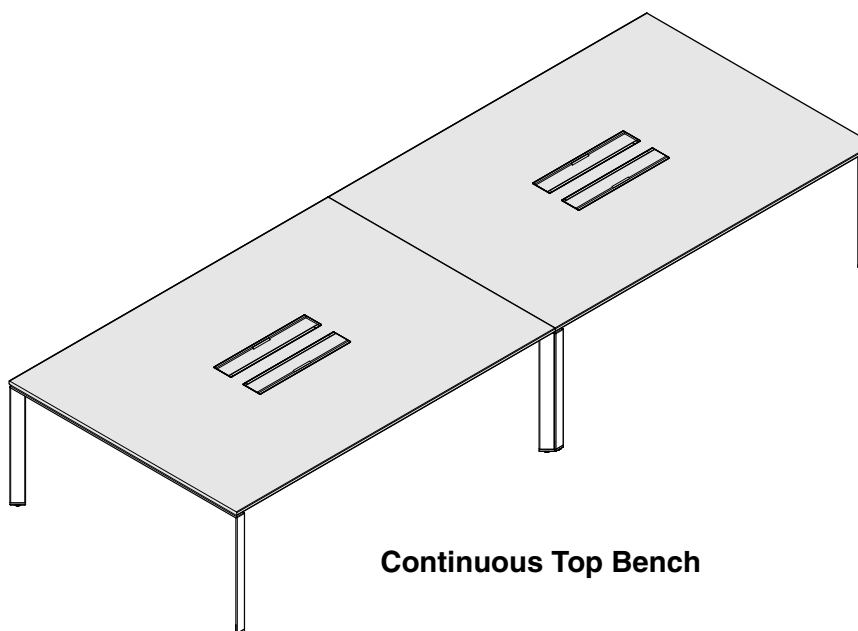

Table of Contents	
Topic	Page
Frame Assembly	2
Worksurface Assembly	3
Power Access Door Package	4
Power Block Installation	5
Assembly for New York Power-In Feed	6
Hardwire Version	8
Power Cover	9
End Counter Installation	10
Worksurface Installation	11
Tray Installation	12
Worksurface Adjustment	13
Continuous Top Base and Extension	14



Continuous Top with End Counter



Continuous Top Bench

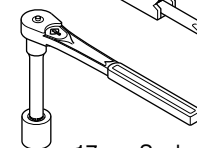
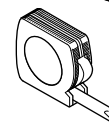
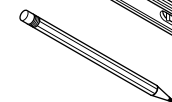
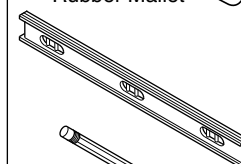
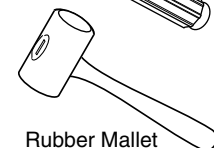
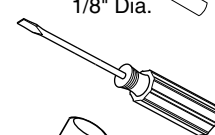
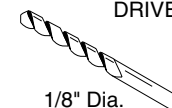
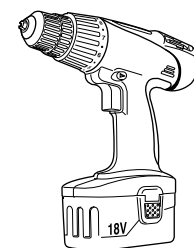

If you have a problem, question, or request, call your local dealer, or Steelcase Line 1 at **888.STEELCASE** (888.783.3522) for immediate action by people who want to help you.

(Outside the U.S.A., Canada, Mexico, Puerto Rico, and the U.S. Virgin Islands, call: 1.616.247.2500) Or visit our website: www.steelcase.com

© 2015 Steelcase Inc.
Grand Rapids, MI 49501
U.S.A.

Printed in U.S.A.

Frame Assembly

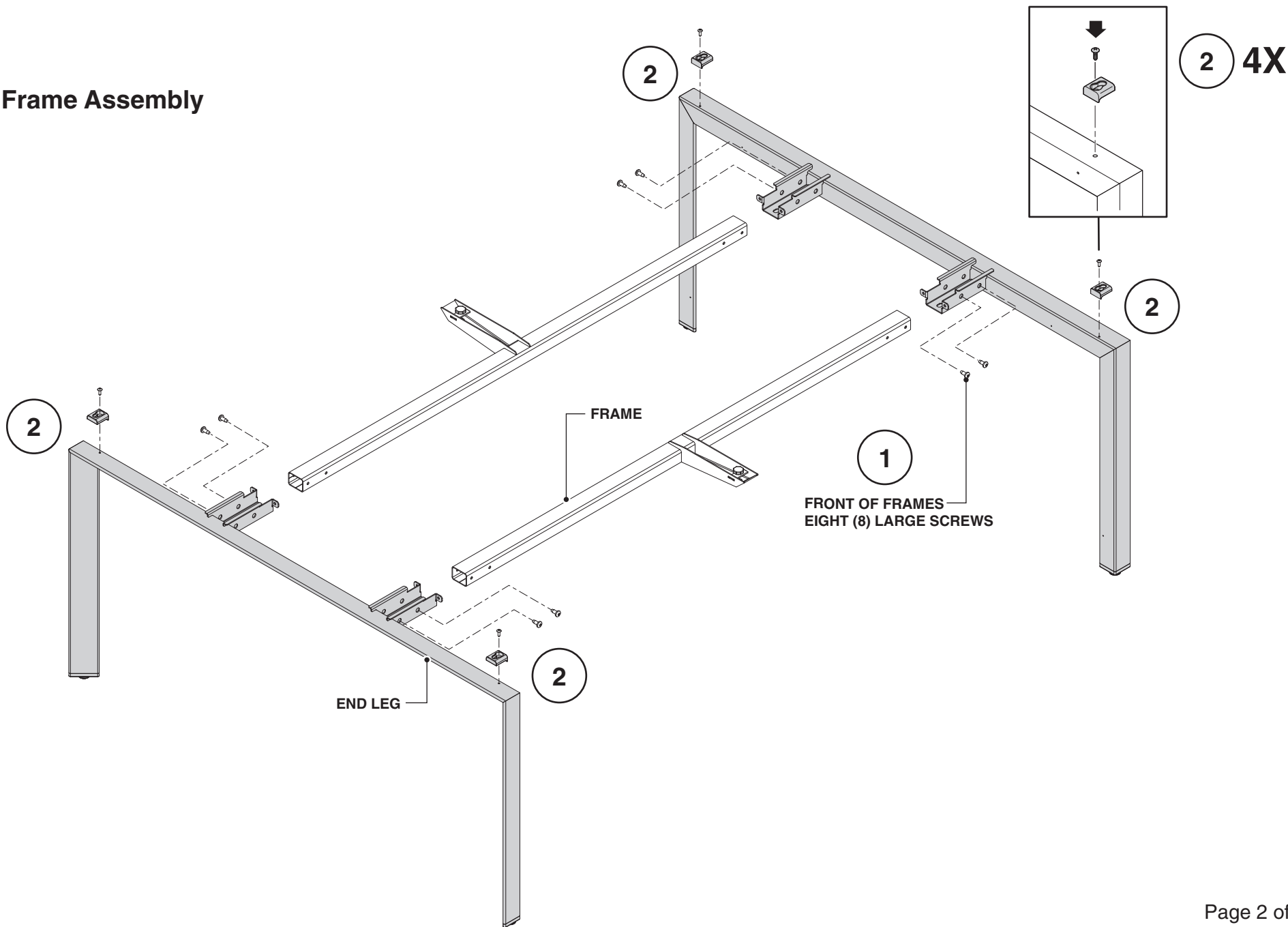

Worksurface Assembly

1. Turn the worksurface over onto a clean, soft surface.

2. Locate and install (2) cantilevers using spacer blocks as shown.

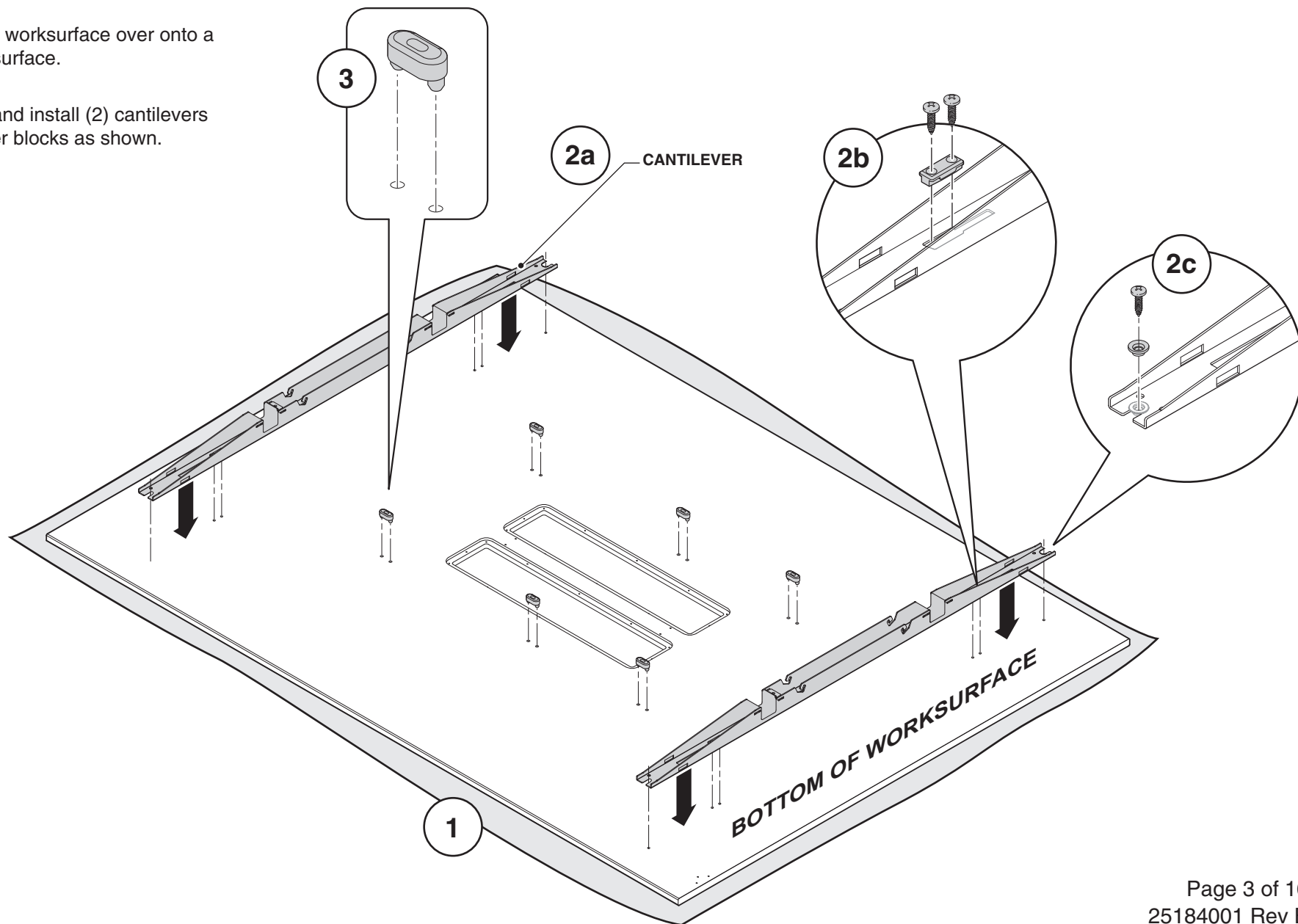

Power Access Door Package

1. Install (2) access door assemblies into openings as shown.

NOTE: Install screws by hand only. Using a power driver could cause damage to the product!

NOTE: Install screws by hand only. Using a power driver could cause damage to the product!

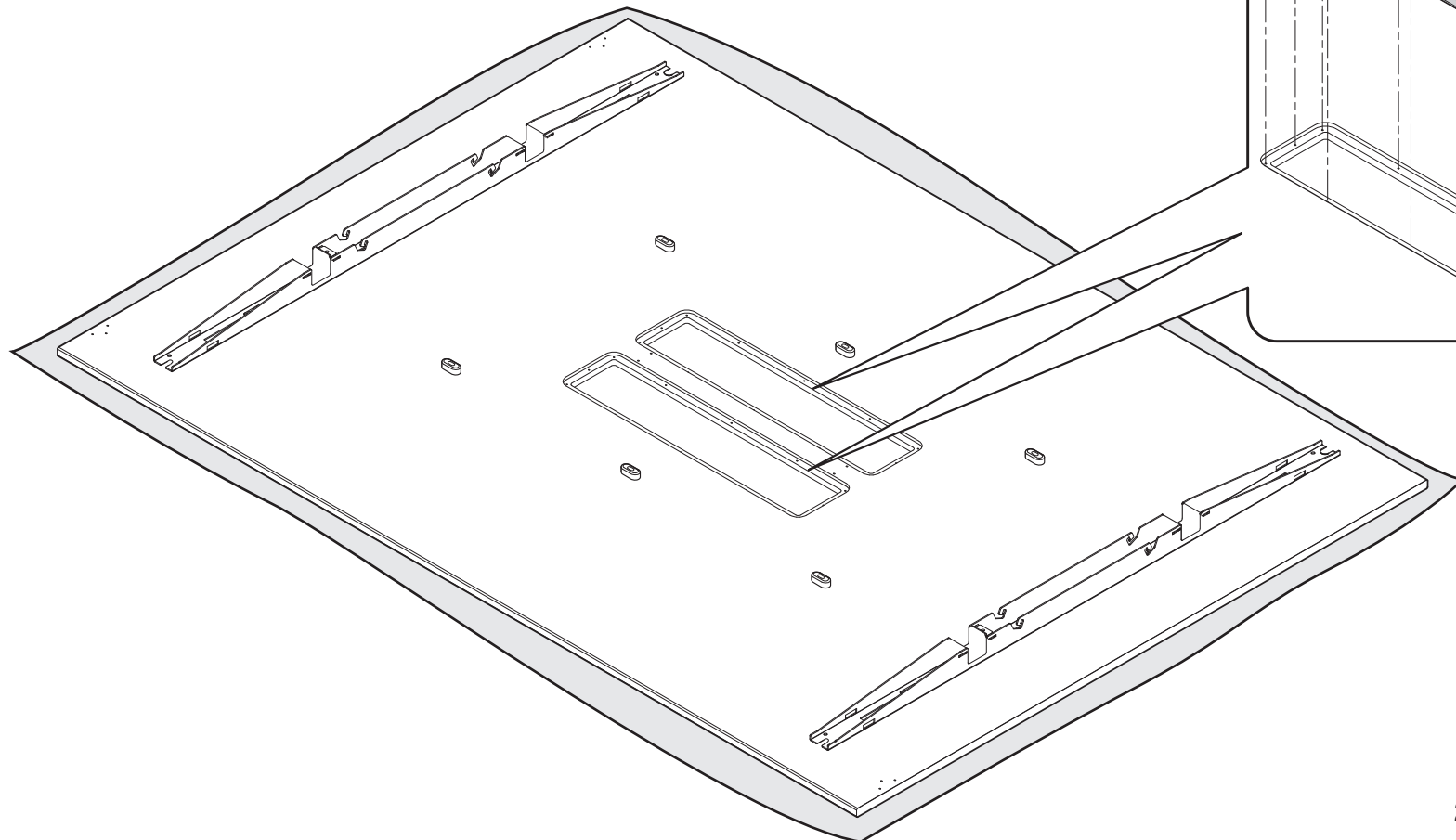

1

(12) 1/2" SCREWS

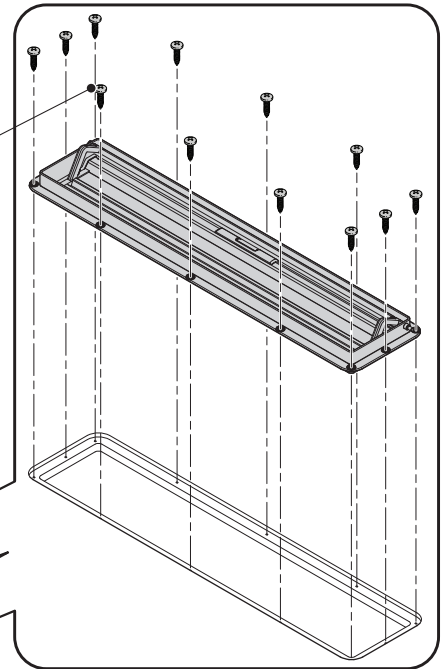

Power Block Installation

NOTE: For hardwire versions, go to page 8.

1. Install power block bracket to worksurface with (4) #10-12 x .625" screws.

2. Attach power block as shown.

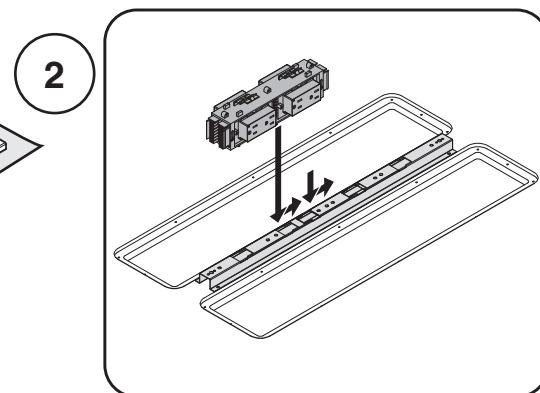
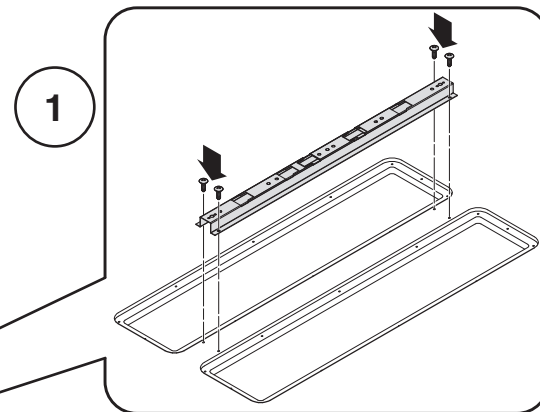
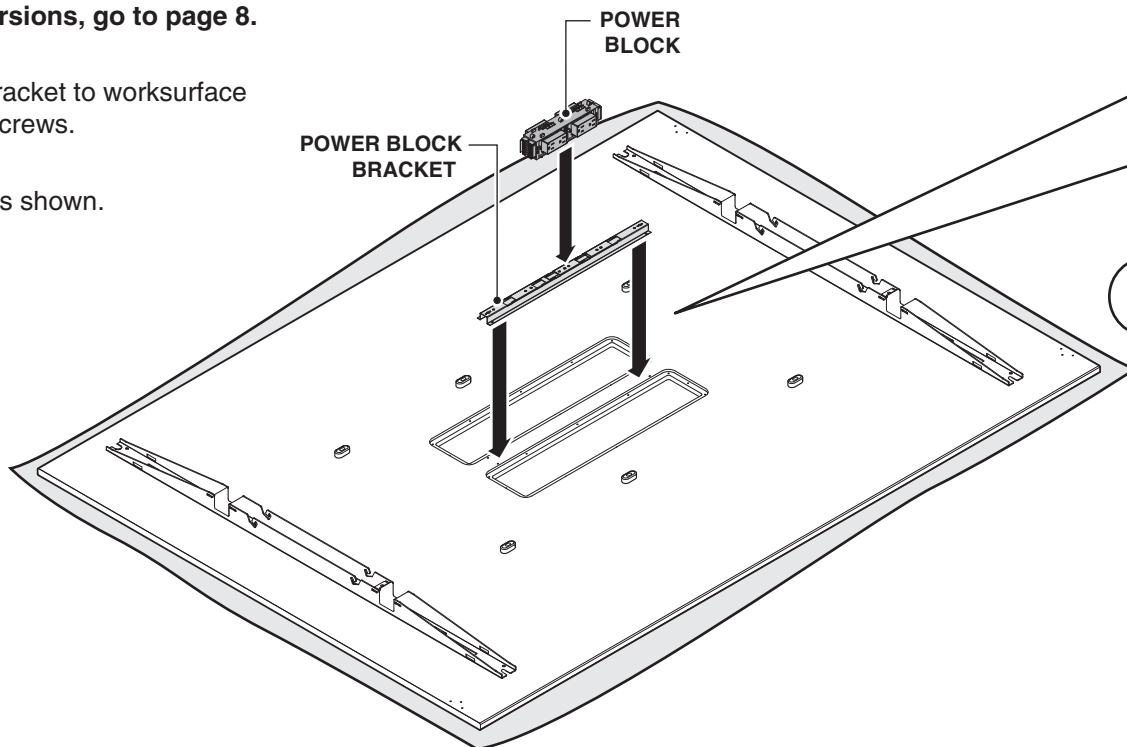

NOTE: Power block must be mounted in the center slots.

Modular Power

Standard Capacity = 1 block

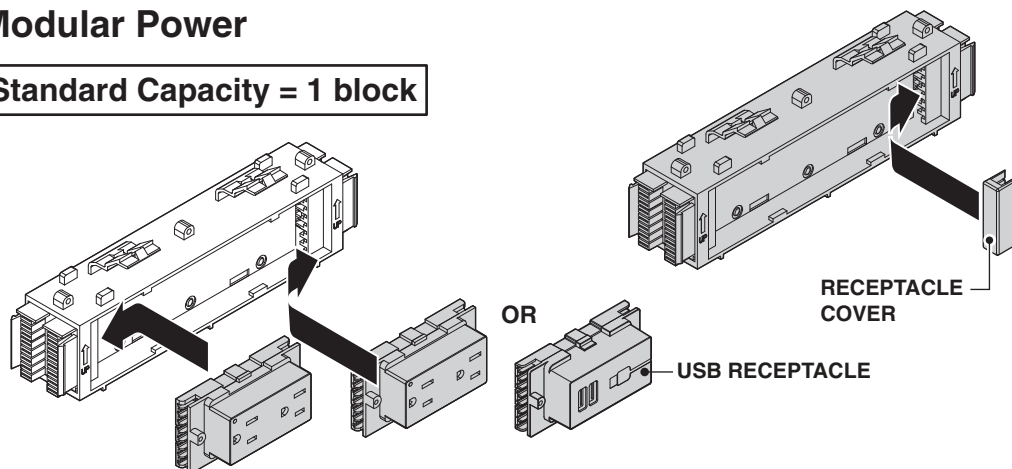

NOTE: If receptacles are not required inside a power block, make sure to apply a receptacle cover to ALL open ports.

NOTE: This equipment has been tested and found to comply with the limits for a Class A digital device, pursuant to part 15 of the FCC rules. These limits are designed to provide reasonable protection against harmful interface when the equipment is operated in a commercial environment. This equipment generates, uses and can radiate radio frequency energy and, if not installed and used in accordance with the instruction manual, may cause harmful interference to radio communications. Operation of this equipment in a residential area is likely to cause harmful interference in which case the user will be required to correct the interference at his own expense.

NOTE: The electrician can cut conduit and wire to length if needed.

Assembly for New York Power-In Feed

1. Assemble junction box, without cover.

NOTE: Determine which end of the desk frame the box will be mounted. Electrician to remove knockouts prior to mounting junction box.

The modular/hardwire harness provided is supplied for a maximum length desk and will need to be cut to length for shorter desks. desired.

2. Measure length from the junction box to the modular connector (*plan junction box distance mounted 6" from cantilever. See page 5*).

Remove conduit connector before cutting modular/hardwire harness to length (2a). Reattach conduit connector, tighten nut, and secure to junction box.

Route modular/hardwire harness through knockout with electrician's power supply cable. Electrician to connect power source wires to the modular/hardwire harness with wire nuts (2b). Place connected power inside junction box and fasten junction box cover (2c).

NOTE: If nuts cannot be tightened, remove item 1A, tighten and reattach.

Harness route and trim may be completed after mounting junction box if desired.

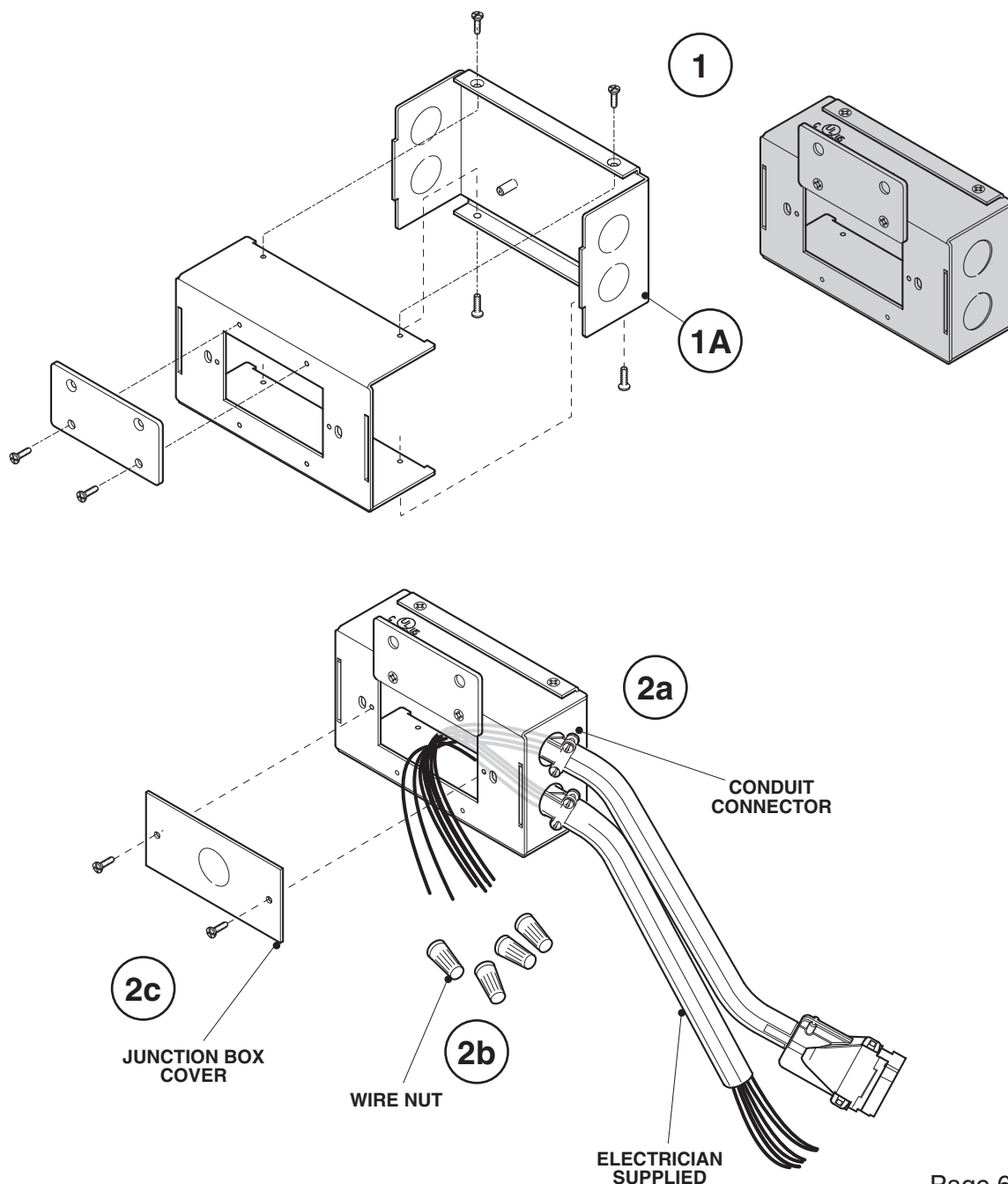

Assembly for New York Power-In Feed (continued)

3. Locate junction box 6" inward from the cantilever bracket on the underside of the frame. Align box and pre-drill holes for #10 screws, (#22 drill bit).

4. Attach the box with screws provided.

5. Drill pilot holes for strain relief brackets. Attach the harness strain relief bracket to the bottom side of the horizontal rail with screw provided (5a). Insert harness into the bracket (5b) and secure harness with nut and bolt (5c). Connect the modular end of the harness to the first modular power block. Attach electrician supplied harness strain relief bracket in location shown. Follow steps 5a - 5c to secure electrician's harness.

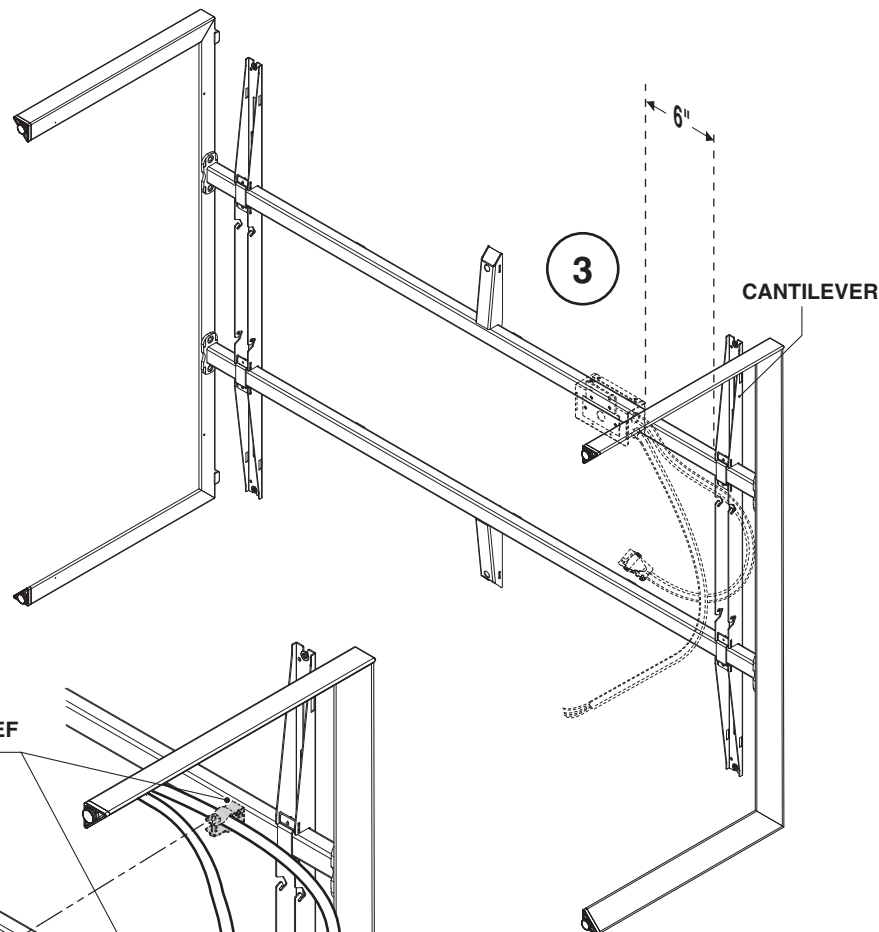
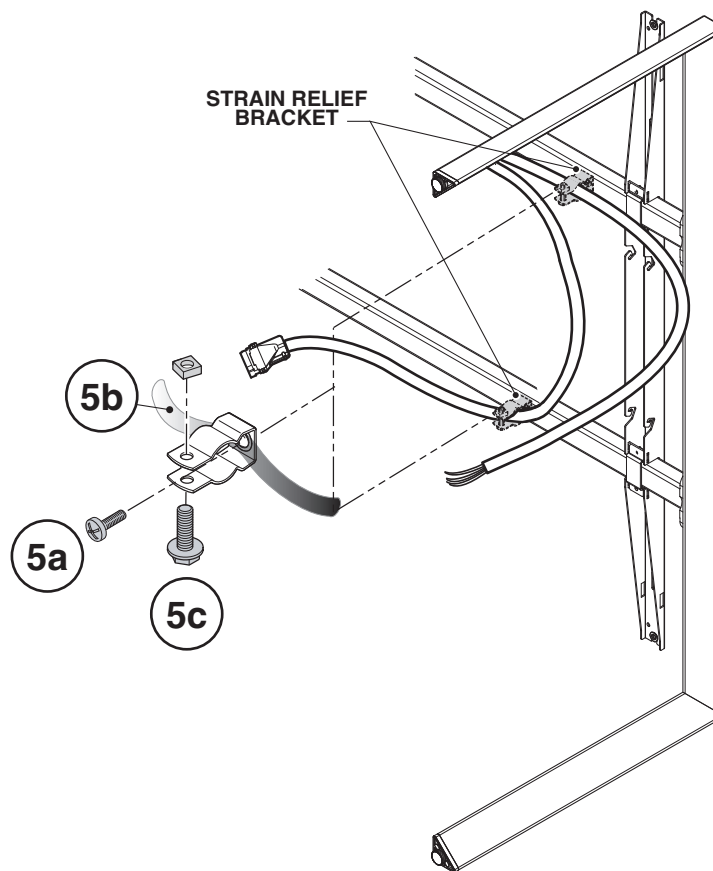
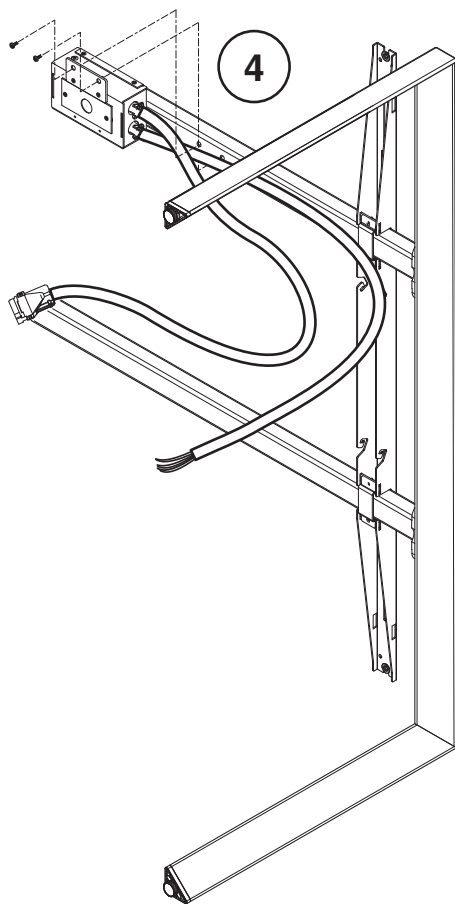

Hardwire Version:

6a One hardwire box installs centered on the bracket.

6b

BEND DOWN

NOTE: For proper fit of receptacle, remove all ears on receptacle

Chicago
Hardwire

Alternate Assembly for Hardwire

Secure to
WORKSURFACE

6c

NOTE: Steps 6c through 6e are also required on all Power-In feeds.

6d

6e

7. Install power covers.

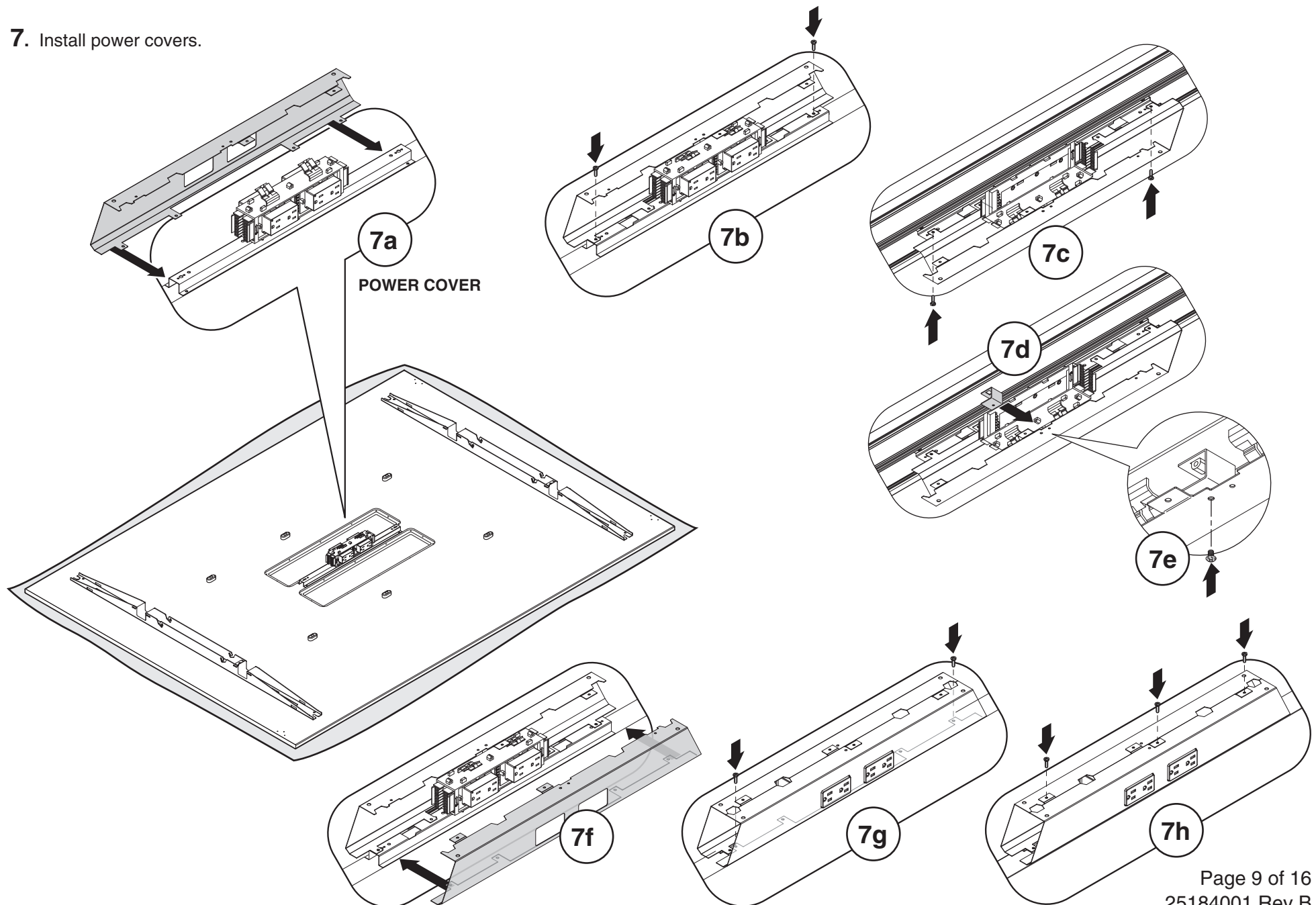

End Counter Installation (If ordered)

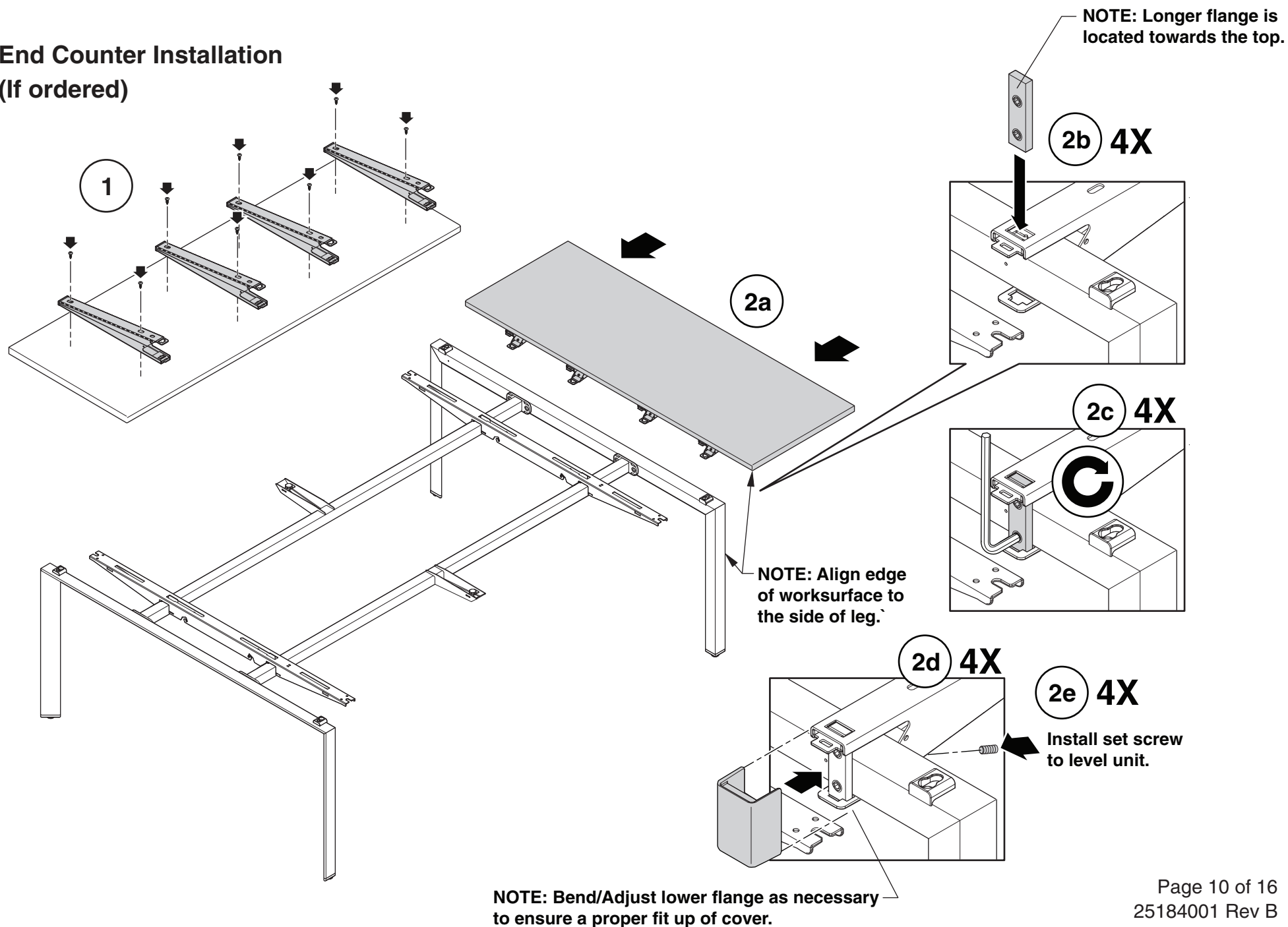

Worksurface Installation

1. Lower worksurface onto frame.
2. Adjust worksurface if necessary.

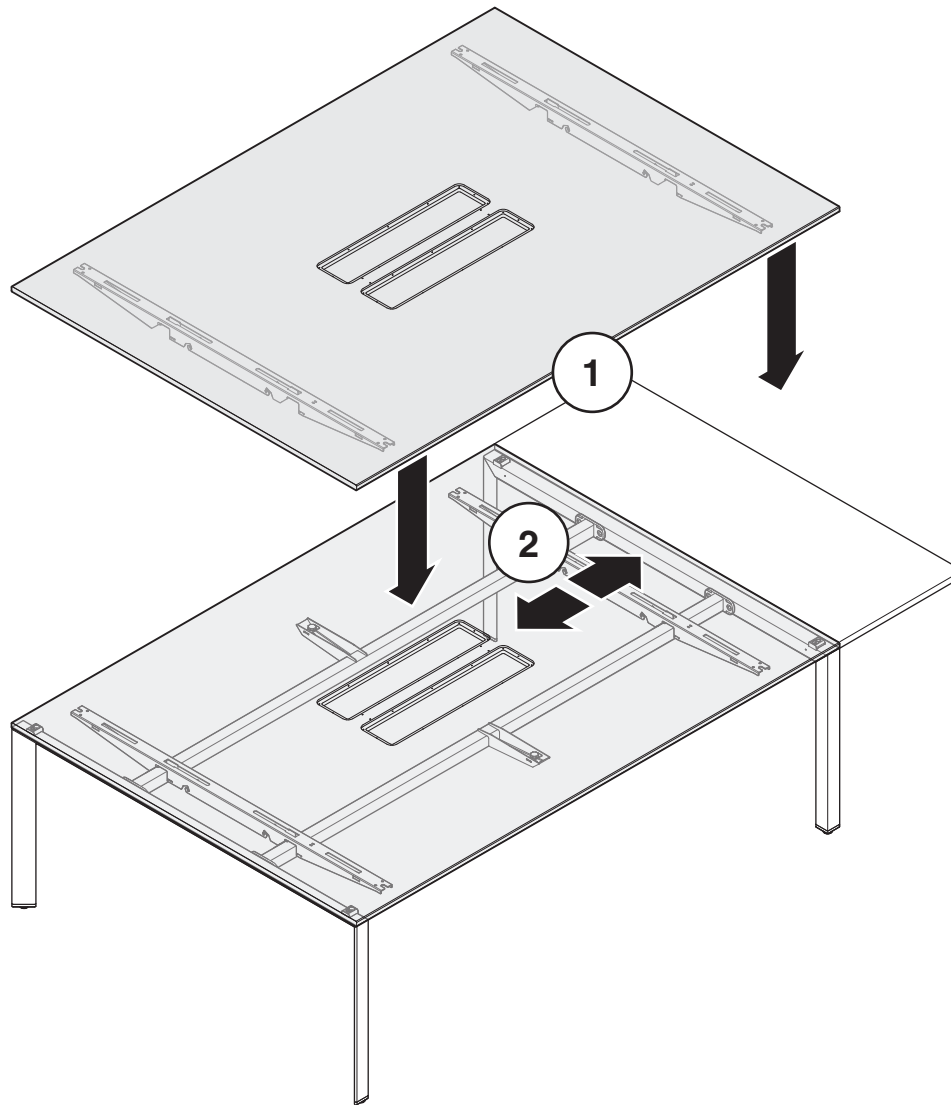

Tray Installation

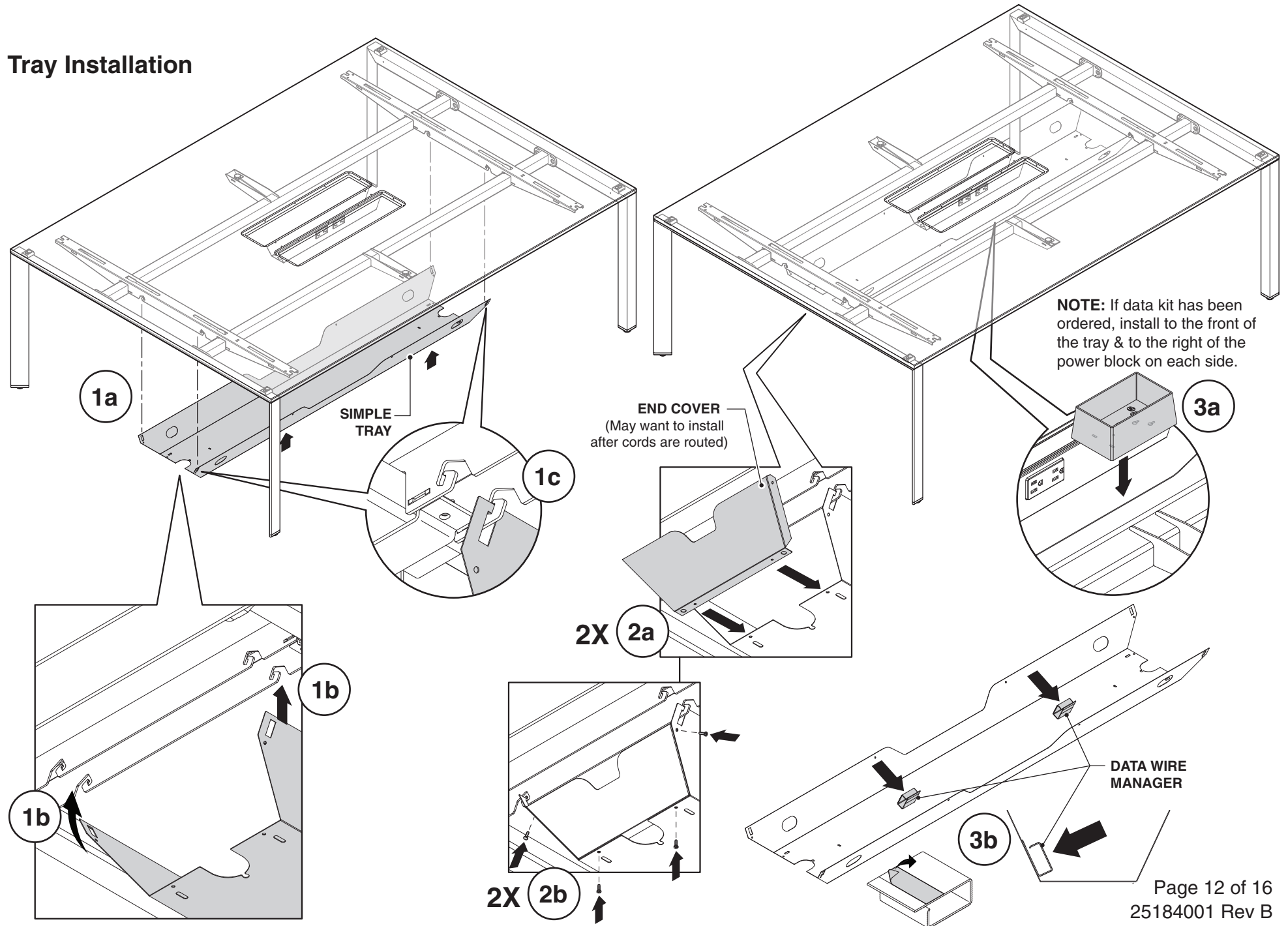

Worksurface Adjustment

1. Adjust center worksurface glide to level the worksurface if needed.
2. Adjust glides as needed.

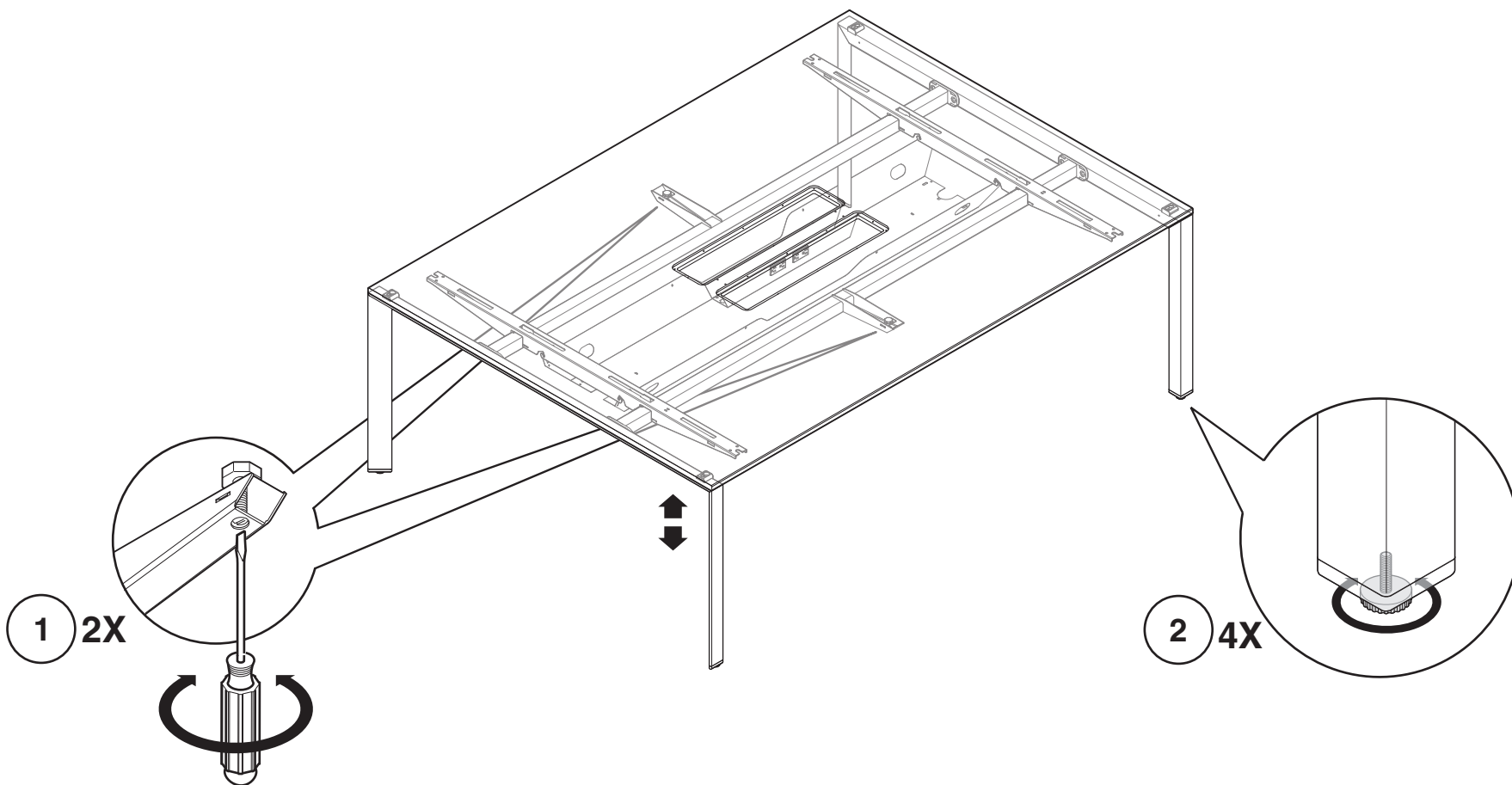

Continuous Top Base and Extension

2. To install cantilevers onto worksurface assembly, perform steps 1 through 3 on page 3 (twice). A total of (4) cantilevers will be installed. Refer to page 4 to install power access doors.

3. For power block installation perform steps 1 and 2 on page 5 (twice). A total of (2) power blocks will be used.

4. For alternate assembly for hardwire, refer to page 8.

5. For alternate assembly for New York power, refer to pages 6 and 7.

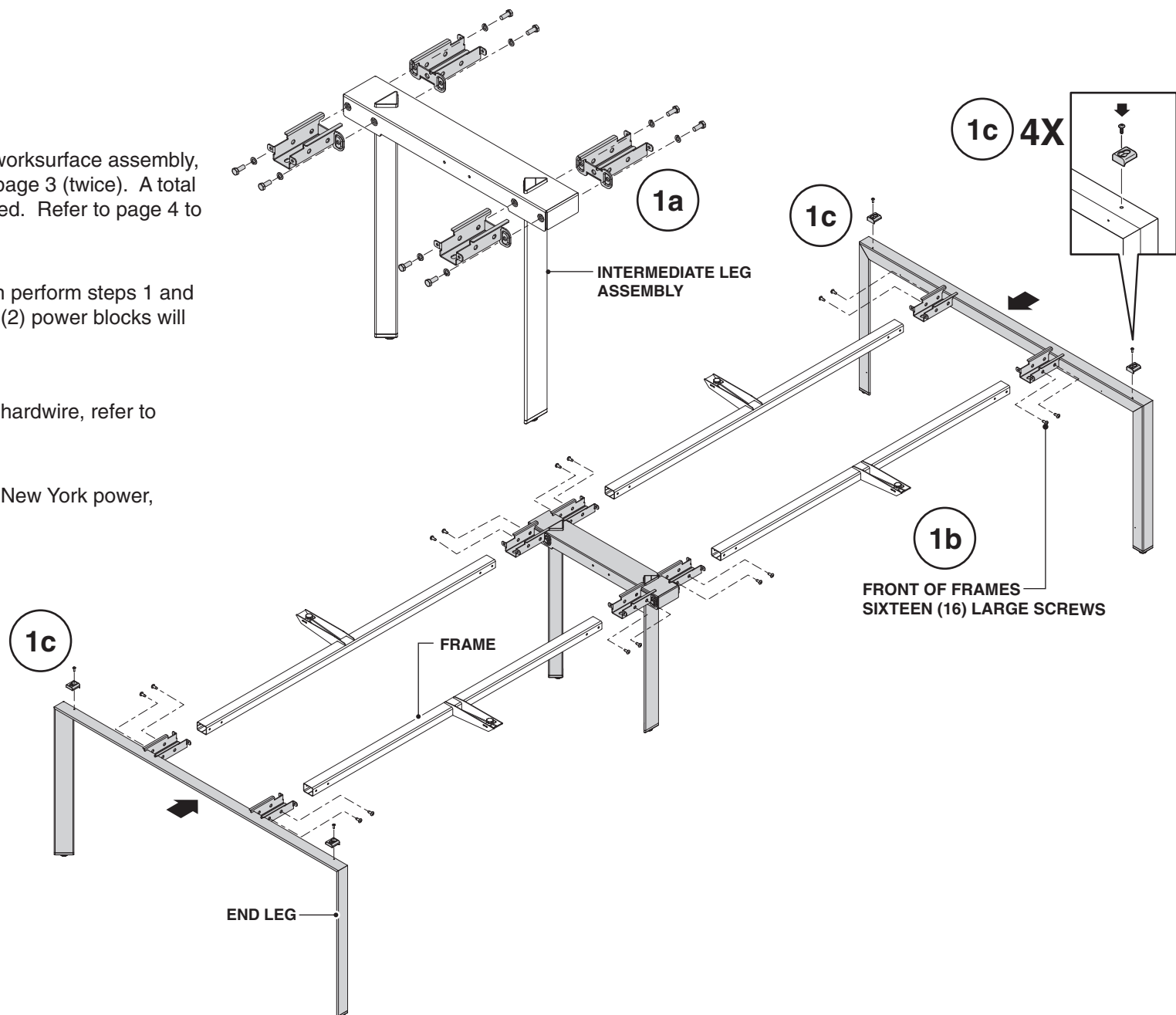

Continuous Top Base and Extension (continued)

6. To install worksurfaces, refer to page 11.

7. Install block-to-block harness and base power-in.

NOTE: If receptacles are not required inside a power block, make sure to apply a receptacle cover to ALL open ports.

8. Strain relief is required on all power-in feeds.

NOTE: Steps 8b through 8d are required on all Power-In feeds.

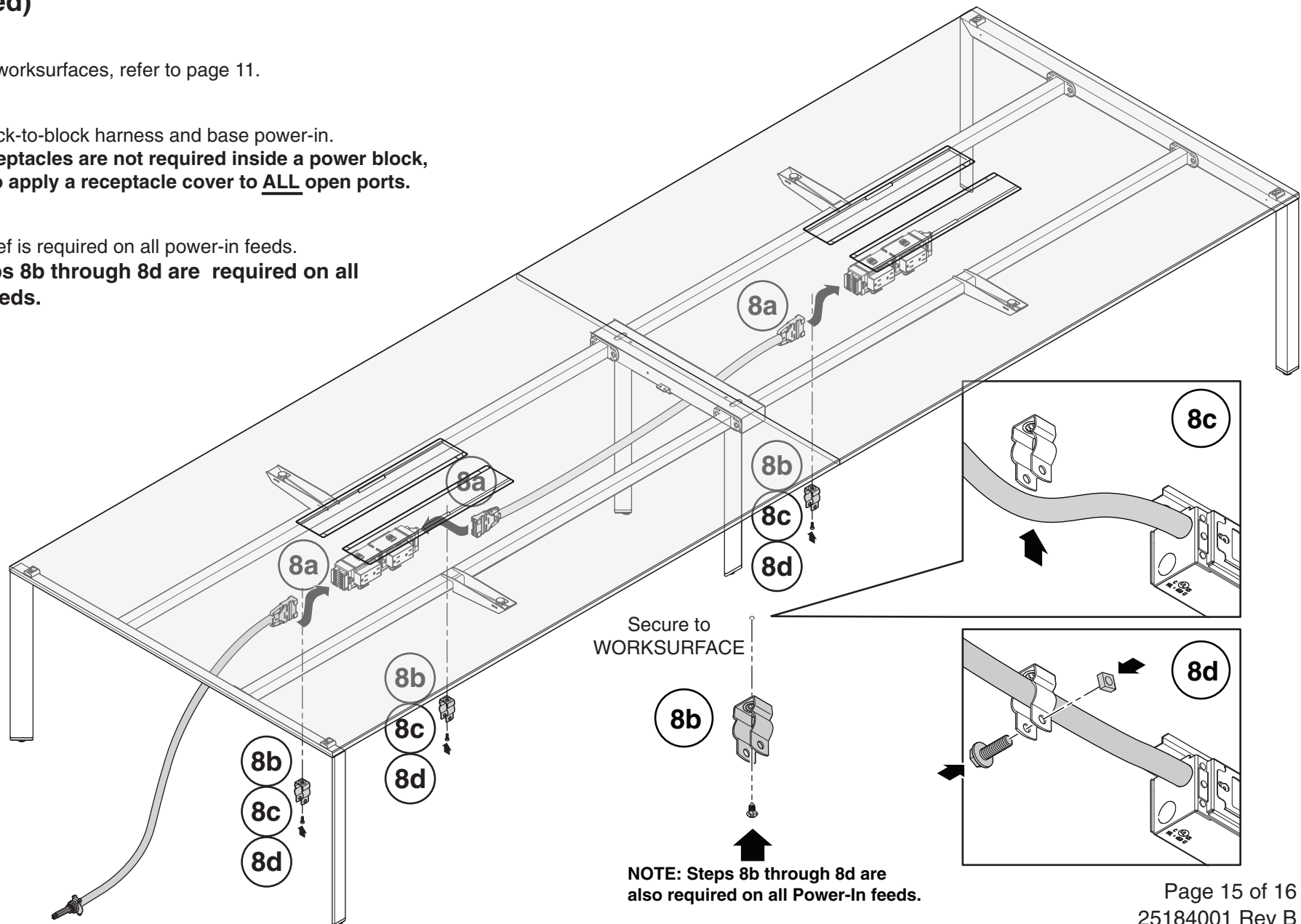

Continuous Top Base and Extension (continued)

9. To install power covers, refer to page 9.
A total of (4) covers will be used.

10. To install data and tray, refer to page 12.
NOTE: Route all data wires at this point.

12. Gang worksurfaces together using (2) tie plates on either side of the intermediate leg (4 screws per tie plate).

