

- 1 Rotate the rail cleat into the FrameOne rail, oriented forward, as shown.
- 2 Place the bracket assembly onto desk rail, over the cleat. Guide two (2) flat head screws through the bracket and turn screws until partially threaded into the cleat.

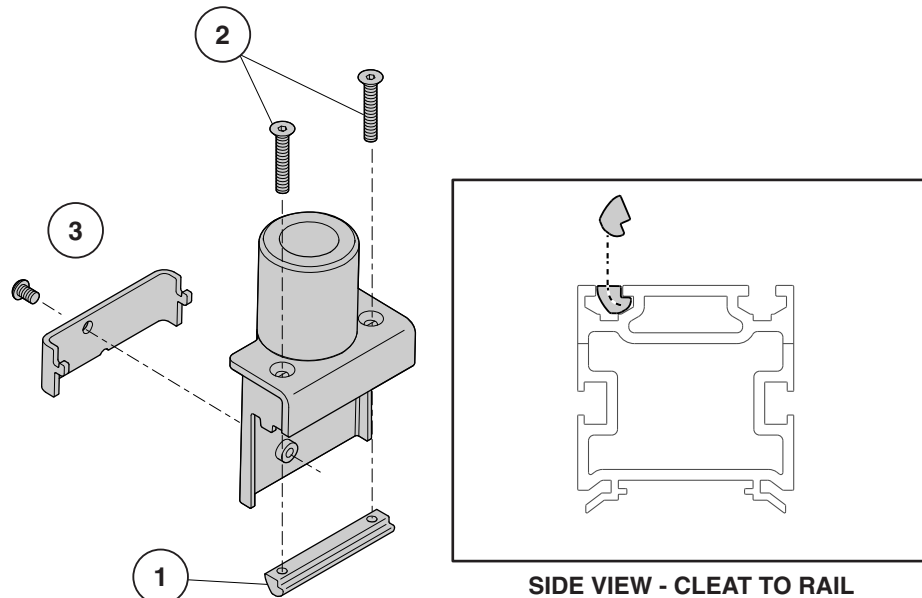

- 3 Install locking plate onto the face of bracket assembly with 'teeth' facing upward. Install and fully tighten the screw. The two (2) flat head screws may now be fully tightened.
- 4 Install CF series arm, as shown.

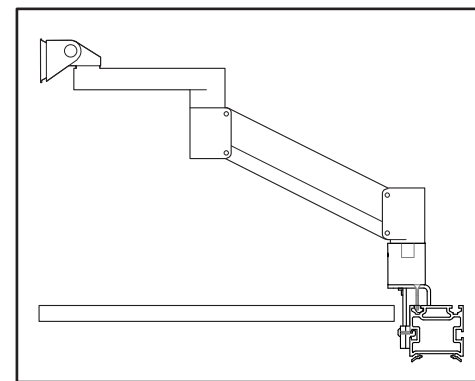
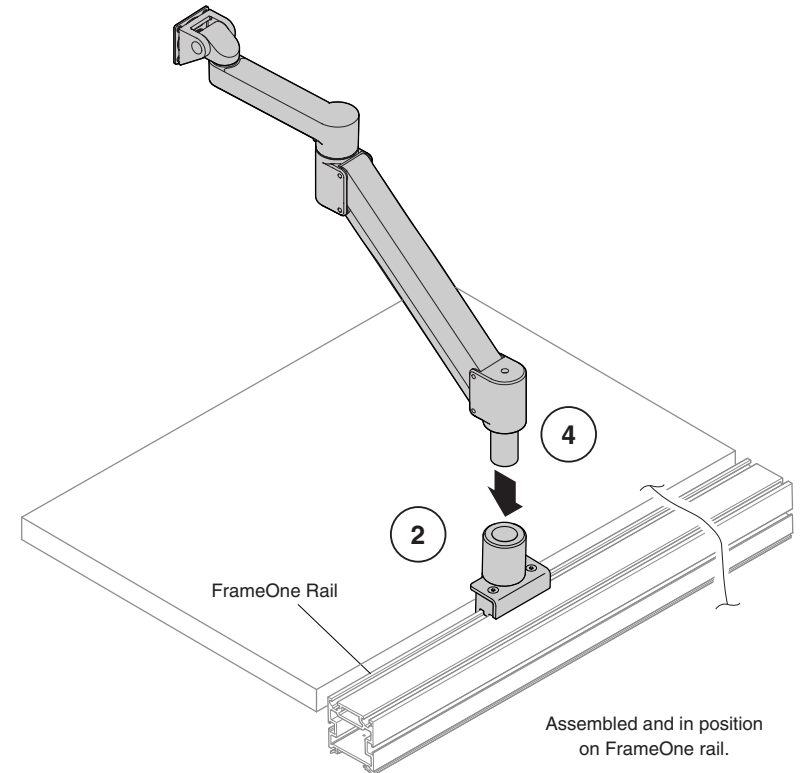
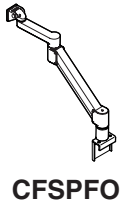

If you have a problem, question, or request, call your local dealer, or Steelcase Line 1 at **888.STEELCASE** (888.783.3522) for immediate action by people who want to help you.

(Outside the U.S.A., Canada, Mexico, Puerto Rico, and the U.S. Virgin Islands, call: 1.616.247.2500)

Or visit our website: www.steelcase.com

© 2015 Steelcase Inc.
Grand Rapids, MI 49501
U.S.A.

Printed in U.S.A.