

LOUNGE
(SHOWN WITH PILLOW - ONLY
AVAILABLE ON LOUNGE CHAIR)

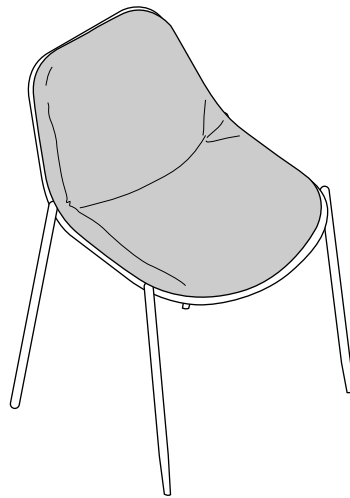

CHAIR

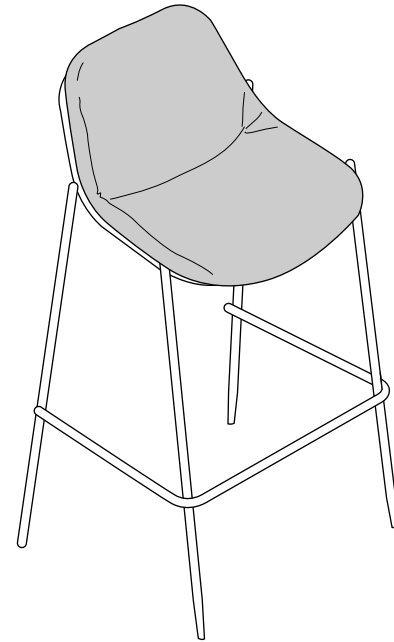

STOOL

If you have a problem, question, or request, call
your local dealer, or Coalesse at 1.800.627.6770
Or visit our website: www.coalesse.com

© 2010 Coalesse
San Francisco, California U.S.A.

Printed in U.S.A.

Installing the Chair Cushion onto a Chair

1. For the six (6) balls located on the cushion, press button on ball inward (1a) and slide ball off string (1b).

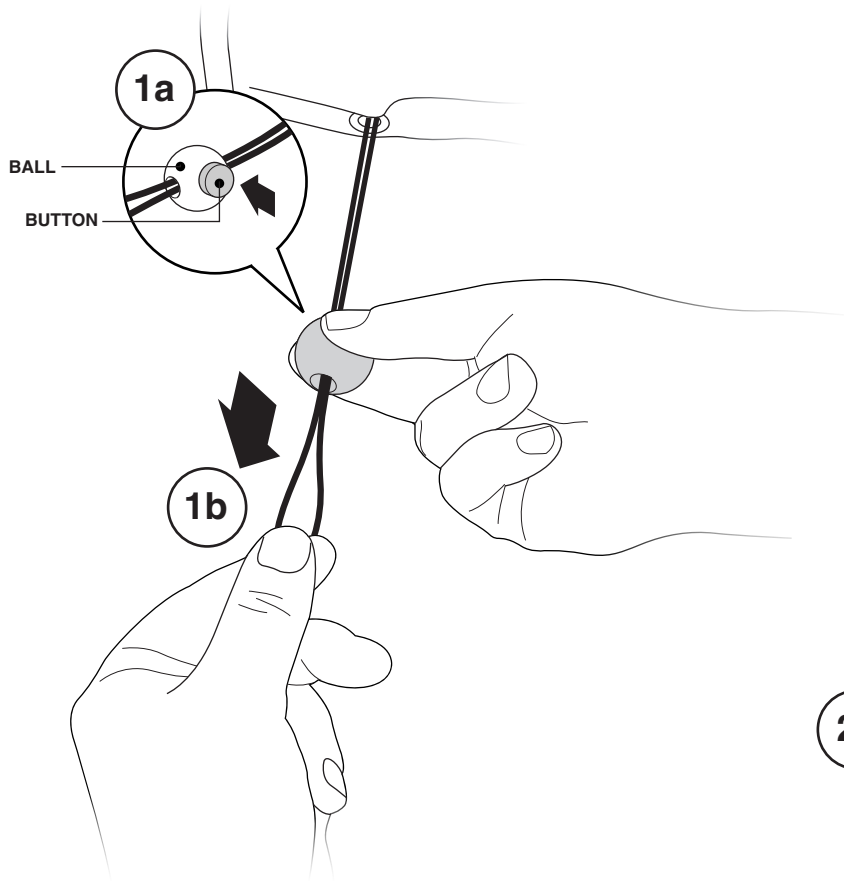

2. Place chair cushion in the center of the chair (2a). Slide the front two (2) strings through chair webbing (2b). Place ball back onto string and slide upward (2c) so it fits snugly against chair webbing.

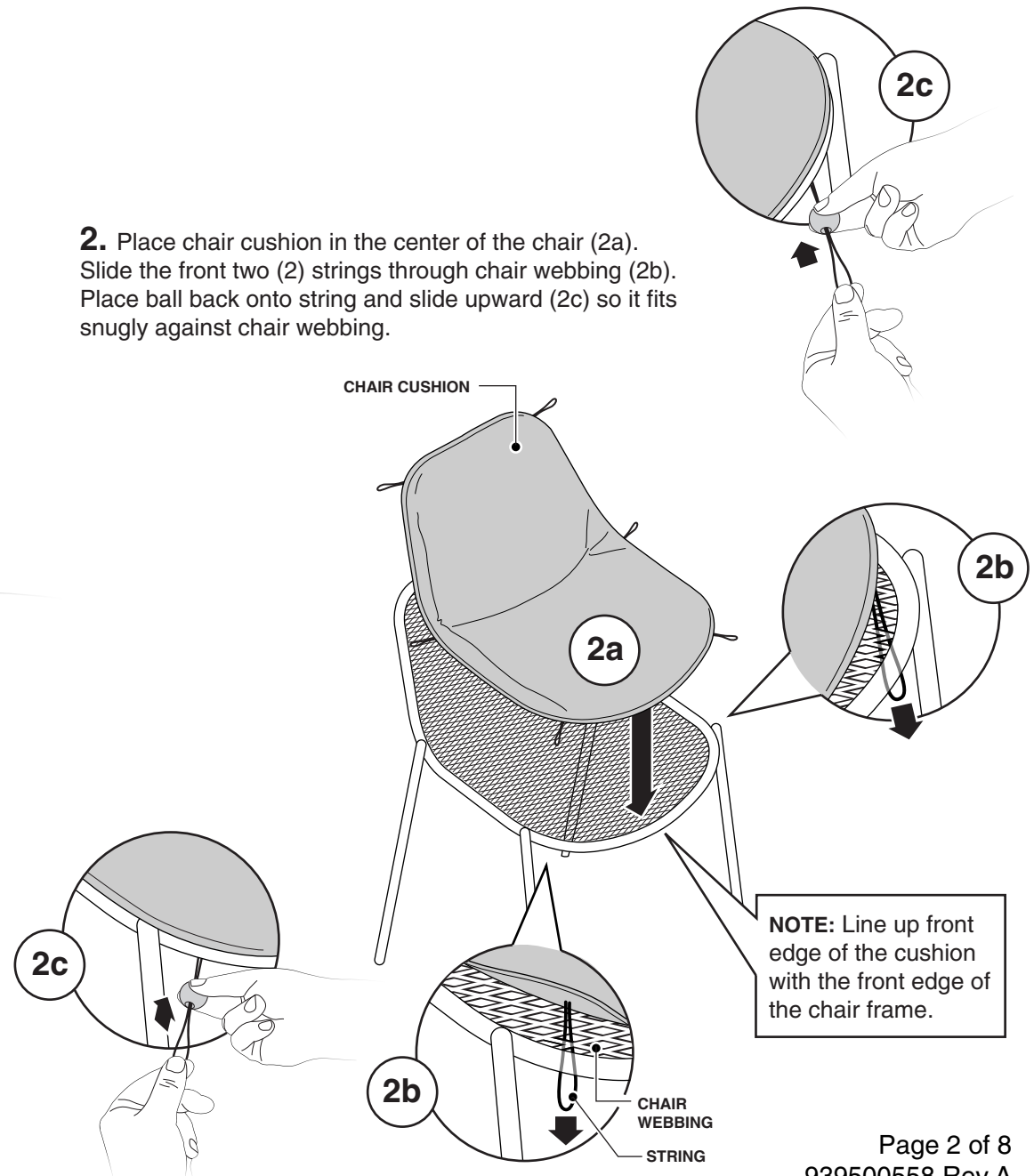

3. Slide the two (2) strings at the rear of cushion through chair webbing (3a). Place ball back onto string and slide upward (3b) so it fits snugly against chair webbing (3b).

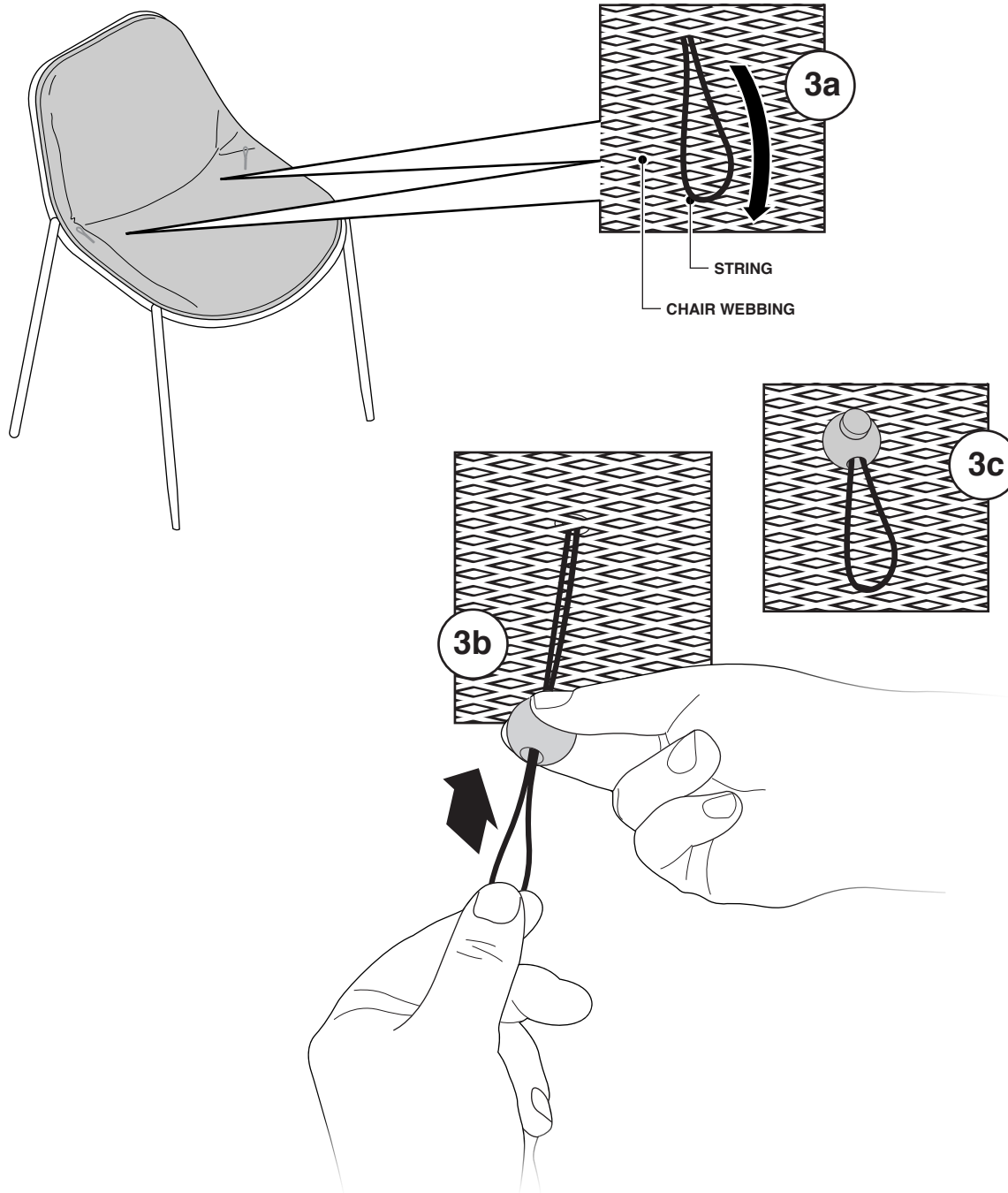

Installing the Chair Cushion onto a Stool

1. For the six (6) balls located on the cushion, press button on ball inward (1a) and slide ball off string (1b).

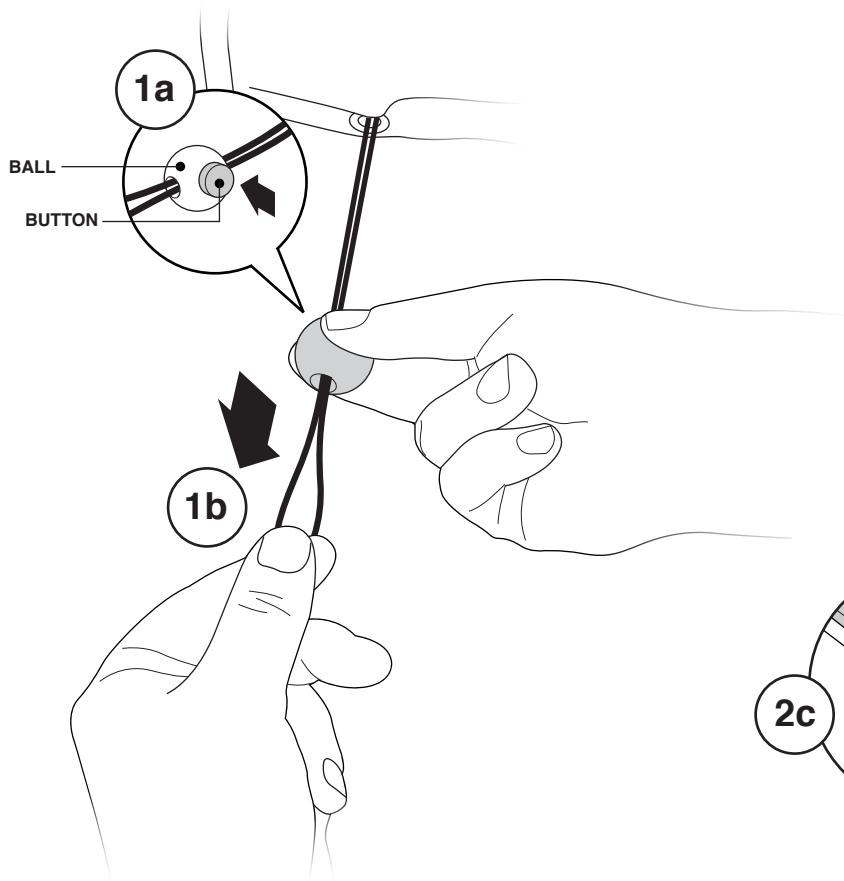

2. Place chair cushion in the center of the chair (2a). Slide the front two (2) strings through chair webbing (2b). Place ball back onto string and slide upward (2c) so it fits snugly against chair webbing.

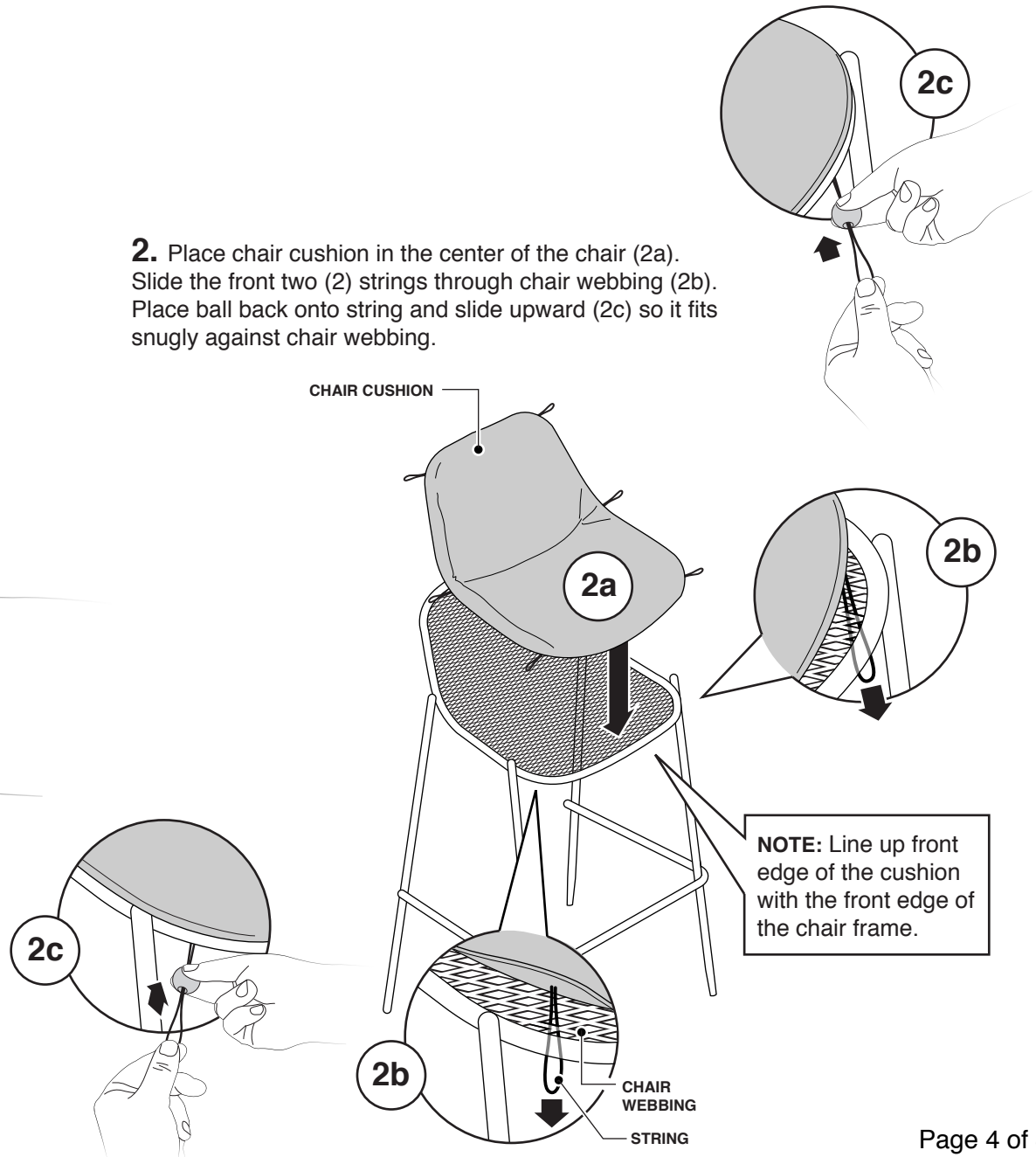

3. For the two (2) strings located on the side of the cushion, slide strings through chair webbing (3a). Place ball back onto string and slide upward (3b) so it fits snugly against chair webbing.

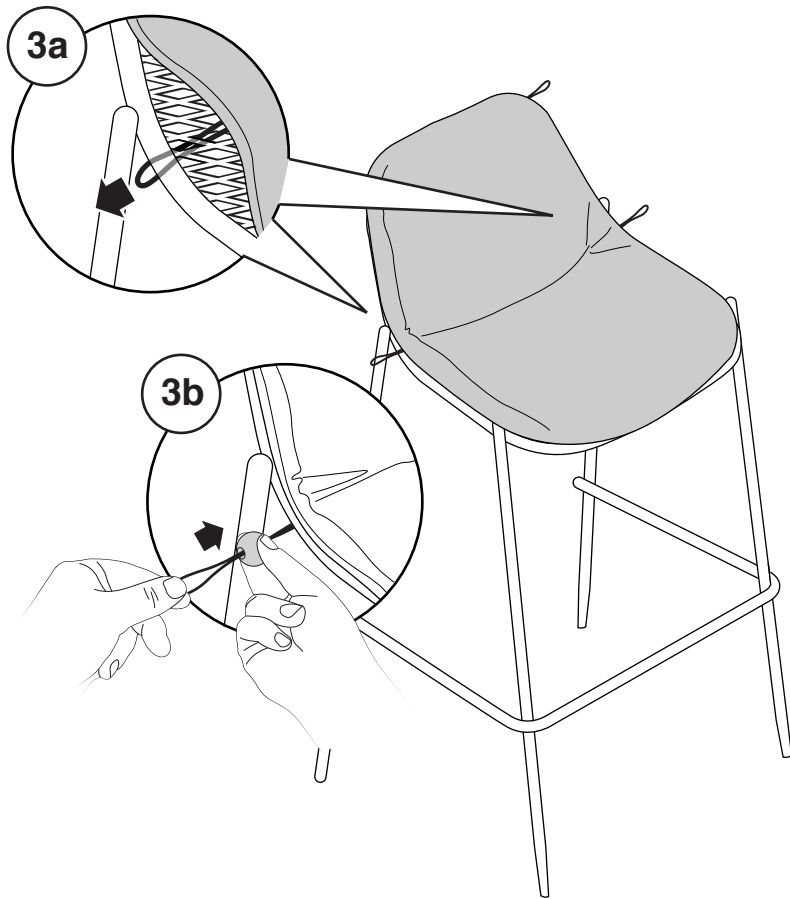

4. For the two (2) strings located at the top of the cushion, slide strings through chair webbing (4a). Place ball back onto string and slide upward (4b) so it fits snugly against chair webbing.

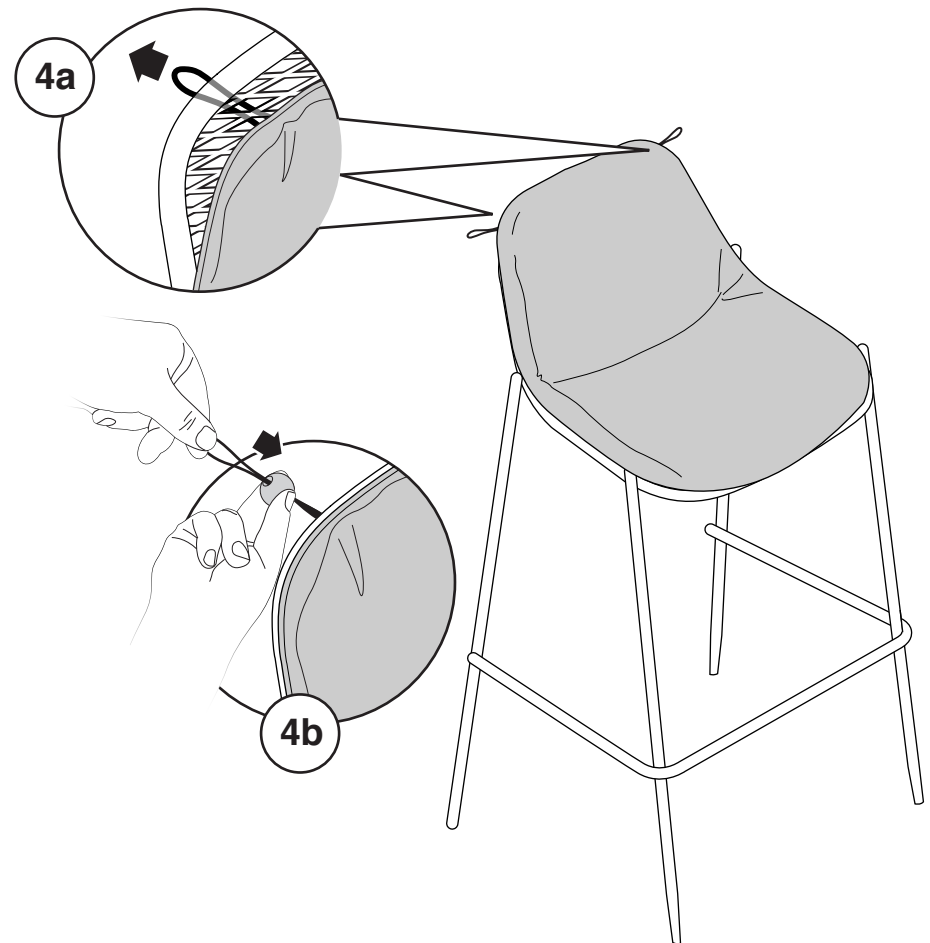

Installing the Chair Cushion onto a Lounge Chair

1. For the six (6) balls located on the cushion, press button on ball inward (1a) and slide ball off string (1b).

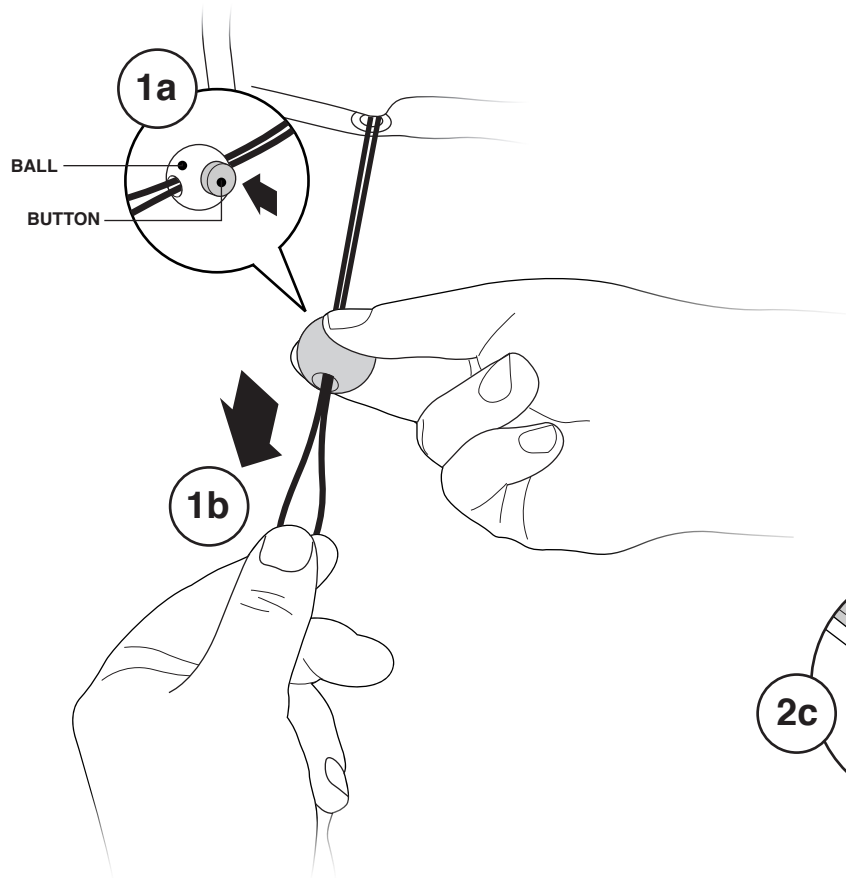

2. Place chair cushion in the center of the chair (2a). Slide the front two (2) strings through chair webbing (2b). Place ball back onto string and slide upward (2c) so it fits snugly against chair webbing.

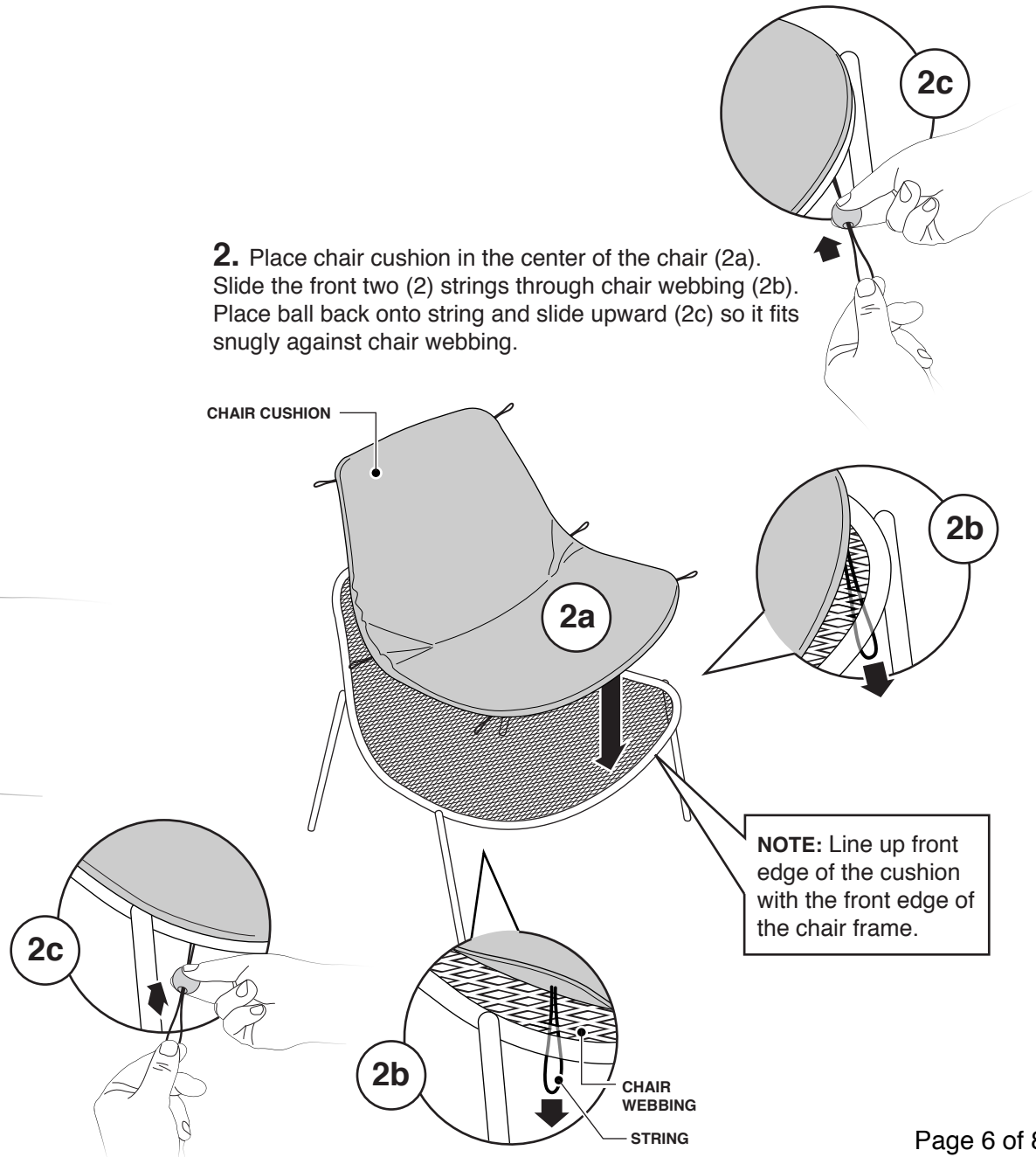

3. For the two (2) strings located on the side of the cushion, slide strings through chair webbing (3a). Place ball back onto string and slide upward (3b) so it fits snugly against chair webbing.

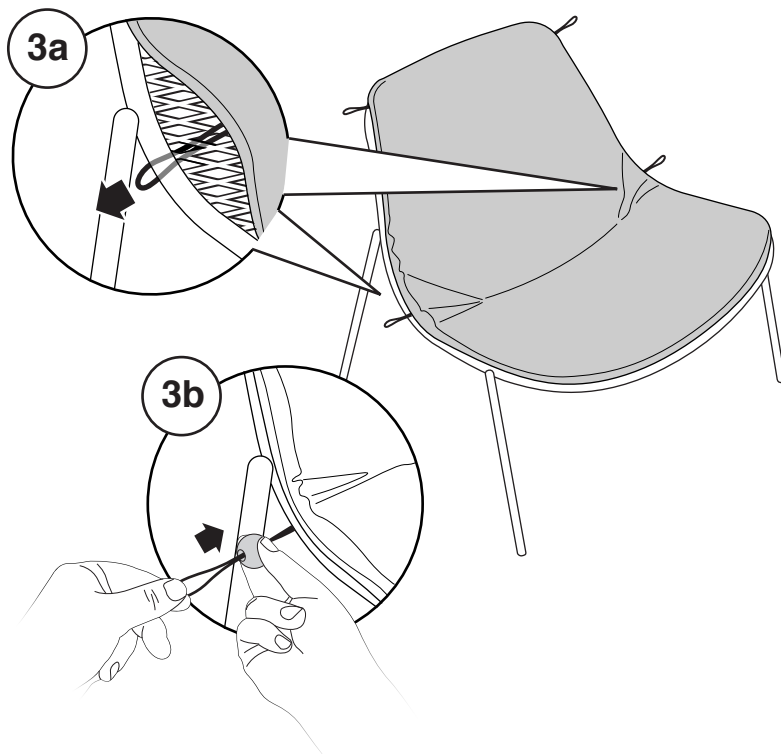

4. For the two (2) strings located at the top of the cushion, slide strings through chair webbing (4a). Place ball back onto string and slide upward (4b) so it fits snugly against chair webbing.

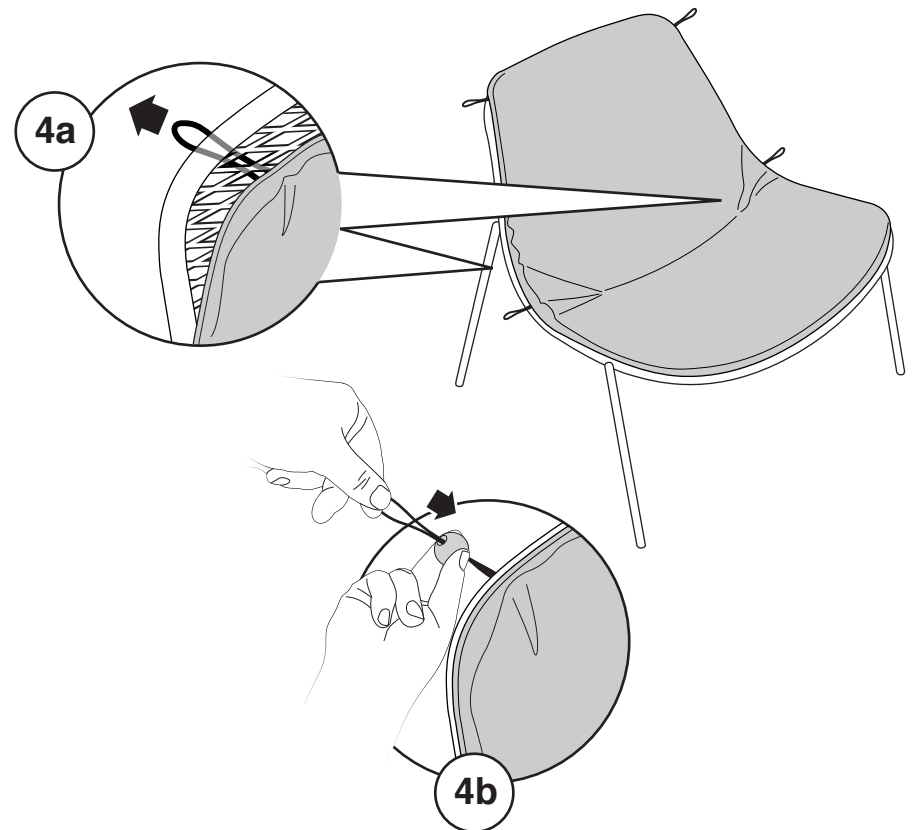

Installing a Pillow onto a Lounge Chair

1. For the two (2) balls located on the pillow, press button on ball inward (1a) and slide ball off string (1b).
2. Route two (2) pillow strings through the rain slit of chair cushion and then through the chair webbing (2a). Place ball back onto string and slide upward (2b) so it fits snugly against chair webbing (2c).

