

If you have a problem, question, or request, call your local dealer, or Steelcase Line 1 at 888.STEELCASE (888.783.3522) for immediate action by people who want to help you. (Outside the U.S.A., Canada, Mexico, Puerto Rico, and the U.S. Virgin Islands, call: 1.616.247.2500) Or visit our website: www.steelcase.com
© 2015 Steelcase Inc.
Grand Rapids, MI 49501
U.S.A.
Printed in U.S.A.

Assemble Gate Leg

1. Carefully turn table top over onto clean, soft surface.
2. Remove brackets and screws from hardware package.
3. Attach brackets to legs. Ensure that the channel in the bracket faces up (toward the thick plate). Use the 8-32 x .375" tri-lobe screws to attach the brackets at pilot hole locations.

3

Tip: Make sure that the torque control drill is set properly to prevent stripping of screws.

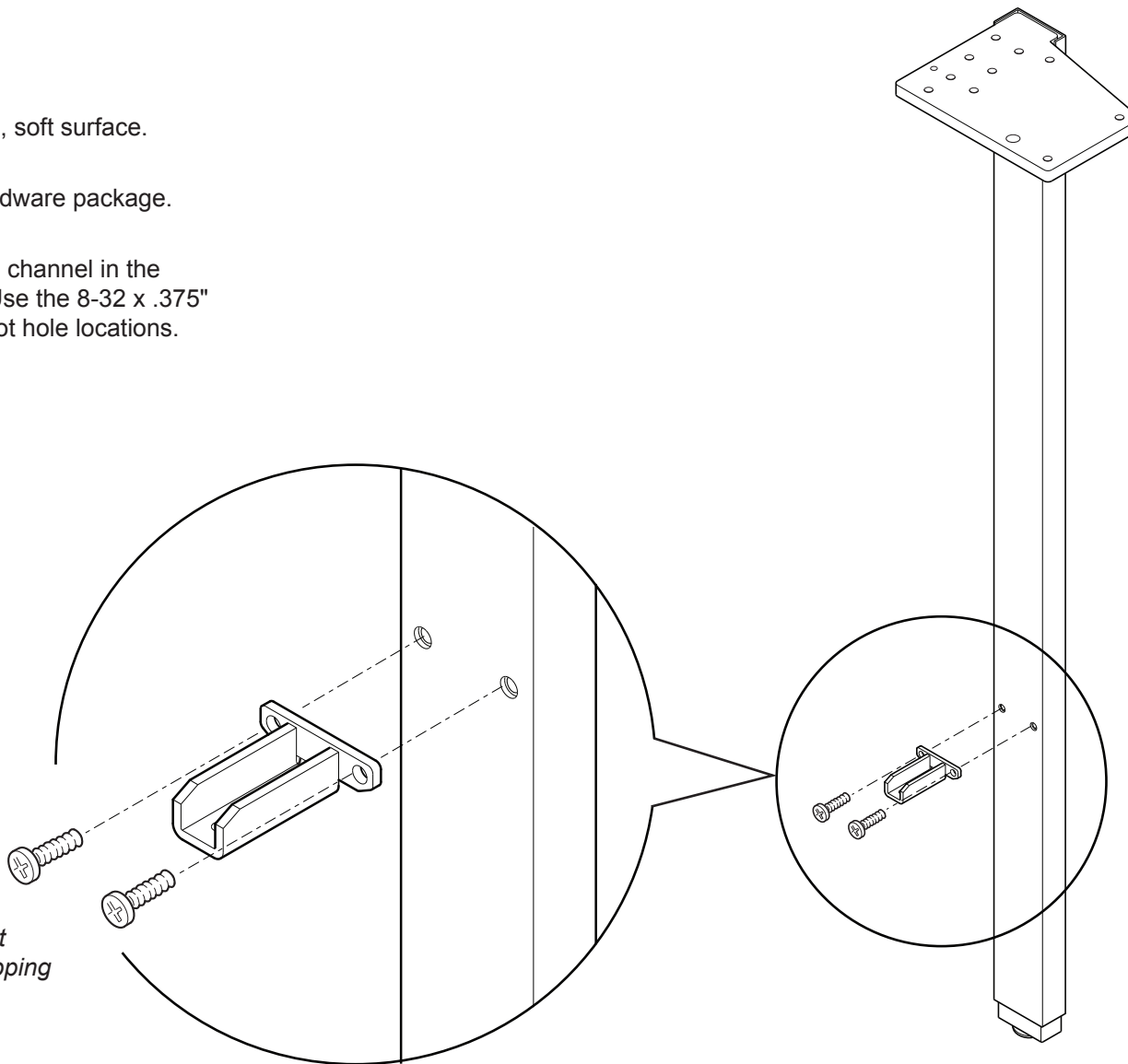

REPEAT FOR OTHER LEG

Assemble Gate Leg

4. Slide the crossbeam over the brackets. Ensure that it is tight to the legs. Use the #8 x .375 flat head screws with washers to attach the cross beam to the brackets.

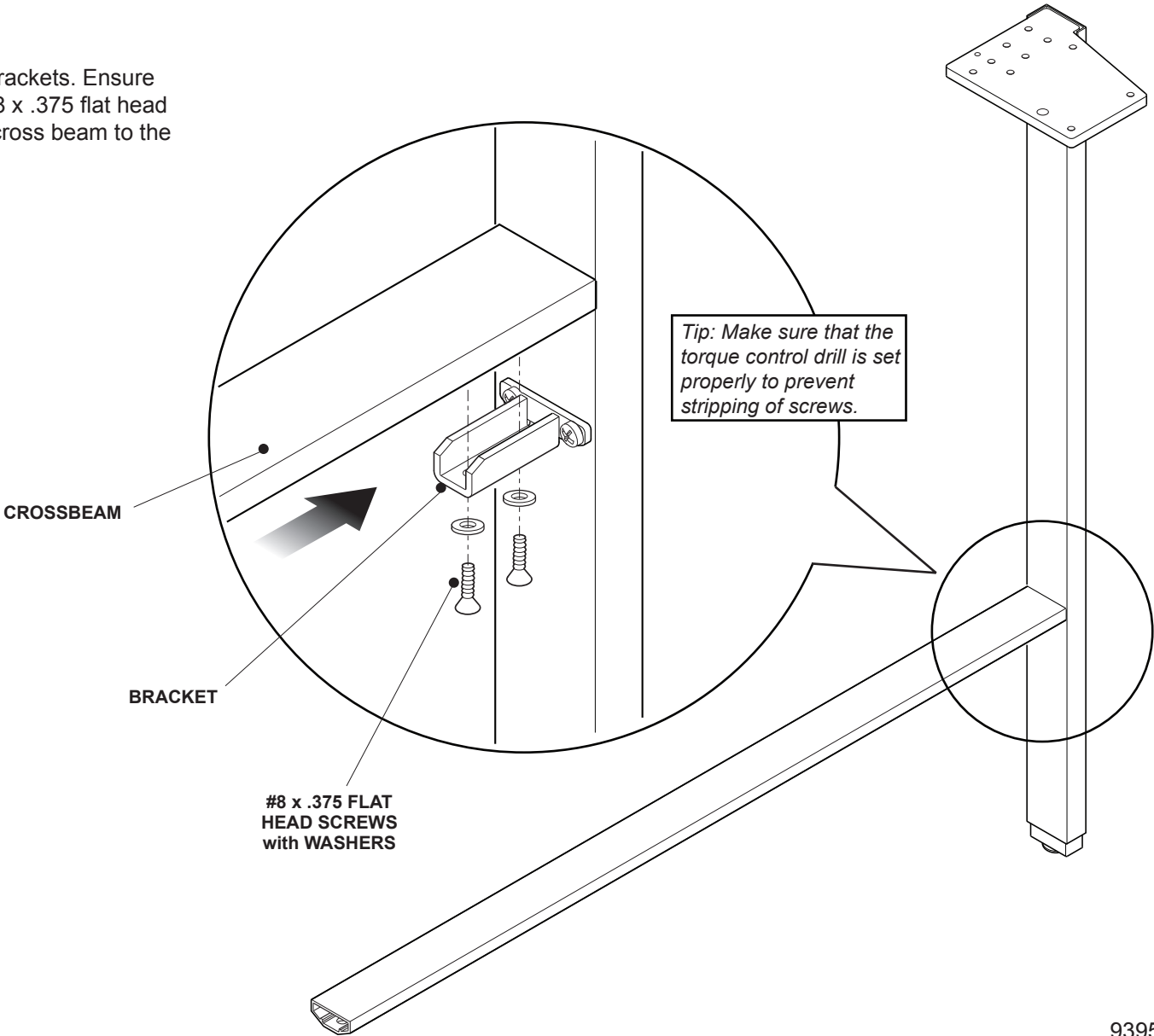

5. Turn leg frame over and attach the trim strip to the legs, making sure it is tight to each leg. Use #8 x .375 flat head screws to attach the trim.

6. Position the leg assembly so that it is centered on the top side to side and inset from the front $3/16"$.

7. Mark mounting plate holes onto the top and drill pilot holes. Use a $.125"$ diameter bit, making the holes approximately $3/4"$ deep.

FOR BLADE EDGE WORKSURFACES ONLY:
The outer surface of the gate leg must be inset from the edge of the worksurface by $3/4"$

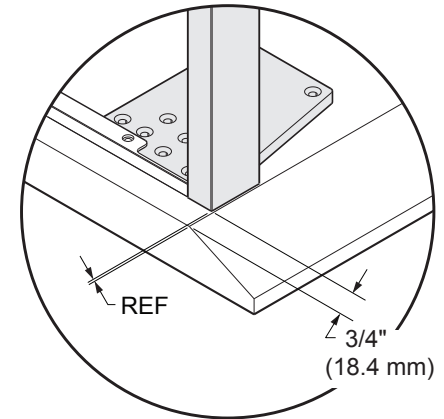
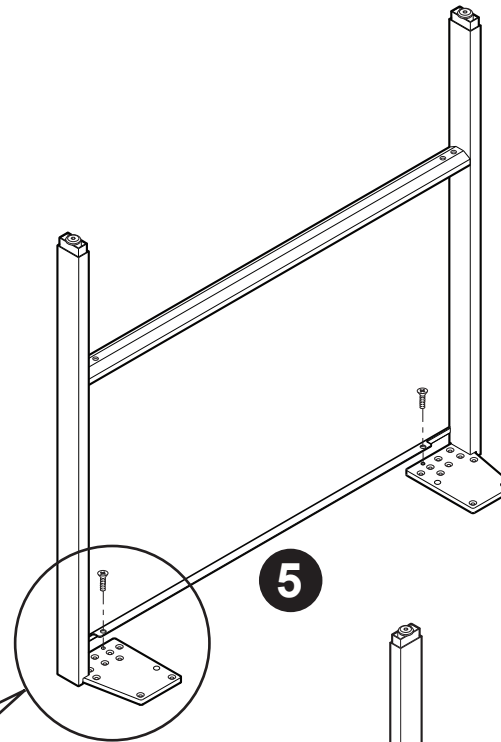

Tip: Make sure that the torque control drill is set properly to prevent stripping of screws.

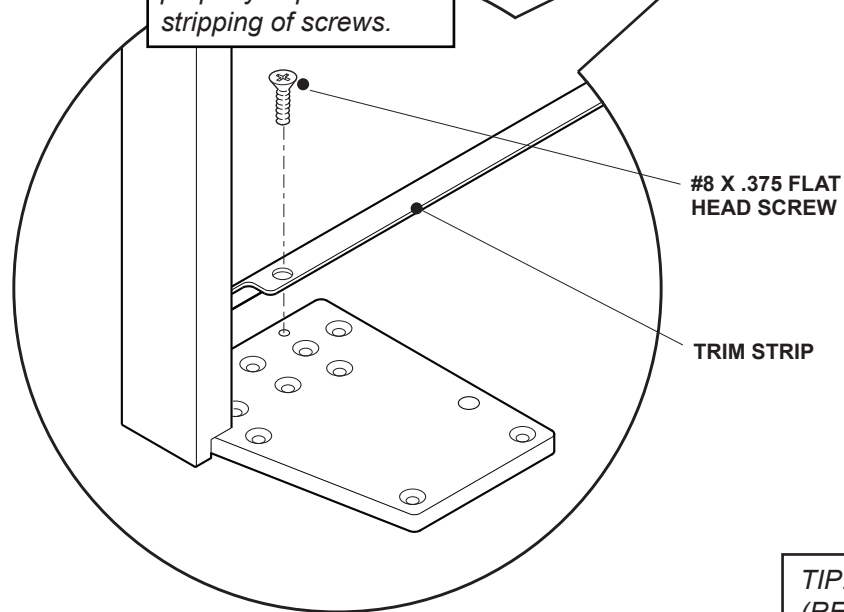

7 MAKE ALL HOLES WITH COUNTERSINKS

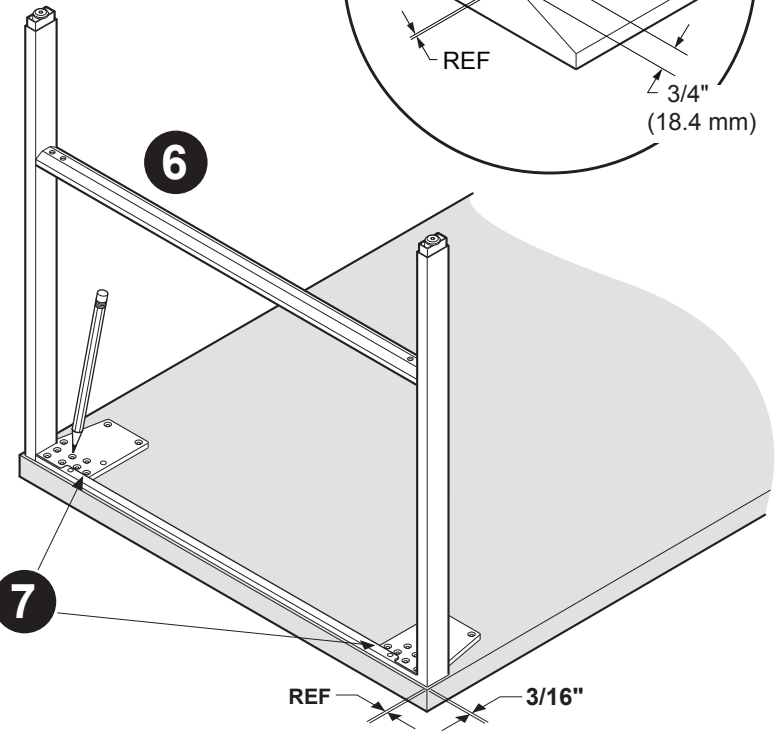

TIP: For back-to-back gate leg application, make this (REF) dimension zero or flush to back of worksurface.

REPEAT FOR OTHER SIDE

Assemble Legs to Top

8. Position the leg assembly on the top. Align holes in mounting bracket to holes drilled in top. Attach using the #10 x 1.5" flat head screws, (quantity - 10 per mounting bracket).

9. Carefully turn top and leg assembly over. Level the assembly by pulling the glide cover up and using glide adjustment wrench to adjust the glide.

Tip: To prevent damage to legs use a long extension and tape the legs.

Tip: Make sure that the torque control drill is set properly to prevent stripping of screws.

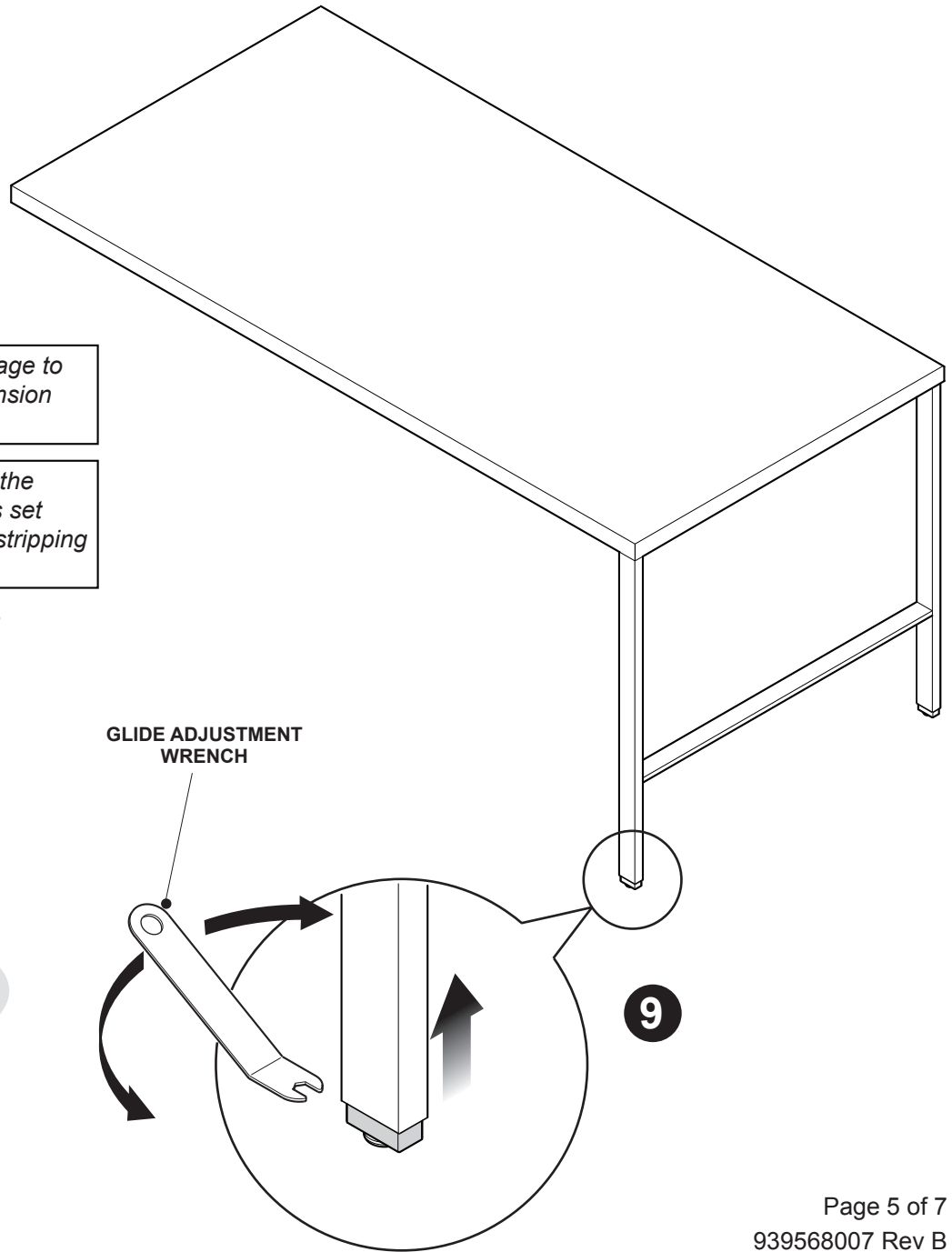
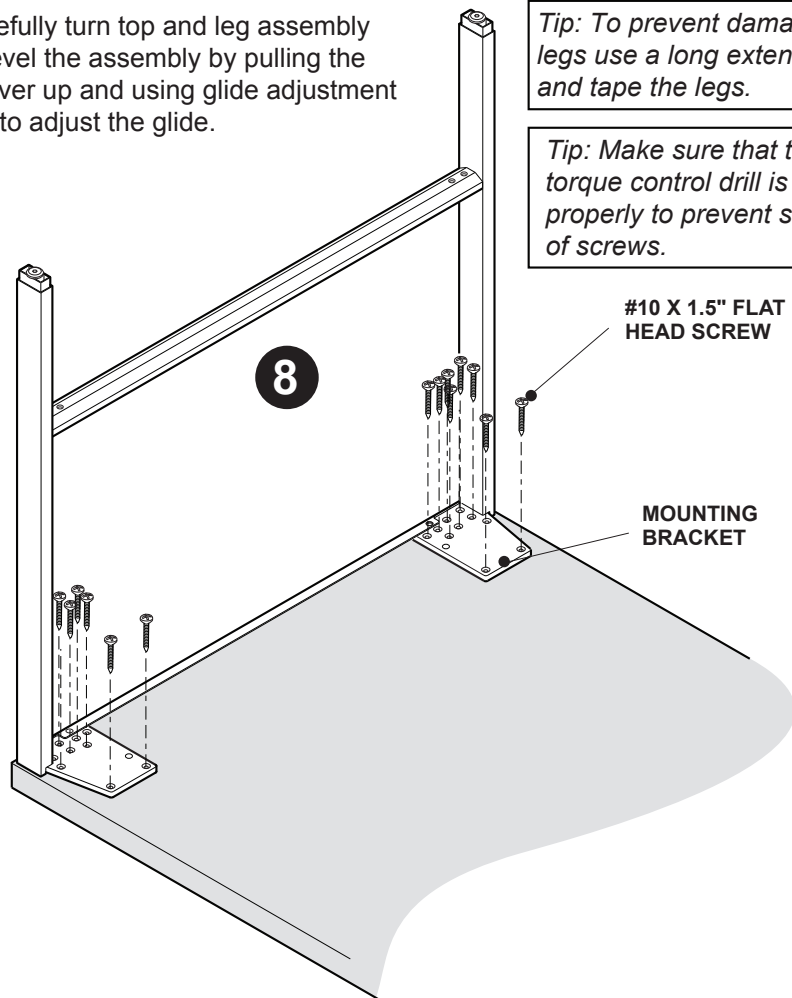

Back to Back Applications Only

1. Clamp the individual leg to the assembled leg ensuring that both legs are aligned in all directions.
2. Using the existing holes in the individual leg as a template, drill through into the assembled leg using a .125" drill bit. (Depth not to exceed 1.375").
3. Attach the bracket and individual leg to the assembled legs using two (2) 8-18 x 1.250" sheet metal screws.

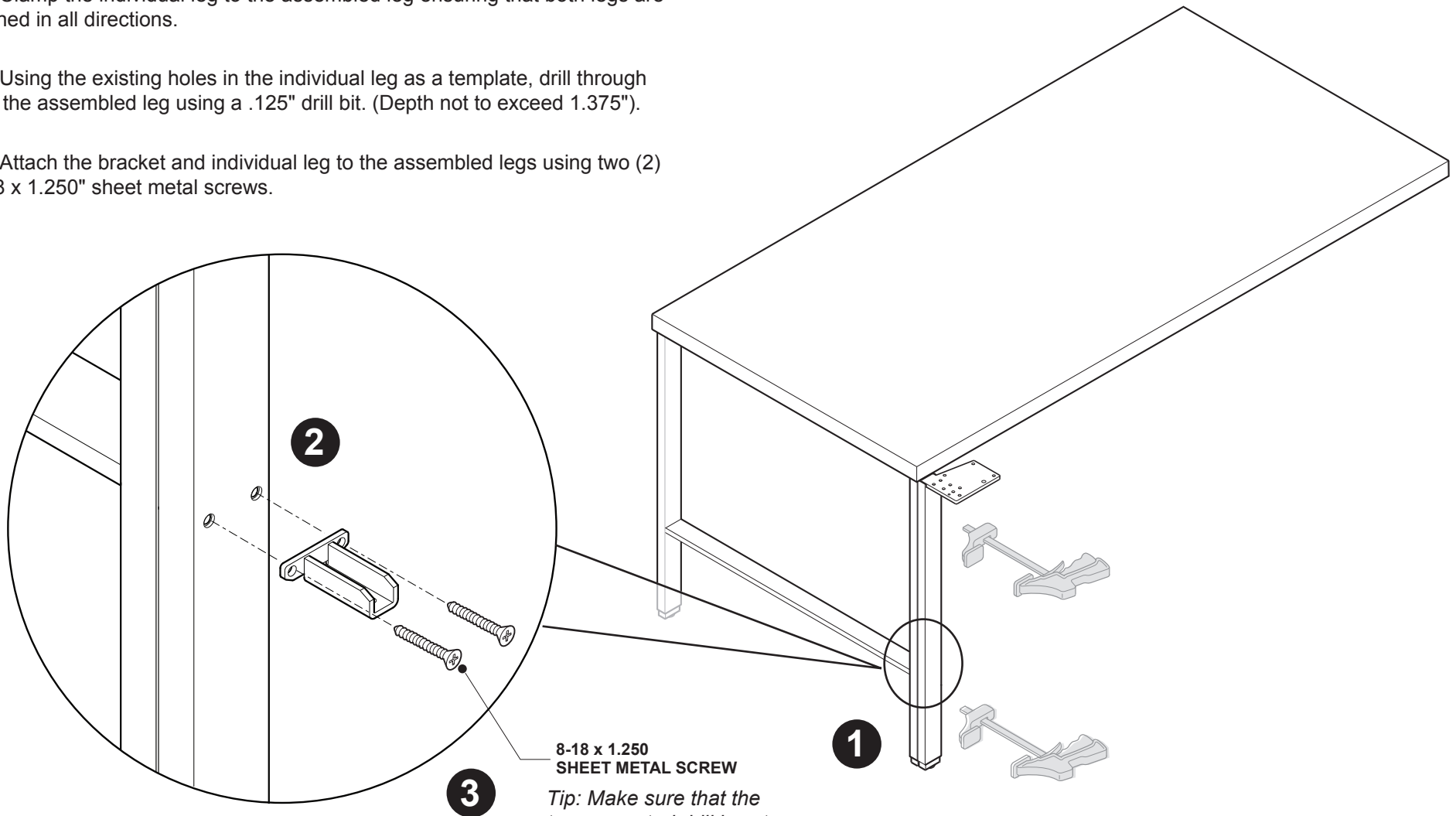

8-18 x 1.250
SHEET METAL SCREW

Tip: Make sure that the torque control drill is set properly to prevent stripping of screws.

Back to Back Applications Only

4. Finish attaching crosspiece, opposite leg and trim per instructions
5. Add worksurface, ensuring it's aligned to the other worksurface in all directions and attach to legs using ten (10) #10 x 1.500" flat head screws per bracket.
6. Attach (2) tie plates to underside of worksurfaces using supplied screws.

