

R2

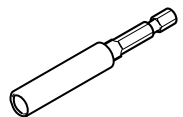

If you have a problem, question, or request, call your local dealer, or Steelcase Line 1 at **888.STEELCASE** (888.783.3522) for immediate action by people who want to help you.

(Outside the U.S.A., Canada, Mexico, Puerto Rico, and the U.S. Virgin Islands, call: 1.616.247.2500)

Or visit our website: [www.steelcase.com](http://www.steelcase.com)

© 2015 Steelcase Inc.  
Grand Rapids, MI 49501  
U.S.A.

Printed in U.S.A.

## Attaching Access Legs to a Chevron, Team or Rectangle Worksurface

**1.** Place worksurface upside down on a clean, scratch resistant surface, such as on a table.

**2.** Align the marked identification holes on the leg top plate with the pilot holes as shown. Install #10 x 1" wood screws into the three (3) pilot hole locations (2a).

**Install six (6) wood screws in the remaining hole locations on the leg top plate (2b).**

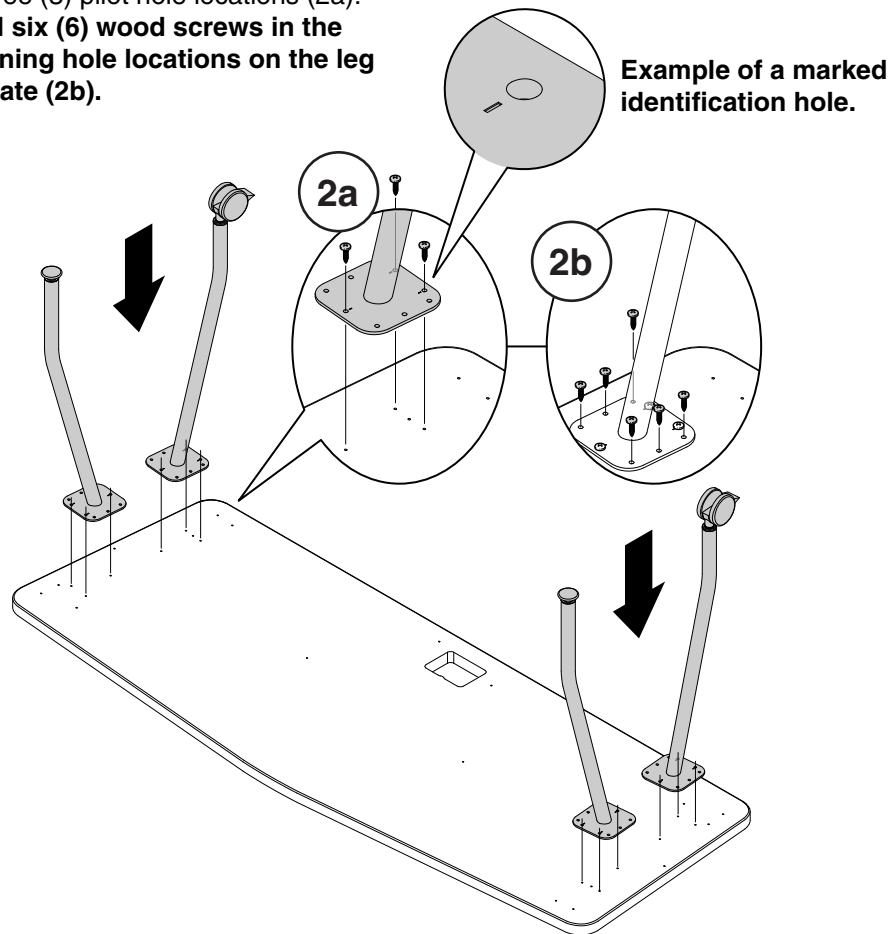

Align the marked identification holes with the inward most pilot holes.

**NOTICE: DO NOT** install Access (Fixed Height) legs in the hole pattern for the Post (Height-Adjustable) legs.

A properly installed leg will have a caster or glide that does not extend past the edge of the worksurface.

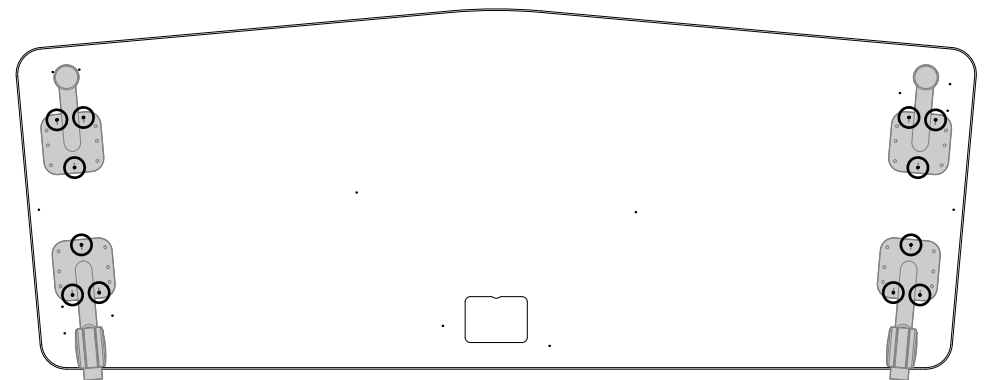
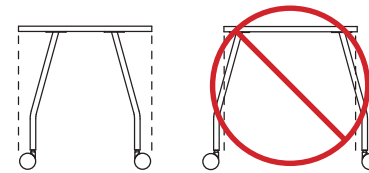

## Attaching Seated Height-Adjustable Legs to a Chevron, Team or Rectangle Worksurface

**1.** Place worksurface upside down on a clean, scratch resistant surface, such as on a table.

**2.** Align the marked identification holes on the leg top plate with the pilot holes as shown. Install #10 x 1" wood screws into the three (3) pilot hole locations (2a). **Install six (6) wood screws in the remaining hole locations on the leg top plate (2b).**

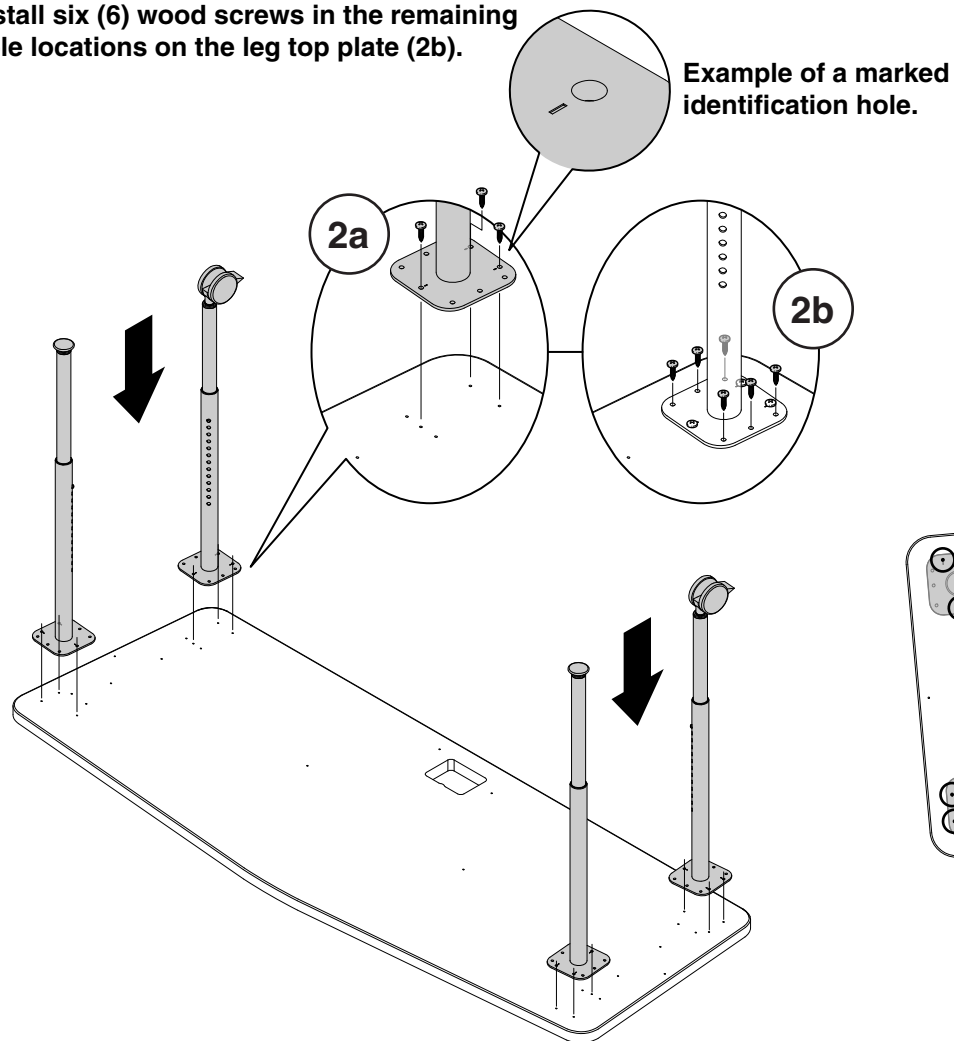

**CAUTION - TIP OVER HAZARD**



**Failure to follow these instructions could affect the stability of the table.**

**NOTE:** There are separate pilot holes for Post (Height-Adjustable) legs AND Access (Fixed Height) legs. Post legs should only be installed using the outward most pilot holes (2a).

**DO NOT** install Post legs using the pilot holes for Access legs.

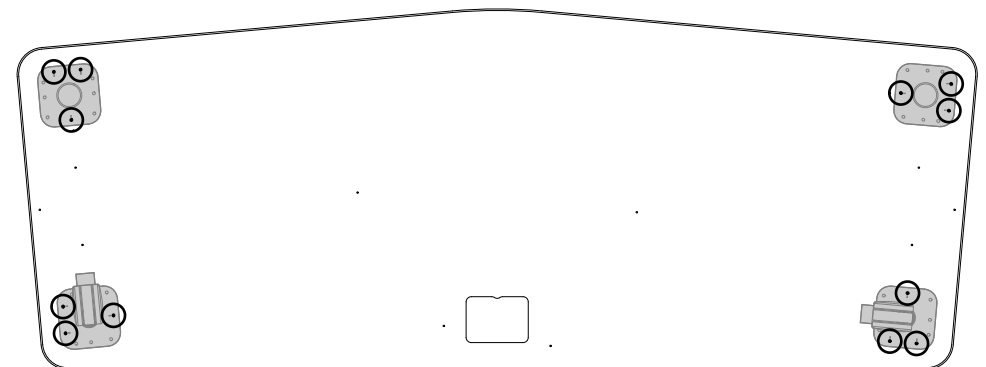
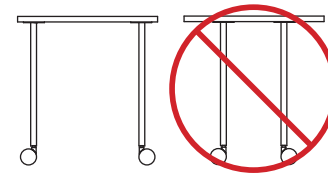

## Attaching Standing Height-Adjustable Legs to a Chevron, Team or Rectangle Worksurface

**1.** Place worksurface upside down on a clean, scratch resistant surface, such as on a table.

**2.** Align the teardrop shaped holes on the leg top plate with the pilot holes as shown. Install #10 x 1" wood screws into the three (3) pilot hole locations (2a). **Install six (6) wood screws in the remaining hole locations on the leg top plate (2b).**

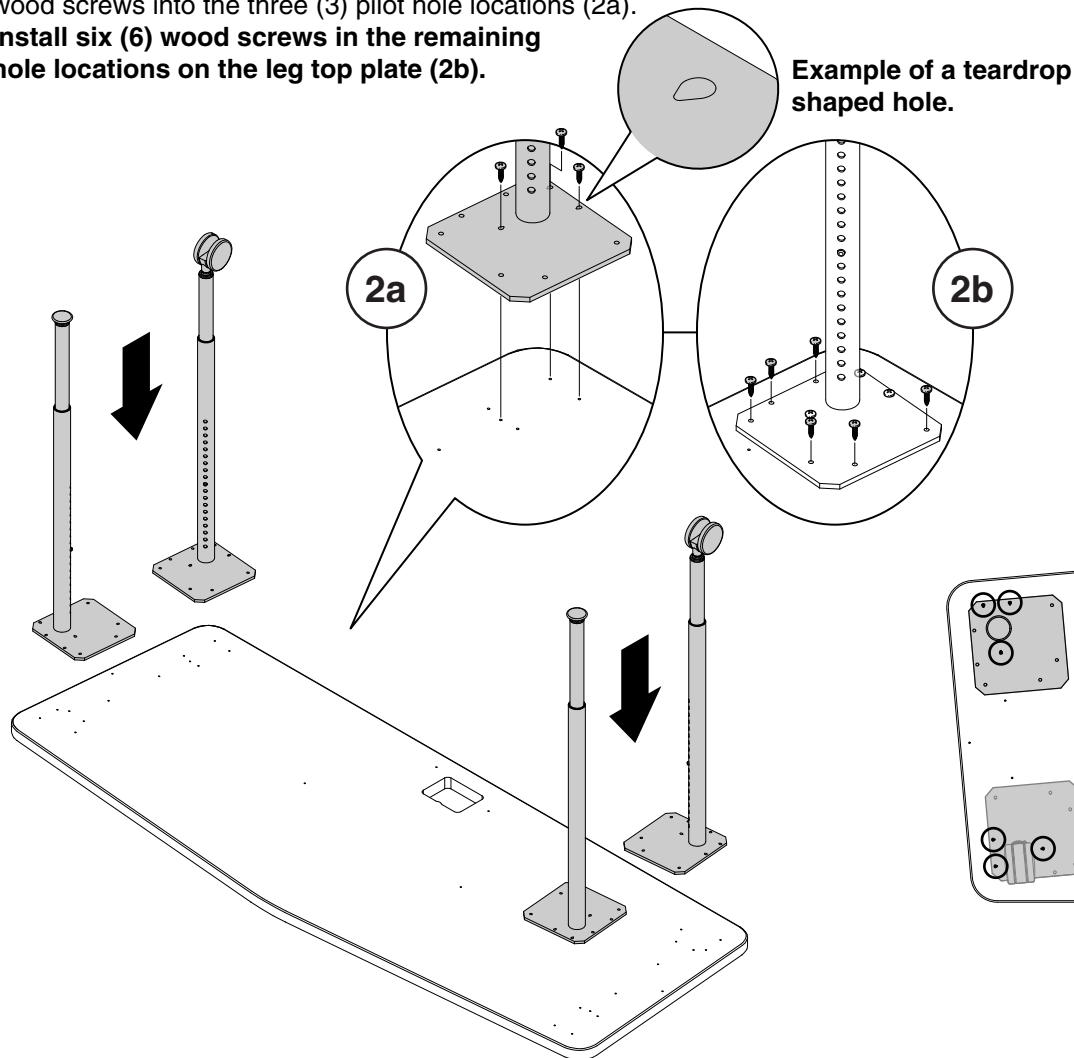

**CAUTION - TIP OVER HAZARD**



Failure to follow these instructions could affect the stability of the table.

**NOTE:** There are separate pilot holes for Post (Height-Adjustable) legs AND Access (Fixed Height) legs. Post legs should only be installed using the outward most pilot holes (2a).

**DO NOT** install Post legs using the pilot holes for Access legs.

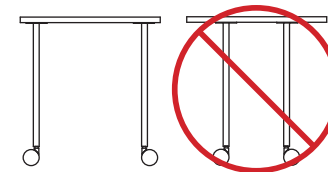

## BRACE INSTALLATION

**3.** Align the holes on the brace with the pilot holes as shown. Install #10 x 1" wood screws into the two (2) pilot hole locations (3a). **Install wood screws in the remaining hole locations on the brace (3b).**

**48" or 57" BRACE  
for all other size tables**

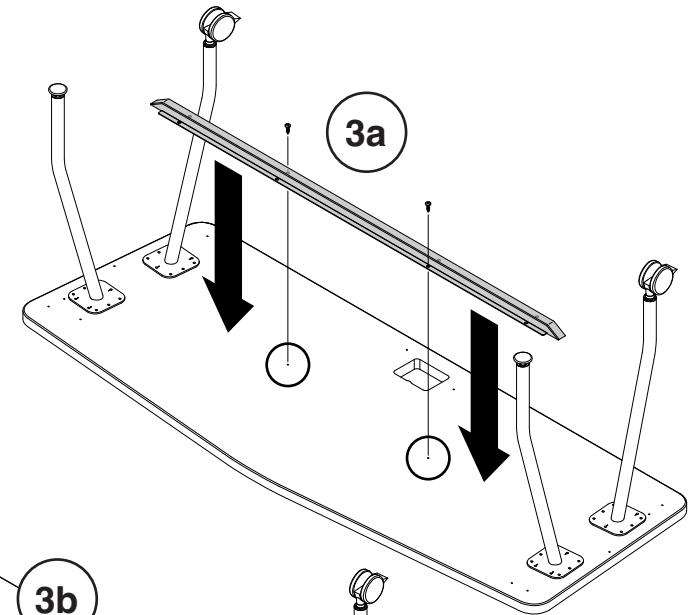

**69" BRACE  
for 84" long tables**

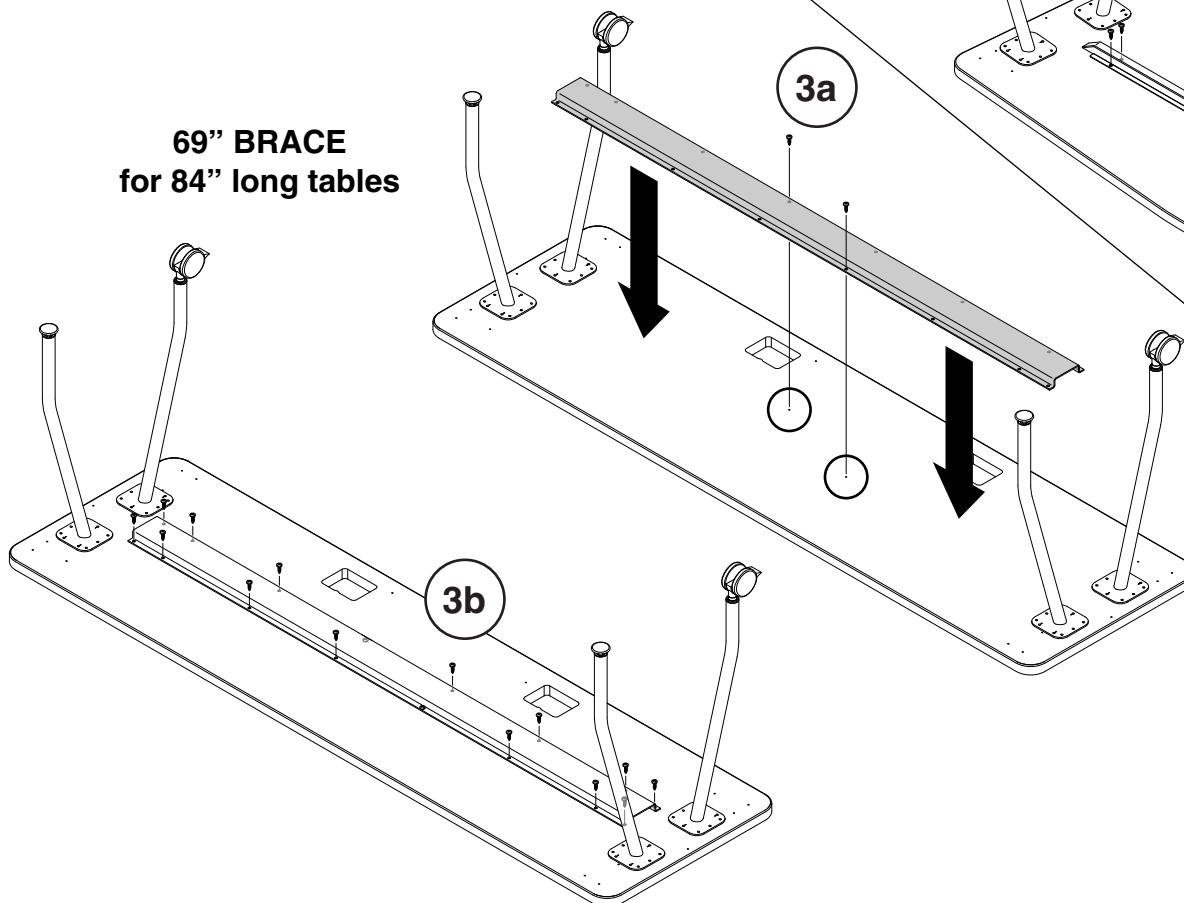

## Optional Modesty Panel

**4.** Align the holes on the modesty panel with the pilot holes as shown. Install #10 x 1" wood screws into the two (2) pilot hole locations (4a).  
**Install wood screws in the remaining hole locations on the modesty panel (4b).**

**5.** Align the middle hole on the side hook and side dock with the pilot hole as shown. Install #10 x 1" wood screws into the pilot hole locations (5a).  
**Install two (2) wood screws in the remaining hole locations on the side hook and side dock (5b).**

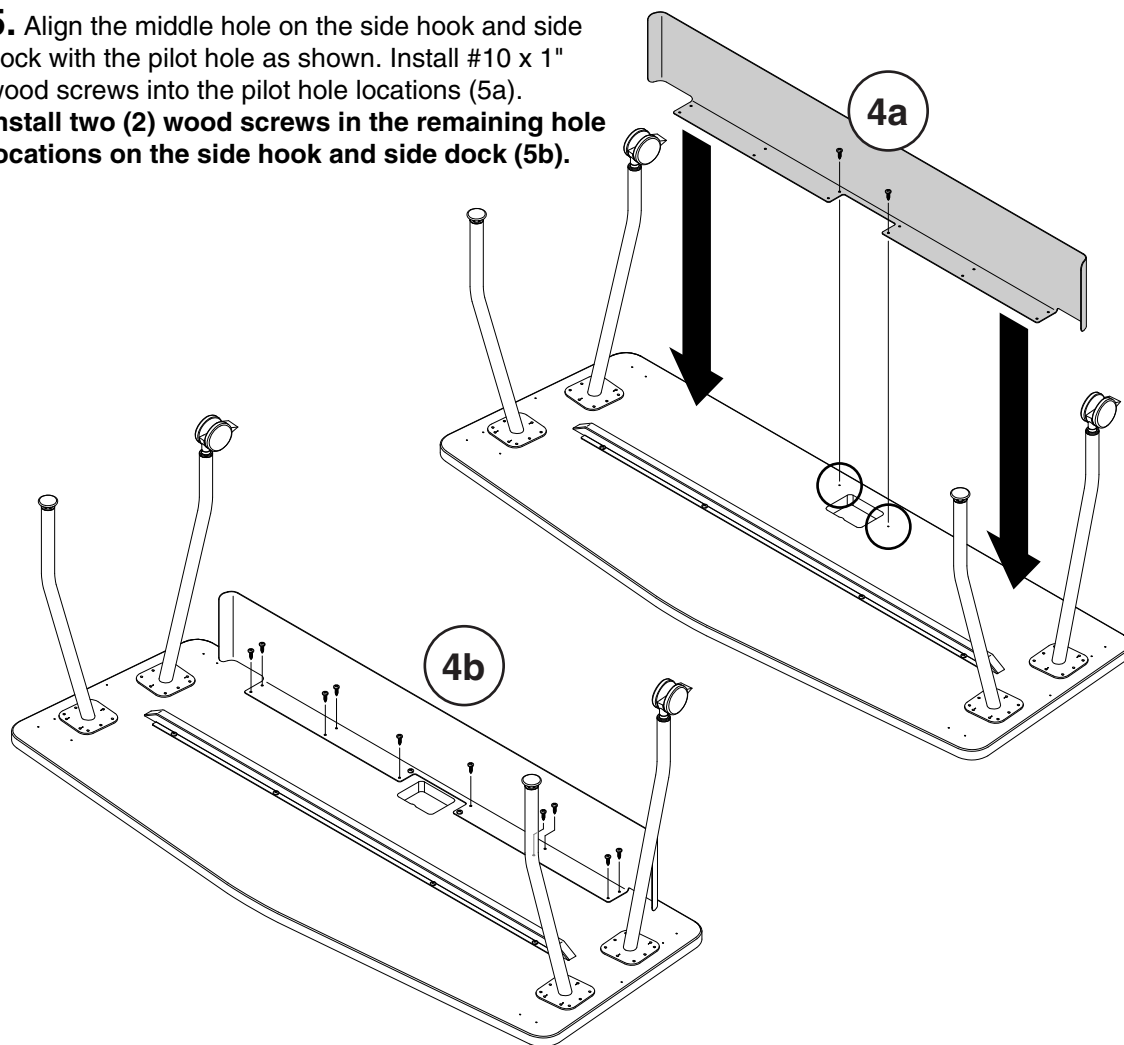

## Optional Side Hooks & Side Docks

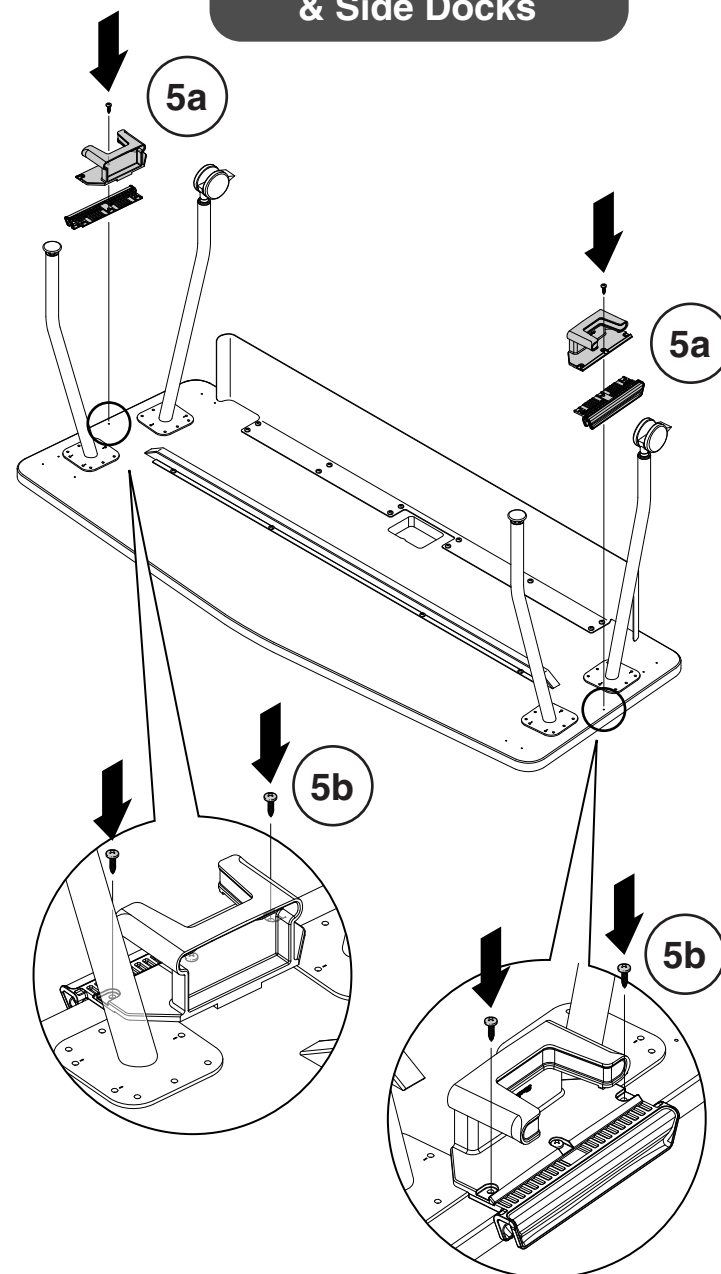

## Optional Center Dock

**6.** Use two (2) or more people (depending on the size and weight) to lift table and place upright.

**7.** Squeeze snap features together (7a) and insert the center dock into the hole in the worksurface (7b). Repeat if there is more than one (1) center dock.

