

If you have a problem, question, or request, call your local dealer, or Steelcase Line 1 at **888.STEELCASE** (888.783.3522) for immediate action by people who want to help you.

(Outside the U.S.A., Canada, Mexico, Puerto Rico, and the U.S. Virgin Islands, call: 1.616.247.2500)

Or visit our website: [www.steelcase.com](http://www.steelcase.com)

© 2015 Steelcase Inc.  
Grand Rapids, MI 49501  
U.S.A.

Printed in U.S.A.

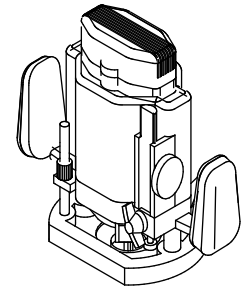

**ROUTER**  
(SEE 'TOOL TIPS'  
ON PAGE 2)

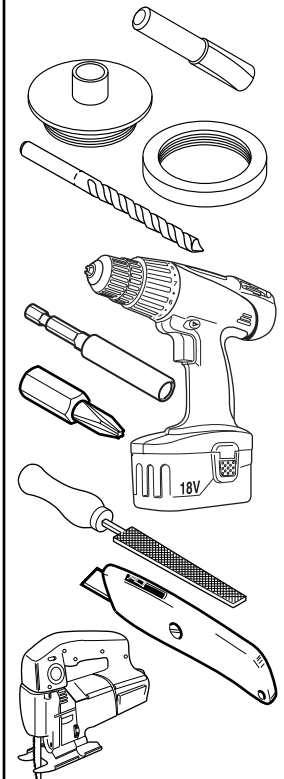

**1.** Install router bit and template guide onto router.

**2.** Scribe horizontal & vertical lines at desired hole location(s).

**3.** Align and attach template to back of skin according to desired position using screws provided.

**4.** Remove material inside of small template.

**TIP:** For steel and fabric skins, route hole 1/16" short of full depth.

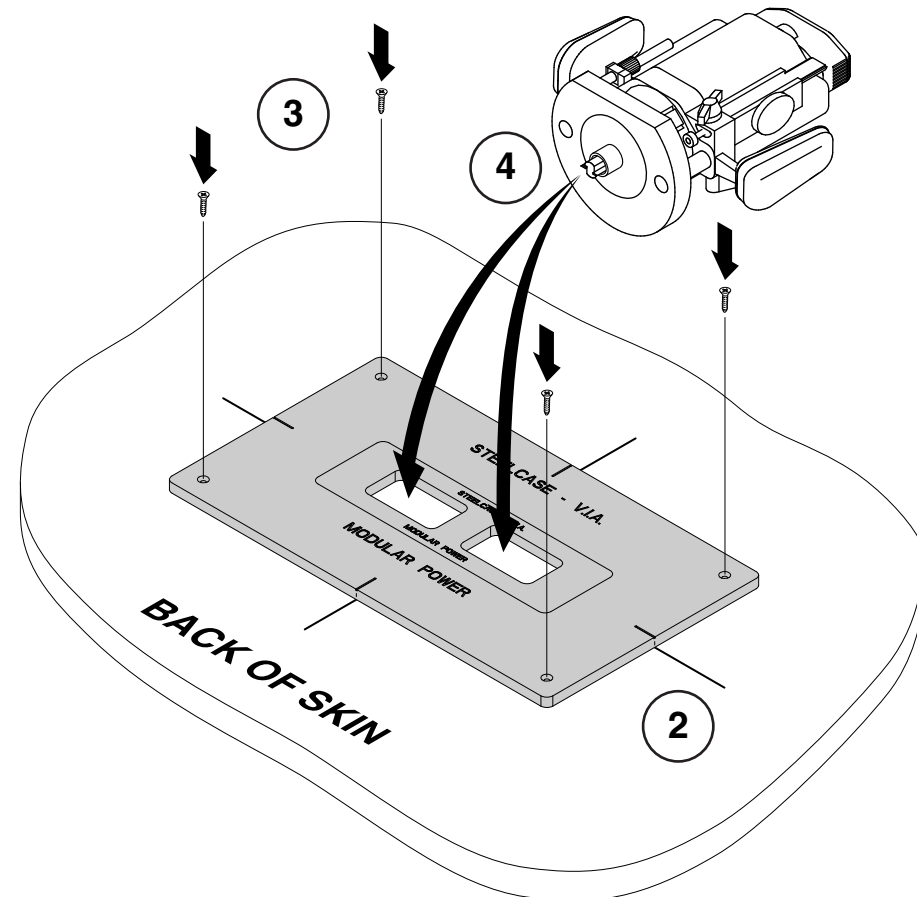
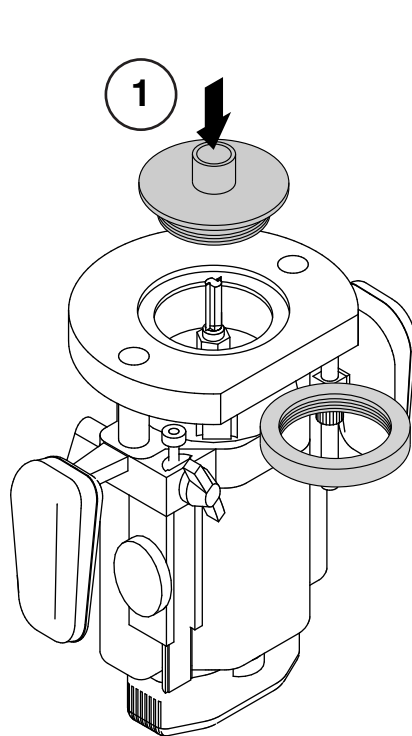

## Tool Tips:

- Router - Select a router that is made to receive a template guide.
- Router Bit - 3/8" x 1" cut with 1/4" shank carbide tipped double flute straight bit.
- Template Guide - 1/2" outside diameter made for 3/8" bit.
- Screws (Supplied with kit) - #8-15 x 3/4" tapping flat head.

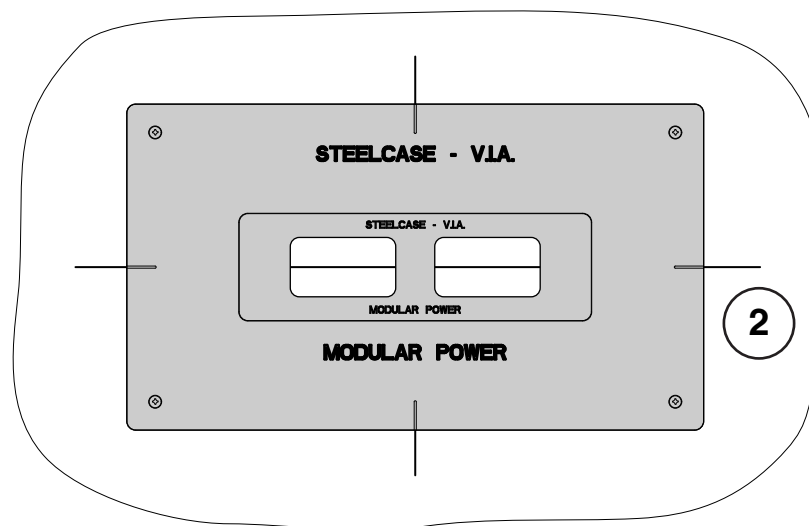

5. Drill 1/4" diameter holes at the corners of the small template cut.

**TIP:** For fabric skins, use a soft board as a backing plate.

6. Remove the small template (6a) and route recess hole (6b) to depth:

	Veneer	Steel	Fabric	Markerboard
Modular Power -	5/16"	11/32"	3/8"	11/32"
Modular Data -	13/32"	13/32"	7/16"	7/16"

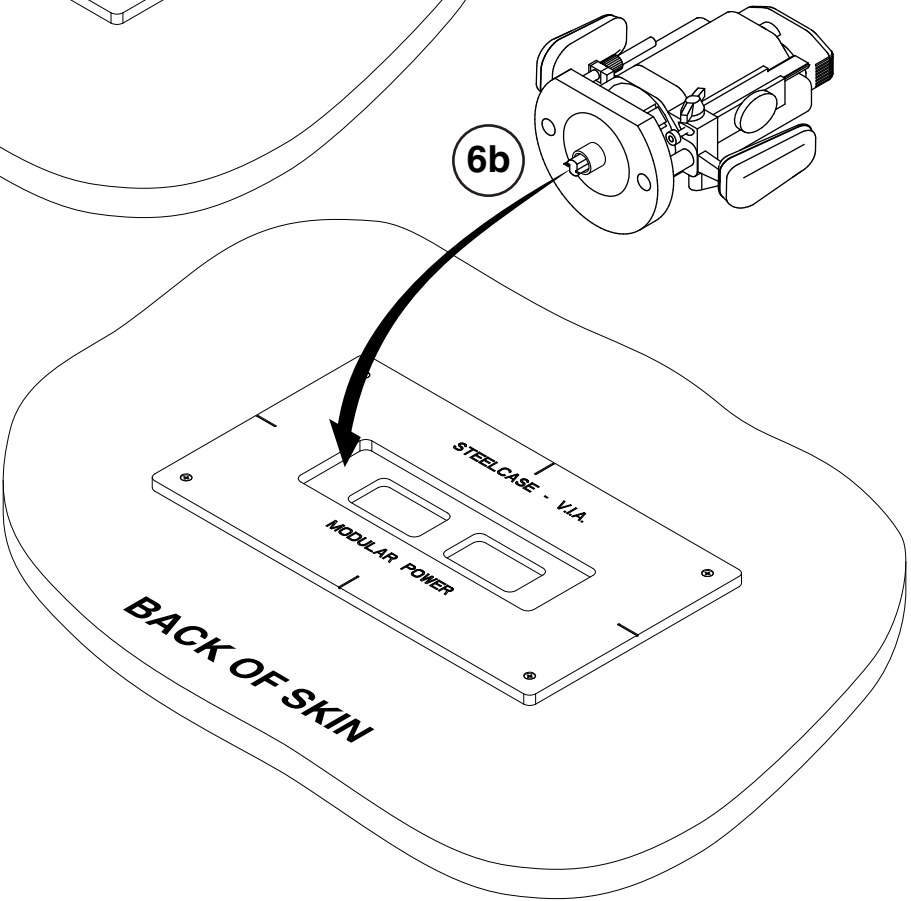
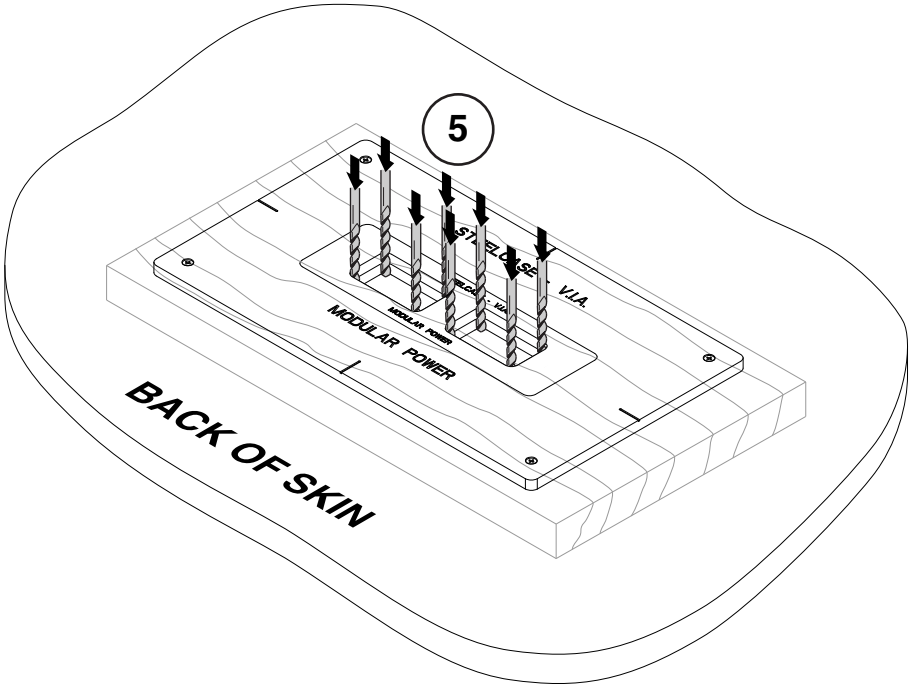
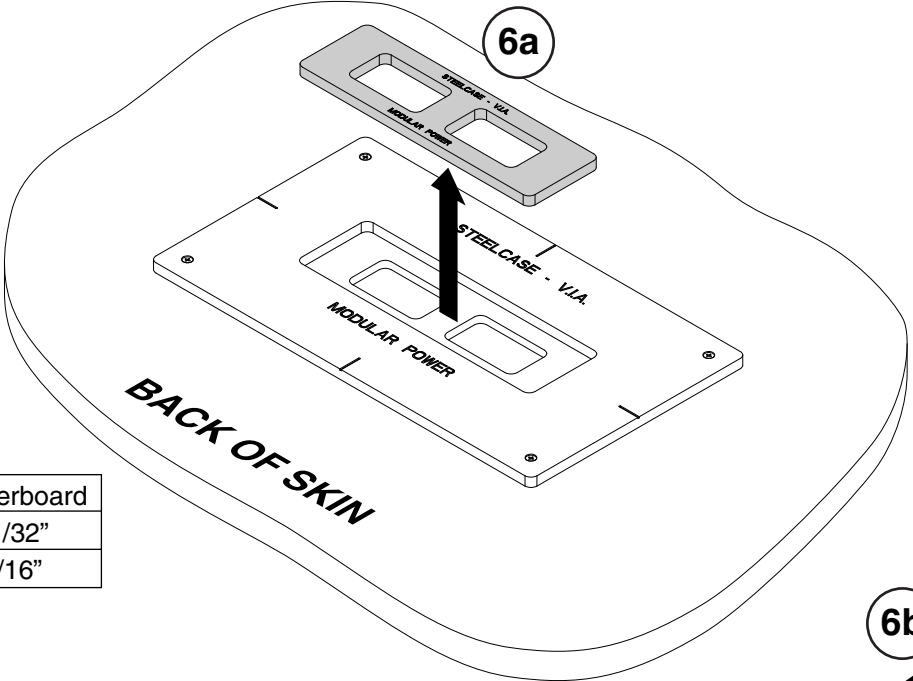

**7.** Trace-out and remove fabric within hole.

**8.** Use a jig saw to cutout the perimeter of the hole using the routed edge as a guide.

**TIP:** Route from back of skin to protect the fabric or paint surface.

**9.** File cut edges and ensure bezel fits securely.

