

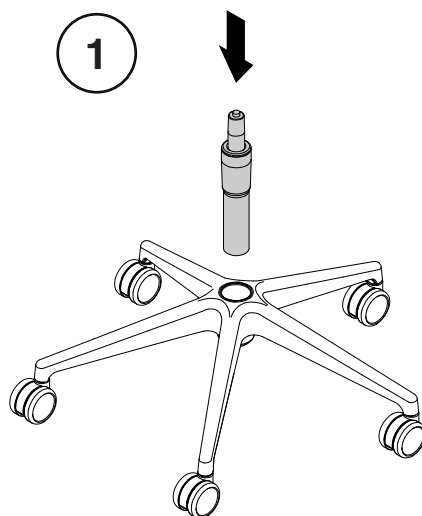

Scan this QR code to watch a video on how to assemble Series 1



For Chair Assembly



For Stool Assembly

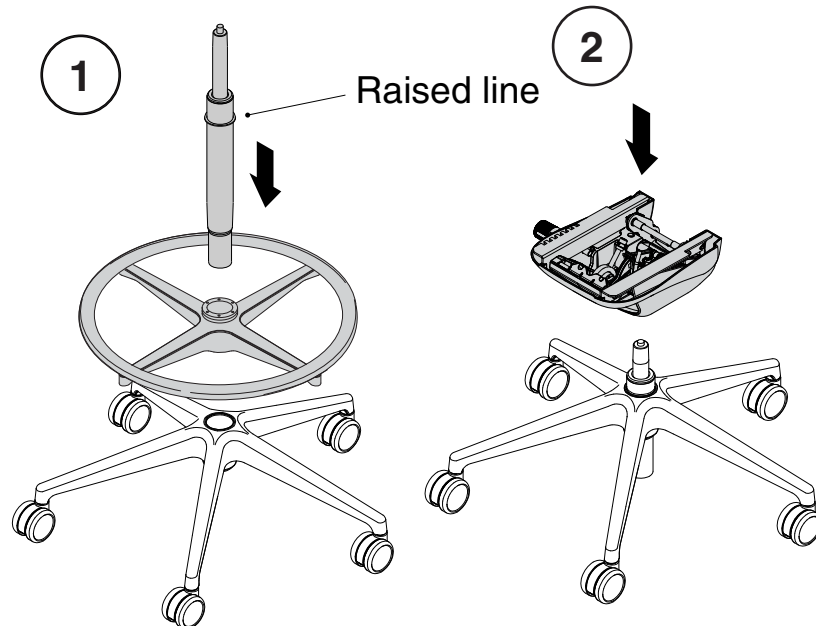

2

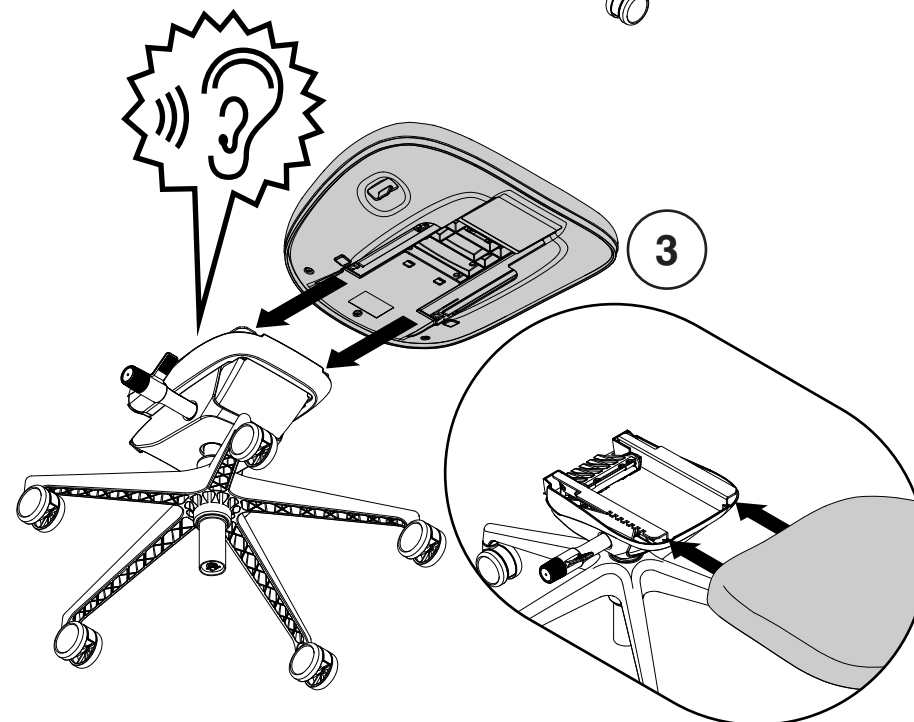
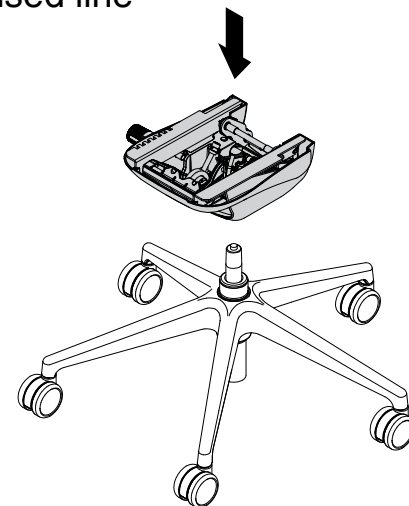

For Stools, slide the stool foot ring onto the cylinder up to the raised line and turn the foot ring clockwise to tighten. Insert the cylinder into the base.

Note: To adjust the foot ring height, turn the foot ring counterclockwise to loosen from the cylinder, and re-tighten at the desired height by turning it clockwise.

