

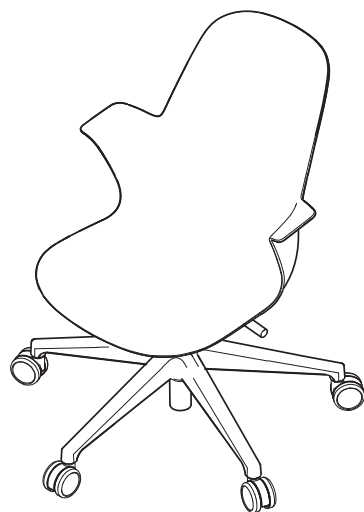

480 Node Chair
with Worksurface
Page 2

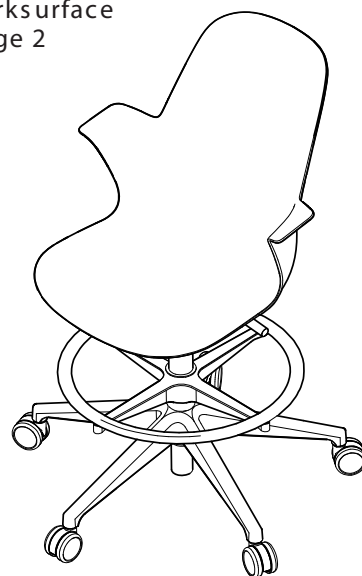

480 Node Chair
Page 1



480 Node Stool
Page 3

If you have a problem, question, or request, call your local dealer, or Steelcase Line 1 at 888.STEELCASE (888.783.3522) for immediate action by people who want to help you.

(Outside the U.S.A., Canada, Mexico, Puerto Rico, and the U.S. Virgin Islands, call: 1.616.247.2500)
Or visit our website: www.steelcase.com

© 2010 Steelcase Inc.
Grand Rapids, MI 49501
U.S.A.

Printed in U.S.A.

480 Node™ 5-Arm Base Chair (with or without Worksurface) and Stool for KD

480 Node Chair

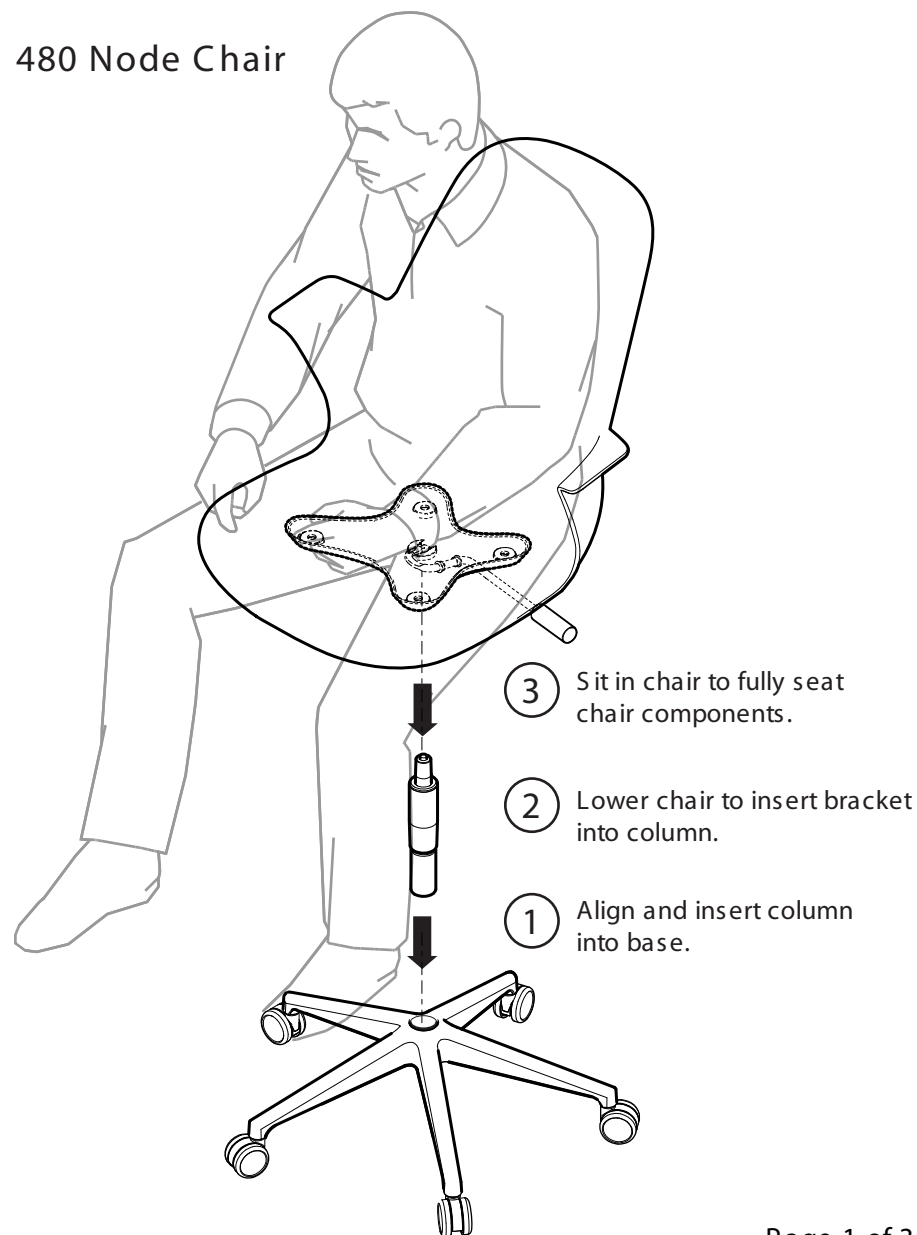

480 Node Chair with Worksurface

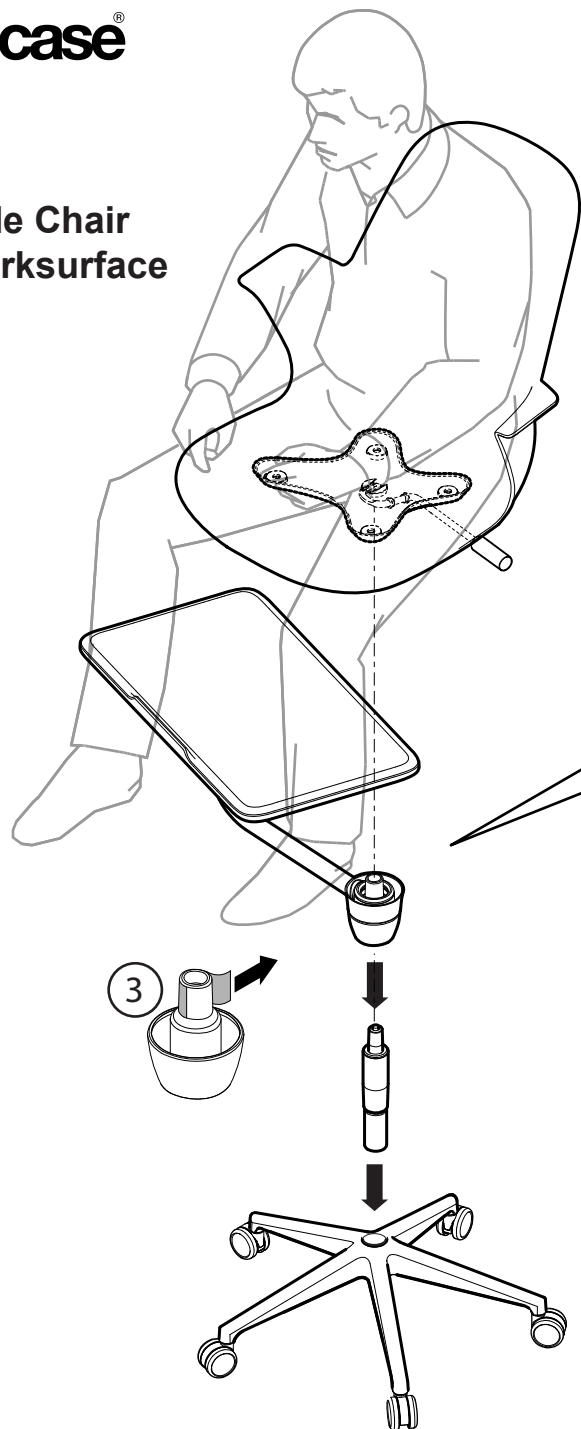

- ⑤ Sit in chair to fully seat chair components.
- ④ Lower chair to insert bracket into column.
NOTE: Align notch in bracket with worksurface arm tube.
- ③ Remove adhesive backer from top of metal collar.
- ② Attach worksurface assembly.
NOTE: Support underside of metal collar to avoid falling out.
- ① Align and insert column into base.

NOTE: Base removed from illustration for clarity.

Worksurface must rest in this area only.

If worksurface is resting outside this area, the chair will not seat properly.

WORKSURFACE

METAL COLLAR

480 Node Stool

