

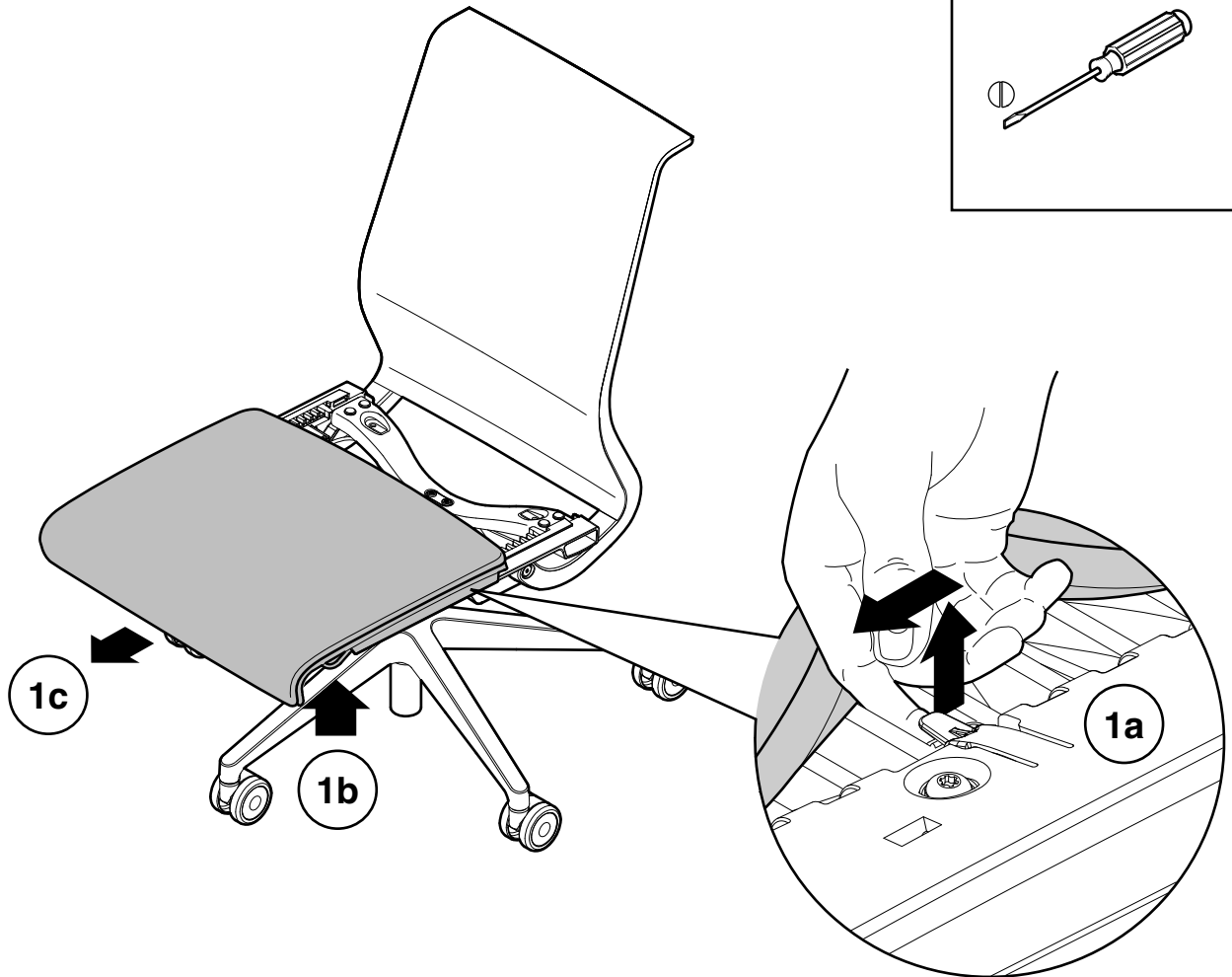

1. Pull back on side of seat cushion and locate the release clip. Lift up on the release clip (1a) while also lifting up on the seat bail (1b) and slide that side of the seat forward as far as it will go. Repeat on the other side and slide the seat forward until you can see the arm attachment holes (1c).



If you have purchased this product on Steelcase Store, call 800.516.3454.

If you have purchased this product through an authorized retailer, please contact them directly or visit our website: www.steelcase.com

© 2008 Steelcase Inc.
Grand Rapids, MI 49501
U.S.A.

Printed in U.S.A.

2. Remove the decorative plug on each side of the chair as shown.

3. Slide the arm in and align the arm hole with the arm attachment hole. Tighten the screw until fully seated using a torx T30 drive bit. Repeat for the opposite side.

4. Lift up on seat bail (4a) and slide the seat frame back onto the side rails until you hear an audible 'click' of the release clips snapping into position then lower seat bail (4b).

