

**Modular Power**

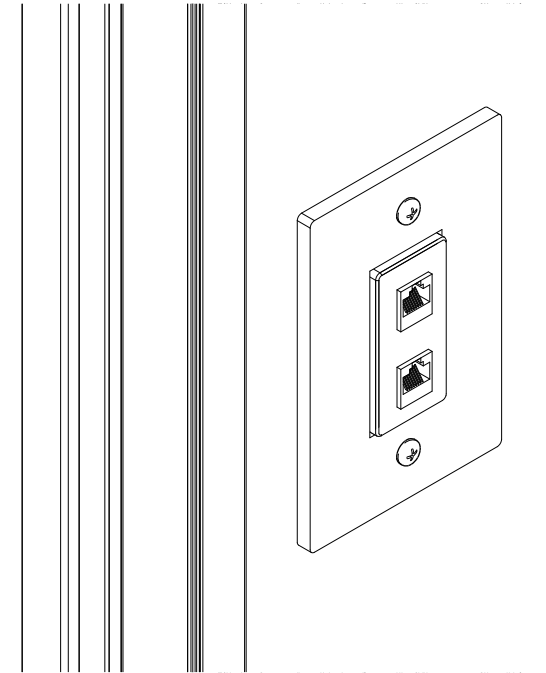
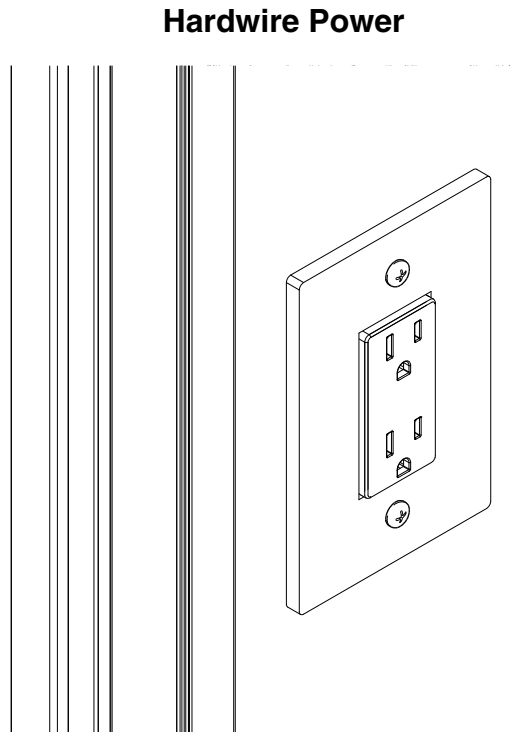

**Hardwire Data**

If you have a problem, question, or request, call your local dealer, or Steelcase Line 1 at **888.STEELCASE** (888.783.3522) for immediate action by people who want to help you.

(Outside the U.S.A., Canada, Mexico, Puerto Rico, and the U.S. Virgin Islands, call: 1.616.247.2500)  
Or visit our website: [www.steelcase.com](http://www.steelcase.com)

© 2016 Steelcase Inc.  
Grand Rapids, MI 49501  
U.S.A.

Printed in U.S.A.

Installation Reference Identification (IRID) Label installed on product.  
Many Everwall Products have specific locations within the floor plan layout.  
These products will be identified with an IRID Label.  
The IRID Label number will indicate the location of the product within the floor plan layout.  
Detailed information can be found on the label including style/model number, finish, Plan dimensions, Measured dimensions etc....

**1.** Measure from floor to center of cutout.  
Mark center of cutout on utility post track.

**2.** Align center of bracket with marks on track.

**3.** Drive 1 screw through each side of bracket and into track.  
Extra hole on each side of bracket are only used if hole in cover/post do not align.

**Note:** Screws are self drilling/self tapping.

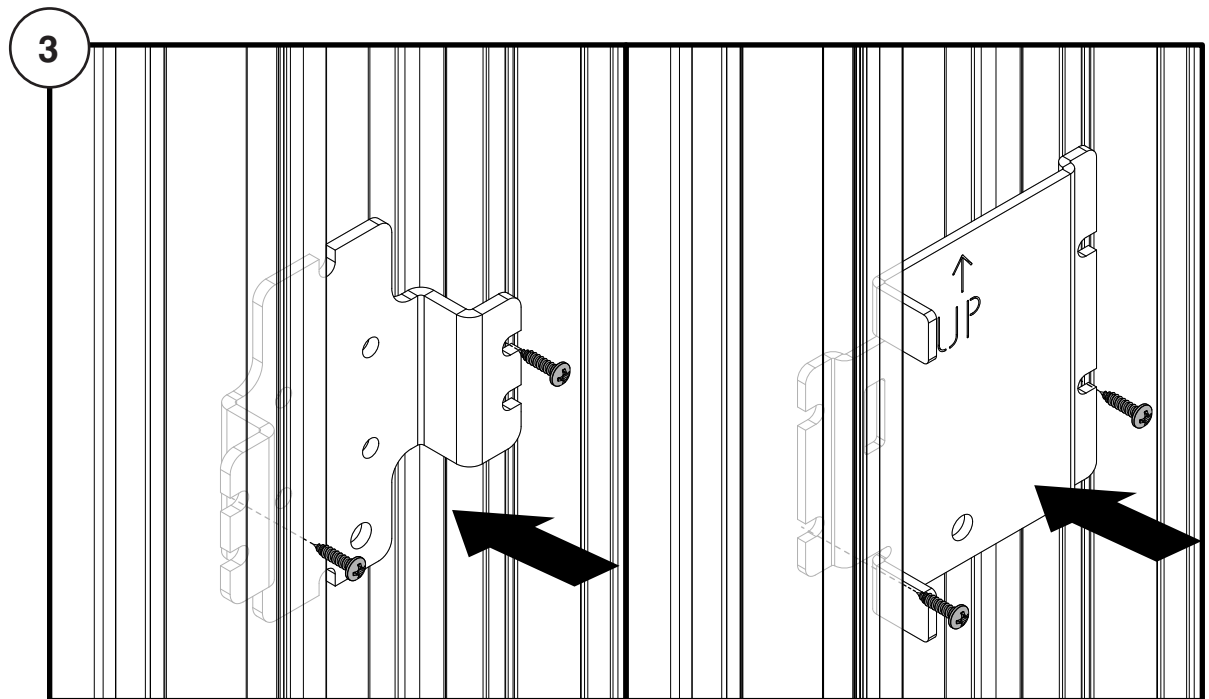
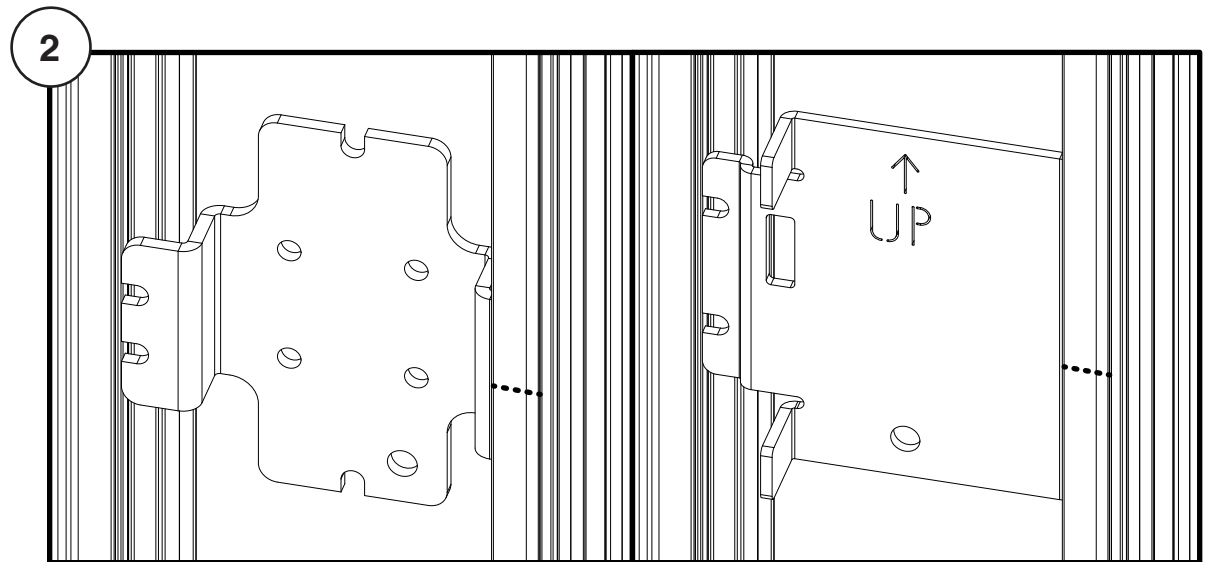
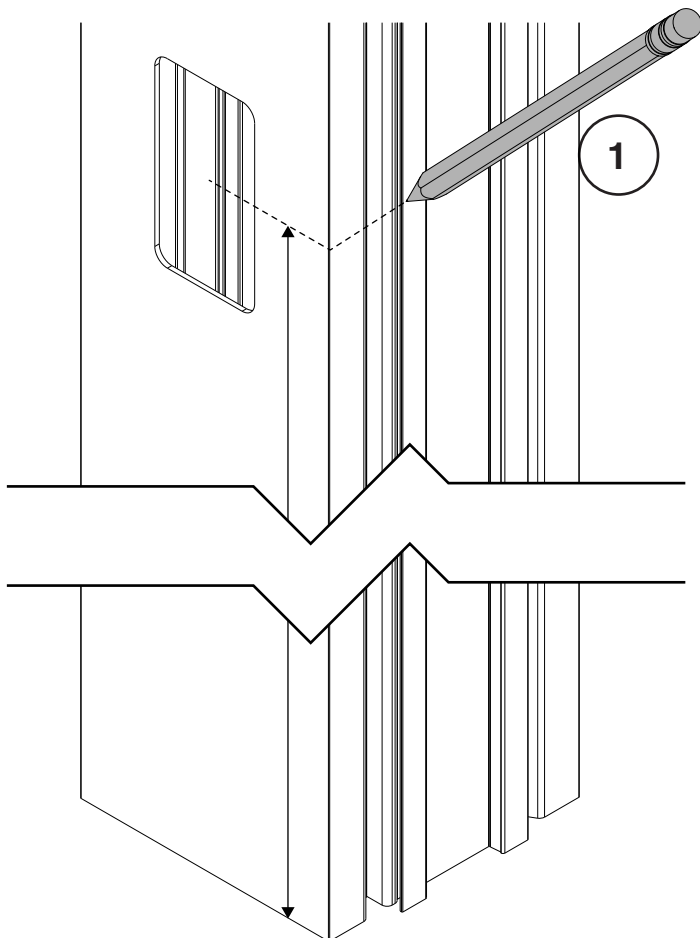

**4.** Power block has “tab and snap” features so that the tabs into holders and the snap from the power block goes into the rectangular hole in the bracket.

**5.** Install the modular receptacles. Load flat to the block and press up.

**6.** Install the power in or modular harness to the modular power block. Feed harness from the floor up, ceiling down or within wall into the feed through hole in the vertical. Installer or electrician to cut hole in the ceiling or floor directly in line with the utility panel. Install cable tie next to connector (as shown) to ensure a prolonged stable connection to modular power block.

**7.** Install the trim bezel. Place trim bezel around the receptacle and push into the chase cover. The receptacle has a spring clip and the bezel has serrated steps, working like a ratcheting system.

**8.** Bezel removal (if necessary). Pry spring clip with small putty knife or small flat-bladed screw-driver.

**NOTE:** The USB receptacle has been tested and found to comply with the limits for a Class A digital device, pursuant to part 15 of the FCC rules. These limits are designed to provide reasonable protection against harmful interface when the equipment is operated in a commercial environment. This equipment generates, uses and can radiate radio frequency energy and, if not installed and used in accordance with the instruction manual, may cause harmful interference to radio communications. Operation of this equipment in a residential area is likely to cause harmful interference in which case the user will be required to correct the interference at his own expense.

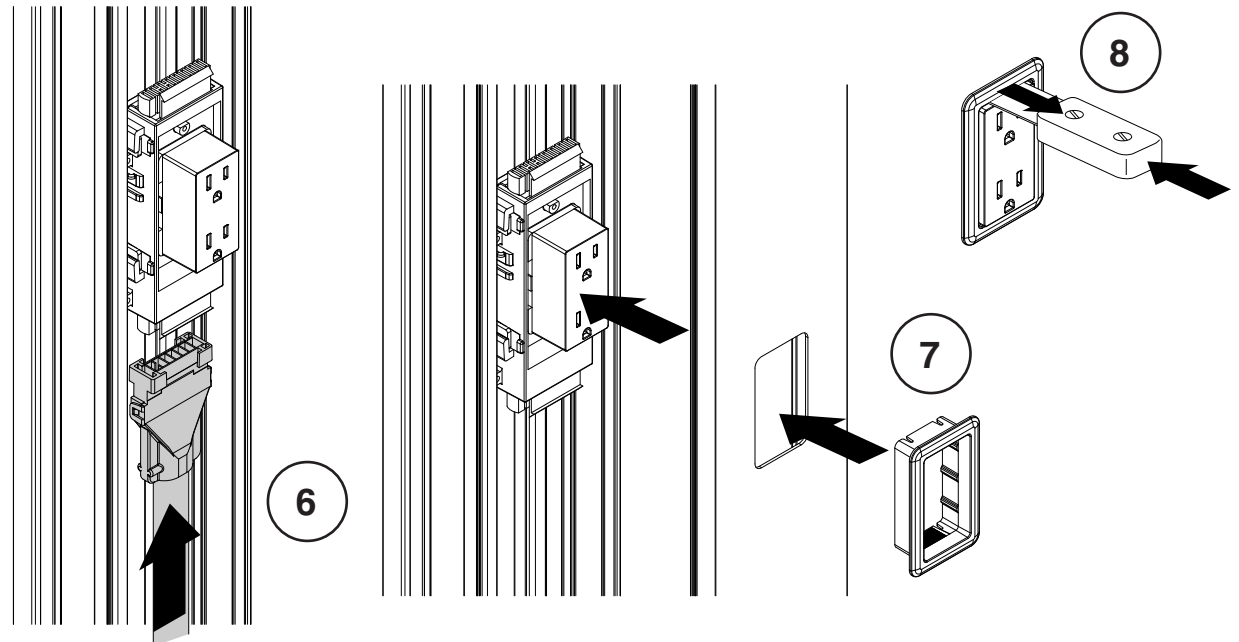
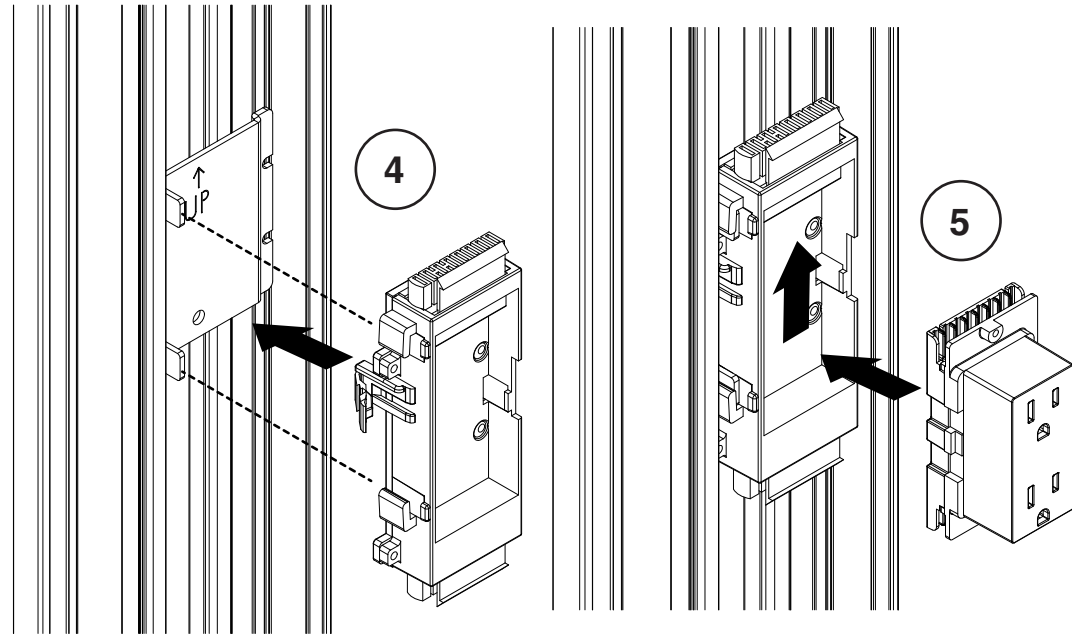

**1.** If holes in electrical box do not line up with bracket, drill 5mm holes through bracket to align with holes in box and attach box using created holes.

**2.** Attach the 2 x 4 junction box to the bracket using the screws provided. Mount screws diagonally as shown.

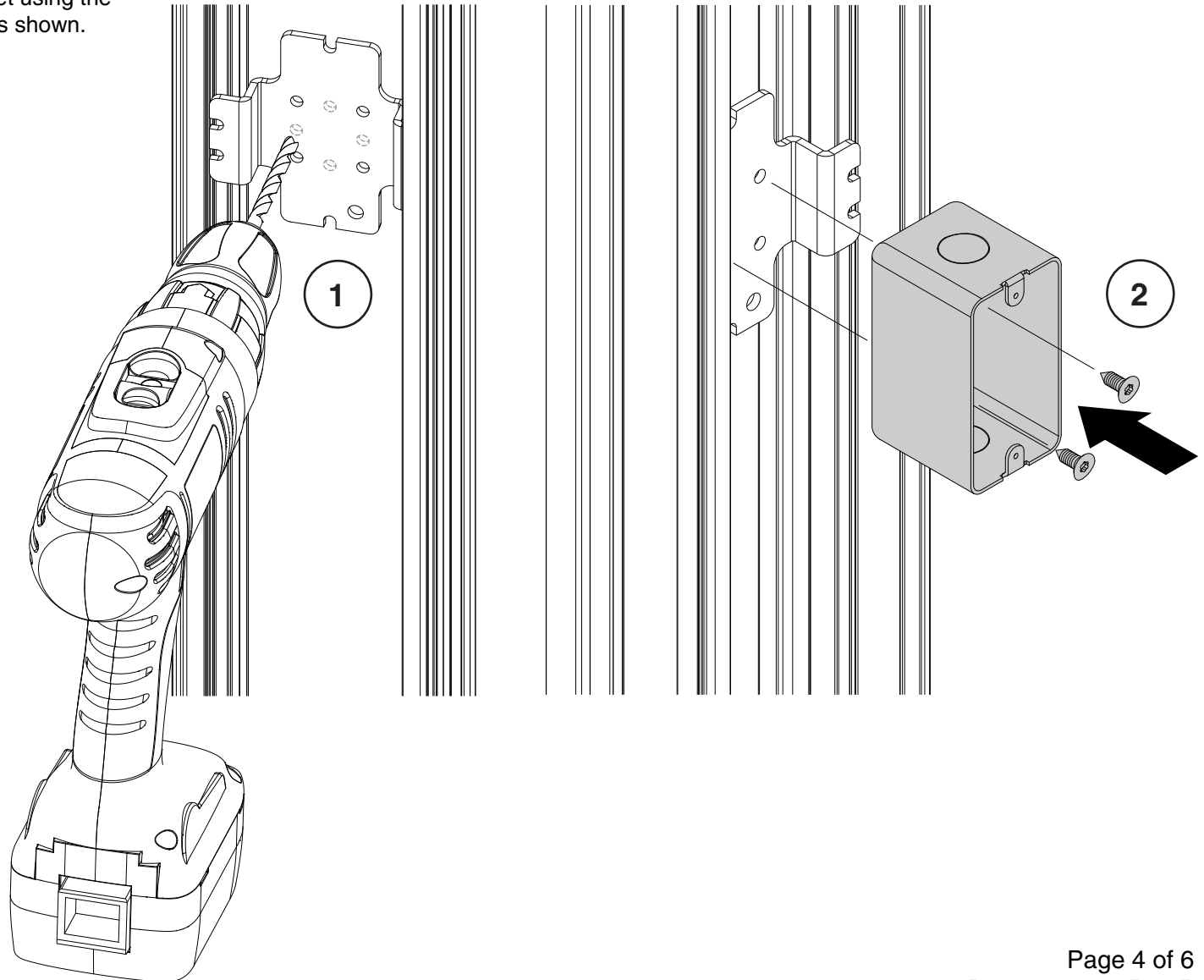

**3.** Remove the desired knockout(s) in the box and add your conduit connector and flex (or rigid) conduit (extra flex conduit is recommended). Run wire and make all electrical connections to the building source. Use cable ties as needed to ensure a prolonged stable support of conduit.

**4.** Install the receptacle or switch to the box (grounding properly).

**5.** Install the trim cover to the receptacle.

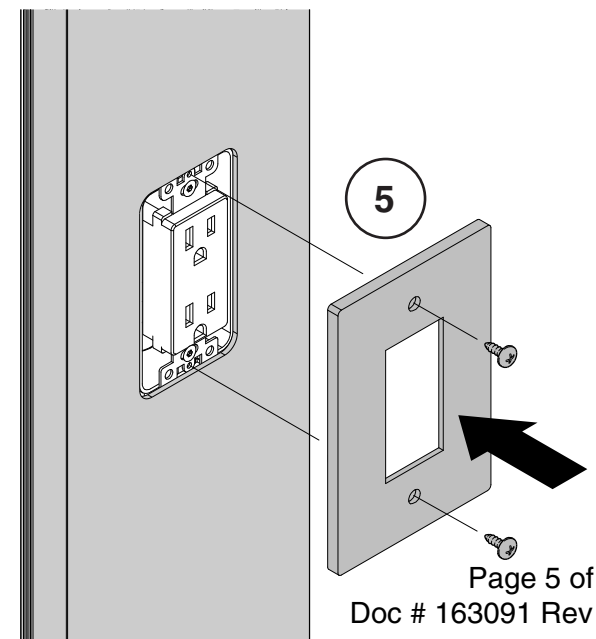
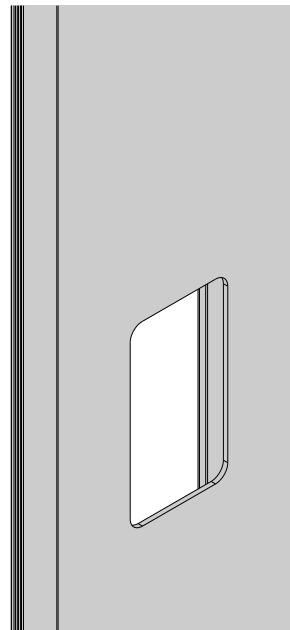
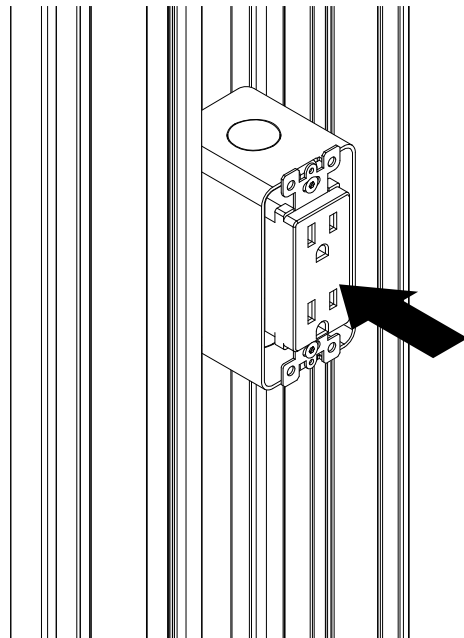
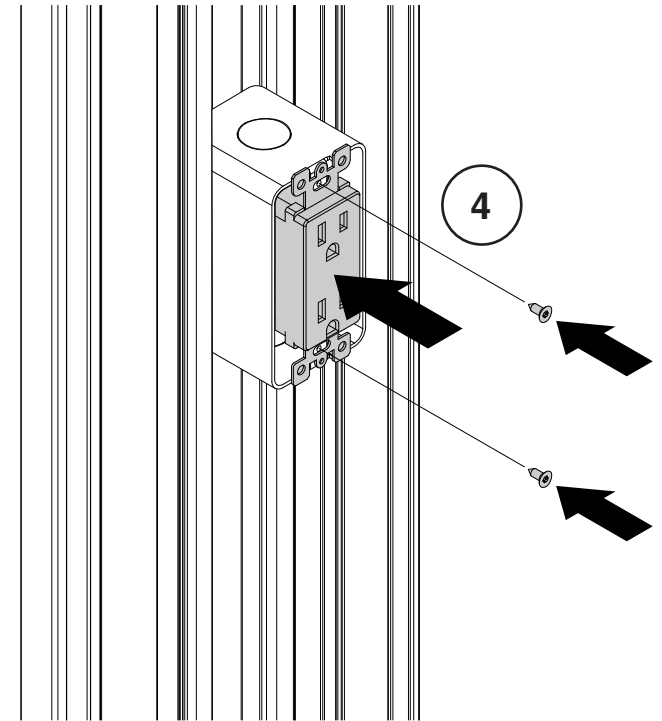
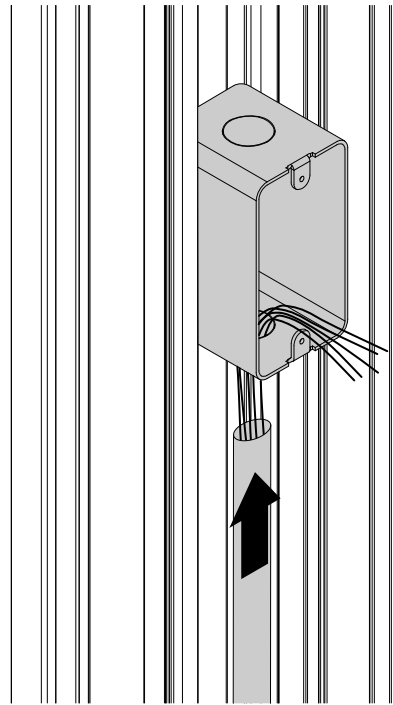

**3.** Remove the desired knockouts in the boxes. Run data wires and make all connections required.

**4.** Install the data receptacle to each box.

**5.** Install the trim cover to each data receptacle.

