

Non-Seismic Applications*

* The building's Engineer of Record must be consulted to determine if there are any seismic requirements.

CAUTION



CRUSH HAZARD!
FAILURE TO PROPERLY
SECURE EVERWALL TO
THE BUILDING COULD RESULT
IN PERSONAL INJURY.

Read the entire Assembly Directions before beginning installation.

Building construction varies greatly. The Building's Engineer of Record is responsible for the design of building floors, ceilings and walls which Everwall attaches to and must verify the adequacy of the mounting solutions, even if provided by Steelcase.

The building owner or designated agent is responsible for verifying that the installation is in compliance with all local codes and regulations.

ETCHED GLASS STYLES:

- Satin
- Mist

PATTERN GLASS STYLES:

- Waterfall
- Bamboo
- Harp
- Mirage

NOTES:

For etched/pattern glass orientation please refer to the installation drawings. Unless noted otherwise, use the default.

DEFAULT GLASS ORIENTATION:

ETCHED GLASS:

Rough side to go on the **inside** of the office space.

PATTERN GLASS:

Rough side to go on the **outside** of the office space.

888.STEELCASE (888.783.3522)

www.steelcase.com

© 2022 Steelcase Inc.

Grand Rapids, MI 49501 U.S.A.

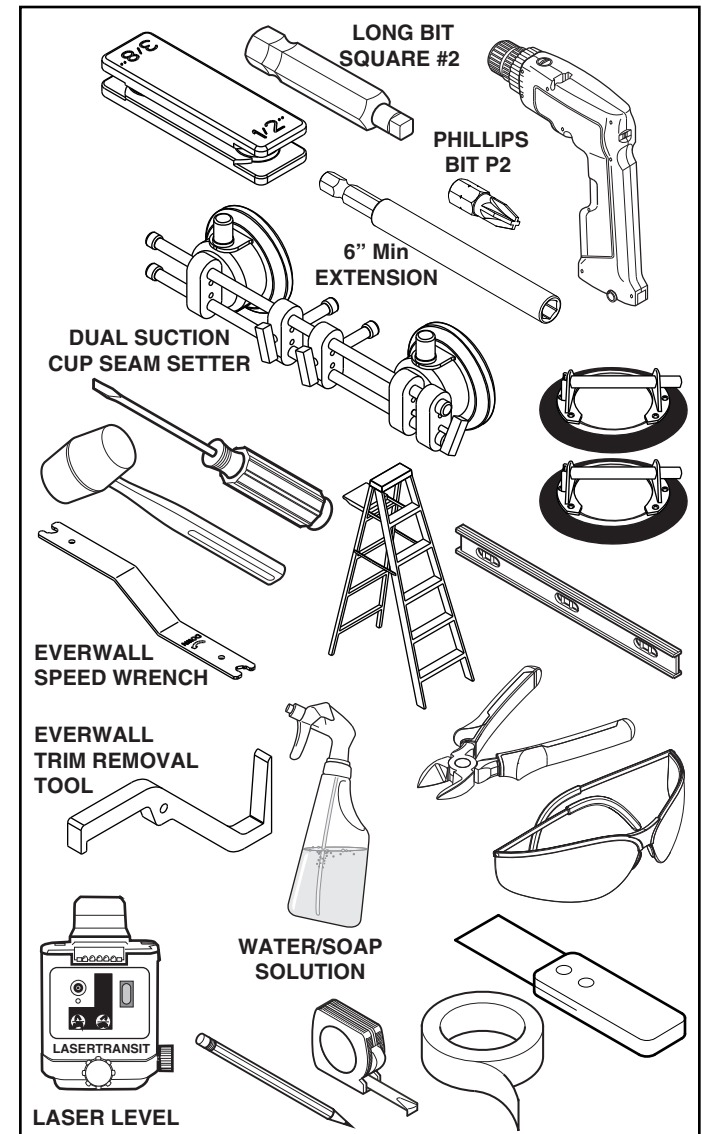
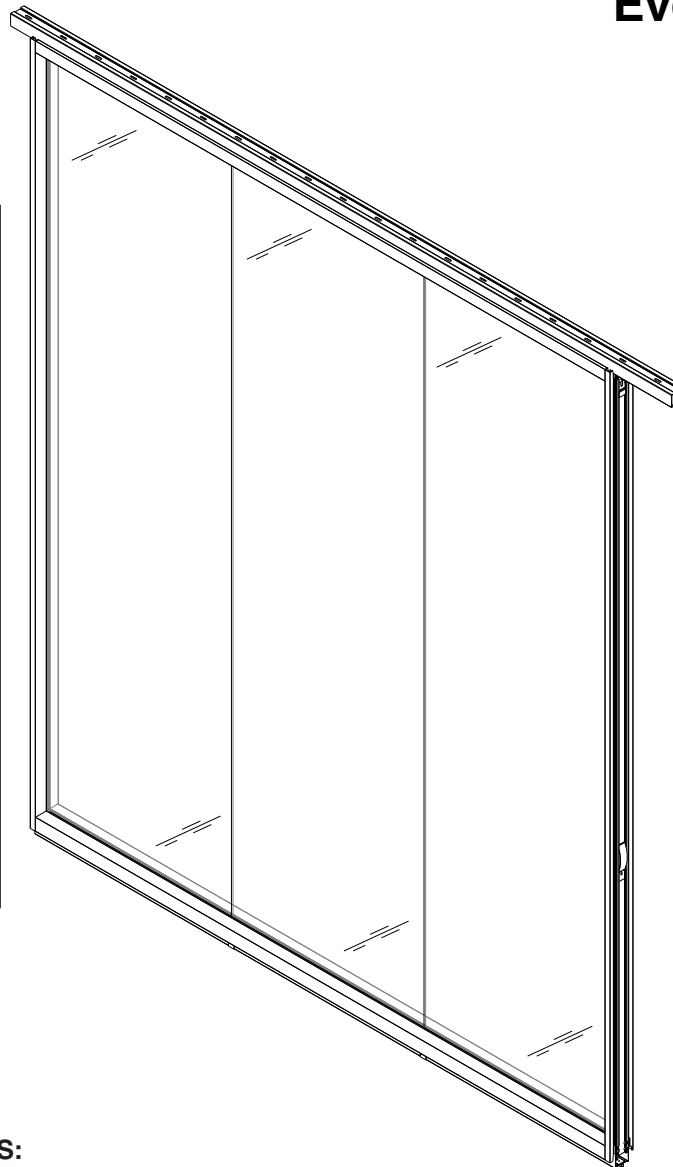

IMPORTANT:

1. If **SLIDER DOOR** is being installed adjacent and/or over a frame and glass kit, it **MUST** be installed following the images and text described below.
2. If **SWING DOOR** is being installed adjacent to a frame and glass kit, it **MUST** be installed following the images and text described below.

By Steelcase Inc. Grand Rapids, MI 49501-1967
www.steelcase.com/patents

Model: NEFK
Ship Date: 08/30/13 Athens
Order No.: 05117553-002300
Barcode: 1PM5P8421
Assembled By: F529600
Finishes **4242**

Def Code:

S5DAF

PH: 21.717 MH: 21.481
PW: 6.000 MW: 5.764

NOTE: Products have specific locations within the floor layout. These products will be identified with an Installation Reference Identification Label (IRID), which will indicate the location of the product within the floor plan layout. Detailed information can be found on the label including style/model number, finish, Plan dimensions, Measured dimensions etc....

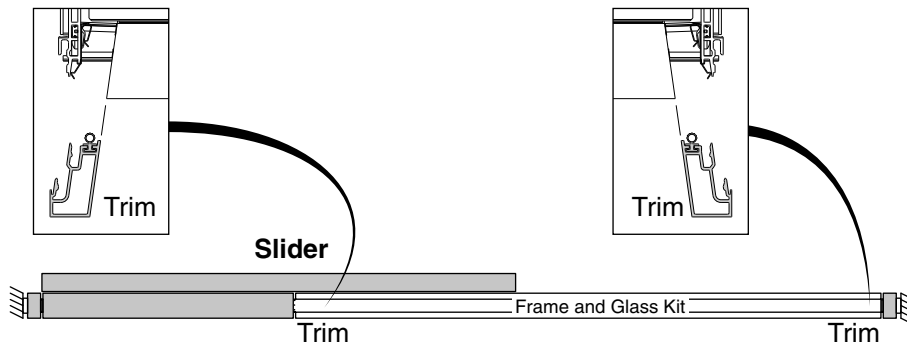

Slider over the Frame and Glass Kit
The trim **MUST** be on the opposite side of the Slider.



Slider adjacent to the Frame and Glass Kit
The trim can be on **EITHER** side of the Slider.

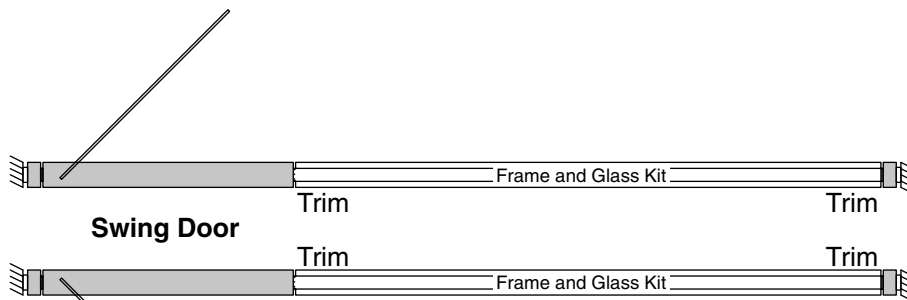

Swing Door with the Frame and Glass Kit on the Strike side
The trim **MUST** be on the opposite side of the Swing Door.

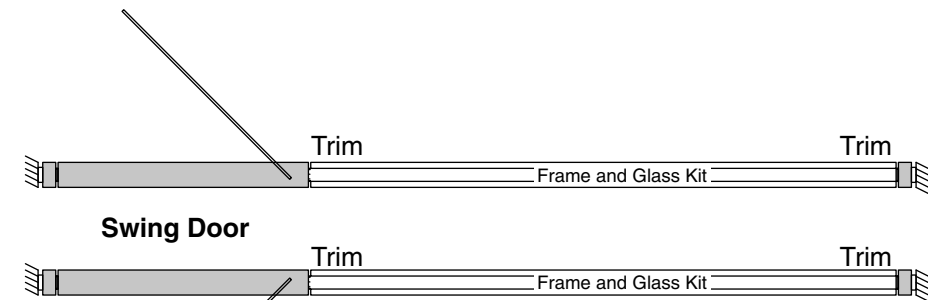

Swing Door with the Frame and Glass Kit on the Hinge side
The trim can be on **EITHER** side of the Swing Door.

Pre-Installation:

1. Verify Ceiling Track and floor guide items are installed prior to continuing per requirements in appropriate assembly directions (Doc # 161959 & 161960).

1. Place the parts on the floor as shown. There are left and right hand vertical parts that need to be located properly, with the notch facing upwards. (see images for views of each) The bottom edge has an extra-large notch on center of the bottom and the top has a chamfer for easier assembly.

TIP: The use of a 2x4 or other spacer at each corner will make it easier for driver to have the necessary clearance to drive fasteners in straight. (2x4's will not be shown in other views for clarity)

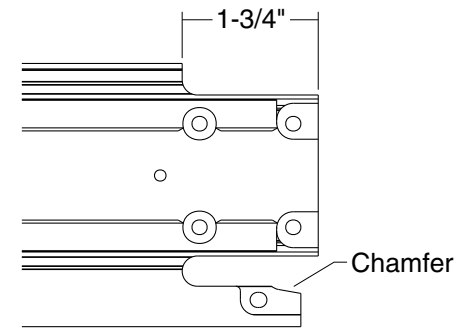

TOP OF VERTICAL

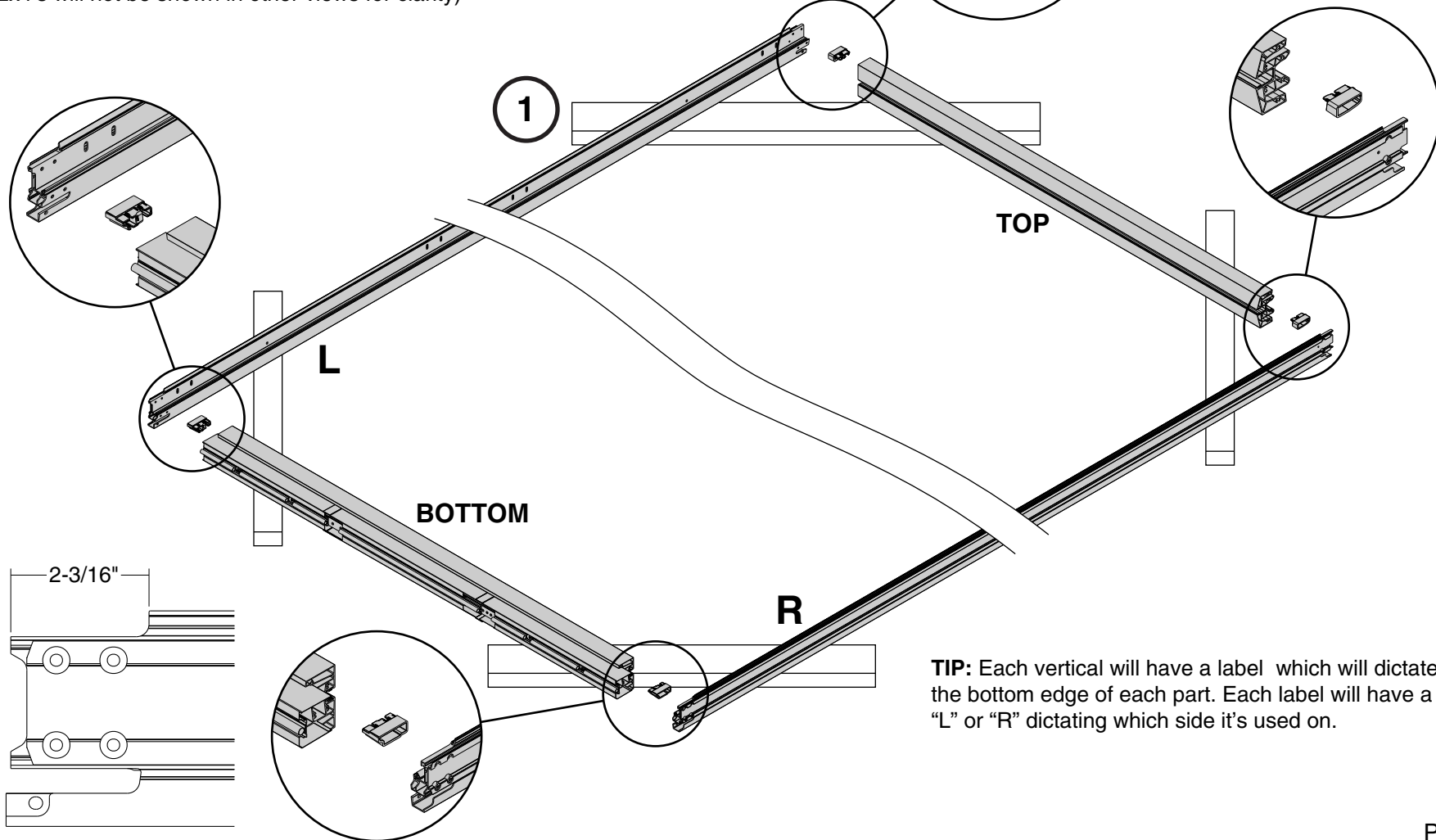

TIP: Each vertical will have a label which will dictate the bottom edge of each part. Each label will have a "L" or "R" dictating which side it's used on.

BOTTOM OF VERTICAL

2. Plastic spacers come as one unit that will need to be snapped away flush from the attachment tree. Each spacer is marked for its specific location when looking at the product from the side facing up (trim removal side).

After verifying the correct position and orientation to the corresponding extrusions, the spacers can be placed into the extrusion openings at each end. Use a rubber mallet to tap each spacer in until it is seated flush with the edge of the aluminum as shown.

NOTE: The spacers can only go in correctly one way when installed on the upward facing side of the parts.

NOTE: Installer can mark the center of the parts near the glass channel (+/- 1/32") with masking tape and a pencil mark on both the top and bottom horizontal now or later per personal preference. (shown on page 10)

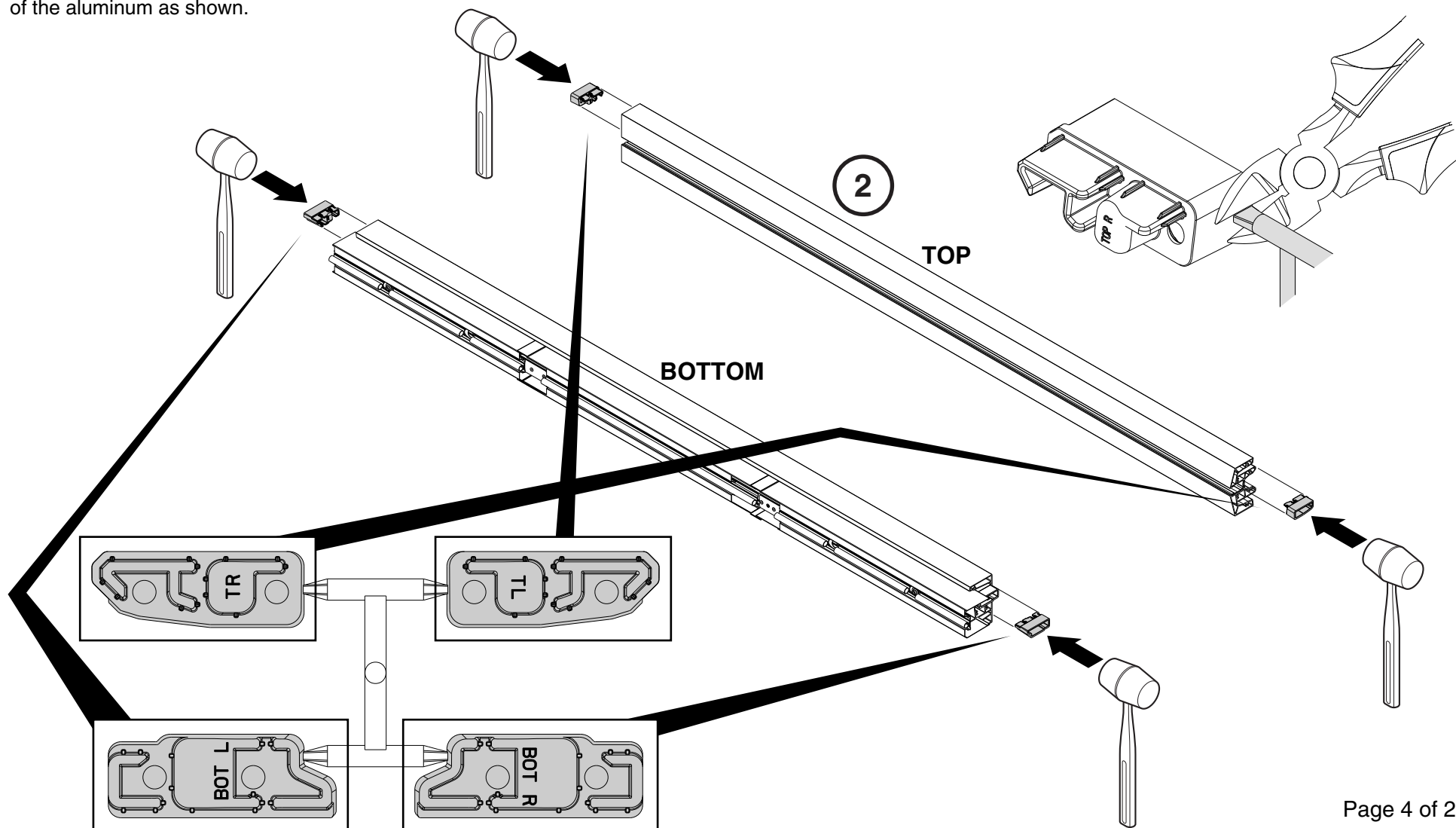

3. Use the #10 x 1-1/2" long screws (A) provided to build the assembly in the proper order. The two back (fixed side) screws install first to align the parts (3a & 3d). Next, install one screw (A) in the third hole (near the back) on the fixed side (3b & 3e) and then install the two #10 x 2" long screws (B) in the front side that go through the spacers (3c & 3f).

Secure all four corners of the frame by repeating the previous steps as shown.

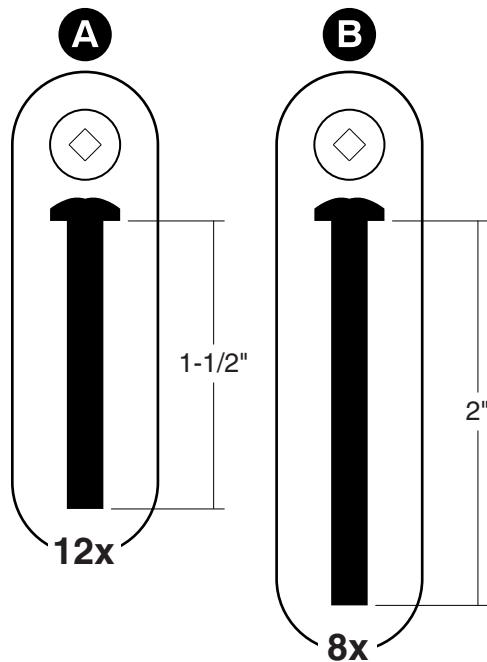

CRITICAL - PARTS TO BE SEATED WITH THE APPROPRIATE SCREW WITH A TORQUE NOT TO EXCEED 30 IN/LBS.

NO IMPACT DRIVERS

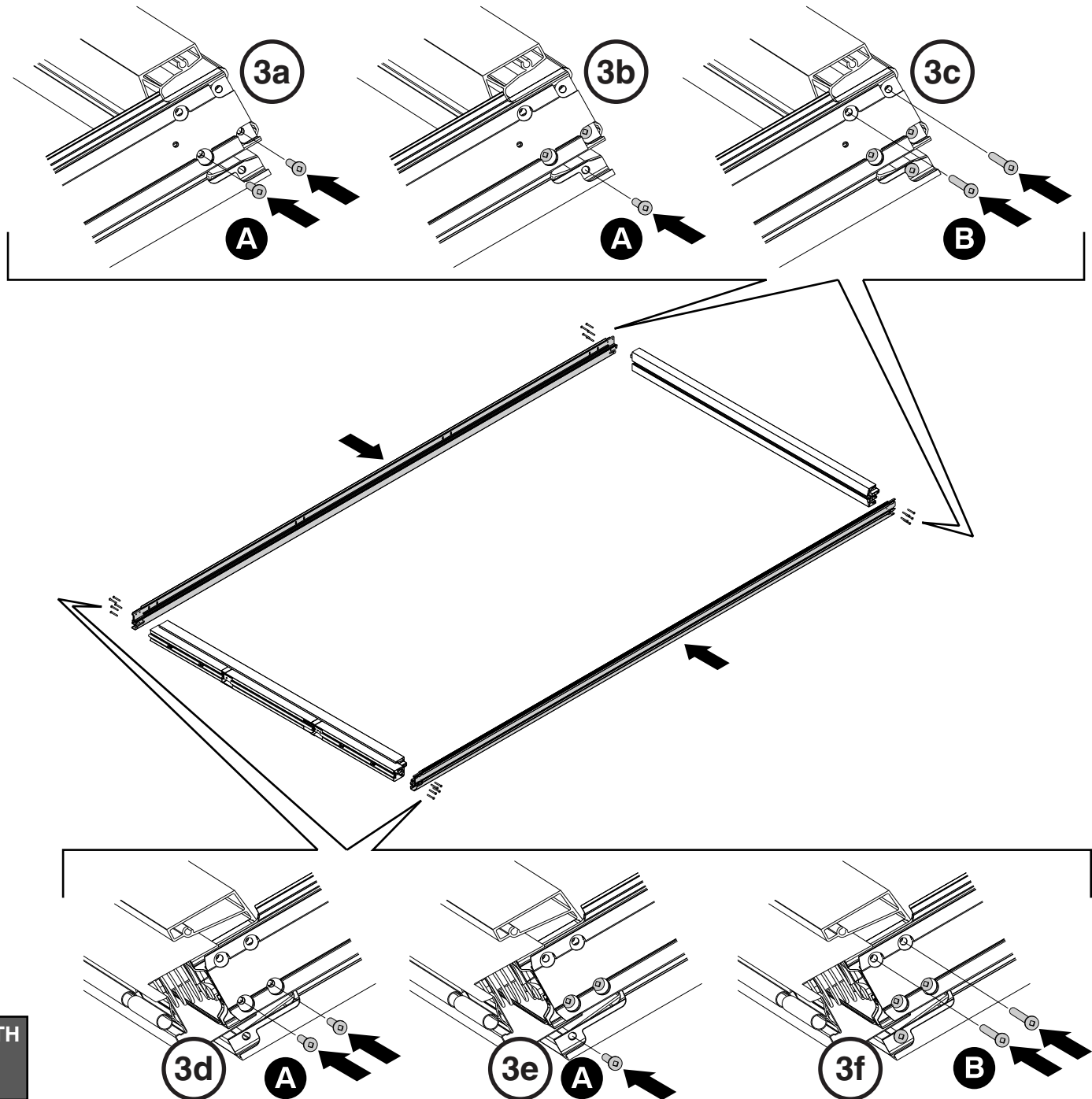

4. Place each post extension, curved washer and shoulder screw at each top corner as shown. Ensure that the curved washer is facing towards the post extension with the tabs of the curved spring engaged into the openings of the post extension. Secure the fastener through the parts into the uppermost hole on the post. Make sure fastener is seated and **NOT TO EXCEED 30 IN/LBS OF TORQUE.** The screw will flatten out the spring to some degree as you tighten it. Cycle the post extension up/down to ensure that the ratcheting effect works properly.

IMPORTANT: Press the post extension all the way down on the post to make installation easier.

Repeat installation of the post extension on the opposite side.

NO IMPACT DRIVERS

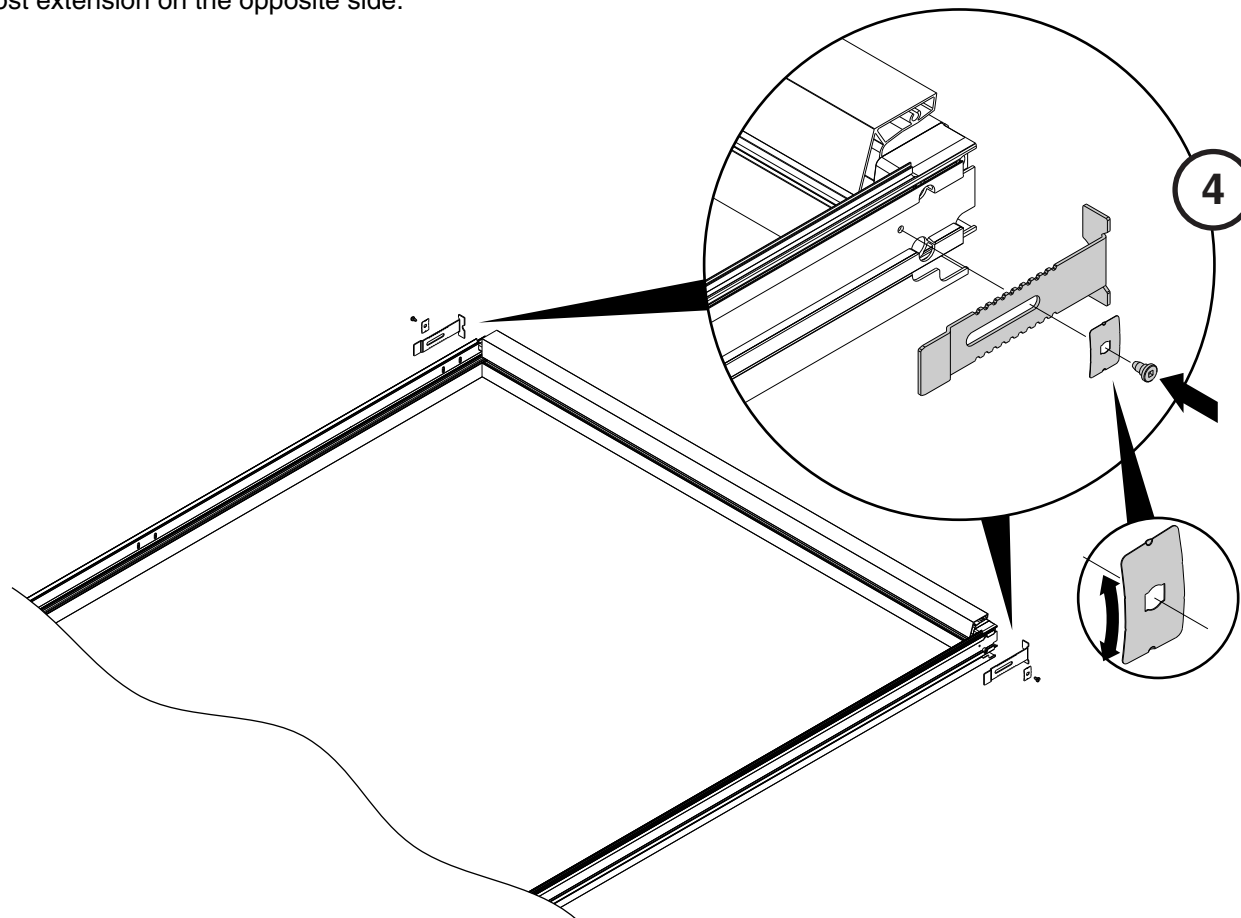

5. Measure up the appropriate dimension (42") and make a mark on the attachment flange on the side of the product that needs it. Place planarity clip near this line and press barbs into the aluminum to temporarily hold in place, then secure in place using a thumb or hammer to tap on the flat area of the spring. Verify that the planarity clip is secure.

6. Take rough measurements of adjacent panel(s) and corresponding floor conditions to pre-adjust glides as much as possible while having easy access. The bottom edge of the frame is designed with a 1-1/4" nominal position to the floor. This may vary, depending on previous adjustment of adjacent product for out-of-level floor conditions. Install the frame like a standard unitized glass or clerestory per the appropriate assembly direction (Doc # 160652).

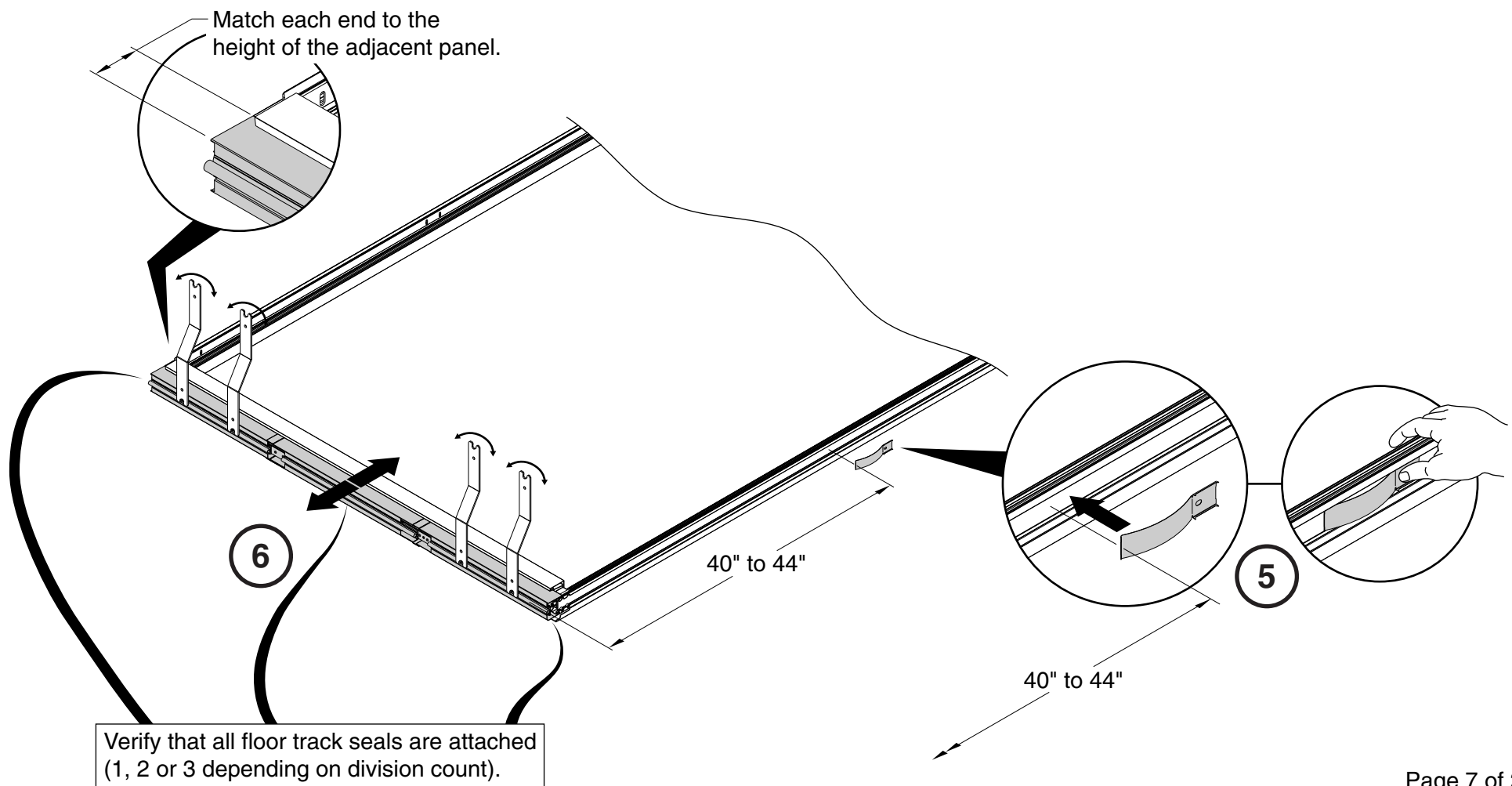

7. Once the frame is installed into the ceiling track, push both post extensions upwards as high as possible. Use a putty knife (7d) to catch the bottom edge of the post extension in the gap between vertical product edges or use a small screwdriver (7d) in the opening next to the spacers on the side of the vertical frame member.

NOTE: When floor guides are required you may need to hold up the floor track while rotating the frame in place. Use a spacer next to each floor guide to hold up floor track while rotating in place.

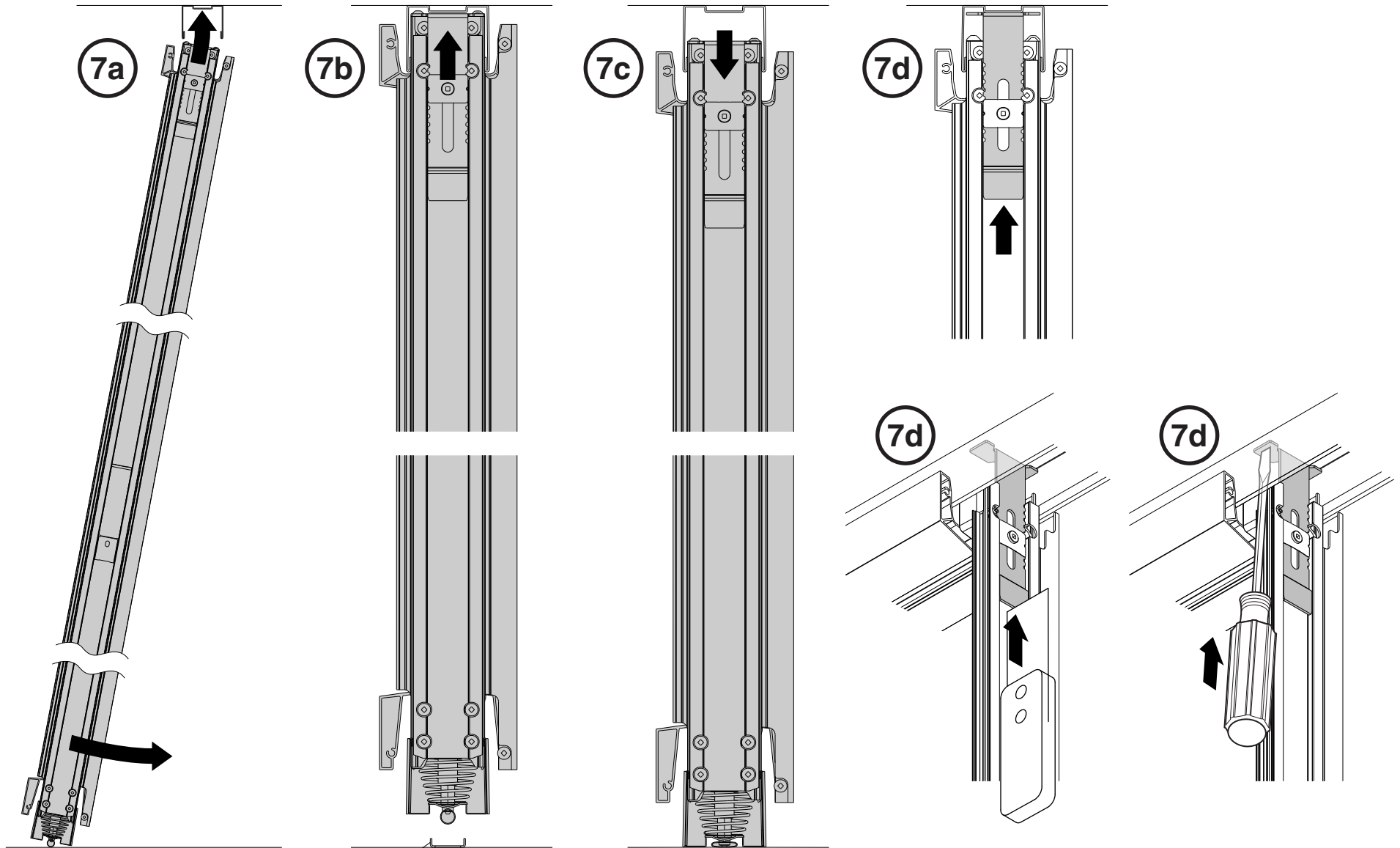

Floor guide
as required

Reference Doc # 161960

8. Perform any major leveling necessary at the glide locations. There will be two or four glides based on the number of pieces of glass specified. For more accurate leveling, apply some weight on the bottom horizontal at the glide locations to simulate the weight of the glass. Plumb verticals as necessary using appropriate levels.

9. Lift floor track up by using a pry bar near the glide locations to gain access to use the speed wrench. Speed wrench is installed on the hex **ABOVE THE CLIP** and above the floor guide if required. (shown below) Use appropriate levels to plumb verticals and adjust as multiple panels are installed.

TIP: Each end of wrench has a specific direction of use.

TIP: Approximately 6 turns of the wrench rotation equals 1/16" movement up or down.

10. Rotate glide as necessary to support proper panel to panel alignment.

NOTE: Maximum mismatch between vertical slots on clerestory and bottom edges of unitized glass is 1/32".

Repeat steps 7 through 10 to complete panel run.

NOTE: Glides are located approx 5" in from each glass segment with PW (Plan Width) is 18" or wider, otherwise approx 3-3/4" in from each end.

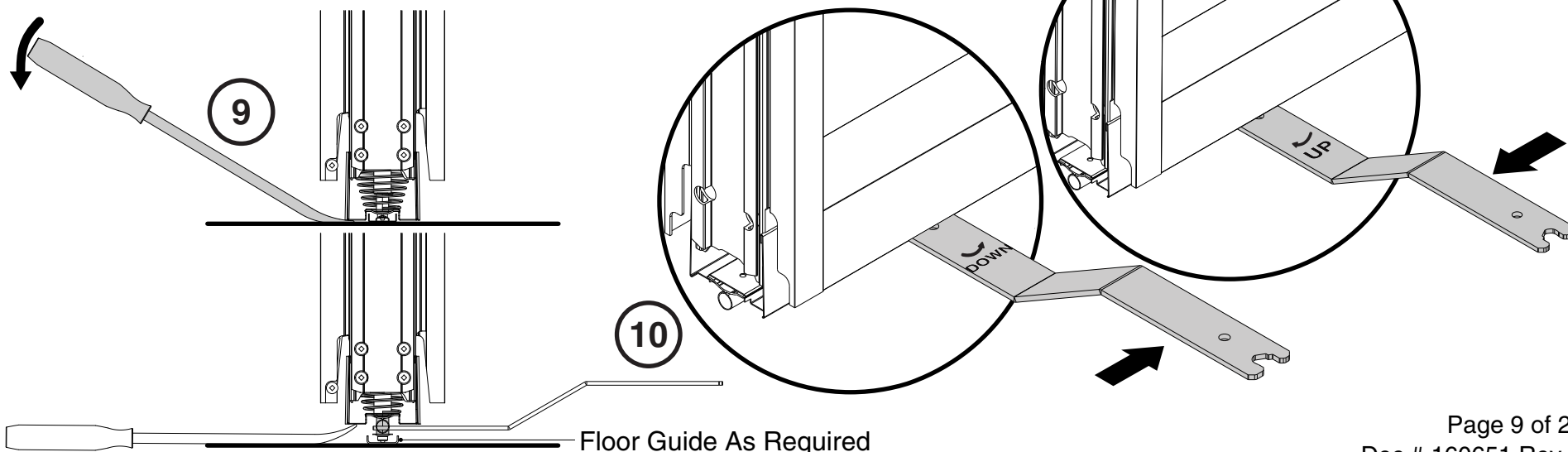
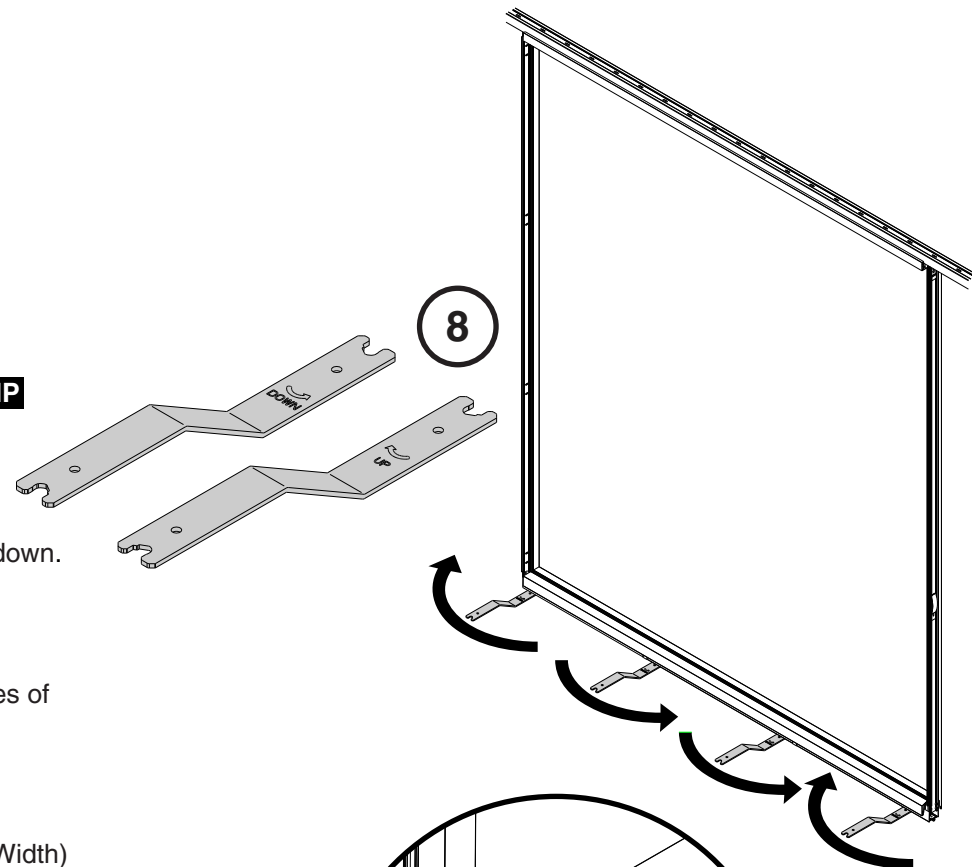

11. Join the frame to any adjacent product using frame couplers as instructed in appropriate assembly direction (Doc # 161960).

Frame for One, Two or Three Pieces of Glass

12. Mark the center ($\pm 1/32$) of the top and bottom aluminum horizontals in a visible spot near glass channel with a piece of tape and pencil mark.

TIP: Place a full length protective barrier (painters tape, etc) on the top surface of the bottom horizontal to protect the aluminum (paint or anodized) on the glass installation side from potential damage from the glass during the glass installation in step 14.

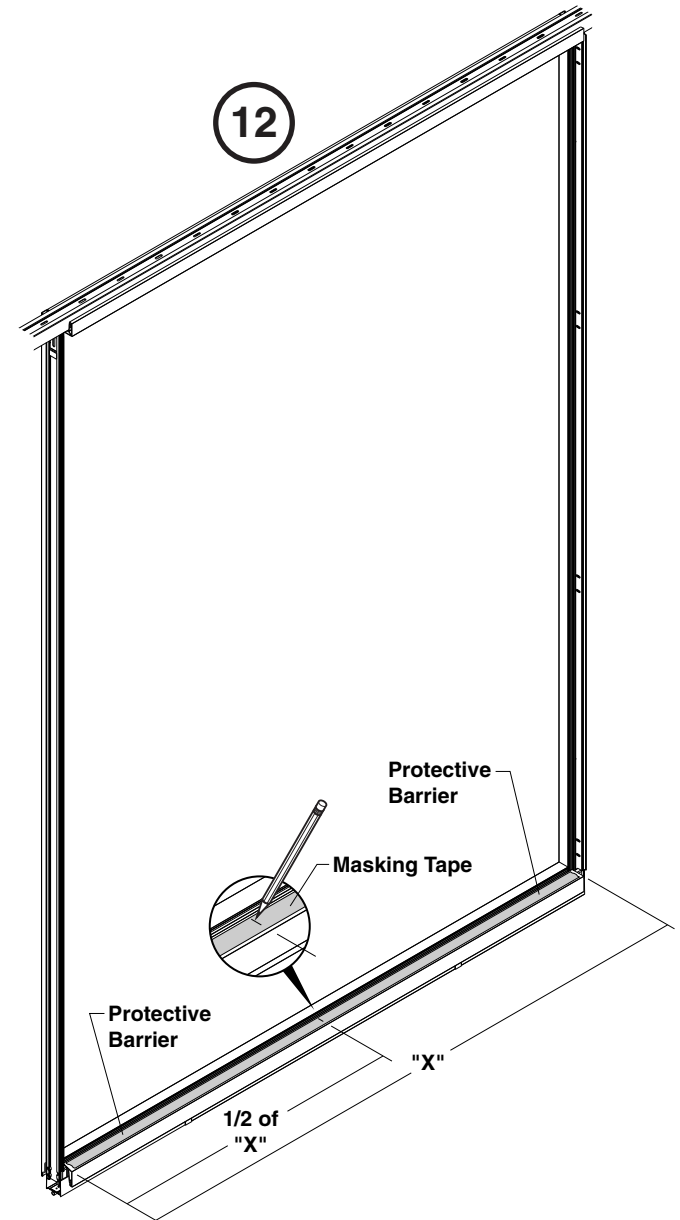
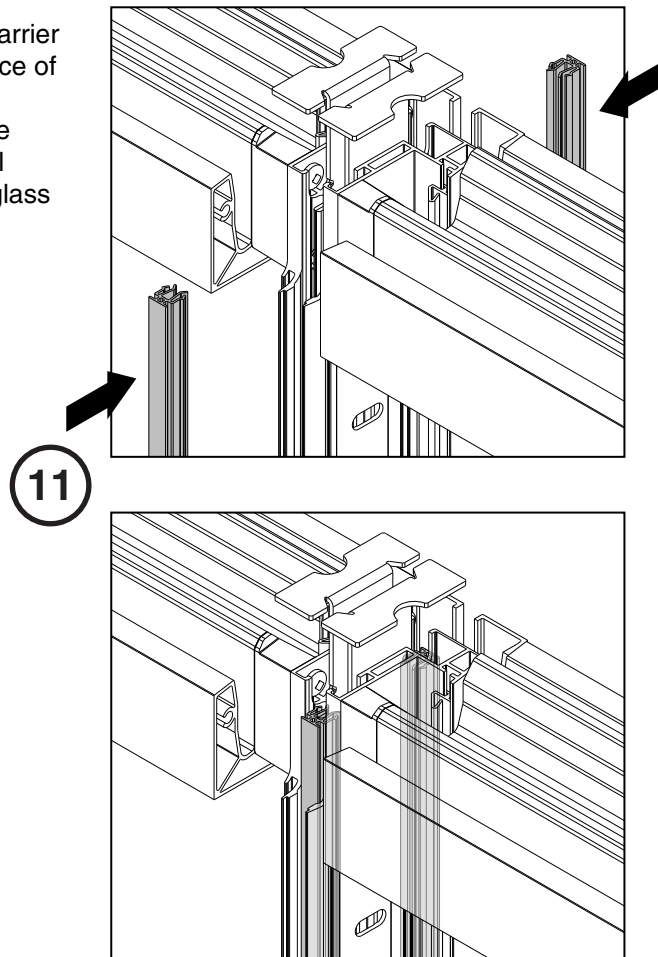

Prepping Glass for Two and Three Piece Glass Installation

1. Read Warning (on this page) prior to uncrating glass.
2. Verify which glass (by layout, IRID, or size label) is to be installed in location desired. Take note of finish side options and safety mark location to understand which edges will need glazing tape applied. Glass safety mark to be on bottom edge and legible from the same side for all pieces of glass.
3. Clean the surface/edge of glass where glazing tape will be applied with isopropyl alcohol.
4. Apply 2mm thick clear glazing tape centered on the **entire length of glass**. Use of the Steelcase glazing tape application tool that is available, if desired. Leave the film on one side until after glass is installed and ready to bond together.
5. Repeat as necessary steps 2 and 3 (on this page) for adjacent glass where glazing tape will contact when glass is installed.

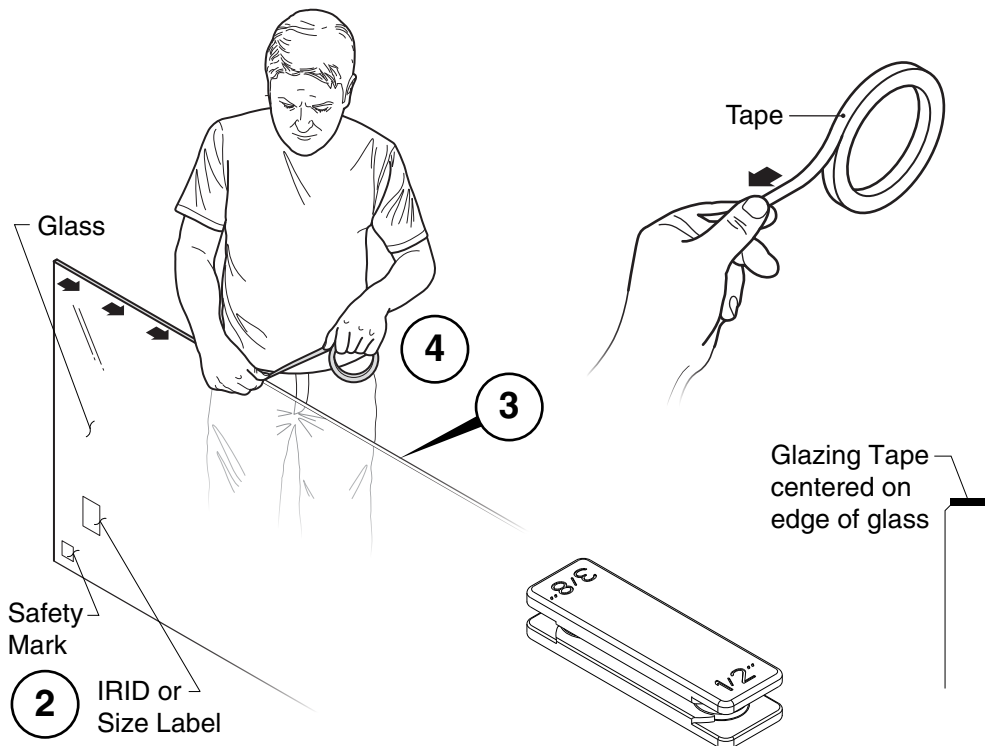

1

⚠ WARNING ⚠ ADVERTENCIA ⚠ AVERTISSEMENT

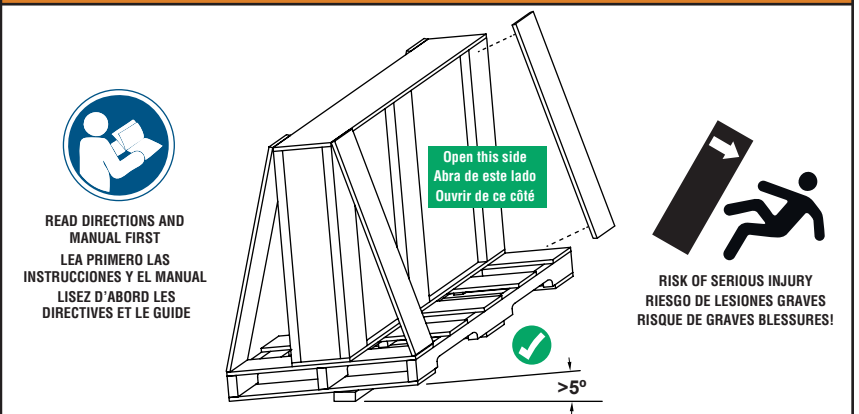

Safety Instructions Instrucciones de Seguridad Consignes de Sécurité

- Before opening, ensure crate is stable and tilted at least 5 degrees to prevent glass from falling out.
- To open, cut any bands first and pry off boards on front of crate.
- Before removing glass, check crate and remove protruding nails or screws that could scratch glass.
- Wear appropriate personal protective equipment (safety glasses and gloves, safety shoes and skin protection).
- Tempered Glass is very heavy and can shatter while handling. Use two or more people to handle glass.
- Handle carefully. A scratched surface, damaged surface, or edge impact can cause the glass to shatter suddenly into sharp pieces.
- Antes de abrir, asegúrese de que la caja esté estable e inclinada al menos por 5 grados para evitar que el vidrio se salga de la caja.
- Para abrir, corte primero las bandas de embalaje y luego separe las tablas del frente de la caja.
- Antes de retirar el vidrio, chequee la caja y quite los clavos o tornillos salientes que puedan rayar el vidrio.
- Use el equipo apropiado de protección personal (gafas de seguridad, guantes, zapatos de seguridad y protección para la piel).
- El vidrio templado es muy pesado y se puede romper durante su manipulación. Use dos o más personas para manipular el vidrio.
- Manéjelo con cuidado. Una superficie rayada o dañada, o el impacto sobre el borde pueden causar que el vidrio se rompa de repente en trozos afilados.
- Avant d'ouvrir, assurez-vous que la caisse à claire-voie est stable et inclinée d'au moins 5 degrés pour éviter que la vitre bascule hors de la caisse.
- Pour ouvrir, coupez d'abord les bandes d'emballage, puis écarter les bords sur le devant de la caisse.
- Avant de retirer la vitre, vérifiez la caisse et enlevez les clous ou les vis qui pourraient dépasser et qui pourraient égratigner la vitre.
- Portez de l'équipement de protection individuelle approprié (lunettes de sécurité, gants, chaussures de sécurité et vêtements de protection).
- Le verre trempé est très lourd et peut se briser en éclats lorsqu'on le manipule. Au moins deux personnes sont nécessaires pour manipuler la vitre.
- Manipulez avec soin. Une surface égratignée ou endommagée ou encore un choc sur le rebord peut faire en sorte que le verre se brise soudainement en éclats tranchants.

13. Spray the top of the glass with a water/soap solution to allow for glass to slide more easily into glazing strip (13a). Spray the glazing strip as well (13b).

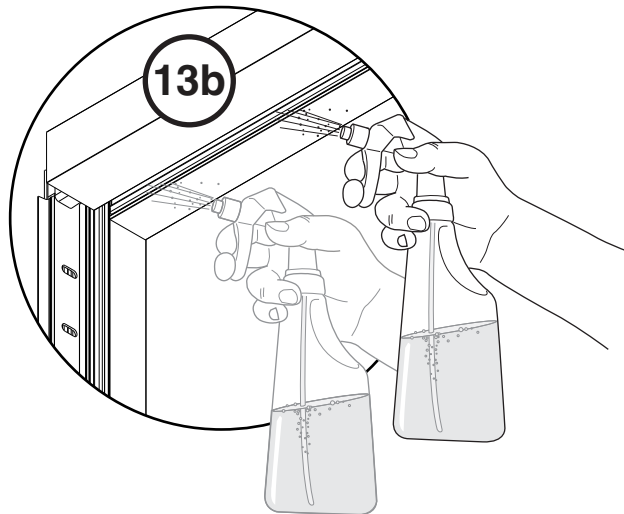
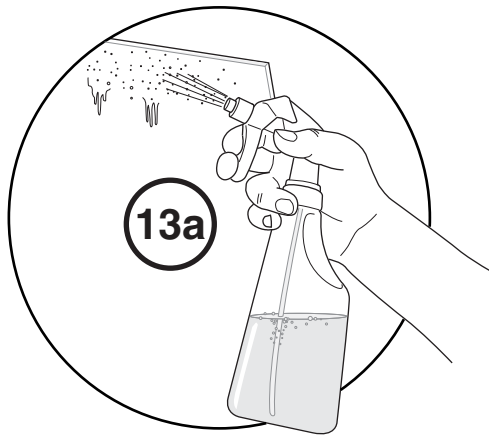

14. Carefully slide glass into the top glazing strip and swing glass into position in bottom channel and lower.

NOTE: Installation shown on Steps 14a through 14d on next page.

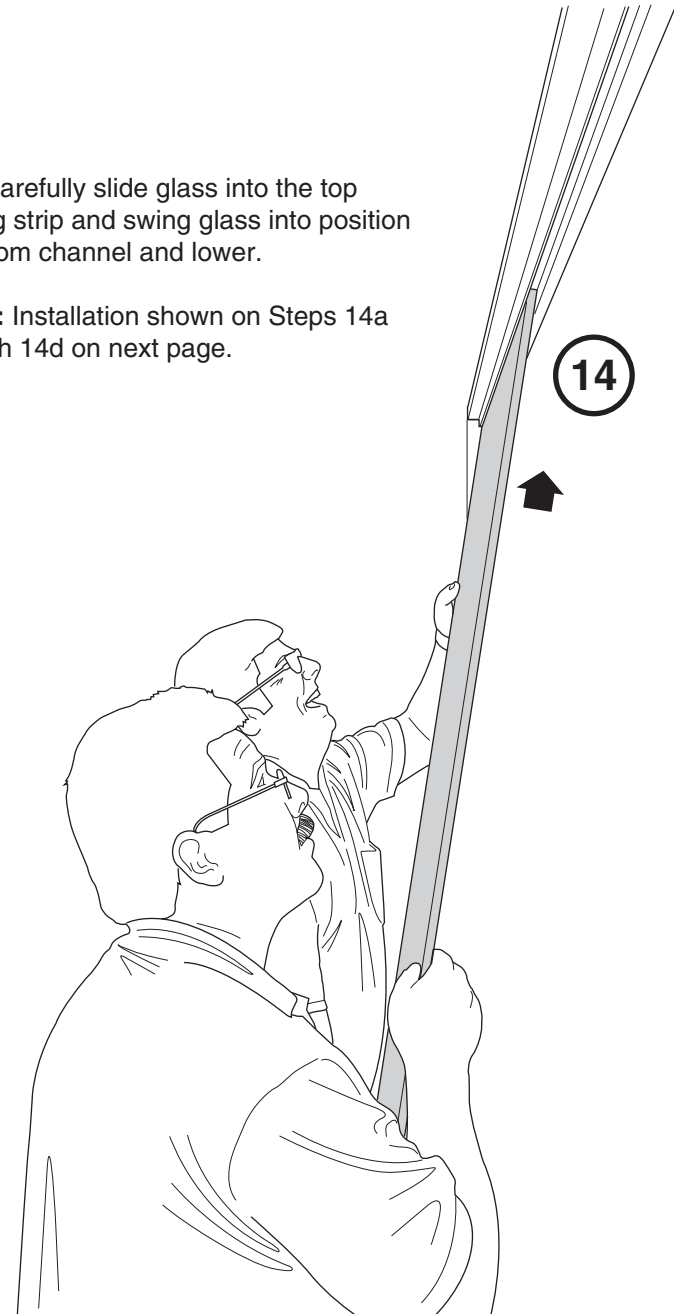

14. Always install the glass with the logo on the lower right hand corner of the glass. All glass safety markings should be facing the same side on the bottom.

To install the glass, insert the top of the glass into the channel at the top (verify the seal is installed) and lift up as far as possible, while rotating the bottom of the glass away from you (14a & 14b).

Continue rotating the glass inward and lifting the bottom edge of glass until the edge of glass is over the channel in the bottom horizontal. Lower it into the channel (14c & 14d).

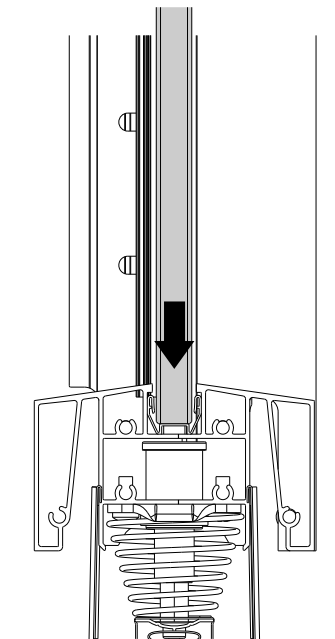
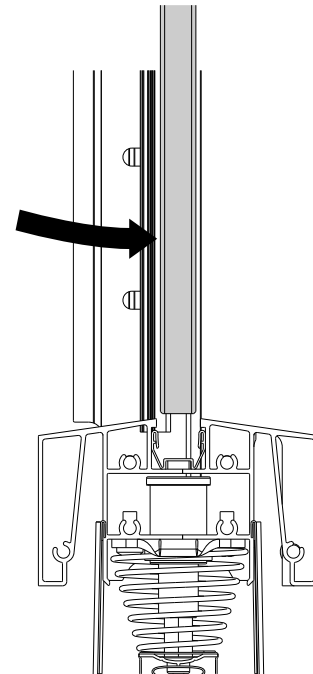
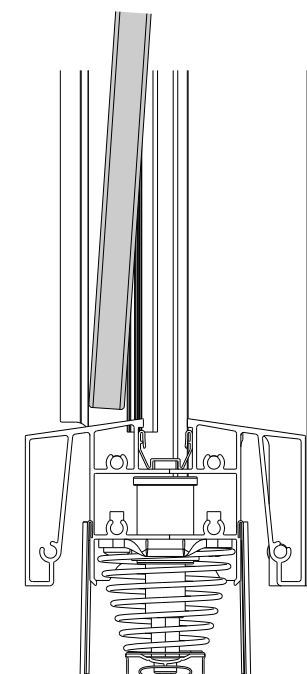
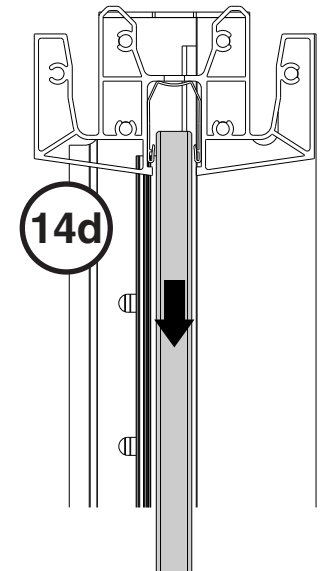
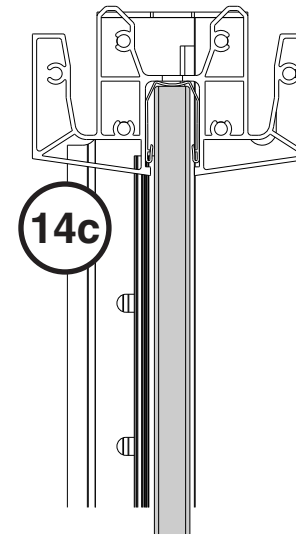
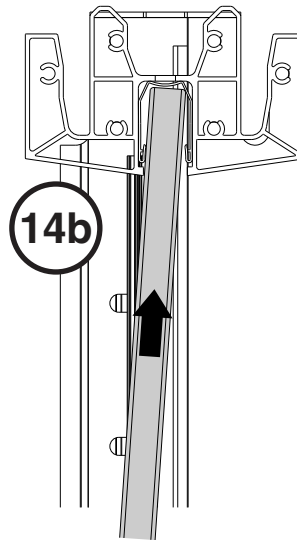
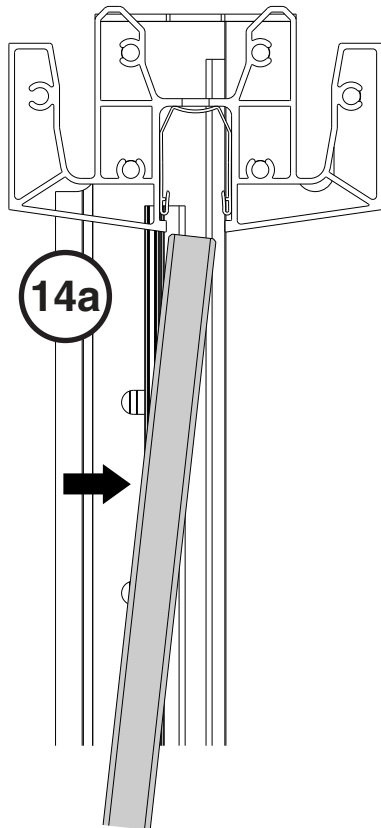

Frame for One Piece of Glass

15. Mark the center of the glass (tape and pencil mark as shown). Install the glass in the opening (see pages 11 & 12). Center the glass to the centerline marks. No glazing tape is required. Ensure that the glass edges are plumb and parallel. Re-verify levelness of product.

NOTE: If the glass edges are not plumb and parallel, use the glides to adjust glass up/down.

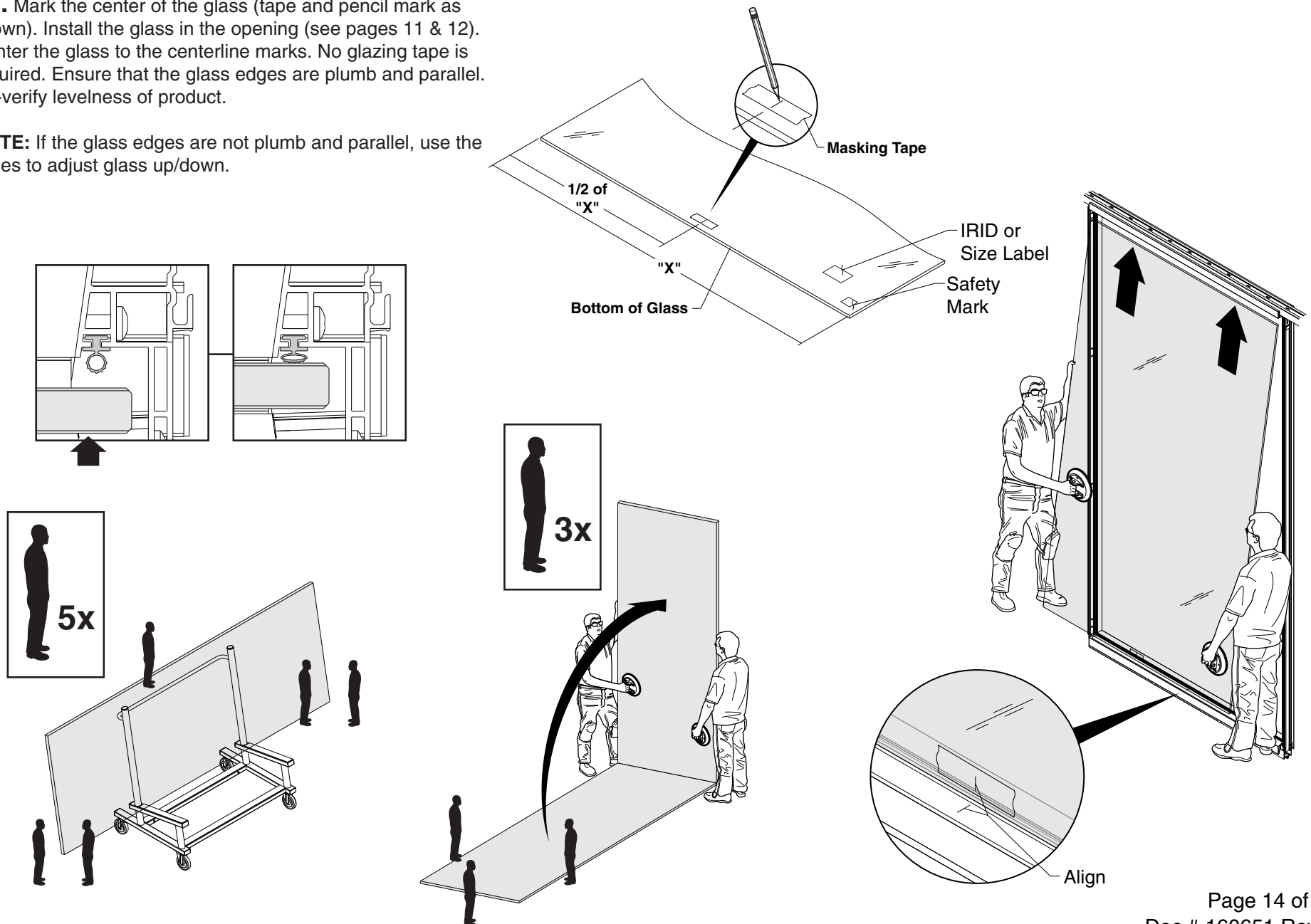

Frame for Two Pieces of Glass

15. Install the glazing tape on one piece of glass as shown on page 11. Install the two pieces of glass in the opening (see pages 11 & 12), making sure the glazing tape is located in the center of the frame. Bias the glass outwards in the frame opening during the installation.

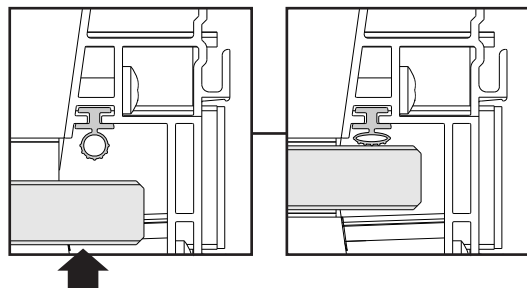

NOTE: Install first piece of glass biased outwards when installing.

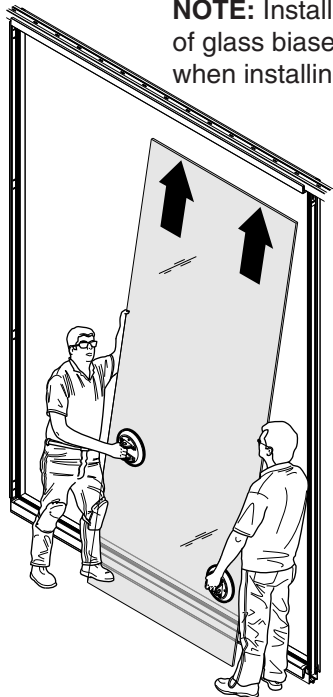

NOTE: When PW (Plan Width) is 60" or greater, add the provided spacer above the glass after the first piece of glass is installed. Install flush to the edge of the glass.

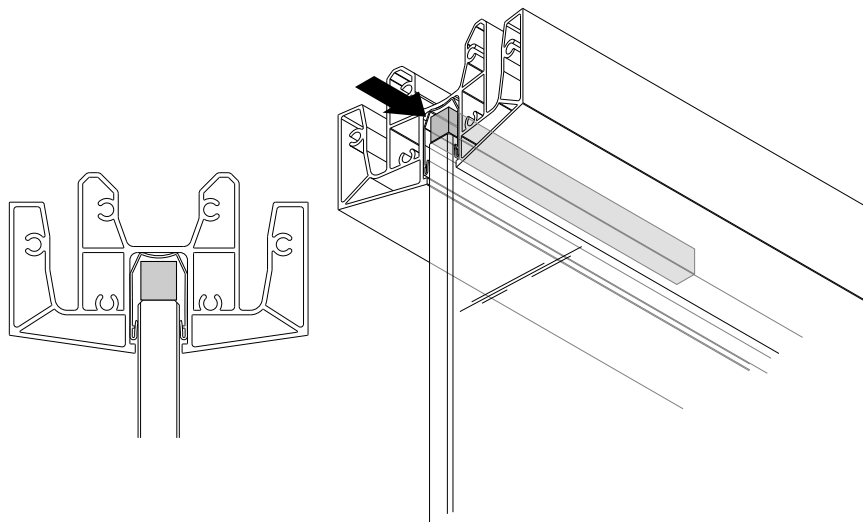

NOTE: Install second piece of glass biased outwards when installing.

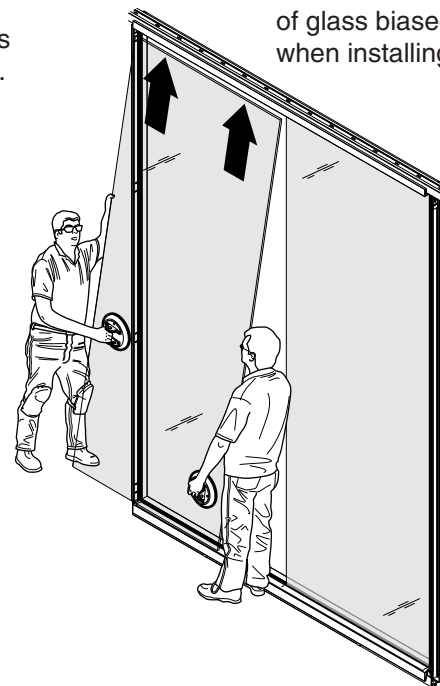

NOTE: If the glass edges are not plumb and parallel, use the glides to adjust glass up/down to get glass edges plumb and parallel to each other. Adjust position laterally as necessary when bonding the glass together.

Frame for Two Pieces of Glass (continued)

15. Remove backing from the glazing tape. Squeeze the two pieces of glass together using suction cup seam setter tool. Align to the centerline mark on the frame to the center of the two pieces of glass as shown. Re-verify levelness of product.

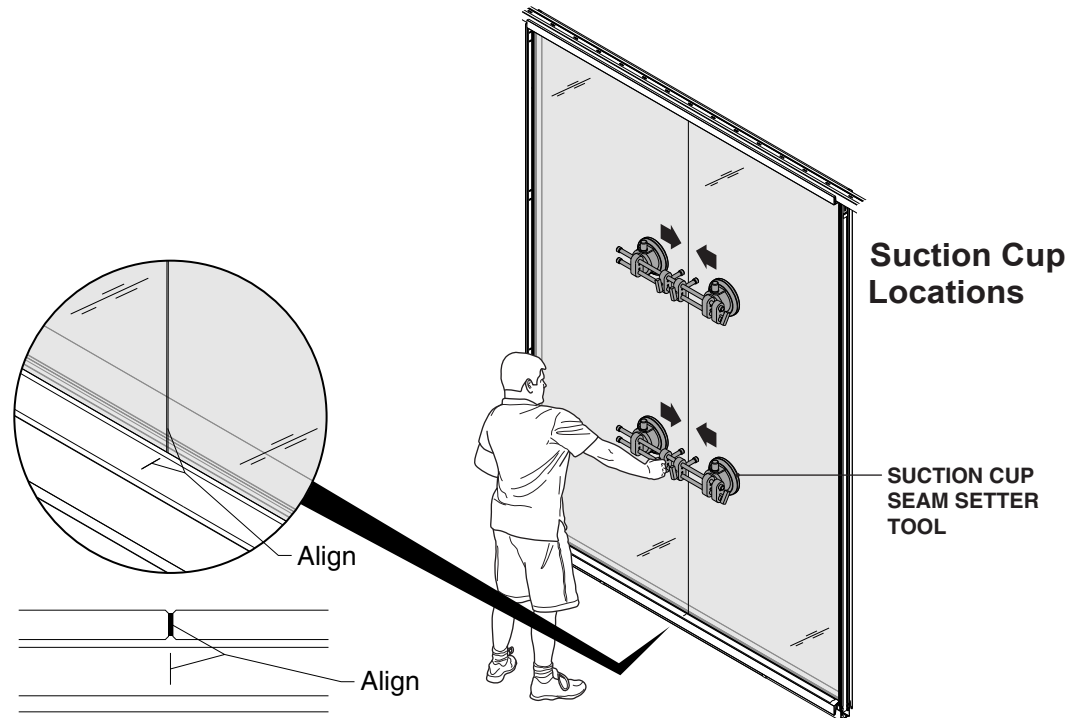
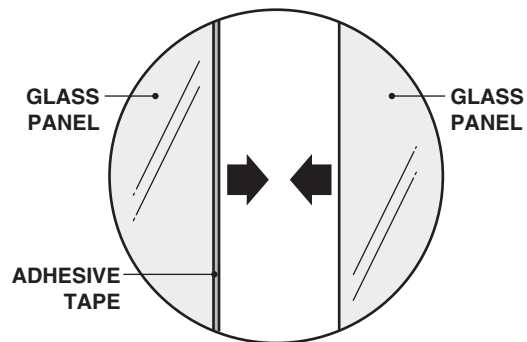
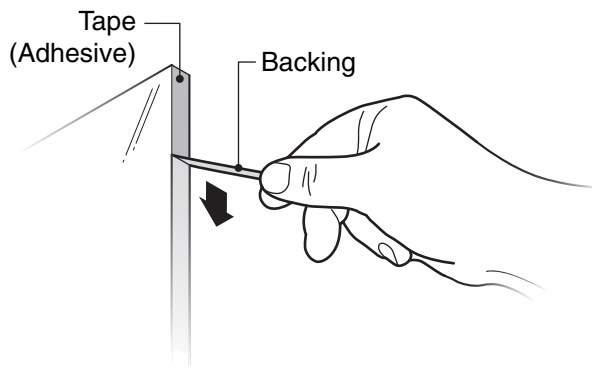

Frame for Three Pieces of Glass

15. Mark the center of the glass on the center piece of glass only (tape and pencil mark as shown). Install the glazing tape to the vertical edge that faces towards the center piece of glass on both the outside pieces of glass as shown on page 11.

NOTE: Center piece of glass should have **NO** glazing tape.
Install the two pieces of glass in the opening, making sure the glazing tape is mounted towards the center of the frame (see pages 11 & 12). Bias the glass outwards in the frame opening during the installation to allow room for the center piece of glass. Install the center piece of glass aligning the centerline marks on the glass and the frame.

NOTE: If the glass edges are not plumb and parallel, use the glides to adjust glass up/down to get glass edges plumb and parallel to each other. Adjust position laterally as necessary when bonding the glass together.

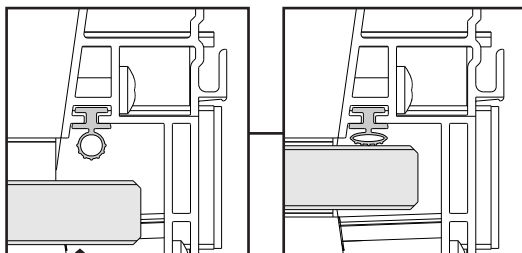
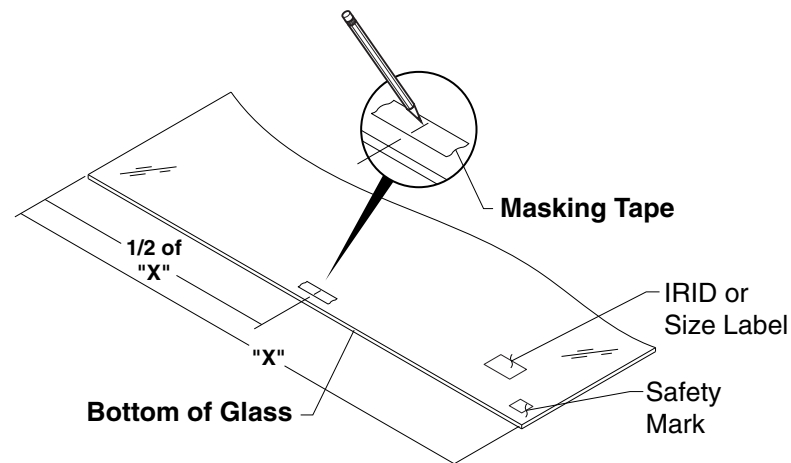

NOTE: When PW (Plan Width) is 60" or greater add spacers above both outer pieces of glass. Install flush to the edge of the glass.

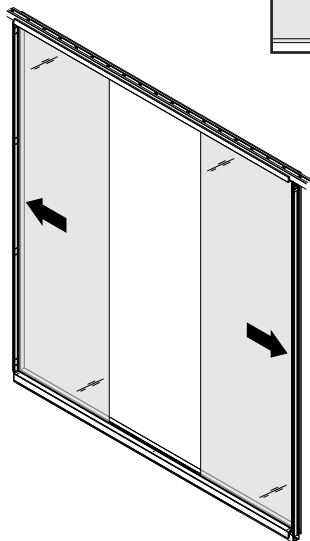

NOTE: Install both pieces of glass biased outwards when installing to allow room for the center piece of glass.

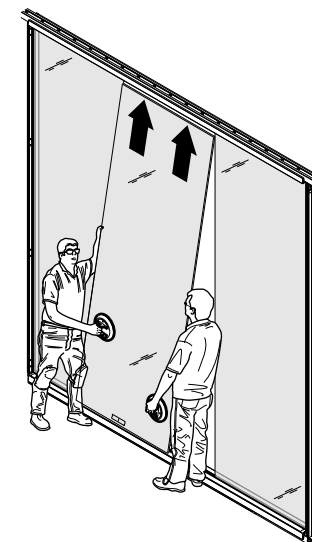
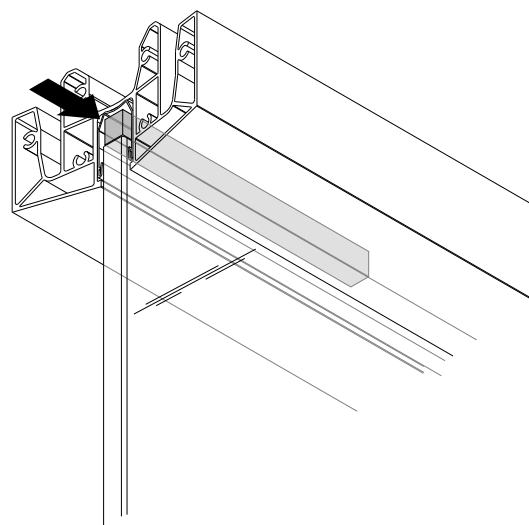
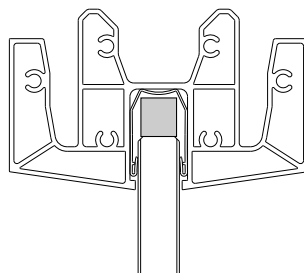

Frame for Three Pieces of Glass (continued)

15. Remove the backing from the glazing tape on each outer piece of glass. Squeeze one of the outer pieces of glass toward the center piece of glass using the suction cup seam setter tool while making sure the center piece of glass is aligned to the centerline mark on the frame and the glass as shown. Repeat for the other piece of glass.

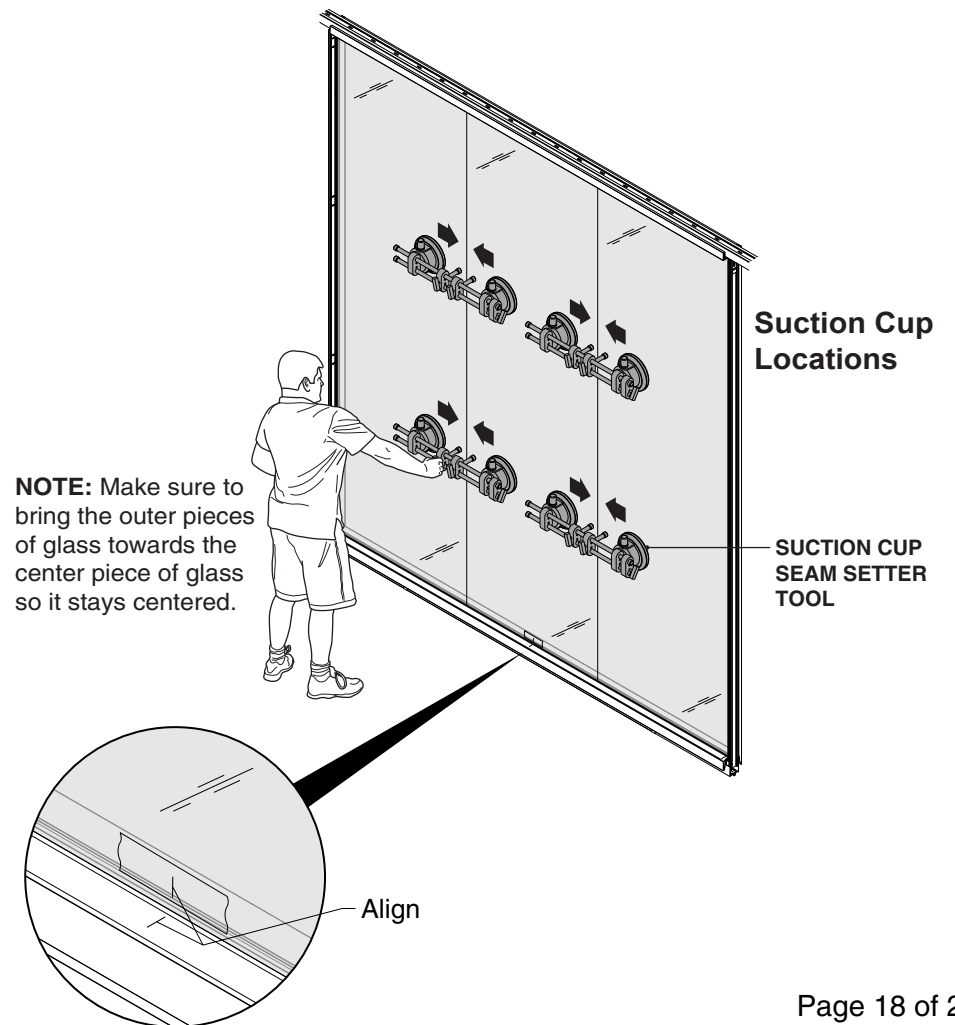
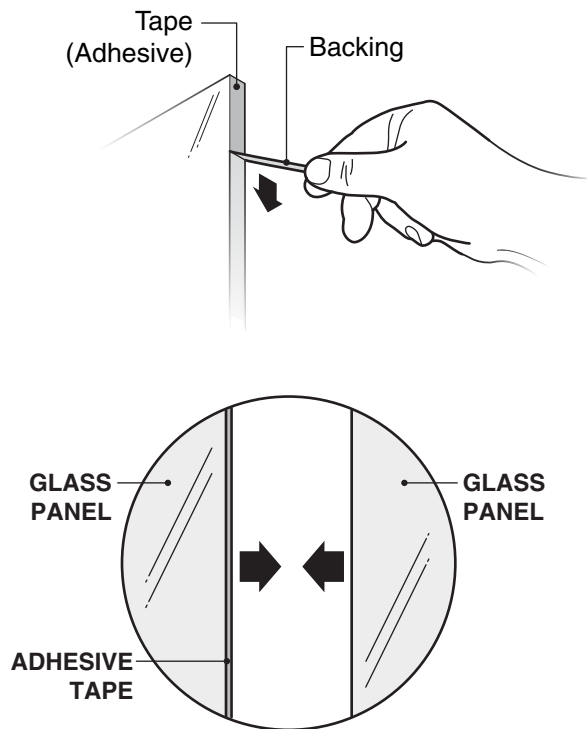

16. Install as many 1/8" spacers as possible in the gap between the aluminum and the glass at the bottom on both sides. A total of 4 shims (2 per side) are provided if needed.

NOTE: To retrofit new clips on old aluminum vertical extrusions or add additional clips, drill Ø.106 size hole for each clip thru 2 walls centered on the groove.

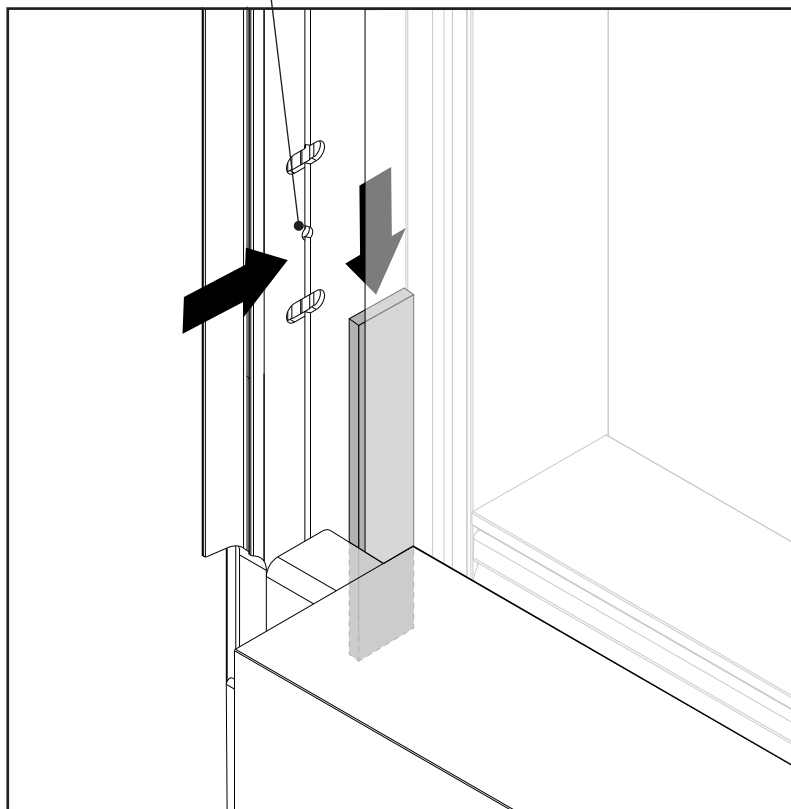

Both Sides

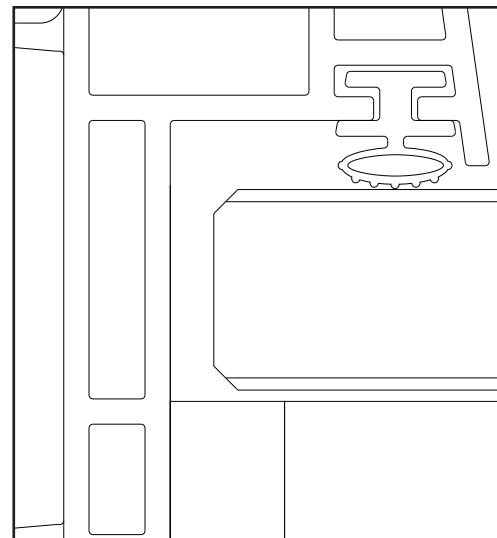

16A

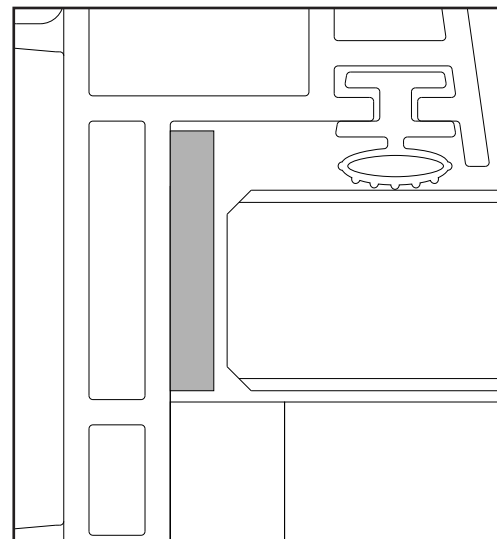

16B

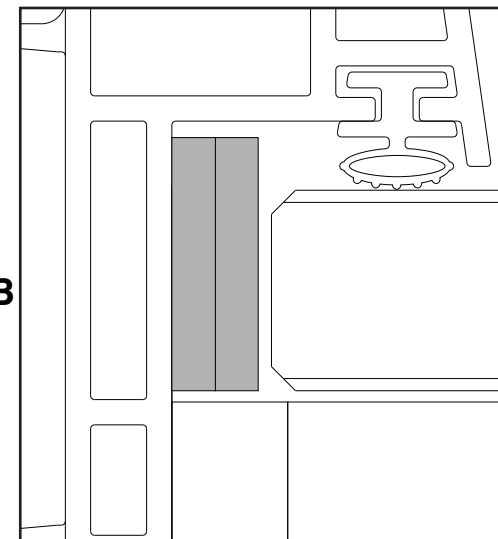

NOTE: Trim retention clips must be installed after the glass and shims are installed.

Prior to Date 12/18/23

17. Install all 4 clips on each side of the frame opening in the appropriate slot patterns by catching the front flange of the clip on the front flange of the aluminum as shown. Press all the way in and then rotate the back flanges to go into the two slots. Press flanges flush with finger or a screwdriver.

Verify trim retention clips are securely attached.

After Date 12/18/23

18. Slide clips on the vertical until they bottom out fully as shown (installing clip at an angle can help with front hooks). Secure fastener with phillips (P2) bit with a minimum of a 6" long extension.

NOTE: Very low torque required.

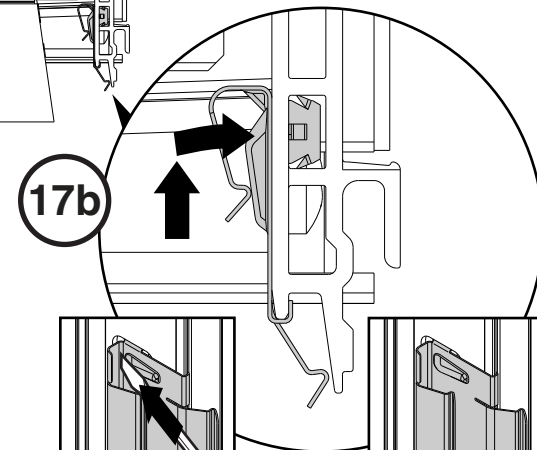
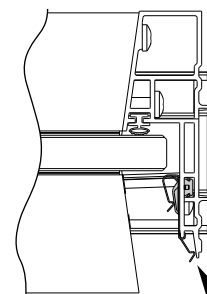
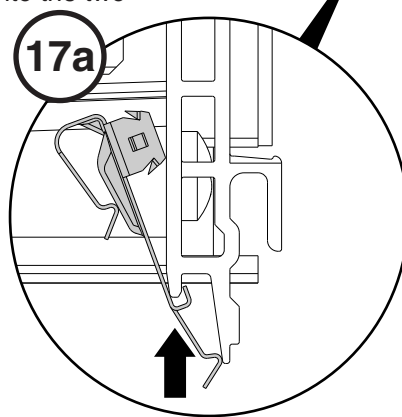
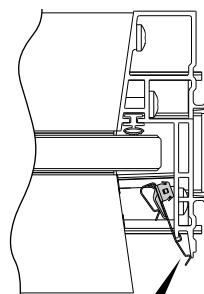
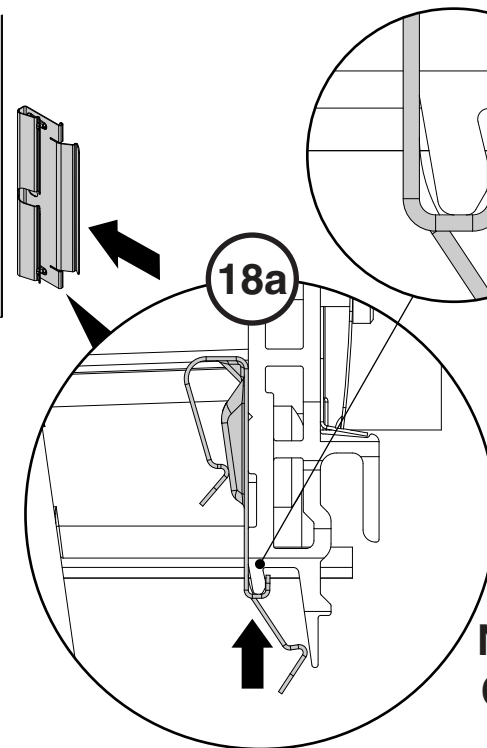
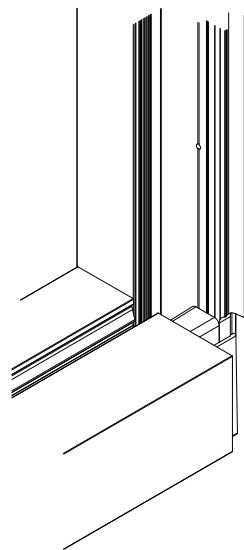
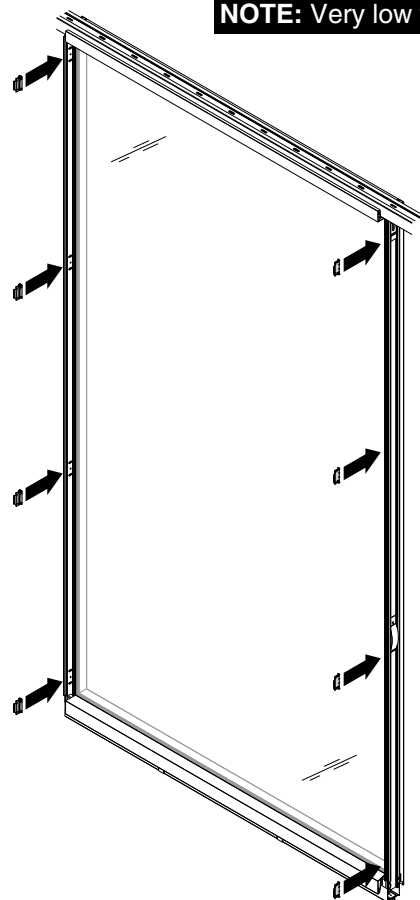

Old Clip

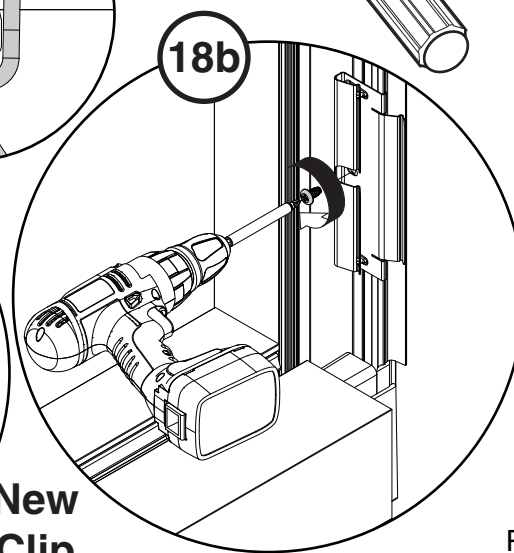
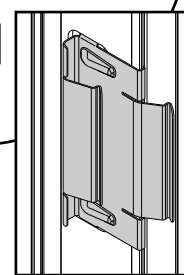
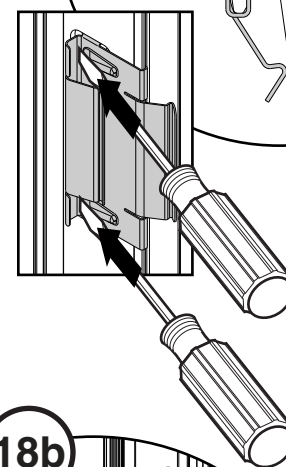

New Clip

NOTE: Longer length notch is located at the bottom end of the trim part. (See graphic on bottom right of page)

19. Position trim on the bottom edge of trim notch on the bottom plastic spacer already attached. Install by rotating vertically as you push the trim in to engage the clips. Secure trim in place by tapping with your hand or soft mallet on the way up until you hear and/or feel it retain at all four clip positions.

Verify retention of the trim at multiple positions.

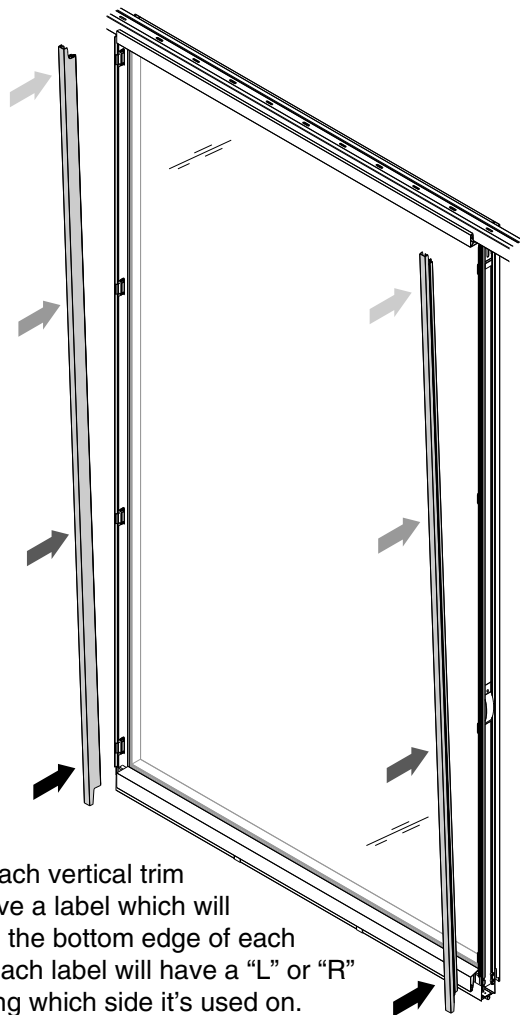

TIP: Each vertical trim will have a label which will dictate the bottom edge of each part. Each label will have a "L" or "R" dictating which side it's used on.

Top view images of top of trim to help show installation process.

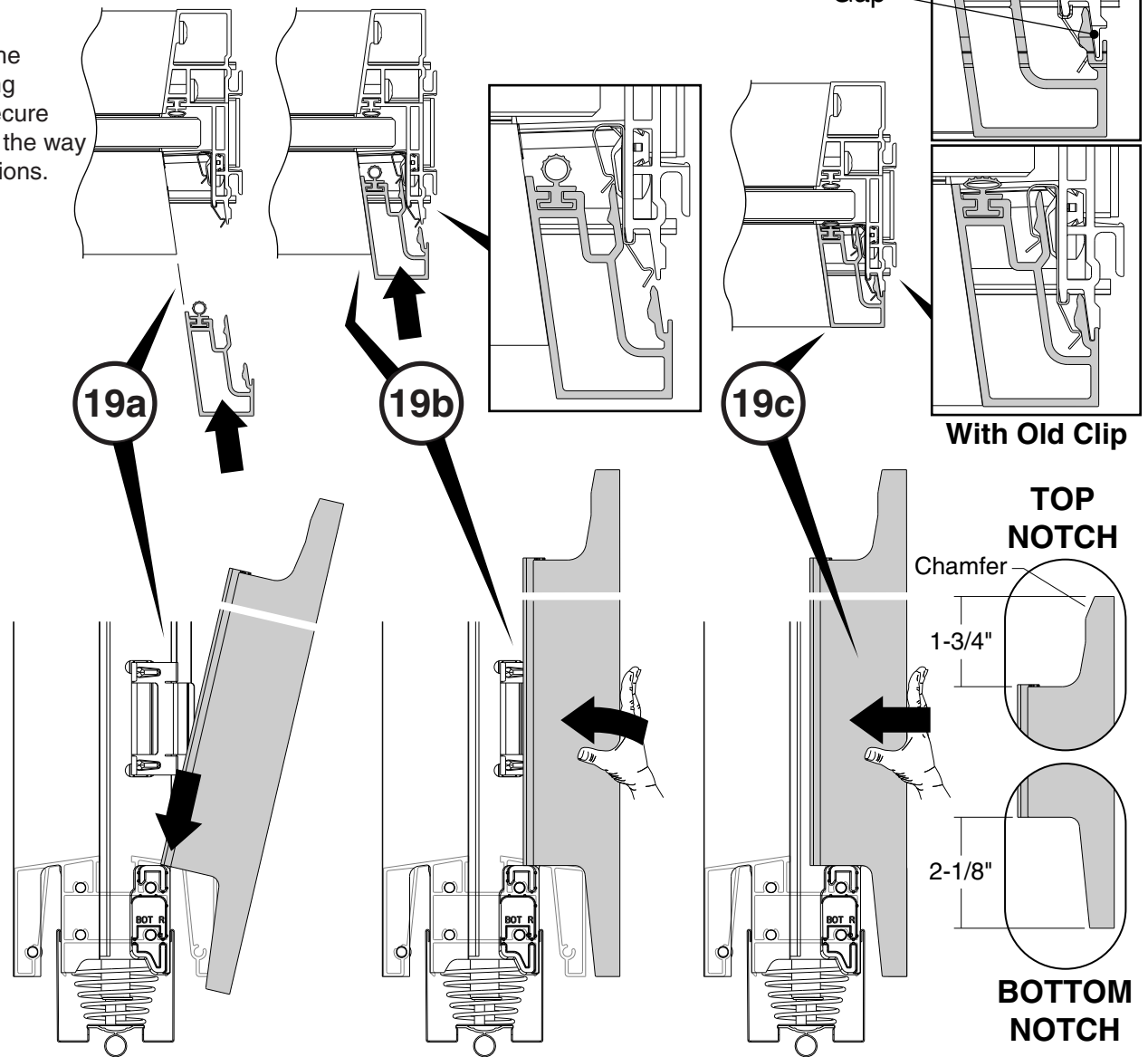

Side view images of bottom of trim to help tell the difference from the top views.

REMOVAL
OF TRIM

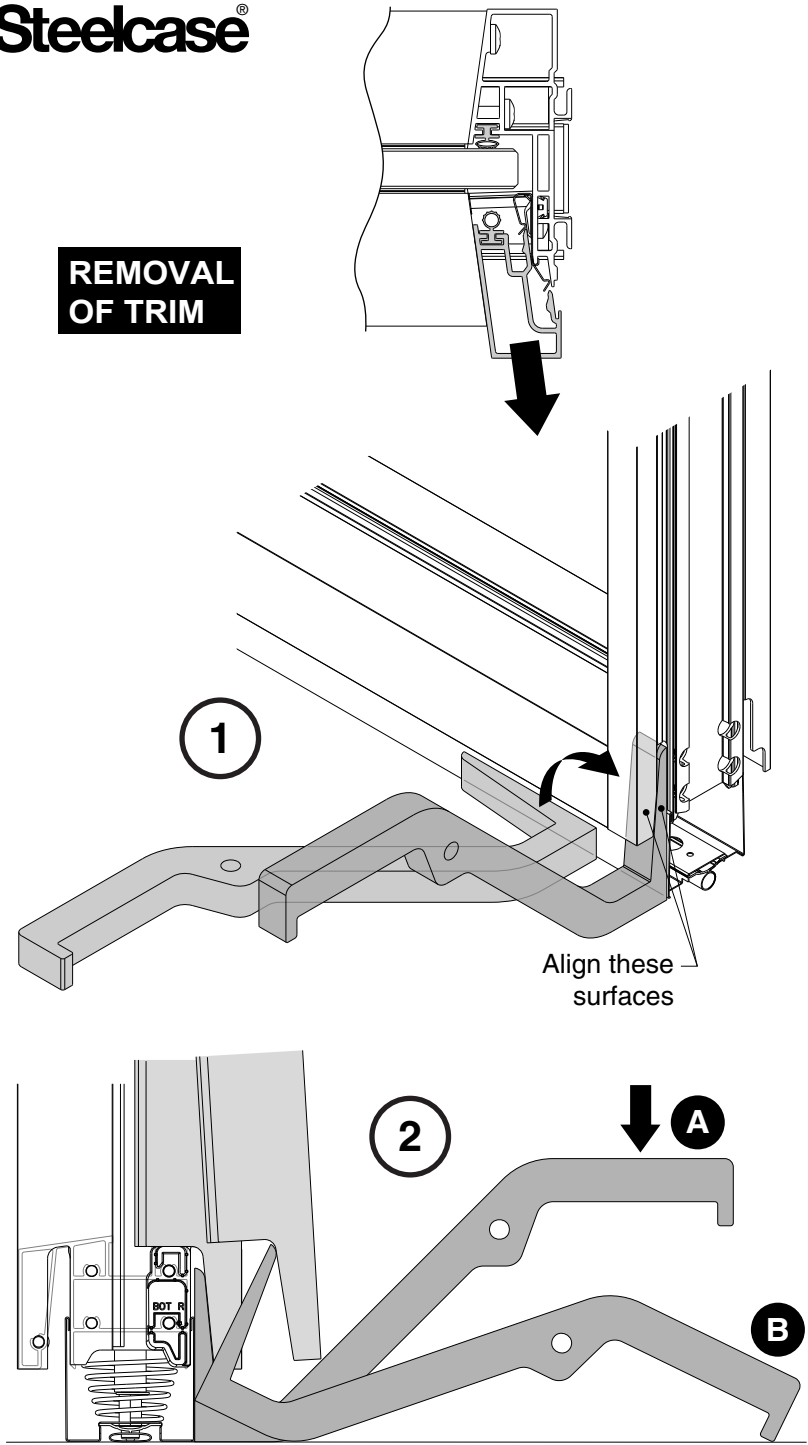

REMOVAL
OF OLD CLIP

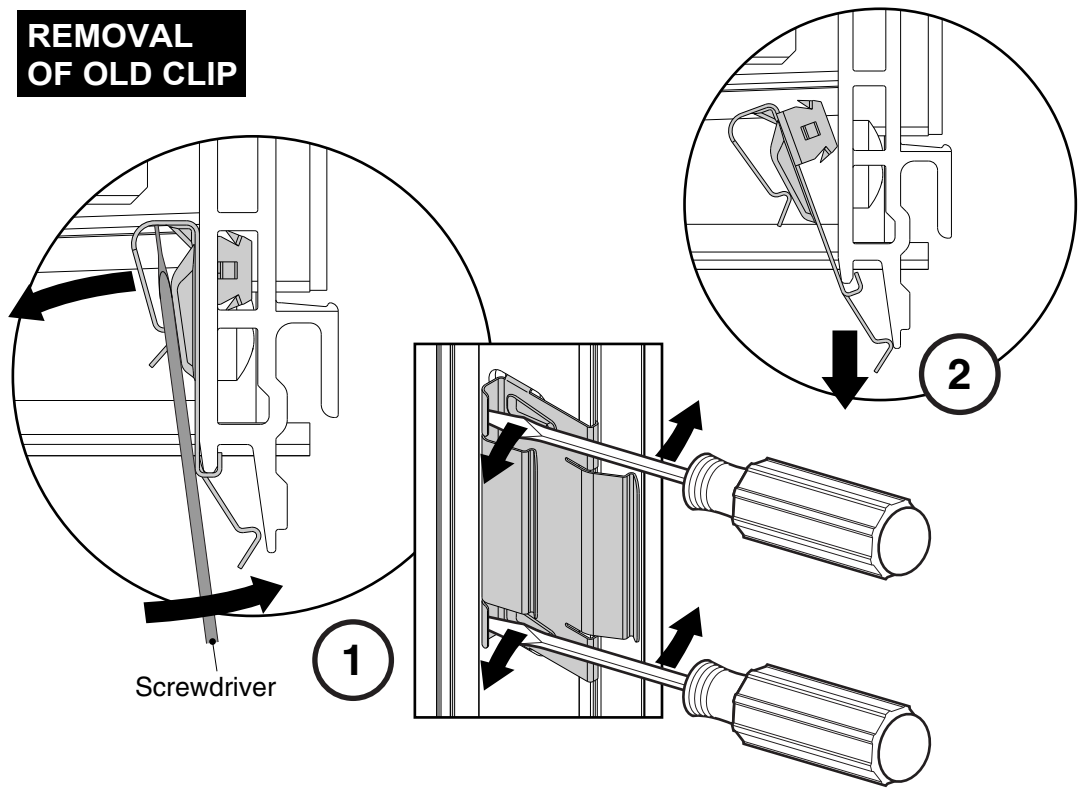

REMOVAL
OF NEW CLIP

