

Four Transom-Aligned Lites

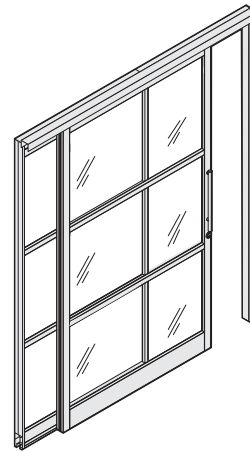

Three Equal Divided Lites

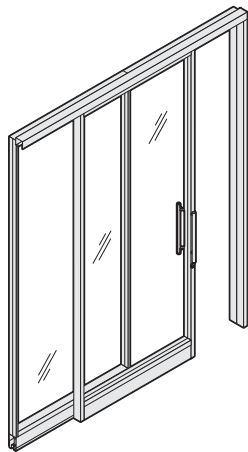

Full Glass

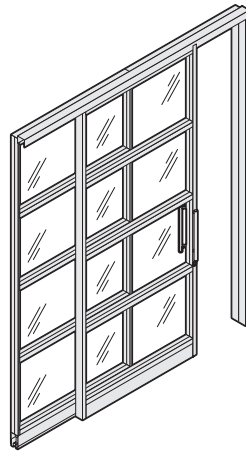

Four Equal Divided Lites

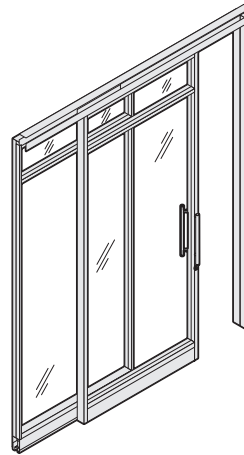

Two Transom-Aligned Lites

## Privacy Wall Slider Door

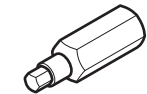

3/16" HEX BIT

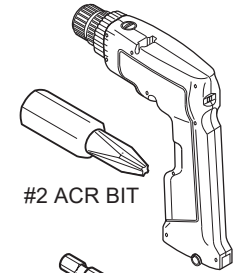
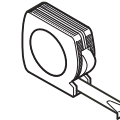

#2 ACR BIT

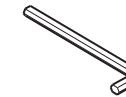

5/64 HEX

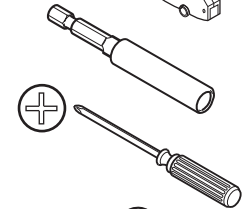

5/32  
DRILL BIT

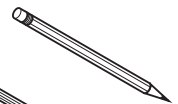
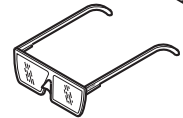

1"  
OPEN END  
WRENCH

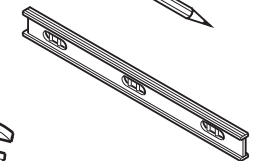

LOCTITE 425®



PLUMB BOB

## Components

HANGER KIT ASSY WITH  
SCREWS INCLUDED IN  
HARDWARE BAG

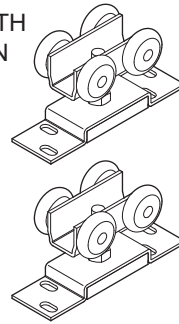
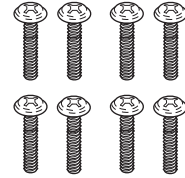

CLAMP CHANNEL &  
#10-16 x 1-1/2" PH TAP SCREWS

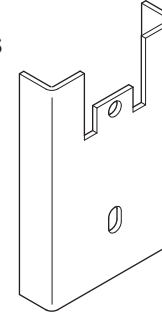
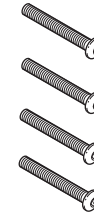

BACK-TO-BACK  
SLIDING DOOR COVER



DOUBLE STRIKE  
SLIDER PLINTH &  
#8-18 x 1/2"  
UNDERCUT FLAT  
HEAD TAP SCREWS

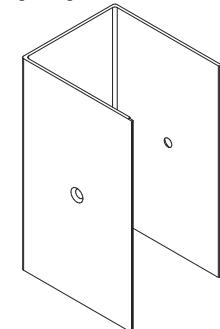

SLIDING DOOR

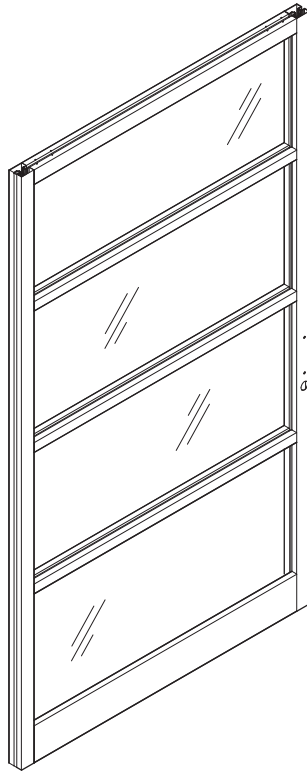

(1) NON-LOCKING  
& (1) LOCKING  
DOOR STOP  
CHANNEL ASSY

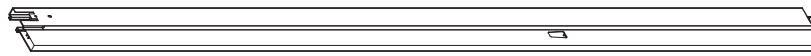

SLIDING DOOR  
FRAME  
CHANNEL

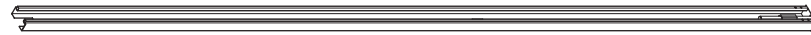

SLIDING DOOR TRACK,  
SLIDER TRACK FASCIA ASSY,  
BUMPER STOP ASSY'S,  
#10-16 x 3/4" SELF DRILL PH SCREWS,  
1/4-20 X 3/4" BTN HD HEX DR CAP  
SCREWS  
& 1/4-20 NUTS

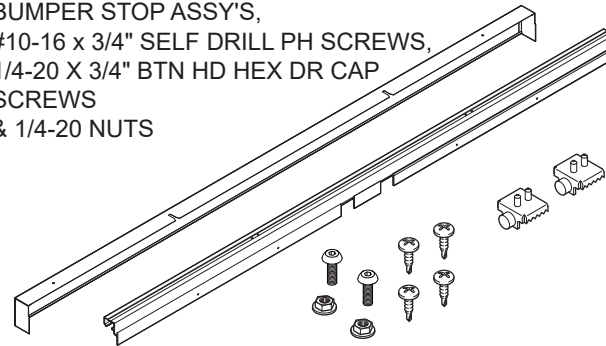

LOCK KIT CONSISTING OF:  
SLIDING DOOR HANDLE ASSY,  
ADAMS RITE LOCK,  
KEY MORTISE  
CYLINDER &  
1-1/8" THUMB  
TURN LEVER

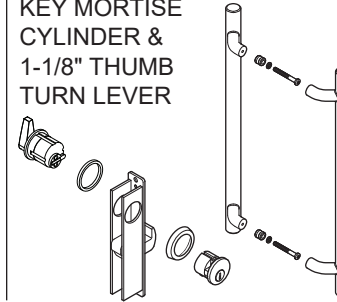

SLIDING DOOR CHANNEL,  
FINISHED END CAP ASSY &  
#10-16 x 1-1/2" PH TAP SCREWS

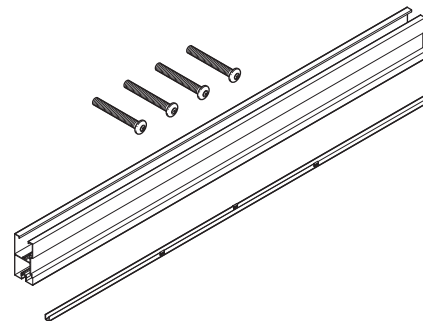

SINGLE STRIKE SLIDER PLINTH TRIMS,  
SLIDER STRIKE PLINTH TRIM &  
#8-18 x 1/2" UNDERCUT FLAT HEAD TAP SCREWS

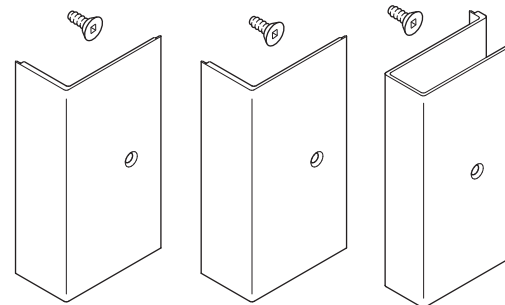

SLIDING DOOR GUIDE ASSY &  
#8-32 x 1/4" PAN HD TAP SCREWS

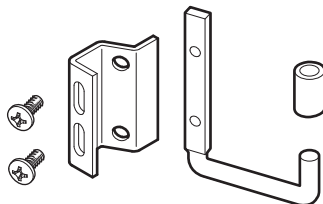

1. Install the fixed panel up into the ceiling track.
2. Build the finished frame using a clamp channel and four (4) #10-16 x 1-1/2" pan head tapping screws.

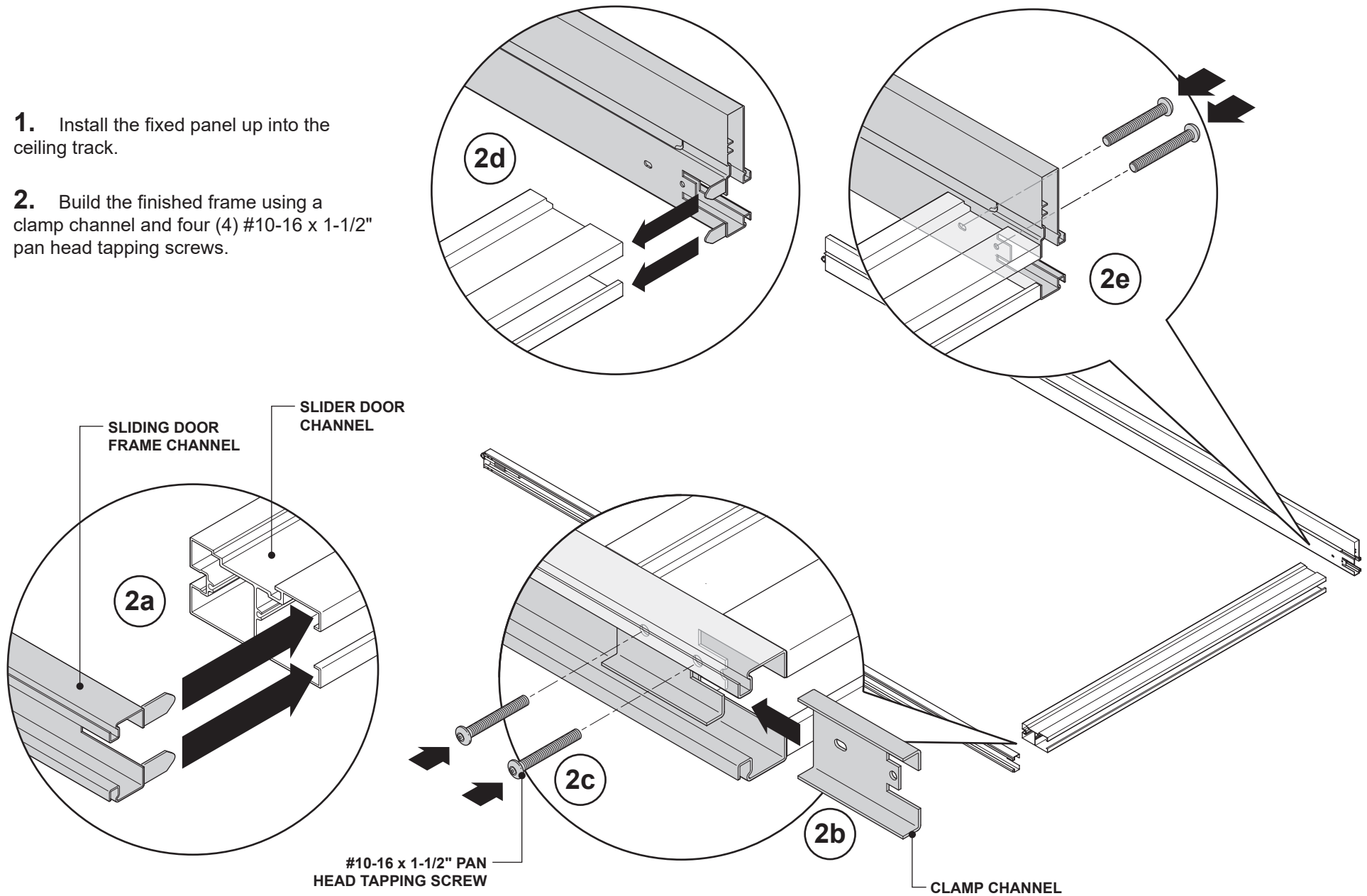

- 3.** Install the finished frame into the opening between the fixed frame and the Pathways Privacy Wall.

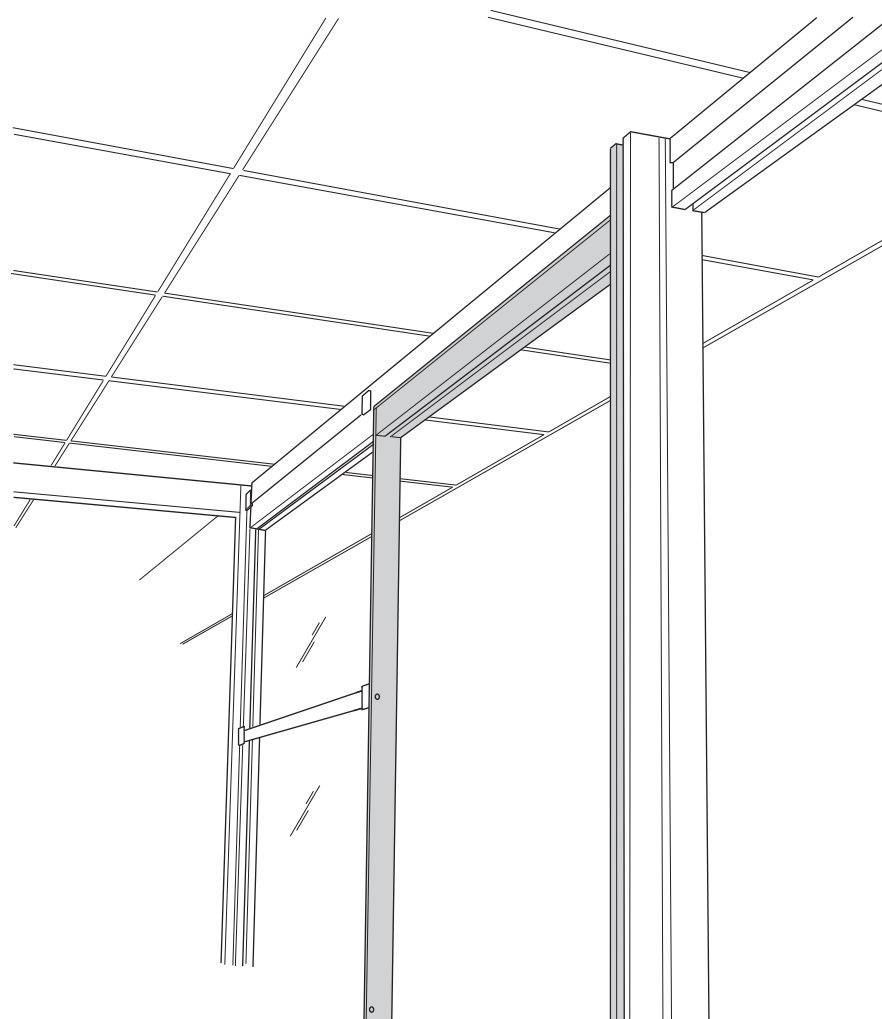
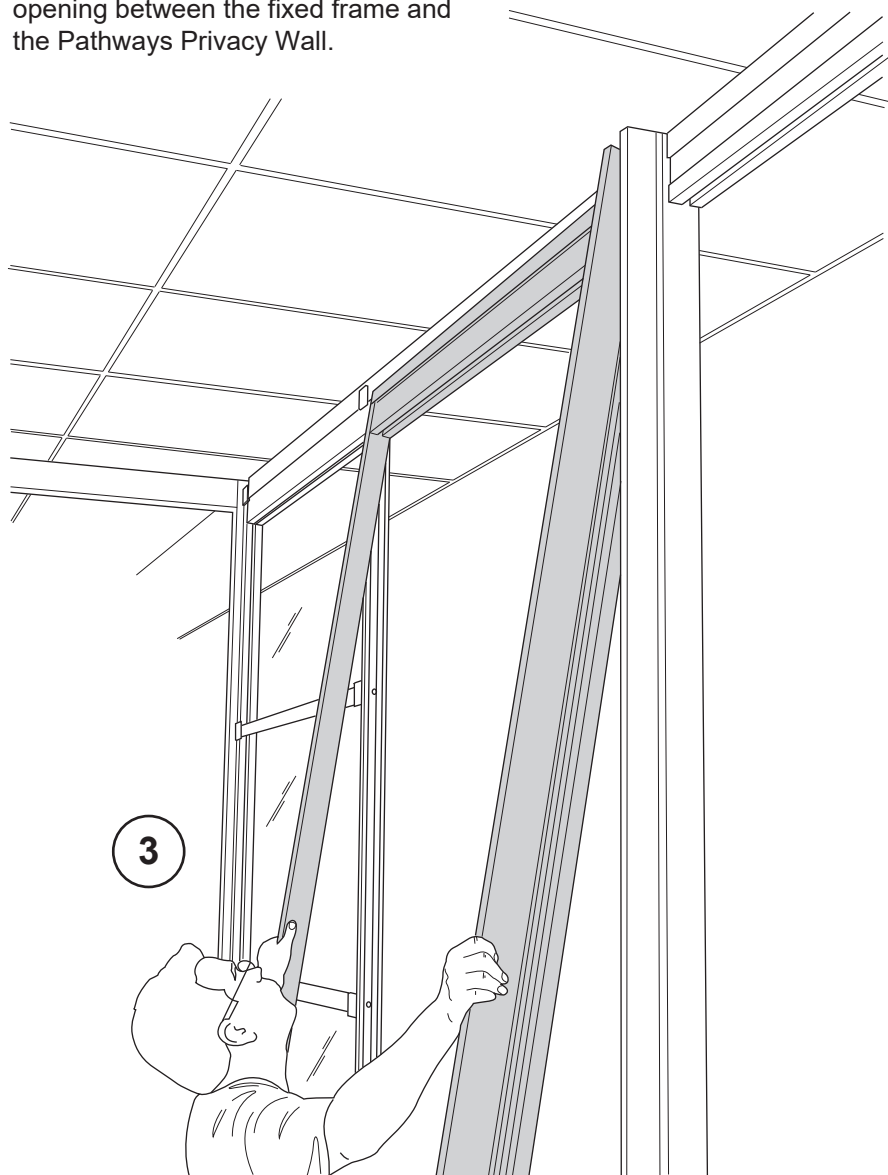

- 4.** Level the panels and finished frame checking.

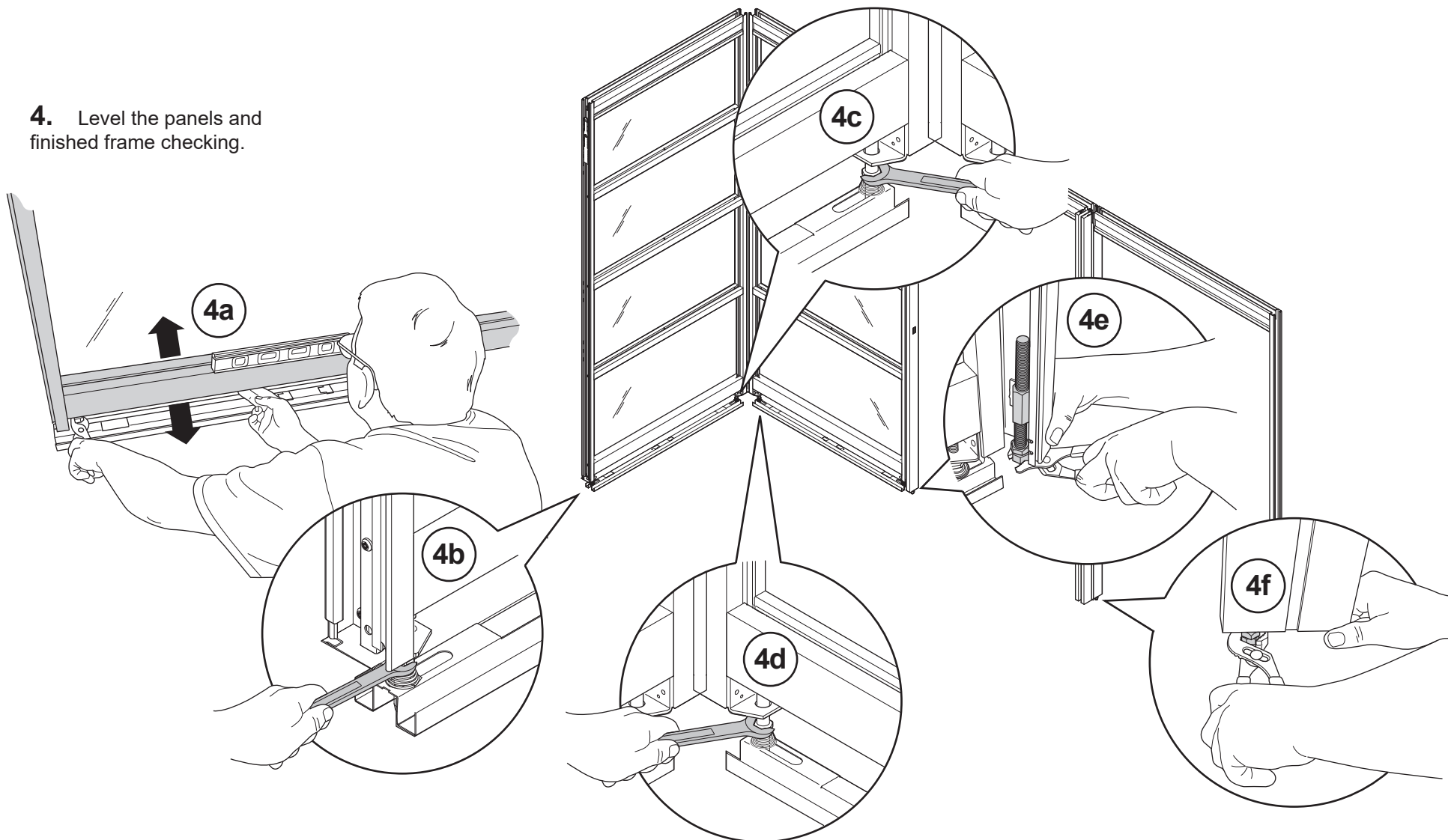

## 5. Checking for plumb and squareness.

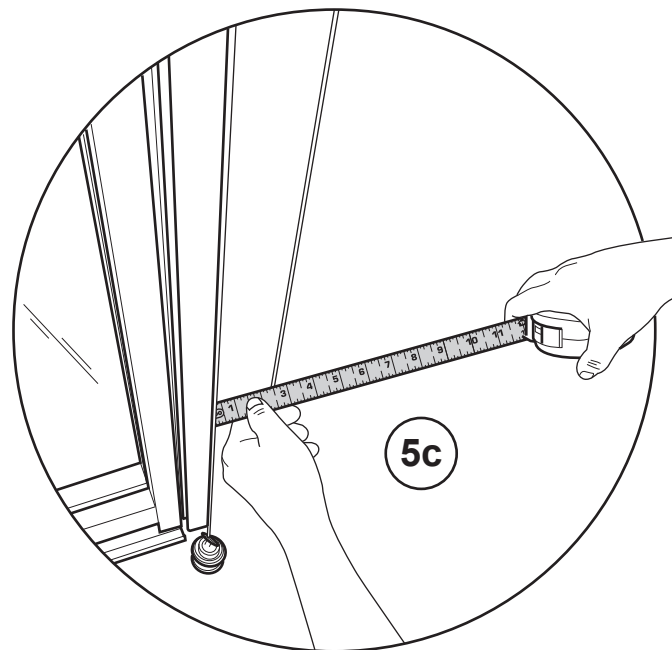
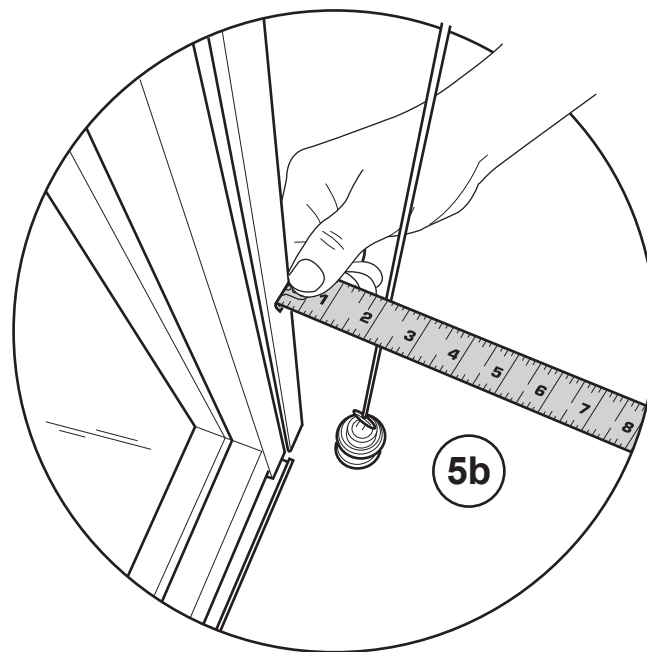
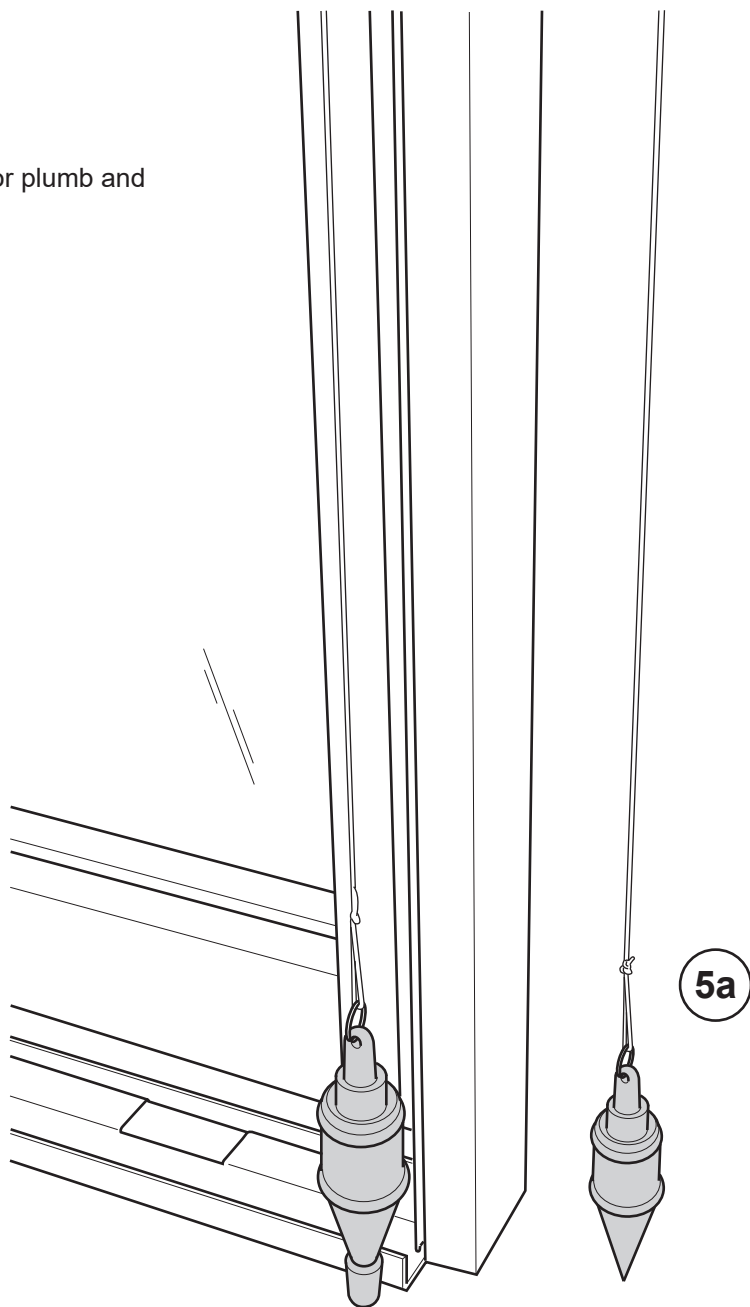

**6.** Install the feature strips and lock the frame to the fixed panel and the Pathways Privacy Wall.

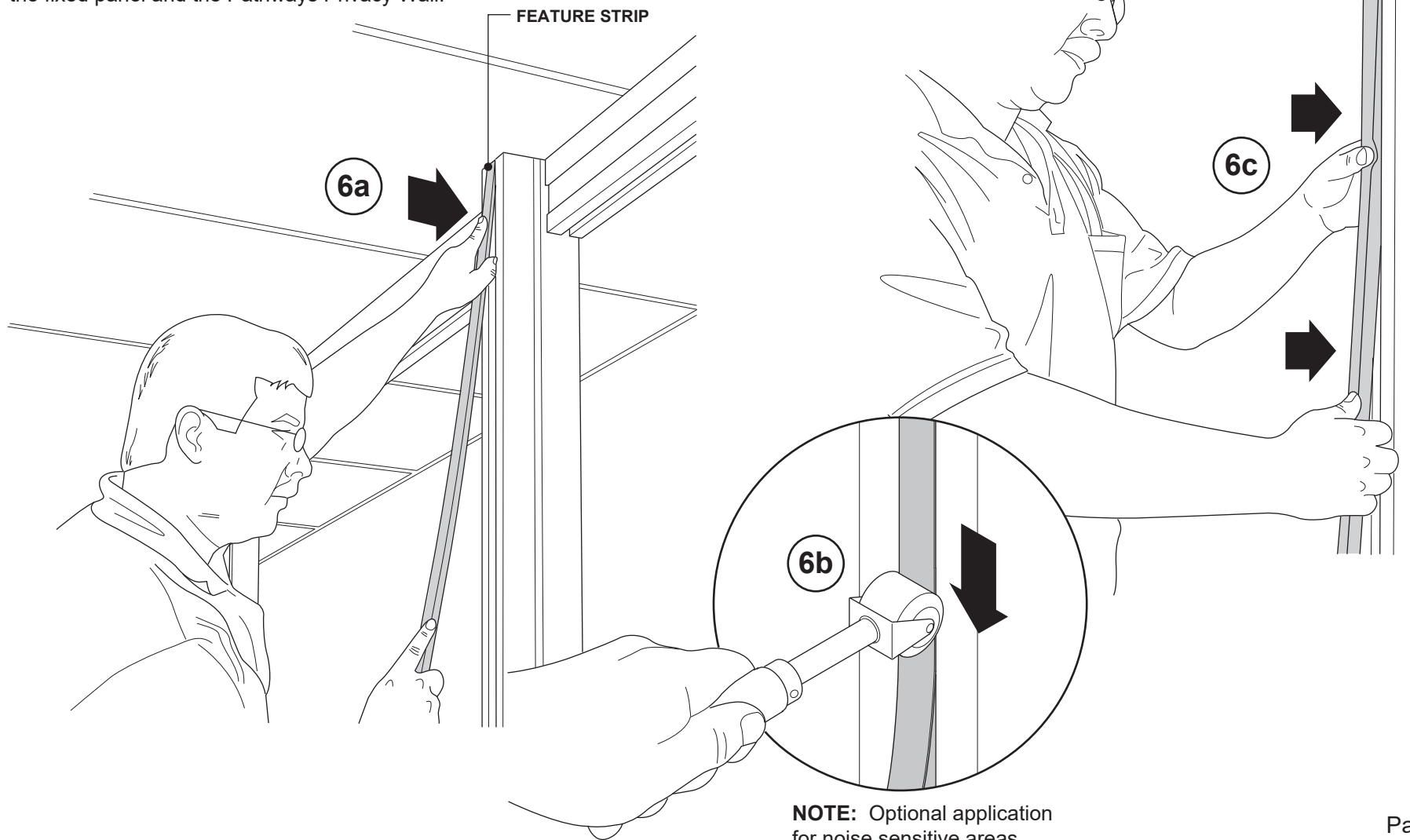

**NOTE:** Optional application for noise sensitive areas.



**7.** Install the sliding door track (7a). The sliding door track has two notches (7b) this is so the track is non-handed. Place the track in the top horizontals and lock into place with four (4) #10-16 x 3/4" self drilling pan head screws.

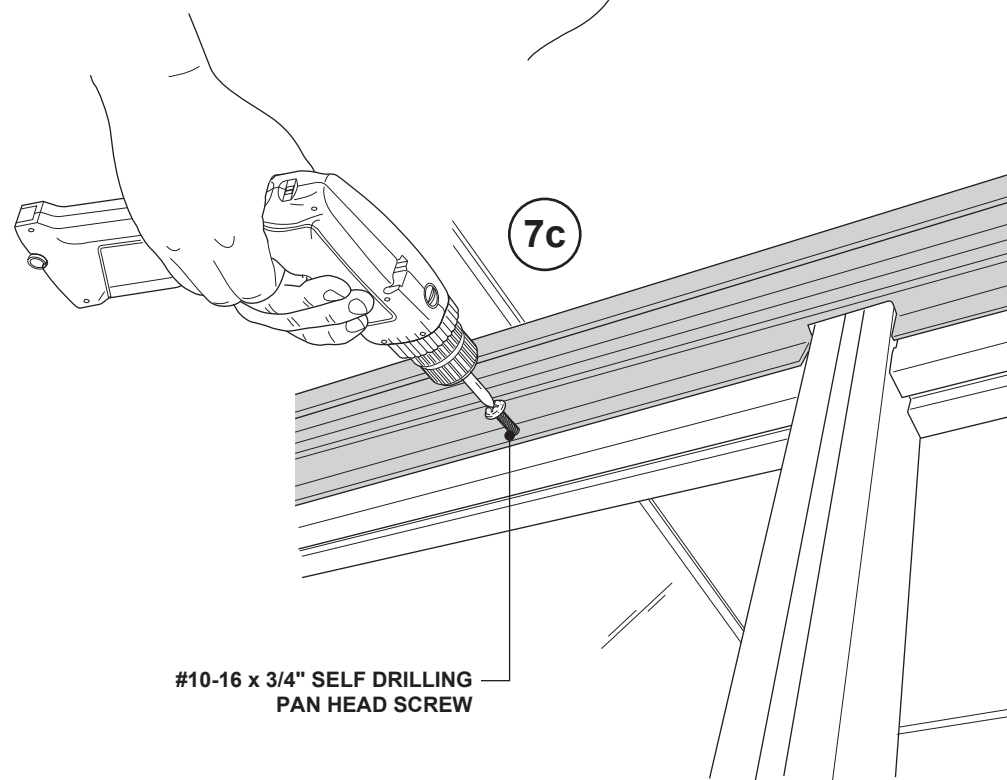
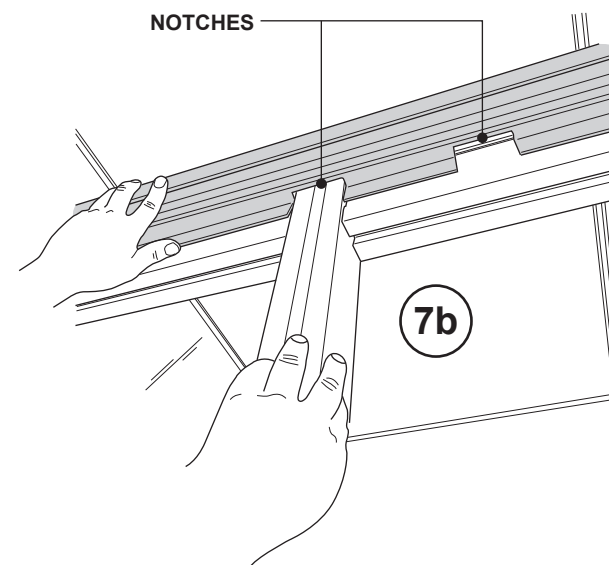
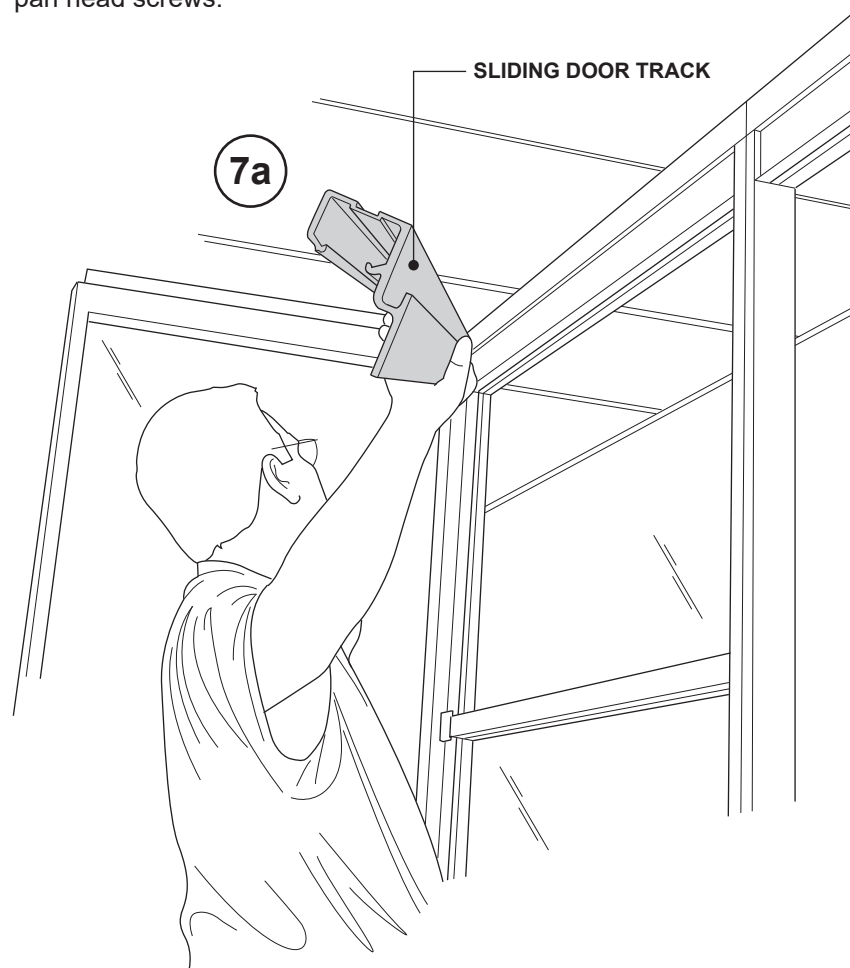



**8.** Install slider door guide assembly components together per the correct handing (8a). Install the slider door guide assembly onto the door stop channel assembly next to the fixed panel on the door side of the frame (8b). Support the slider door guide assembly temporarily with foam (8c). Install with (2) two #8-32 x 1/4" pan head tapping screws (8d).

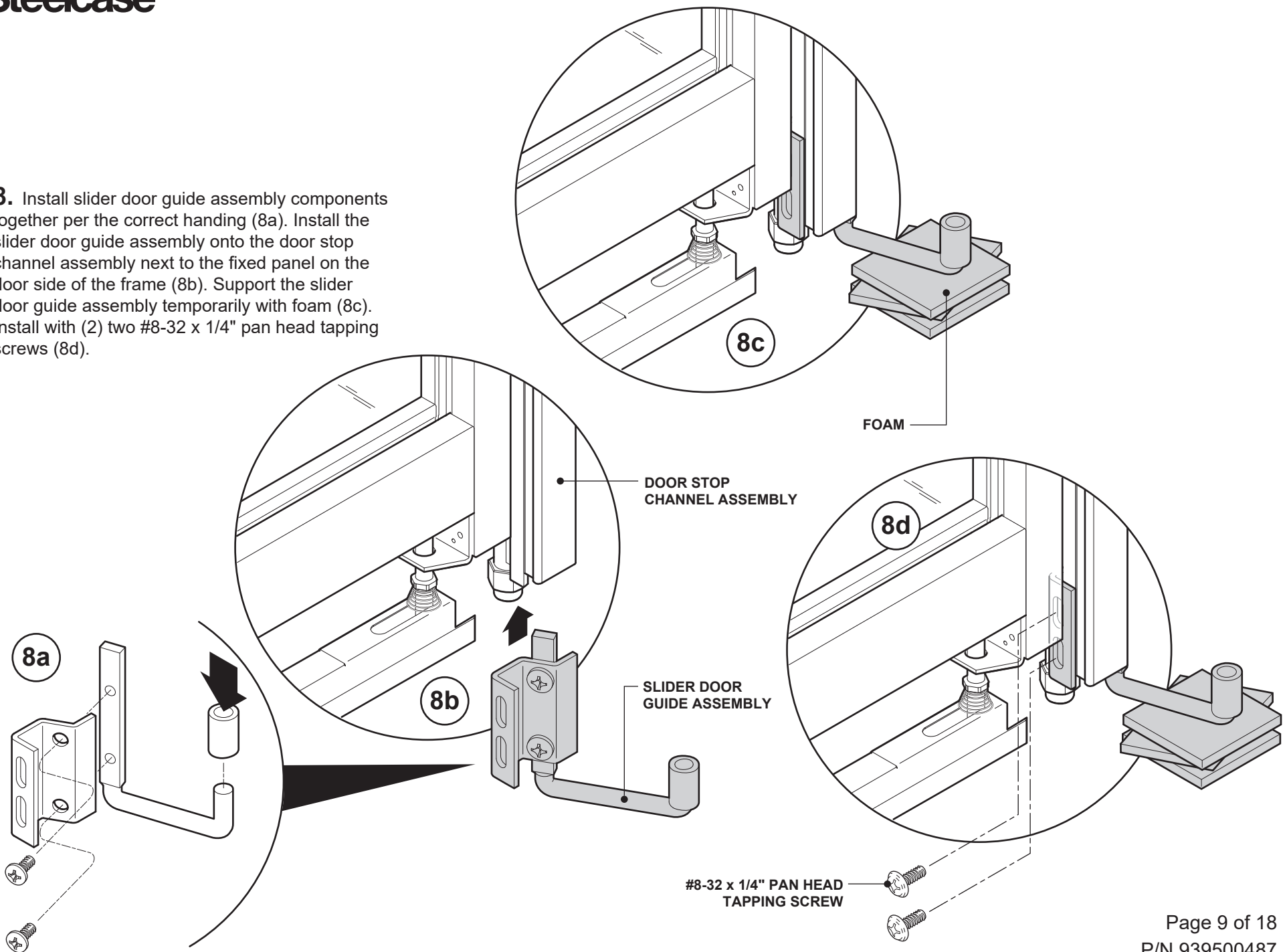

**9.** Install the bumper stop assemblies loosely and the hanger kit assemblies (wheel portion) into the sliding door track (9a). Mount the hanger kit assembly (bracket) on top of the sliding door (9b) with screws that are provided with the hanger kit.

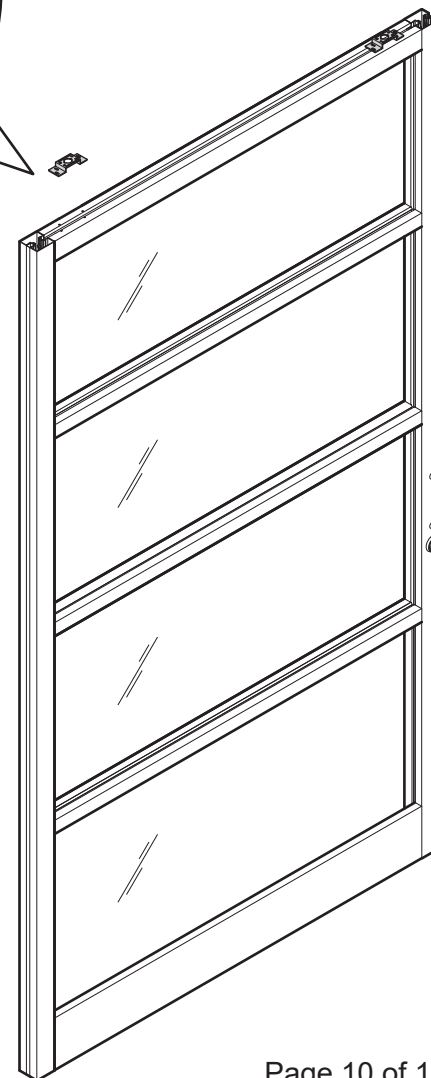
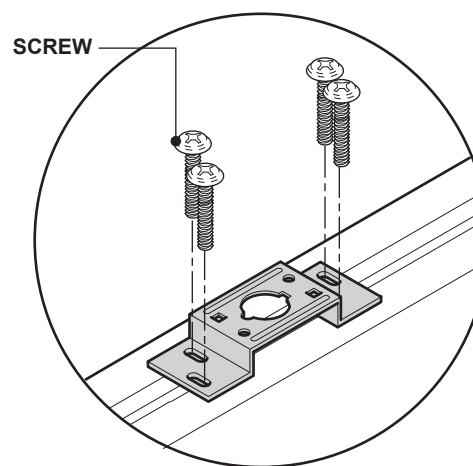
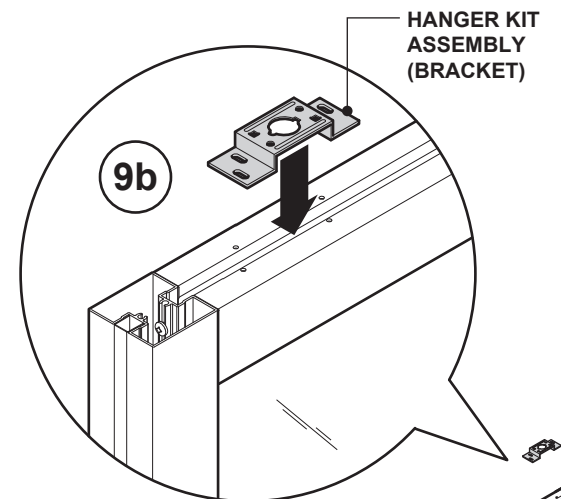
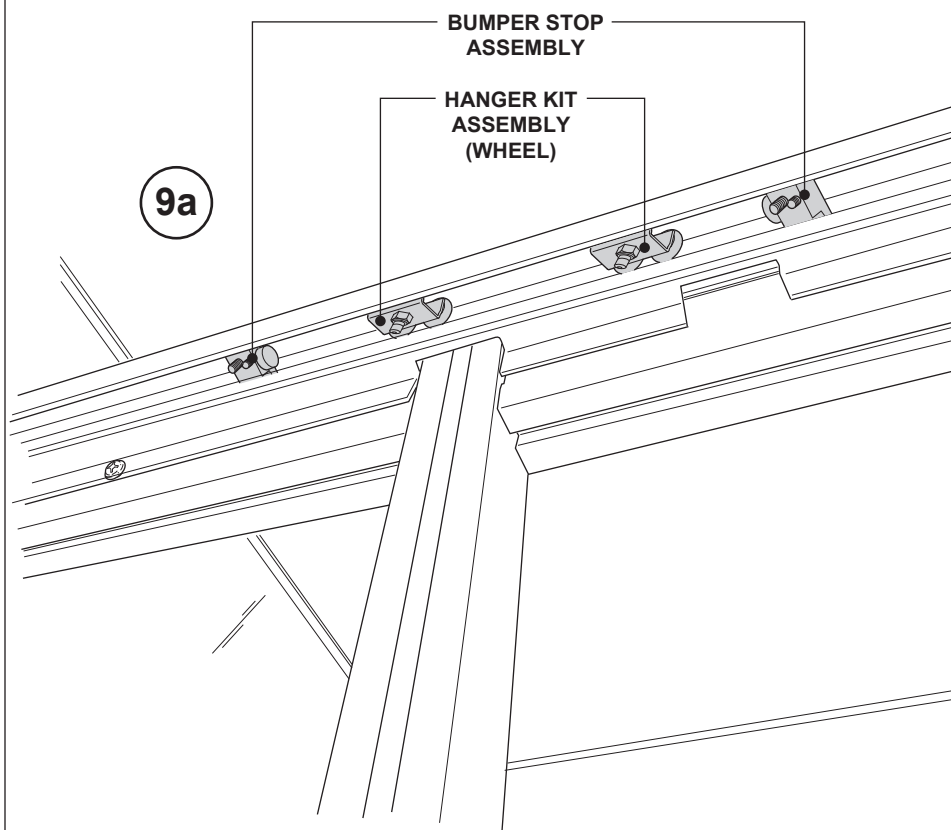

**10.** Position the bottom of the sliding door on the guide assembly (10a) and tilt the top up. Next, engage the sliding door onto the hanger kit then lock the hanger kit in place (10b). Now adjust the hanger kit up or down to align sliding door, frame and panels. Adjust the bumper stop assemblies (10c).

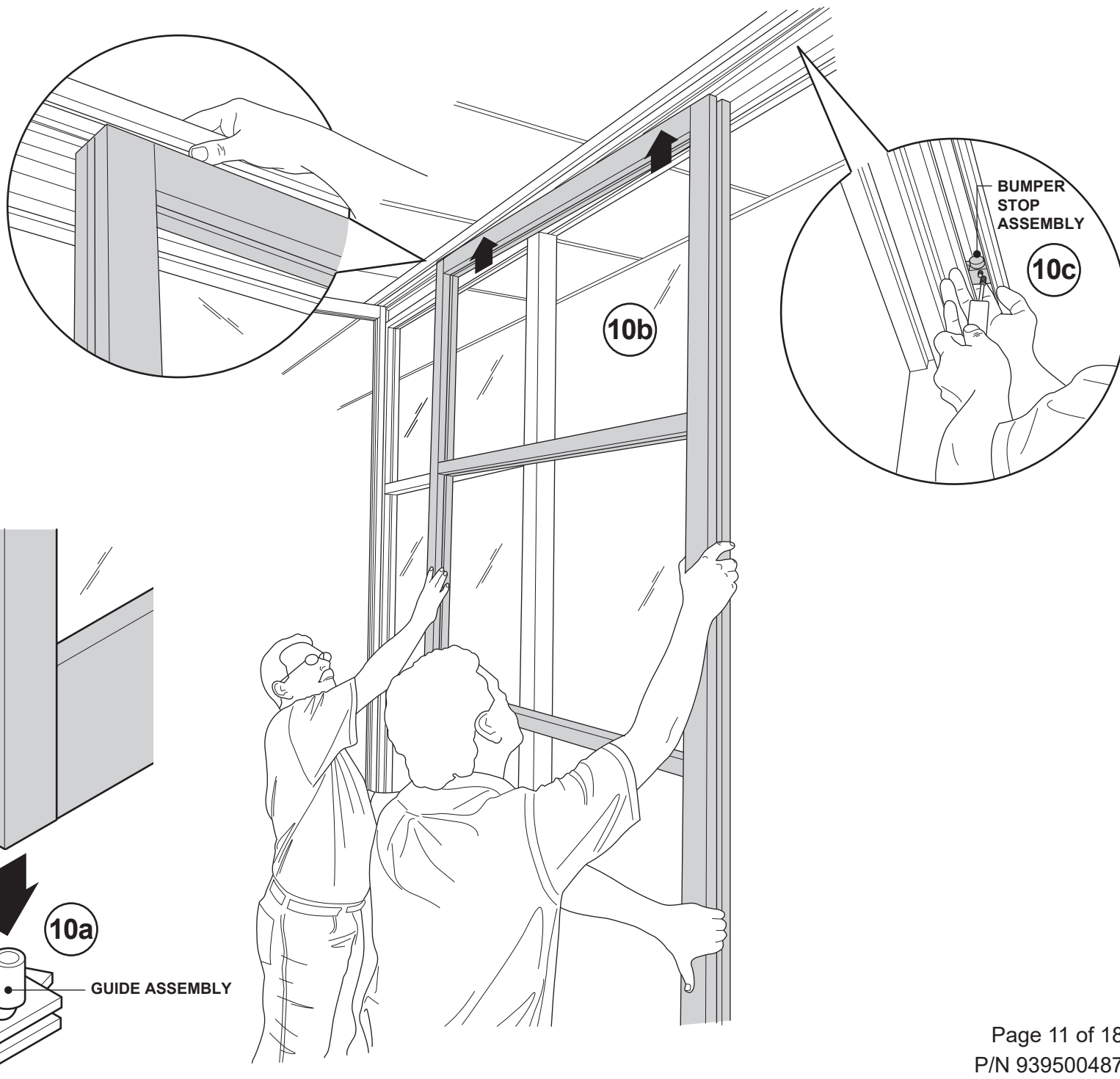

**11.** There are two sets of holes on the door track. Place the fascia on top of the door track to see which holes are used for your installation.

Install the 1/4-20 X 3/4" BTN HD HEX DR CAP SCREWS up from bottom side and add the 1/4-20nuts to the top side of the door track (11a) loosely, leaving room to slide the fascia between the track and the nuts. Position the fascia (11b) and tighten the nuts (11c).

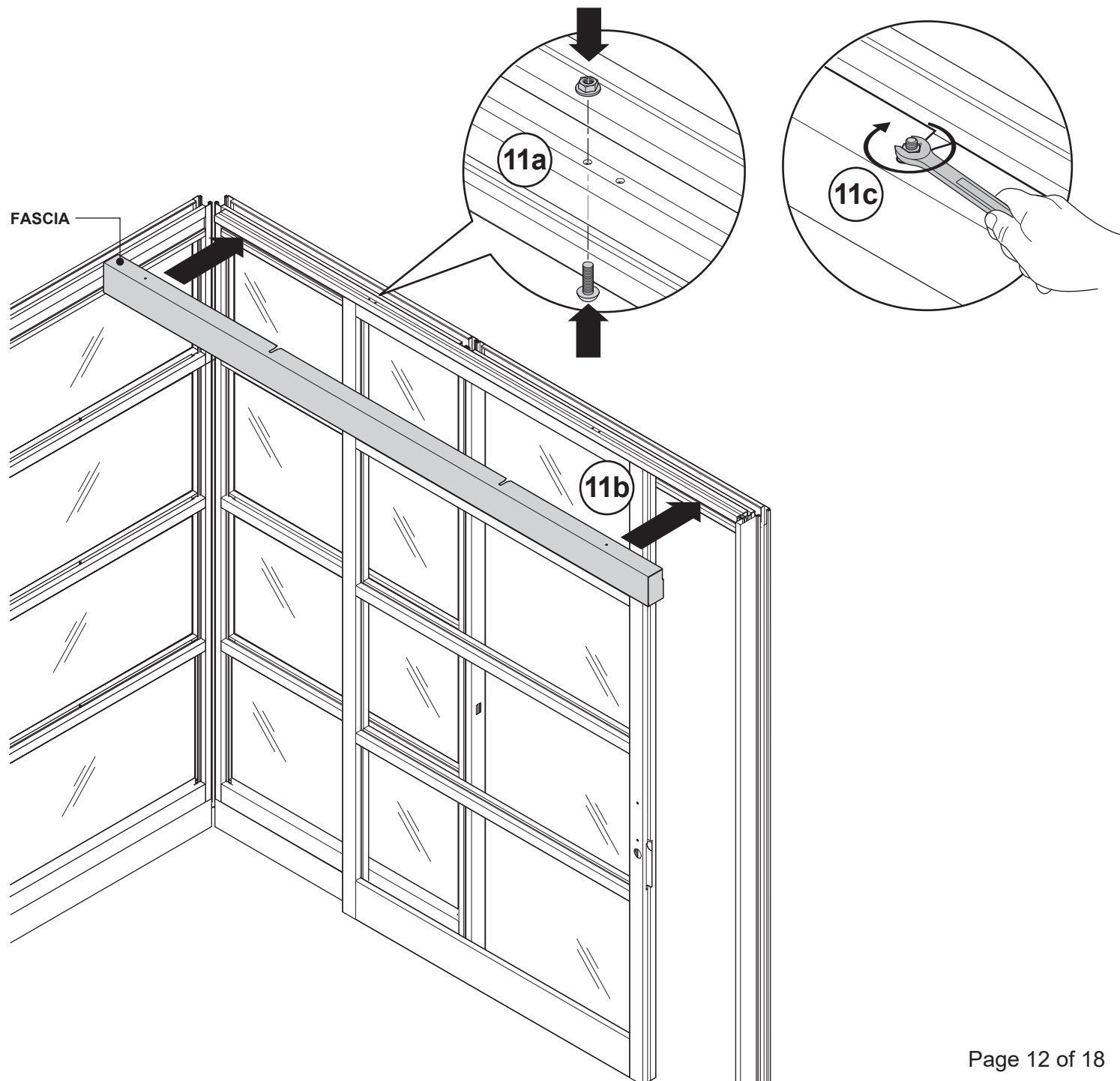

**12.** Install collar, lock washer and screw onto the handle that has threads inside the tubes as shown (12a). Place the handle with the clearance hole inside the tubes over the screw head and collar (12b). Install the set screw on the upper and lower portion of the handle using Loctite 425 (12c).

**NOTE:** Make sure the set screws are located on the bottom of the handle, so they are not visible to the user.

Insert the lock body into the sliding door frame and start screws to hold lock loosely. Install key and thumb cylinder. Lock cylinders in place with set screws then tighten lock body screws check lock, key and thumb and adjust after complete. Place the trim around lock bodies (12d).

When the door is oriented to the outside of the office, it may be necessary to change the rotation of the thumbturn to clear the door jamb. When oriented to the inside, no change in orientation is required.

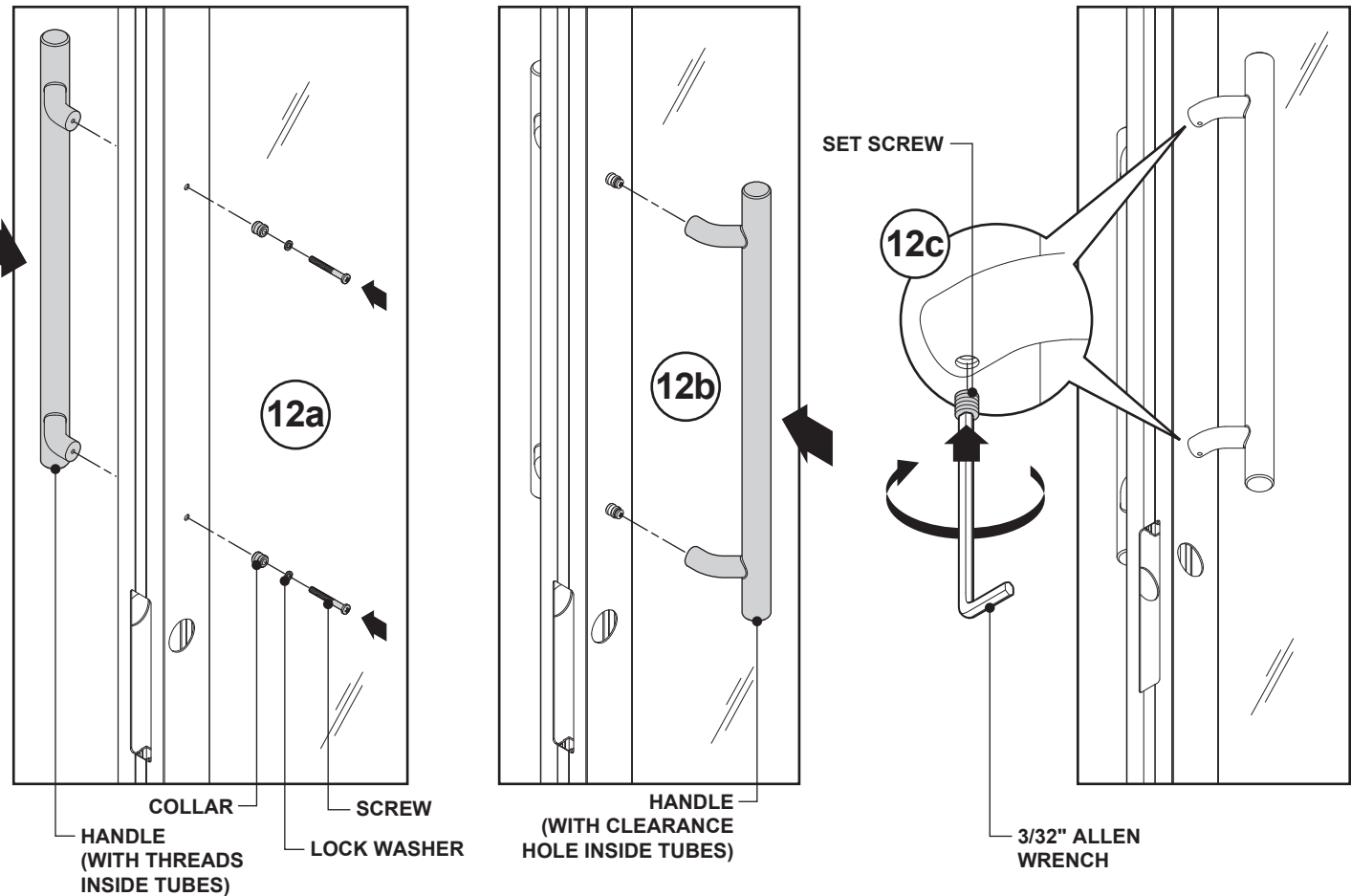

## FOR FIELD INSTALLED HANDLE OPTION

Locate handle mounting holes in this zone.

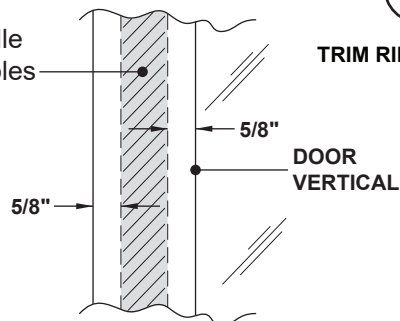

## For units manufactured after September 2021:

Lock Thumb Turn is in LH position by default

To adjust to RH ORIENTATION:

- Remove 2 screws holding actuator tab
- Rotate tab 180°
- Reinstall screws

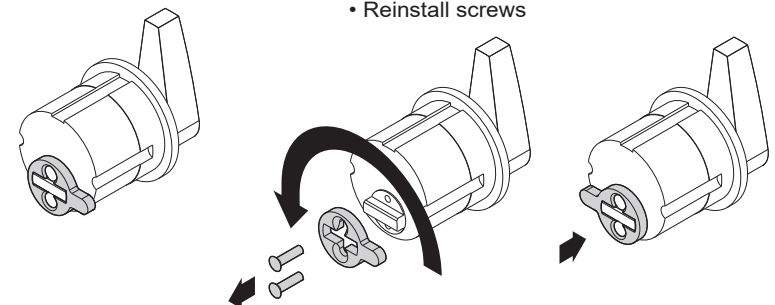

**13.** Mount the single strike slider plinth trim with a #8-18 x 1/2" undercut flat head tap screw as shown, making sure the base trim mounts with clean lines.

**14.** Mount the single strike slider plinth trim and the slider strike plinth trim with two (2) #8-18 x 1/2" undercut flat head tap screw as shown, making sure all the trims mount with clean lines.

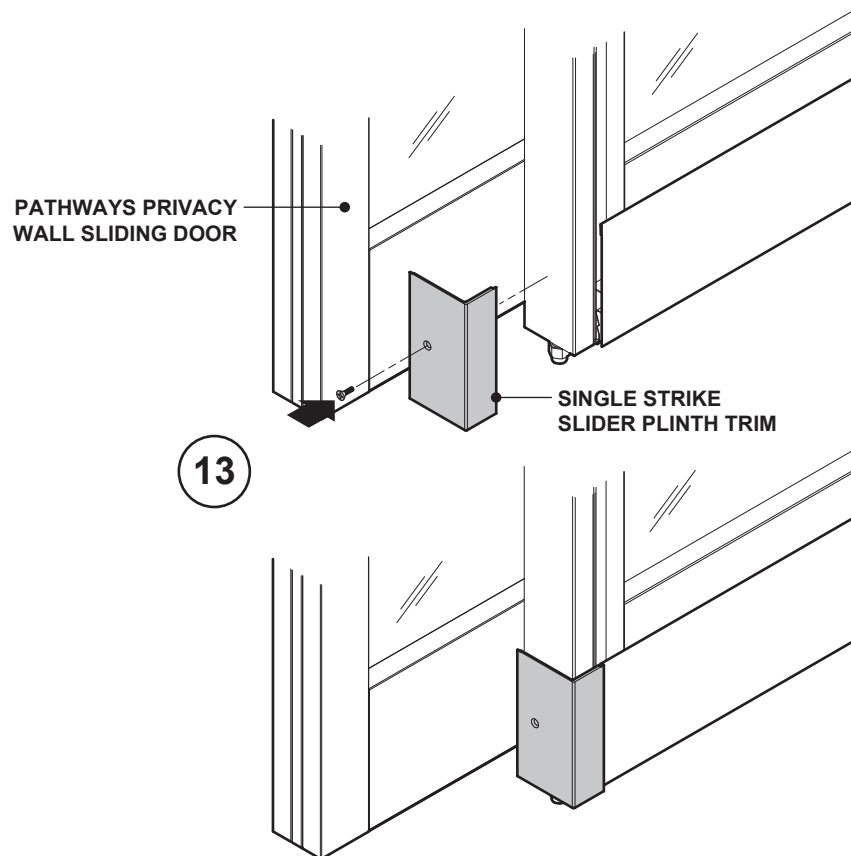

**NOTE:** This view is shown turned 90 degrees for clarity.

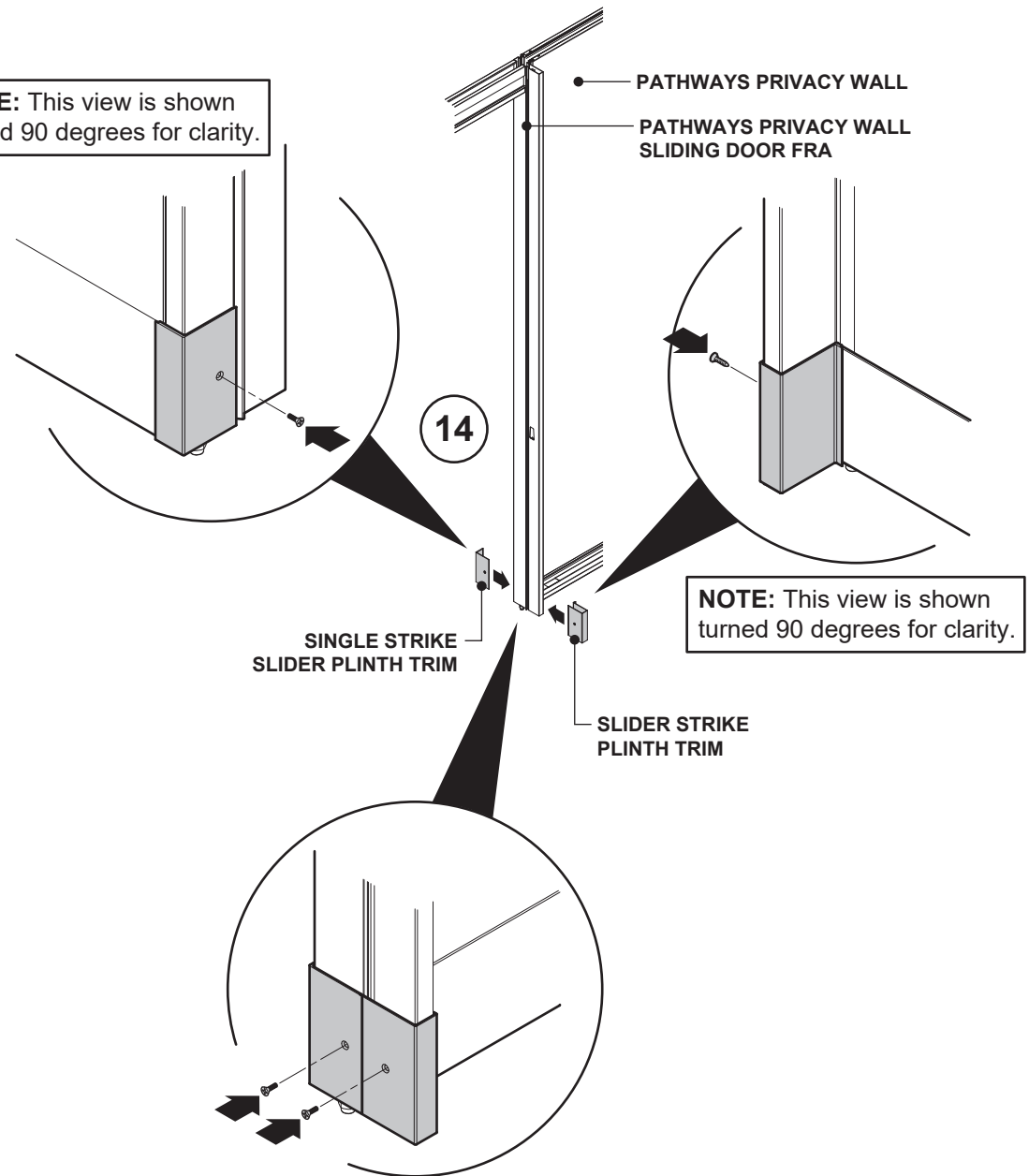

**15.** Use an awl and scribe down inside the step of the plinth trim (15a & 15c) and then take a pair of pliers and snap the thin metal step off the trim (15b & 15d).

**16.** Mount the two (2) single strike slider plinth trims with two (2) #8-18 x 1/2" undercut flat head tap screws as shown.

**17.** Mount the two (2) slider strike plinth trims with two (2) #8-18 x 1/2" undercut flat head tap screws as shown.

**NOTE:** This view is shown turned 90 degrees for clarity.

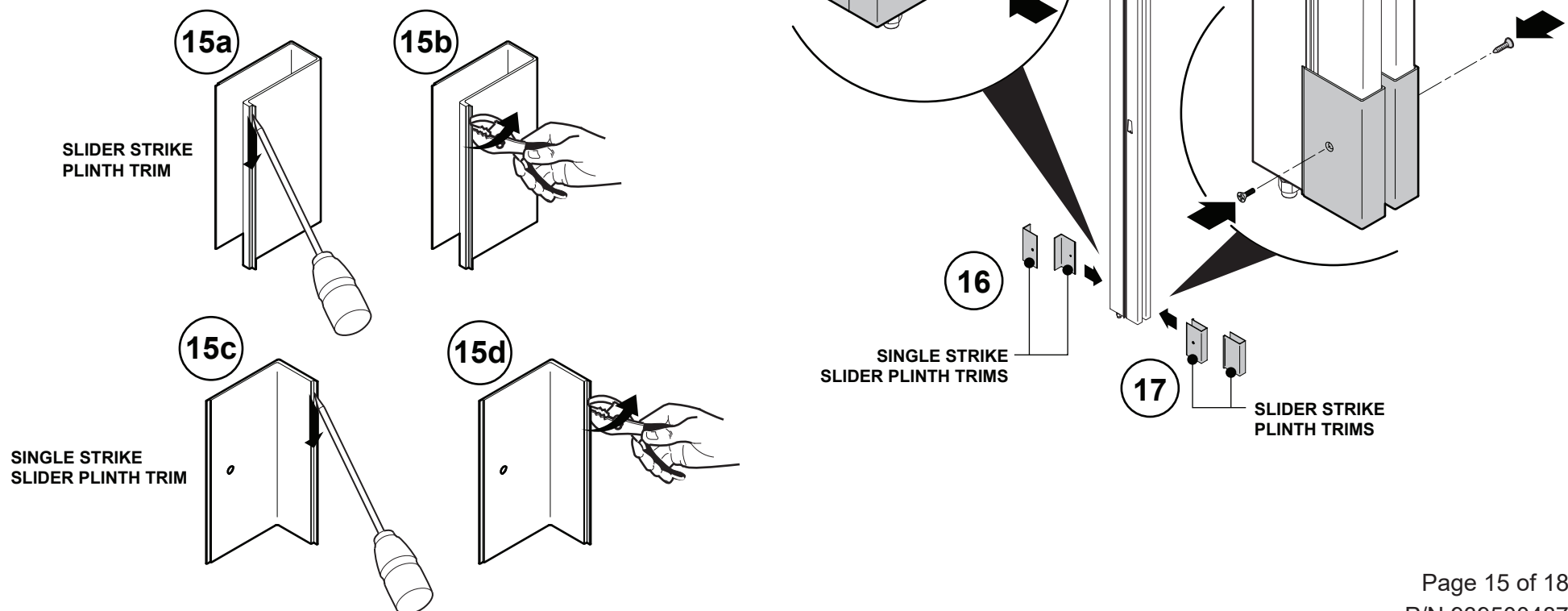



## Optional Back-to-Back Cover (Inline Application)

1. Use an awl and scribe down inside the step of the single strike slider plinth trim (15c on previous page) and then take a pair of pliers and snap the thin metal step off the trim (15d on previous page). Two (2) single slider plinth trims are required for this installation.
2. Slide the double strike sliding door plinth trim over the back-to-back pathways privacy wall sliding door frames and secure with two (2) #8-18 x 1/2" undercut flat head tap screws (2a). Slide the back-to-back slider cover over the frames and on top of the plinth trim and snap into position (2b).
3. Install the two (2) single strike slider plinth trims with #8-18 x 1/2" undercut flat head tap screws as shown.

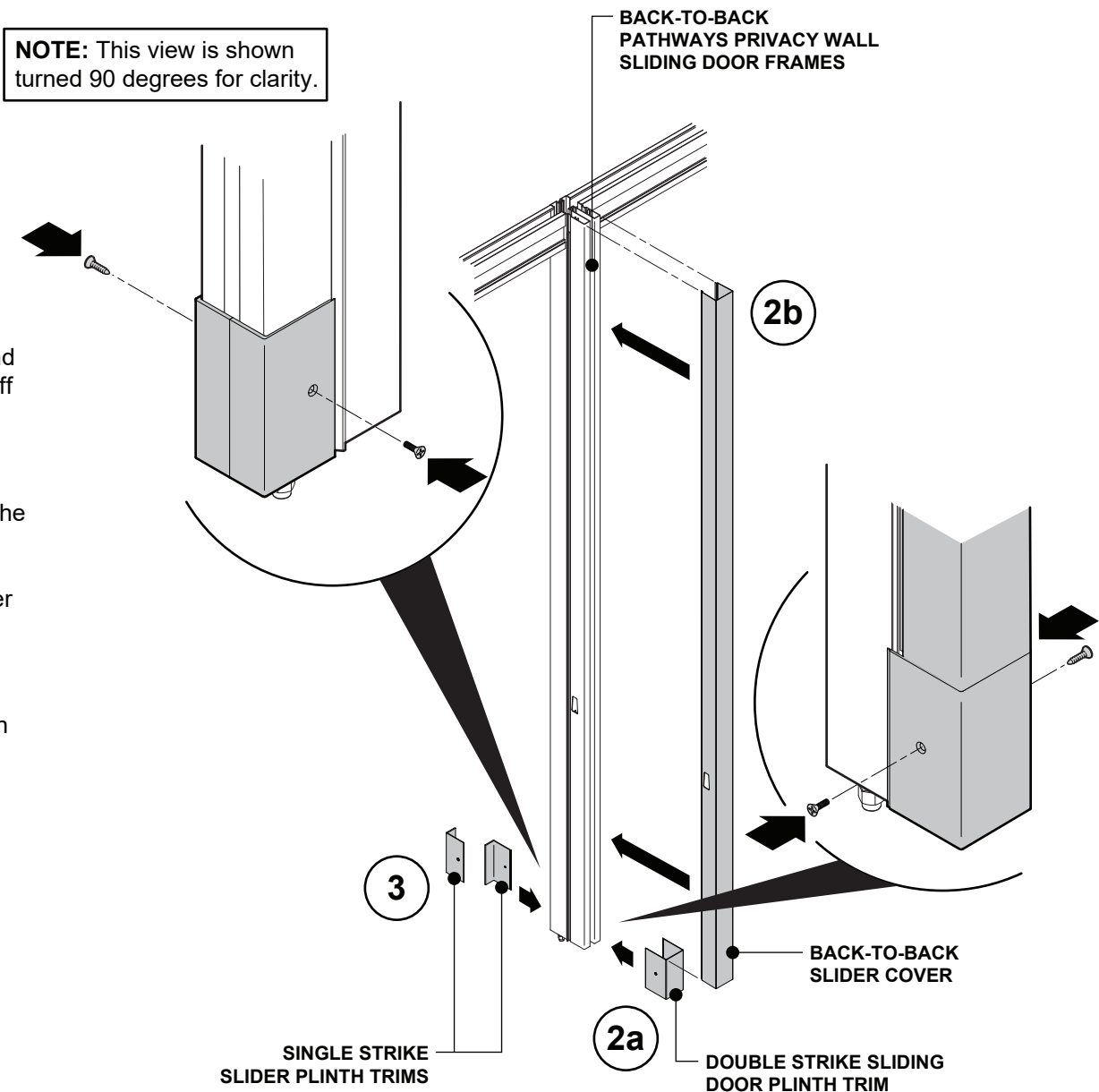

 = Inline Feature Strip

 = Half Feature Strip

## Optional Connection Conditions

**NOTE:** All other connection conditions are the same as standard panel mounting connection conditions.

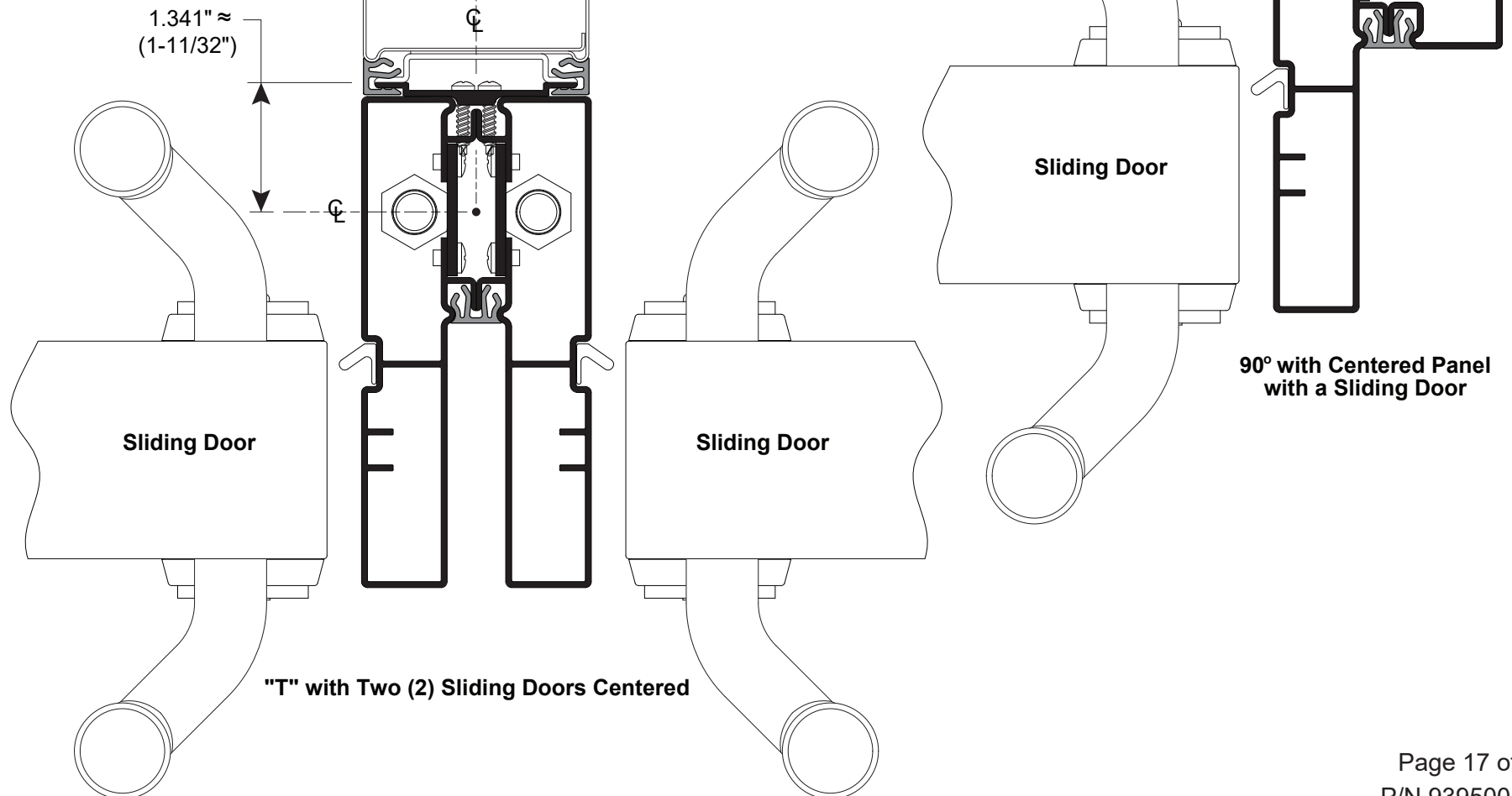

## Optional Plinth and Base Trim Connection Conditions

**NOTE:** All other plinth and base trim connection conditions are the same as standard panel mounting plinth and base trim connection conditions.

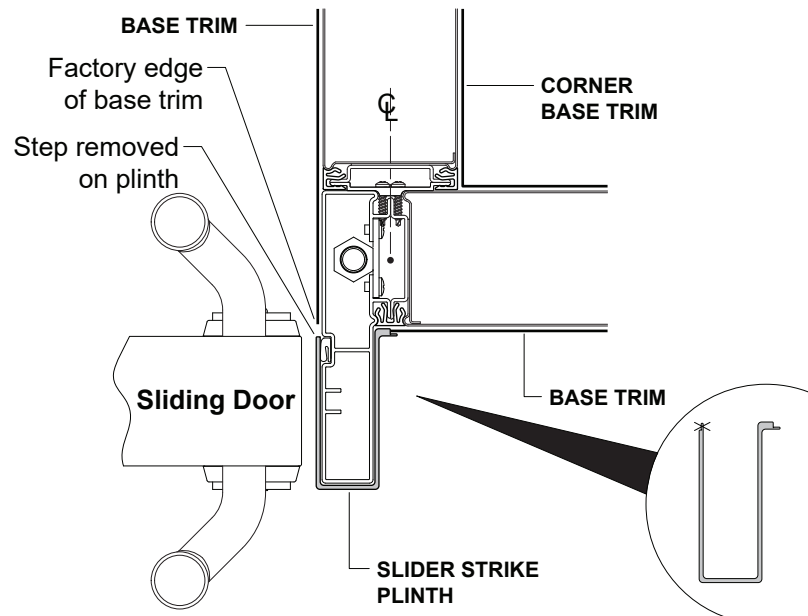

**"T" with a Sliding Door Centered**

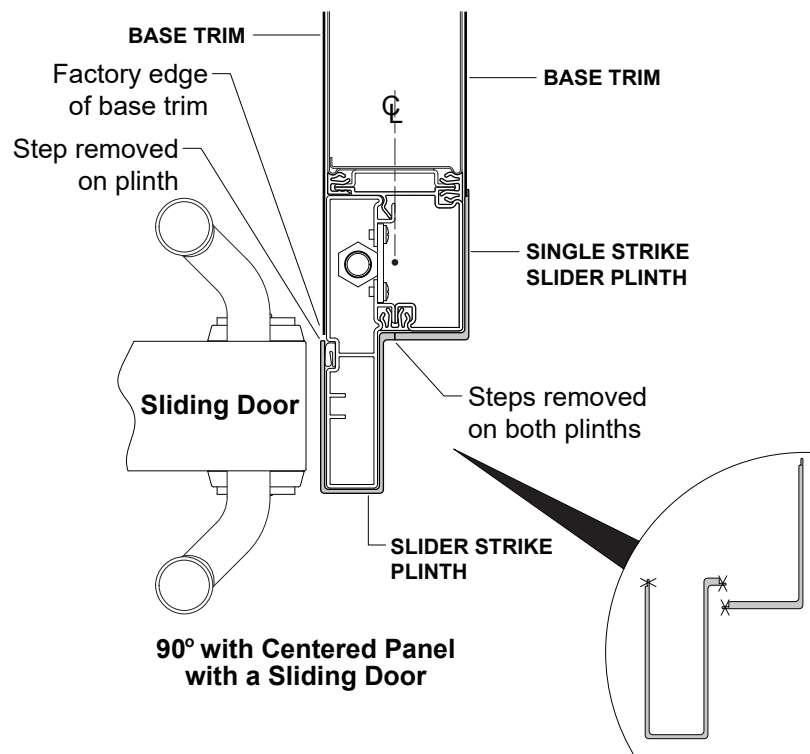

**90° with Centered Panel with a Sliding Door**

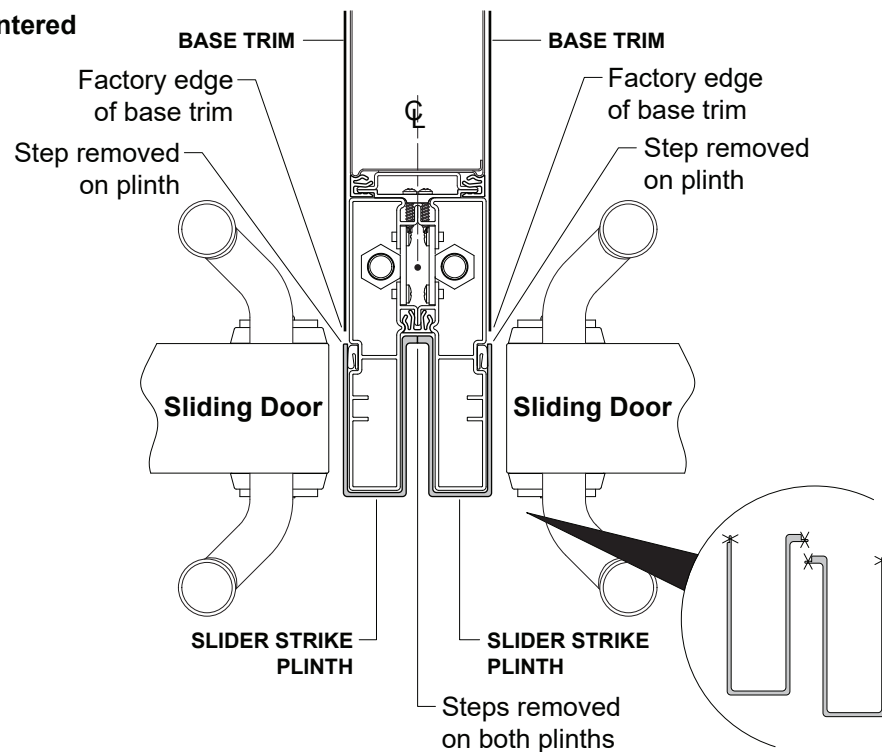

**"T" with Two (2) Sliding Doors Centered**