

### Non-Seismic Applications\*

\* The building's Engineer of Record must be consulted to determine if there are any seismic requirements.

#### CAUTION



**CRUSH HAZARD!**  
FAILURE TO PROPERLY  
SECURE PRIVACY WALL TO  
THE BUILDING COULD RESULT  
IN PERSONAL INJURY.

Read the entire Assembly Directions before beginning installation.

Building construction varies greatly. The Building's Engineer of Record is responsible for the design of building floors, ceilings and walls which Privacy Wall attaches to and must verify the adequacy of the mounting solutions, even if provided by Steelcase.

The building owner or designated agent is responsible for verifying that the installation is in compliance with all local codes and regulations.

#### ETCHED GLASS STYLES:

- Satin
- Mist

#### PATTERN GLASS STYLES:

- Waterfall
- Bamboo
- Harp
- Mirage

#### NOTES:

For etched/pattern glass orientation please refer to the installation drawings. Unless noted otherwise, use the default.

#### DEFAULT GLASS ORIENTATION:

##### ETCHED GLASS:

Rough side to go on the **inside** of the office space.

##### PATTERN GLASS:

Rough side to go on the **outside** of the office space.

All joints between the glass must be sealed with a silicone sealant or VHB glazing tape to be code compliant.

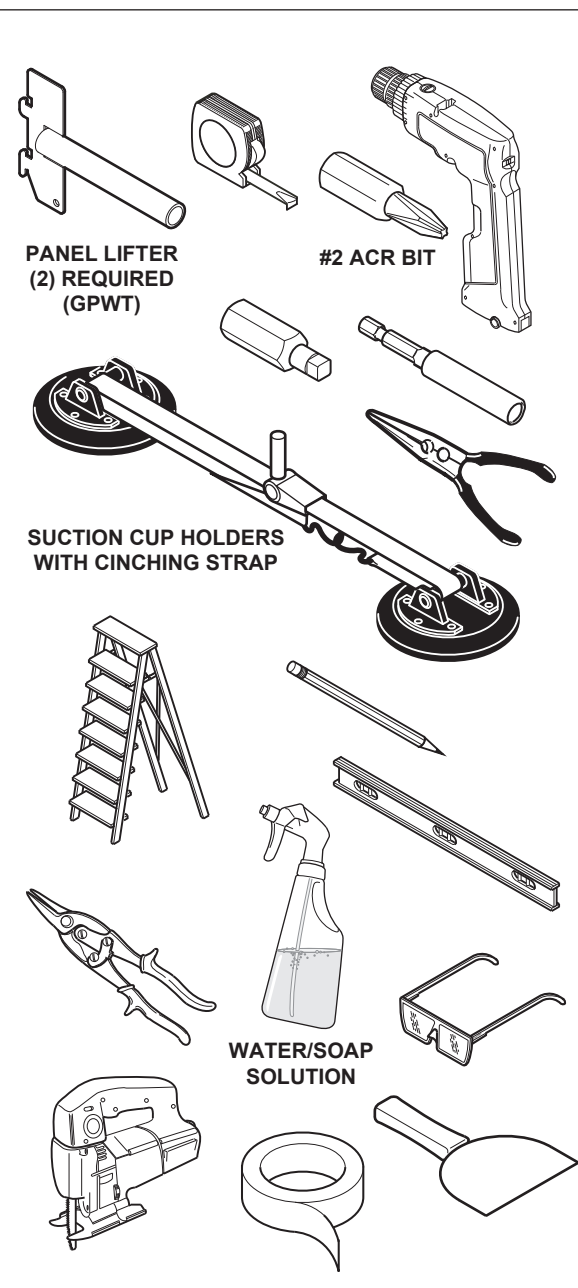

888.STEELCASE (888.783.3522)

www.steelcase.com

© 2025 Steelcase Inc.

Grand Rapids, MI 49501 U.S.A.

## ⚠ WARNING ⚠ ADVERTENCIA ⚠ AVERTISSEMENT

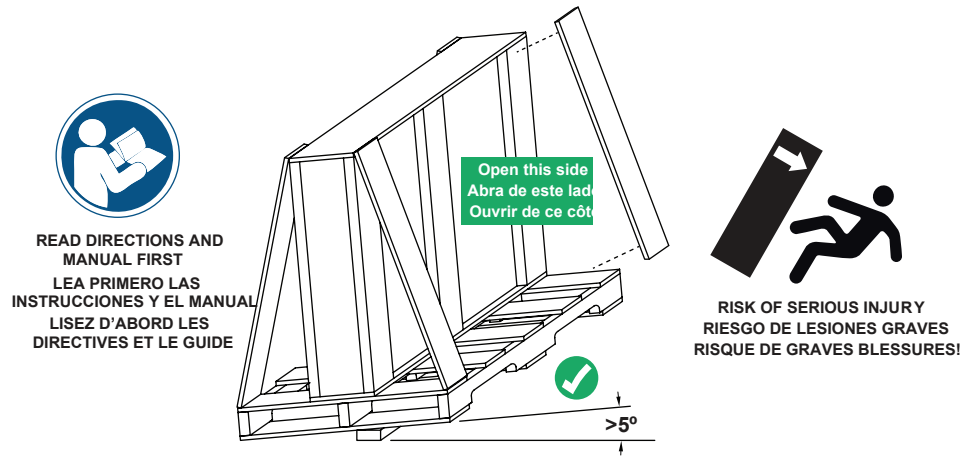

## Safety Instructions Instrucciones de Seguridad Consignes de Sécurité



- Before opening, ensure crate is stable and tilted at least 5 degrees to prevent glass from falling out.
  - To open, cut any bands first and pry off boards on front of crate.
  - Before removing glass, check crate and remove protruding nails or screws that could scratch glass.
  - Wear appropriate personal protective equipment (safety glasses, gloves, safety shoes and skin protection).
  - Tempered Glass is very heavy and can shatter while handling. Use two or more people to handle glass.
  - Handle carefully. A scratched surface, damaged surface, or edge impact can cause the glass to shatter suddenly into sharp pieces.
- 
- Antes de abrir, asegúrese de que la caja esté estable e inclinada al menos por 5 grados para evitar que el vidrio se salga de la caja.
  - Para abrir, corte primero las bandas de embalaje y luego separe las tablas del frente de la caja.
  - Antes de retirar el vidrio, chequee la caja y quite los clavos o tornillos salientes que puedan rayar el vidrio.
  - Use el equipo apropiado de protección personal (gafas de seguridad, guantes, zapatos de seguridad y protección para la piel).
  - El vidrio templado es muy pesado y se puede romper durante su manipulación. Use dos o más personas para manipular el vidrio.
  - Manéjelo con cuidado. Una superficie rayada o dañada, o el impacto sobre el borde pueden causar que el vidrio se rompa de repente en trozos afilados.
- 
- Avant d'ouvrir, assurez-vous que la caisse à claire-voie est stable et inclinée d'au moins 5 degrés pour éviter que la vitre bascule hors de la caisse.
  - Pour ouvrir, coupez d'abord les bandes d'emballage, puis écarter les bords sur le devant de la caisse.
  - Avant de retirer la vitre, vérifiez la caisse et enlevez les clous ou les vis qui pourraient dépasser et qui pourraient égratigner la vitre.
  - Portez de l'équipement de protection individuelle approprié (lunettes de sécurité, gants, chaussures de sécurité et vêtements de protection).
  - Le verre trempé est très lourd et peut se briser en éclats lorsqu'on le manipule. Au moins deux personnes sont nécessaires pour manipuler la vitre.
  - Manipulez avec soin. Une surface égratignée ou endommagée ou encore un choc sur le rebord peut faire en sorte que le verre se brise soudainement en éclats tranchants.

Components Options vary per Frame Type and Base Height

TOP HORIZONTAL OR FULL HEIGHT SLIDER HEADER

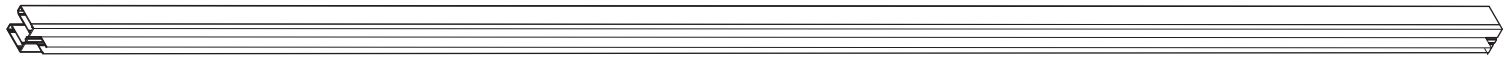

TRANSOM HORIZONTAL OR TRANSOM HEIGHT SLIDER HEADER



HORIZONTAL BOTTOM CAP (SHIPS ATTACHED TO BOTTOM ASSEMBLY) 5" BASE ONLY



HORIZONTAL BOTTOM ASSEMBLY 5" BASE OR 2.5" BASE

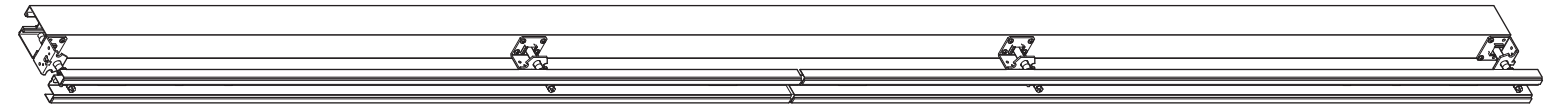

VERTICAL CHANNELS WITH GLAZING AND STIFFENERS



TALL GLAZING STRIP



SHORT GLAZING STRIP



POST EXTENSION  
MOUNTING ASSEMBLY

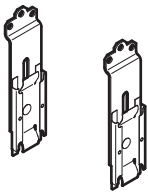

POST  
EXTENSION



CEILING TRACK  
RETENTION  
CHANNEL  
(QTY. VARIES)

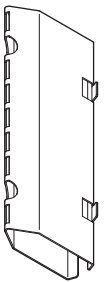

**1.** Install post extension mounting assembly into the vertical channel (1a). Secure thru vertical channel and into the top horizontal using three (3) #10-16 x 1-1/2" pan head screws.

**2.** Attach transom horizontal to the vertical channel using two (2) #10-16 x 1" pan head screws.

**NOTE:** For full height glass panel, skip step 2.

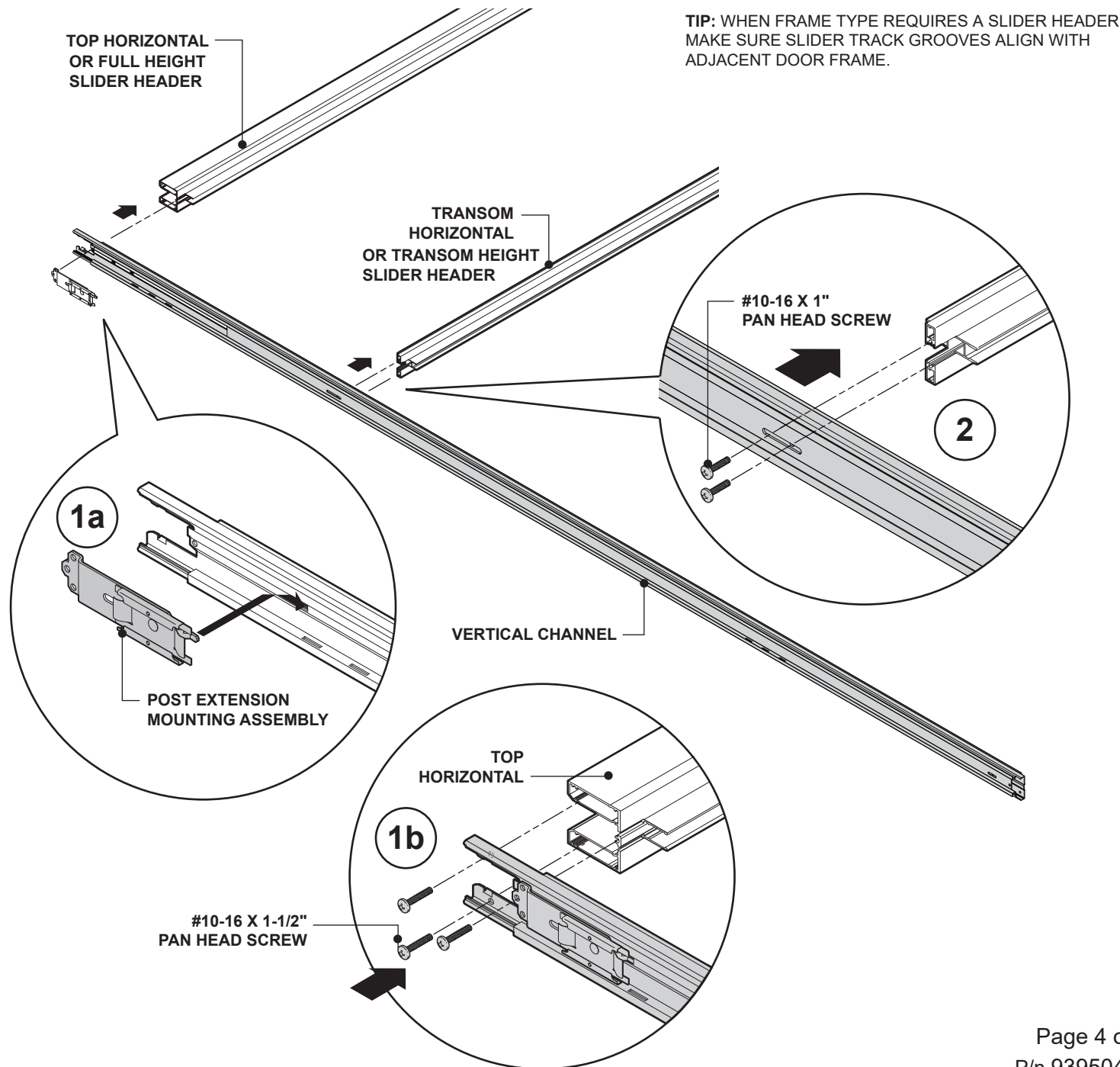

**IMPORTANT!!!**  
GLAZING STRIP MUST BE  
COMPLETELY SEATED  
AS SHOWN

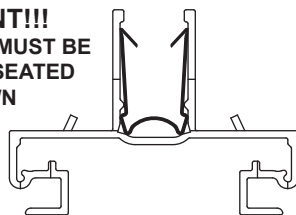

GLAZING STRIP  
3/4"  
approx.

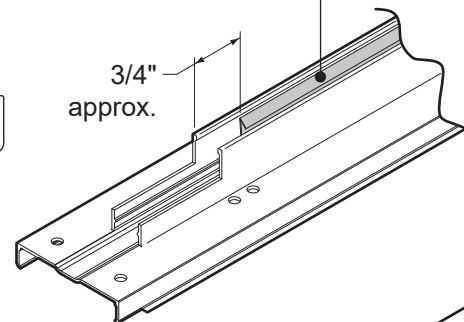

BOTTOM OF VERTICAL  
CHANNEL ASSEMBLY

**NOTE:** Check glazing strip location within the vertical channel assembly before assembly.

For 5" Base only

**3.** Remove horizontal bottom cap as shown (3a). Align horizontal bottom assembly to vertical channel assembly and mount using two (2) #10-16 x 1" pan head screws on both sides and two (2) #10-16 x 1/2" pan head screws on both sides (3b).

**NOTE:** For 2.5" Base, the bottom horizontal is a single piece and has no cap.

For 5" Base only  
HORIZONTAL  
BOTTOM CAP

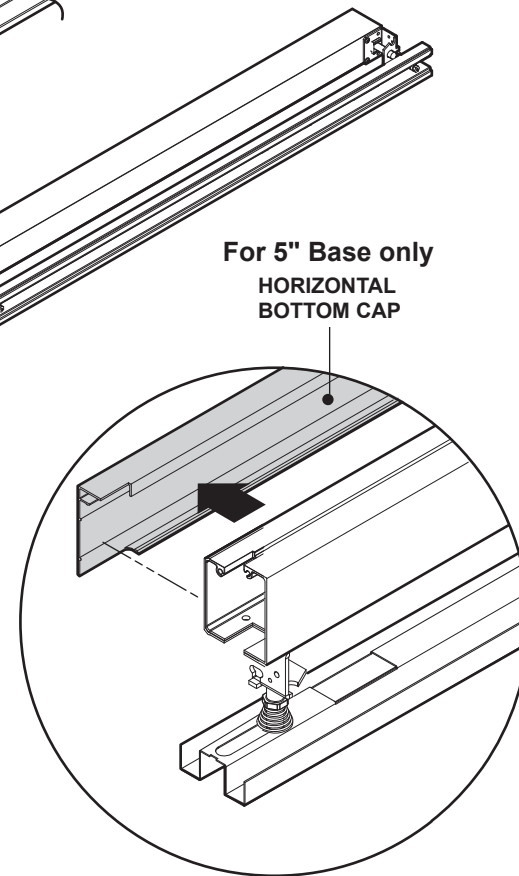

3a

HORIZONTAL  
BOTTOM ASSEMBLY

VERTICAL  
CHANNEL ASSEMBLY

#10-16 x 1"  
PAN HEAD SCREW

#10-16 x 1/2"  
PAN HEAD SCREW

3b

**4.** One (1) or two (2) ceiling retention brackets are to be placed at glass seams. Bend bracket so each leg is parallel and install into top horizontal. Place flat-bladed screwdriver through the clearance holes and twist to secure into top horizontal.

**NOTE:** NOT REQUIRED WITH OVERLAPPING CEILING TRACK.

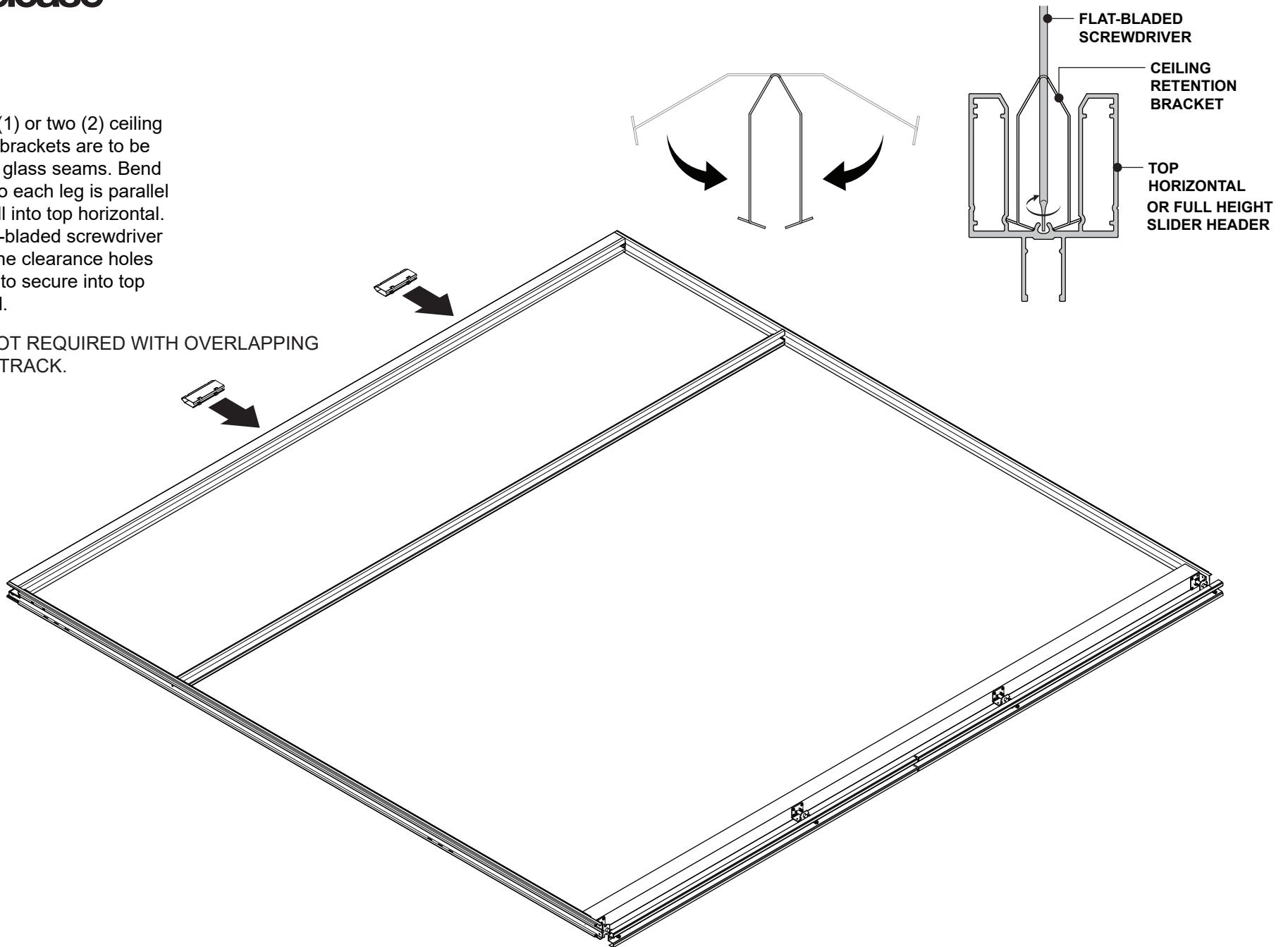



**5.** Using two installers, stand frame upright using the frame installation tool (not supplied) (5a). Carefully guide the frame under the recessed or overlapping channel (5b). Lift and set into place (5c). Level frame at this time.

**6.** When installing transom only, glazing strip must be cut into sections to accommodate leveler screws. Measure location of leveler screws on horizontal transom (6a) and transfer them to the tall top glazing strip (6b). Cut glazing strip into sections accordingly (6c). Position glazing strip sections for installation in next step (6d).

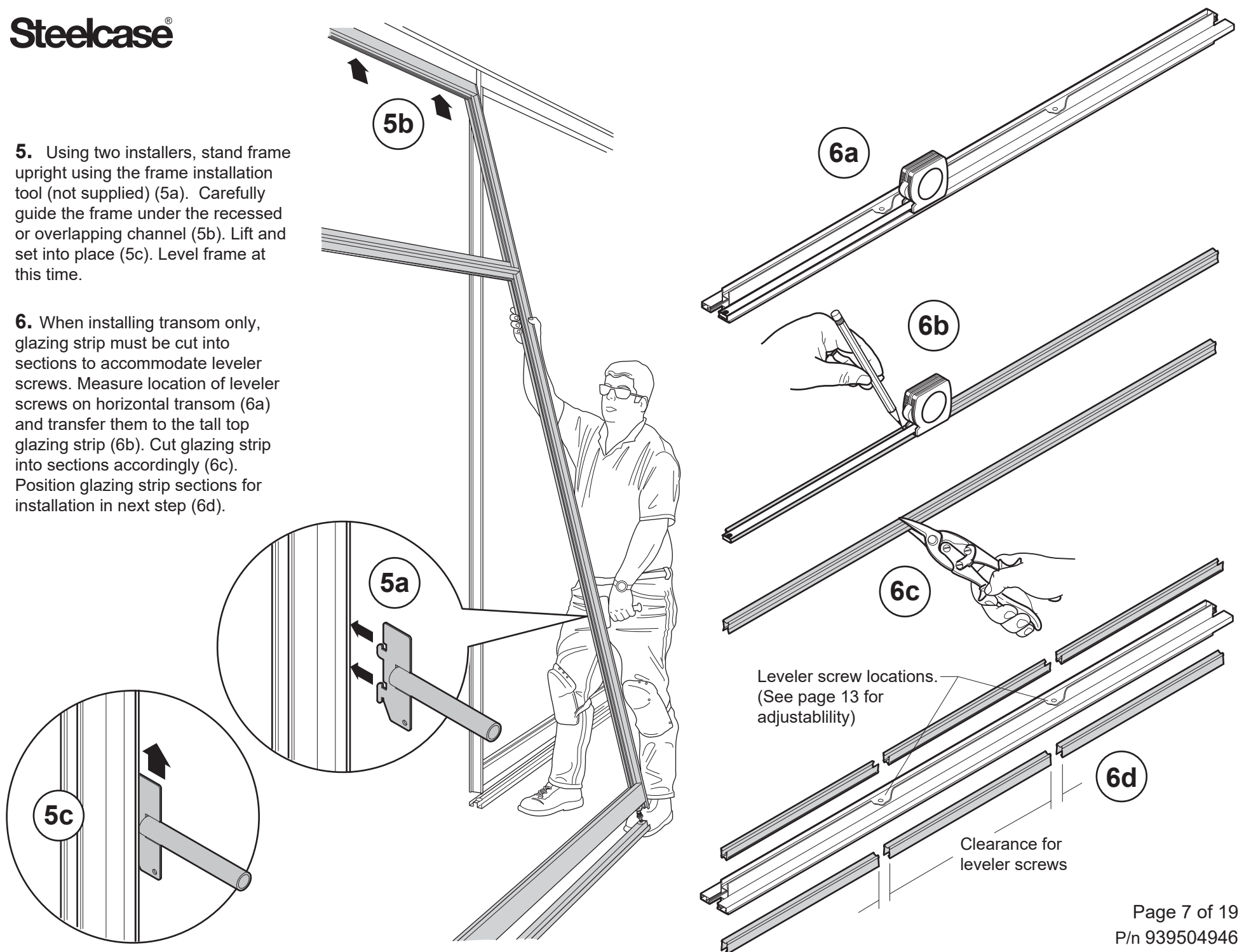

**7.** Install the tall glazing strips into the top of the frame (7a) making sure to push them in all the way (7b). Repeat procedure for the transom. For short glazing strips, mount onto the glass for lower glass panel (7c) and mount into transom horizontal (7d) for transom glass panel.

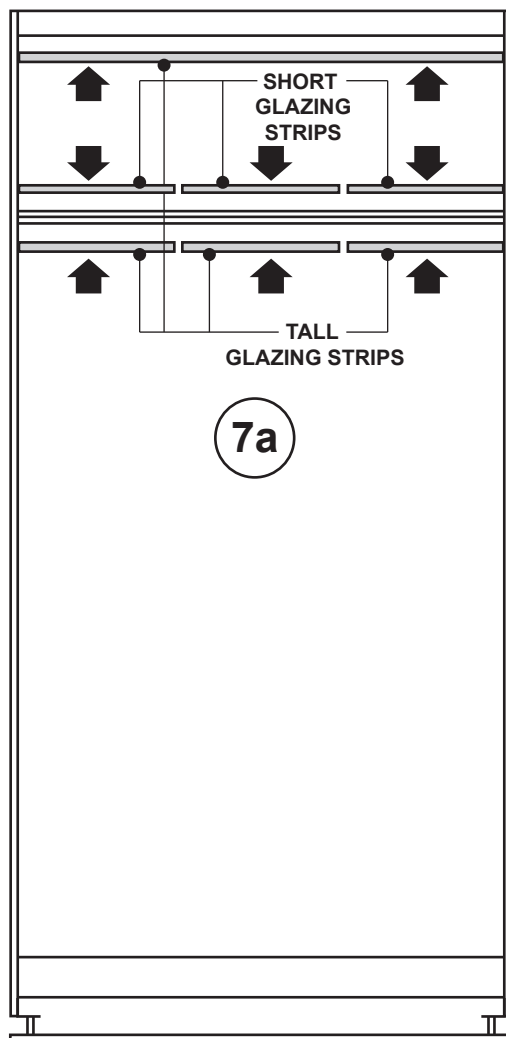

LOWER GLASS PANEL

**NOTE:** For 5" Base Remove glazing strip from horizontal bottom assembly. Cut to length (1" shorter than the width of the glass) and install on bottom of lower glass panel.

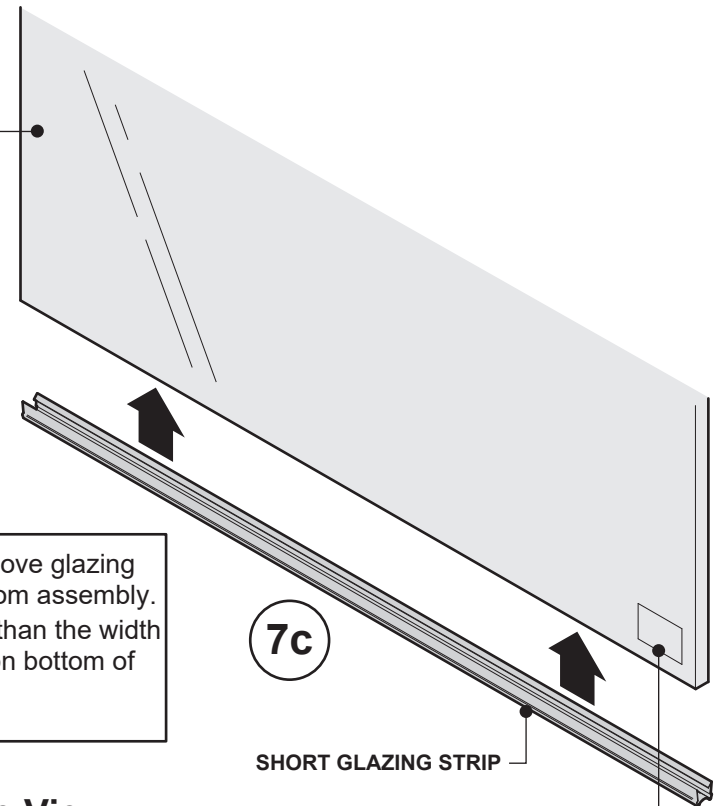

SHORT GLAZING STRIP

GLASS LOGO TO BE VISUAL FROM OUTSIDE

**Side View**

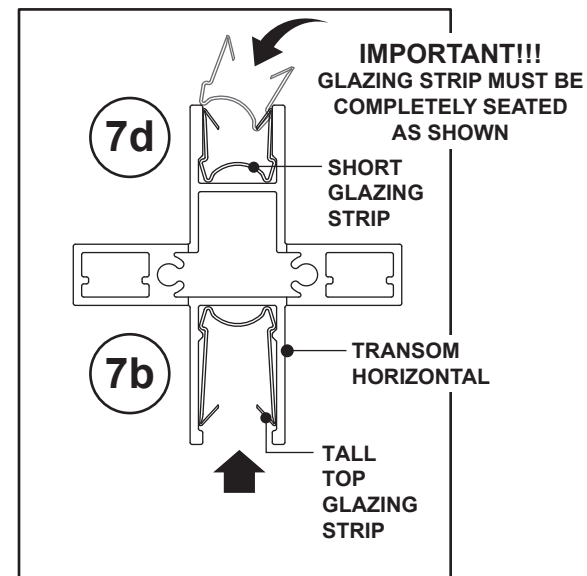



**8.** Spray the top of the glass with a water/soap solution to allow for glass to slide with more ease into glazing strip (8a). Spray the glazing strip as well (8b).

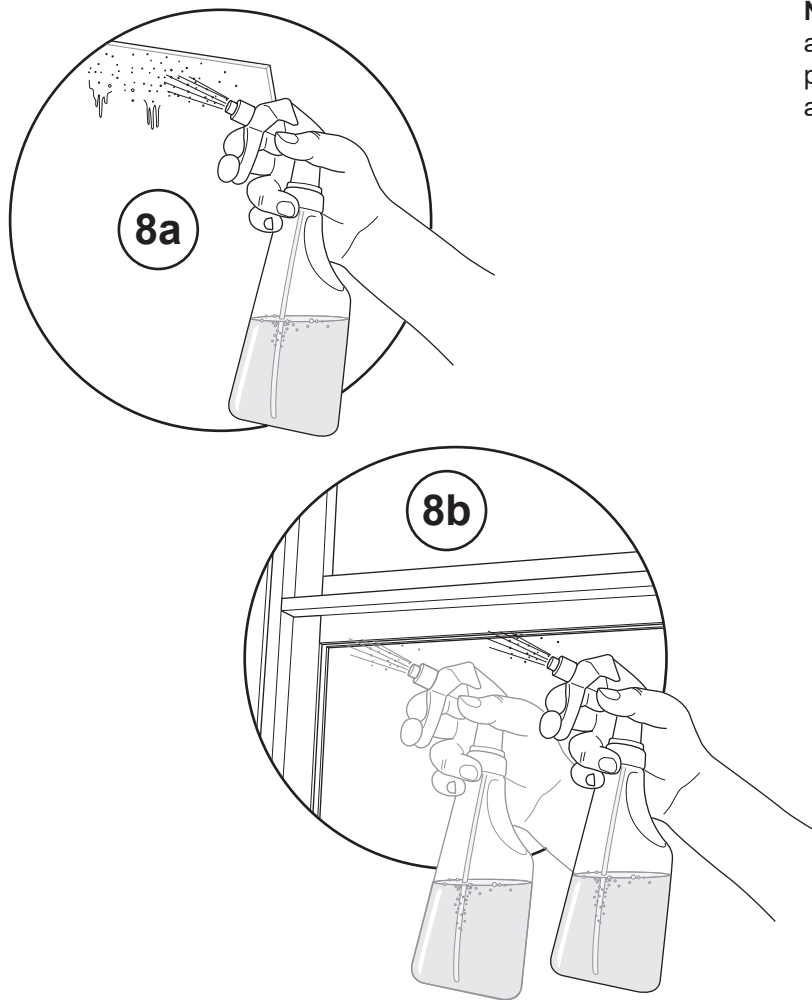

**9.** Carefully slide glass into the glazing strip and swing glass into position on top of horizontal bottom.

**Note:** Installation shown on Step 14c of Page 13.

**Note:** If using tape to seal glass seams, apply tape to edge of seam before placing in frame. Refer to pages 18 and 19.

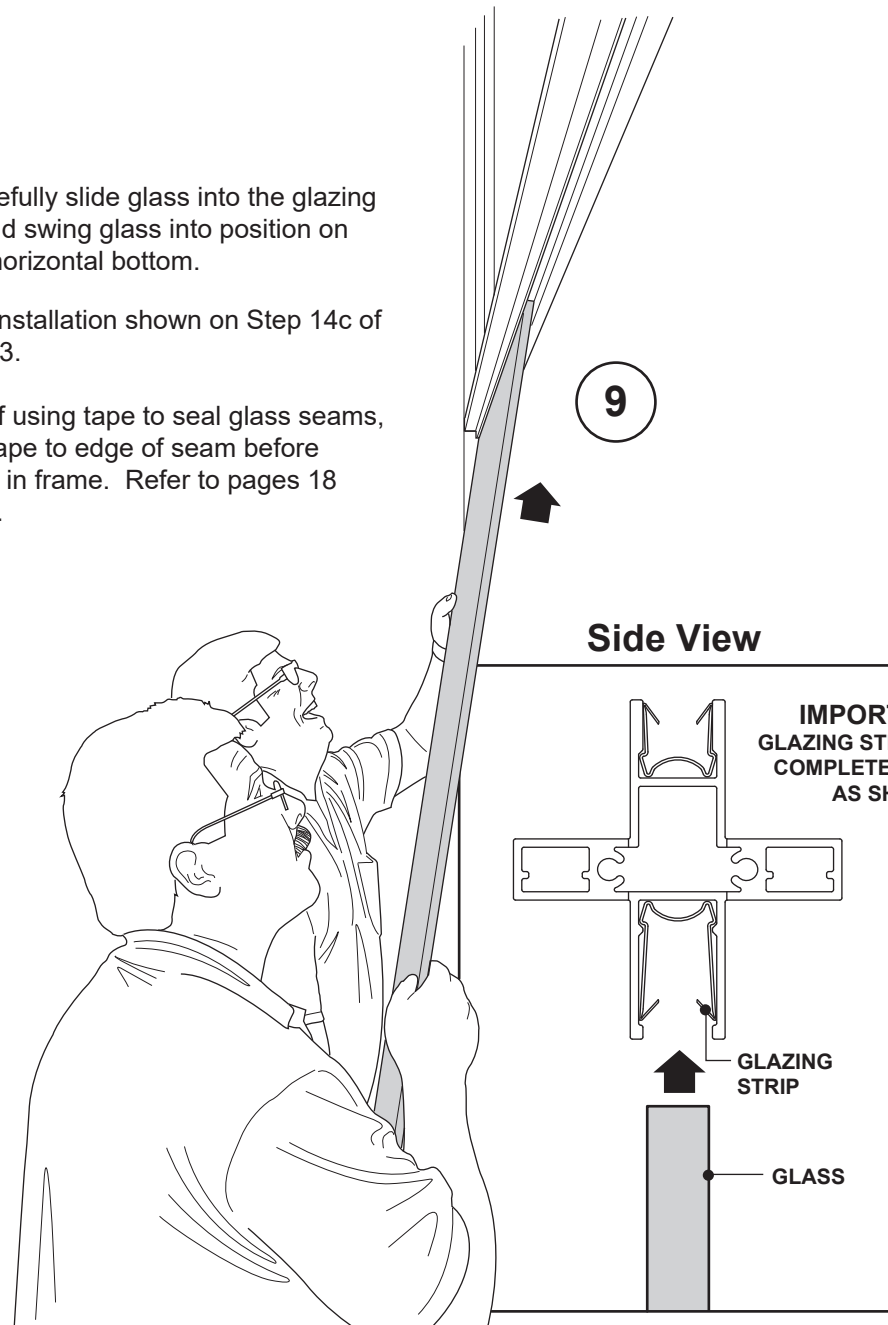

**10.** Slide the glass panel into the side glazing strip while making sure it is snug (10a). Measure to make sure glass is properly placed (10b).

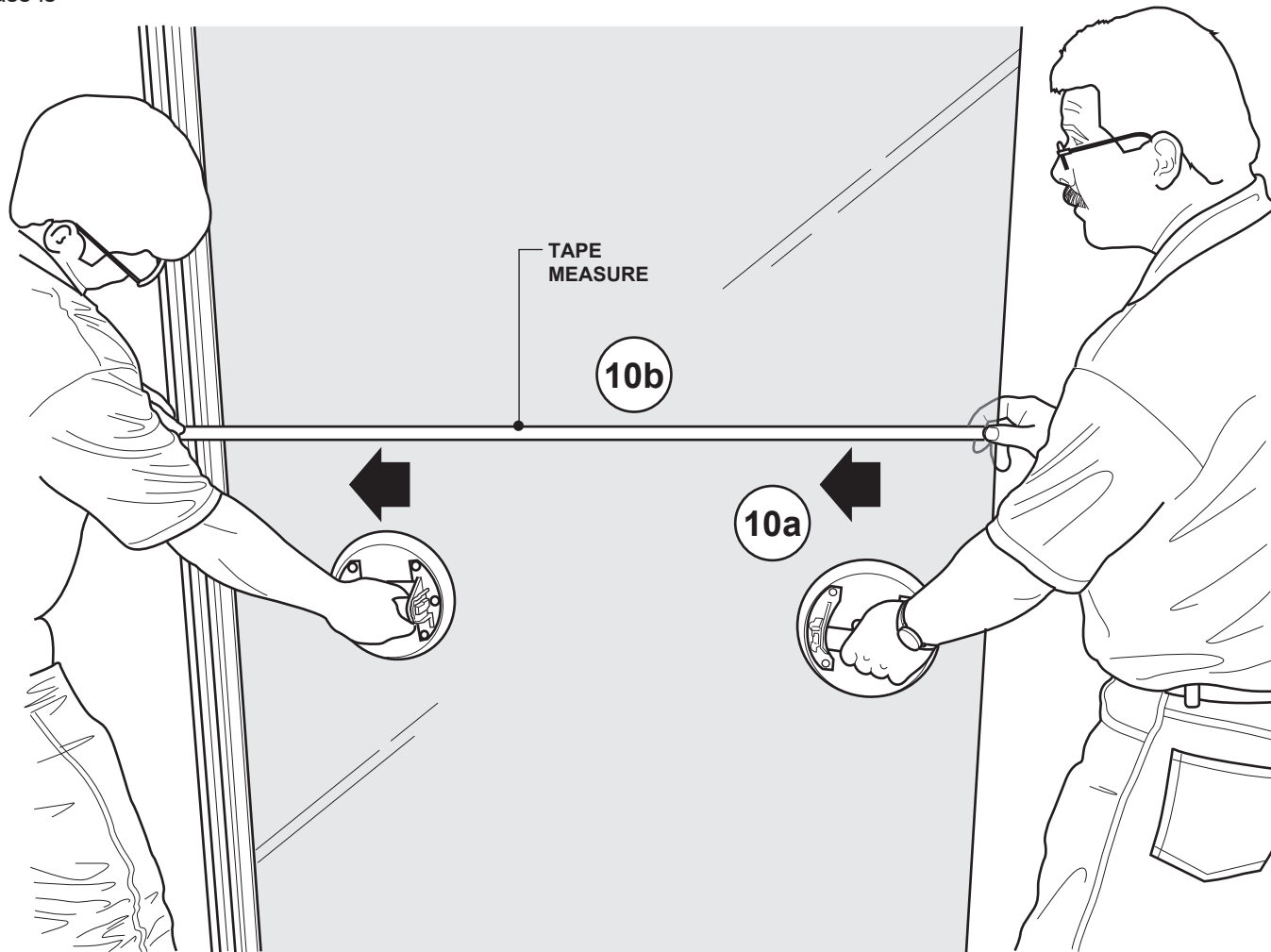

**11.** Create a wood brace (not supplied) to be placed between the top horizontal and the horizontal transom. Length to be determined (Dim 'X'). Measure at both ends of the board (11a) and cut using a saber saw (11b).

**12.** Place the wood brace between the top horizontal glass and the transom glass to prevent bowing. Tape into position.

**NOTE:** When Frame Type Transom Aligned Slider, one end of wood brace will be cut as shown.

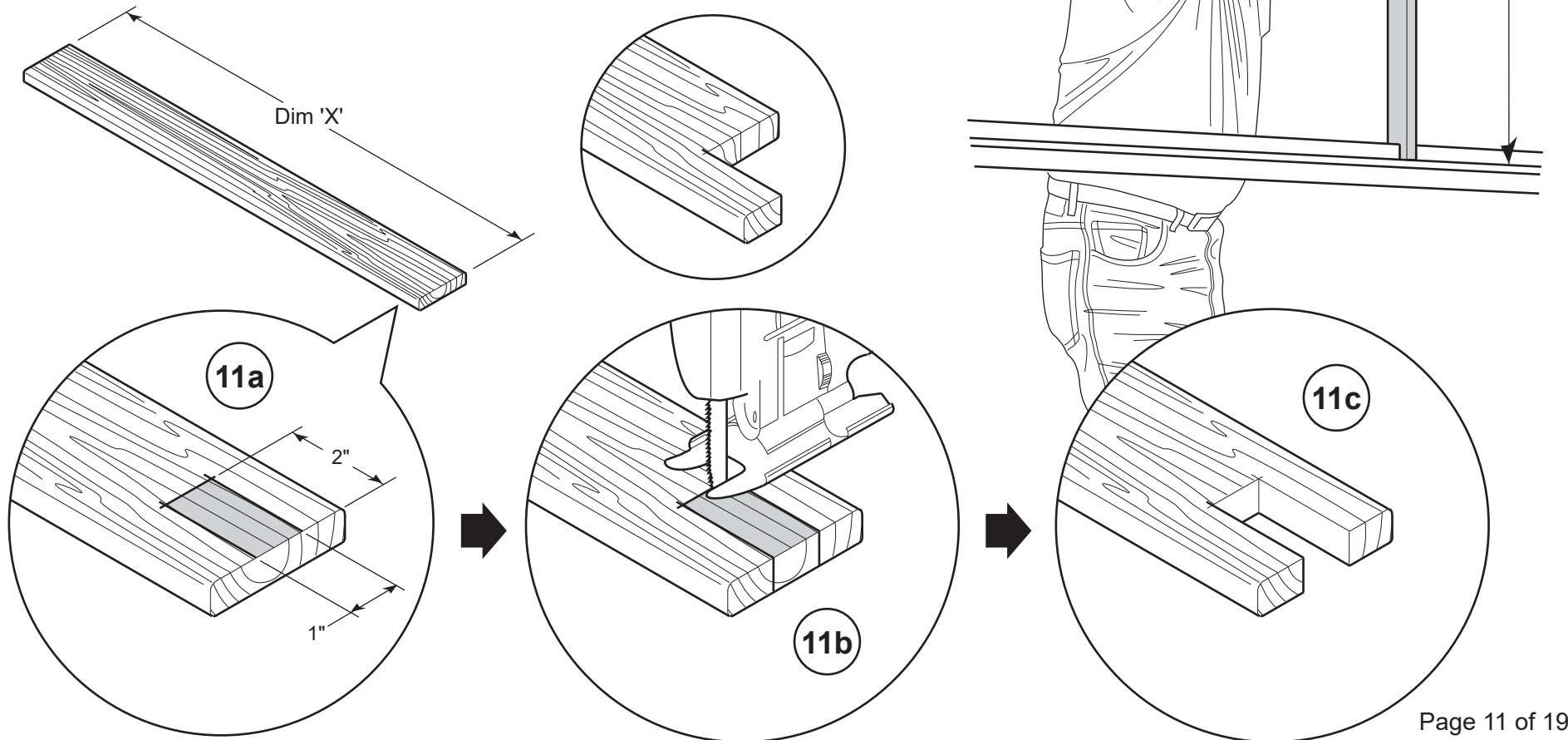

**13.** Measure between the two (2) installed glass panels to make sure there is enough room for the final glass panel.

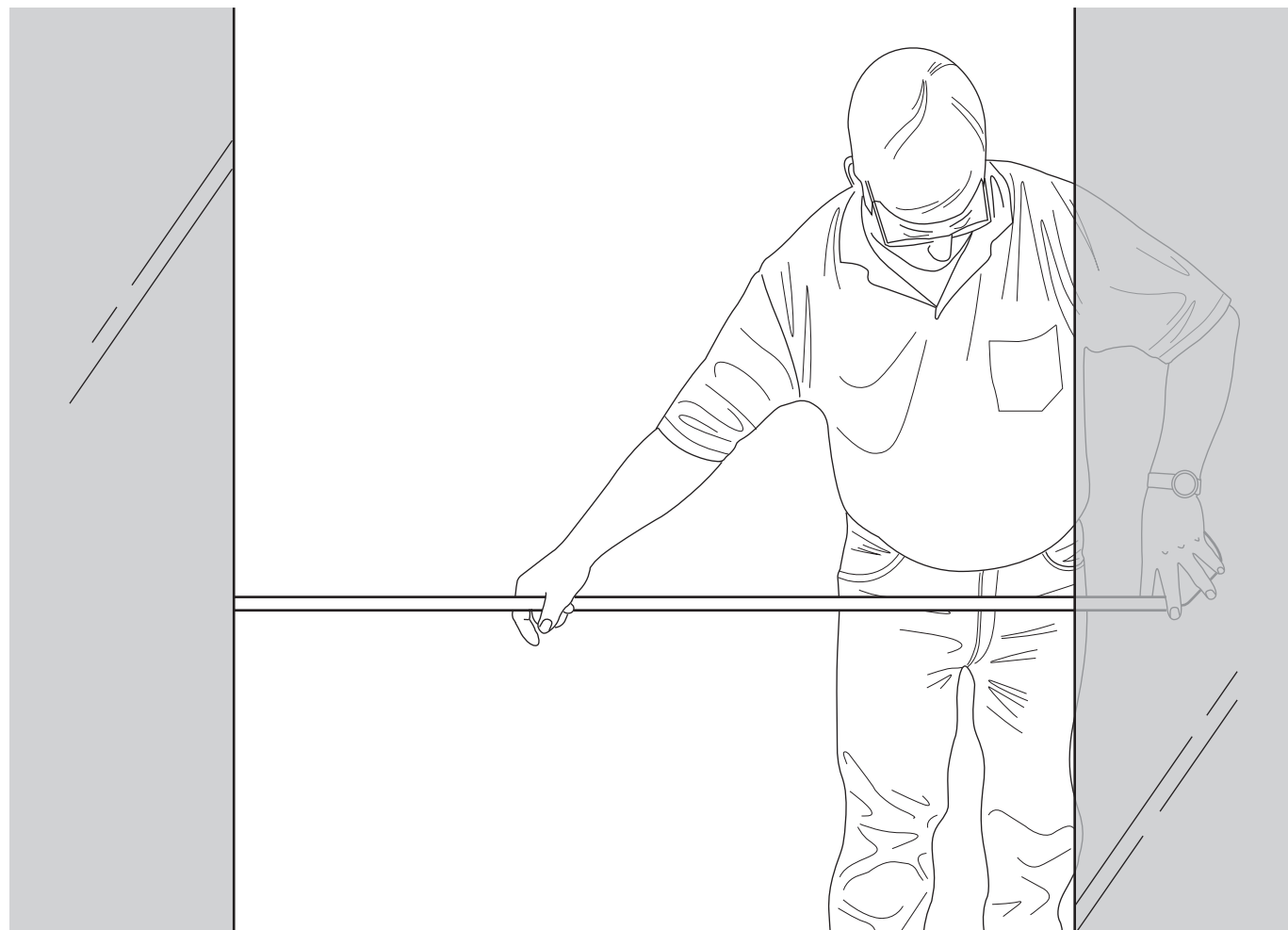

**14.** Spray the top of the remaining glass panel with water/soap solution to allow for glass to slide with more ease into glazing strip (14a). Spray the glazing strip as well (14b). Carefully slide glass into glazing strip (14c). For added support, put a temporary support under bottom horizontal. Make sure there is a 1/8" gap between the glass panels (14d).

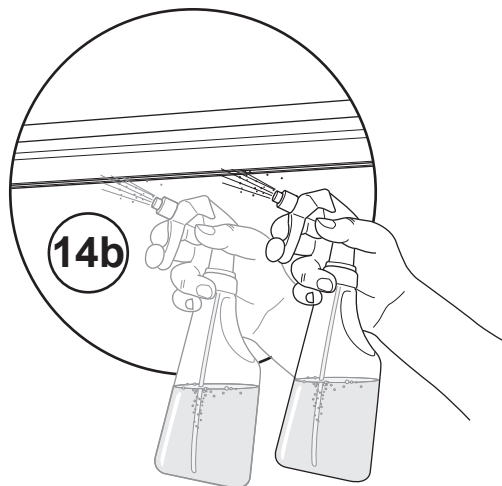

**Top View  
Glass Alignment**

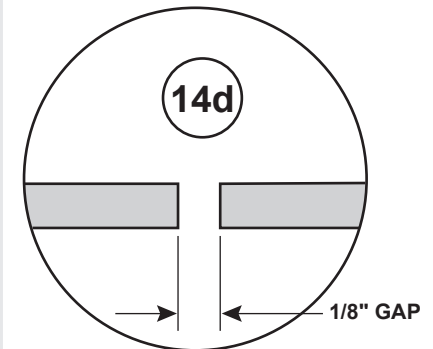

**NOTE:** The bottom glass panels have the glazing strip already installed.

**NOTE:** Horizontal bottom cap must be removed before setting glass  
For 5" Base only

**15.** Level the transom horizontal by adjusting the screws located inside the transom horizontal.

**16.** When installing the transom glass panel, repeat steps 14 and 15.

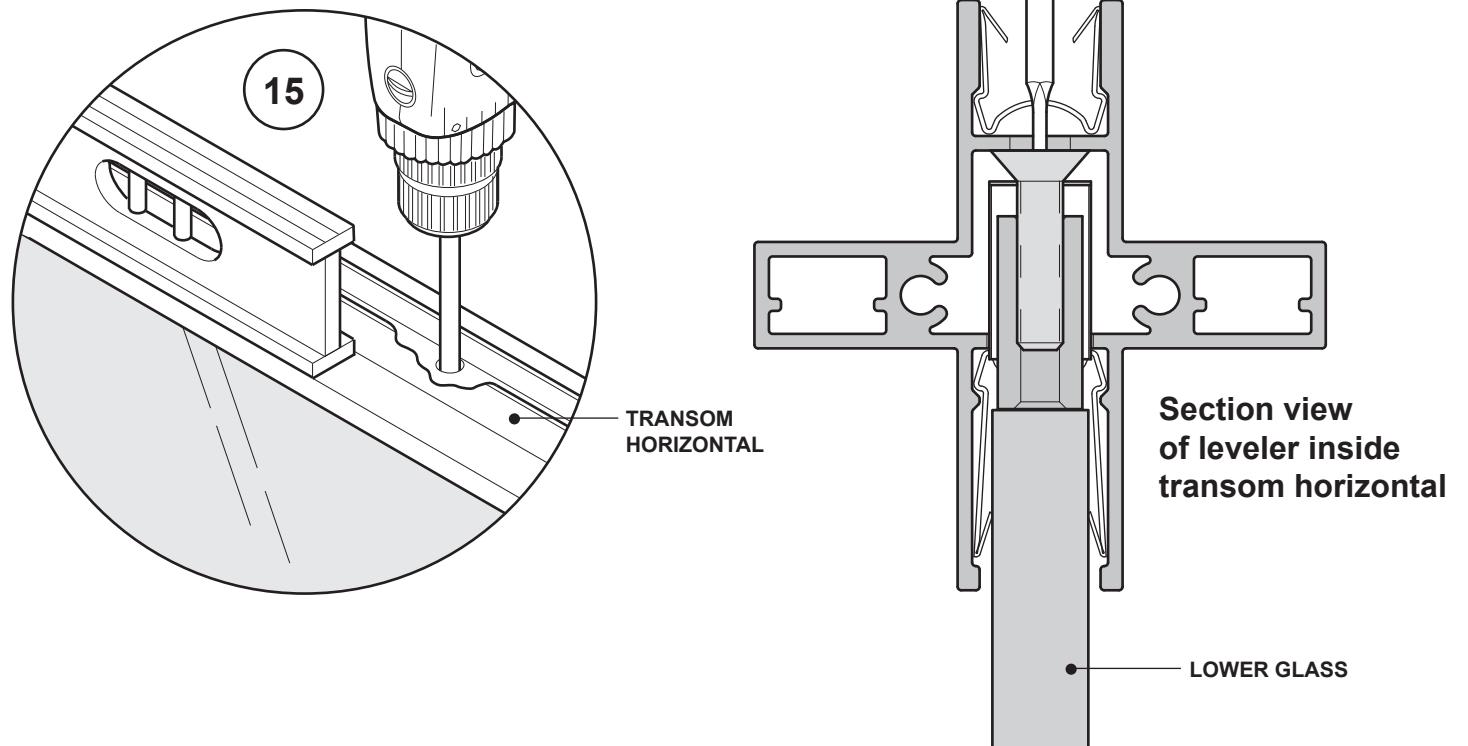

**17.** Attach the horizontal bottom cap to the horizontal bottom by snapping into place. For 5" Base only.

**18.** Refer to Assembly Directions 939599485- Privacy Wall & Glass Selections - Solid and Glass Wall Panels for application of base trims.

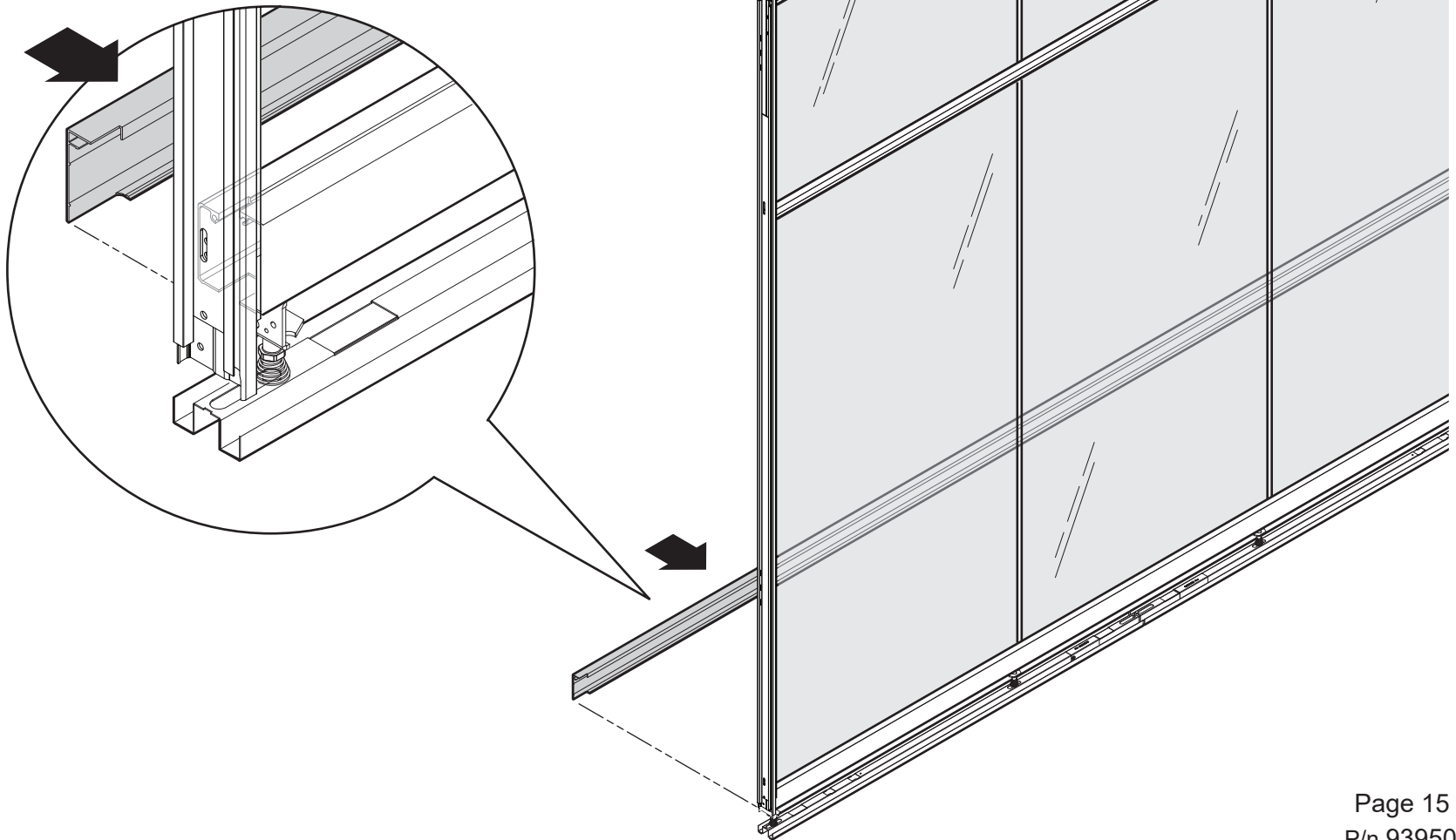



If using tape to seal, refer to pages 18 & 19.

## Applying the Silicone Sealant

**Note:** It is recommended that a professional glazer be used. This is a two (2) person operation.

**1.** Apply 2" masking tape to each side of the gap on both sides of the glass.

**2.** Make sure there is a 1/8" gap between the glass (2a). Adjust if needed (2b).

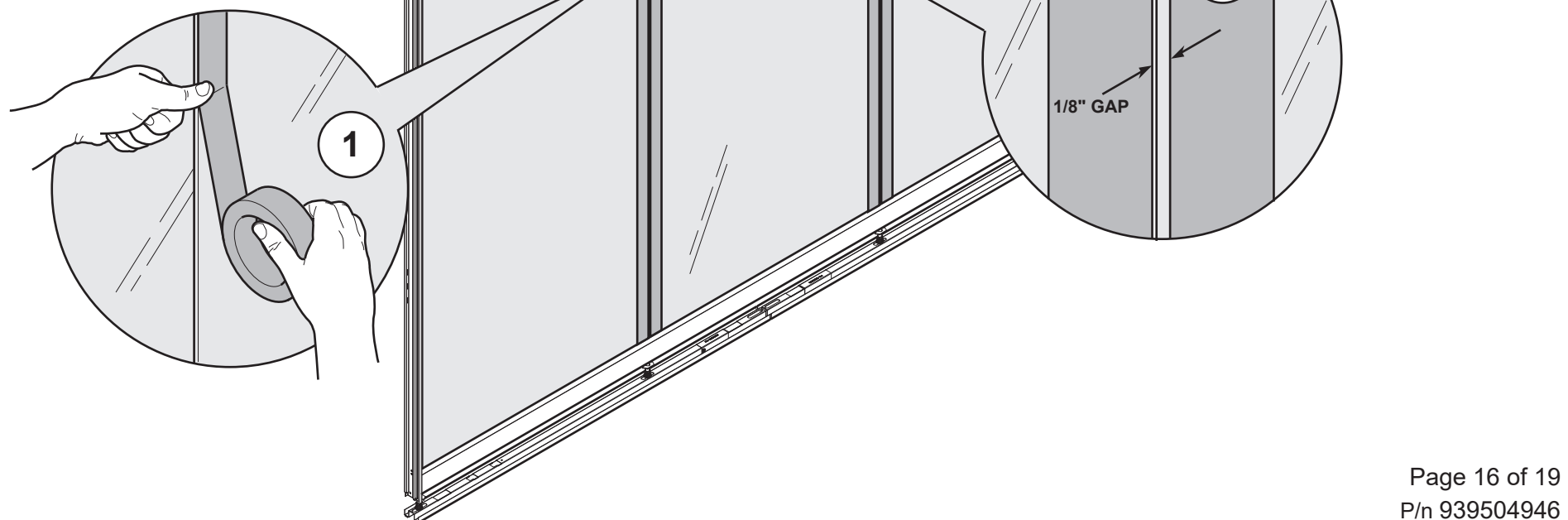

**3.** Apply silicone sealant into groove and smooth sealant on both sides of the glass simultaneously.

**4.** Remove masking tape.

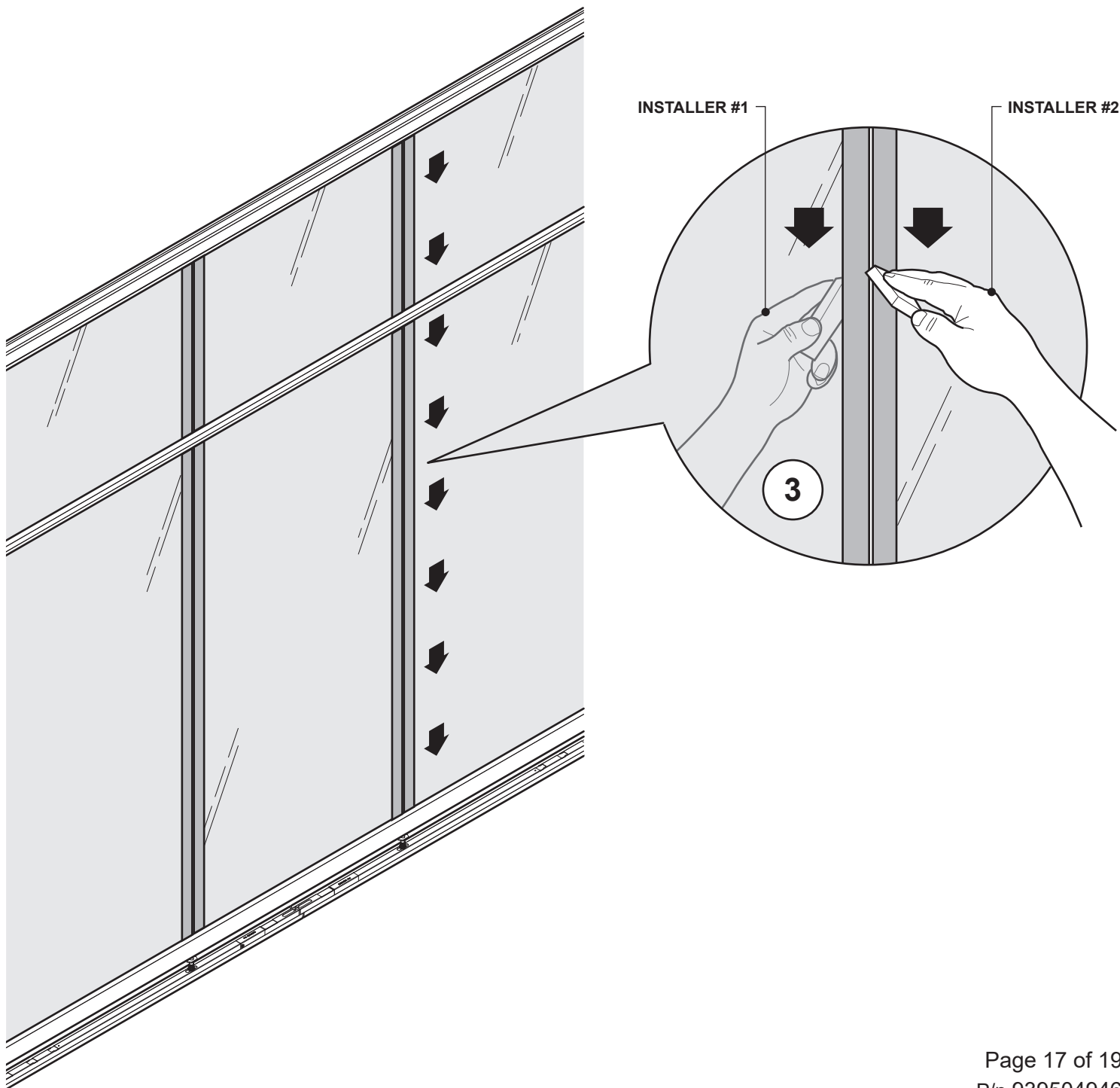

## Applying Adhesive Tape Sealant

**Note:** It is recommended that a professional glazer be used. This is a two (2) person operation.

**Note:** 3M 4905 6mm wide VHB tape is the recommended tape for use in this application. Follow all tape manufacturer's recommendations including surface preparation and cure time.

**1.** Unroll tape to expose adhesive and apply tape to glass.

**2.** Follow Steps 9 thru 16 on pages 8 thru 13 as shown.

**3.** Remove the remaining backing from tape.

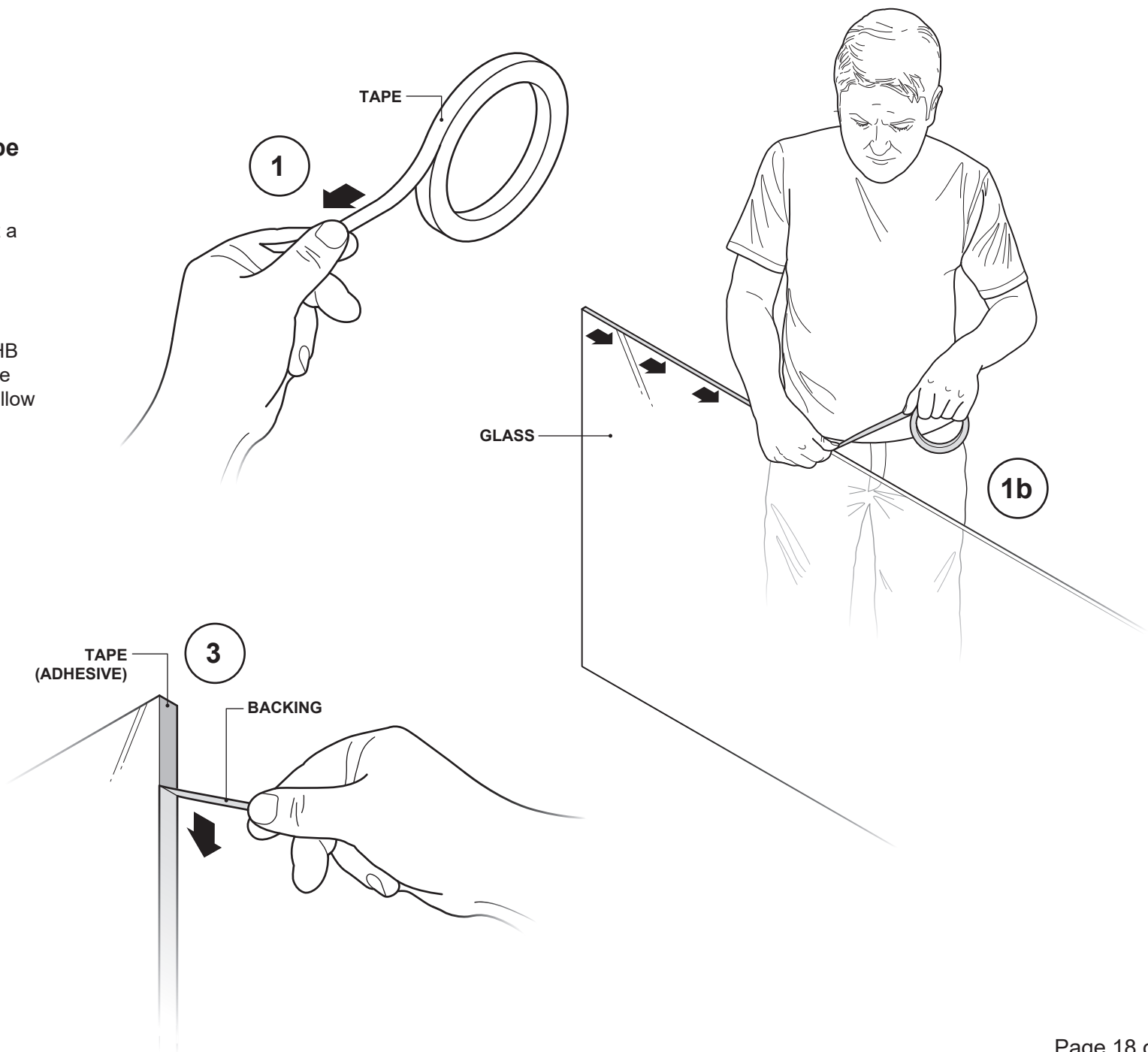

**4.** Slide the two (2) glass panels together, checking alignment before contacting the adhesive to insure flush appearance.

**5.** Apply pressure during cure as recommended by the tape manufacturer.

**Note:** This can be accomplished using suction cups and cinching straps.

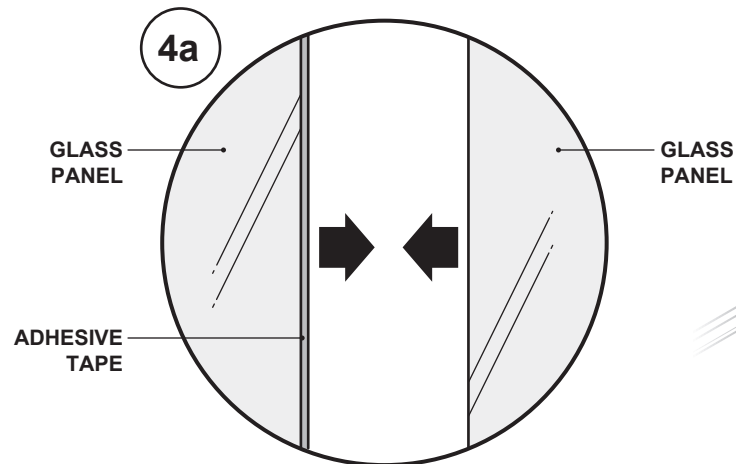

**Side View of Suction Cup Location In-Line**

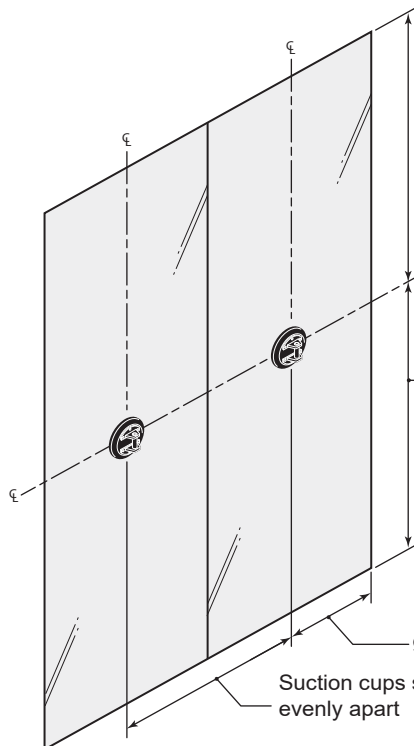

**Side View of Suction Cup Location Corner**

