

## Power and Data Covers (GPPDC) and Power Only (GPPC) Modular and Hardwire Versions - Privacy Wall

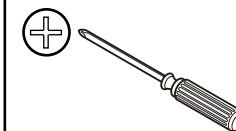
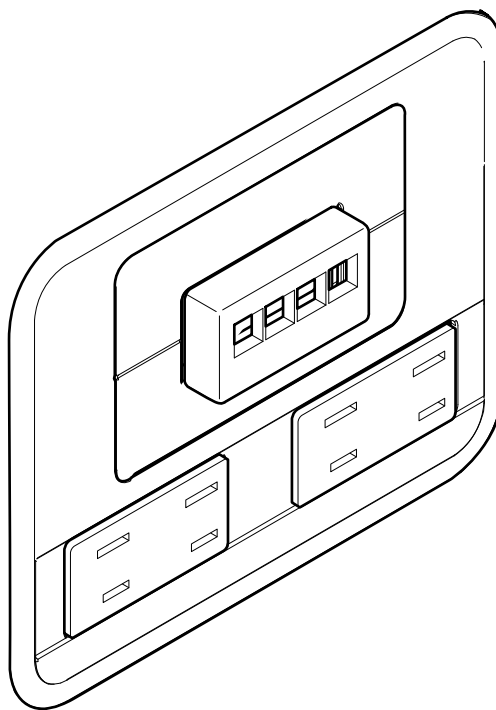

If you have a problem, question, or request, call  
your local dealer, or Steelcase Line 1 at  
**888.STEELCASE** (888.783.3522)  
for immediate action by people who want to help you.

(Outside the U.S.A., Canada, Mexico, Puerto Rico,  
and the U.S. Virgin Islands, call: 1.616.247.2500)

Or visit our website: [www.steelcase.com](http://www.steelcase.com)

© 2004 Steelcase Inc.  
Grand Rapids, MI 49501  
U.S.A.

Printed in U.S.A.

1. Depending on location, zone, and type of cover, add foam strips to support skin.

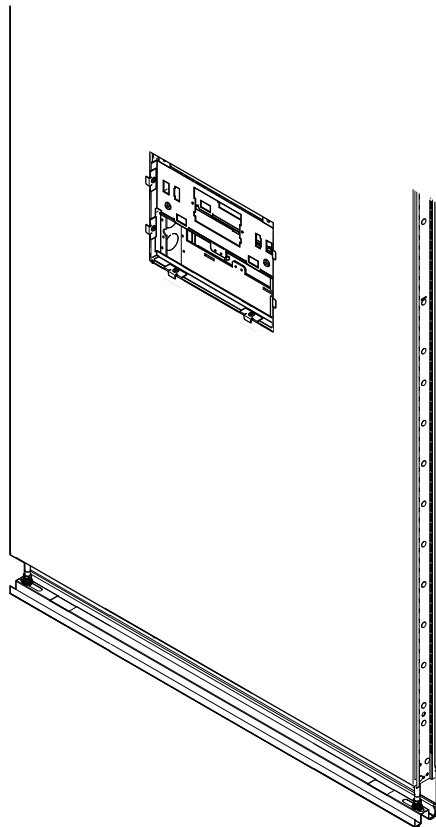

**All Other Zones Require 2 (two) Foam Strips**

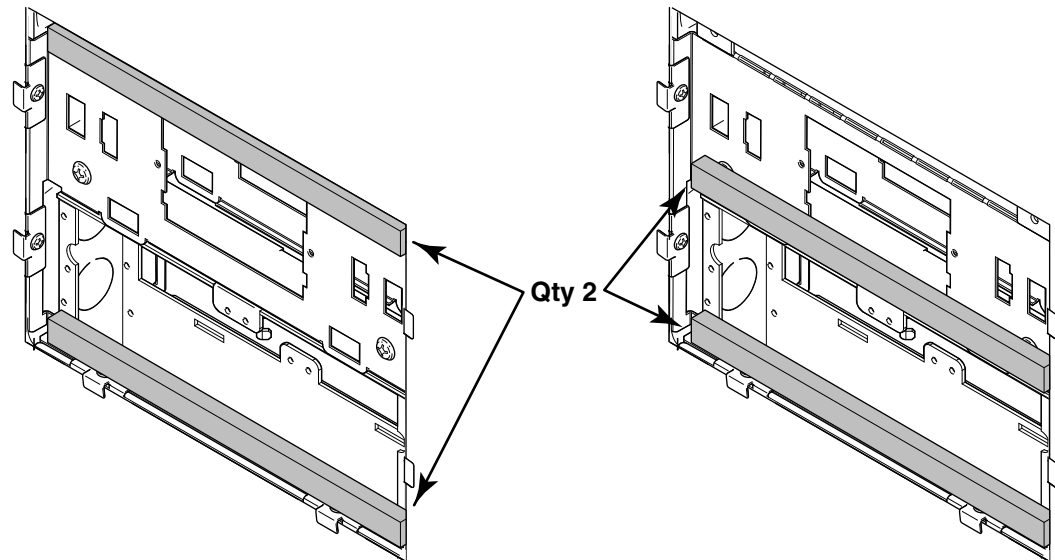

## Power and Data Cover Installation

**2.** Check to see if power mounting brackets, vertical brackets, power blocks and receptacles are installed correctly. Refer to assembly instruction #939504926, #939504927 and #939504928.

**3.** Locate communications spacer and snap on.

**NOTE:** If using modular furniture or decora mounting strap face plate, a face plate adaptor is required (included in package).

### Nema Mounting Face Plate

**3**

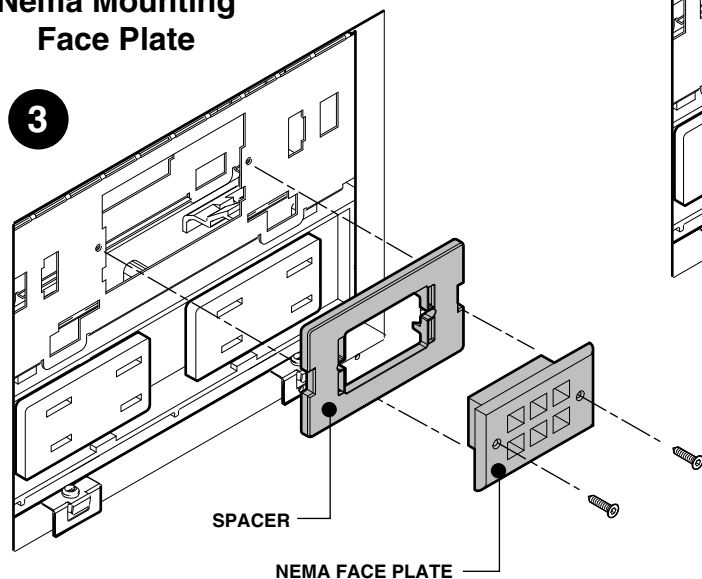

### Decora Mounting Strap Face Plate

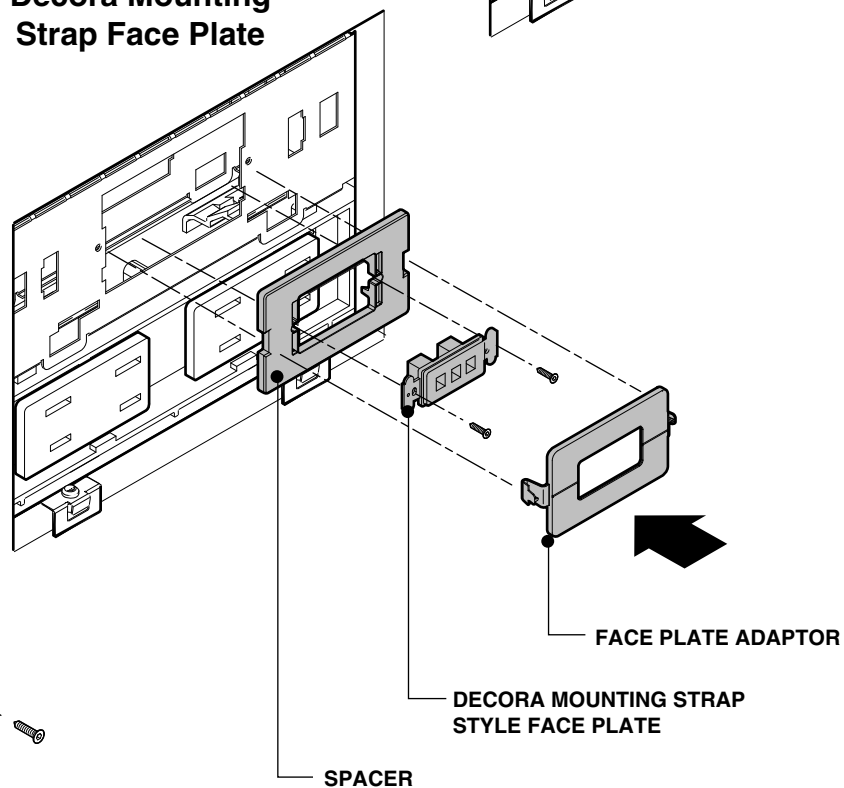

### Modular Furniture Face Plate

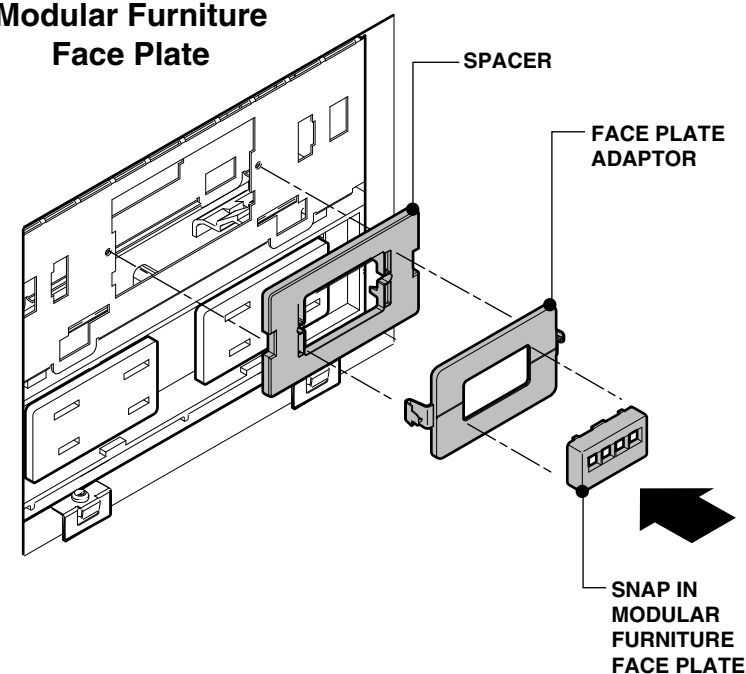

**4.** Locate bottom tabs of cover (4a) assembly, in slots below receptacles. Rotate and gently snap on cover assembly (4b). Cover assembly is self aligning. Do not use excess force to install. For hardwire situations, push receptacles in (4c).

**NOTE:** Power receptacles type (3+1, 2+2, 3SepN) may be changed at any time without disturbing data cable connections.

