

Privacy Wall Glass Selections - Polished Edge Slider Door with Self-Assist Closers

DOOR LEAF:

- Satin Tempered
- Clear Tempered

SIDE LIGHT

ETCHED GLASS STYLES:

- Satin
- Mist

PATTERN GLASS STYLES:

- Waterfall
- Bamboo
- Harp
- Mirage

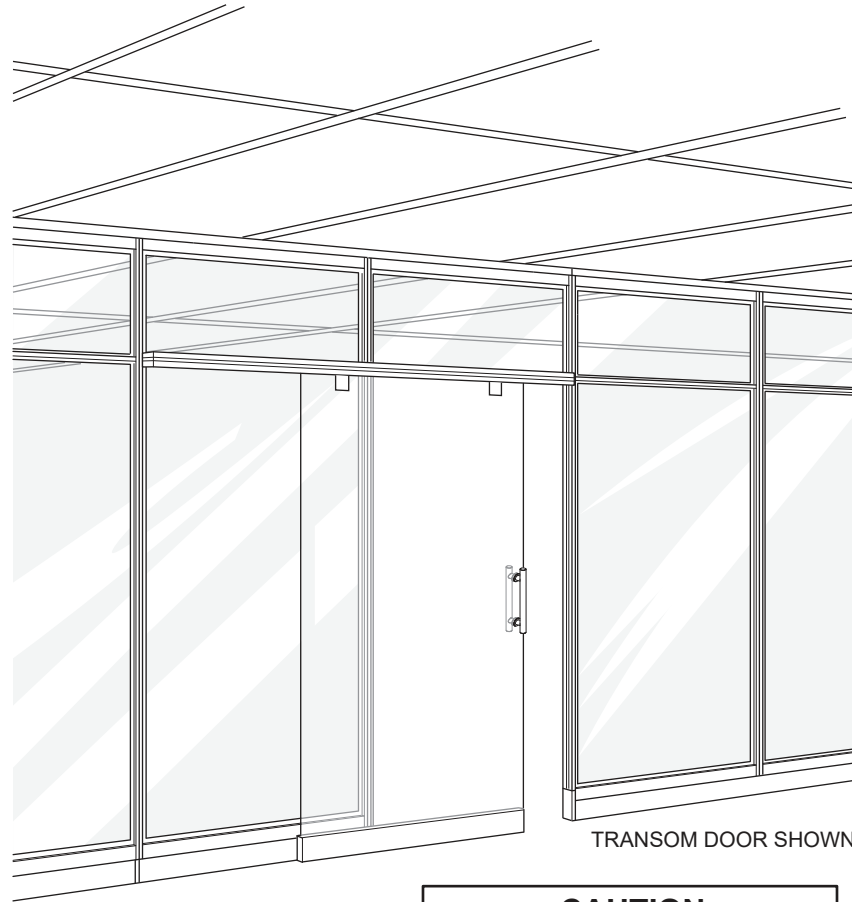

TRANSOM DOOR SHOWN

CAUTION:

Corner of the glass can easily be damaged while being installed. Please handle carefully!

NOTE:

For etched/pattern glass orientation please refer to the installation drawings. Unless noted otherwise, use the default.

DEFAULT GLASS ORIENTATION:

ETCHED GLASS:

Rough side to go on the **inside** of the office space.

PATTERN GLASS:

Rough side to go on the **outside** of the office space.

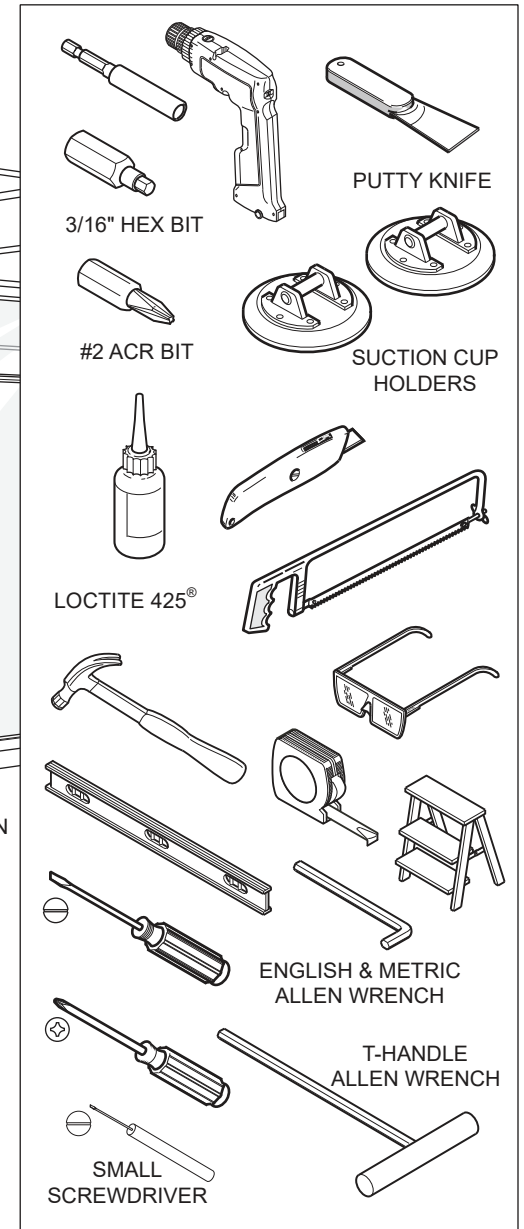

Wall
Installation
Support



HORIZONTAL ENTRY

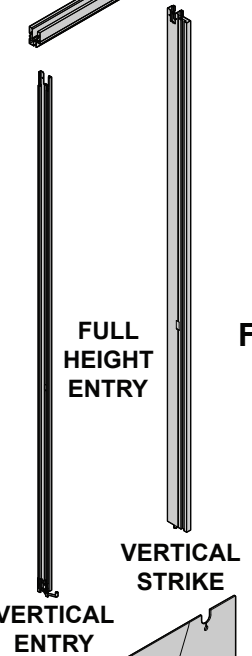

VERTICAL STRIKE

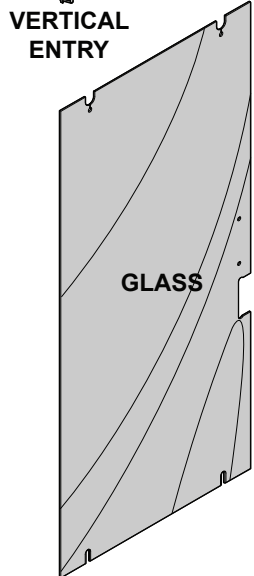

FRAME AND PANEL ASSEMBLIES

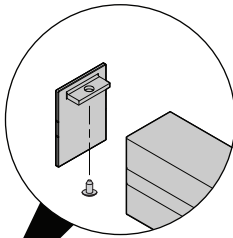
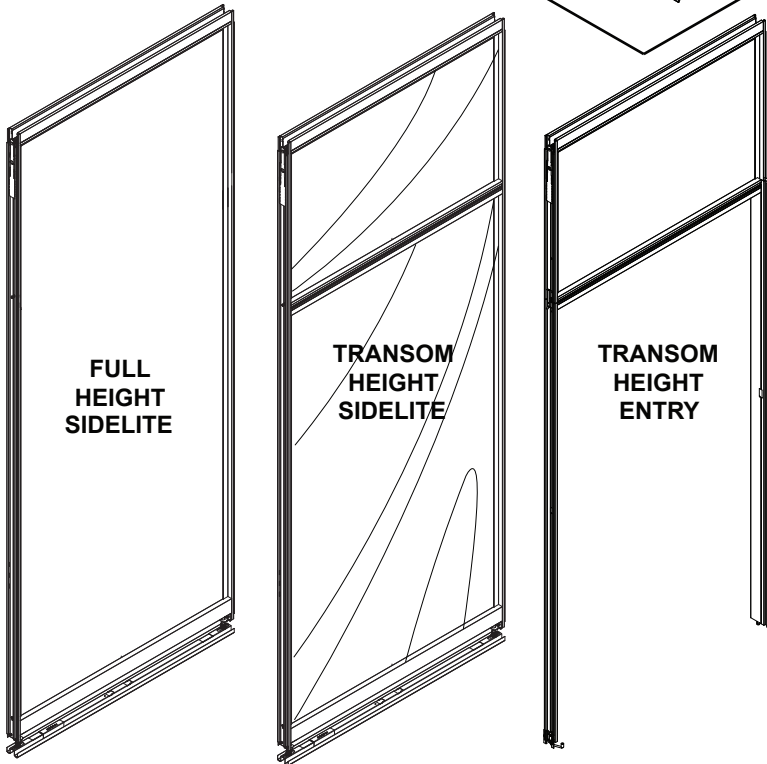

TRACK KIT ASSEMBLY

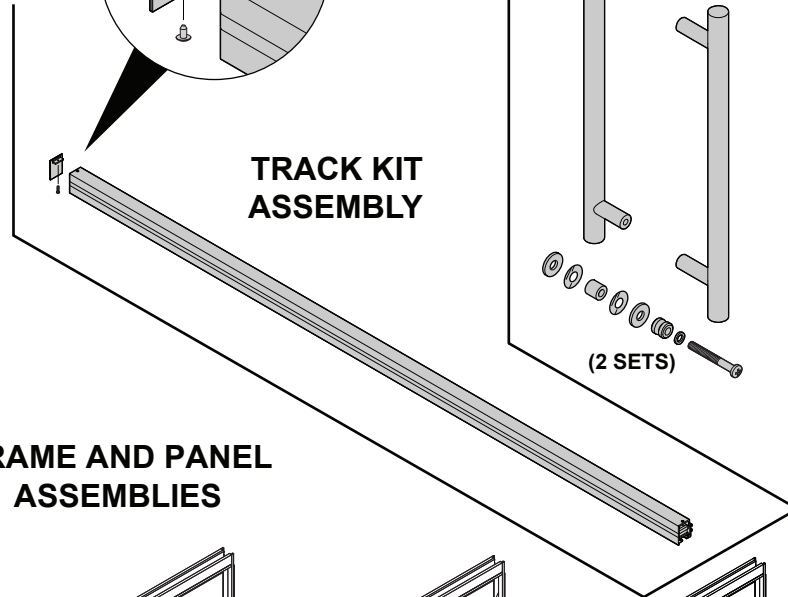

HANDLE ASSEMBLY

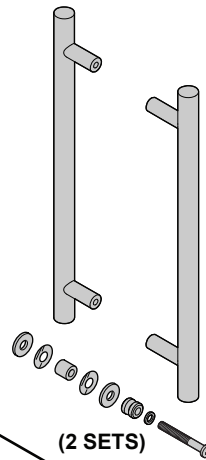

ROLLER KIT ASSEMBLIES
(see pages 3, 4 & 5)

NO BASE OPTION

GUIDE

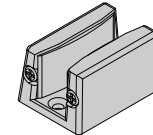

SPACERS

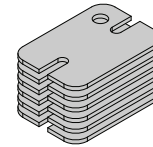

SCREWS



ALSO USED WITH 2.5" BASE OPTION

SLIDER PANEL PLINTH TRIM

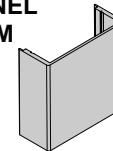

SLIDER STRIKE PLINTH TRIM

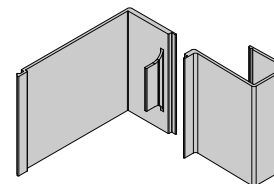

BASE ASSEMBLY

BASE CHANNELS

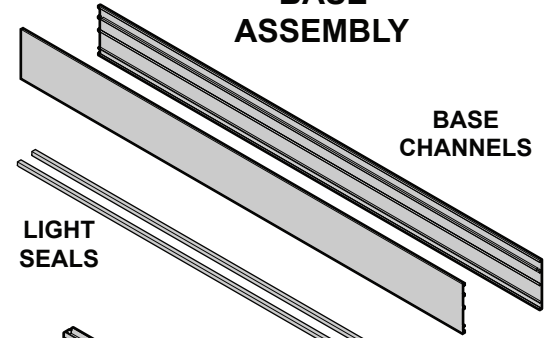

SPLINE CHANNEL

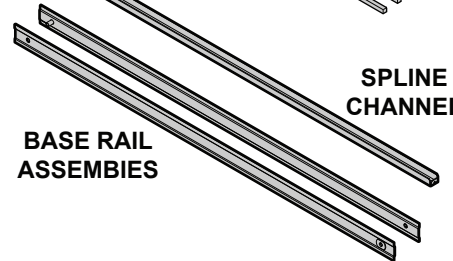

BASE SPACERS

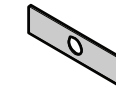

(12) PER KIT

BASE COVERS WITH SCREWS

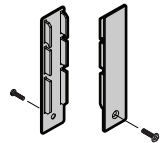

SLIDER SIDELITE PLINTH WITH PLASTIC CLIPS

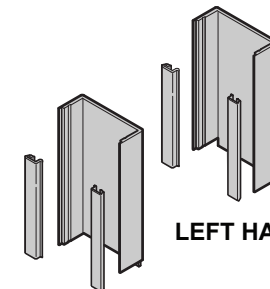

RIGHT HAND

SLIDER STRIKE PLINTH TRIM

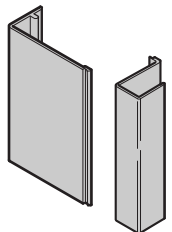

LEFT HAND

(2) CLOSER KIT

(2) CLOSER BRACKETS

(2) CLOSERS

(2) CLOSER STOPS

BUSHINGS

(2) SUSPENSION BOLTS

**(2) SETS OF SUSPENSION
PATCHES WITH SPACERS
AND SCREWS**

COVERS

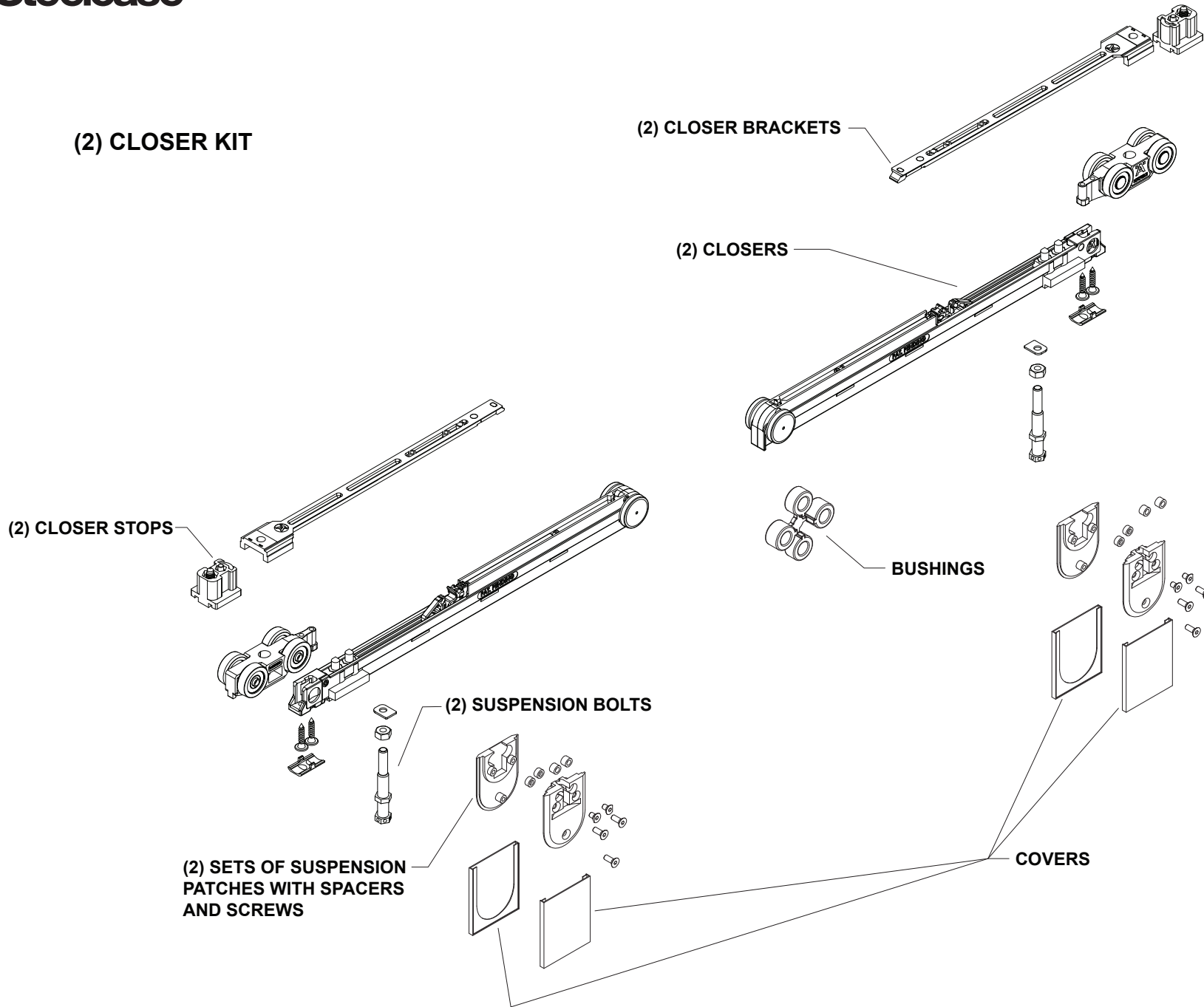

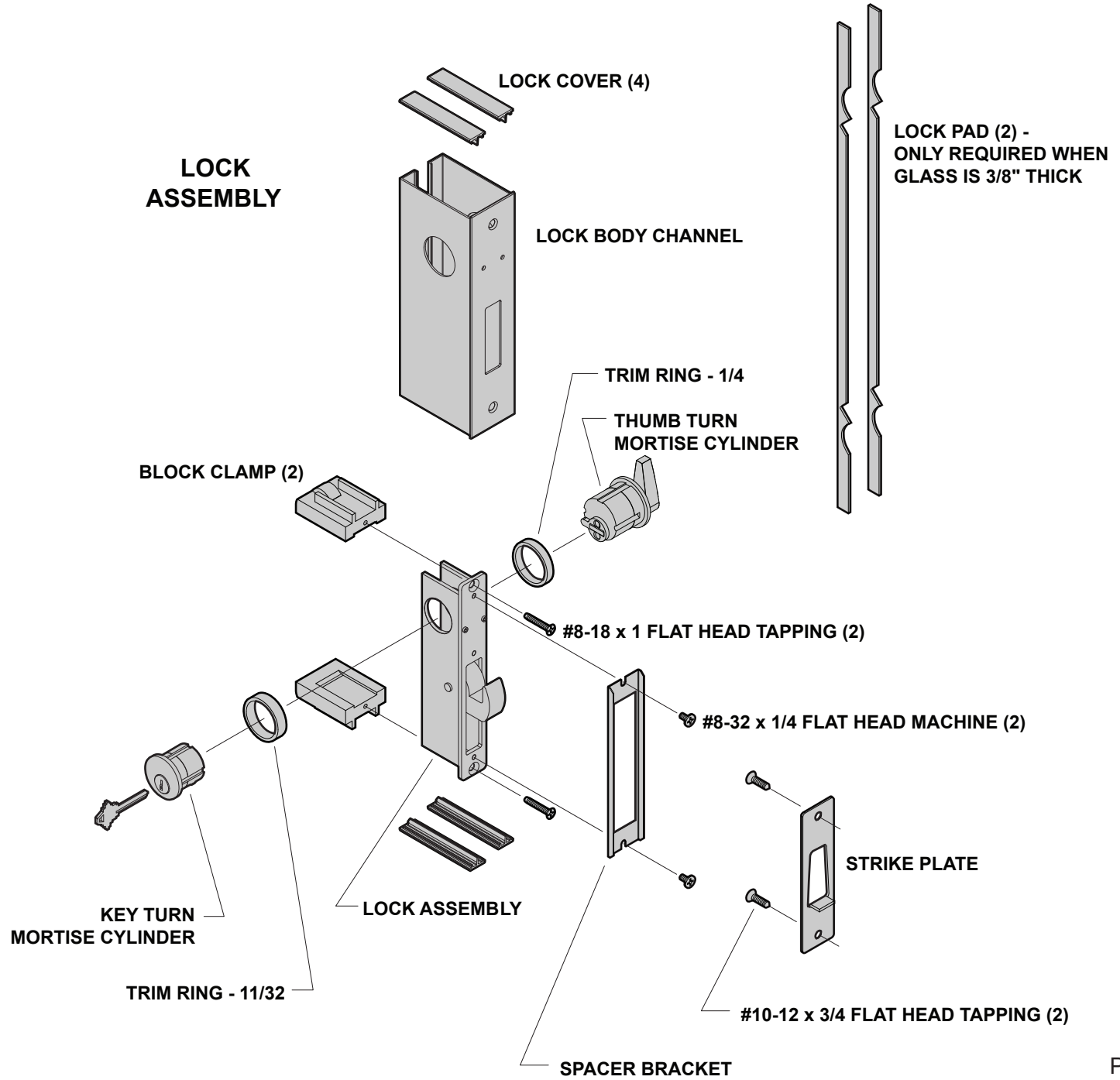

 = Inline Feature Strip

 = Half Feature Strip

Connection Conditions

NOTE: All other connection conditions are the same as standard panel mounting connection conditions.

If a Floor Anchor is required

1. Using a pencil, mark floor anchor hole.
2. Using a masonry drill bit, drill a hole to the manufactures specification.
3. Place the anchor bolt into the hole.
4. Tap the anchor bolt down into the hole.
5. Place anchor bracket over the anchor bolt and secure with washer & nut.
6. Tighten nut with wrench.

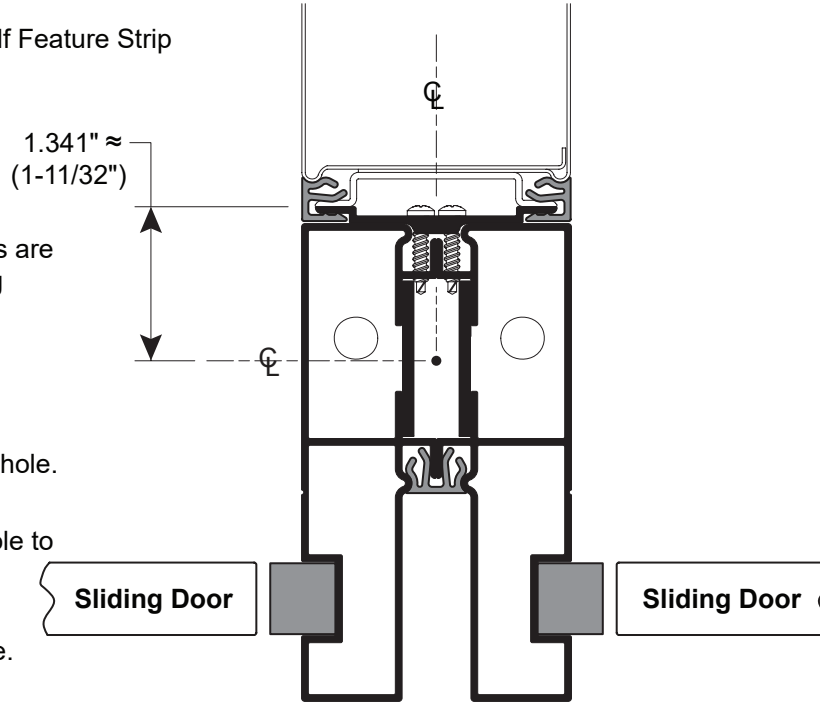

"T" with Sliding Doors Centered

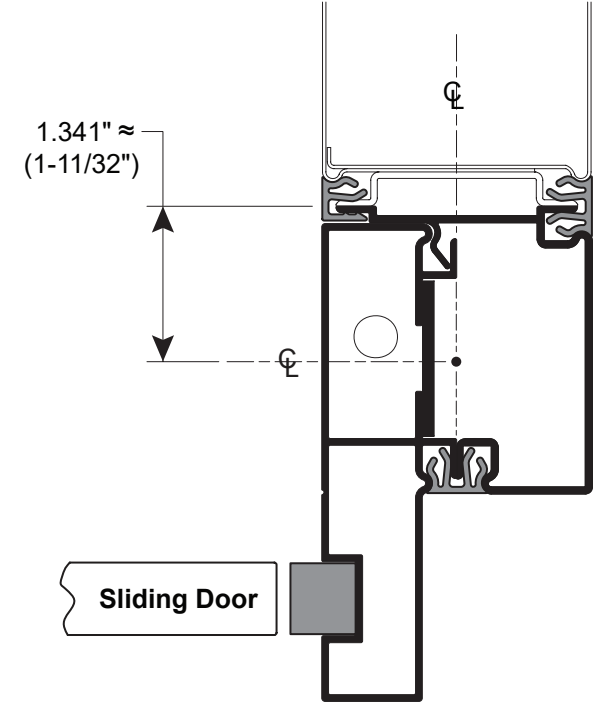

90° with Centered Sliding Door

NOTE: If floor anchoring is required on a raised floor, you can secure the anchor bracket to the floor with a screw and washer.

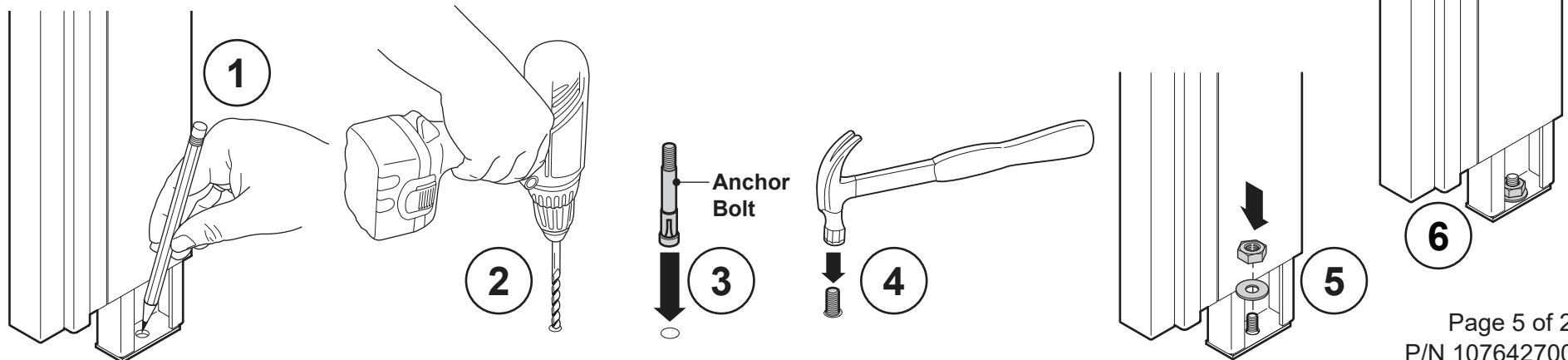

Installing The Frames

1. Install the slider door panel. Place top of panel into ceiling track first and then swing base of panel toward the floor.

2. Engage the post extension by inserting a screwdriver into the slots and slowly tapping the extension upward (2a) by engaging the small holes in the extension (2b). Extend fully to top of ceiling channel.

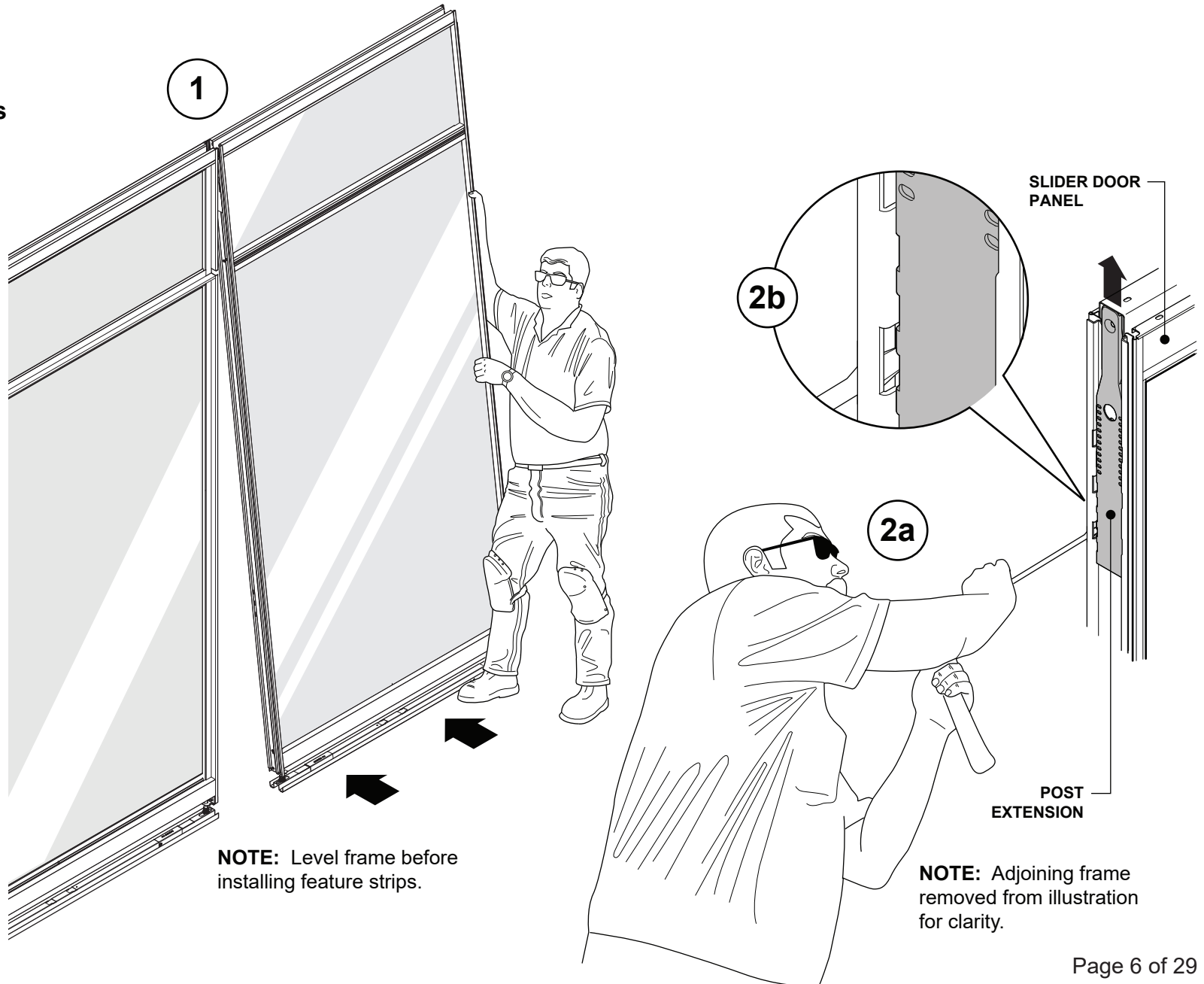

NOTE: Level frame before installing feature strips.

NOTE: Adjoining frame removed from illustration for clarity.

Installing The Frames (continued)

3. Using two people, slide the transom height entryway into place.

NOTE: For full height entryway unit see page 8 for assembly.

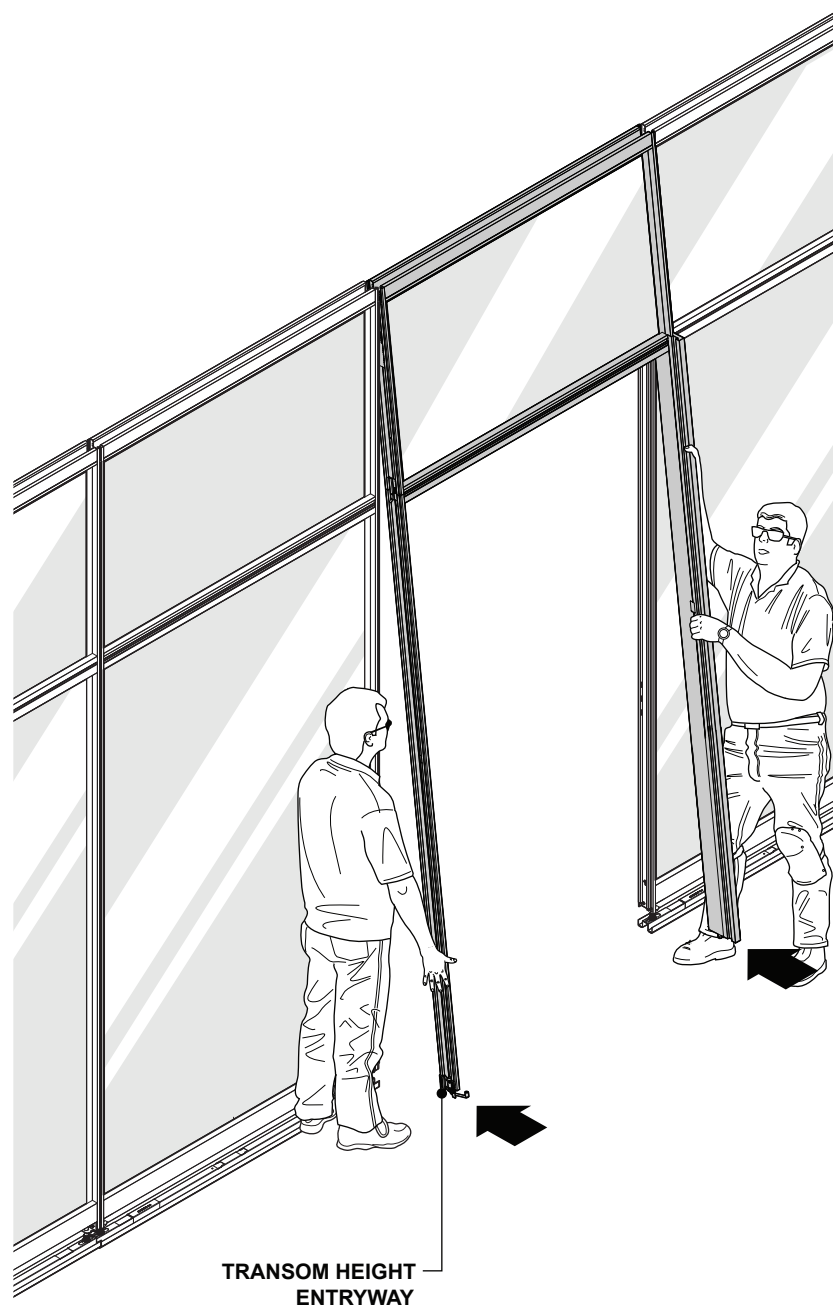

Assembling a Full Height Entry Frame

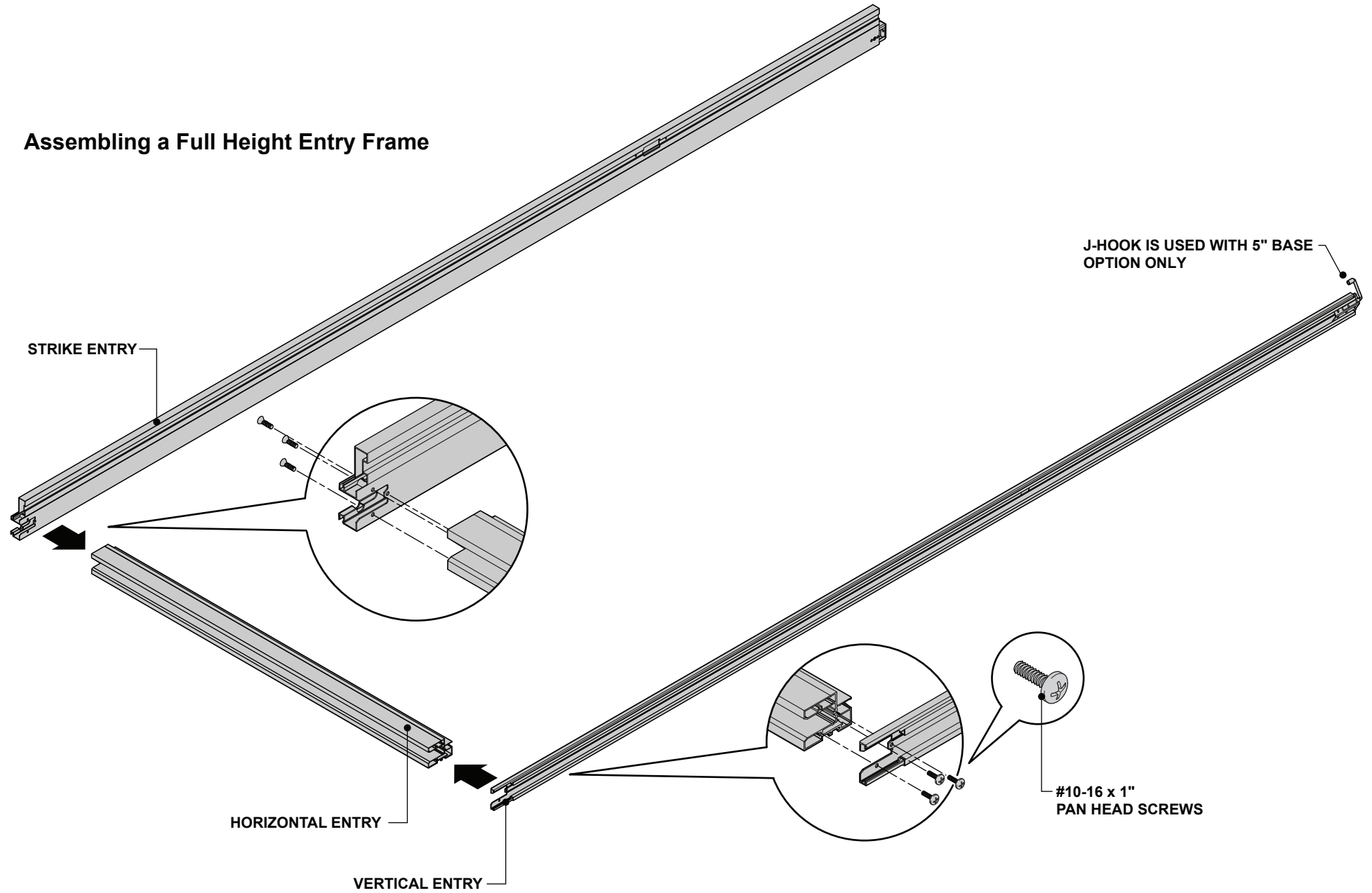

Installing The Frames (continued)

4. Adjust levelers so that the tracks align on both the slider door panel and the entryway frame.

CAUTION: Do not over tighten.

5. Secure the frames together with a full length feature strip or the optional vertical seal (see page 11).

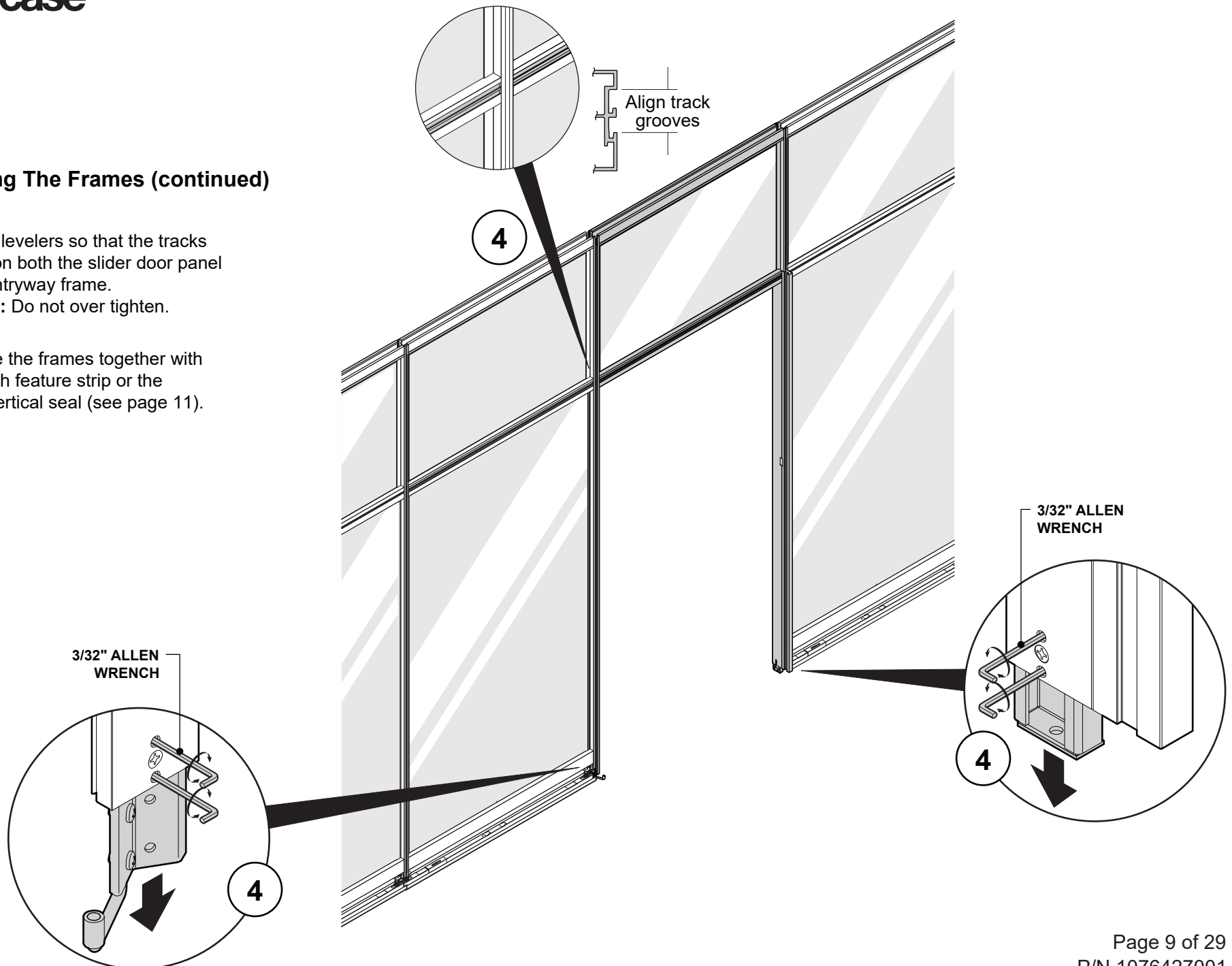

Installing The Door Track Assembly

1. Align the track kit assembly with the frames. Butt end of track to vertical strike.
2. Attach track kit assembly to frames by engaging into track (2a) and secure using six (6) set screws with Loctite 425 (2b).

NOTE: If the slider track plan width is over 122" the track will be two pieces. The longer section is used over the entry frame and first portion of adjacent slider door panel. The shorter section is used to over the remainder of the slider door panel. The door roller hardware should never be allowed to cross the joint between the two track sections. This applies to Frame Kits with slider door options. If a two-piece track is present, install the shorter section of track after installing and adjusting trailing end closer stop on page 15.

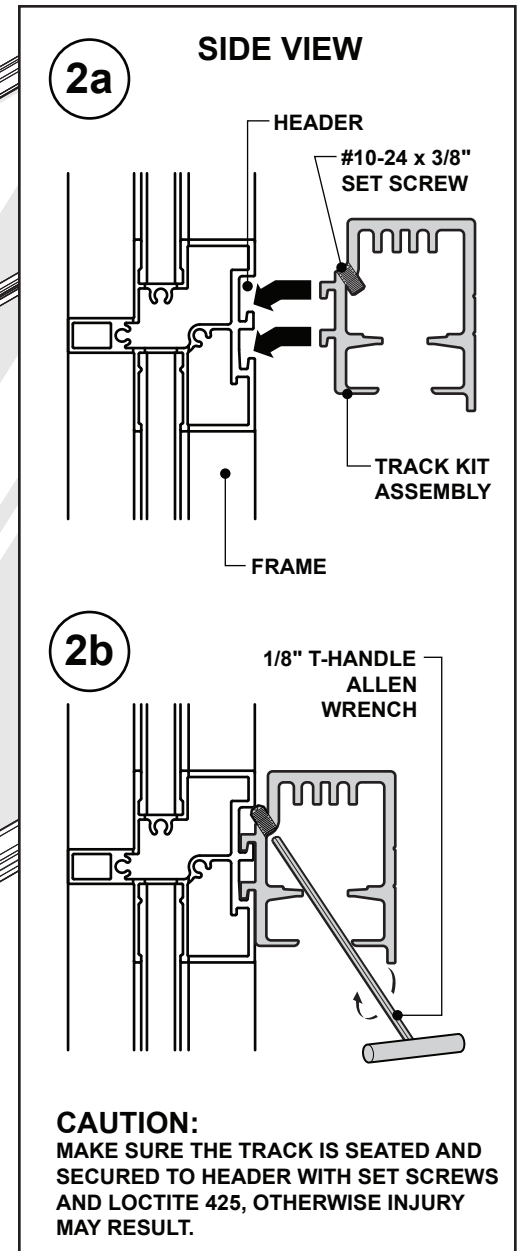
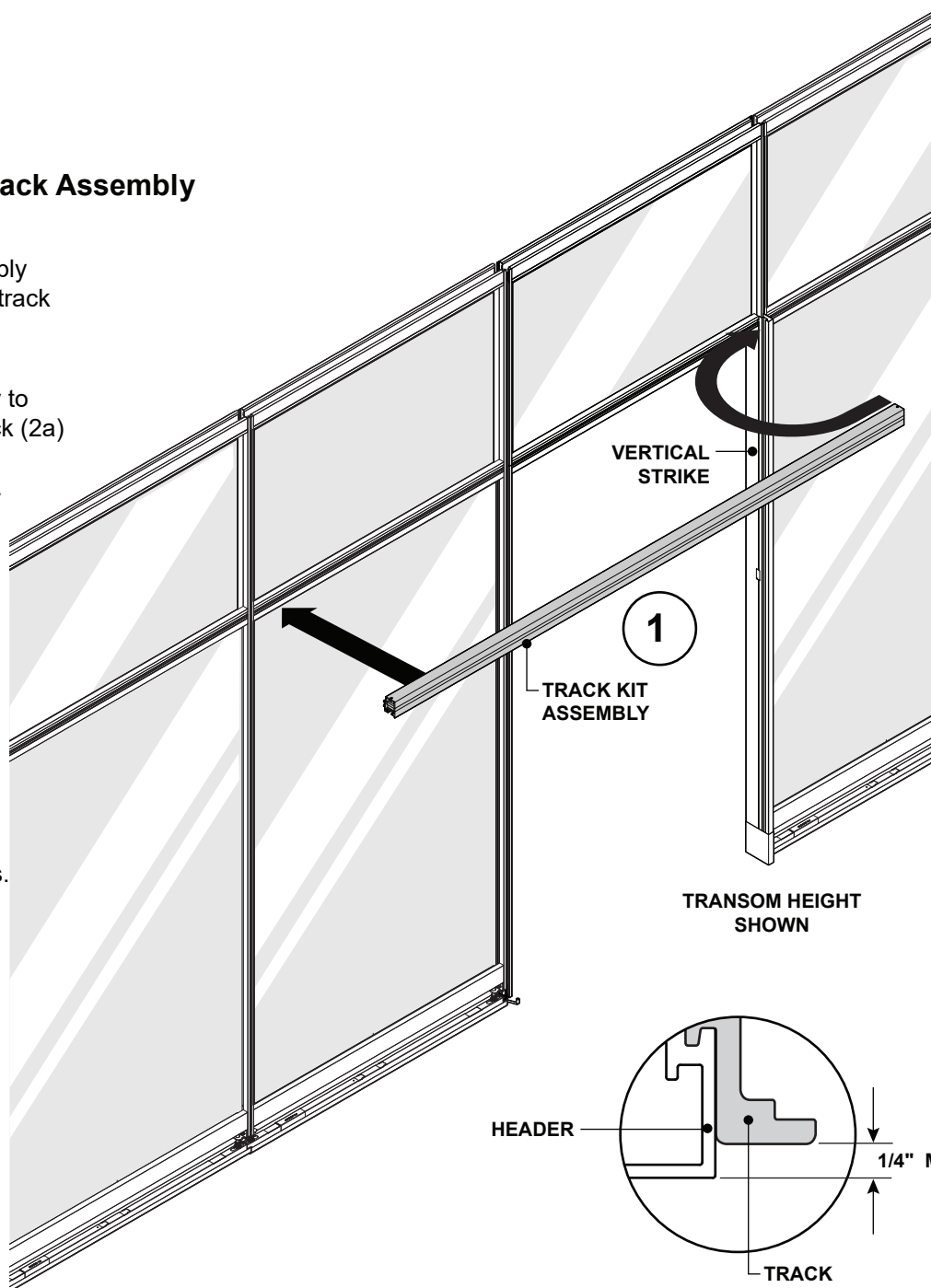

Installing the Door Seal and the Optional Vertical Seal

1. Apply door seal to strike as shown.

2. For vertical seal option use vertical seal instead of feature strip on door side. Install as shown (2a). Use feature strip above track (2b).

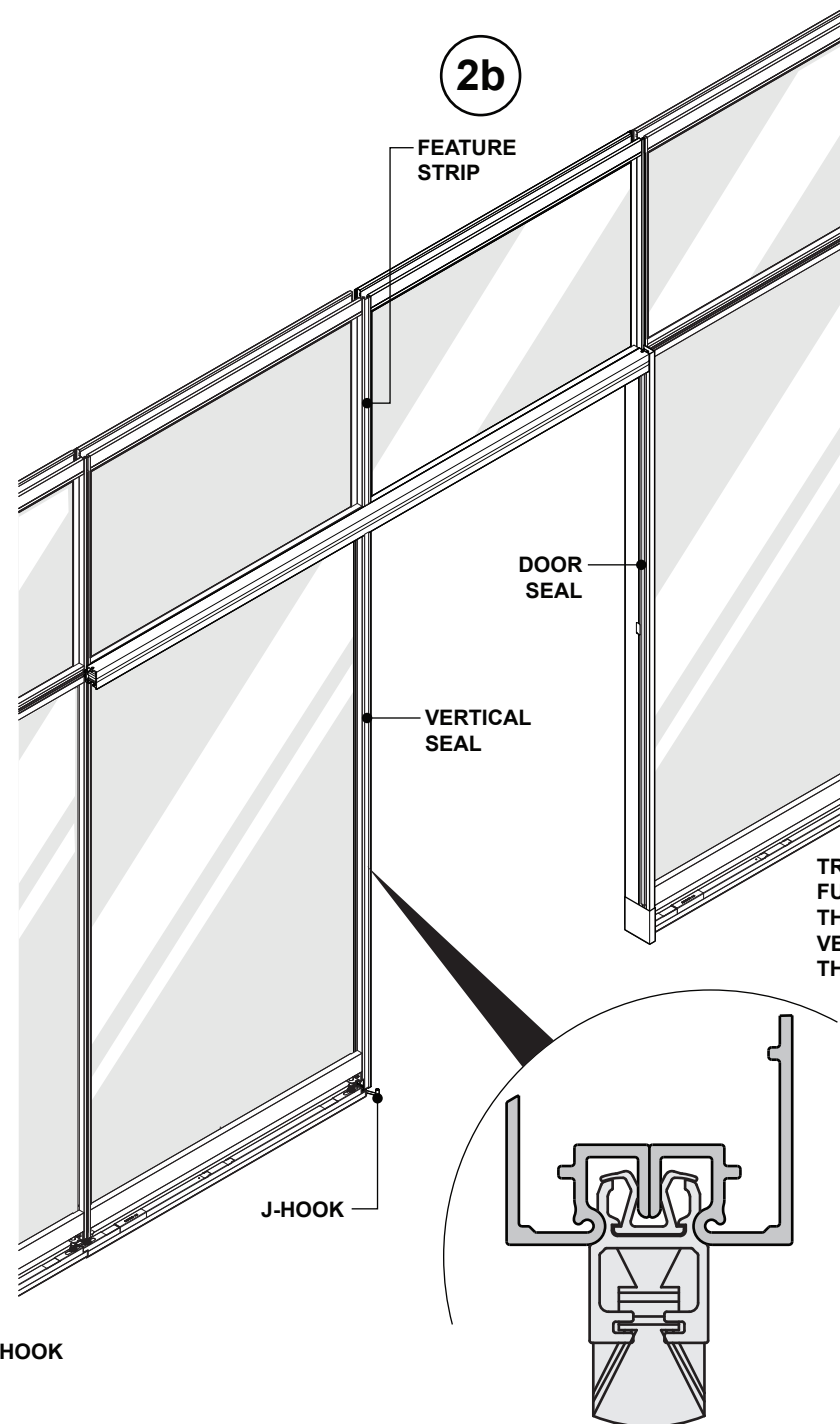
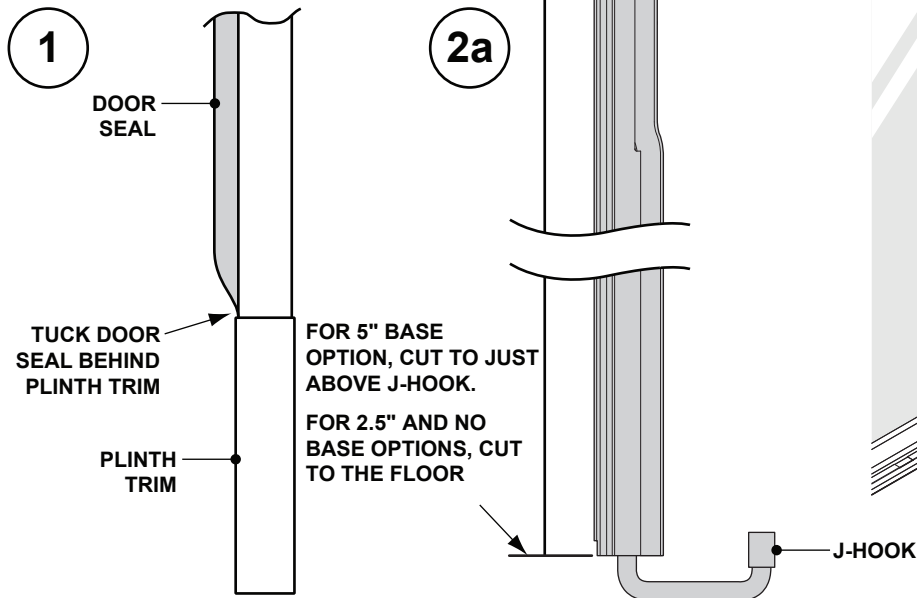

TRANSOM HEIGHT SHOWN. FULL HEIGHT WILL HAVE THE DOOR SEAL AND THE VERTICAL SEAL GOING THE ENTIRE HEIGHT.

Installing the Suspension Patches to the Door Leaf

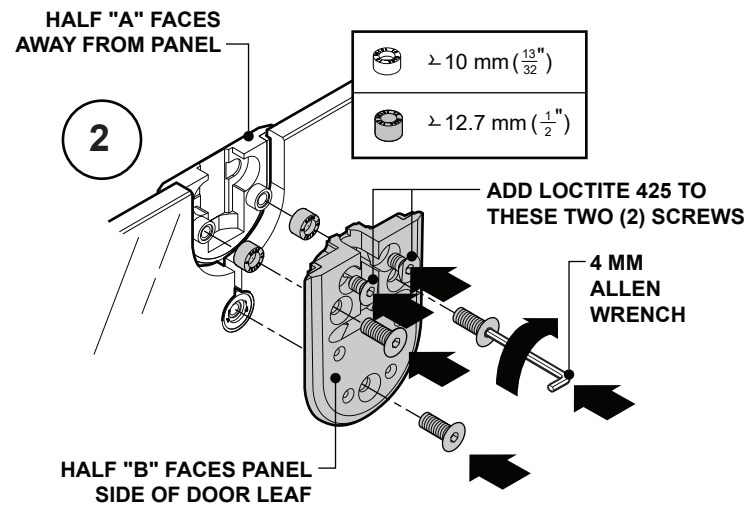
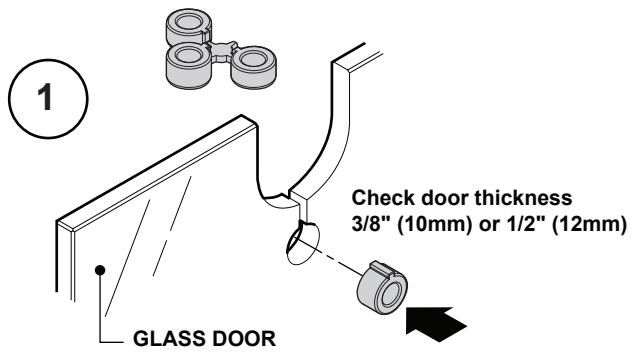

DOOR FRAME STRIKE
SIDE TRACK IS SHOWN
TRANSPARENT. OTHER
DOOR PARTS NOT
SHOWN.

Installing Leading End Closer Stop & Bracket

1. Slide the leading end closer stop and bracket assembly down the length of the track toward the strike side as shown.
2. Position the end of the closer stop and bracket assembly approximately 1- 7/8" from the end of the track.
3. Install #8 - 18 x 1/2" long Flat head screw, making sure bracket is aligned with center groove as shown.
4. Tighten both screws in stop.

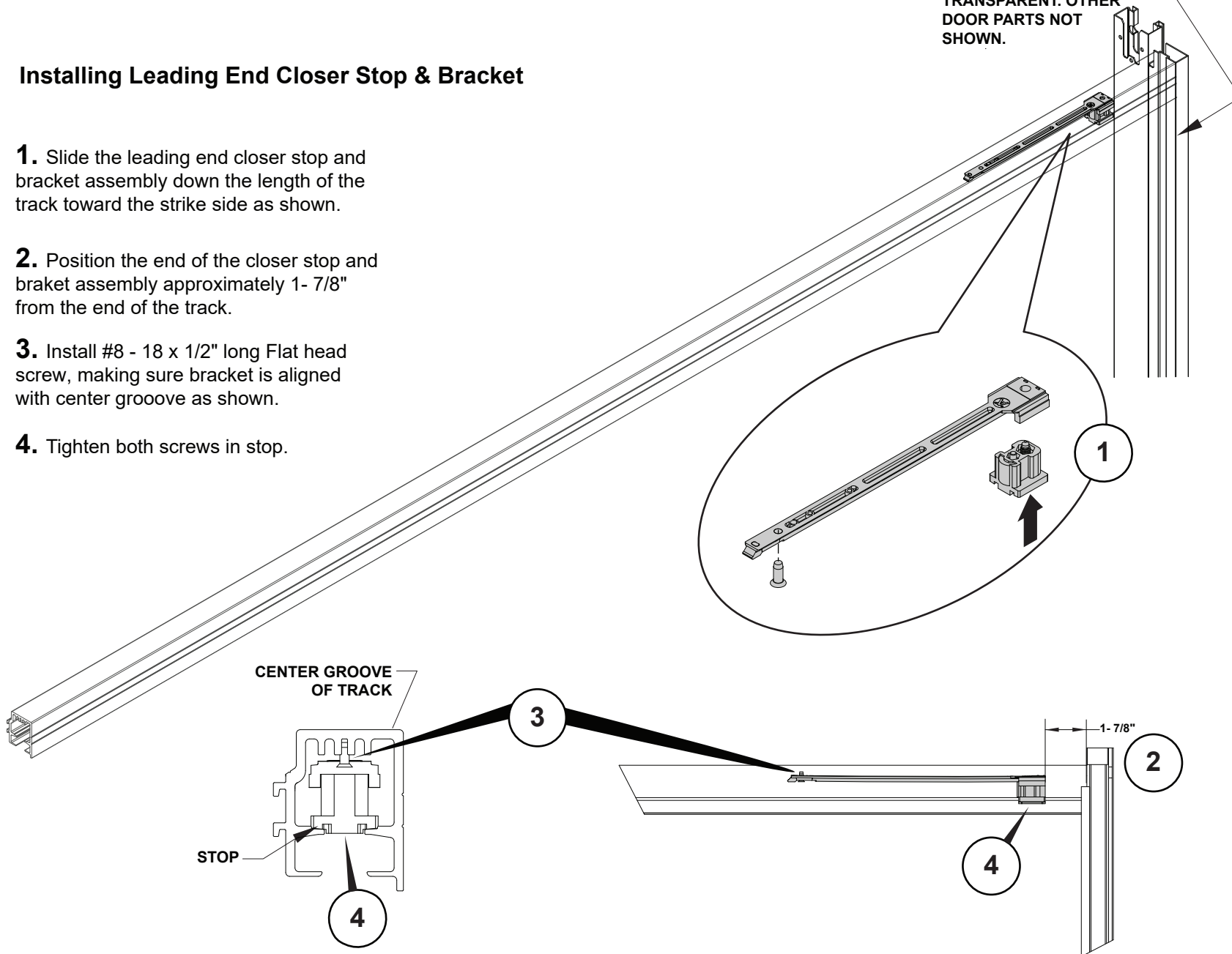

Installing Leading End & Trailing End Closers

1. Insert nut and washer into pocket of closer as shown.
2. Assemble suspension bolt to approximate depth shown. Repeat for trailing end closer.
3. Install leading end closer into track as shown.
4. Slide closer toward strike end of track.
5. Install trailing end closer as shown.

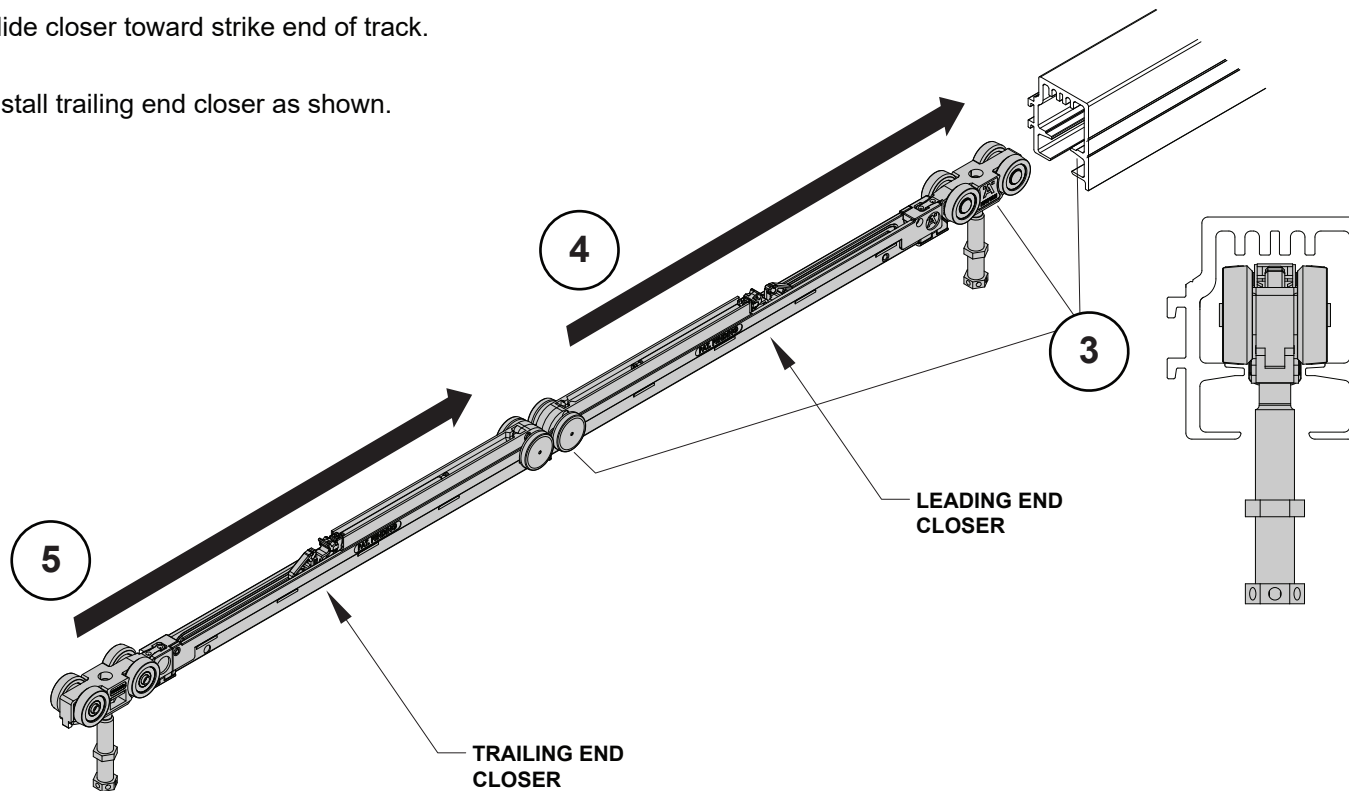
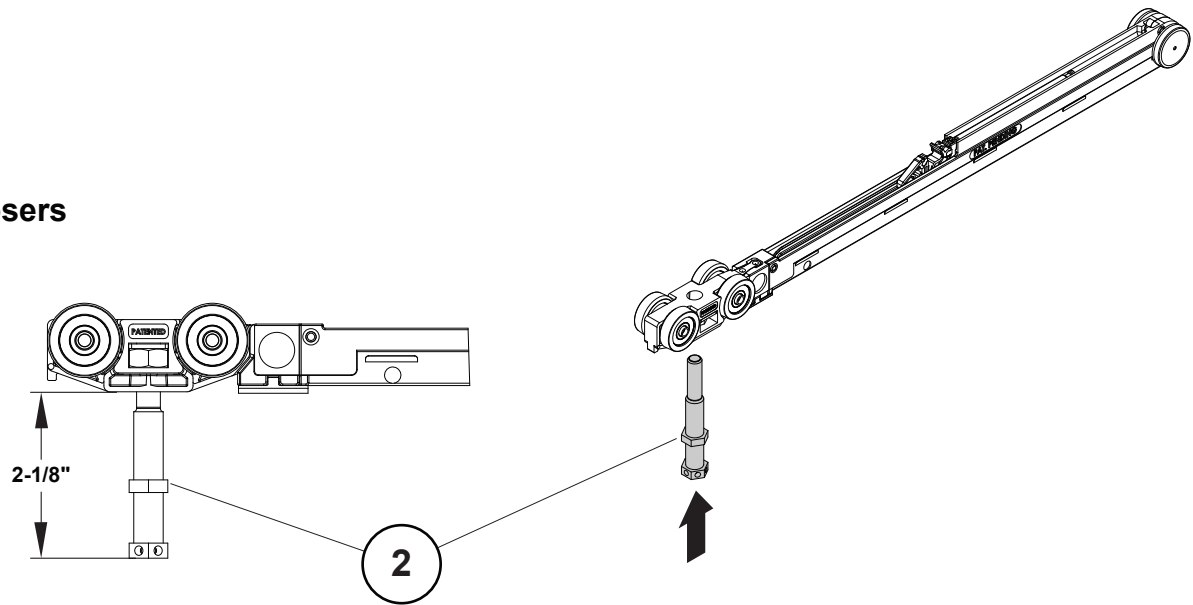

DOOR FRAME STRIKE
SIDE TRACK IS SHOWN
TRANSPARENT. OTHER
DOOR PARTS NOT
SHOWN.

Installing Trailing End Closer Stop & Bracket

1. Slide the trailing end closer stop and bracket assembly into the track toward the strike side as shown.
2. Install #8 - 18 x 1/2" long Flat head screw, making sure bracket is aligned with center groove as shown.
3. Tighten both screws in stop.
4. If a two-piece track is present, the shorter track can be installed at this time. See steps 2A and 2B on page 10.

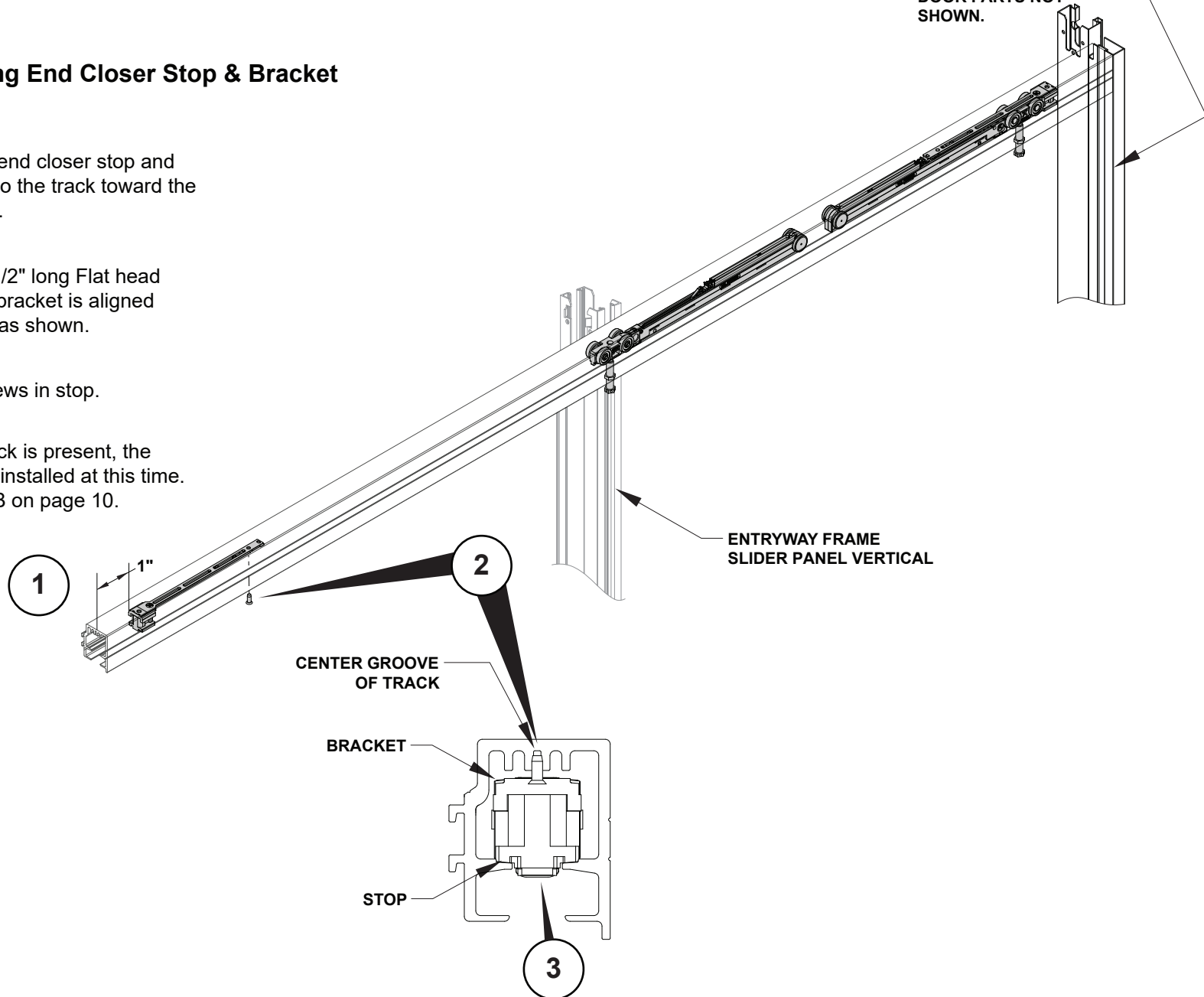

Installing The Glass Door Assembly

1. Install roller package assembly to the glass door per steps 1 and 2 on page 12, except do not install (4) "D" screws.
2. Using two people, gently guide the glass door assembly into the track kit assembly (2a). Have third person position the bolts and once the door is hung add Loctite 425 to "D" screws and install (2b).

CAUTION:

To avoid glass chipping, keep all protective corner packaging in place while unpacking and staging.

Remove top protective corners after installing door leaf. Take care to avoid damage to unprotected corners.

Do not rest bottom of glass on J-hook or other foreign objects.

NOTE: For door leaf with NO BASE option see page 21

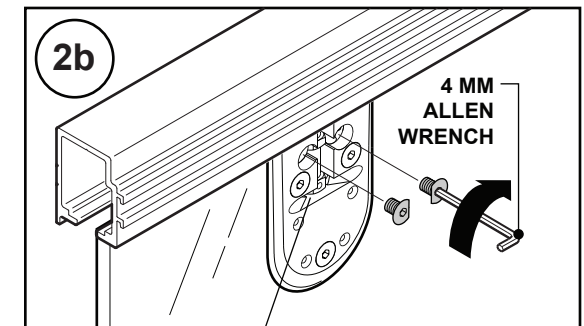
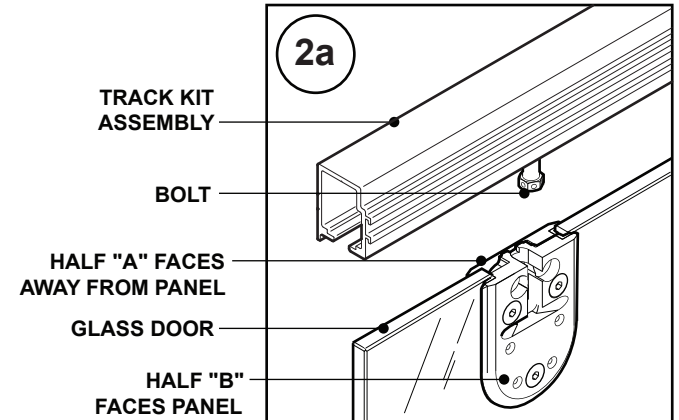
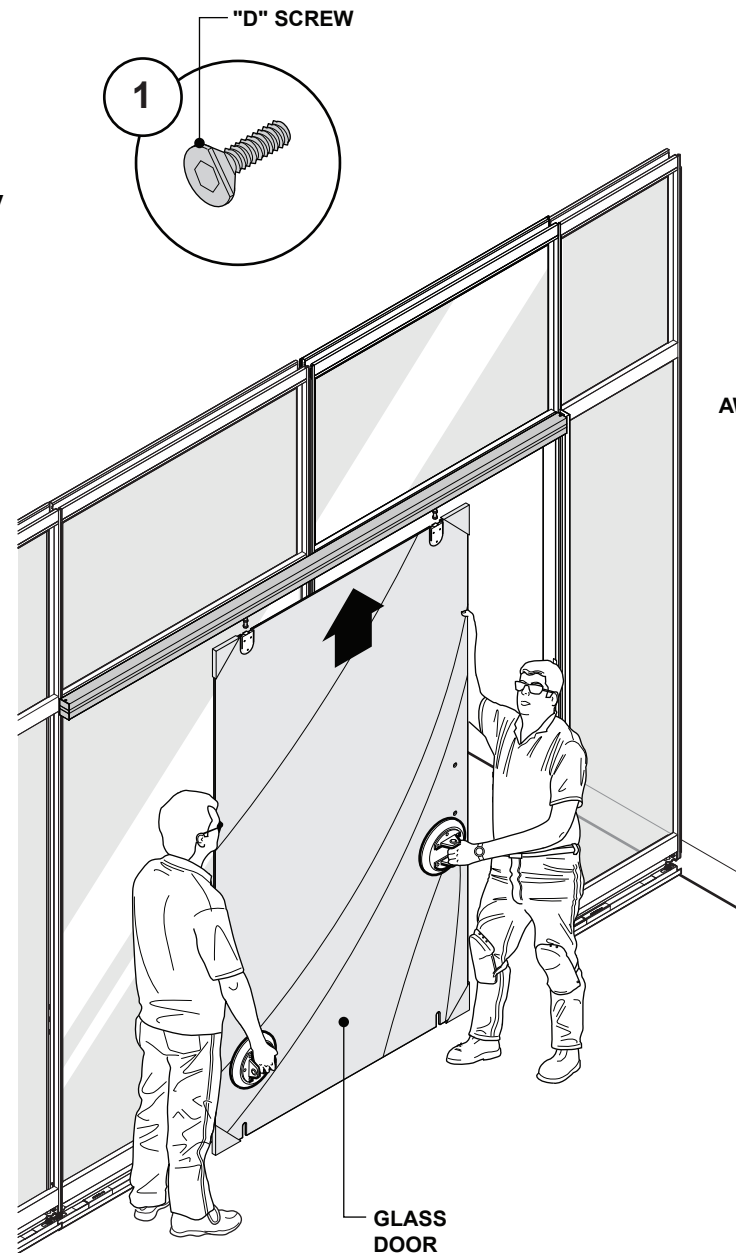

Adjustment of suspension bolt may be required to plumb door to seal.

Installing The Glass Door Assembly (continued)

3. Gently roll door closed to set the leading end closer mechanism then gently open door to door stop to set the trailing closer mechanism.

4. Adjust both stops so the door opens and closes at the correct distance.

5. Tighten the screws at stops.

Edge of door to entryway (5a).
Door should contact seal (5b).

6. Install cover caps.

7. Install track cap with #8-18 x 1/4" long truss head screw as shown.

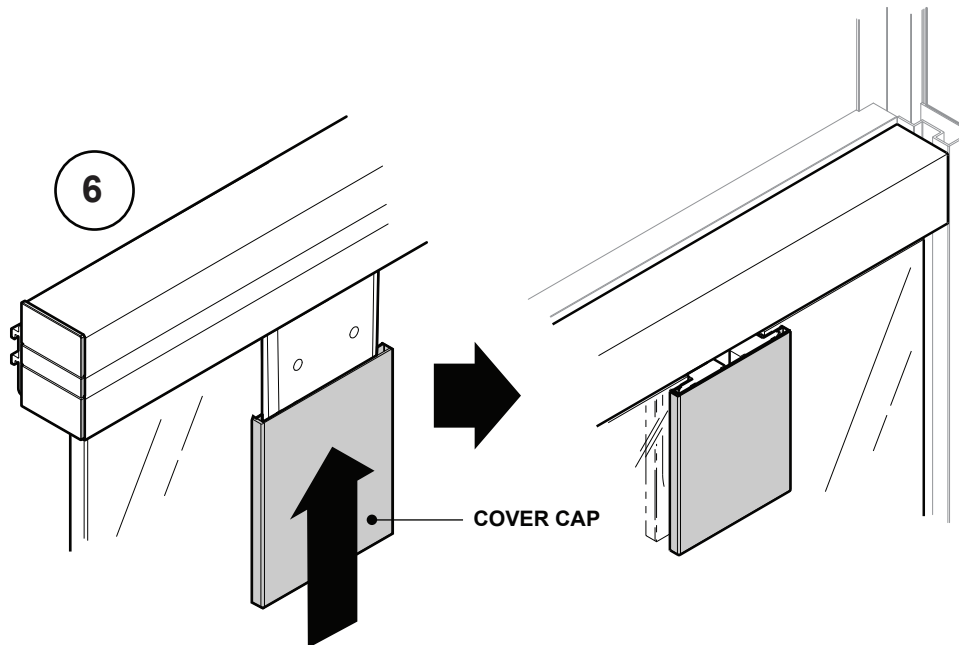
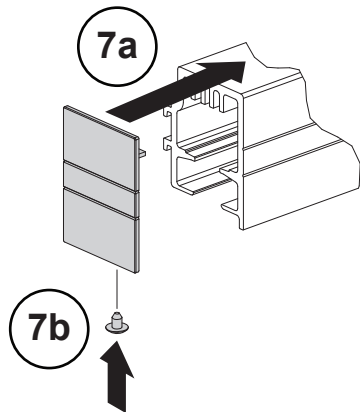
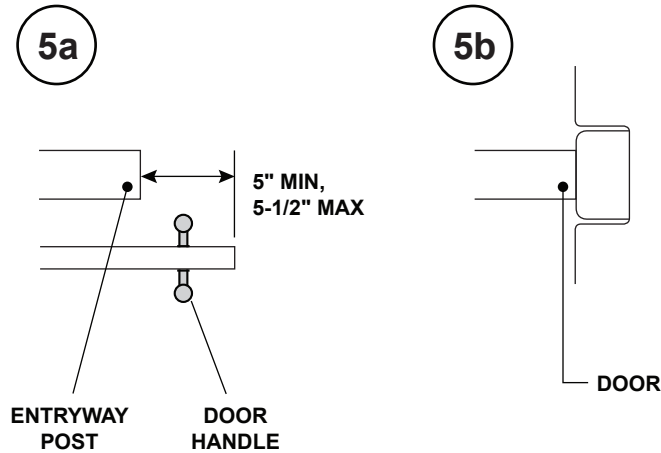

1/2" GLASS RECEIVES ONE (1) SPACER PER SIDE
 3/8" GLASS RECEIVES THREE (3) SPACER PER SIDE

5" BASE option

1. Align base rail assemblies to each side of glass door and attach using two (2) screws with Loctite 425. Only tighten screws enough to hold base rail assemblies from falling.

NOTE: For a glass thickness of 1/2" use one (1) spacer per side. For 3/8" glass, use 3 (three) spacers per side.

2. Apply light seal to the back of each base channel in the location shown.

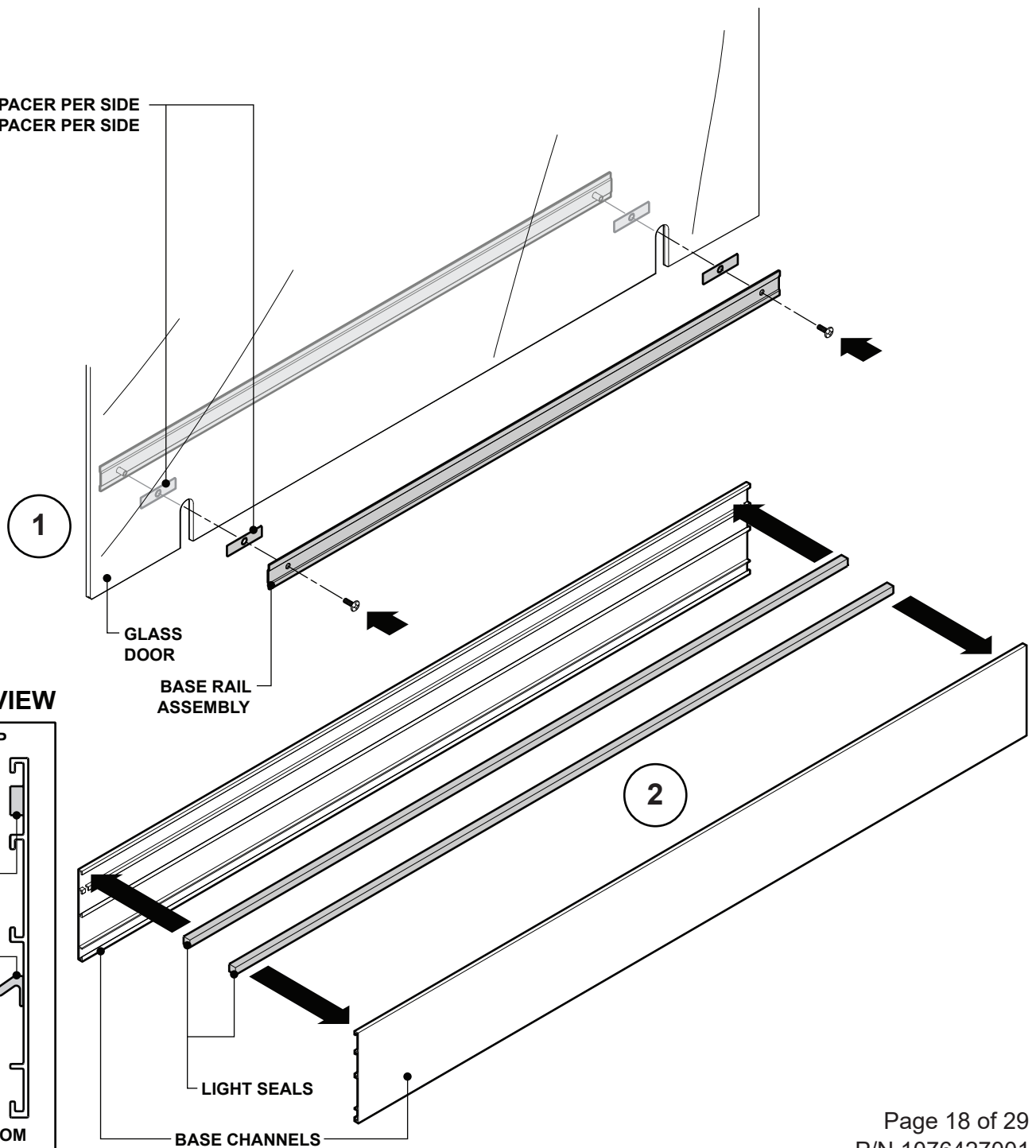
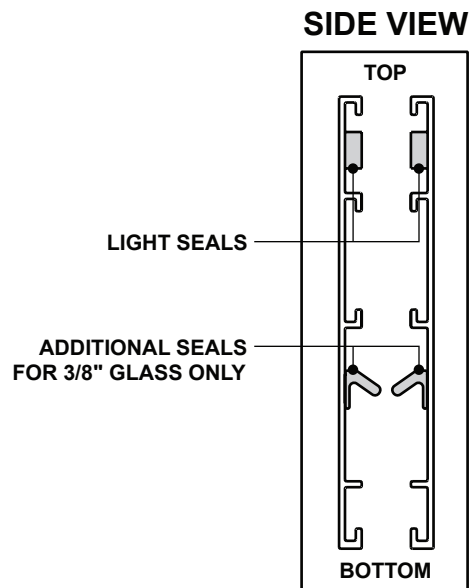

5" BASE option

3. Start by sliding the rear base channel towards the strike side (3a) while also sliding the spline channel over the slider door guide assembly (3b) and also sliding the front base channel (3c).

Advance the base channels and the spline channel until they are flush to the edge of the glass door. Align the base trim with the top of the plinth and the panel base.

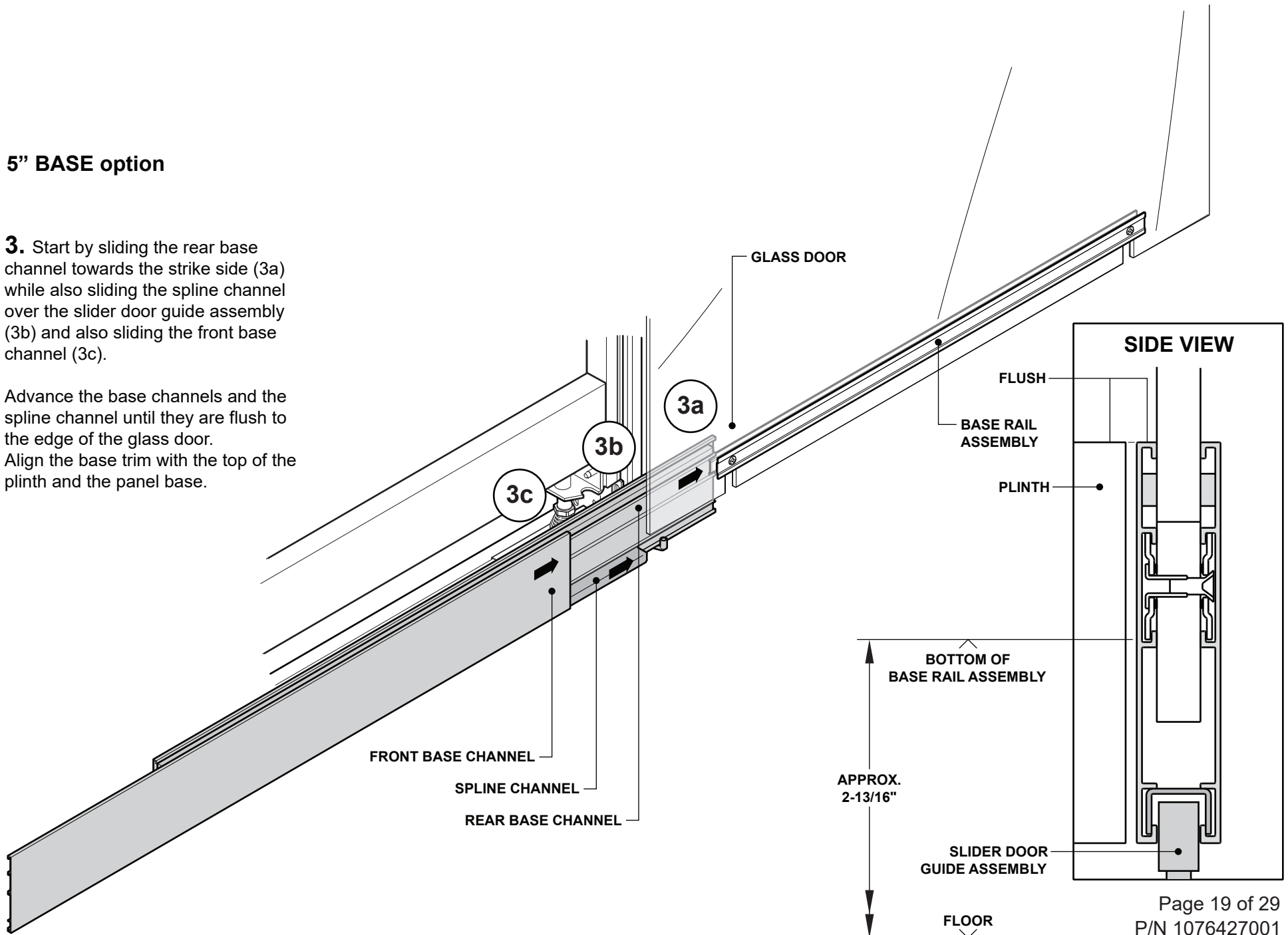

5" BASE option

4. Place base covers onto the ends of the base channels and secure with screws provided.

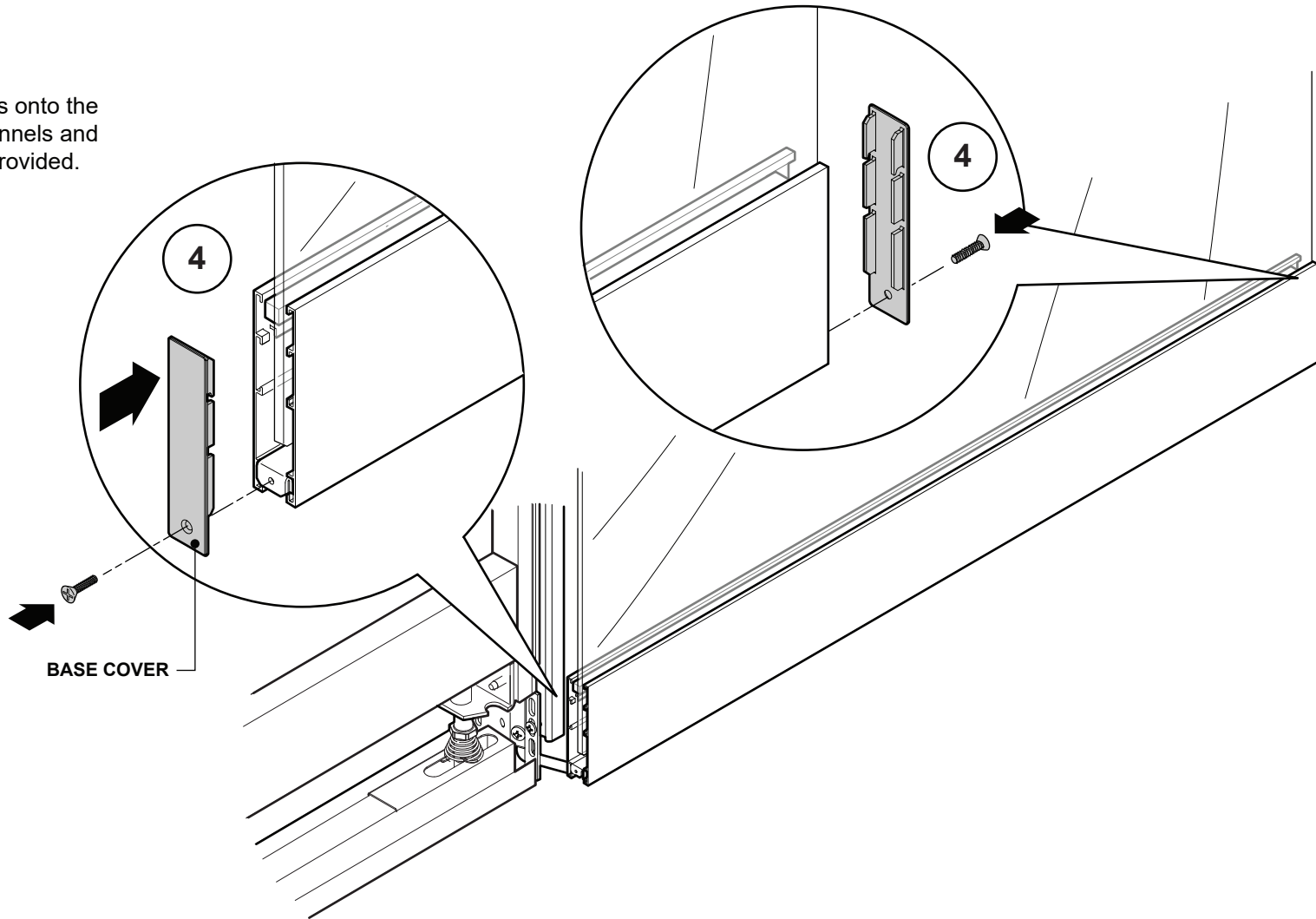

Installing the NO BASE option door guide

1. Adjust the trailing side stop bracket to the end of the track and tighten screws.
2. Prior to installing door pull or lock, open door until stop engages.
3. Determine how many spacers are required for gap shown. Position the spacers and guide as shown and use 2 #8 screws to affix to the floor. (Screw length depends on floor construction and is not provided by Steelcase.)
4. Open and close the door to insure there is clearance along the travel of the door leaf.
5. Use screws on door guide to adjust tension on the guide.
6. Readjust the trailing stop bracket per page 17.

ADJUST THE STOP TO THE END OF THE TRACK AND TIGHTEN SCREWS

1

OPEN DOOR UNTIL STOP ENGAGES

2

PLACE DOOR GUIDE NEXT TO DOOR FRAME AND USE #8 SCREWS TO FIX TO THE FLOOR (SCREWS NOT PROVIDED BY STEELCASE)

3

SPACERS

DOOR GUIDE

5

2.5" PLINTH

USE SPACERS PROVIDED TO ADJUST THE GAP BETWEEN THE TOP OF THE GUIDE TO THE BOTTOM OF THE DOOR LEAF. ALWAYS MAINTAIN AT LEAST HALF THE HEIGHT OF THE GUIDE THROAT OF ENGAGEMENT

Fix Leveler Position

1. Verify unit for plumb, square and level.
2. Adjust strike and leveler as required.
3. With countersink bit, drill hole and countersink the strike at pilot hole indicated.
4. Use #10-32 thread cutting screw to secure leveler position.

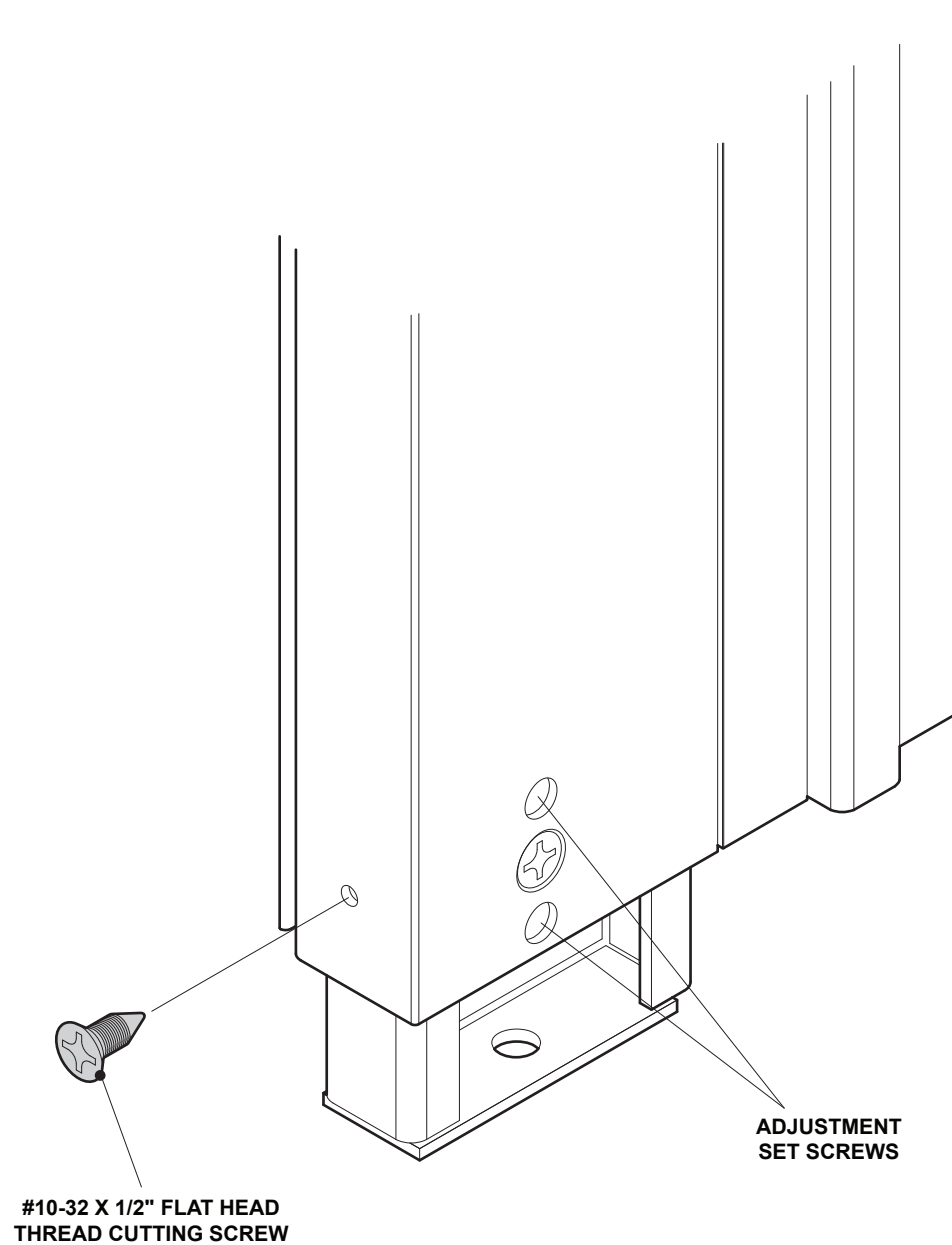
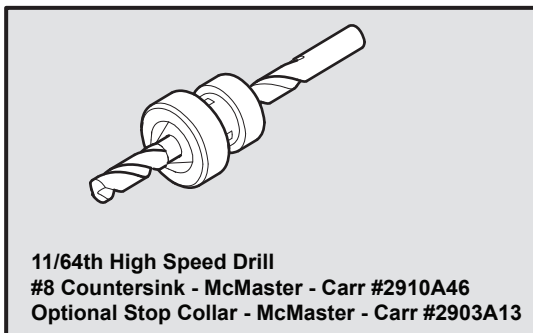

Installing Plinths

1. Install base trims.

NOTE: Per AD #9500485

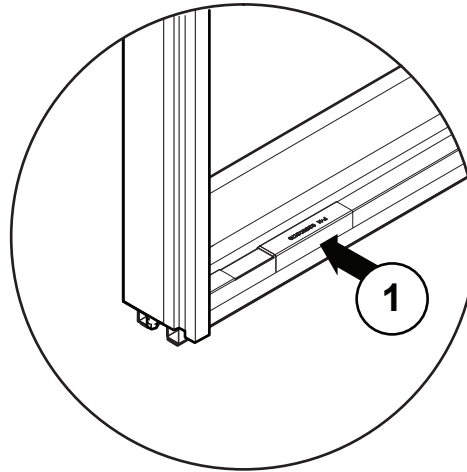
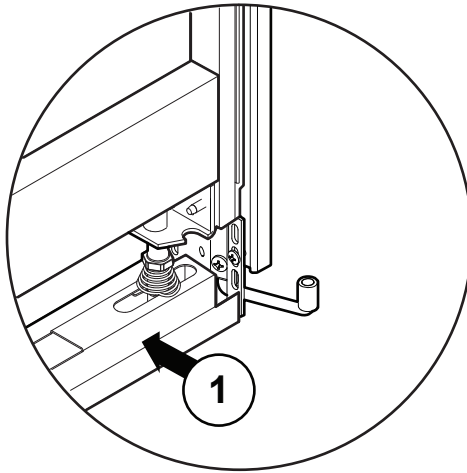

5" BASE option shown

Plinth Installation at strike side

1. Position 'L' shape strike plinth as shown.
2. Slide 'J' shape strike plinth into place.
3. Press strike plinths together to lock assembly.
4. Trim and adhere seal, flush to top of plinth.

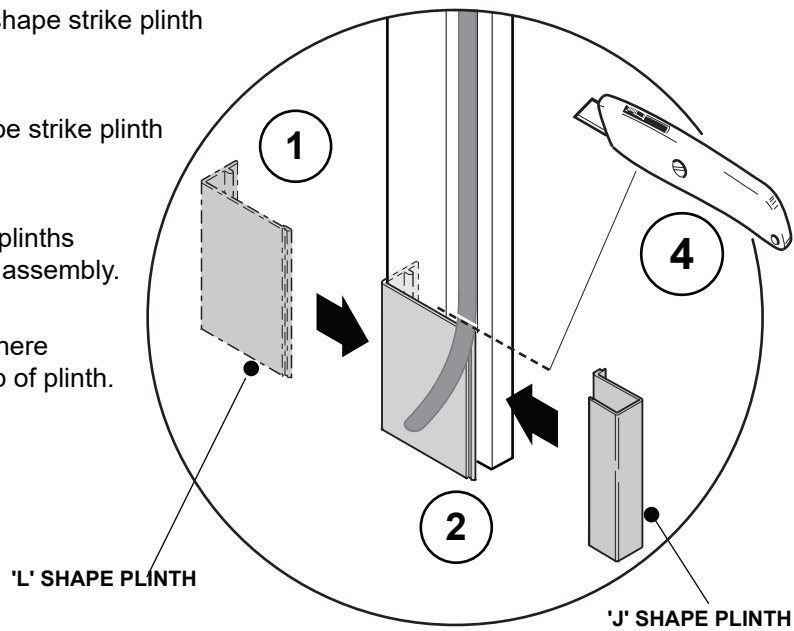

Plinth Removal at strike side

1. Pry 'L' and 'J' shape plinths apart at connection seam.

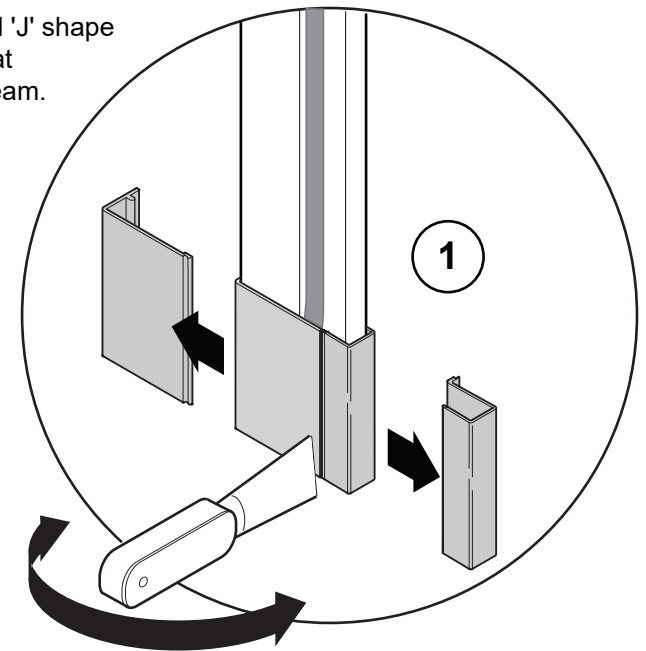

Top View - Panel Side

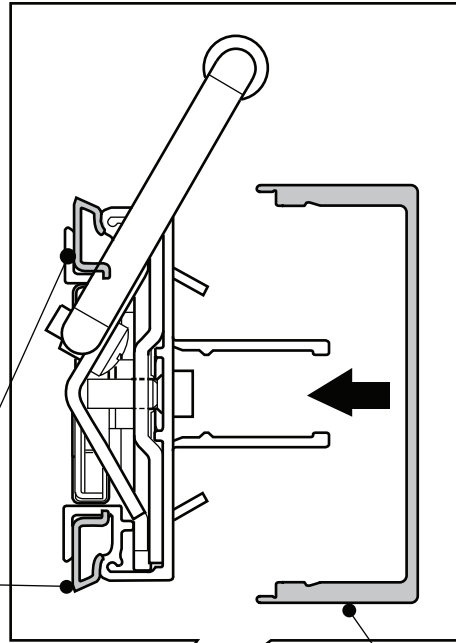

Plinth Installation at panel side

- 1.** Insert a plastic clip in each of door vertical.
- 2.** Locate and press panel plinth into place, engaging plastic clips.

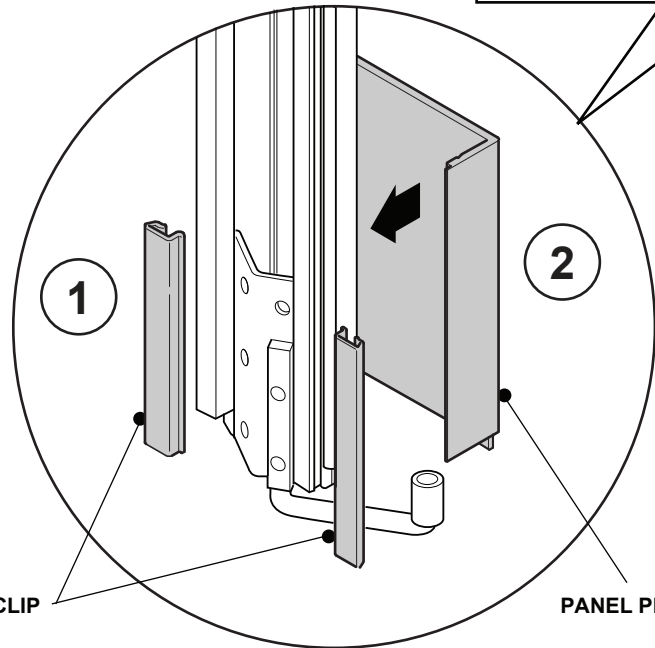

5" BASE OPTION SHOWN FOR 2.5" BASE OPTION THE J-HOOK IS NOT PRESENT.

Plinth Removal at panel side

- 1.** Slide panel plinth up from plastic clips, then pull back.

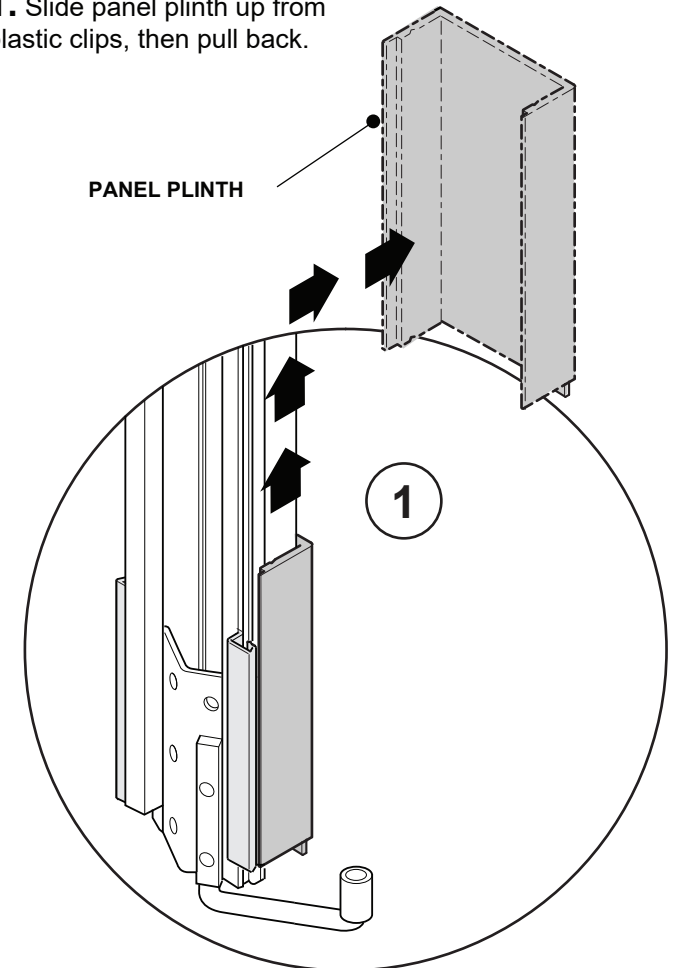

Installing the Pull Option

1. Place the two (2) spacers into the holes on the glass door.
2. Install the plastic washers, steel washers and bolts onto the handle that has the threads inside the tubes as shown.

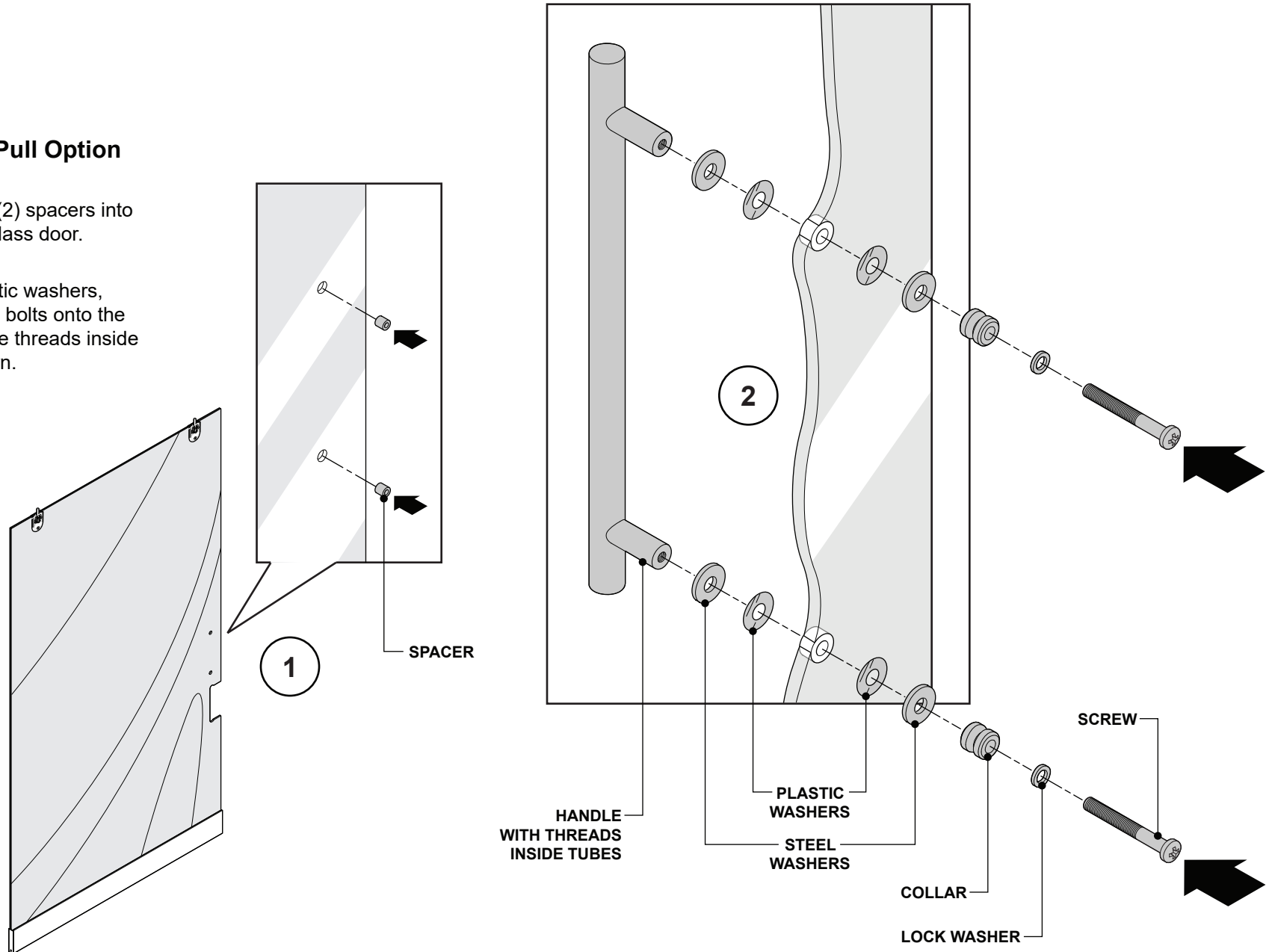

Installing the Door Handle (continued)

3. Place the handle with the clearance holes inside the tubes over the bolts.

4. Install the set screws on the upper (4a) and lower (4b) portion of the handle using Loctite 425.

NOTE: Make sure the set screws are located on the bottom of the handle, so they are not visible to the customer.

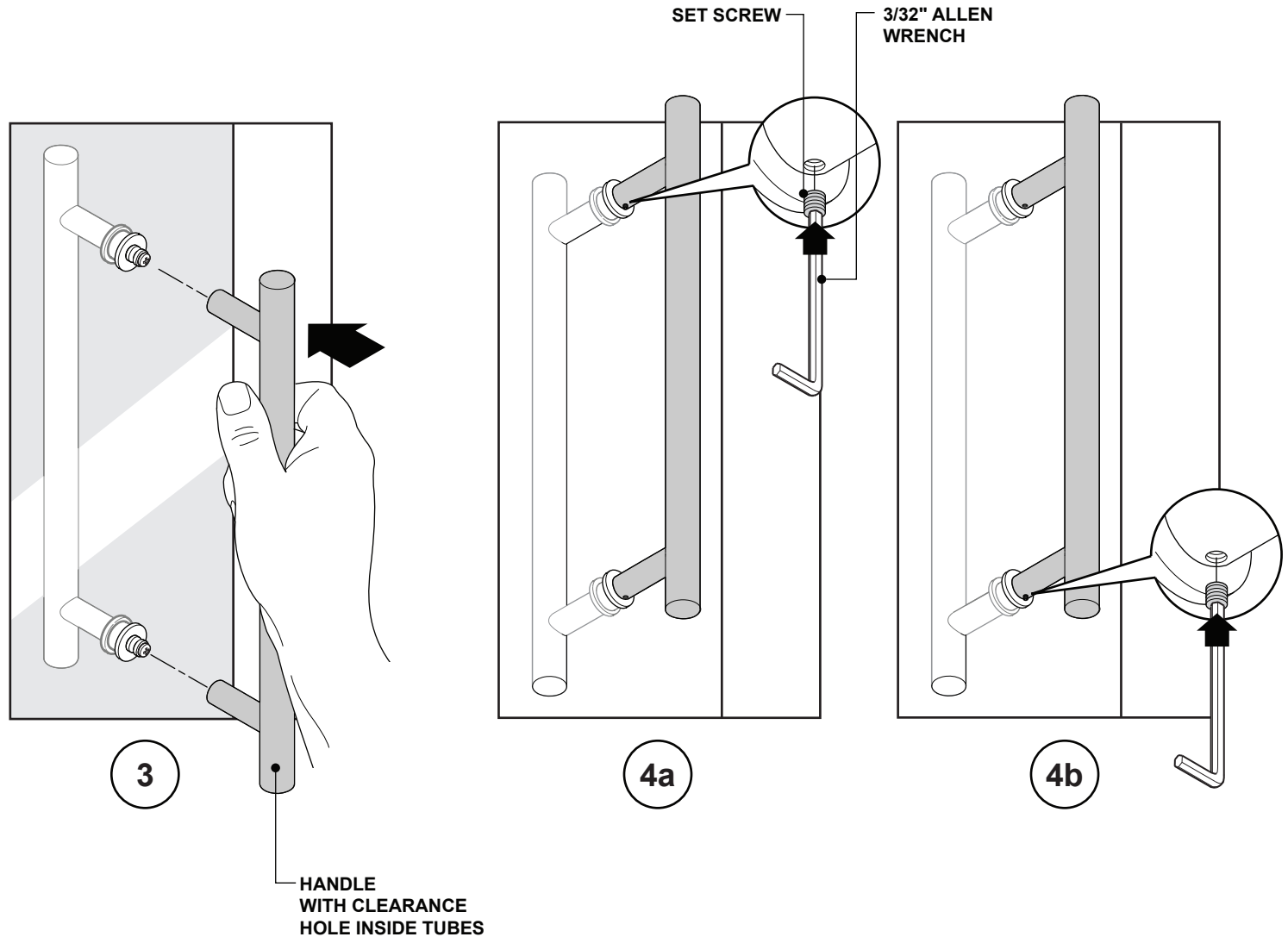

Installing the Door Lock Option

1. Place the spacer bracket onto the lock assembly and install two (2) #8-32 x 1/4" flat head machine screws. Take note of the style of the set screws. They can be flat or hex.

2. If the glass is 3/8" thick, apply a lock pad on each side of the glass around the glass cutout as shown (2a). Place the block clamps inside the glass cutout (2b), then slide the lock assembly with spacer bracket inside the pockets of the block clamps (2c).

3. Slide the lock body channel up over the lock assembly with spacer bracket and line up the top and bottom holes with the holes on the block clamps.

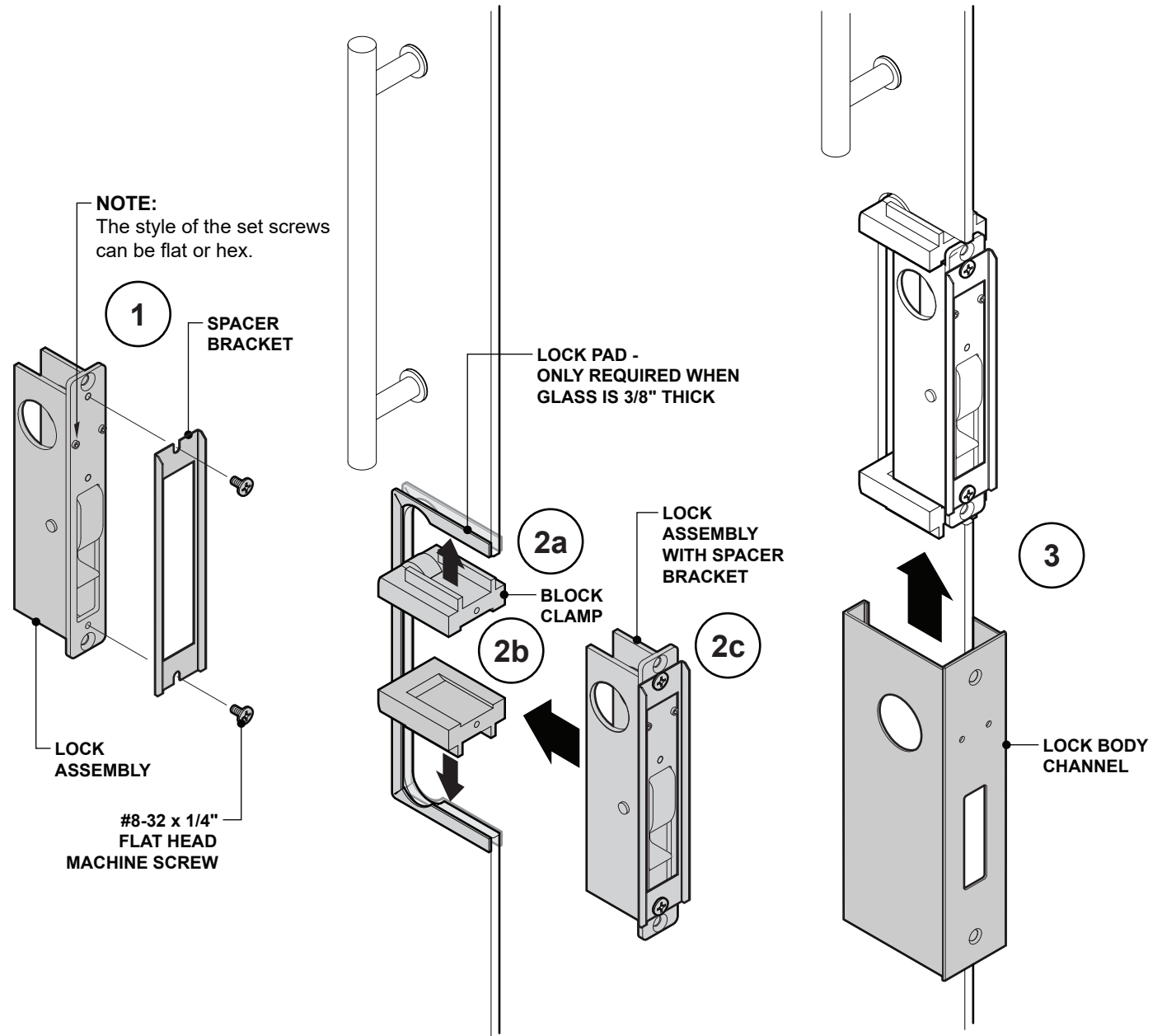

Installing the Door Lock (continued)

4. Install two (2) #8-18 x 1" flat head tapping screws.

5. Place the 11/32" wide trim ring over the key turn mortise cylinder and install outside the office. Place the 1/4" wide trim ring over the thumb turn mortise cylinder and install inside the office. Check function of lock. Tighten the set screws to lock the cylinders in place.

6. Snap four (4) lock covers onto the top and bottom of the lock body channel.

7. Place the strike plate into the hole on the vertical strike and install two (2) #10-12 x 3/4" flat head tapping screws. Make sure seal is tucked under the strike plate at the top & bottom.

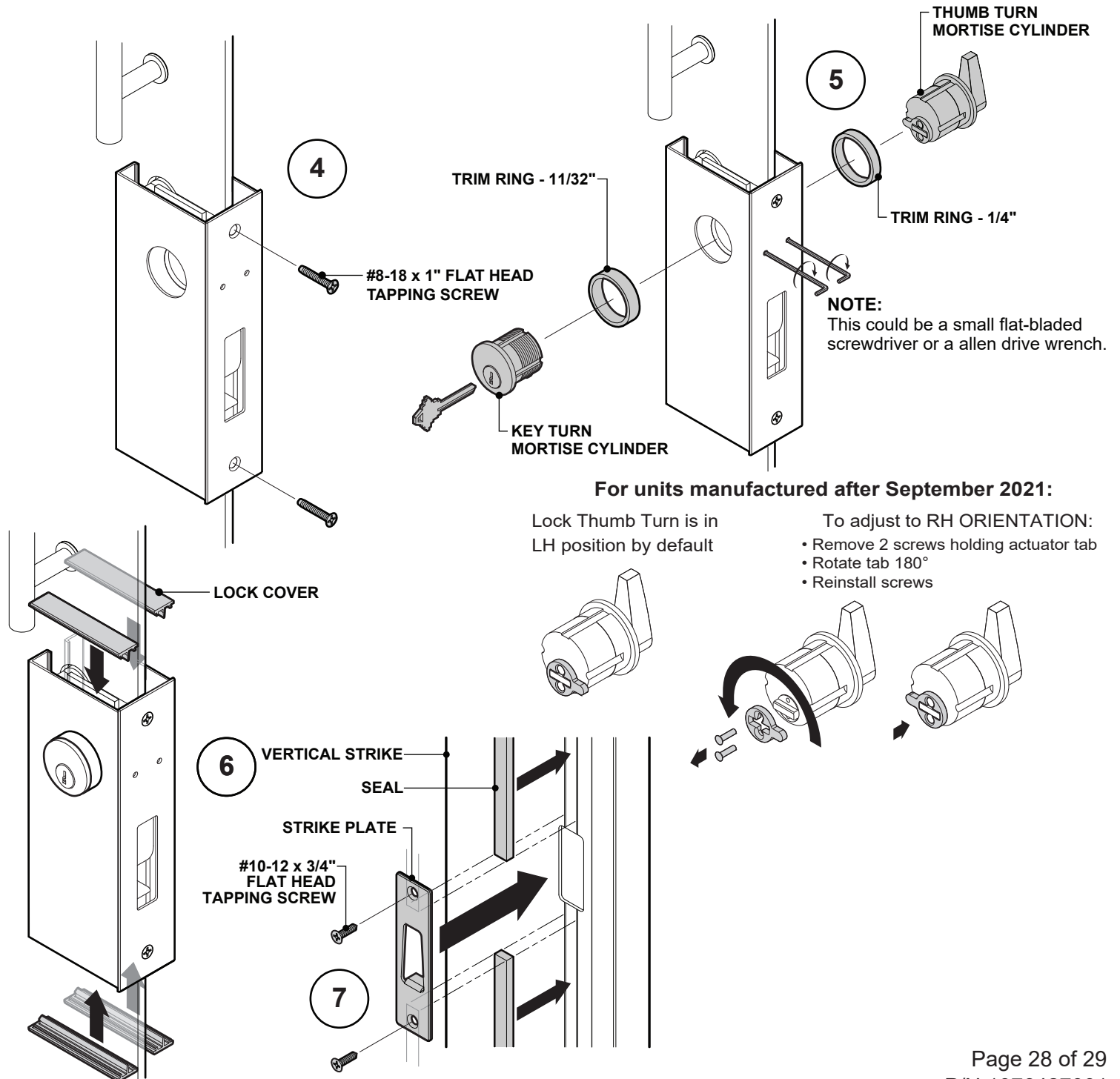

For units manufactured after September 2021:

Lock Thumb Turn is in LH position by default

- To adjust to RH ORIENTATION:
- Remove 2 screws holding actuator tab
 - Rotate tab 180°
 - Reinstall screws

Ladder Pull Handle Installation

Configurations:

- Locking and non-locking aligned
- Locking and non-locking offset

1a. Place plastic bushings into the respective mounting holes. 1 for every stanchion. Ladder pull with 2 stanchions shown.

1b. Complete the handle installation per manufacture's instructions.

Installation Dust Floor Socket "Locking Option" Only:

2. Reference manufacture's instructions.

