

**Manual de montagem**  
**Assembly instructions**  
**Instrucciones de montaje**

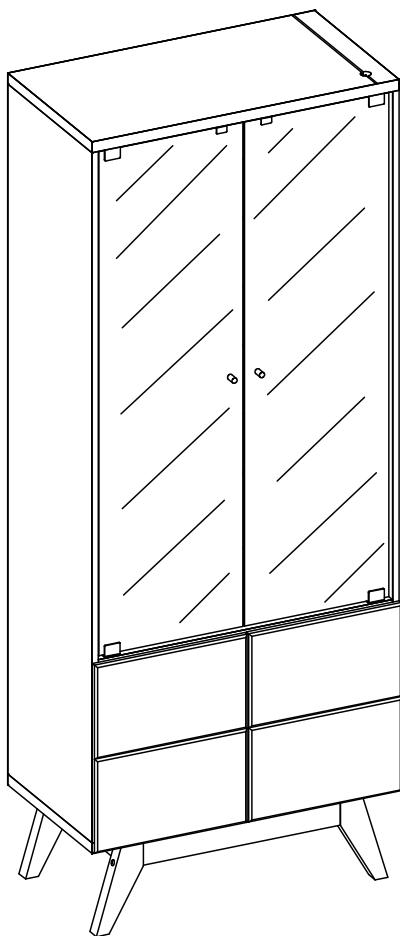

**Cristaleira Noronha**  
**1.538**





**Segurança:**

Mantém os acessórios e os plásticos da embalagem fora do alcance de crianças e animais.  
A montagem incorreta pode provocar a queda do móvel, causando e lesões e danos.

**Montagem:**

Cobrir o local de montagem com a embalagem do próprio produto.  
Separar os acessórios e peças antes da montagem.  
Seguir o manual de montagem passo a passo para garantir o correto resultado final.  
Ferramentas para montagem não incluídas.

**Limpeza:**

Não molhar o móvel e não expor em lugar úmido.  
Não expor o móvel próximo de fontes de calor.  
Limpar apenas com pano limpo e levemente úmido.



**Safety:**

Keep accessories and plastics out of the reach of children and animals.  
Incorrect assembly can cause the furniture fall causing injury and damage.

**Mounting:**

Cover the assembly space with the proper product packaging  
Separates accessories and mounting parts.  
Follow the assembly manual step by step to ensure the correct final result.  
Assembly tools not included.

**Cleaning:**

Do not wet the furniture and do not expose it in a humid place.  
Do not expose the furniture to sources of heat.  
Wipe only with a clean, slightly damp cloth.



**Seguridad:**

Mantenga los accesorios y los plásticos de embalaje fuera del alcance de los niños y los animales.  
Un montaje incorrecto puede provocar una caída del mueble provocando lesiones y daños.

**Montaje:**

Cubra el lugar de montaje con el propio embalaje del producto.  
Separa accesorios y piezas de montaje.  
Siga el manual de montaje paso a paso para asegurar el resultado final correcto.  
Herramientas de montaje no incluidas.

**Limpieza:**

No moje los muebles y no los exponga en un lugar húmedo.  
No exponga los muebles a fuentes de calor.  
Limpiar solo con un paño limpio y ligeramente humedecido.

COLIBRI - IND. COM. DE MÓVEIS LTDA.

Rua Rouxinol, 5530 - Fone/Fax (43) 3275 - 8600

Pq. Industrial XI - CEP 86.706-418 - Araçongas -PR

E-mail: [sac@colibrimoveis.com.br](mailto:sac@colibrimoveis.com.br)

Site: [www.colibrimoveis.com.br](http://www.colibrimoveis.com.br)



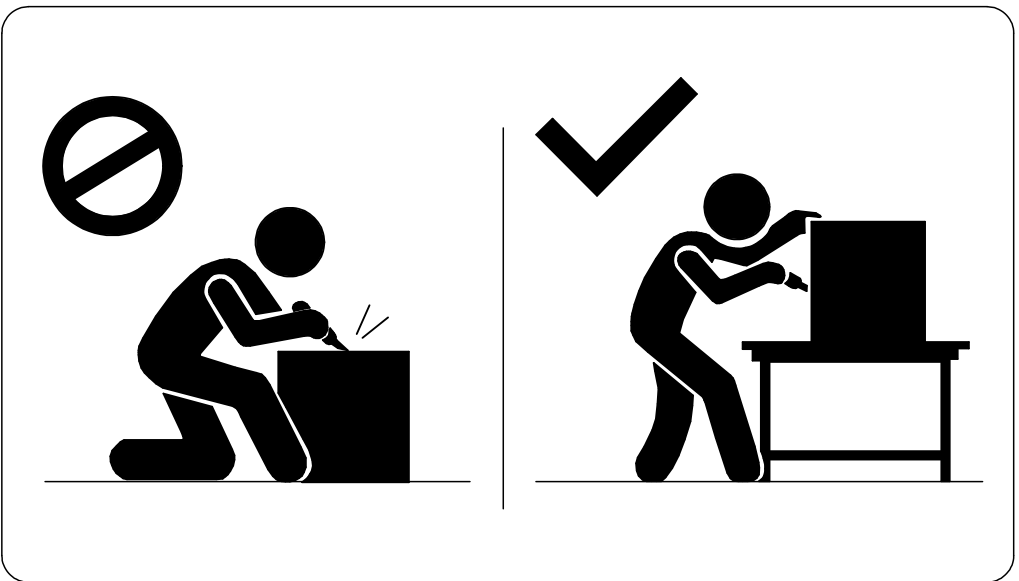
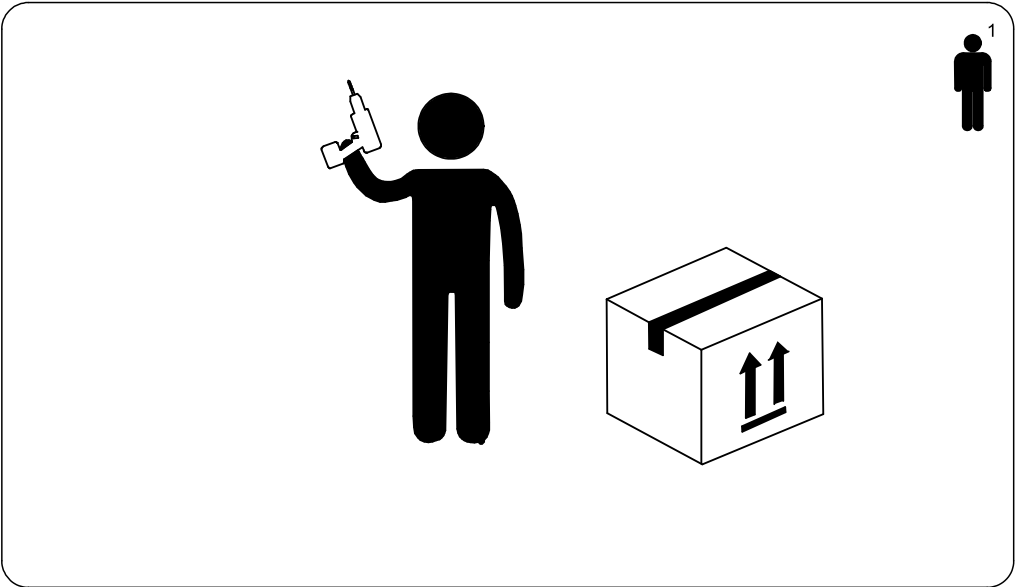
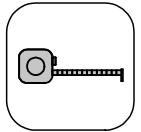
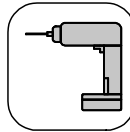
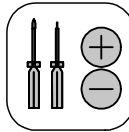
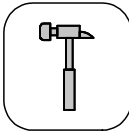
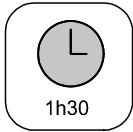



776

**A**  
55x

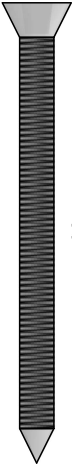

793

**B**  
04x

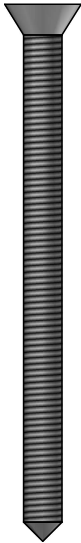

792

**C**  
08x



162

**D**  
16x



949

**E**  
20x

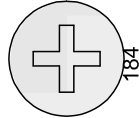

184

**F**  
16x



163

**G**  
04x

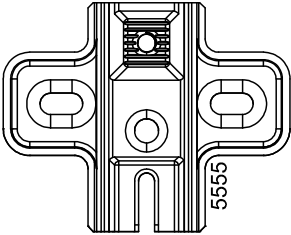

5555

**H**  
04x

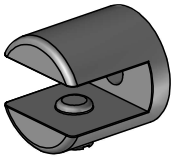

182

**I**  
12x

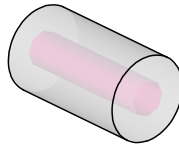

7057

**J**  
02x

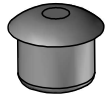

6529

**K**  
04x

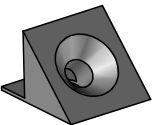

150

**L**  
23x

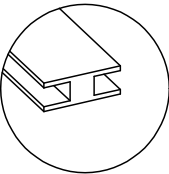

**M**  
04x

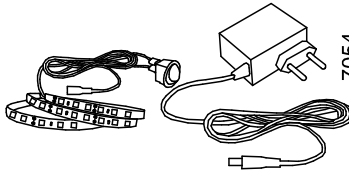

7054

**N**  
01x

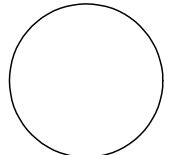

**O**  
12x



**P**  
02x

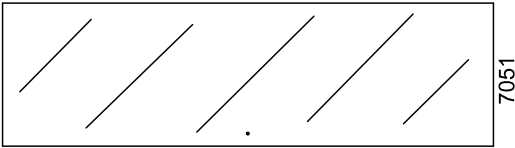

**Q**  
02x

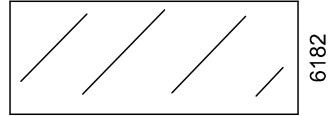

**R**  
03x

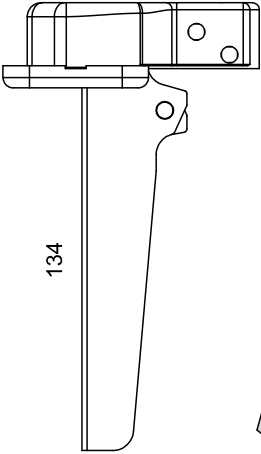

**S**  
04x

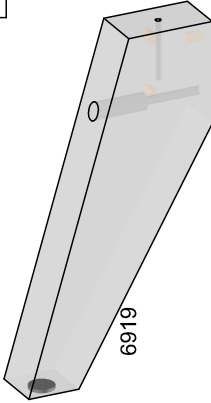

**T**  
02x

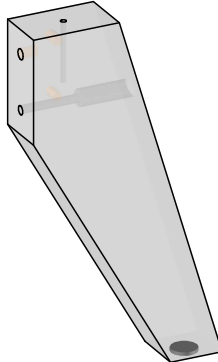

**U**  
02x



**V**  
02x

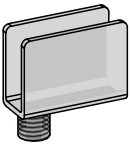

**W**  
02x

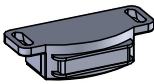

7059

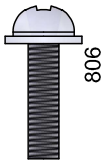

**X**  
02x



**Y**  
01x

## 1.538.A0

Cód.	Peças	Piece	Pieza	Qtd.
01	Chapéu	Hat	Sombrero	1
02	Prateleira	Shelf	Estante	1
03	Base	Base	Base	1
04	Lateral esquerda	Left side	Lado izquierdo	1
05	Lateral direita	Right side	Lado derecha	1
06	Porta	Door	Puerta	2
07	Fundo superior	Top bottom	Fondo superior	3
08	Fundo inferior	Bottom bottom	Fondo inferior	2
09	Trava frontal	Front lock	Bloqueo frontal	1
10	Trava traseira	Rear lock	Cerradura trasera	1
11	Trava lateral	Side lock	Bloqueo lateral	2
Q	Porta de vidro	Porta de vidro	Puerta de vidrio	2
R	Prateleira de vidro	Glass shelf	Estante de cristal	3

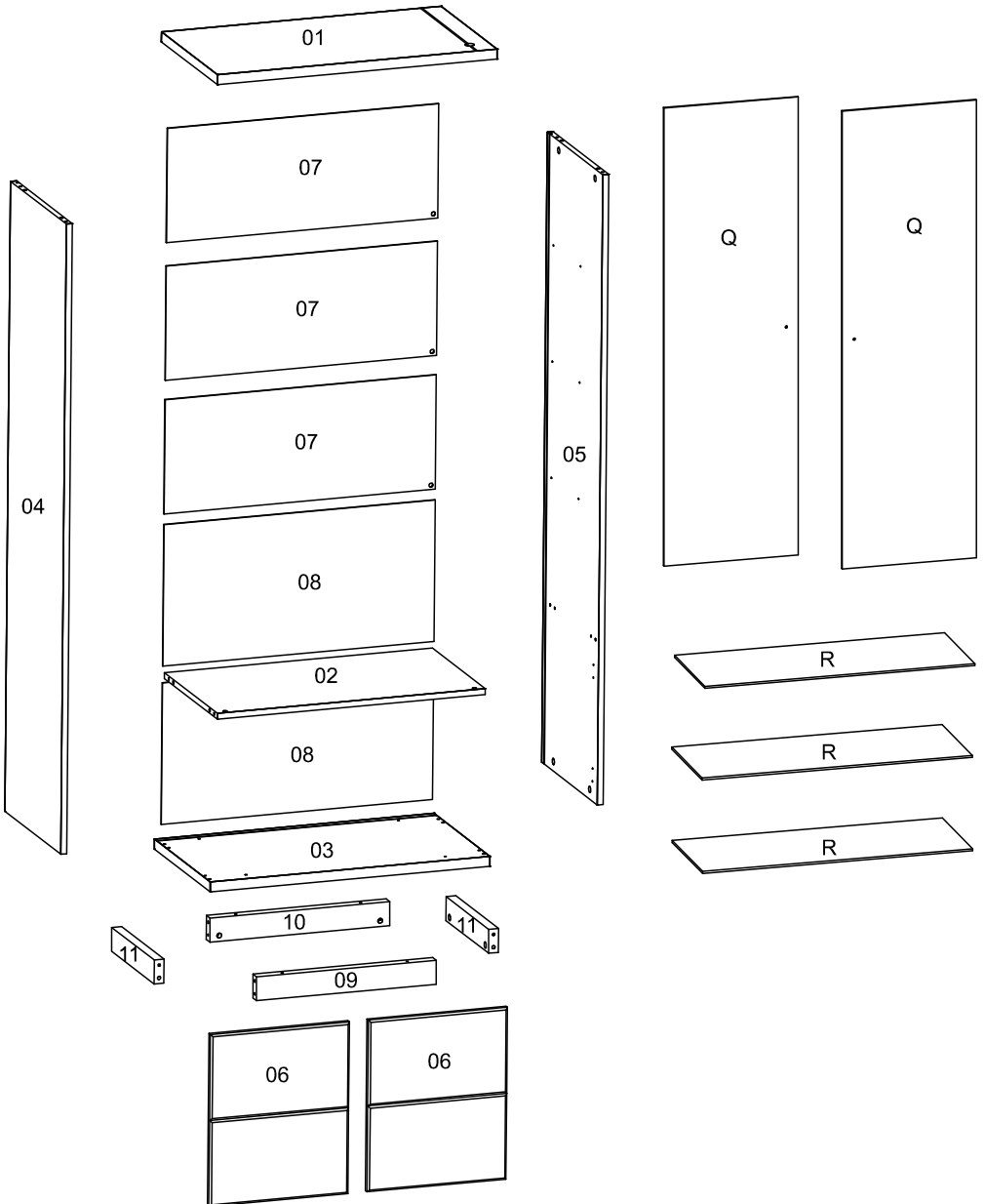

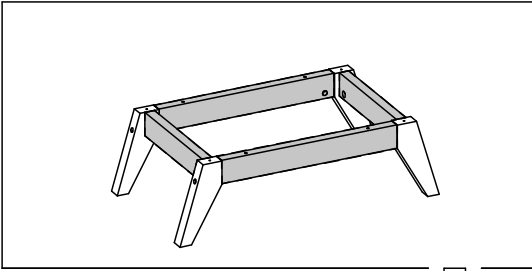

01

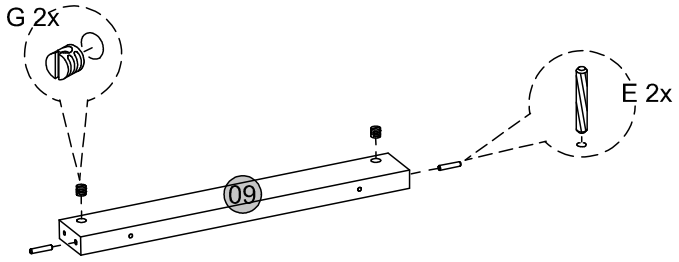

02

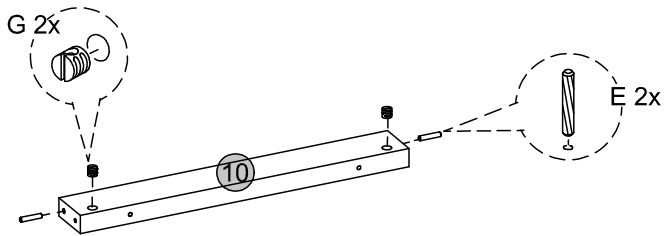

03 x2

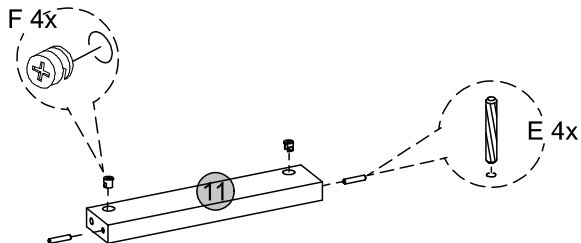

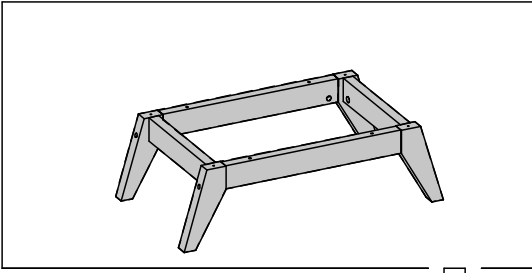

04

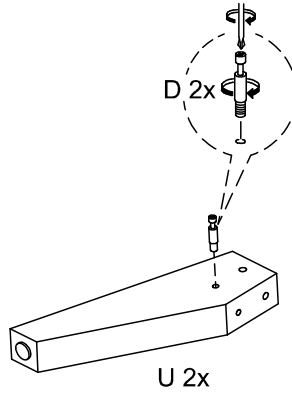
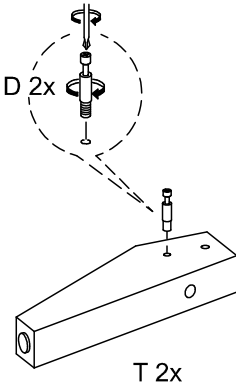

05

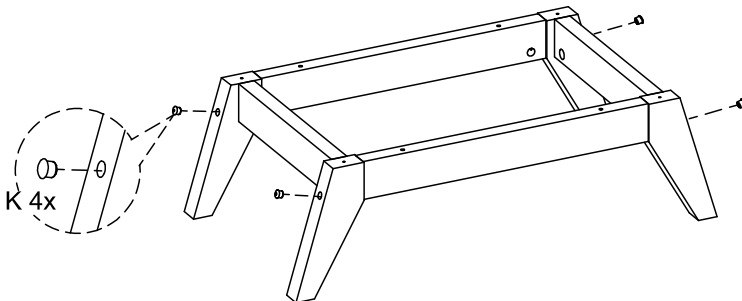
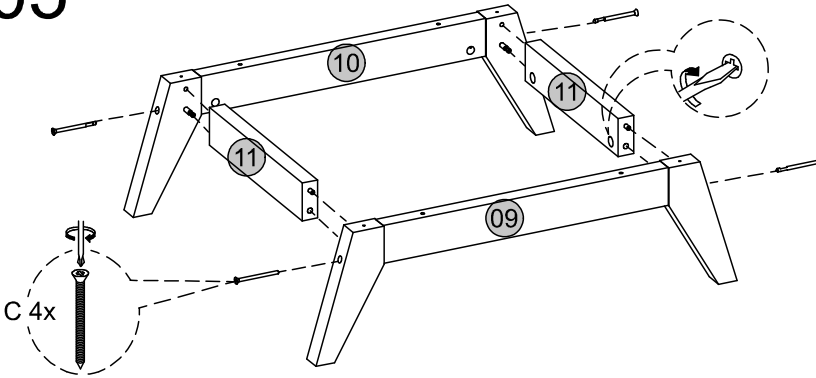

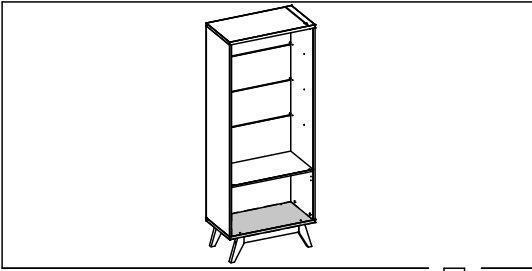

06

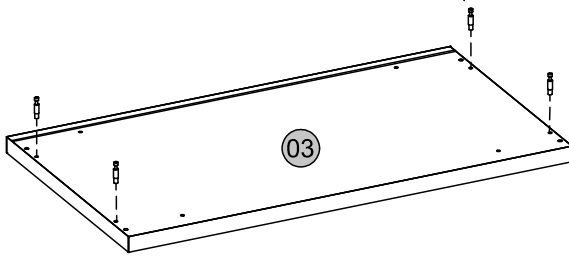
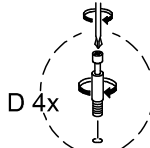

07

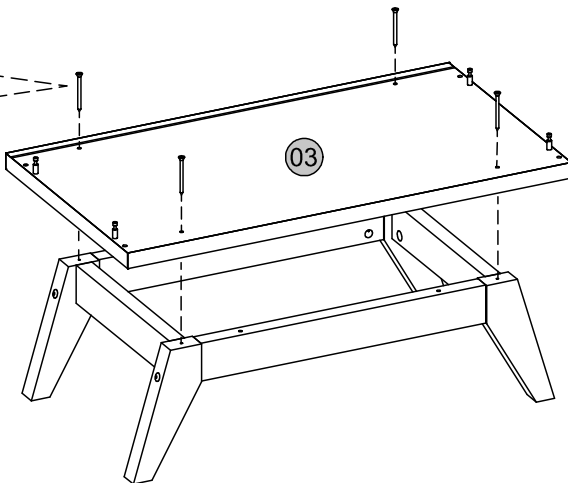
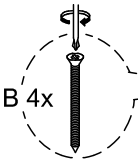

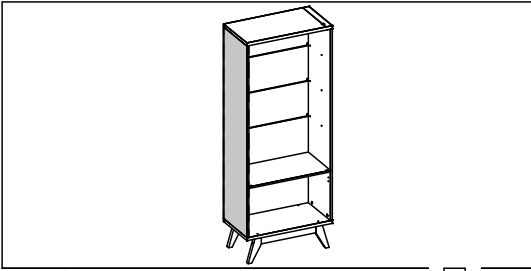

08

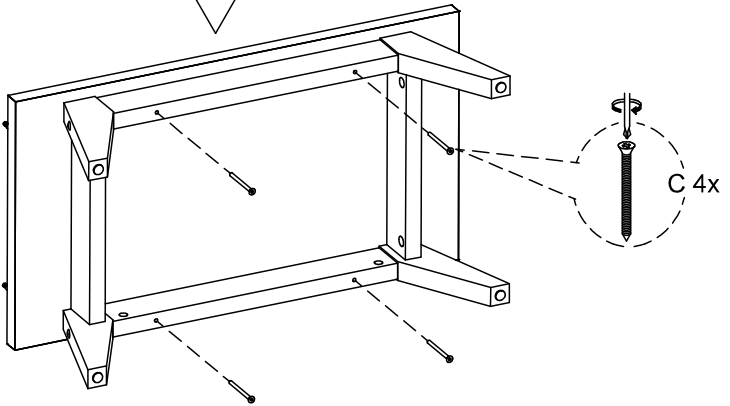

09

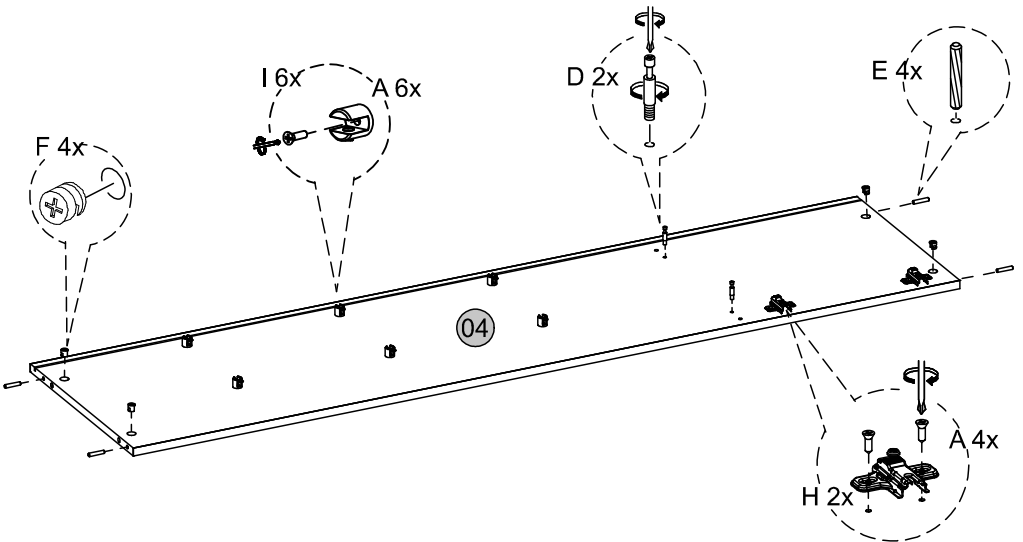

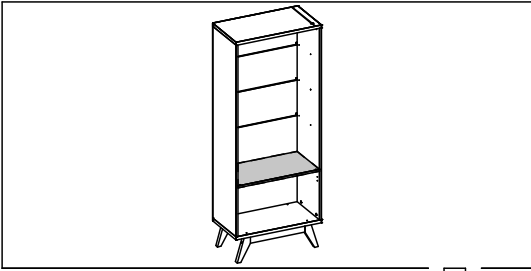

10

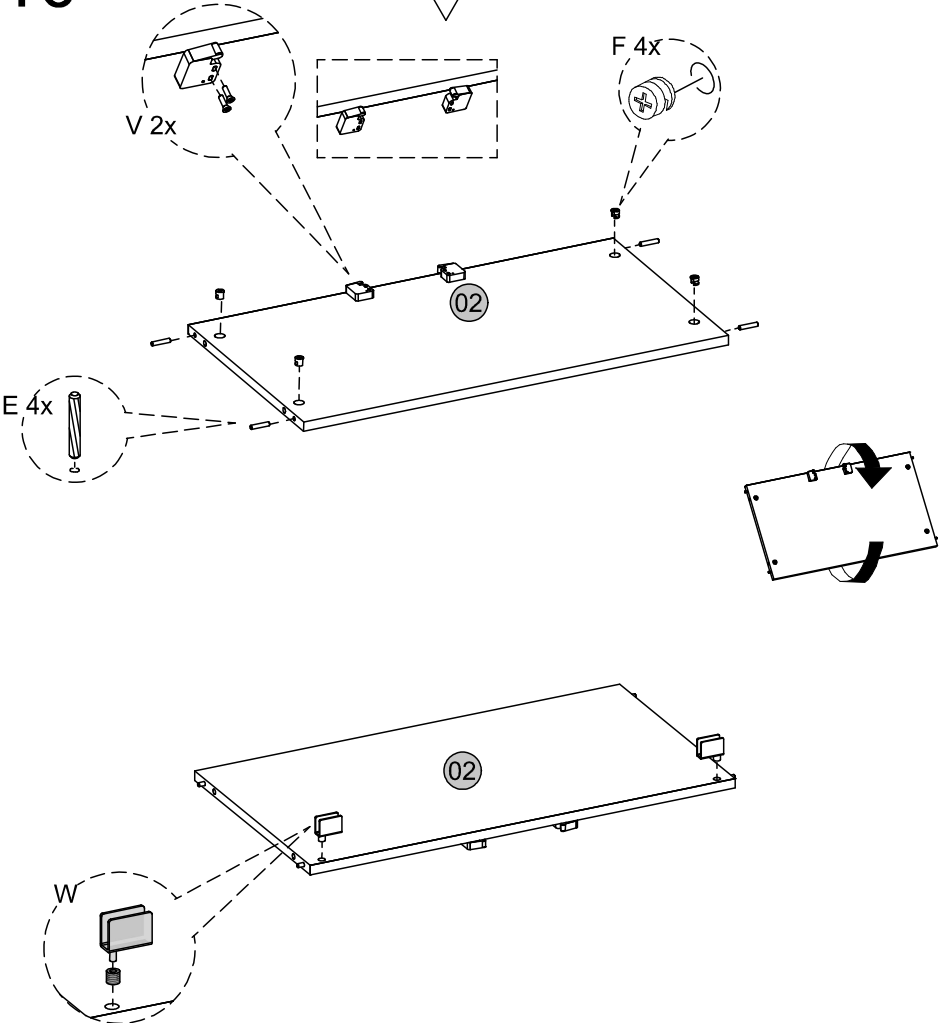

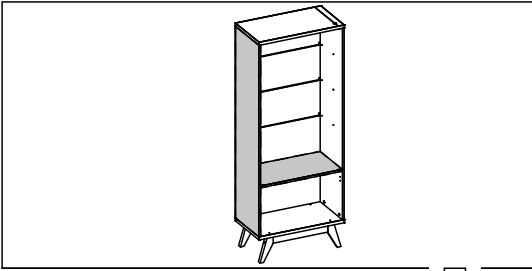

11

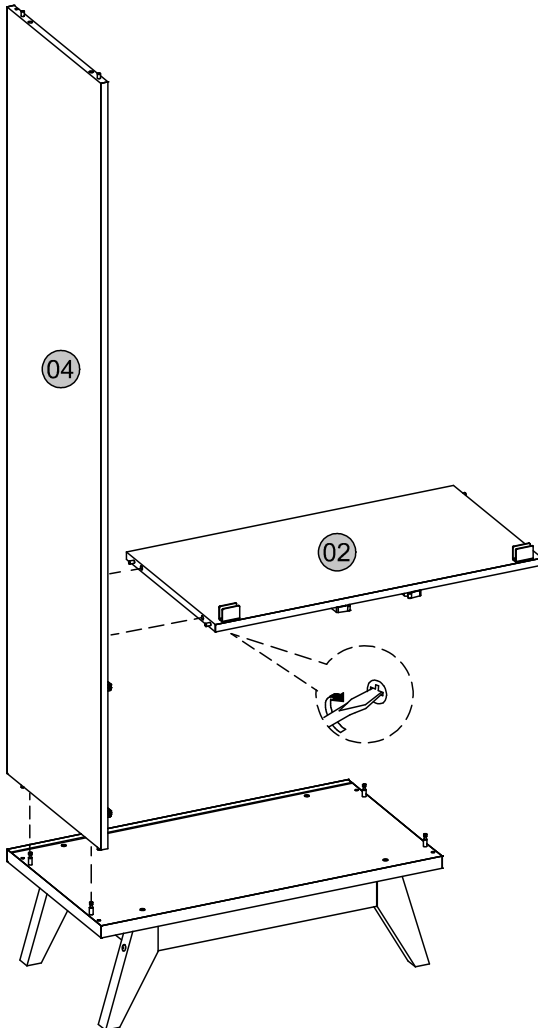

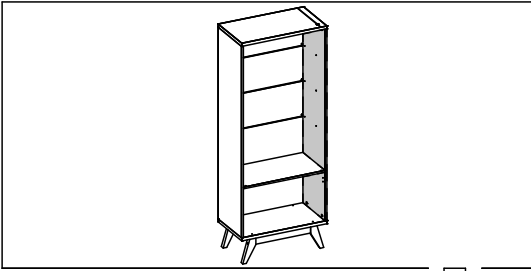

12

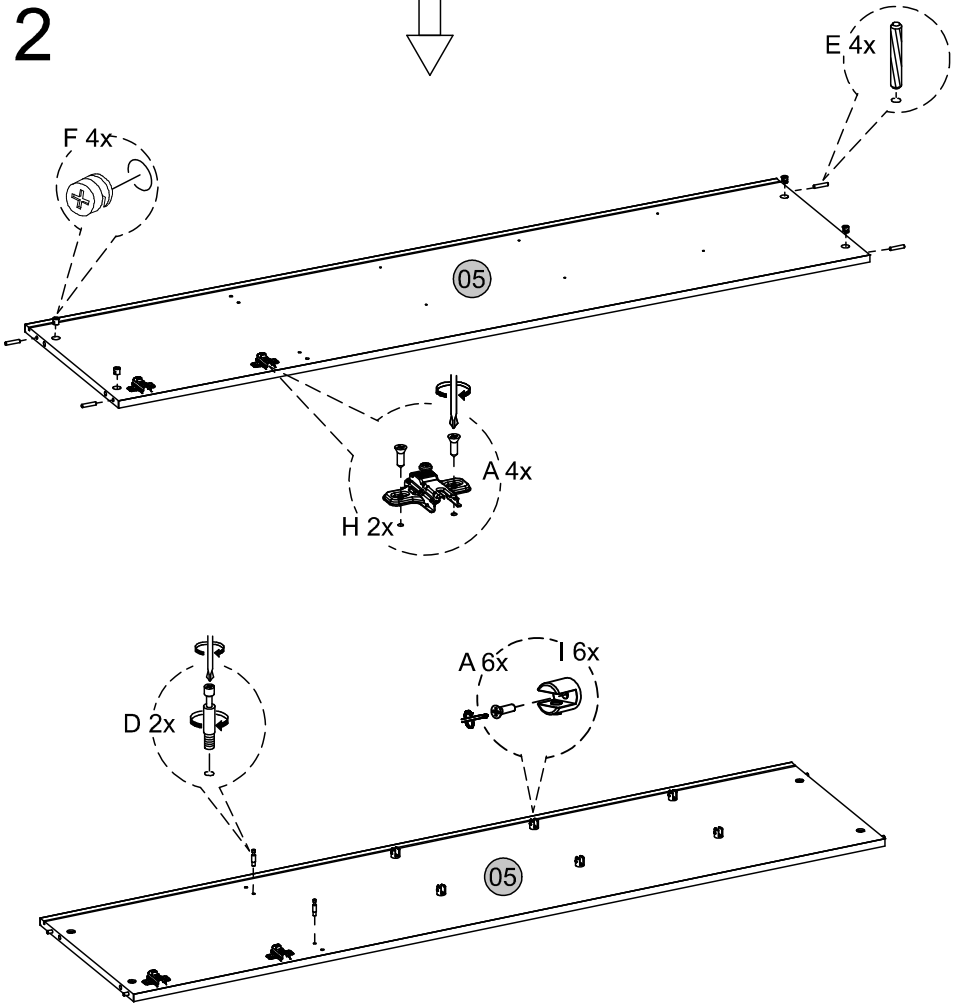

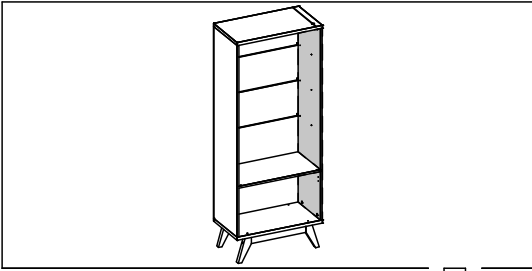

13

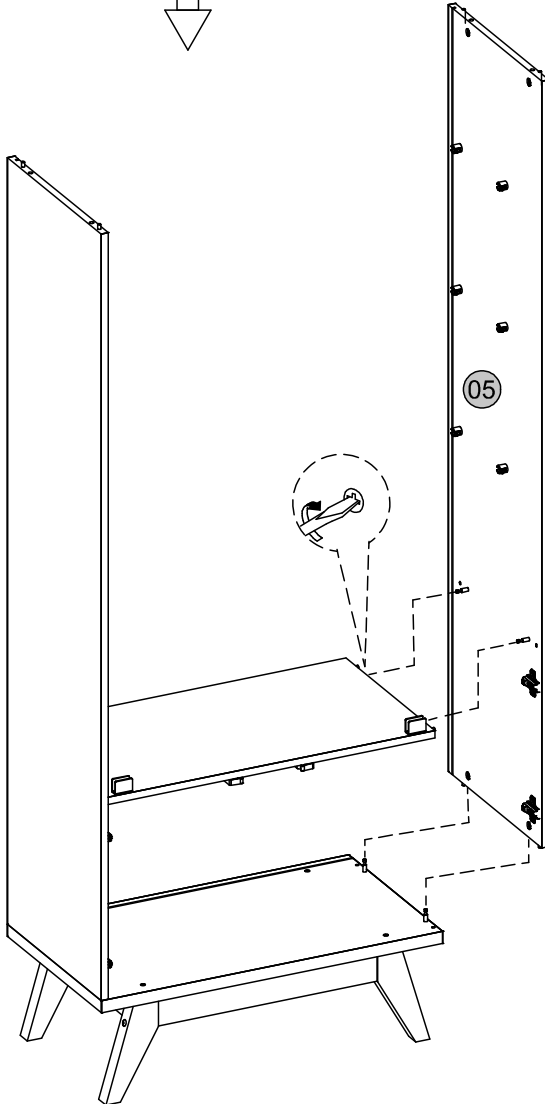

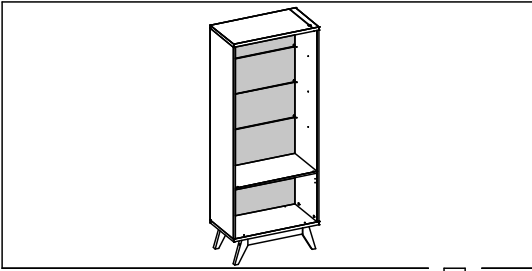

14

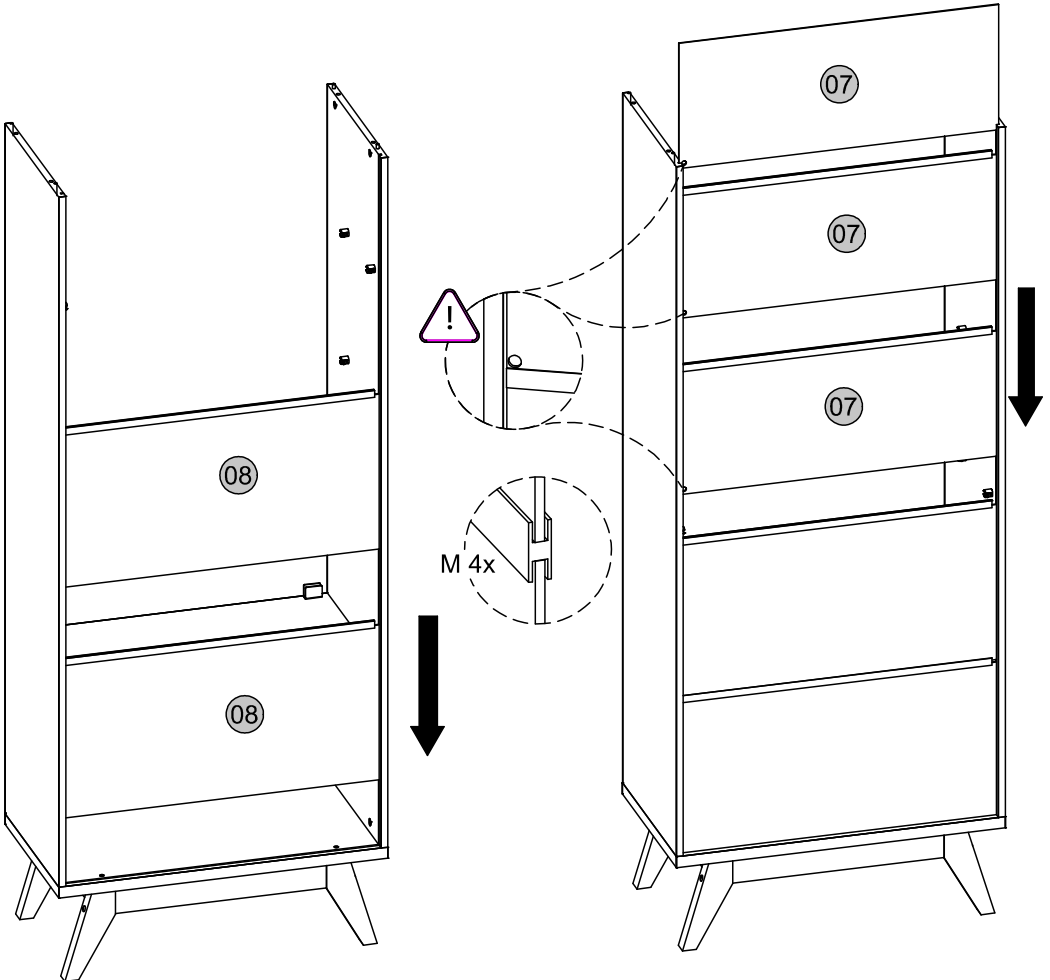

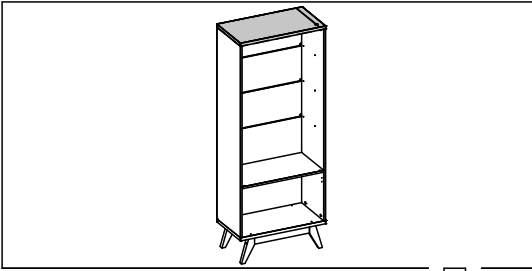

15

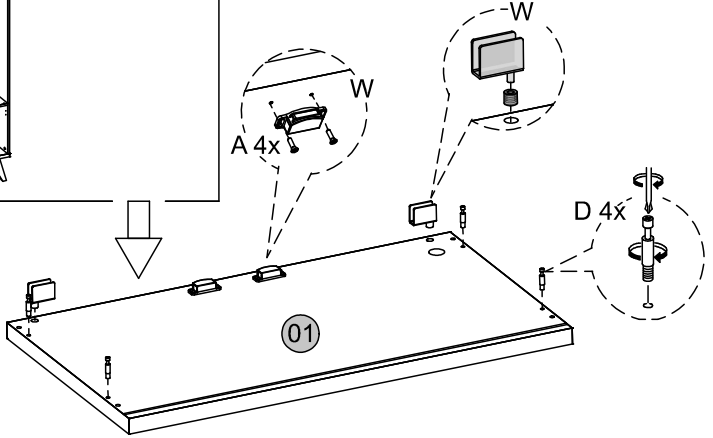

16

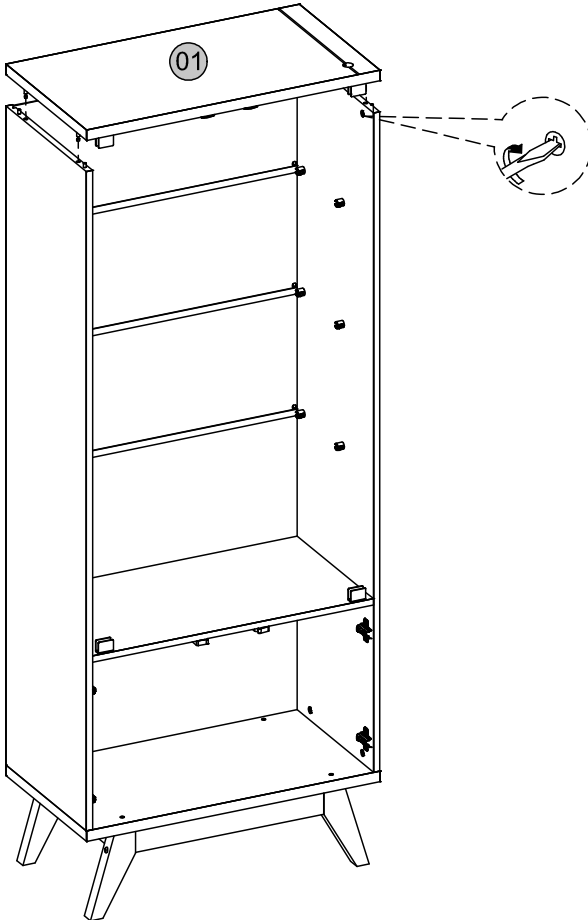

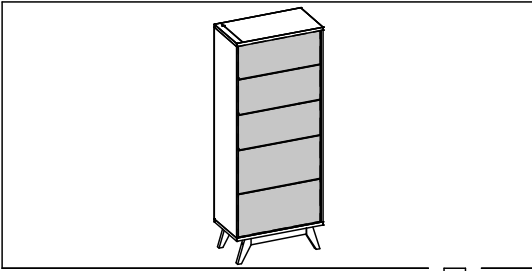

17

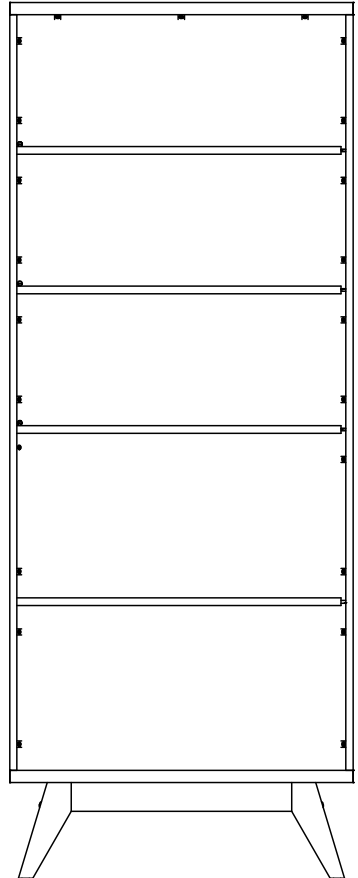
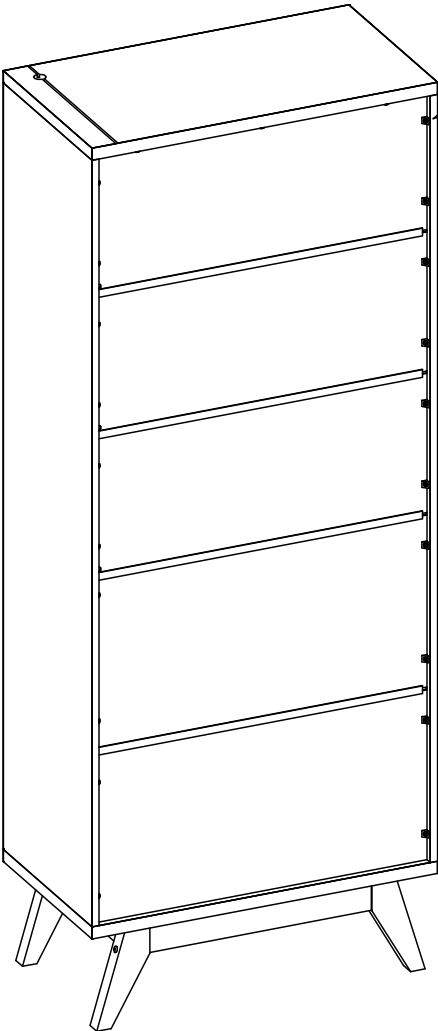
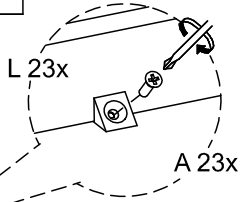

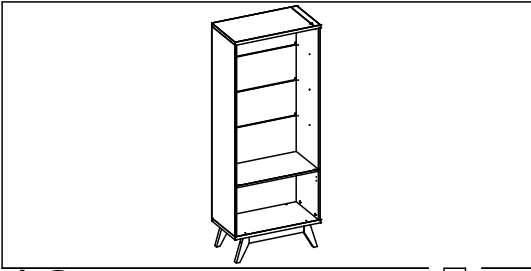

18

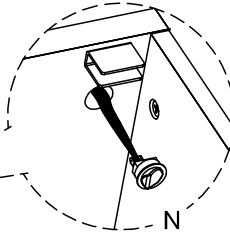
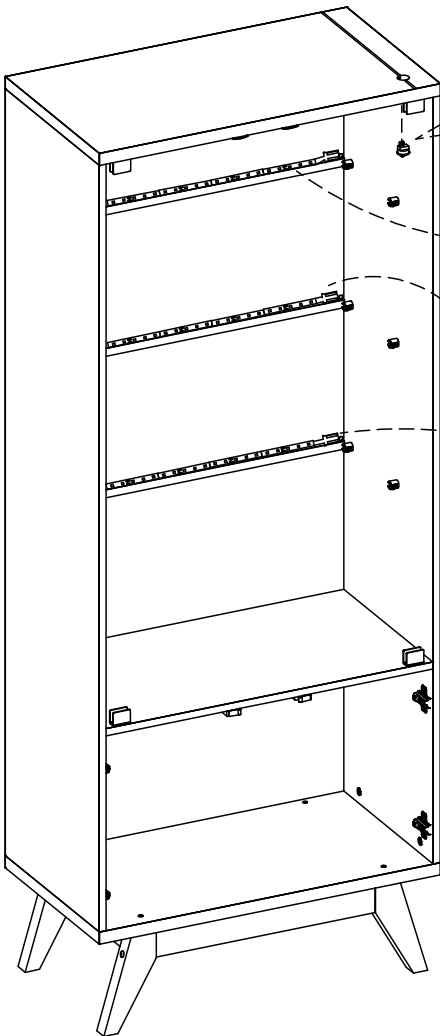

ATENÇÃO  
Led Adesivo

Attention!  
Led sticker  
Atención!  
Pegatina led

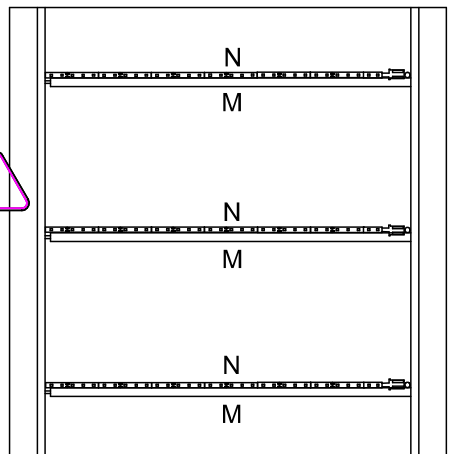
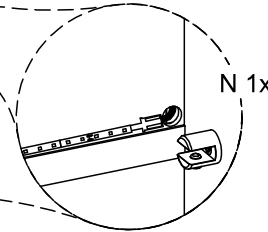

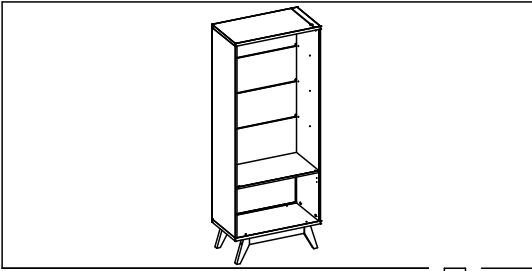

19

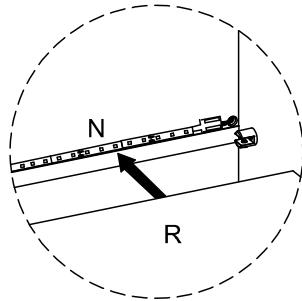
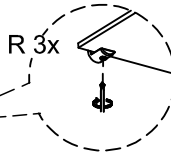
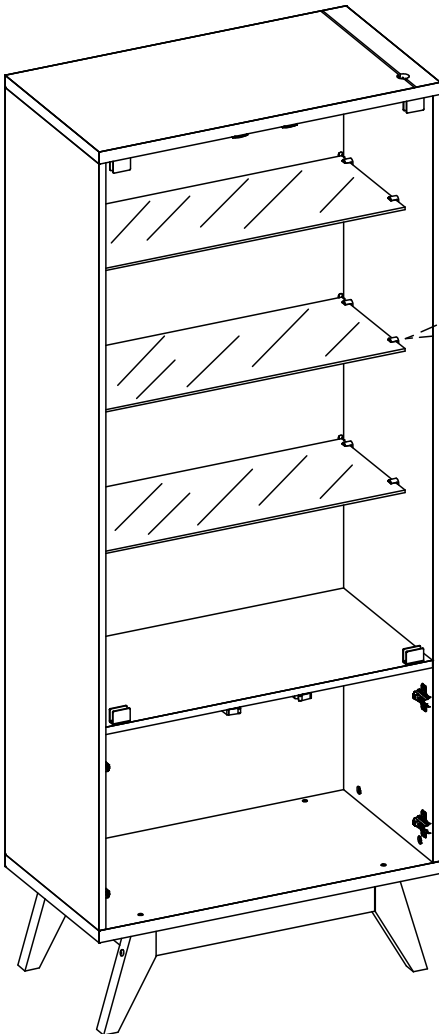

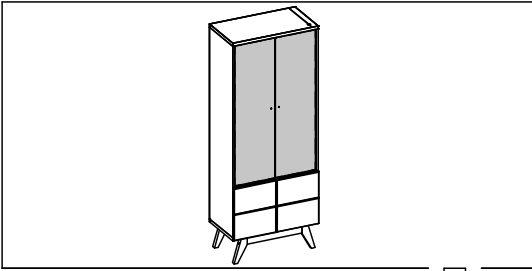

20 x2

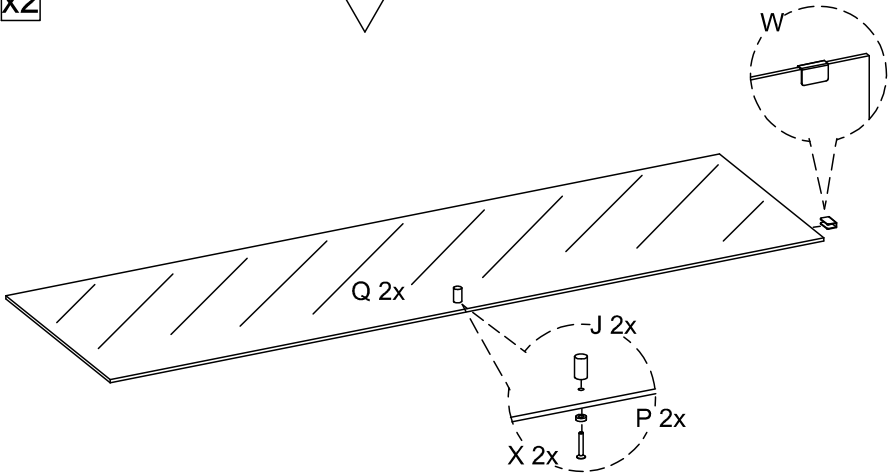

21 x2

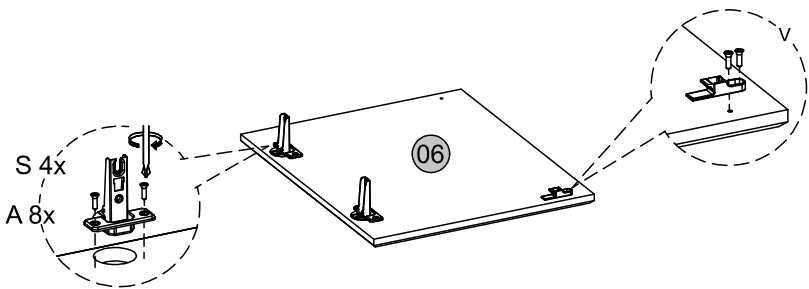

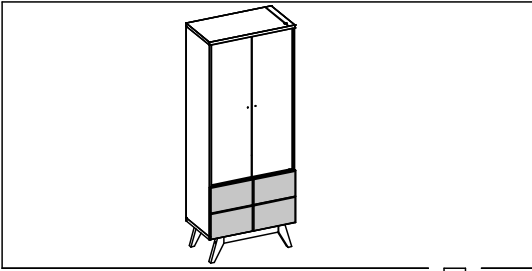



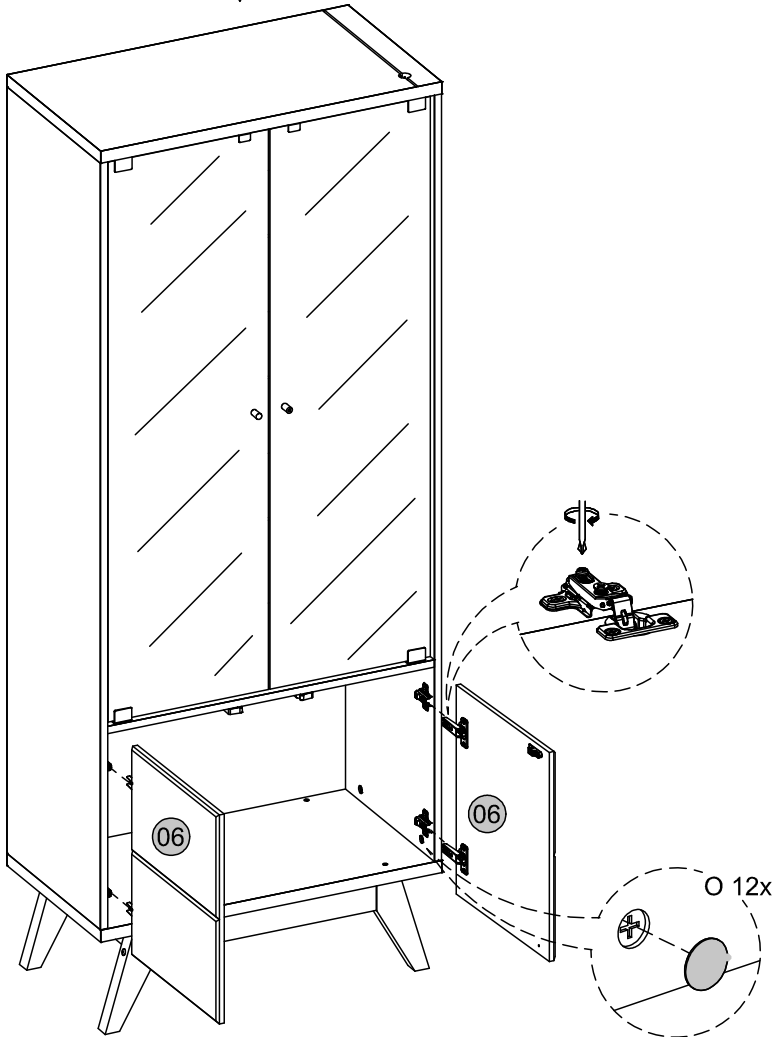



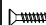
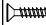











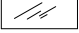
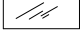

22

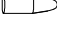

Num.	Peças	Medidas	Qt.	M.P.	Vol.	Off White Matte / Freijó
01	Chapéu	716x394x25	1	MDP	2	Off White Matte / Freijó
02	Prateleira	686x373x15	1	MDP	1	Off White Matte / Freijó
03	Base	716x394x25	1	MDP	2	Off White Matte / Freijó
04	Lateral esquerda	1577x393x15	1	MDP	1	Off White Matte / Freijó
05	Lateral direita	1577x393x15	1	MDP	1	Off White Matte / Freijó
06	Porta	430x356x15	2	MDF	1	Off White Matte
07	Fundo superior	694x286x3	3	HDF	2	Freijó
08	Fundo inferior	694x354x3	2	HDF	2	Freijó
09	Trava frontal	460x60x25	1	MDF	3	Freijó tingido
10	Trava traseira	460x60x25	1	MDF	3	Sem cor
11	Trava lateral	300x60x25	2	MDF	3	Freijó tingido
Q	Porta de vidro	1152x336x05	2	VIDRO	4	Incolor
R	Prateleira de vidro	676x265x05	3	VIDRO	2	Incolor

<b>A</b> 55x  Parafuso 3,5x14 Cabeça chata philips cod. 776	<b>B</b> 04x  Parafuso 4,5x60 Cabeça chata philips cod. 793	<b>C</b> 08x  Parafuso 5,0x70 Cabeça chata philips cod. 792	<b>D</b> 16x  Pino p/ Girofix Rosca soberba 6x31 cod. 162	<b>E</b> 20x  Cavilha 6x30 Madeira estriada cod. 949	<b>F</b> 16x  Tambor Ø15 Metálico cod. 184	<b>G</b> 04x  Porca cilíndrica Plástico 12x8 cod. 163
<b>H</b> 04x  Calço 5mm Metálico cod. 5555	<b>I</b> 12x  Suporte vidro 6mm 15x15 cod. 182	<b>J</b> 02x  Puxador pontual Metálico 25x12 cod. 7057	<b>K</b> 04x  Tapa furo 10mm Plástico	<b>L</b> 23x  Cunha de fixação Plástico 14x10x09 cod. 150	<b>M</b> 04x  Perfil "H" Plástico 16x685	<b>N</b> 01x  Kit 3x fitas luminária 700mm cod. 7054
<b>O</b> 12x  Tapa furo 21mm Plástico	<b>P</b> 02x  Arruela Plástica 10x03 cod. 7058	<b>Q</b> 02x  Porta de vidro 1152x336x05 cod. 7051	<b>R</b> 03x  Prateleira de vidro 676x265x05 cod. 6182	<b>S</b> 04x  Dobr reta 35mm Metálica cod. 134	<b>T</b> 02x  Pé madeira chanfrado 200x50x30 esq fro/dir tras cod. 6919	<b>U</b> 02x  Pé madeira chanfrado 200x50x30 dir fro/esq tra cod. 6920
<b>V</b> 02x  Fecho toque articulado Niquelado 45x38x10 cod. 6921	<b>W</b> 02x  Kit Dobr. 1 Porta vidro 35x26x14 cod. 7059	<b>X</b> 02x  Parafuso M4x16 Cabeça flang philips cod. 806	<b>Y</b> 01x  Giz de correção			

	Acessório	Qt.	Off White Matte / Freijó	cod.
K	Tapa furo plástico 10mm	4	Chocolate	6529
M	Perfil H	4	Freijó	6184
O	Tapa furo 21mm	12	Freijó	6084
Y	Giz de correção	1	Naturallis 2	5739
Y	Giz de correção	1	Off White 3	5738

Medidas finais / Final measures / Medidas finales

Comprimento / Length / Largo : 716mm

Altura / Height / Alto : 1829mm

Profundidade / Depth / Profundidad : 409mm

