

# RT 3107

## LISTA DE PEÇAS / LISTA DE PIEZAS / LIST OF PIECES

PEÇA / PIEZAS / PARTS	ITEM	DIMENSÕES / DIMENSIONES DIMENSIONS	CÓDIGO CODE	QTD.
BASE / TBASE / BASE	①	700 X 400 X 15	67663	01
TAMPO / TAMPLE / TAMPLE	②	700 X 400 X 15	66386	01
LATERAL / LATERAL / SIDE	③	997 X 380 X 15	69313	02
PRATELEIRA / ESTANTE / SHELF	④	649 X 378 X 15	69314	03
FR GAVETA / FRENTE DE CAJÓN / DRAWER FRONT	⑤	659 X 162 X 15	69315	01
LAT GAV DIREITA / LADO DEL CAJÓN DERECHO RIGHT DRAWER SIDE	⑥	350 X 100 X 15	60087	01
LAT GAV ESQ. / LADO DEL CAJÓN IZQUIERDO LEFT DRAWER SIDE	⑦	350 X 100 X 15	67214	01
COSTA GAVETA / CAJÓN COSTA / COSTA DRAWER	⑧	594 X 100 X 15	66389	01
COSTA / COSTA / BACK	⑨	674 X 278 X 3	69310	03
COSTA / COSTA / BACK	⑩	674 X 180 X 3	69311	01
BASE GAVETA / BASE DE CAJONES / DRAWER BASE	⑪	620 X 355 X 3	66390	01
PORTA VIDRO / PUERTA VIDRIO / GLASS DOOR	⑫	822 X 328 X 15	69588	02

LISTA DE ACESSÓRIOS / LISTA DE ACCESORIOS ACCESSORIES LIST				
ACESSÓRIO	ITEM	QTD		
PARAFUSO ALLEN 5X50	(A)	08	(A)	(J)
CHAVE Z ALLEN 3 MM	(B)	01	(B)	(K)
CAVILHA 8 X 30 MM	(C)	20	(C)	(L)
PÉ DE MADEIRA 140MM(69546)	(D)	04	(D)	(M)
TAMPA DE MINIFIX	(E)	04	(E)	(N)
PARAFUSO CAB CHATA 3,5X14	(F)	34	(F)	(O)
CALÇO DE DOBRADIÇA	(G)	06	(G)	(P)
CANECO DE DOBRADIÇA	(H)	06	(H)	(Q)
PREGO 10X10	(I)	60	(I)	(R)
TAMPA DE PARAFUSO	(J)	04		
PARAFUSO PANELA 3,5X30	(K)	03		
PARAFUSO ESTRUTURAL 7X50	(L)	04		
HASTE DE MINIFIX	(M)	16		
TAMBOR DE MINIFIX	(N)	16		
GARRA METALICA P/ COSTA	(O)	12		
CORREDIÇA AO PAR (158)	(P)	01		
PUXADOR GRACE (77168)	(Q)	03		
COLA 12G	(R)	01		

FERRAMENTAS NÃO FORNECIDAS:  
HERRAMIENTAS NO PROPORCIONADAS:  
TOOLS NOT PROVIDED:

FERRAMENTAS NECESSÁRIAS  
HERRAMIENTAS NECESARIAS



1. A montagem do produto deverá ser feita em uma superfície limpa e plana. Aconselhamos utilizar a própria embalagem para forrar o chão a fim de não danificar o produto.  
2. Reservar área livre para montagem do produto.  
3. Evitar batidas e o contato com objetos cortantes.

1. El producto debe montarse en una superficie limpio y plano, le recomendamos que utilice el embalaje en sí para forre el piso - para no dañar el producto.

2. Reserve un área libre para el ensamble del producto.  
3. Evite golpes y contacto con objetos afilados.

1. The product must be assembled on a clean and flat surface. We advise you to use the packaging itself to cover the floor in order not to damage the product.

2. Reserve free area for product assembly.  
3. Avoid knocking and contact with sharp objects.

1º MONTAGEM DA GAVETA  
MONTAJE DEL CAJÓN  
ASSEMBLY OF THE DRAWER

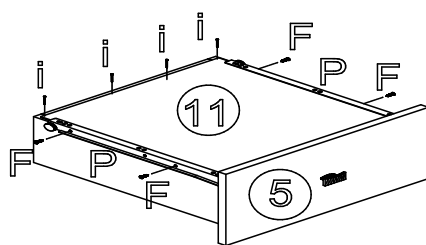
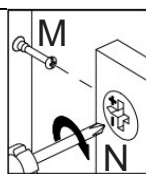
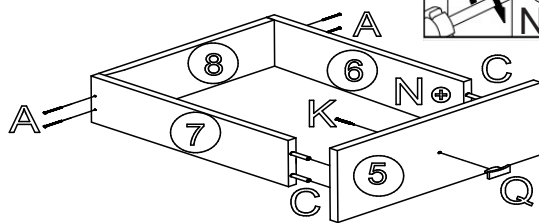
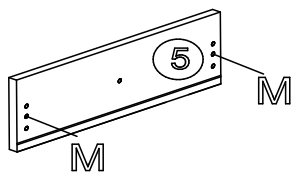

Identificação de peças  
Identificación de piezas  
Parts identification

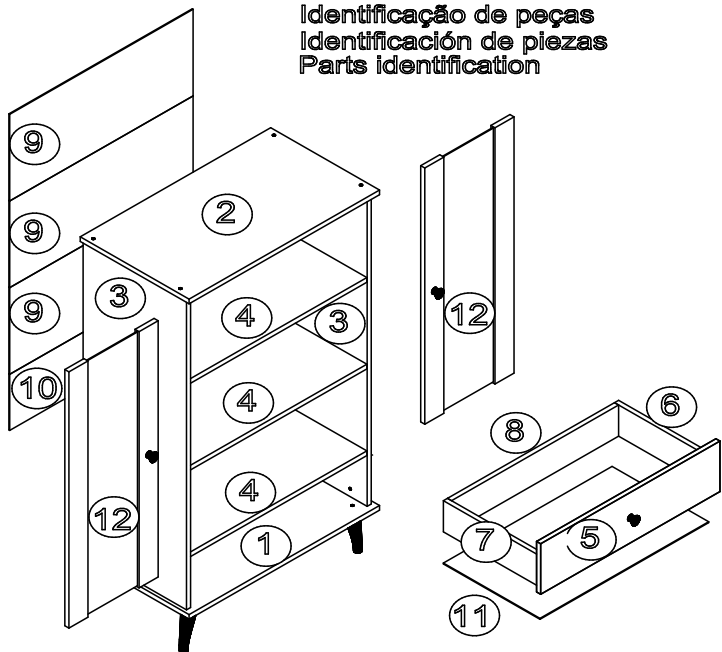

2º

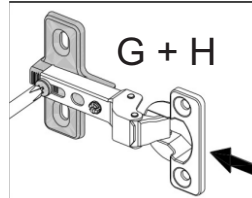
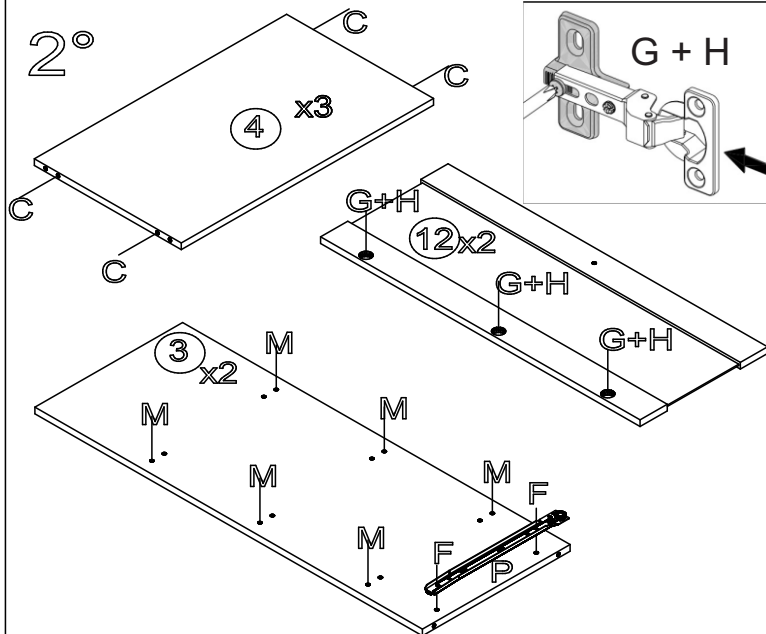

3º

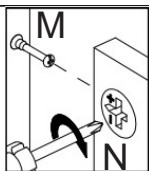
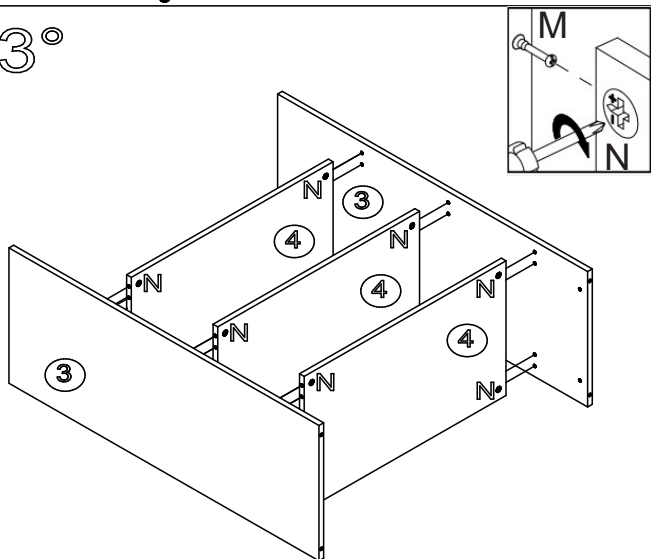

4º

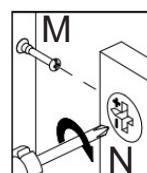
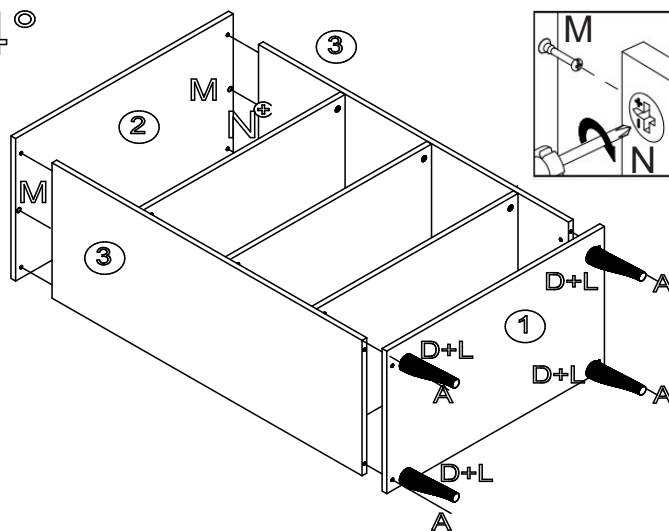

5º

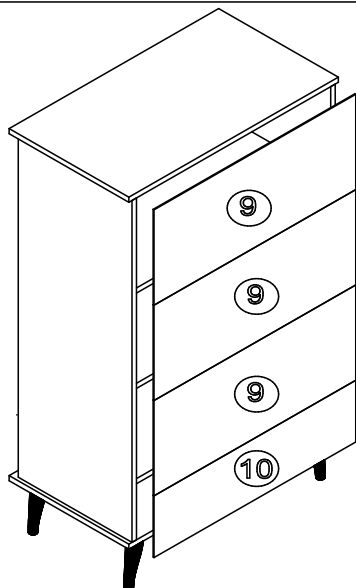

6º

