

# ACESSÓRIOS

ACCESSORIES - ACCESORIOS

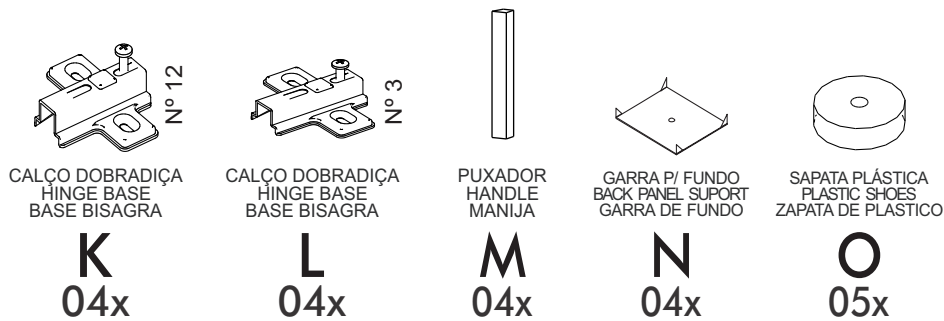
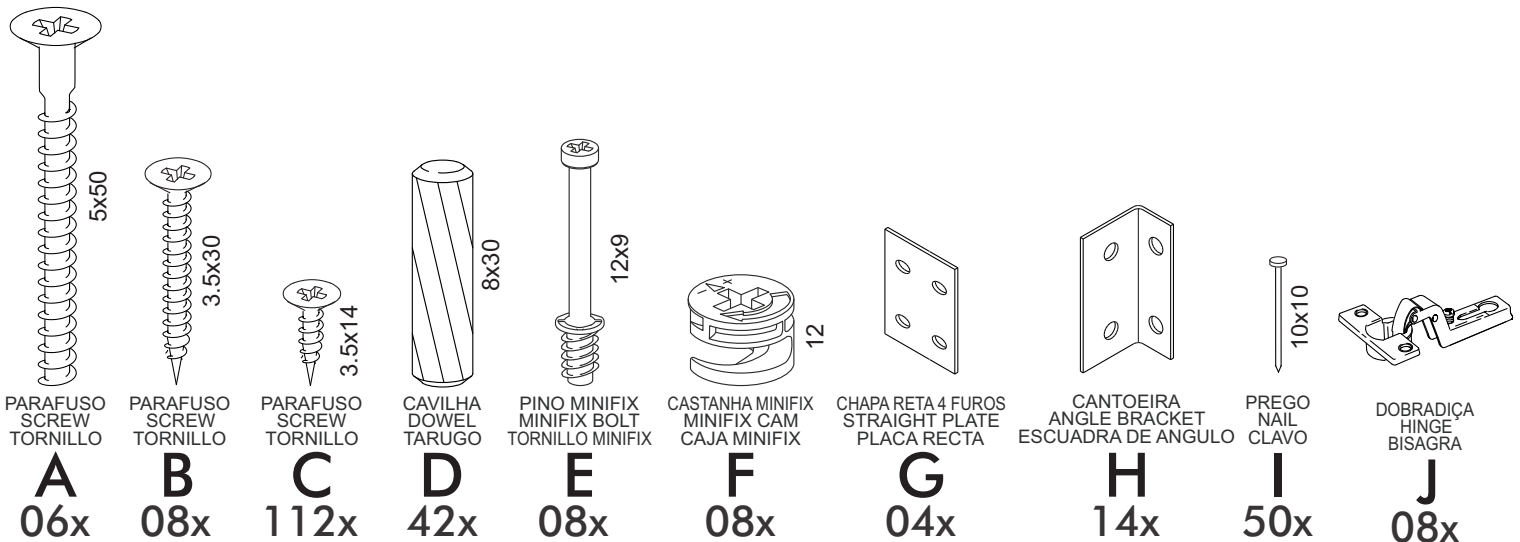

## CAPACIDADE DE CARGA

LOAD CAPACITY - CAPACIDAD DE CARGA

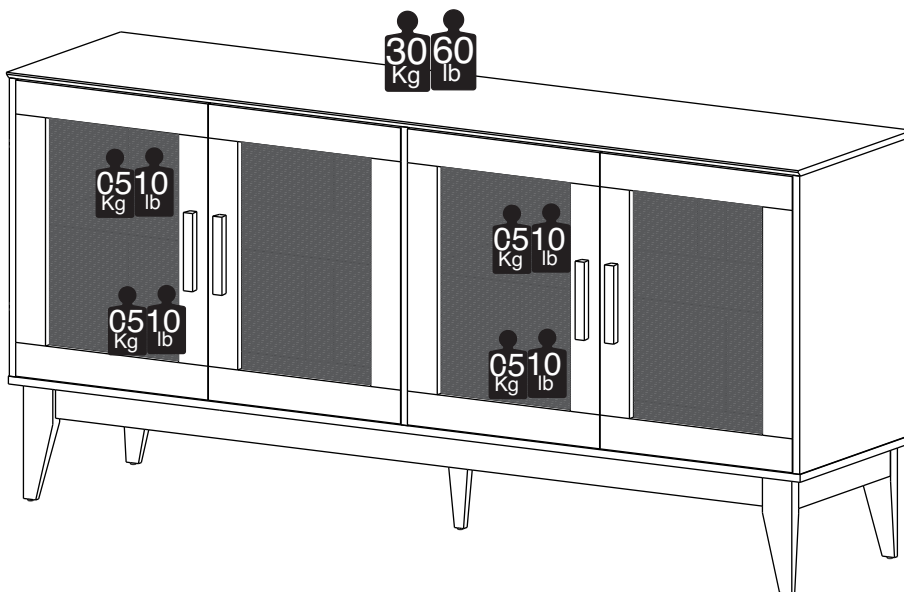
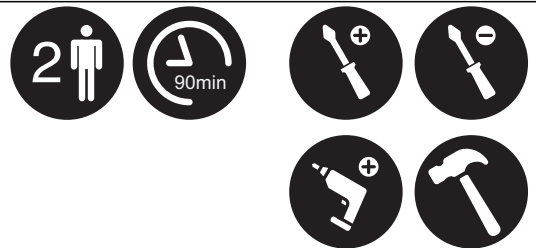

A CAPACIDADE DE CARGA INDICADA É DISTRIBUÍDA NAS ÁREAS DEMONSTRADAS.  
 THE INDICATED LOAD CAPACITY IS DISTRIBUTED IN THE SHOWN AREAS.  
 LA CAPACIDAD DE CARGA INDICADA ES DISTRIBUIDA EN ZONAS DEMONSTRADAS.

# MONTAGEM

ASSEMBLY - MONTAJE

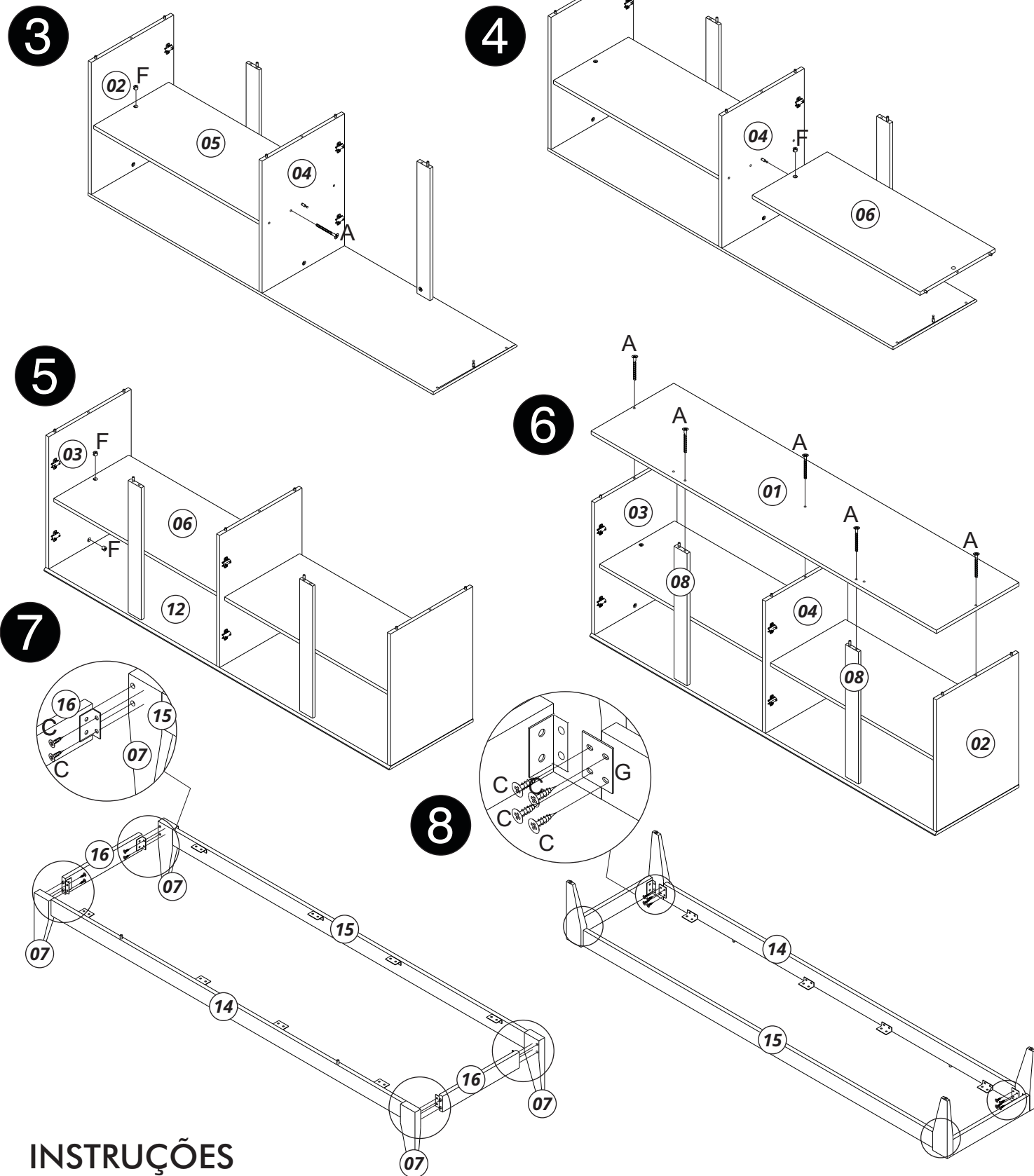

## INSTRUÇÕES

INSTRUCTIONS - INSTRUCCIONES

