

MANUAL DE MONTAGEM MESA REF. 165

1 2x

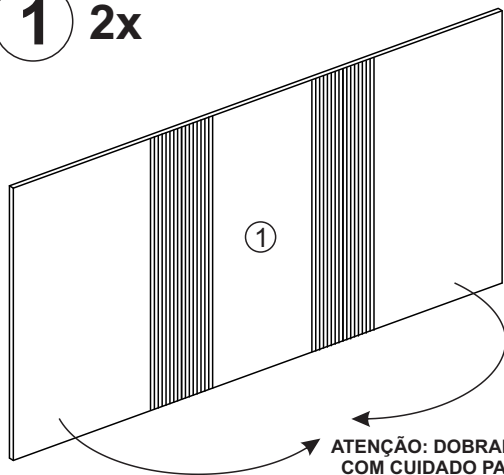

ATENÇÃO: DOBRAR A PEÇA COM CUIDADO PARA NÃO QUEBRAR.

2

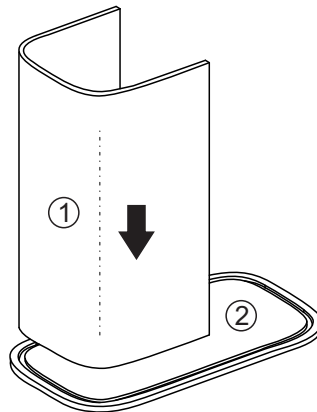

3

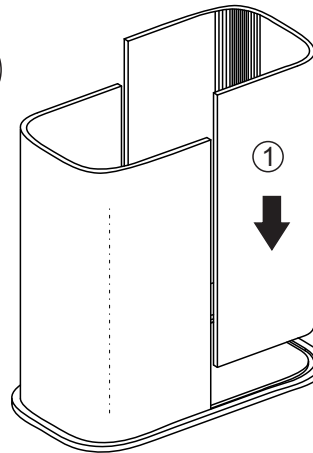

4

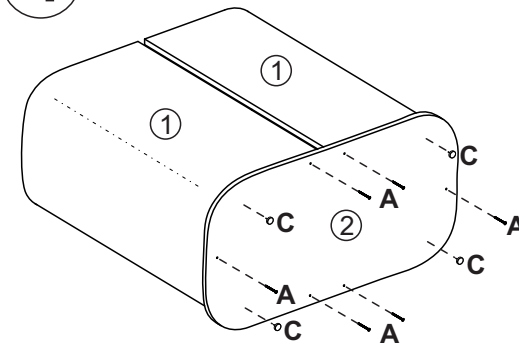

5

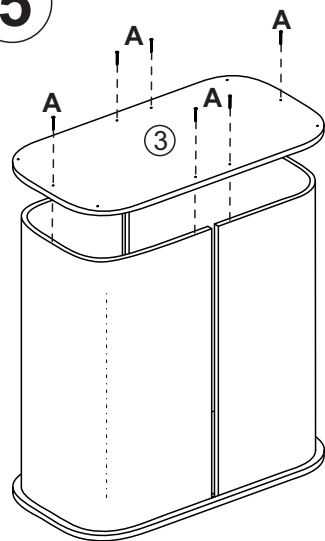

6



RETIRE A PROTEÇÃO DO ADESIVO E APLIQUE NO DETALHE LATERAL

2x

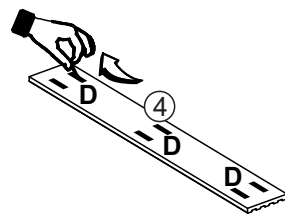

RETIRE A PROTEÇÃO DO ADESIVO E APLIQUE NA LATERAL DA BASE DA MESA, COMO MOSTRA A ETAPA 7.

7

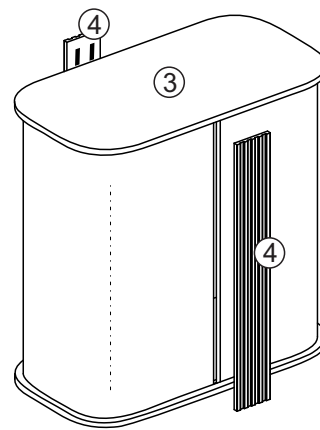

8

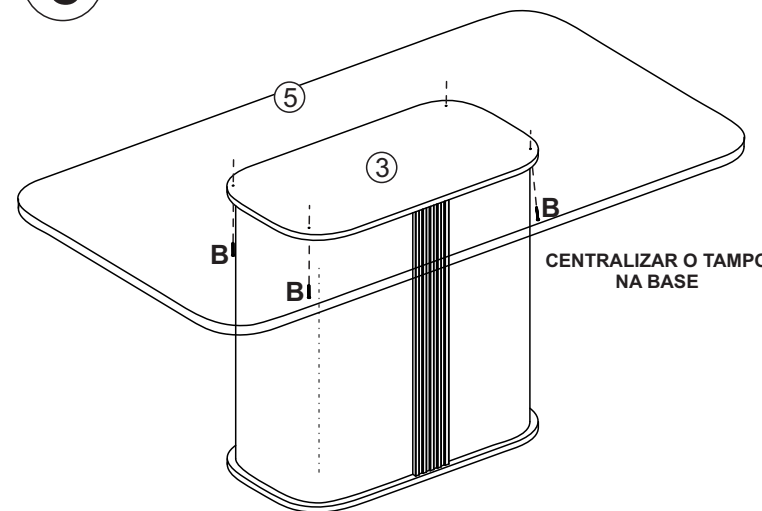

CENTRALIZAR O TAMPO NA BASE

A.  Ø4,5x45 - 12x

B.  Ø4,5x30 - 4x

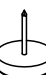
C.  4x

D.  12x