

RENOVATOR'S

Renovators Supply, Inc. ©
www.rensup.com

PEDESTAL SINK INSTALLATION LAG BOLTS SOLD SEPARATELY

Mounting hardware is not included as it is best determined by the onsite installer.

Lift and place sink on pedestal, adjust its position against the wall and make sure it is leveled. Adjust pedestal to plumb position. Large sinks are heavy, get help lifting the sink.

Mark centerline on the floor and trace pedestal base on the floor.

Mark the wall for each lag bolt mounting hole.

Note: Install sufficient backing behind the finished wall to provide a secure material for the bolting device of choice.

Carefully remove sink from pedestal, drill pilot holes into the wall for the lag bolts, sold separately.

Install faucets and drains.

Carefully lift the sink into the desired position lining up holes and on top of pedestal. Screw in lag bolts (B) DO NOT overtighten, this may crack sink. For added protection place the neoprene washer on the sink followed by the additional metal washer. (Lag bolts sold separately).
Note: The lavatory must be supported by the lag bolts & pedestal.

Optional: It is recommended applying silicone caulk between the back of the sink and the wall, where the pedestal joints the sink and also between the floor and the base of the pedestal.

Example diagram

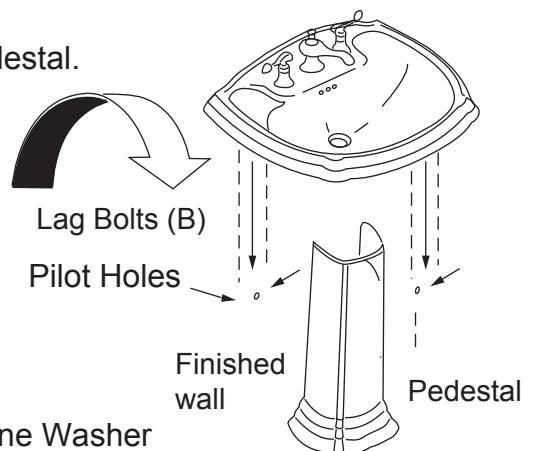
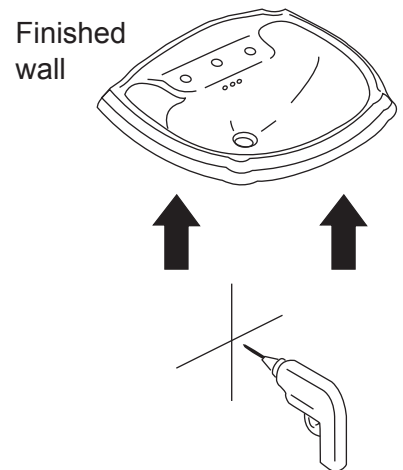
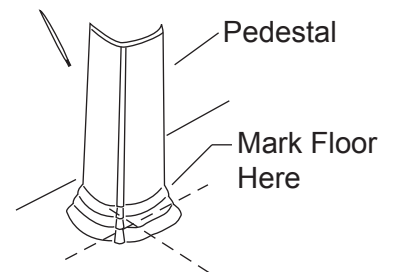
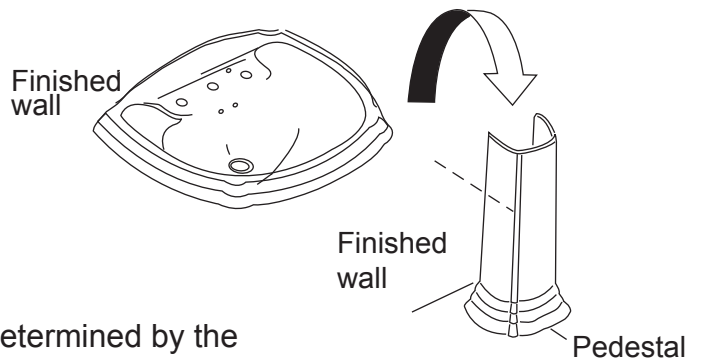
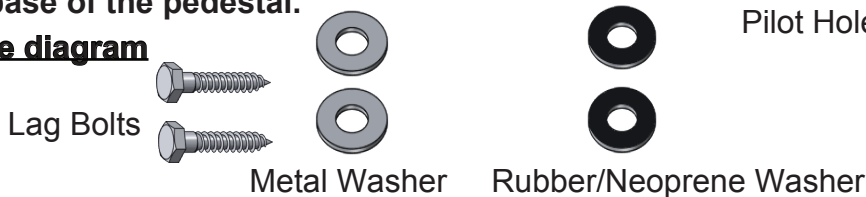

These instructions and drawings disclose confidential and other data of proprietary nature owned by Renovator's Supply Inc. and may not be used or disclosed to others without the prior written consent of Renovator's Supply Inc. Renovators Supply, Inc.©



**Congratulations on your purchase of a superior quality
Pedestal sink (with brackets) designed to be
The centerpiece of your bathroom with built-in practical features for everyday use.
Designed & Manufactured to ANSI spec. for the US since 1978.**

Our pedestal sinks feature not only elegance in design but built-in functionality that allows you & your family the practicality of modern convenience without sacrificing quality & style.

Made of Grade A Vitreous China

Our sinks are hard-fired at intense temperatures. This process allows our superior quality porcelain glazes to fuse and cure with sink molds and provide a vitreous finish that is impervious to water & other common household acids & chemicals. Our sinks do not stain like lesser grades of vitreous china sinks.

Our Porcelain Glazes

Are manufactured to provide stunning colors and designs for which we are renown worldwide. Our whites are white unlike cheaper manufacturers who settle for grayish or yellowish glazes. Our porcelain glazes do not fade with time & are scratch-resistant. Perfect for everyday wear & tear.

Pedestal Sink features:

- Space-saving design maximizes limited bathroom space
- Allows for easy bathroom cleaning
- Ergonomic design for less back strain & an easy reach to the sink & faucets
- Select between white, bone & black colors to match any bathroom décor
- Choose from a variety of faucet styles:
 - Modern single hole
 - Compact 4" center set
 - Elegant 8" widespread
- Where applicable, the supports are easily installed & include instructions
- Where applicable, the pedestal conceals unsightly pipes
- Pedestal height are easily adjustable with pedestal extenders at: www.rensup.com
 - 16549 4"h White, 16550 4"h Bone
 - 16551 8"h White, 16552 8"h Bone

100's of Faucets to choose from with solid brass construction & wide variety of finishes.

- Modern Waterfall Faucets with over 35 glass disk designs & colors to choose from
- Sleek, one hand single lever designs
- Traditional cross handles
- Vintage porcelain levers
- Ceramic Euro faucets & Cottage style faucets

**Always dreamed of a cast iron clawfoot tub!
Visit www.rensup.com for a wide selection**

- Extra thick cast iron tubs 5/16" thick retain heat longer so you can soak longer!
- Authentic white porcelain glaze
- Primed & ready to be painted
- A variety of claw feet finishes

Complete your tub's vintage look with a shower surround & keep water off the floor!

- You can select from a floor, deck or wall mount type shower surround package
- Round or oval surrounds
- 100's of showerhead & handheld options with solid brass inner workings in a variety of finishes to match your bathroom decor:
 - Luxurious rainfall showerheads
 - Modern, avant-garde designs
 - Nostalgic telephone showerheads
 - Variety of handle styles
 - Porcelain cross handles
 - Brass PVD or Chrome cross handles
 - Teardrop levers
 - Double levers

Eco-savvy consumers know we have the widest selection of environmentally sound toilets!

At www.rensup.com we have:

Over 45 Dual Flush Toilets to choose from with the latest **Dual-Flush Technology**

- Which puts you in control of your water consumption
- Choose from both 0.8 & 1.6 gallon flush at the touch of a button
- Lowers water usage & saves you money
- Modern sleek designs to toilets with an Old World style & vintage flair

Over 350 High-tank Toilets & Conversion Kits that allow you to have that Old World charm

- Yet take advantage of water saving technology
- Are adjustable to accommodate various size bathrooms
- Come in a variety of colors & finishes



These instructions and drawings disclose confidential and other data of proprietary nature owned by **Renovator's Supply Inc.** and may not be used or disclosed to others without the prior written consent of **Renovator's Supply Inc.** Renovators Supply, Inc.©