

LOCATION MAP NOT TO SCALE

LOT 41  
BLOCK 23

ORIGINAL FIELD WORK  
COMPLETED BY:  
TARGET SURVEYING, LLC  
DATED: 01-04-2012  
SURVEY #173204

LOT 39  
BLOCK 23

ORIGINATION BENCHMARK  
SARASOTA COUNTY BRASS DISK  
"5AR9"  
N.G.V.D. 1929 ELEVATION = 10.21

NOTES:

1. LEGAL DESCRIPTION PROVIDED BY CLIENT
2. NO SEARCH OF THE PUBLIC RECORD FOR THE PURPOSE OF ABSTRACTING TITLE WAS PERFORMED BY THIS OFFICE
3. NO SUBSURFACE IMPROVEMENTS WERE LOCATED AS PART OF THIS SURVEY
4. ALL ANGLES AND DISTANCES SHOWN HEREON ARE BOTH RECORD AND MEASURED UNLESS OTHERWISE NOTED
5. THE BEARINGS SHOWN HEREON ARE BASED ON THE SOUTHERLY PROPERTY LINE, ASSUMED TO BEAR S47°49'00"W.

ABBREVIATION DESCRIPTION:

A/C	AIR CONDITIONER
C/L	CENTERLINE
I.D.	IDENTIFICATION
LB	LICENSED BUSINESS
N.G.V.D.	NATIONAL GEODETIC VERTICAL DATUM
M	MEASURED
P	PLAT
PSM	PROFESSIONAL SURVEYOR MAPPER
R/W	RIGHT OF WAY
	TOPOGRAPHIC ELEVATION

LEGAL DESCRIPTION:

LOT 40, BLOCK 23, BIRD KEY SUBDIVISION, ACCORDING TO THE MAP OR PLAT THEREOF, AS RECORDED IN PLAT BOOK 11, PAGE(S) 20, OF THE PUBLIC RECORDS OF SARASOTA COUNTY, FLORIDA.

FLOOD ZONE: B  
COMMUNITY NUMBER: 120195  
PANEL: 0005  
SUFFIX: C

*Clyde O. McNeal*

**Clyde O. McNeal PSM #2883**  
THIS SURVEY IS NOT VALID WITHOUT  
THE SIGNATURE AND THE ORIGINAL RAISED SEAL  
OF A FLORIDA LICENSED SURVEYOR AND MAPPER

BOUNDARY SURVEY OF  
658 MOURNING DOVE DRIVE  
SARASOTA, FL 34236  
PREPARED FOR  
PATRICK DIPINTO

Project C-13197	1 of 1
Date 06-08-2015	
Scale 1" = 25'	

6250 N. MILITARY TRAIL, SUITE 102  
WEST PALM BEACH, FL 33407  
www.compassurveying.net

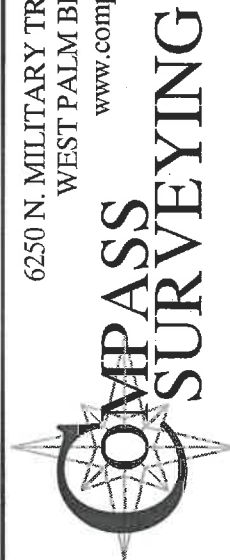

LB. 7463 PHONE: 561.640.4800 FAX: 561.640.0576