

FORM NO. GWS-32 10/94

PUMP INSTALLATION AND TEST REPORT
STATE OF COLORADO, OFFICE OF THE STATE ENGINEER

For Office Use only

RECEIVED

JAN 13 1997

WALTER J. GARDNER
STATE ENGINEER
COLORADO

1. WELL PERMIT NUMBER 199263

2. OWNER NAME(S) Ronnie & Becky Moyer
Mailing Address Box 458
City, St. Zip Simla Co 80835
Phone (719) 541-3202

3. WELL LOCATION AS DRILLED: sq 1/4 sq 1/4, Sec. 8 Twp. 11 S, Range 60 W
DISTANCES FROM SEC. LINES:
660 ft. from South Sec. line. and 660 ft. from East Sec. line.
(north or south) (east or west)
SUBDIVISION: _____ LOT _____ BLOCK _____ FILING(UNIT) _____
STREET ADDRESS AT WELL LOCATION: _____

4. PUMP DATA: Type Sub Installation Completed Jan 9 1997
Pump Manufacturer Red Jacket Pump Model No. 150CNS18 BC
Design GPM 10 at RPM 3450, HP 1 1/2, Volts 230, Full Load Amps 12
Pump Intake Depth 347 Feet, Drop/Column Pipe Size 1 Inches, Kind PVC

ADDITIONAL INFORMATION FOR PUMPS GREATER THAN 50 GPM:

TURBINE DRIVER TYPE: Electric Engine Other _____
Design Head _____ feet, Number of Stages _____, Shaft size _____ inches.

5. OTHER EQUIPMENT:
Airline Installed Yes No, Orifice Depth ft. _____ Monitor Tube Installed Yes No, Depth ft. _____
Flow Meter Mfg. _____ Meter Serial No. _____
Meter Readout Gallons, Thousand Gallons, Acre feet, Beginning Reading _____

6. TEST DATA: Check box if Test data is submitted on Supplemental Form.
Date Jan 9 1997
Total Well Depth 520 Time _____
Static Level 190 Rate (GPM) 11
Date Measured Dec 16 1996 Pumping Lvl. 280

7. DISINFECTION: Type HTH Amt. Used 1 Cup

8. Water Quality analysis available. Yes No

9. Remarks _____

10. I have read the statements made herein and know the contents thereof, and that they are true to my knowledge.
[Pursuant to Section 24-4-104 (13)(a) C.R.S., the making of false statements herein constitutes perjury in the second degree and is punishable as a class 1 misdemeanor.]

CONTRACTOR Hamacher Well Works Inc Phone (719) 541-2460 Lic. No. 71
Mailing Address Box 86 Simla Co 80835

Name/Title (Please type or print) <u>T.R. Hamacher</u>	Signature <u>T.R. Hamacher</u>	Date <u>Jan 10 1997</u>
---	-----------------------------------	----------------------------

INSTRUCTIONS FOR PUMP INSTALLATION REPORT

The report must be typed or printed in **BLACK INK**. All changes on the form must be initialed and dated. Attach additional sheets if more space is required. Each additional sheet must be identified at the top by the well owner's name, the permit number, form name/number and a sequential page number. Report depths in feet below ground surface.

This form may be reproduced by photocopy methods, or by computer generation with prior approval by the State Engineer. Photocopy reproductions must retain margins and print quality of the original form.

The original form must be submitted to the State Engineer's Office within 60 days after completing the well or 7 days after the permit expiration date, whichever is earlier.

A copy of the form must be provided to the well owner.

If this form is submitted in conjunction with the Well Completion and Test Report, form number GWS-31, ONLY THE PERMIT NUMBER AND OWNER NAME NEED TO BE COMPLETED in items 1 and 2.

1. Complete the **Permit Number** in full.
2. Fill in **Name and Mailing Address of Well Owner** where correspondence should be sent.
3. Complete the blocks for the **actual** location of the well. For wells located in subdivisions the lot, block and subdivision information must also be provided.
4. Indicate the type of pump installed and complete the requested information. When installing pumps greater than 50 gpm, complete the additional information in this area.
5. Provide the information on other equipment which may be installed in the well.
6. Report test data as required by Rule 13.9. Spaces are provided to report all measurements made during the test. The report should show that the test complied with the provisions of the rules. If a test was not performed explain when it will be done. If available, report clock time when measurements were taken.
7. Record the type and the amount of disinfection used, how placed and the length of time left in the hole.
8. Indicate if a water quality analysis was performed and submit a copy of the report if available.
9. Use the remarks area to note any additional information including additional equipment installed, water supply construction problems.
10. Fill in **Company Name and Address of Contractor** who installed pumping equipment. The report must be signed by the licensed contractor responsible for the installation of pumping equipment.

FORM NO. GWS-31 10/94

WELL CONSTRUCTION AND TEST REPORT STATE OF COLORADO, OFFICE OF THE STATE ENGINEER

For Office Use only

RECEIVED

DEC 23 '96

WATER RESOURCES STATE ENGINEER COLO

1. WELL PERMIT NUMBER 199263

2. OWNER NAME(S) Ronnie & Becky Moyer Mailing Address Box 458 City, St. Zip Simla Co 80835 Phone (719) 541-3202

3. WELL LOCATION AS DRILLED: SE 1/4 SE 1/4, Sec. 8 Twp. 11 S, Range 60 W DISTANCES FROM SEC. LINES: 660 ft. from South Sec. line. and 660 ft. from East Sec. line. OR (north or south) (east or west) SUBDIVISION: LOT BLOCK FILING(UNIT) STREET ADDRESS AT WELL LOCATION:

4. GROUND SURFACE ELEVATION ft. DRILLING METHOD Rotary DATE COMPLETED Dec 16 1996 TOTAL DEPTH 560 ft. DEPTH COMPLETED 520 ft.

5. GEOLOGIC LOG: Table with columns Depth and Description of Material (Type, Size, Color, Water Location). Rows include 0-10 Brown Sand, 10-18 Clay, 18-50 Coal & Shale, 50-80 Shale, 80-110 Sandstone, 110-140 Shale, 140-150 Coal, 150-420 Shale & Sandstone, 420-520 Sandy Shale, 520-560 Shale.

6. HOLE DIAM. (in.) From (ft) To (ft) Table with rows for 8 5/8 (0-20) and 6 1/4 (20-520).

7. PLAIN CASING Table with columns OD (in), Kind, Wall Size, From(ft), To(ft). Rows include 6 5/8 Steel (188) (+1-20), 4 1/2 PVC (1/4) (0-180), 4 1/2 PVC (1/4) (200-300, 320-420), 4 1/2 PVC (1/4) (440-460, 480-500). PERF. CASING: Screen Slot Size: 20th, 4 1/2 PVC (1/4) (180-200, 300-320), 4 1/2 PVC (1/4) (420-440, 460-480), 4 1/2 PVC (1/4) (500-520).

8. FILTER PACK: Material Silica Sand Size 8-12 Interval 130-520

9. PACKER PLACEMENT: Type Depth

10. GROUTING RECORD: Material Amount Density Interval Placement Cemented 2 Sack 12 Gal 0-20 Poured Cemented 2 Sack 14 Gal 110-130 Pumped Tremmie Pipe

REMARKS:

11. DISINFECTION: Type HTH Amt. Used 1 Cup

12. WELL TEST DATA: [] Check box if Test Data is submitted on Form No. GWS 39 Supplemental Well Test. TESTING METHOD Aired and Bailed Static Level 180 ft. Date/Time measured Dec 16 1996 Production Rate 15 gpm. Pumping level 350 ft. Date/Time measured Test length (hrs.) 4

13. I have read the statements made herein and know the contents thereof, and that they are true to my knowledge. [Pursuant to Section 24-4-104 (13)(a) C.R.S., the making of false statements herein constitutes perjury in the second degree and is punishable as a class 1 misdemeanor.]

CONTRACTOR Hamacher Well Works Inc Phone (719) 541-2460 Lic. No. 71 Mailing Address Box 86 Simla Co 80835

Name/Title (Please type or print) T.R. Hamacher Signature [Signature] Date Dec 20 1996

The report must be typed or printed in **BLACK INK**. All changes on the form must be initialed and dated. Attach additional sheets if more space is required. Each additional sheet must be identified at the top by the well owner's name, the permit number, form name/number and a sequential page number. Report depths in feet below ground surface.

This form may be reproduced by photocopy methods, or by computer generation with prior approval by the State Engineer. Photocopy reproductions must retain margins and print quality of the original form.

The original form must be submitted to the State Engineer's Office within 60 days after completing the well or 7 days after the permit expiration date, whichever is earlier.

A copy of the form must be provided to the well owner.

1. Complete the **Well Permit Number** in full.
2. Fill in **Name and Mailing Address of Well Owner** where correspondence should be sent.
3. Complete the blocks for the **actual** location of the well where drilled. If the owner has more than one well serving this property, provide the identification (**Owner's Designation**) for this well. **DO NOT USE THE OWNER SUPPLIED LOCATION** unless a survey has been provided. For wells located in subdivisions the lot, block and subdivision information must also be provided.
4. Report the ground surface elevation in feet above sea level if available. This value may be obtained from a topographic map. Describe the drilling method used to construct the well and the date completed. Indicate the total depth drilled and the actual completed depth of the well.
5. Fully describe the materials encountered in drilling. Do not use formation names unless they are in conjunction with a description of materials.
Examples of descriptive terms include:
Grain size--Boulders, gravel, sand, silt, clay.
Hardness--Loose, soft, tight, hard, very hard.
Color--All materials. Most critical in sedimentary rock.
Depth when water is encountered (if it can be determined).
6. Provide the diameters of the drilled bore hole.
7. The outside diameter, kind, wall thickness and interval of casing lengths must be indicated.
8. Indicate the type and size of filter (gravel) pack and the interval where placed.
9. Indicate the type and setting depth for any packers installed.
10. The density of the grout slurry must be reported and may be indicated as pounds per gallon, gallons of water per sack, total gallons of water and number of sacks used, etc. Specify the grout placement method, i.e. tremie pipe or positive displacement. The percentage of additives mixed with the grout should be reported under remarks.
11. Record the type and the amount of disinfection used, how placed and the length of time left in the hole.
12. Report well test data as required by Rule 10.7. Spaces are provided to report all measurements made during the test. The report should show that the test complied with the provisions of the rules. If a test was not performed explain when it will be done. If available, report clock time when measurements were taken.
13. Fill in **Company Name and Address of Contractor** who constructed the well. The report must be signed by the licensed contractor responsible for the construction of the well.

OFFICE OF THE STATE ENGINEER
COLORADO DIVISION OF WATER RESOURCES

818 Centennial Bldg., 1313 Sherman St., Denver, Colorado 80203
(303) 866-3581

WELL PERMIT NUMBER	199263
DIV. 8	CNTY. 21
WD 67	DES. BASIN 7
MD 13	

APPLICANT

RONNIE & BECKY MOYER
BOX 458
SIMLA CO 80835-

(719)541-3202

APPROVED WELL LOCATION
EL PASO COUNTY

SE 1/4 SE 1/4 Section 8
Twp 11 S RANGE 60 W 6th P.M.

DISTANCES FROM SECTION LINES

660 Ft. from South Section Line
660 Ft. from East Section Line

PERMIT TO CONSTRUCT A WELL

CONDITIONS OF APPROVAL

- 1) This well shall be used in such a way as to cause no material injury to existing water rights. The issuance of the permit does not assure the applicant that no injury will occur to another vested water right or preclude another owner of a vested water right from seeking relief in a civil court action.
- 2) The construction of this well shall be in compliance with the Water Well Construction Rules 2 CCR 402-2, unless approval of a variance has been granted by the State Board of Examiners of Water Well Construction and Pump Installation Contractors in accordance with Rule 18.
- 3) Approved pursuant to CRS 37-90-105.
- 4) Water from this well may be used for domestic purposes inside three (3) single family dwellings.
- 5) The maximum pumping rate shall not exceed 15 GPM.
- 6) The annual withdrawal of ground water from this well shall not exceed 1 acre-foot.
- 7) The irrigated area shall not exceed 1 acre of lawn and garden.
- 8) Water from this well may be used for the watering of livestock on range and pasture.
- 9) Production is limited to the Arapahoe aquifer. Plain casing must be installed and grouted from ground surface to a minimum depth of 130 feet to prevent diversion of water from other zones. The depth of the well shall not exceed 565 feet, which is the estimated base of the Arapahoe aquifer.
- 10) This well must be constructed within 300 feet of the location specified on this permit.

NOTE: The ability of this well to withdraw its authorized amount of water from this non-renewable aquifer may be less than the 100 years upon which the amount of water in the aquifer is allocated, due to anticipated water level declines.

JWS 10/30/96

APPROVED
JWB

Hal D. Simpson

State Engineer

John L. Bilyeu

By

Receipt No. 0406119

DATE ISSUED OCT 30 1996

EXPIRATION DATE OCT 30 1998

COLORADO DIVISION OF WATER RESOURCES
 DEPARTMENT OF NATURAL RESOURCES
 1313 SHERMAN ST., RM. 818, DENVER CO 80203
 phone - info: (303) 866-3587 main: (303) 866-3581

RECEIVED
 199263 RECEIVED
 OCT 17 1996
 SEP 09 1996
 WATER RESOURCES STATE ENGINEER
 COLORADO

RESIDENTIAL * (Note: You may also use this form to apply for livestock watering)
Water Well Permit Application
 Review instructions prior to completing form Must be completed in black ink or typed

1. APPLICANT INFORMATION				6. USE OF WELL (check appropriate entry or entries)			
Name of applicant <u>Ronnie + Becky Moyer</u>				See instructions to determine use(s) for which you may qualify --			
Mailing Address <u>Box 458</u>				<input type="checkbox"/> A. Ordinary household use in one single-family dwelling (NO outside use)			
City <u>Summit Co</u>		State <u>CO</u>		Zip code <u>80835</u>		<input checked="" type="checkbox"/> B. Ordinary household use in 1 to 3 single-family dwellings:	
Telephone Number (include area code) <u>(719) 541-3202</u>				Number of dwellings: <u>3</u>			
2. TYPE OF APPLICATION (check applicable box(es))				<input checked="" type="checkbox"/> Home garden/lawn irrigation, not to exceed 1 acre: area irrigated <u>1/4</u> <input type="checkbox"/> sq. ft. <input checked="" type="checkbox"/> acre			
<input checked="" type="checkbox"/> Construct new well		<input type="checkbox"/> Use existing well		<input checked="" type="checkbox"/> Domestic animal watering -- (non-commercial)			
<input type="checkbox"/> Replace existing well		<input type="checkbox"/> Change / Increase Use		7. WELL DATA			
<input type="checkbox"/> Change (source) aquifer		<input type="checkbox"/> Reapplication (expired permit)		Maximum pumping rate <u>15</u> gpm		Annual amount to be withdrawn <u>1</u> acre-feet	
<input type="checkbox"/> Other:				Total depth <u>380</u> feet		Aquifer <u>Arapahoe</u>	
3. REFER TO (if applicable):				<input checked="" type="checkbox"/> C. Livestock watering (on farm/ranch/range/pasture)			
Water court case #		Permit #		8. TYPE OF RESIDENTIAL SEWAGE SYSTEM			
Verbal # <u>-VE-</u>		Monitoring hole acknowledgment # <u>MH-</u>		<input checked="" type="checkbox"/> Septic tank / absorption leach field			
Well name or #				<input type="checkbox"/> Central system			
4. LOCATION OF WELL				District name: _____			
County <u>EL PASO</u>		Quarter/quarter <u>SE 1/4</u>		Quarter <u>SE 1/4</u>		<input type="checkbox"/> Vault	
Section <u>8</u>		Township N or S <u>11</u> <input type="checkbox"/> N <input checked="" type="checkbox"/> S		Range E or W <u>60</u> <input type="checkbox"/> E <input checked="" type="checkbox"/> W		Location sewage to be hauled to: _____	
Principal Meridian <u>6</u>						<input type="checkbox"/> Other (attach copy of engineering design)	
Distance of well from section line <u>660</u> ft. from <input type="checkbox"/> N <input checked="" type="checkbox"/> S <u>660</u> ft. from <input checked="" type="checkbox"/> E <input type="checkbox"/> W				9. PROPOSED WELL DRILLER (optional)			
Well location address, if different from applicant address (if applicable)				Name <u>Hamacher Well Works Inc</u>		License number <u>71</u>	
For replacement wells only - distance and direction from old well to new well				10. SIGNATURE of applicant(s) or authorized agent			
feet		direction		The making of false statements herein constitutes perjury in the second degree, which is punishable as a class 1 misdemeanor pursuant to C.R.S. 24-4-104(13)(a). I have read the statements herein, know the contents thereof and state that they are true to my knowledge.			
5. TRACT ON WHICH WELL WILL BE LOCATED				Must be original signature <u>Becky R. Moyer</u>			
A. You must check one of the following - see instructions				Title <u>Owner</u>		Date <u>Aug 96</u>	
<input type="checkbox"/> Subdivision: Name _____				OPTIONAL INFORMATION			
Lot no. _____ Block no. _____ Filing/Unit _____				USGS map name		DWR map no. <u>6270</u>	
<input type="checkbox"/> County exemption (attach copy of county approval & survey) Name/no. _____ Tract no. _____				Office Use Only		Surface elev. _____	
<input type="checkbox"/> Mining claim (attach copy of deed or survey) Name/no. _____				CHECKS		8-2	
<input type="checkbox"/> Other (attach legal description to application)				DIV OF WATER RESOURCES		CO21	
B. STATE PARCEL				15 GPM		WD 67	
ID# (optional): _____		C. # acres in tract <u>40</u>		1 AF		BA 7	
D. Are you the owner of this property?		<input checked="" type="checkbox"/> YES <input type="checkbox"/> NO (if no - see detailed inst.)		1 AC IFR		MD 13	
E. Will this be the only well on this tract?				USE _____ MD _____			
<input checked="" type="checkbox"/> YES <input type="checkbox"/> NO (if other wells are on this tract - see detailed inst.)							

RESIDENTIAL APPLICATIONS - GENERAL INSTRUCTIONS

There are a variety of uses for ground water in Colorado. This form (GWS-44) can be used when applying for a permit for a new well or replacement of an existing well for the following types of uses:

ORDINARY HOUSEHOLD USE inside one single family residence (NO outside water use allowed)
OTHER RESIDENTIAL USE (sometimes referred to as "domestic" use) which may include use in up to three single-family residences, watering of up to one acre of home gardens and lawns, and watering of domestic animals
LIVESTOCK WATERING on a farm, ranch, range, or pasture

If you are applying for a NEW household use only well, or for a NEW 35+ acre residential well outside the Denver Basin or Designated Basins of eastern Colorado, please use simplified forms GWS-49 or GWS-50. DO NOT use this form for registration of an existing unpermitted well (Use Form GWS-12), monitoring/observation wells (Use Form GWS-46), gravel pit wells (Use Form GWS-27), or for other uses not listed above, including - commercial, industrial, crop irrigation, municipal, etcetera (Use GENERAL PURPOSE Form GWS-45).

FEES Applications must be submitted with the appropriate required non-refundable filing fees. The required filing fee for most well permit applications is \$60. The filing fees for replacement or deepening well permit applications for most previously permitted residential and livestock water wells is \$20. Checks should be payable to the COLORADO DIVISION OF WATER RESOURCES.

Applications are evaluated in chronological order. Please allow approximately six weeks for processing.

APPLICATIONS must be completed clearly, and legibly, in BLACK INK or typed. ALL ITEMS in the application must be completed. Incomplete applications may be returned to the applicant for more information. Do not change or alter the application in any way.

THE LOCATION of the well in item 4 must be correctly and accurately described. The county, quarter/quarter, section, township, range, principal meridian, and distance from section lines must be provided.
NOTE: Distances are not necessarily the same distances as the distances from (your) property lines.

For additional assistance in describing the location of your well, review the publication entitled "How to Determine Well Location" which was provided with your packet, or can be requested from any Colorado Division of Water Resource office.

A LEGAL DESCRIPTION of your lot or parcel of land is required in item 5. For tracts of less than 35 acres approval may depend upon whether the tract was created by a division of land after June 1, 1972. If your lot is less than 35 acres in size, it would be prudent to have a deed or legal description that shows your tract was divided from a larger tract prior to June 1, 1972. This may be accomplished by obtaining a copy of a deed for the tract issued prior to June 1, 1972.

An ORIGINAL signature must be on each application. The applicant's authorized agent may sign the application, if a letter signed by the applicant is submitted with the application authorizing them to act as agent for the purpose of obtaining a well permit.

IF YOU HAVE ANY QUESTIONS regarding any item on the application form, please call the Division of Water Resources Ground Water Information Desk (303-866-3587), or the nearest Division of Water Resources Field Office located in Greeley (970-352-8712), Pueblo (719-542-3368), Alamosa (719-589-6683), Montrose (970-249-6622), Glenwood Springs (970-945-5665), Steamboat Springs (970-879-0272), or Durango (970-247-1845).

DETAILED INSTRUCTIONS ARE AVAILABLE UPON REQUEST

EXEMPT WELL DATA SHEET - DENVER BASIN, COLORADO

APPLICANT: MOYER RECEIPT NO. 406119
 LOCATION: SE1/4 OF SE1/4 OF SEC. 8, T.11S., R.60W. (660 SSL, 660 ESL)
 LOCATION IS WITHIN THE UPPER BIG SANDY DESIGNATED GROUND WATER BASIN *ae*
 PROPOSED AQUIFER:
 SURFACE ELEVATION: 6270 NUMBER OF ACRES IN TRACT: 40.

IS PROPERTY WITHIN SERVICE BOUNDARIES OF MUNICIPALITY S.B.5 CONSENT MAPS? NO YES
 IF SUBDIVISION IS UNDER AUGMENTATION PLAN, CASE NO. IS _____, DIV. _____
 IF SUBDIVISION WAS RECOMMENDED FOR APPROVAL BY THE WATER MANAGEMENT BRANCH, DATE OF LETTER IS _____
 INFORMATION ON SUBDIVISION OR TRACT OF LAND/SPECIAL RESTRICTIONS:

evaluated by JWB on SEPTEMBER 30, 1996

AQUIFER	ELEVATION		NET SAND	DEPTH TO		ANNUAL APPROP A-F	STATUS
	BOT.	TOP		BOT.	TOP		
UPPER DAWSON	----	----	----	----	----	----	---
LOWER DAWSON	----	----	----	----	----	----	---
DENVER	----	----	----	----	----	----	---
UPPER ARAPAHOE	5703	6141	165	567	129	11.220	NMT
LOWER ARAPAHOE	----	----	----	----	----	----	---
LARAMIE-FOX HILLS	5243	5523	176	1028	748	10.500	NT

note: E indicates location is at aquifer boundary and values may be more approximate.
 * indicates the proposed aquifer.

All values are interpolated from the S.B.5 data base assembled in November of 1986.

10/1/96 - JWB calling app for legal div. - no answer

STATE OF COLORADO

OFFICE OF THE STATE ENGINEER
Division of Water Resources
Department of Natural Resources

1313 Sherman Street, Room 818
Denver, Colorado 80203
Phone (303) 866-3581
FAX (303) 866-3589



September 17, 1996

Roy Romer
Governor

James S. Lochhead
Executive Director

Hal D. Simpson
State Engineer

MS ANGELA WINGARD MANAGER
UPPER BIG SANDY GWMD
35194 EAST HIGHWAY 24
RAMAH CO 80832

Subject: Ronnie & Becky Moyer permit application for a new residential well (Rec.#406119)

Dear Ms. Wingard:

As discussed in Section 37-90-111(3) C.R.S., we are requesting written recommendations concerning this application from the Board of Directors of your District. If such recommendations are not received within 35 days of the date of this letter, the application will be processed in accordance with existing statutes, Ground Water Commission Guidelines or policies, the applicable rules and regulations of your District, and policies as directed by the State Engineer.

If emergency conditions exist, the processing of this application will be expedited by you relaying the recommendations of your Board by telephone. Recommendations given by phone should be followed up by a letter.

If you have any questions concerning the application, please contact me.

Sincerely,

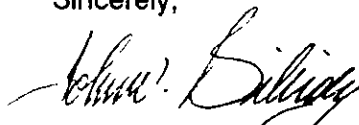
John W. Bilisoly
Engineering Technician
Designated Basins

JWB/jb
Attachment(s)

cc: Applicant

/Form #3097.mrg

STATE OF COLORADO

OFFICE OF THE STATE ENGINEER
Division of Water Resources
Department of Natural Resources
1313 Sherman Street, Room 818
Denver, Colorado 80203
Phone (303) 866-3581
FAX (303) 866-3589

RECEIVED
OCT 17 1996



WATER RESOURCES
STATE ENGINEER
2017

Roy Romer
Governor
James S. Lochhead
Executive Director
Hal D. Simpson
State Engineer

TO: Ronnie & Becky Moyer
RECEIPT NO.: 406119

FROM: John W. Bilisoly
DATE: October 1, 1996

JWB

Your application for a permit to construct a well is being returned for the reason(s) listed below. The amendments and/or additional information or documentation requested is required before we can proceed with the evaluation of your application.

All amendments made to the application must be typed or printed in **BLACK INK**. Please **initial and date all amendments made then return the application and all attachments to this office**. If you have any questions, please contact this office.

Please submit a full legal description or surveyor's plat map of your 40 acre tract so the boundaries of it can be plotted on our office maps. This description is requested in Item (5) on the application, but was not provided. Thank you.

Make a copy of warranty deed

RECEIVED
OCT 17 1996

5.00
1.00

KNOW ALL MEN BY THESE PRESENTS, That
Dickie Dale Tracy

of the County of Pueblo, and State of Colorado,

for the consideration of TEN DOLLARS AND OTHER GOOD AND VALUABLE CONSIDERATION Dollars,

in hand paid, hereby sell and convey to

Becky K. Moyer
of the County of El Paso, and State of Colorado,

the following real property, situate in the County of ~~Pueblo~~ El Paso

and State of Colorado, to-wit:

The East Half of the Southeast Quarter of Section 8, and the Northeast Quarter of the Northeast Quarter of Section 17, all in Township 11 South, Range 60 West of the 6th P. M., El Paso County, Colorado.

STATE DOCUMENTARY

JUL 26 1995

FEE 9.25

DF 9.25

COMMONLY KNOWN AS: Chelton Road

SDF: 9.25

with all its appurtenances, and warrant the title to the same, subject to general taxes for the current year, subsequent taxes and assessments, easements, covenants and restrictions of record.

Signed and delivered this

24 day of July, A.D. 1995

in the presence of

Dickie Dale Tracy (SEAL)
Dickie Dale Tracy

(SEAL)

(SEAL)

STATE OF COLORADO

ss.

It was acknowledged before me this
Dale Tracy

24 day of July

my official seal.

8-7-96

Kan C. DeWaters

Notary Public.

*If by natural person or persons here insert name or names: if by person acting in representative or official capacity or as attorney-in-fact, then insert name of person as executor, attorney-in-fact or other capacity or description. If by officer of corporation, then insert name of such officer or officers, as the president or other officers of such corporation, naming it. — STATUTORY ACKNOWLEDGMENT, Session 1927. WARRANTY DEED

MIA 36510 E. Ramah Rd, Ramah, Co. 80832

Best Copy Available

Meyer

RECEIVED
OCT 17 1996

WATER RESOURCES
STATE ENGINEER
COLD.

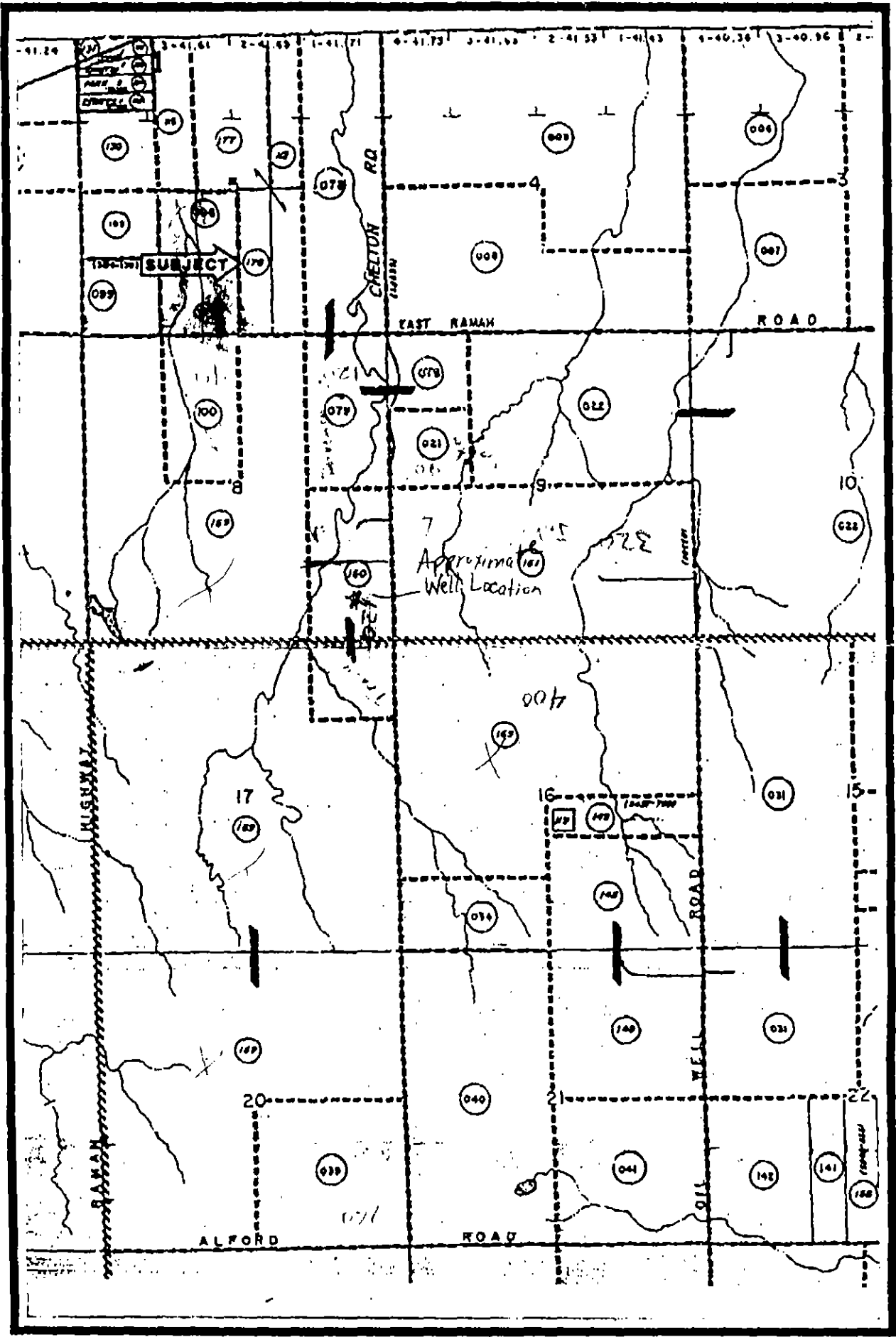

Plat Map

RECEIVED

OCT 30 1996

UPPER BIG SANDY
GROUND WATER MANAGEMENT DISTRICT

35194 E. Hwy 24
Ramah, Colorado 80832

October 18, 1996

Mr. John Bilisoly
Engineering Technician
Designated Basins
Office of State Engineer
1313 Sherman Street, Room 818
Denver, Colorado 80203

Dear Mr. Bilisoly:

The Board of Directions approved the following well permits at their meeting
October 17, 1996.

Jennie L. Montoya - New Residential Well (Rec.# 406179) - El Paso Co.
→ Ronnie & Becky Moyer - New Residential Well (Rec.#406119) El Paso Co.
J. J. Moreland - New Domestic & Livestock well - Rec.# 406776). Elbert Co.
Jess Solomon - New Residential & Livestock well - (Rec.#407170) El Paso Co.

Sincerely,

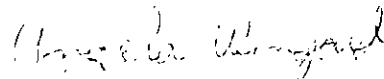

Angela Wingard
Manager