

360 NORTH
 A CONDOMINIUM
 IN SEC. 15, TWP. 35-S, RGE. 16-E
 MANATEE COUNTY, FLORIDA
 TOWN OF LONGBOAT KEY

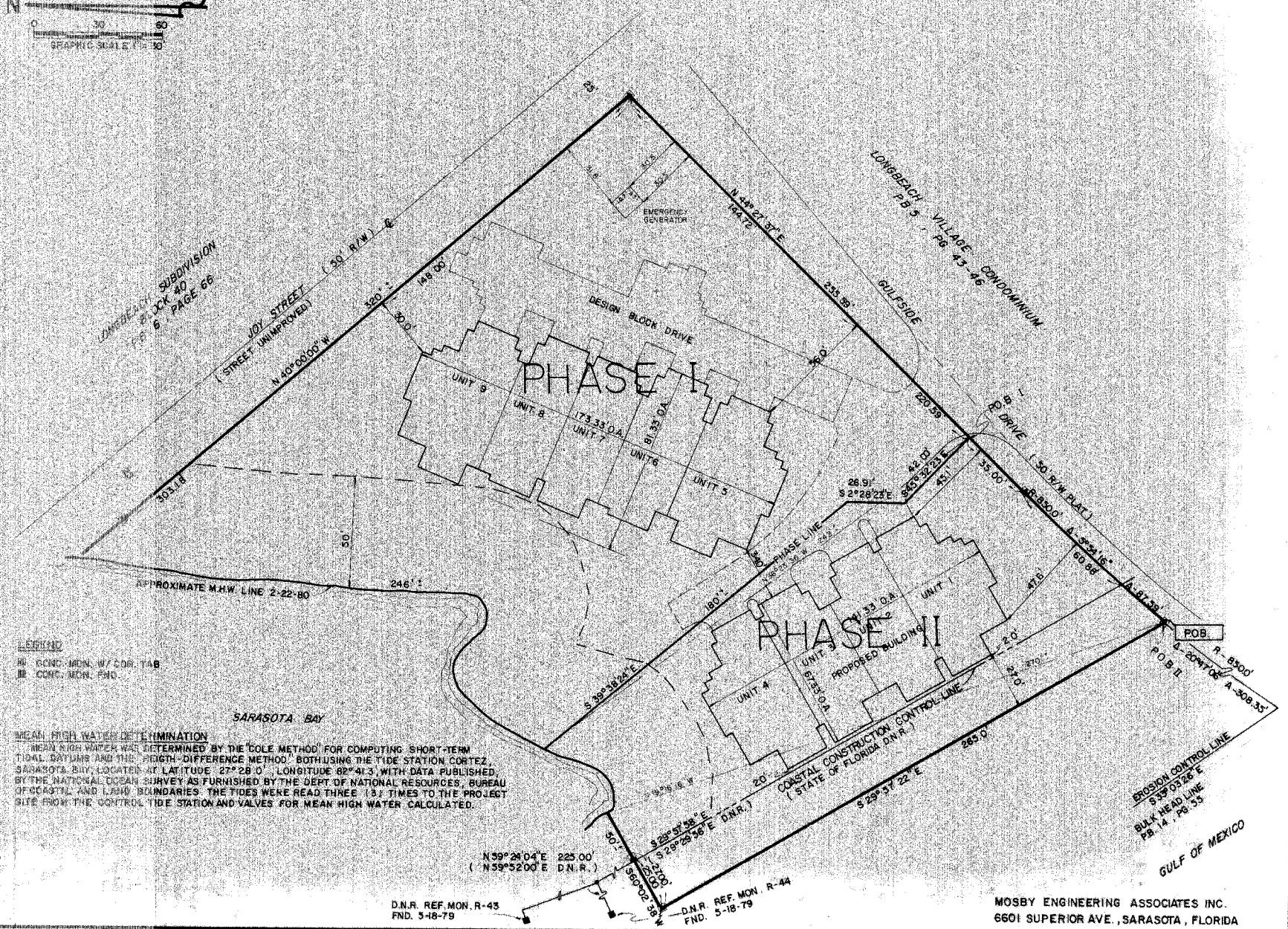

LEGEND
 ■ CONC. IRON W/ COR. TAB
 ■ CONC. MON. PND

MEAN HIGH WATER DETERMINATION
 MEAN HIGH WATER WAS DETERMINED BY THE 'COLE METHOD' FOR COMPUTING SHORT-TERM TIDAL DATUMS AND THE 'HEIGHT-DIFFERENCE METHOD' BOTH USING THE TIDE STATION CORTEZ, SARASOTA, BAY, LOCATED AT LATITUDE 27° 28' 0" LONGITUDE 82° 41' 3" WITH DATA PUBLISHED BY THE NATIONAL COASTAL SURVEY AS FURNISHED BY THE DEPT. OF NATIONAL RESOURCES, BUREAU OF COASTAL AND LAND BOUNDARIES. THE TIDES WERE READ THREE (3) TIMES TO THE PROJECT SITE FROM THE CONTROL TIDE STATION AND VALUES FOR MEAN HIGH WATER CALCULATED.

D.N.R. REF. MON. R-43
 FND. 5-18-79

D.N.R. REF. MON. R-44
 FND. 5-18-79

MOSBY ENGINEERING ASSOCIATES INC.
 6601 SUPERIOR AVE., SARASOTA, FLORIDA