



July 2020 PTAC Meeting: City Update

Agenda

1. MBTA Ridership Intro + COVID Impacts
2. Somerville Coordination w/ MBTA
3. Washington St Queue Jump
4. 2019 Ped/Bike Count Results
5. FY21 Mobility Operating Budget
6. Shared Streets Updates

MBTA Ridership – Routes in Somerville

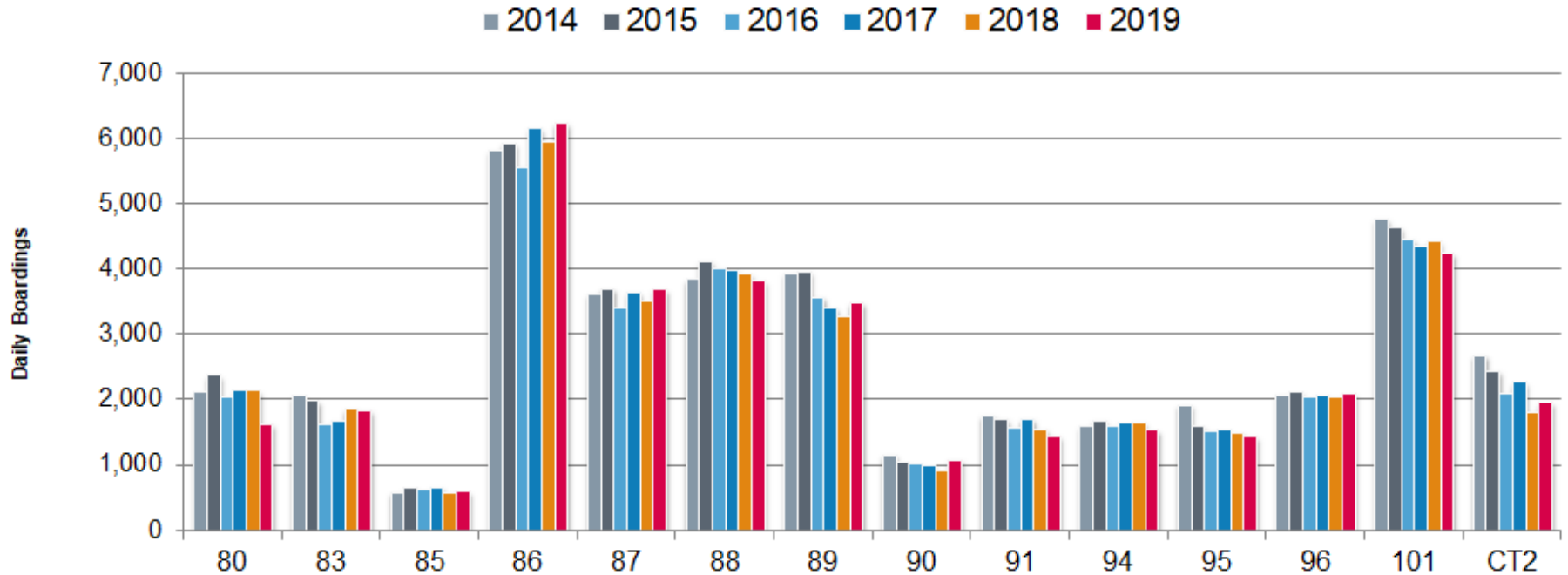

Note: average daily weekday ridership for fall season

- Ridership trends largely mirror MBTA-wide and national trends for bus transit
- These data reflect total route ridership (i.e. include boardings for stops outside Somerville boundaries)
- National and local customer surveys indicate that bus reliability is the most important influence on ridership

MBTA Ridership – COVID Impacts

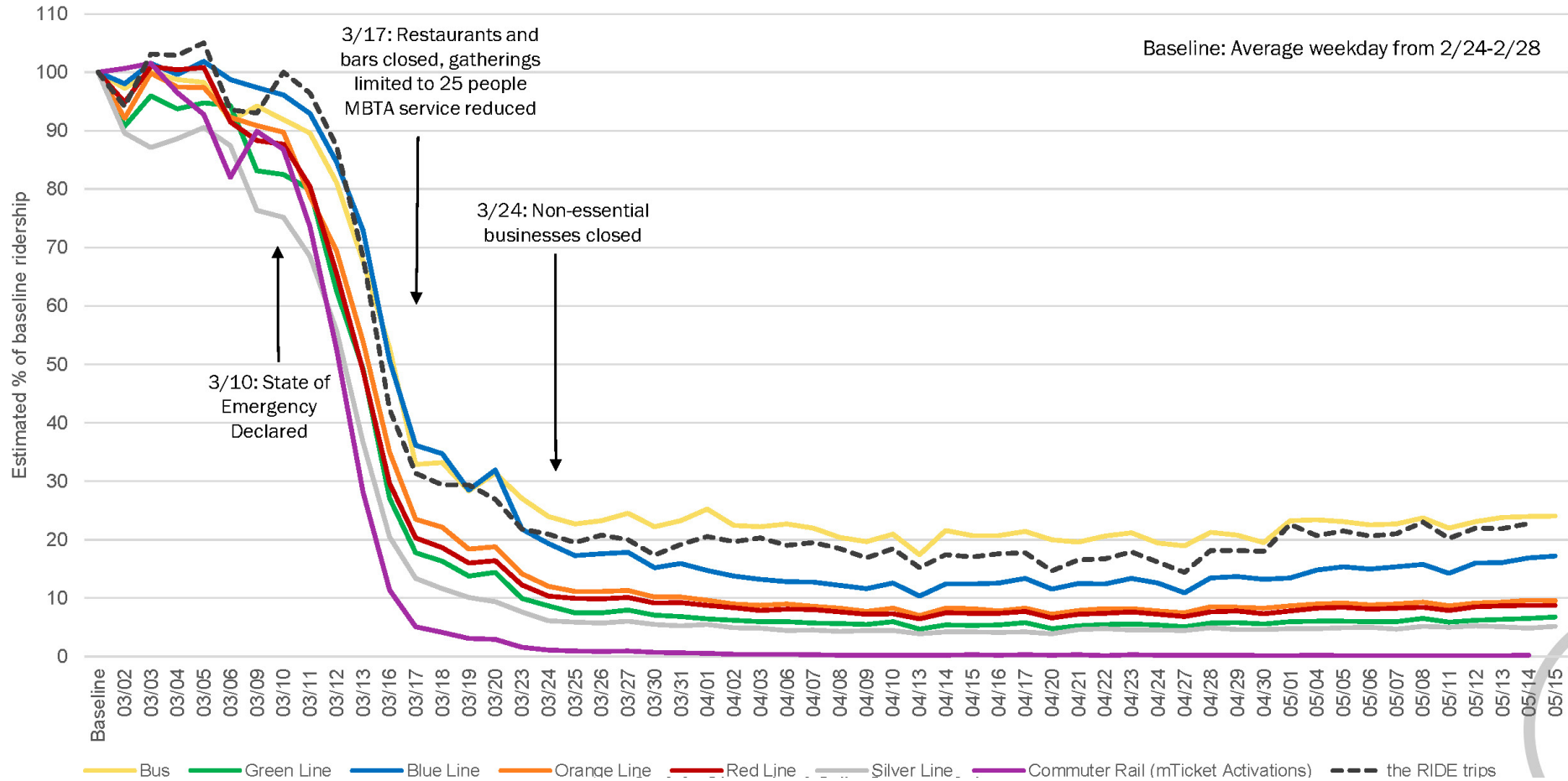

- Ridership continues to inch up steadily on each mode
- Since mid-May → 15% increase each week on buses and a 9% increase each week on subway.
- Ridership compared to baseline: Bus = 30%; Subway = 13%; Commuter Rail = 3.5%; The RIDE = 29%

MBTA Ridership – Somerville Bus COVID Impacts

MBTA Bus Ridership Compared with Baseline (3/16 thru 6/19)

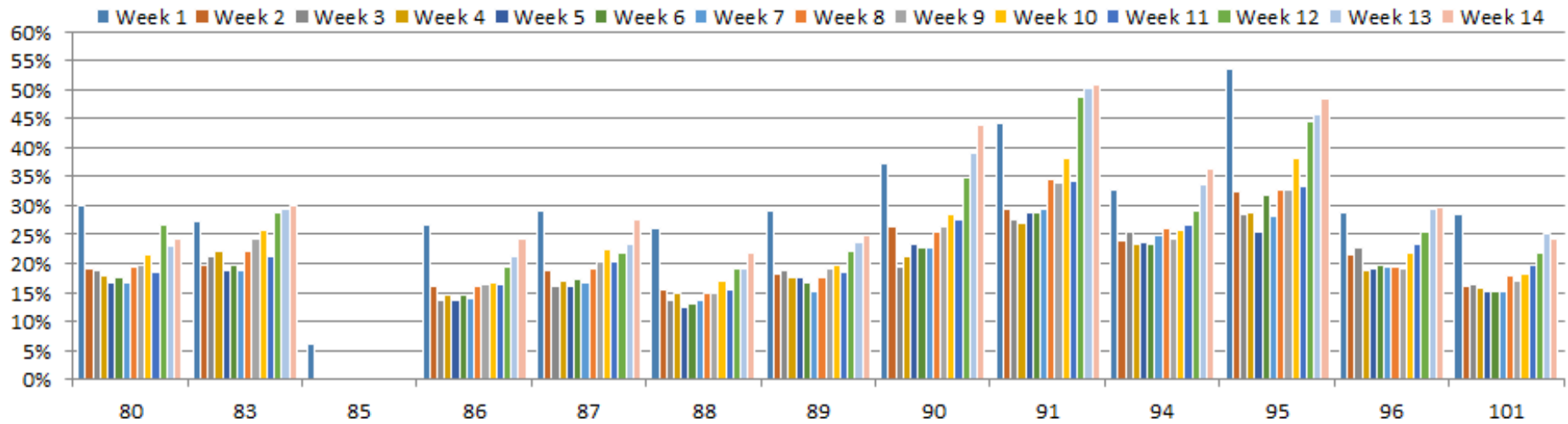

- All routes continue to run well below baseline
- Some routes did not fall as far – and recovered more quickly
- The 85 bus is not currently operating.

MBTA Coordination

- As needed, we reach out to contacts on the service planning team with issues, sign requests, data requests, etc.
- Regular monthly meetings held with Transit Priority Team, along with service planning staff
- Regular monthly coordination meetings with Boston, and Cambridge, and MBTA

MBTA Coordination

- Bus Stop Amenities
 - Shelters mostly installed, operated, and maintained by JCDecaux through the MBTA's existing street furniture program and supported by advertising
 - Smaller number are either City of MBTA owned and do not have advertising panels.
 - Benches are owned by the city and maintained by DPW
- GLX Coordination
 - In general: City has been reviewing design packages and providing input for the past few years.
 - Right now: the design of stations is essentially complete, city is consulted on any change orders but major changes are not expected

Washington Street Bus Lane

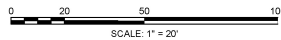
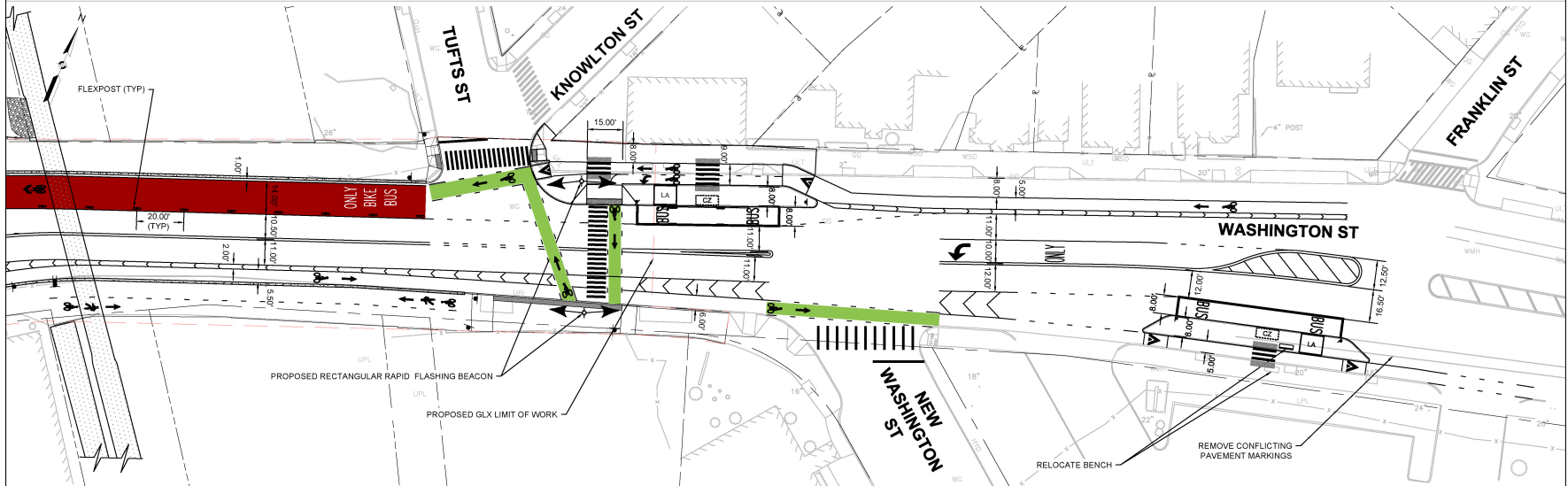
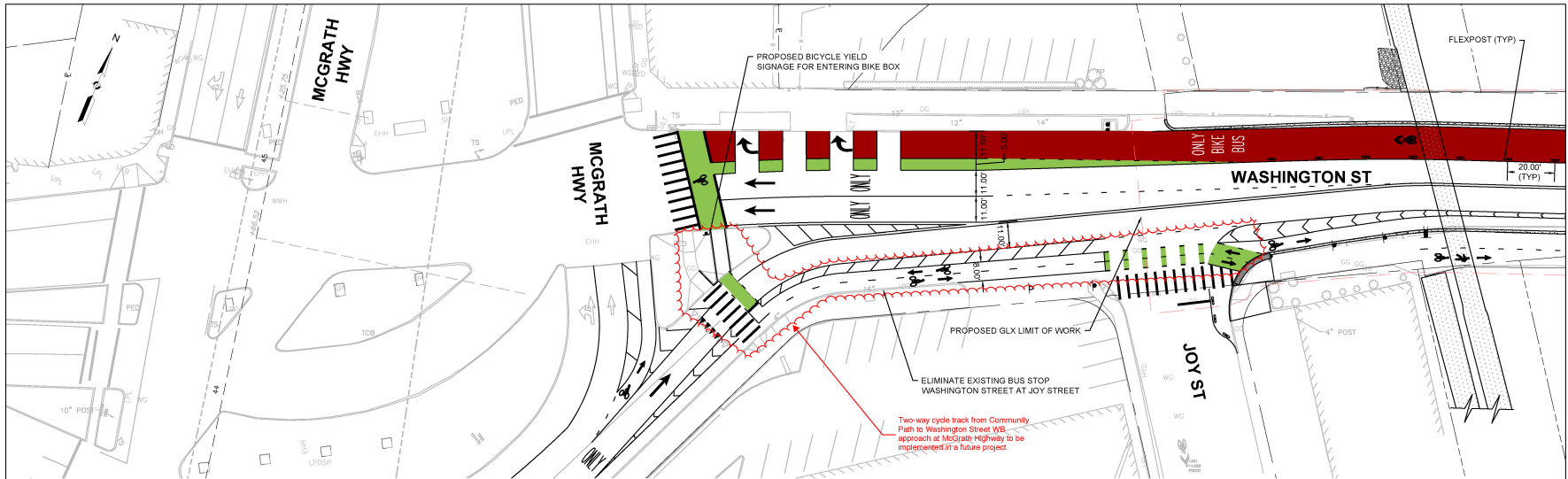

WASHINGTON STREET UNDERPASS
REVISED PAVEMENT MARKING CONCEPT
CONCEPT
SOMERVILLE, MA

Ped/Bike Counts

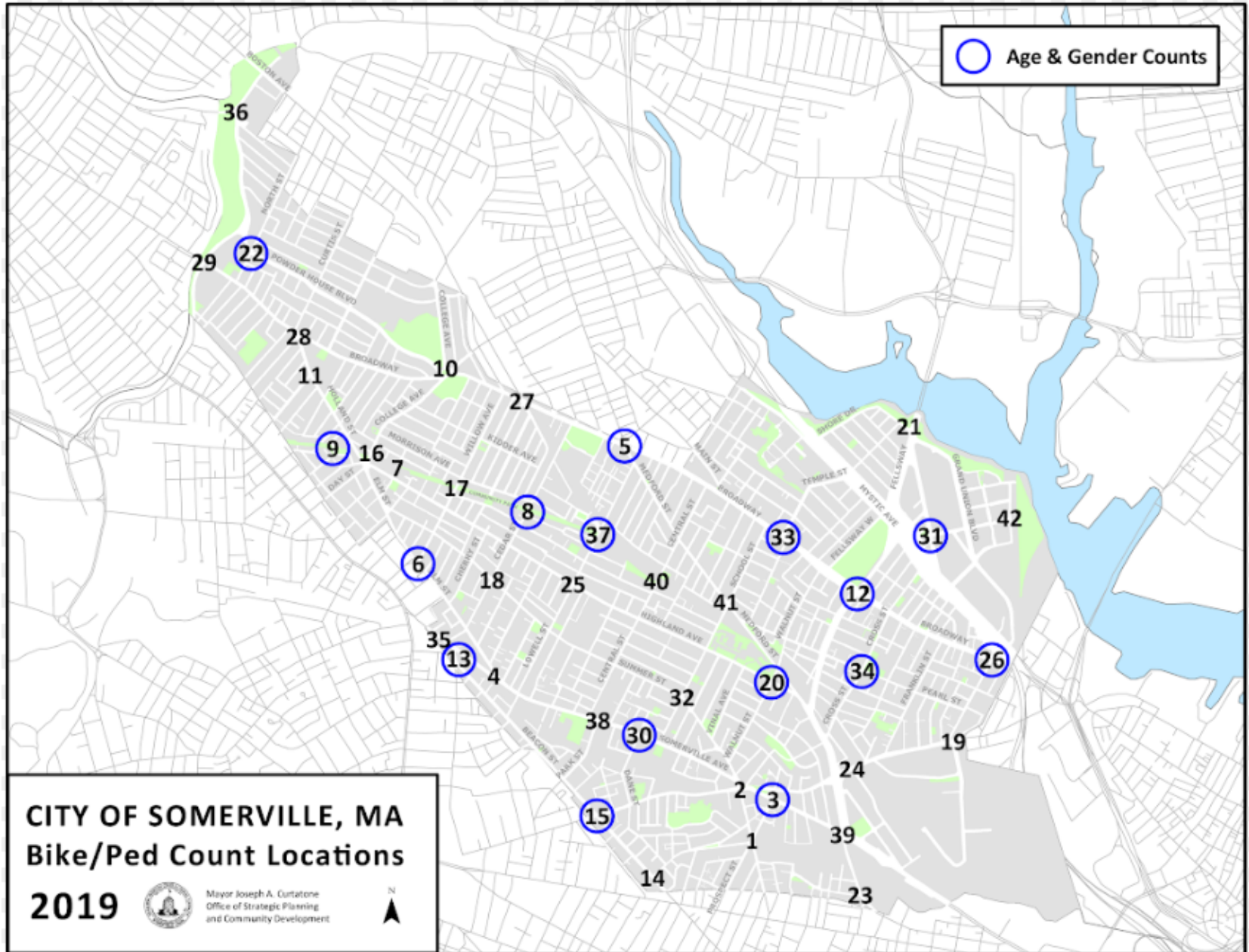

Ped/Bike Counts

Average Number of Bicyclists and Pedestrians Counted at an Intersection

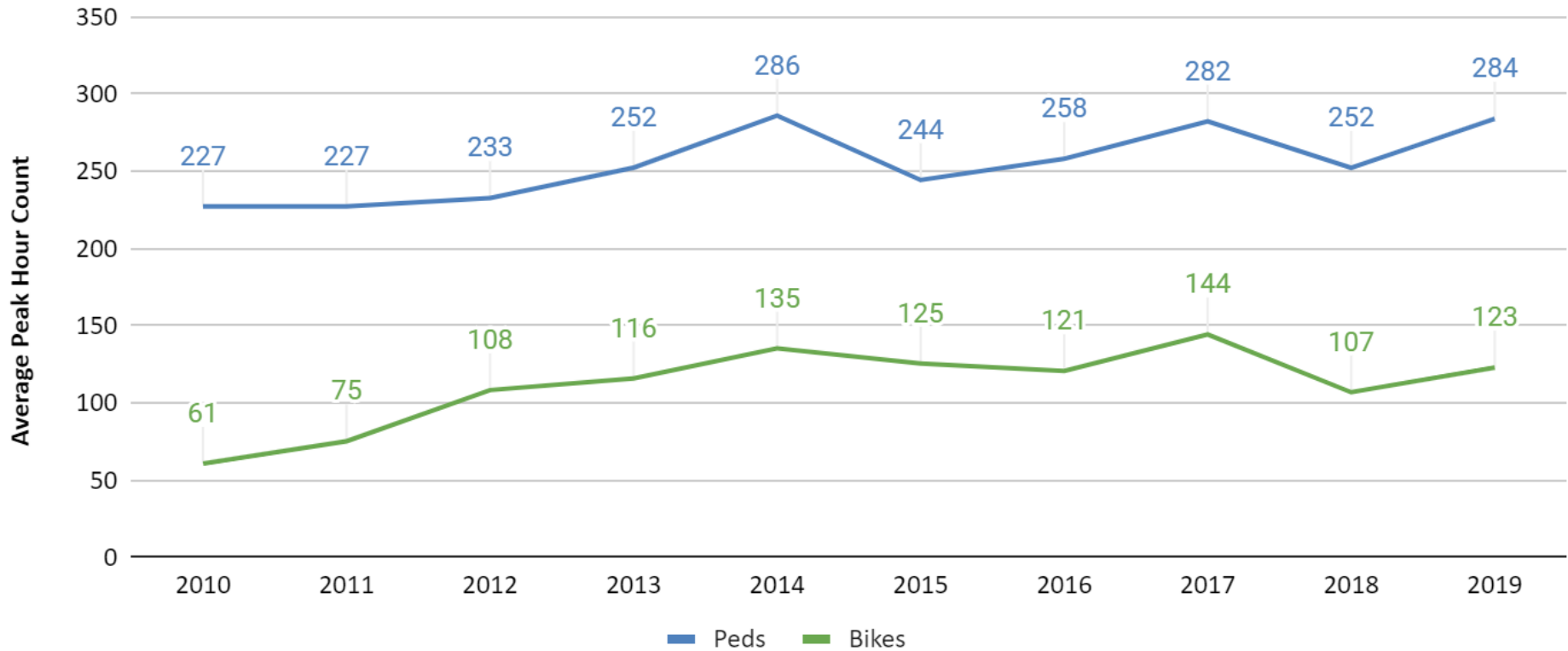

Peak Hour Pedestrian Counts

Morning Peak Hour Pedestrian Counts - October 2019

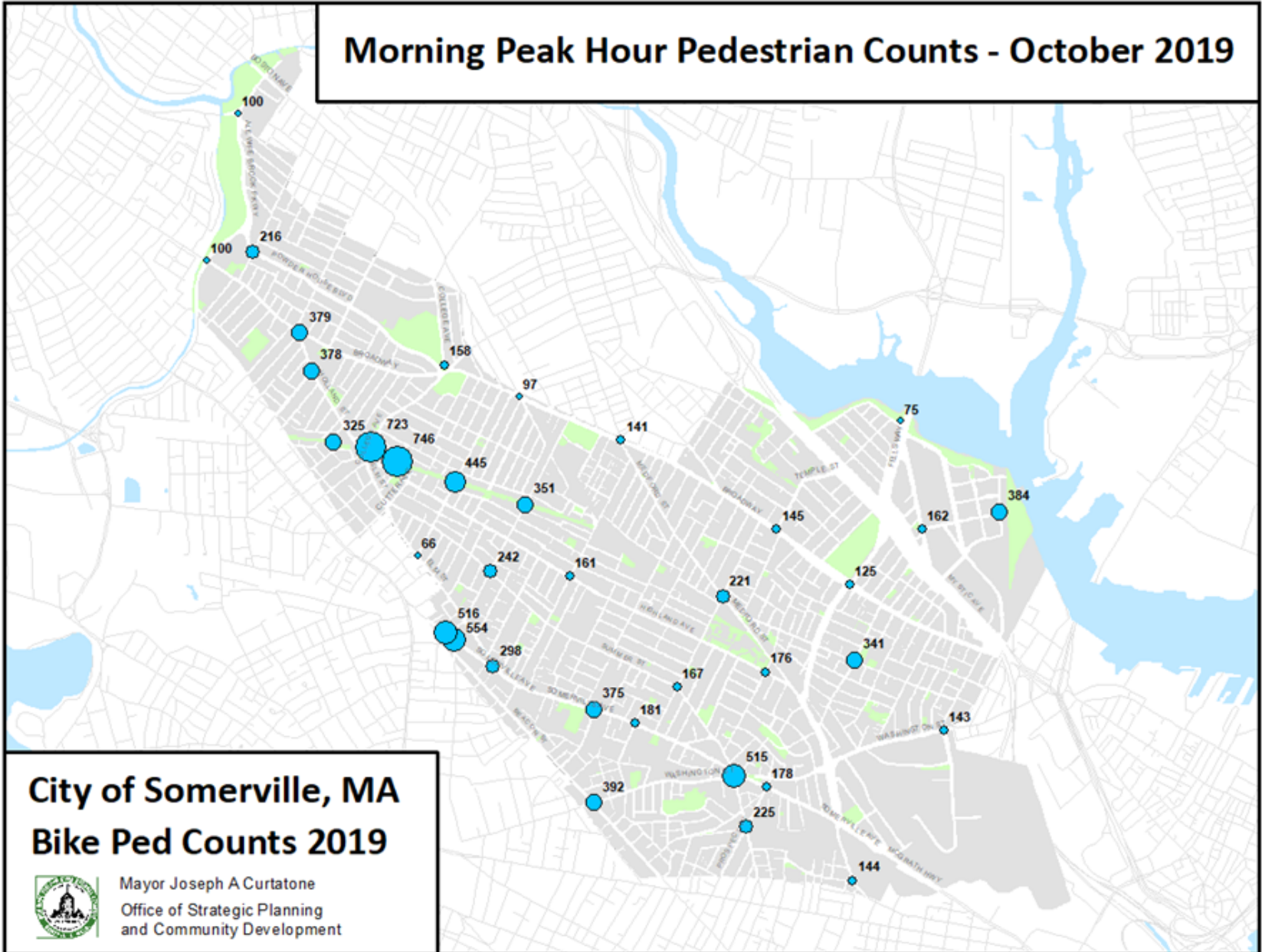

City of Somerville, MA
Bike Ped Counts 2019



Mayor Joseph A. Curtatone
Office of Strategic Planning
and Community Development

Peak Hour Pedestrian Counts

Evening Peak Hour Pedestrian Counts - October 2019

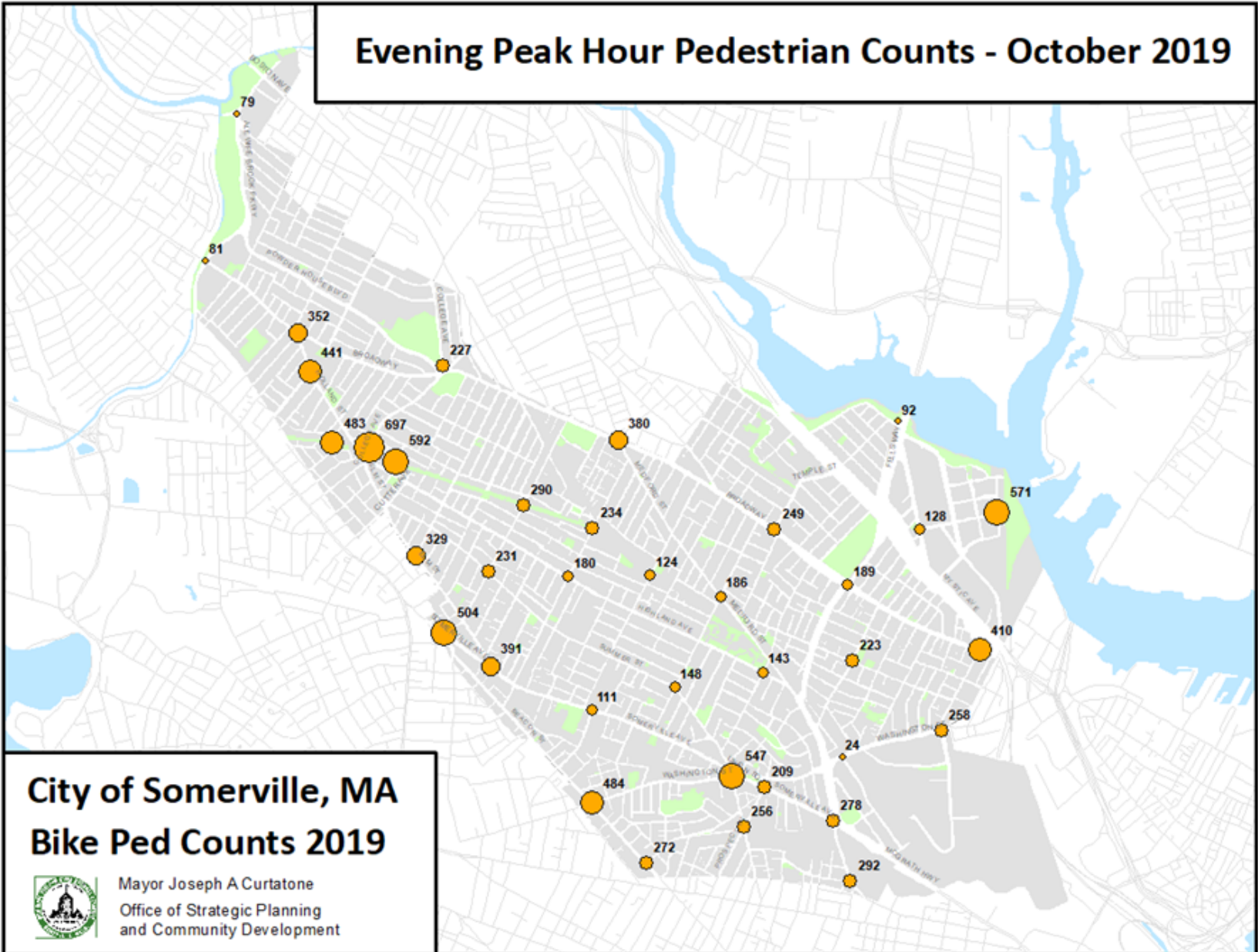

City of Somerville, MA
Bike Ped Counts 2019



Mayor Joseph A. Curtatone
Office of Strategic Planning
and Community Development

Peak Hour Pedestrian Counts

Morning Peak Hour Pedestrian Counts - 2019 vs 2018

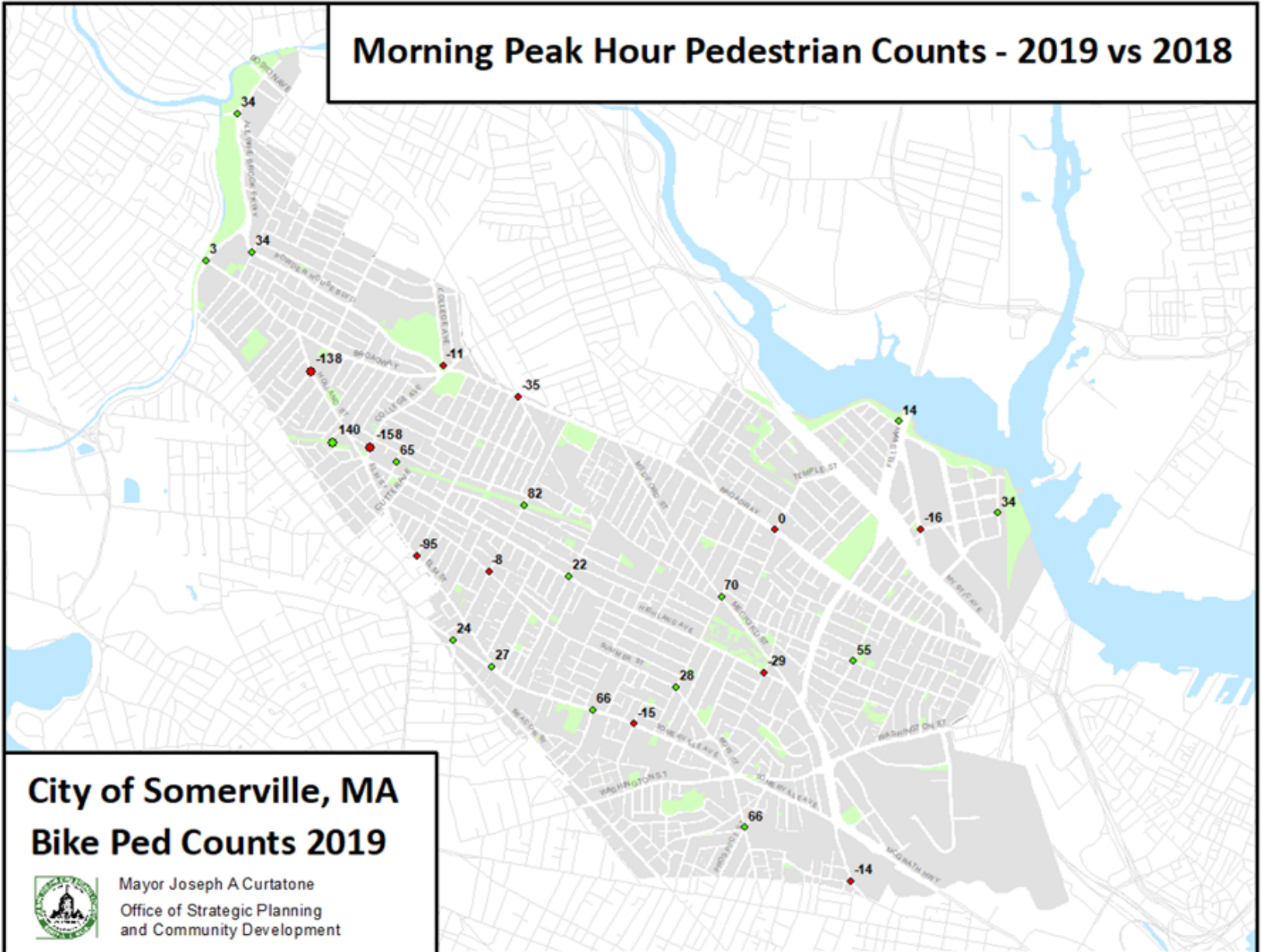

City of Somerville, MA Bike Ped Counts 2019



Mayor Joseph A Curtatone
Office of Strategic Planning
and Community Development

Peak Hour Pedestrian Counts

Evening Peak Hour Pedestrian Counts - 2019 vs 2018

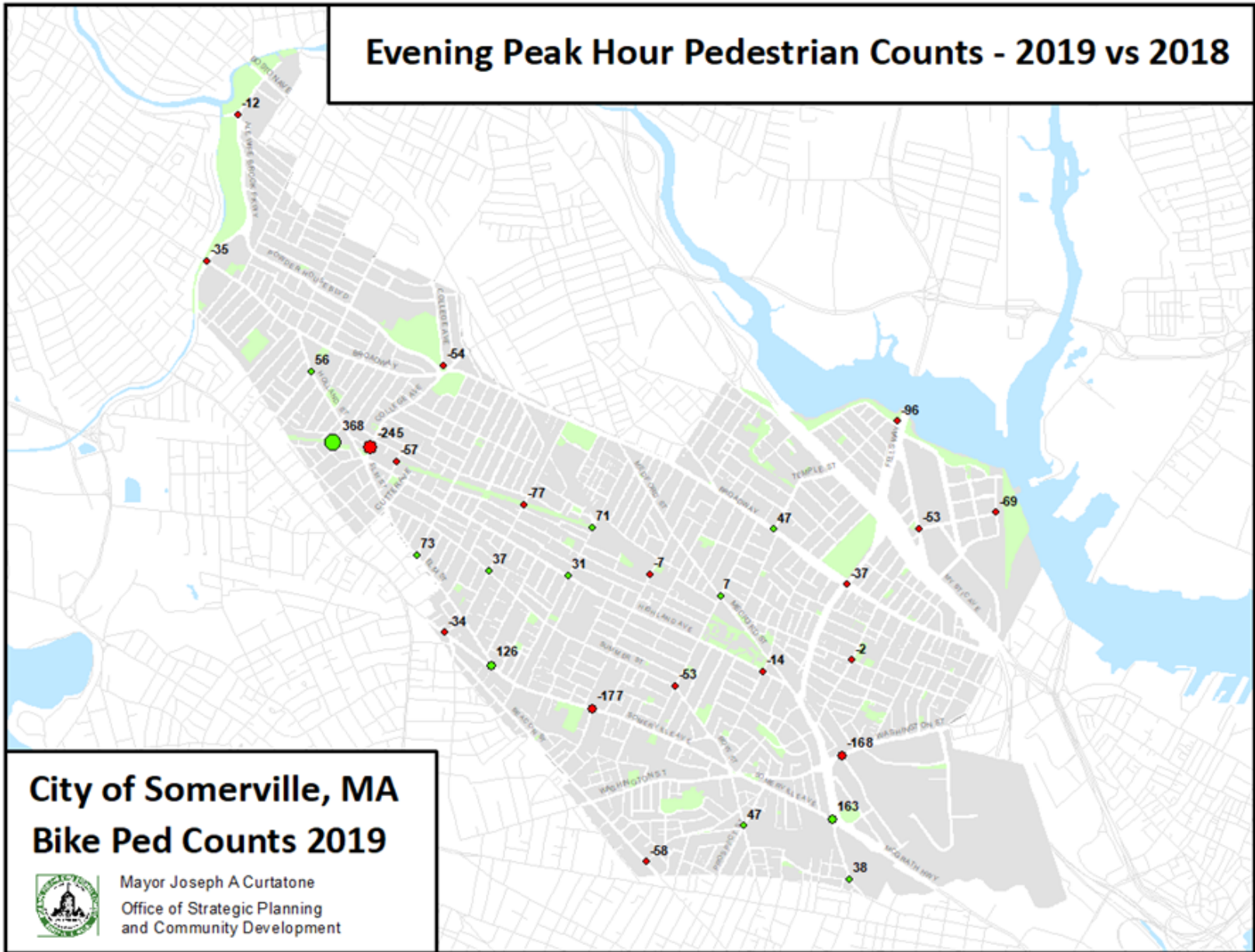

City of Somerville, MA
Bike Ped Counts 2019



Mayor Joseph A Curtatone
Office of Strategic Planning
and Community Development

FY21 Mobility Budget Proposal

OSPCD - MOBILITY	FY19 ACTUAL	FY20 BUDGET	FY20 THRU 4/30	FY21 PROPOSED	% CHANGE
OSPCD - MOBILITY OM					
530000 PROFESSIONAL & TECHNICAL SVC	96,464	215,000	24,433	215,000	
530018 POLICE DETAIL	-	1,000	-	1,500	
553001 SIGNS AND CONES	394	500	-	1,000	
573000 DUES AND MEMBERSHIPS	9,438	8,000	68	8,000	
OSPCD - MOBILITY OM TOTAL	106,295	224,500	24,500	225,500	0.4%
OSPCD - MOBILITY PS					
511000 SALARIES	600,432	334,458	247,082	303,106	
515006 HOLIDAYS NON-UNION	-	-	-	1,162	
OSPCD - MOBILITY PS TOTAL	600,432	334,458	247,082	304,268	-9.0%
OSPCD - MOBILITY TOTAL	706,727	558,958	271,583	529,768	-5.2%

- Mobility Professional & Technical Services (215k) proposed breakdown:
 - \$60,000 for Pearl St design services
 - \$60,000 for Washington St design services
 - \$65,000 for Holland/College/Davis (street & signal design work)
 - \$30,000 for Neighborways projects (includes shared streets supplies)

Shared Streets – Progress Map

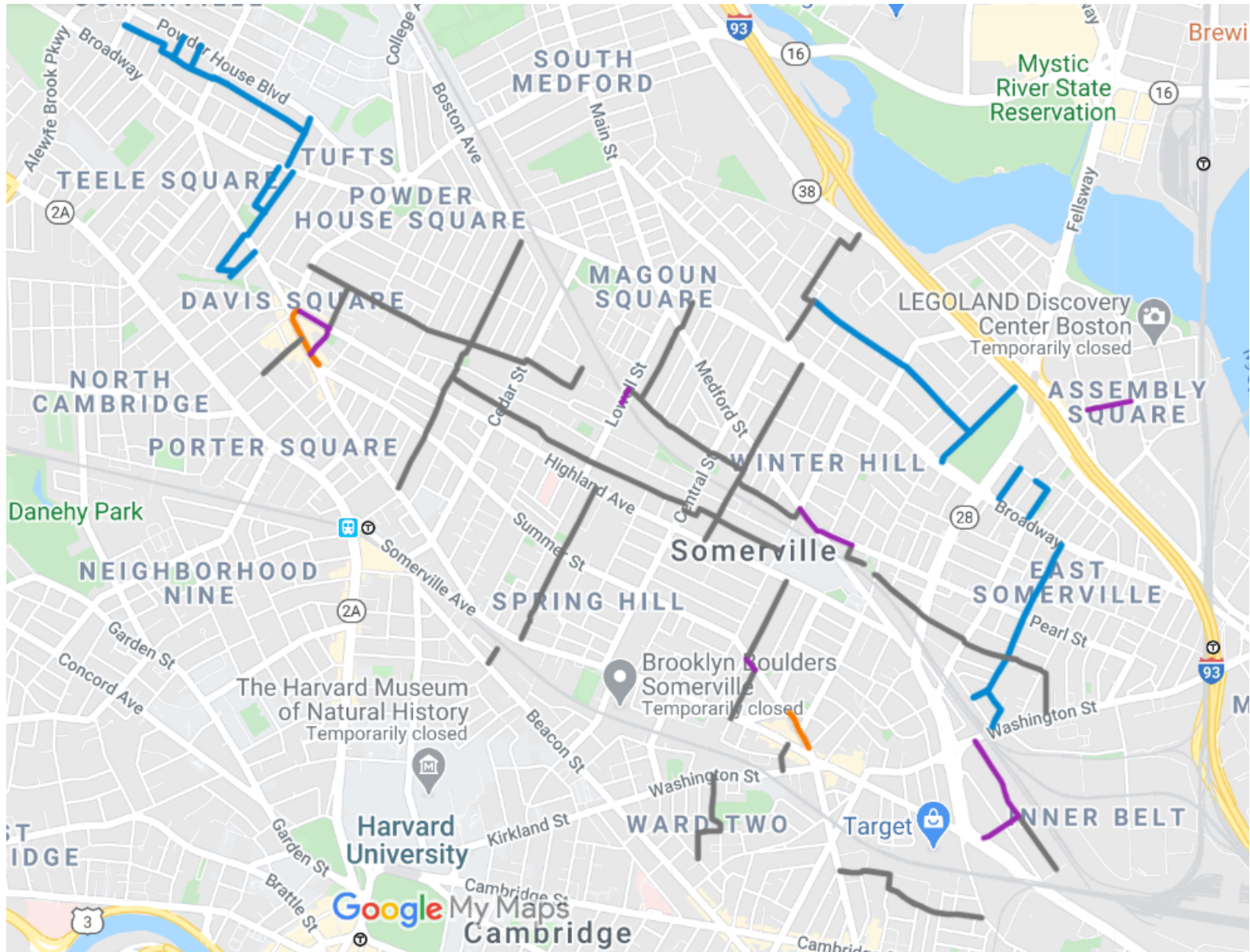

Shared Streets – Strategy Adjustment



Gateway treatments:
Focus of next phase



Midblock treatments:
Will continue after gateway treatment
rollout

- Original model: Deploy gateway and midblock treatments together
- Midblock treatments are more labor-intensive
- Proposed model: Install all gateway treatments to maximize citywide network
- Pursue midblock treatments opportunistically

Shared Streets – Spring Hill Route Options



2020/2021 Projects

Project Name	Owner	Type	Project Stage				
			Funding & Contracts	Design	Outreach	Traffic Commission	Construct
Somerville Ave Utility & Streetscape Improvements (SAUSI)	IAM	Full depth	✓	✓	✓		In progress
Powder House Blvd	IAM/Mobility	Full depth	✓	✓			
Lower Medford St	IAM/Mobility	Resurfacing	✓	In progress	✓		
Holland St	IAM/Mobility	Resurfacing	✓	In progress	In progress		
College Ave	IAM/Mobility	Resurfacing	✓	In progress	In progress		
West Broadway	Mobility	Quick Build	✓	In progress			
Powder House Circle	Mobility	Quick Build	In progress	In progress			
Clarendon Hill Rotary	Mobility	Full depth	✓	In progress			
Spring Hill Sewer Separation	IAM/Mobility	Full depth	✓	In progress	In progress		
Gilman Square Streetscape	IAM/Mobility	Full depth	✓ (for 25% design)	In progress	In progress		
Ball Square Streetscape	IAM/Mobility	Full depth	In progress				
Union Square Streetscape	IAM/Mobility	Full depth	✓ (for design)	In progress			
Grand Union Blvd	Mobility	Quick Build		In progress			
Shore Drive	Mobility	Quick Build		In progress			
Washington St West	IAM/Mobility	Resurfacing					
Pearl St	IAM/Mobility	Resurfacing					

Meeting with Cambridge staff this week

Virtual meeting w/ project updates tentative for 8/13

2020/2021 Plans and Studies

Plan/Study Name	Owner	Timeline	Status
Vision Zero Action Plan	Mobility	Plan release in April	finalizing plan; developing implementation tracking system; forming internal working group
Citywide Parking Study	Parking/Mobility	Phase 1: By June Phase 2: FY21	Delayed given budget concerns
Bicycle Network Plan	Mobility	FY21 release	Delayed given budget concerns; rescoping for a multimodal approach
MassDOT Route 38 / Route 28 Planning Study & Project Design (see State Highways Tab here)	MassDOT	Planning and design now; Construction in FY22/23	Planning Study and initial concepts complete; MassDOT forming scope and schedule for TIP project; city coordinating with MassDOT on other improvements to advance
MBTA Better Bus Project	MBTA	2018-2021	MBTA budget proposal says delay by 1 year
NACTO Designing Cities Conference	Conference: NACTO Walkshops: Boston, Cambridge, & Somerville	Conference September 7-10, 2022	Delayed to 2022
Assembly Square Neighborhood Plan	Planning	2020+ Planning Process	Consultant responses under review; meetings expected in 2020
Brickbottom Neighborhood Plan	Planning	2020+ Planning Process	Process in development, more info coming soon

red text = updates

Shared Streets – Public Input

Over 5.5k visits to website

130 comments via email, web survey, web Q&A, web map, and 311

30 map entries

100 Surveys, emails, Q&A

- More, faster, year-round!
- Cars still need to be slowed, more traffic calming
- Challenges with materials holding up
- Getting the word out/people understanding shared streets
- Challenges with depicting shared streets in mapping apps

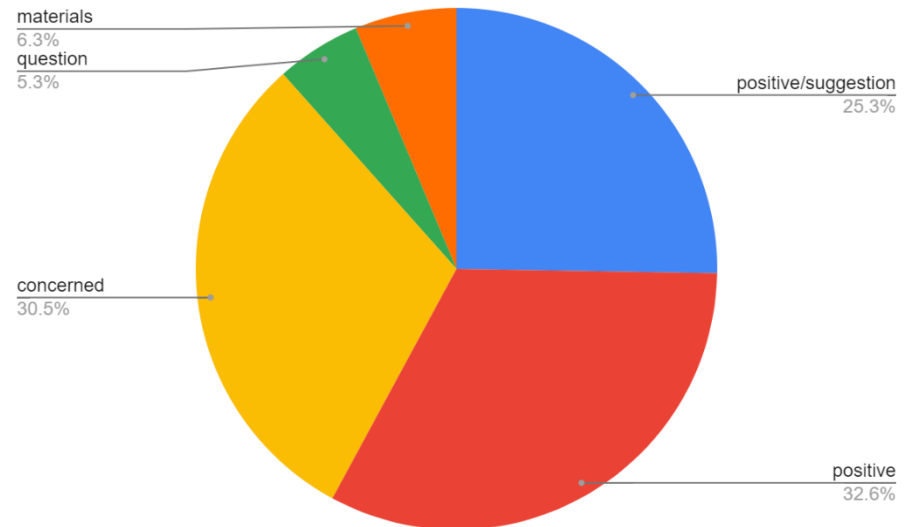

Shared Streets – Volunteer Program

Fairly good monitoring coverage

— Phase 1

- Could use more help in late July and August on:

Knowlton and Morton

Kensington, Blakeley, Cross

Jaques

— Phase 2

- Still need several volunteers for late July and August

60 submissions of monitoring form

— Feedback

- Additional signs and street markings
- Indication that contraflow biking is allowed

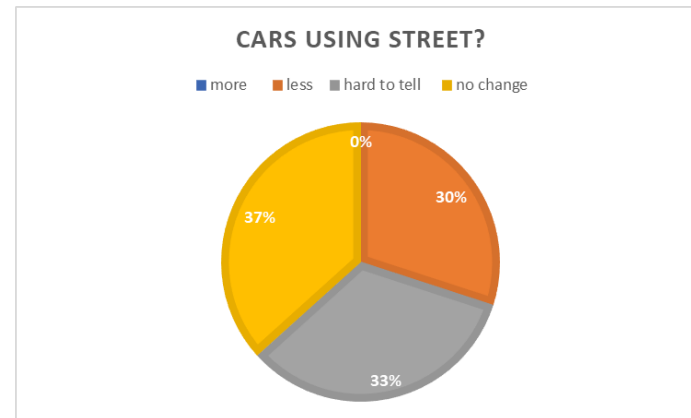
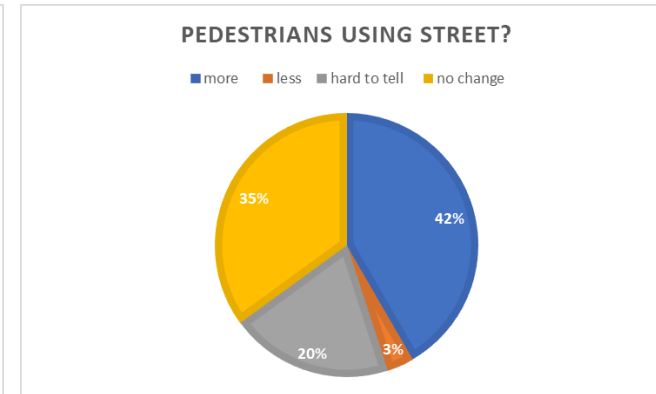
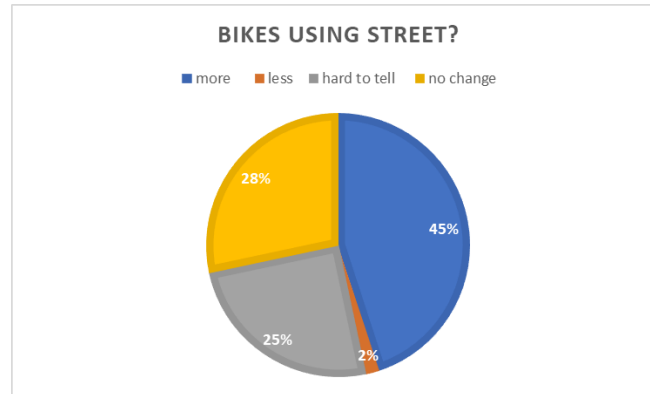

Ped/Bike Counts

% Change in Peak Hour Average (2010-2019)

