

Serviceberry Street Tree to Accommodate Overhead Wires



Fox Sedge



Pennsylvania Sedge

See Page L4 for Plant List



3' Metal Fence



Permeable Pavers at Building Exterior (Techo-bloc Hydra or equal)



Inverted U Bike Rack (Somerville Standard)



Black Steel Ribbon Street Bench (Somerville Standard)



LMPDE Planter at Retail Entry (Landscapeforms 'Rosa')



Reinforced Gravel Paving at Side Entry (Arenal Eco Pavers TrueGrid)



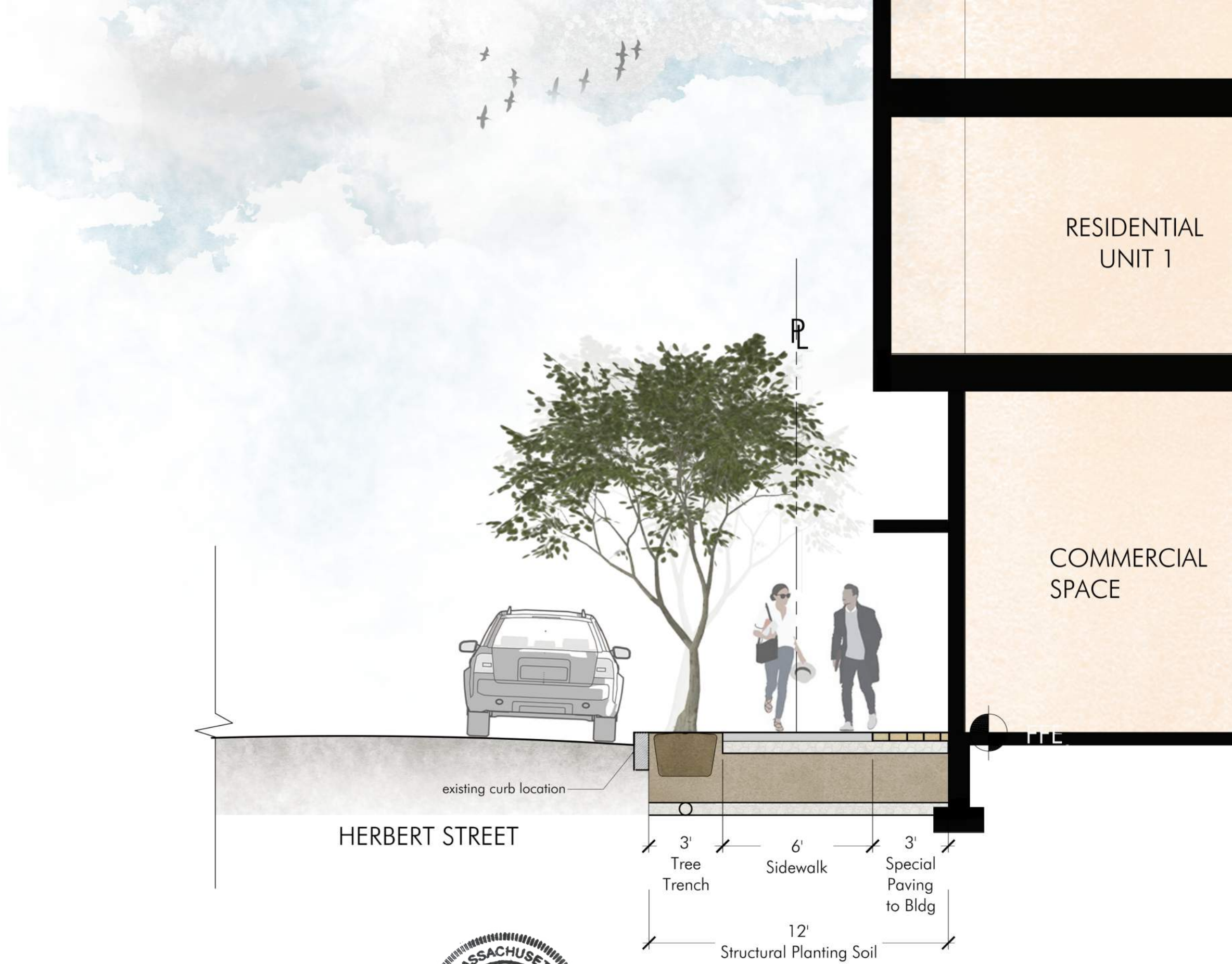



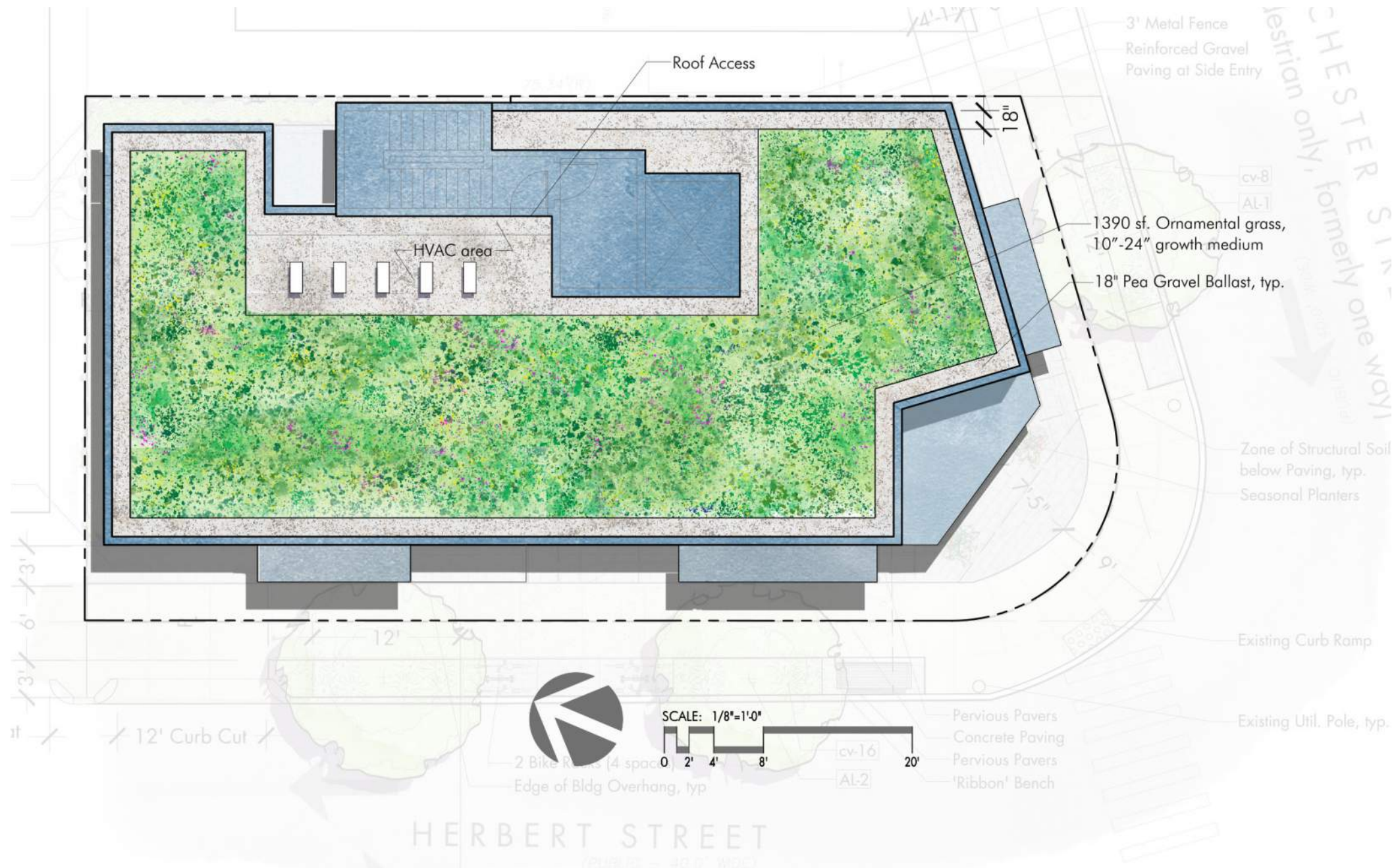

Purple Love Grass



Prairie Dropseed



Little Bluestem



Bottlebrush Grass

PROPOSED PLANT LIST: ROOFDECK

SYMB	QTY.	LATIN NAME	COMMON NAME	SIZE	NOTES
ORNAMENTAL GRASS					
es	275	Eragrostis spectabilis	Purple Love Grass	1 qt.	15" o.c.
sh	100	Sporobolus heterolepis	Prairie Dropseed	1 qt.	18" o.c.
ss	115	Schizachyrium scoparium	Little Bluestem	1 qt.	24" o.c.
eh	120	Elymus hystrix	Bottlebrush Grass	1 qt.	20" o.c.



Vegetated Roofdeck, 10"-24"  
Growth Medium



Pea Gravel Ballast



TREES TO BE REMOVED		
SPECIES	DBH (in)	COMMENTS
Japanese Yew	21 (multiple trunks cumulative sum)	Good Condition, Within proposed construction site

PROPOSED PLANT LIST: Chester 53

SYMB	QTY.	LATIN NAME	COMMON NAME	SIZE	NOTES
------	------	------------	-------------	------	-------

TREES

AL	3	Amelanchier laevis	Allegheny Serviceberry	2.5-3" cal.	B+B single stem
----	---	--------------------	------------------------	-------------	-----------------

PERENNIALS

cv	24	Carex vulpinoidea	Fox Sedge	1 gal.	Pot
cp	34	Carex pensylvanica	Pennsylvania sedge	1 gal.	Pot

PROPOSED PLANT LIST: ROOFDECK

SYMB	QTY.	LATIN NAME	COMMON NAME	SIZE	NOTES
------	------	------------	-------------	------	-------

ORNAMENTAL GRASS

es	275	Eragrostis spectabilis	Purple Love Grass	1 qt.	15" o.c.
sh	100	Sporobolus heterolepis	Prairie Dropseed	1 qt.	18" o.c.
ss	115	Schizachyrium scoparium	Little Bluestem	1 qt.	24" o.c.
eh	120	Elymus hystrix	Bottlebrush Grass	1 qt.	20" o.c.

Somerville Green Score: 53 Chester Revised 8/27/24

Area or Number		Sq Ft Credit	Multiplier	Weighted Area	Score Value	% of Score
3,375						
Soils						
Landscaped area with a soil depth less than 24 inches	0	actual sq ft	0.3	0	0.000	0%
Landscaped area with a soil depth equal to or greater than 24 inches	97	actual sq ft	0.6	58.2	0.017	6%
Pervious Paving with 6 to 24 inches of subsurface soil or gravel	25	actual sq ft	0.2	5	0.001	1%
Pervious Paving with more than 24 inches of subsurface soil or gravel	151	actual sq ft	0.5	75.5	0.022	8%
Groundcovers						
Turf grass, mulch, and inorganic surfacing materials	0	actual sq ft	0.1	0	0.000	0%
Plants						
Vegetation less than two (2) feet tall at maturity	97	actual sq ft	0.2	19.4	0.006	2%
Vegetation at least two (2) feet tall at maturity	0	12	0.3	0	0.000	0%
Trees						
Small Tree	0	50	0.6	0	0.000	0%
Large Tree	0	450	0.6	0	0.000	0%
Preserved Tree	0	65	0.8	0	0.000	0%
Engineered Landscape						
Vegetated Wall	0	actual sq ft	0.1	0	0.000	0%
Rain gardens, bioswales, and stormwater planters	0	actual sq ft	1.0	0	0.000	0%
Green Roof with up to 6" of growth medium	0	actual sq ft	0.1	0	0.000	0%
Green Roof with 6"-10" of growth medium	0	actual sq ft	0.4	0	0.000	0%
Green Roof of 10"-24" growth medium	1390	actual sq ft	0.6	834	0.247	84%
Green Roof of over 24" growth medium	0	Calculate as if soils, groundcovers, plants, and trees				N/A

Green Score = 0.294

Required Score:  
Target Score:  
Actual Green Score:

Green Score District Requirements			
NR & UR	MR3 & MR4	MR5, MR6, & HR	FAB, CC, CB, CI
0.35	0.25	0.20	0.20
0.40	0.3	0.25	-
0.294	0.294	0.294	0.294

CONCRETE PAVING (PEDESTRIAN)

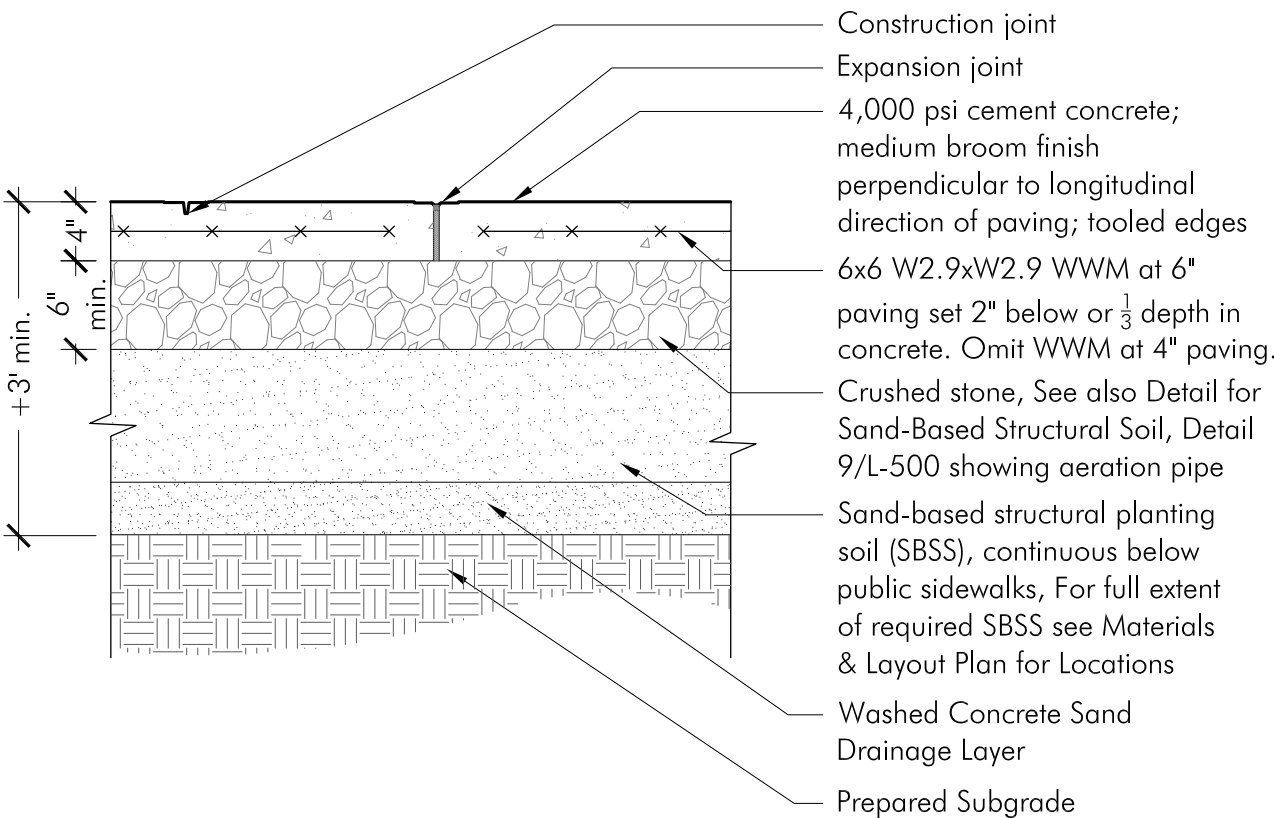

- Notes:
1. See Civil Engineer Plans + Details for additional information. Provide expansion joint between concrete paving & all structures unless specifically directed by owner or Landscape Architect.
  2. Provide 6" depth concrete at bike racks, benches and other site furnishings as noted on details.
  3. All construction joints shall be 5' o.c. typical unless otherwise noted.
  4. Expansion joints every 30' o.c. both ways and as noted.

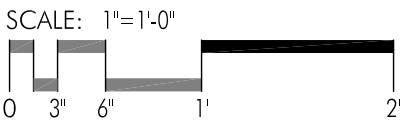

PERMEABLE UNIT PAVERS

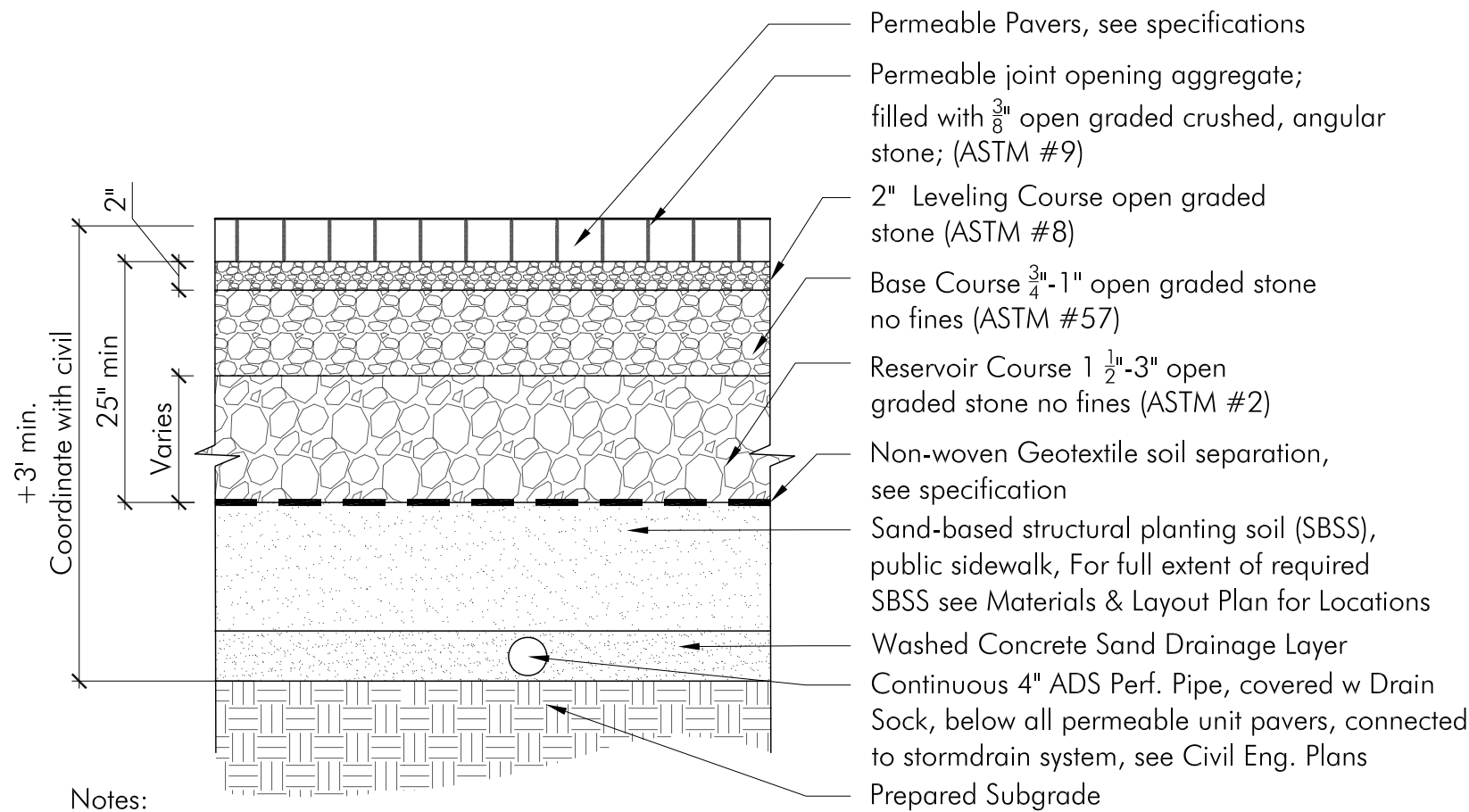

- Notes:
1. Edge restraints may vary.
  2. All aggregate material shall be crushed, angular stone and free of fines.
  3. Compact subsoil with a California bearing ratio (cbr) of less than 5% as directed by a professional engineer.
  4. Surface slope shall be a minimum of 1% and a maximum of 5%.
  5. Install pvc underdrain pipe where infiltration rate of subsoil is less than 0.5 in./hr. size as directed by a professional engineer.
  6. Never build permeable pavements on organic clay soils of high plasticity and/or peat, mulch, soils with high organic content.
  7. Maintain a minimum distance of 2' between bottom of permeable base and water table.
  8. The minimum aggregate thicknesses are after compaction.

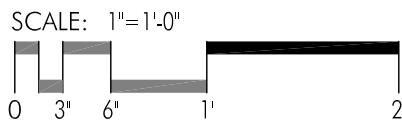

REINFORCED GRAVEL PAVING

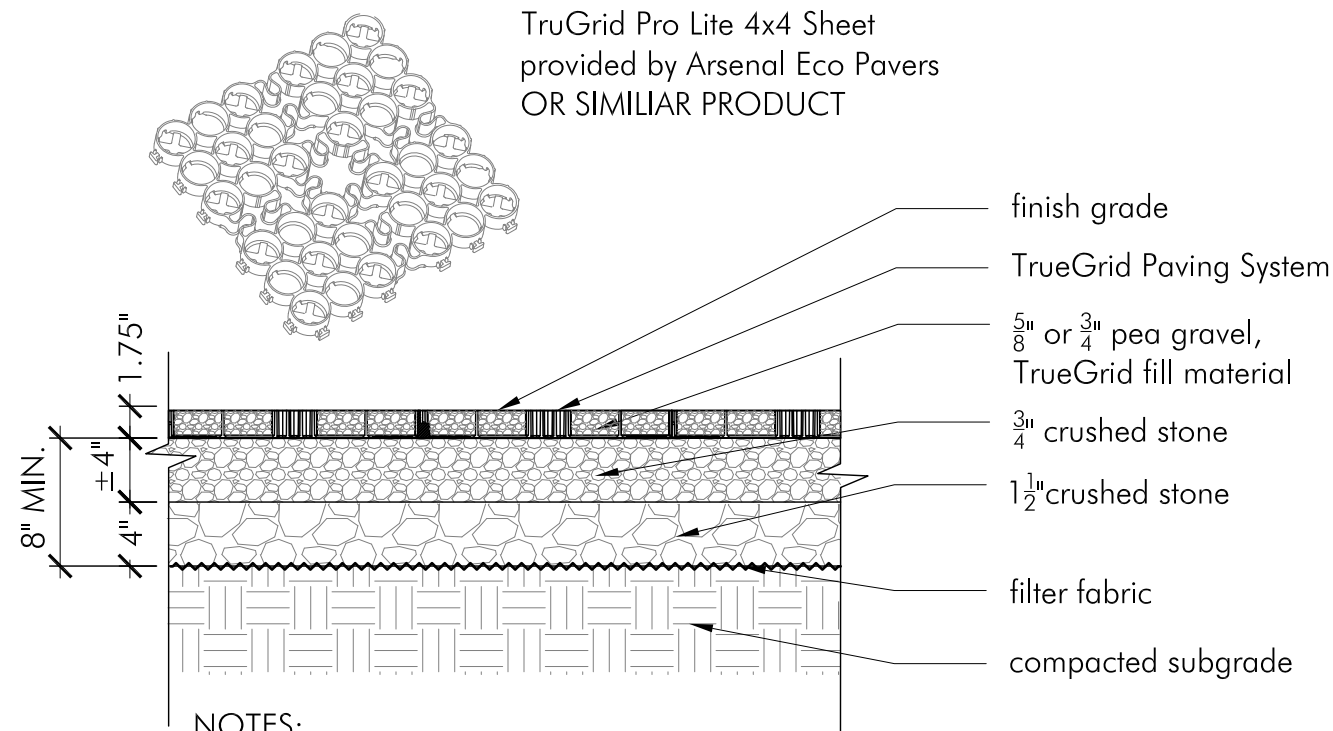

NOTES:

1. TruGrid Pro Plus by TrueGrid Paver provided by Arsenal Eco Pavers OR SIMILAR PRODUCT
  - 1.1. [arsenalecopavers.com](http://arsenalecopavers.com)
  - 1.2. See manufacturer's specifications
  - 1.3. Preassembled & delivered in 4'x4' sheet. Reconfigured as needed. No extra tooling or accessories required.
2. Geogrid mesh or geofabric may be required between subgrade and subbase for certain soils and site specific requirements.
3. No staking necessary when slope is  $<10^\circ$ .
4. Final engineered cross section aggregates and depth should allow for expected infiltration rates, storage capacities, outlet flow rates, and other site specific conditions and load requirements.

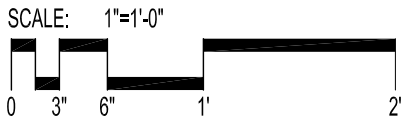

# STREET TREE PLANTING

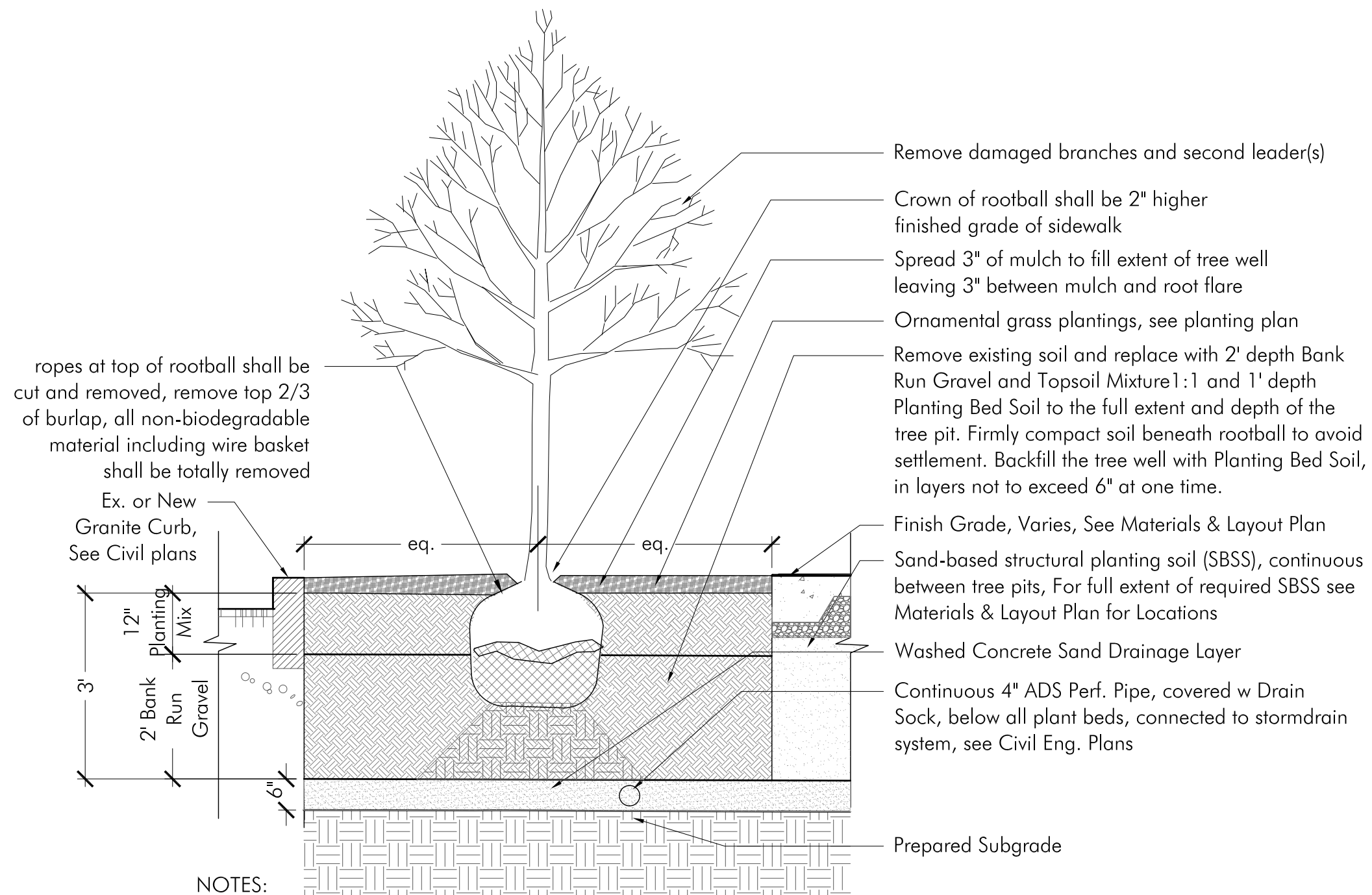

## NOTES:

1. Gently remove excess soil around root flare which may have collected during tree spading/B+B operations.
2. Provide wooden stakes (2 per tree) and guy wire (rubber hose cover at trunk) in windy locations and as site conditions require, as directed by Landscape Architect.
3. See Soil Specifications for Planting Mix, Bank Run Gravel, Concrete Sand, and Sand-Based Structural Soil.

SCALE: 1/2"=1'-0"





PEA GRAVEL PAVING

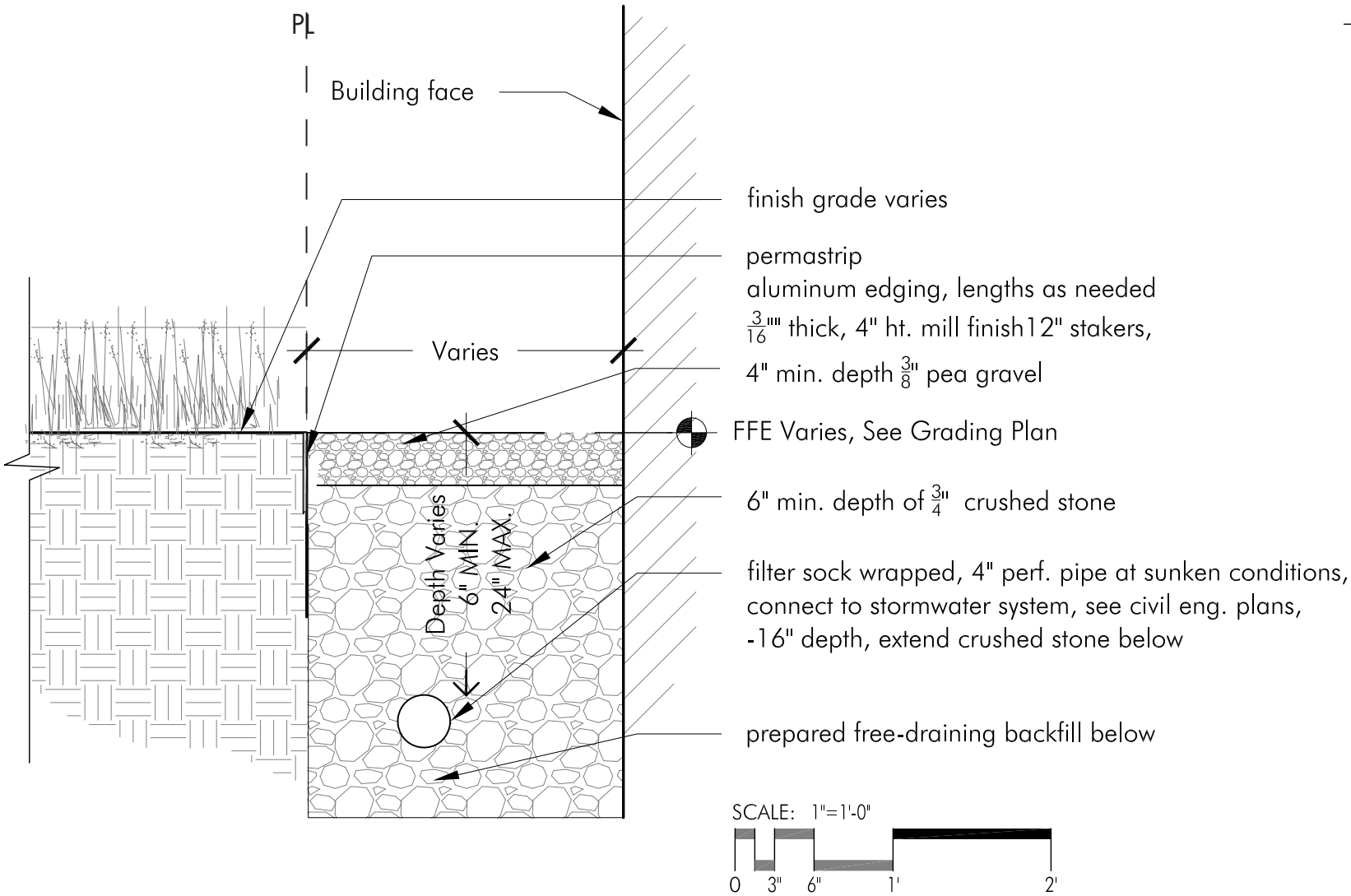

10" Min. DEPTH INTENSIVE GREENROOF + BALLAST EDGE

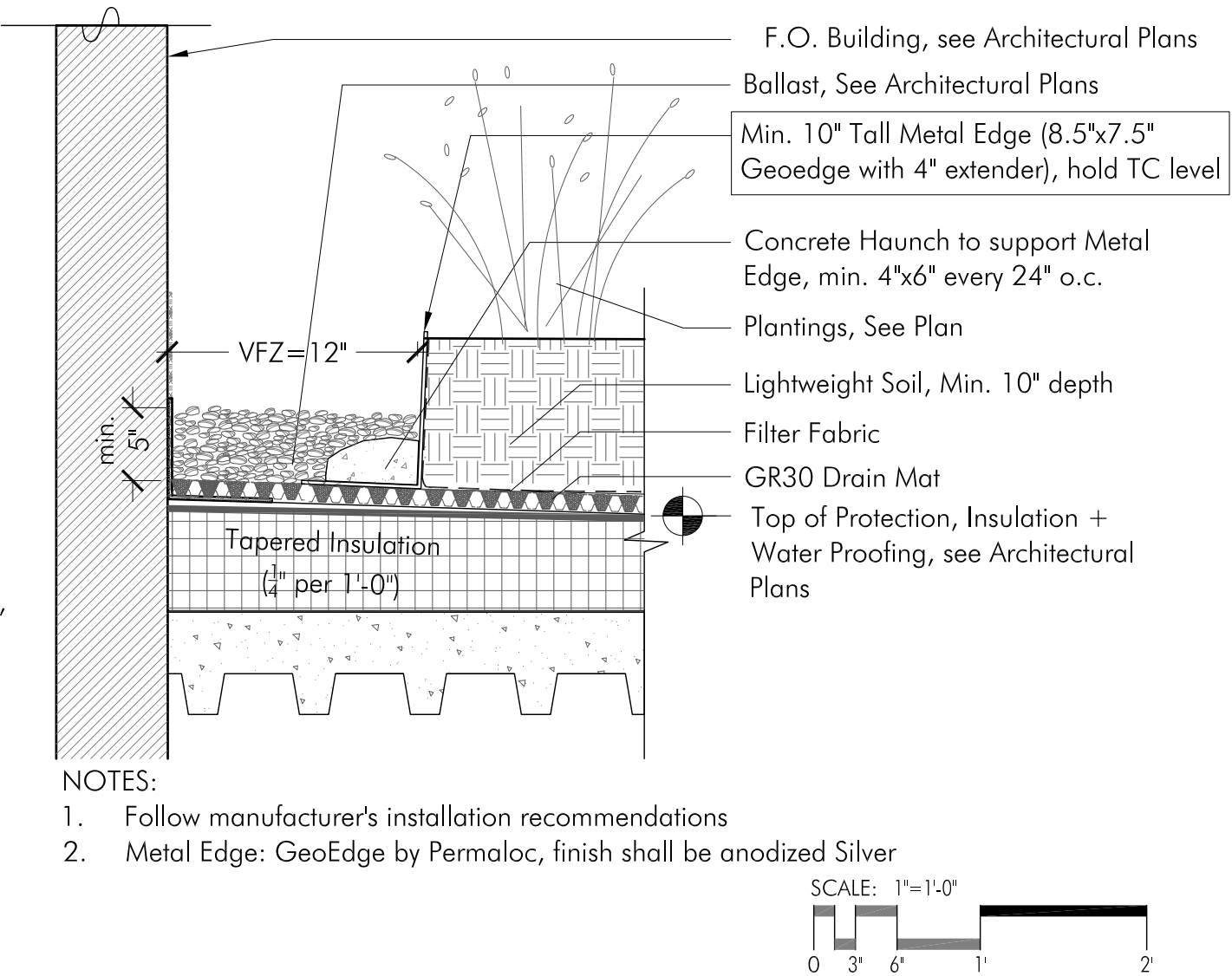



NOTES

1. Green roof modules are to be delivered in good condition. Green roof modules are to be handled carefully to prevent damage to the plants. Modules shall have plastic unwrapped (if shipped on pallets) the same day as delivery to avoid plant damage caused by overheating.

2. Conduct roof top staging of green roof system components after verifying roof loads and acceptable staging areas. Stage green roof modules over plywood panels or protective sheeting.

3. Green roof modules are to be conveyed to the roof surface with equipment that is designed and certified to hoist the associated weights safely and in accordance with equipment capacity, and local codes and regulations.

4. Protect the roof deck and waterproofing membranes using appropriate materials such as plywood sheeting. Avoid using sharp tools and keep the roof surfaces clean and free of soil, grit, or debris.

5. The vegetated green roof system Installer shall maintain the modules for at least 30 days following installation.

6. Maintenance during the initial 30-days shall follow industry accepted horticultural practices. Watering: two watering events per week to sufficiently saturate the growing medium. Provide spot weeding (by hand), as needed, to maintain plant health and prevent weed to flower and set seed, and to prevent woody plants to establish. Do not use any pesticides which include herbicides. Repair, rework and replant, if necessary, areas where wash out caused erosion, and replace dead plants.

7. Maintenance protocols: Provide the GreenGrid® maintenance guide and protocols to the Owner for extended maintenance of the green roof system. Provide a report(s) to the Owner outlining post-installation green roof conditions and observations about plant care and the initial maintenance period.

8. Irrigation: Irrigation lines to be inserted through an integrated irrigation channel in the module during installation. Water shall be delivered directly and evenly to plants for uniform plant growth. Pop-up sprinklers and spray systems are commercially available. Consult a qualified irrigation specialist to determine appropriate design, system details and configuration, materials and maintenance requirements.
9. Edge Treatment: Provide decorative edge treatment from Permaloc, or equivalent suppliers, in multiple sizes, and color for use as landscape edging around the perimeter of the vegetated green roof system in all depths.

10. Stone Ballast: Clean stone or ‘river rock’, nominal 1-1/2” diameter minimum (#4) rounded stone can be used to infill around roof drains or along irregular-shaped areas.

11. Drain Covers: Stainless steel drain enclosure and cover to enclose roof drains. Provide standard 24-inch by 24-inch or custom sizes as necessary to fit roof drains and fit within modular green roof system. Drain covers shall have L-shaped tabs at the bottom edges to anchor beneath the modules.

12. Qualified Installers including General Contractors, Roofing Contractors and Landscape Contractors can install the GreenGrid® system by following the Installation Guide. A pre-installation conference call/meeting may be appropriate for new Installers. Install the vegetated green roof system according to specifications, applicable codes and regulations.

13. Safety: Installers are solely responsible to comply with all applicable safety and fall protection codes, laws and regulations as required by federal, state and local codes and regulations.

14. When plants are properly adapted and acclimated to the local weather conditions. In northern climates and unless otherwise permitted, modules shall be installed between April 15th and October 1st, except when temperatures are below 35° F. In more southern climates, the installation season will depend on seasonal weather conditions.

15. Handle the modules with care. Do not drop, kick or

point-load the modules during installation. Place modules above the slip sheet or protective layer in accordance with the landscape design or layout Drawing. Modules shall be placed in straight rows, positioned tight beside each module and in proper orientation according to the landscape design.

16. After installation, modules shall be immediately watered so as to thoroughly moisten growing media throughout. Water shall be free of substances harmful to plant growth.
17. Do not install modules directly in low sections of roof where water ponds or where modules will block flow of drainage, or on saturated roof surface or during freezing weather conditions.
18. If required, install an irrigation system according to the manufacturer specifications and instructions. If an irrigation system is not required, provide hoses/sprayers for temporary irrigation, as needed, to conduct initial watering for plant maintenance.
19. Cut modules, only if necessary, to offset structures or roof edges, or around obstructions. Install partial or cut planter modules with the cut edge facing another module or edging.

IRRIGATION NOTES

1. The Contractor shall provide a complete irrigation plan as described in the specifications.
2. The Contractor shall provide water supply through a second meter for the rooftop Greenroof within the Sprinkler room or mechanical room. A backflow preventer and hose-bib (or faucet) shall be provided to drain out the water supply line to the roof.
3. At the rooftop, the Contractor shall provide winterization/blowout configuration, including any additional back flow valve as may be required by code. Beyond the winterization appurtenances, the Contractor shall provide a valvebox for the irrigation spray zones as may be needed depending on the water pressure at the roof.