

			<p>New Substantial Completion Dates</p> <p>Phase 1A – 5/15/20 Phase 1B – 5/15/20 Phase 1 – 5/15/20 Phase 2A – 5/15/20 Phase 2- 07/2020 Phase 3 – 05/2021</p> <p>Motion: Accept the revised phasing schedule dates of Phase 1A – 5/15/20, Phase 1B – 5/15/20, Phase 1 – 5/15/20, Phase 2A – 5/15/20, Phase 2- 07/2020, Phase 3 – 05/2021. M: TB S: RR D: (see below) V: 9-0-1 PASS.</p> <p>The hardest program to relocate is auto-tech. We were already relocating auto tech, Herb Chambers has graciously agreed to allow the school to use his space for an extended period of time to support the change in phasing.</p> <p>School sports are not scheduled to use the gym next spring, the gym will be ready but access to the space is tough, if not impossible.</p> <p>There is \$7.5M is claimed schedule impact costs, a large portion of that cost is overtime cost for shifting and stacking the schedule.</p> <p>SCCI: This saves \$25K a week in steel costs alone. The May 15 phase 1, 1A,1B and 2A opening dates have 2 months of float which give schedule certainty.</p> <p>TP: There is some cost avoidance for not building temp provisions to temporarily occupy the building. We will also have the whole building opening concurrently so warranties will start at the same time. There is a negative in that students are displaced for a longer period. Our recommendation is to accept the new schedule.</p> <p>LP: There are some associated costs to extend the students off site, I assume the district does not have off site budgeted through May. MS: Transportation and the Saint Anne's lease are the largest costs. We are assuming we are displaced until June 30 and have and will continue to have conversations with the Mayor's office.</p> <p>MJR: SCCI said there are 2 months of float in the schedule, is that typical? SCCI: The float is calculated. The critical path is the shortest time a project can be completed. The float is the amount of time the schedule can slip without affecting the project completion date. We do not add float to the without justification. MJR:SCCI presented a fantastic schedule in their interview which is why they were chosen; MJR is very nervous about the current end date. SCCI: There is no schedule impact to phase 2, the end date does not change.</p> <p>TB: a month ago, TB brought this up and kept prodding because he didn't think the schedule was achievable. The new phasing makes much more sense. TB is concerned with the quality of education and prolonged amount of time the students will be displaced. We need to make sure the shops are up to snuff.</p> <p>LP: The scheduled was delayed, and it cost us more money. Now we are delaying the schedule any we are saving money? RR: We were originally compressing a schedule which would require OT and weekend work. Now we are extending the schedule which takes pressure off and removed the requirement to work weekends. There will still be escalation cost but those should be significantly less than OT and weekend work. LP: What is the plan to press release the schedule? RR: We will talk with the district on messaging. Jeff Curley: We had a meeting to discuss how</p>
--	--	--	---

			best to inform students of the plans, transportation ect. It went out as an email to students and parents.
2/15:01	TC		School/Community Interactions : TB: Does the school department have concerns? MS: If we could get into the building before April it would be great but it doesn't look achievable. We have been meeting with DESE all along, they will have to approve the spaces. We are trying to come up with a plan to limit travel time. LD: We are allowing students to start directly at the Edgerly in the morning and leave from the Edgerly in the afternoon. We are meeting with DESE on Friday to walk through the Herb Chambers space and perform a safety check.
3/26:02	ALL		GLX: no update
10/22:1			<p>Cost/GMP Discussion: MJR: Out of the \$7.5M, \$0.5 million has been resolved. Is there still \$7 million to go through? TP: Yes, the change of schedule will put SCCI in a better position to negotiate with the subcontractors now that the 6 and 7 day work weeks have been removed.</p> <p>TB: Is there a date the GMP needs to be done by? Are there any planned changes to staffing? SCCI: We are bringing on another senior superintendent. TB: Jim McCoy was supposed to be assigned to this project from day one, that never happened. SCCI: There are no changes in field leadership since Denis G (SCCI) came on to the project in July 2018. We are adding an additional field superintendent after conversations with the city and PMA. PMA: PMA reviewed the field staff and requested that SCCI do the same. As a result of their review, SCCI is supplementing their staff.</p> <p>TC: Would it be helpful to have the new superintendent come to the committee meeting? DG: We toured the site with our Director of Ops, director of scheduling, VPs, ect. We used that exercise to assess the job and plan phase 2 to ensure the project come in on time. TC: asked that the senior superintendent come in and present the schedule and project to the committee on 8/12.</p> <p>LP: Asked does anyone on the project team share responsibility on the cost? PMA: We have liquidated damages terms in the contract but the unforeseen materials muddy the water. We expect that project team members will absorb any internal staffing costs to deliver this project.</p> <p>PMA: The GMP is not a guarantee of cost. There is no timeline when the GMP needs to be signed by. We are currently operating under a CM for fee/mini GMP. We need to get to a place where our contingency can cover the overage. Now that the schedule has extended, we can use that to drive the cost down. Target date is mid/end of July to have a draft GMP to review.</p>
3/28:01			Change Orders/Budget: Motion: Approve PCO #180 for \$11,461.93 to add an additional OxBlue time lapse Camera to the project site. M: RR S: SL – 9-0-1 APPROVED
2/15:03	ALL		Public Comment: None
			<p>Upcoming Meetings : ALL meetings at 4:30PM unless otherwise noted</p> <p>07/15 – HS Mods</p> <p>08/12 – HS Mods</p>

Meeting Adjourned: Motion to Adjourn **M:RR S:TB V: 9-0-1 PASS 5:57 PM**

The author of these minutes assumes, to the best of his or her knowledge, that the above content of these Meeting Minutes depict all that transpired during this Project meeting. All attendees are required to address by memo or via e-mail, any omissions, errors or inconsistencies in the reporting of these Meeting Minutes, to the writer, within two (2) business days of receipt of these Meeting Minutes.

Prepared By: Sean Burke, PMA Consultants

Signed: Sean Burke

Date: 07/03/19;

Somerville HS School Building Committee Agenda

Monday, June 17, 2019 - 4:30 P.M.

Location : 81 Highland Ave, Somerville MA

The meeting will be held in the Somerville High School Modular Trailers located in front of the High School Main Entrance

		Estimated Time Frame
I.	Chair Tony Pierantozzi Call to Order	4:30 P.M.
II.	05-20-19 Meeting Minutes Discussion Motion and Second Needed Vote to Approve	4:35 P.M.
III.	Overview of Meeting Agenda Tony Pierantozzi – SBC Chair	4:40 P.M.
IV.	Old Business a. Construction Update i. Schedule Update b. Community Update i. School Interaction Update c. Design Update i. FF&E Update	4:45 P.M.
V.	GMP Update a. GMP Update b. Update on Delay Claim Process	5:00 P.M.
VI.	New Business a. New Business (TBD) b. Change Orders c. Any unanticipated items	5:45 P.M.
VII.	Public Comment Period	6:00 P.M.

Authorized Person: Rich Raiche, Capital Projects



PMA Consultants

35 Braintree Hill Office Park, Suite 300
Braintree, MA 02184
Tel: 781.794.1404
Fax: 781.794.1405

MEMORANDUM

To: Rich Raiche, Director of Engineering

From: Chad Crittenden, Somerville High School Project OPM

Re: *City Hall Project Update – Somerville High School Project*

Date: 6/13/2019

Dear Mr. Raiche,

For discussion during the June 13th City Hall project status update meeting, we offer the following synopsis of current project status:

Unsuitable Soils

- On June 3rd, Suffolk issued a Notice for Unsuitable Fill found under footings at the sub-level, indicating that steel start would be delayed until the week of June 17th. PMA has evaluated the notice and is unable to find merit. PMA has issued a response to Suffolk as appropriate.

Project Schedule

- Suffolk's most recent schedule submission received on June 11th (with data date May 31, 2019) forecasts late completion for Phase 1, 1A and 1B as shown below: (Phase 2 remains on schedule)

Activity ID	Activity Name	Original Duration	Start	Finish	Total Float
Project Milestones					
P1D1040	NTP (Early Demo & Abatement)	0	23-Apr-18 A		
CMSC1060	Early Demo & Abatement - Substantial Completion	0		29-Aug-18 A	
CMSC1010	Phase 1A - Substantial Completion (11/26/19)	0		15-Jan-20*	-50
CMSC1020	Phase 1B - Substantial Completion (1/3/20)	0		15-Jan-20*	-12
CMSC1000	Phase 1 - Substantial Completion (12/24/19)	0		14-Feb-20*	-52
CMSC1030	Phase 2A - Substantial Completion (5/21/20)	0		21-May-20*	0
CMSC1040	Phase 2 - Substantial Completion (7/31/20)	0		31-Jul-20*	0
CMSC1050	Phase 3 - Substantial Completion (5/28/21)	0		28-May-21*	0

- PMA April 25th City Hall update memo noted PMA observations of day-to-day critical path analysis had prompted foundation productivity concerns for which PMA sought immediate corrective actions. Suffolk's April 2019 schedule failed to address those concerns and instead elected to insert schedule impact activities as indicated by the attached graphic which was included with their May schedule update submission and in response to PMA's rejection of Suffolk's April schedule update.
- Suffolk has issued schedule impact claim responses disputing the submitted values for steel, plumbing, concrete, mechanical, curtainwall, site and electrical subcontractors. Suffolk has received responses from steel, mechanical and site subcontractors reducing cost exposure by \$314k and has been instructed to schedule meetings to discuss with representatives from the subcontractor, City, SCCI, SMMA and PMA present. Responses from plumbing, curtainwall and electrical subcontractors are forthcoming. To-date, Suffolk has not yet formally presented any schedule delay impact costs to the City.



GLX Coordination

- Weekly meetings between the GLX and SHS teams continue with no notable issues.
- Suffolk progress at the gymnasium trusses is currently ahead of schedule, which may allow the GLX team to begin work on the Medford Street bridge abutment earlier than anticipated.

GMP

- At the November 5th School Building Committee meeting, approval was provided for a not-to-exceed GMP value of \$206,383,977. This amount captures all buyout but does not address the aforementioned schedule impact costs.
- Suffolk's current GMP proposal is \$213,242,072, placing current VM and schedule impact negotiation savings target at a combined value of (\$6.8M). These values have reduced by \$0.5M +/- since the 4/25 update.
- A majority of approved value engineering options worth an estimated \$900K are now with the subcontractors for pricing. SMMA is working to finalize the remaining components and will issue remaining proposal requests by the end of next week.

As always, please feel free to contact us with any questions.

Regards,

Chad Crittenden
Senior Director | Owner's Project Manager
PMA Consultants, LLC

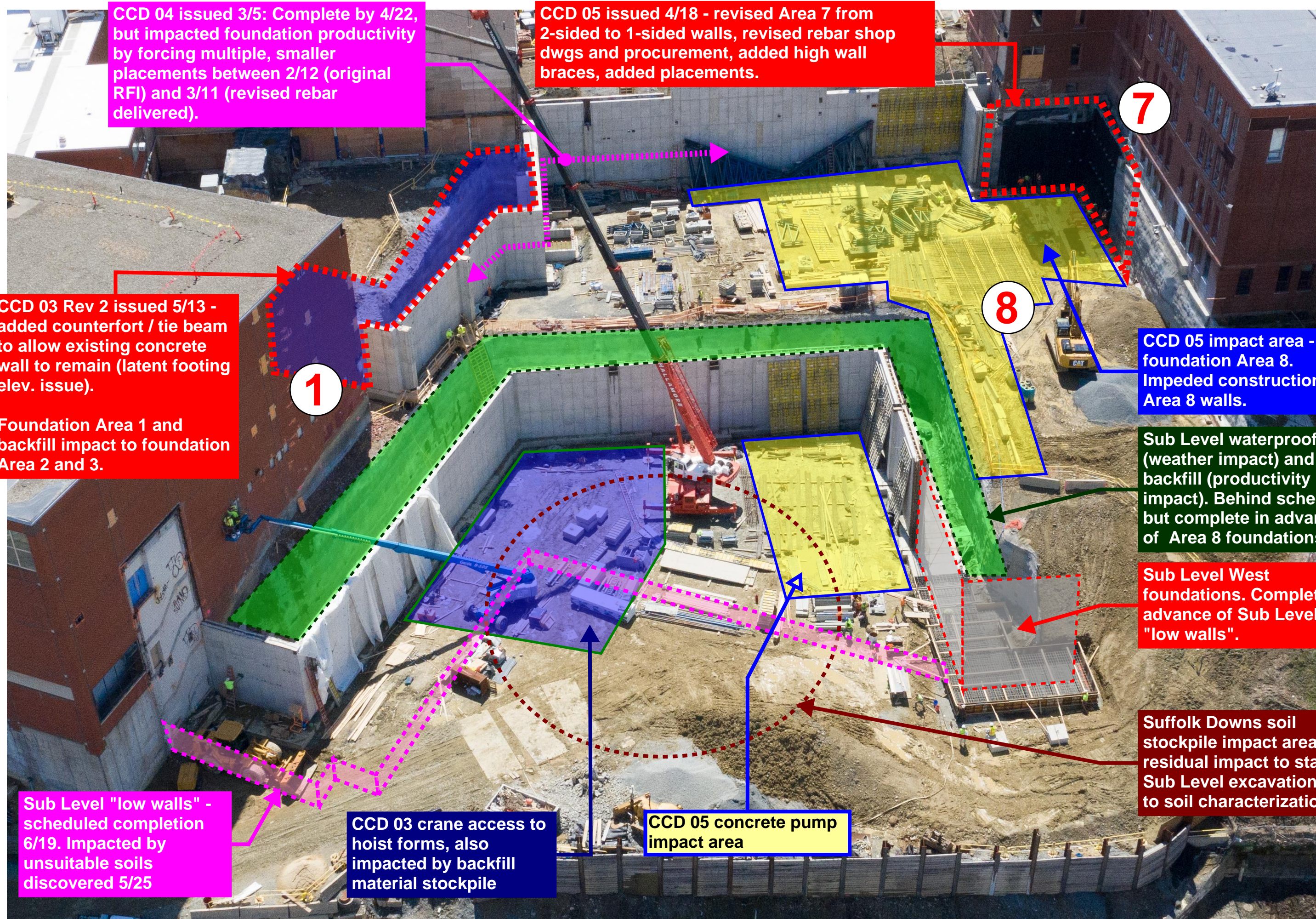

**SOMERVILLE HIGH SCHOOL
CONTAMINATED SOILS UPDATE
6/13/2019 BUILDING COMMITTEE MEETING**

UPDATED NUMBERS AS OF 03/28/19			
Facility- Soil Type	Estimated (Tons)	Actual Trucked to Date	Percentage Gone
Group I-2/3 - 41% of total soils (basis: Saugus Facility unit rate)	44,431	43,142.59	97.1%
Group II-1- 33% of total soils (basis: Coventry Facility unit rate)	35,761	19,360.06	54.1%
Group II-3/4- 7% of total soils (basis: ARC Facility unit rate)	7,586	5,613.45	74.0%
TOTAL Tons Trucked to Date	87,778	68,116.09	77.6%

Contaminated Soils Budget Spent to Date (03/28/19)	
Total Contaminated Export Cost to date	\$ 1,435,480.54
Total Budget for Contaminated Soils	\$ 2,249,000.00
TOTAL Budget Spent to Date	63.83%

MONTHLY STATUS REPORT

May 2019

Project: Somerville High School	Building Size: 377,406 SF	Phase 1 Completion: December 24 th 2019
Current Phase: Construction Administration	Project Budget: \$255,982,704	Phase 2 Completion: July 31 st 2020
Construction Type: 78% New / 22% Reno	Design Enrollment: 1,590	Phase 3 Completion: May 28 th 2021
Phase 1 Start: April 23 rd 2018	Reimbursement Rate: 75.29%	Day 404 of 1132 to Ph.3 Substantial: 35.68%

BUDGET STATUS

Total Project Budget: \$255,982,702

Actual Costs Incurred to Date: \$55,015,550 (21.49%)

PROJECT STATUS

May 2019 Progress

- Site Work: excavation/export of soil to new building footing foundation elevations continued throughout the month. Backfilling/Compacting behind new building foundation walls continued throughout the month. Construction of temporary SOE wire mesh wall road for School Street construction access began.
- Cast-in-Place Concrete: foundation footings / walls continued being formed and poured along the west and east sides of the site for new building lower/sub levels.
- Structural Steel: old gym decking/trusses removed as new gym decking/trusses are installed.
- Demolition / Abatement: abatement and demolition of the lower level/field house in the 1986 wing continued throughout the month.
- Mechanical, Electrical, Plumbing: MEP makesafe of the lower level/field house of the 1986 wing. Electrical conduit behind foundation walls began. New plumbing lines placed in CTE shop spaces.

June 2019 Forecasted Items

- Site Work: minor excavation/export of soil to new building footing foundation elevations to continue through June 2019. Backfilling/Compacting behind new building foundation walls to continue through June 2019. Construction of temporary SOE wire mesh wall road for School Street construction access to continue. Phase 2 excavation for footings to began the end of the month.
- Cast-in-Place Concrete: foundation footings / walls to continue to be formed and poured, interior footings/piers to be formed/poured.
- Structural Steel: new gym decking/trusses operation to continue. Phase 1 structural steel erection to begin on the sub level.
- Demolition / Abatement: abatement and demolition of the 1986 wing lower level to continue. End of the month abatement of 1986 upper levels to begin.
- Mechanical, Electrical, Plumbing (MEP): new utility conduit placement to continue in CTE shop spaces / behind Phase 1 new building walls.

PROJECT NOTES

- GMP negotiations began on 08/10/2018, have continued throughout May 2019.

MILESTONE DATES

Milestone Dates	Forecast	Actual	Status	Schedule Notes
Substantial Completion Phase 1 New Addition	24Dec19			Revised per 01/18 Schedule
Substantial Completion Phase 1A Tech Space Reno	26Nov19			Revised per 01/18 Schedule
Substantial Completion Phase 1B Gymnasium Reno	03Jan20			On target
Substantial Completion Phase 2 New Addition	31Jul20			On target
Substantial Completion Phase 2A Auditorium	21May20			On target
Substantial Completion Phase 3A Demo /Field	28May21			On target

PROJECT CASHFLOW PROJECTION

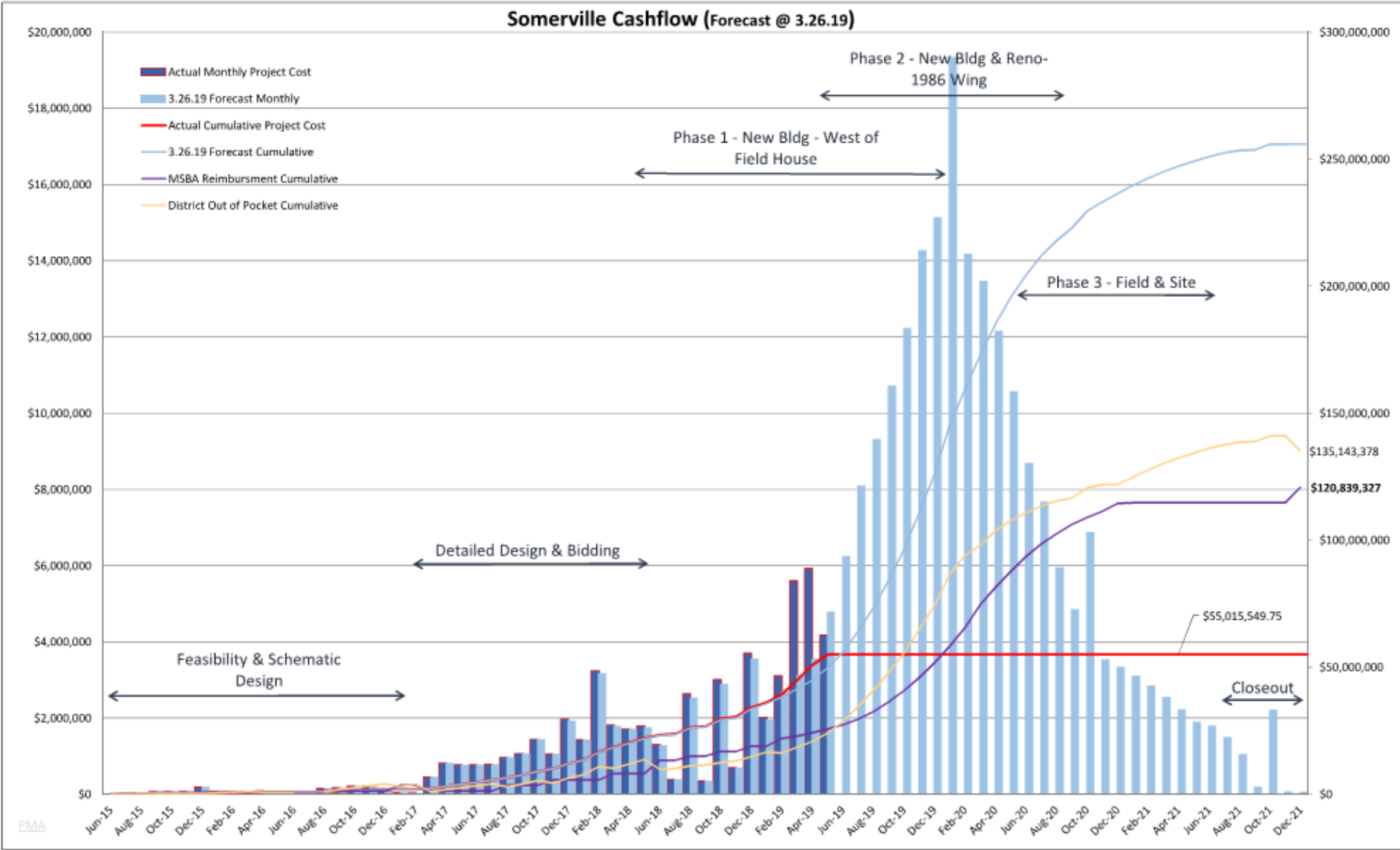

PROJECT PHOTOS

**April 14, 2018 – December 2019
Phase 1 Construction Limit of Work**

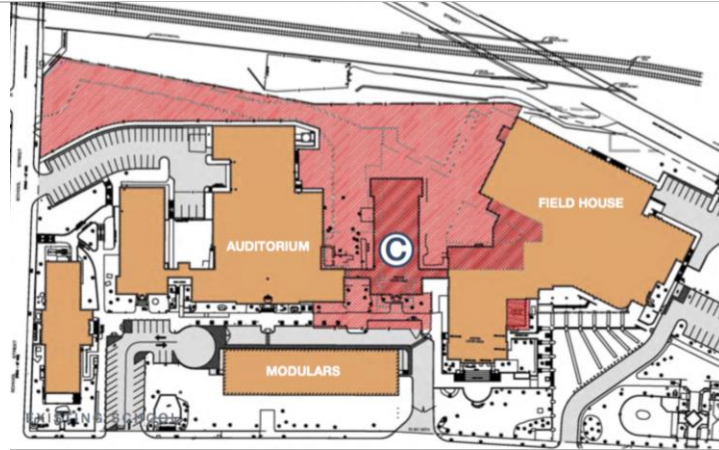

May 2019: Installation of Gym Roof Joists

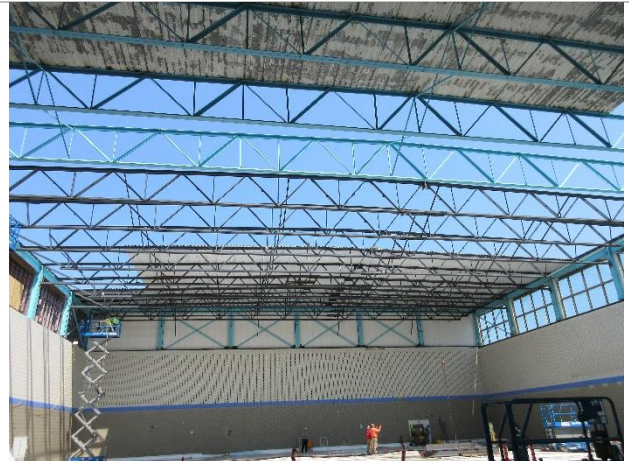

**May 2019: New Utilities Trench in CTE Shop Space of
1986 Wing Lower Level**



**May 2019: Lower Level Foundation Walls (Next to 1895
Building)**



**May 2019: Lower Level Foundation Footings
(Forms/Bracing)**



May 2019: MSE Wall Progress (Parallel to Rail Tracks)



CONSTRUCTION PHASING & LIMIT OF WORK BY PHASE

Existing Condition

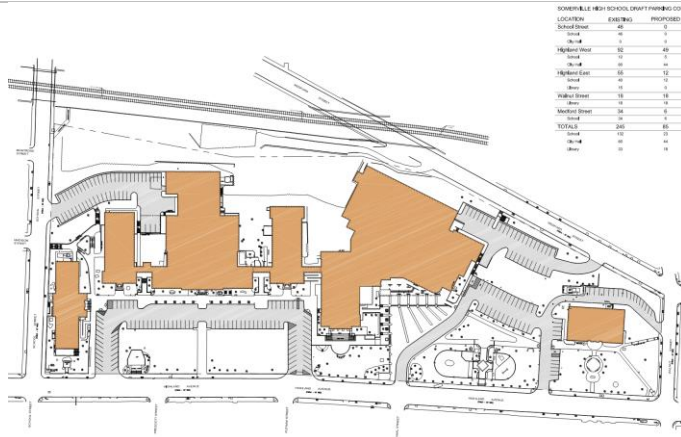

April 2018 – Commence Phase 1 – New Bldg West

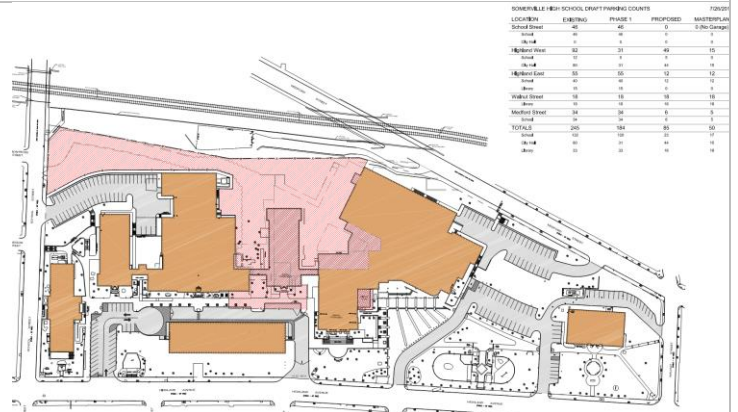

April 2019 – January 2020 – Site Improvements & Commence Phase 1A/1B

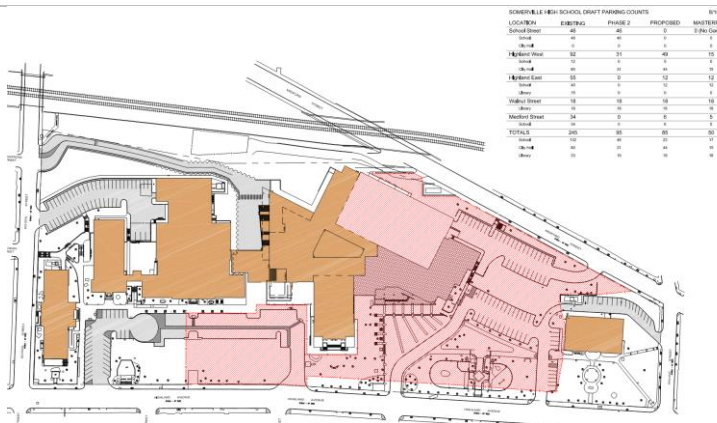

June 2019 – Commence Phase 2 – New Bldg East

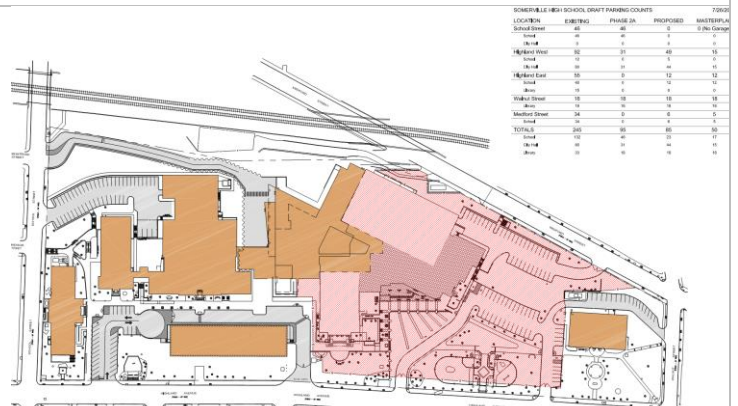

June 2020 – Commence Phase 3 – Athletic Field

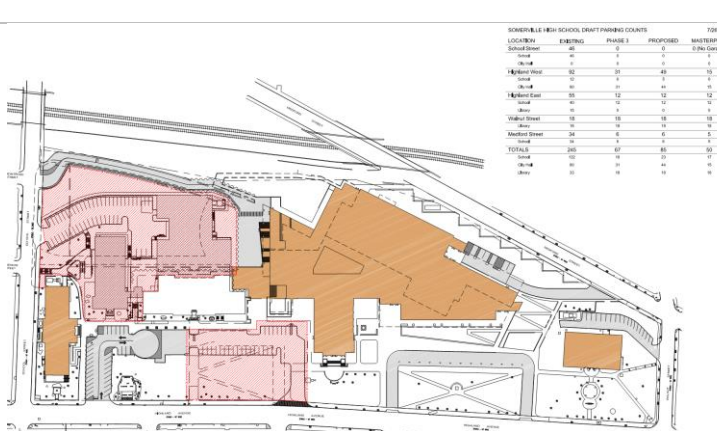

Summer 2021 – High School Project Complete

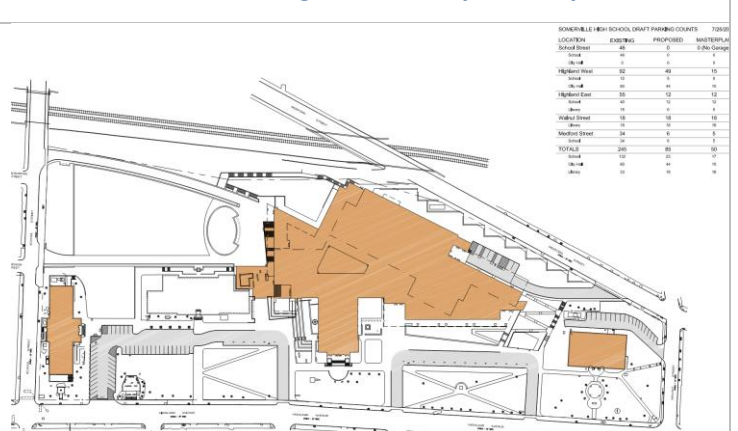

PROACTIVE MEASURES RELEVANT TO COMMUNITY INTERACTION DURING CONSTRUCTION



Conduct of Contractor Personnel

All Construction Personnel must be CORI checked. The Contractor must establish and enforce rules as are appropriate to ensure the safety of the school programs and appropriate demeanor in the presences of the students, staff, parents and other visitors. Personnel must wear identification badges when on site. Workers are forbidden from intermingling with students or entering a school occupied area except with prior approval of the Owner.



Working Hours

The Contractor is allowed to work on site between 7:00AM to 7:00PM Monday-Friday and between 9:00AM and 7:00PM on Saturdays. Work on Sunday and Legal Holidays is prohibited. Any deviation from this plan requires a request made by the contractor 72 hours in advance of the work being performed and the approval of the DPW Commissioner.



Use of Site

Site Work and Work outside the building may be performed while school is in session if it does not interfere with or impede school activities, including but not limited to arrivals and departures of students and staff, and outdoor athletic and play activities. Before performing work in any area that is immediately outside an occupied area of the building, the contractor must notify the Owner and obtain written authorization.

Any operations that would result in high levels of noise, vibration, odors or other disruption to the school must be coordinated to with school prior to the activity commencing. Any operation causing interruptions to the school activities will be stopped as required by the school.

Prior to execution of the work, the contractor is required to submit a site utilization plan, weather protection and heating plan, dust containment plan, and traffic and hauling plan.



Existing Utility Interruptions

Utilities serving the property are not allowed to be interrupted. When utilities connections need to be modified, temporary services must be provided and put in place to insure uninterrupted utility service to the school, unless otherwise approved by the Owner.



Indoor Air Quality

The contractor will develop and enforce procedures for preventing construction activities from creating unacceptable Indoor Air Quality within occupied areas. This includes use of dust protection, filters, containment, ventilation and negative air pressurization. The contractor is required to monitor work practices and have systems in place for early detection of potential Indoor Air Quality issues. The contractor is required to provide monthly monitoring of the building indoor air quality with additional monitoring required when construction operations generate higher levels of potential contaminants.



Noise Control

The contractor is required to develop and maintain a noise abatement program and enforce strict discipline over personnel to minimize noise. The must employ construction methods and equipment which reduce excess noise

	SD Budgets		Form 3011	DD Budget Status		With FF&E Bids
	1/4/17		Budget	5/22/17		5/21/19
	FF&E		FF&E	FF&E		FF&E
Furniture (Stefura)	\$	2,368,187		\$	1,997,892	\$ 1,861,308
Academic Equipment (TDA)	\$	450,000		\$	800,000	\$ 595,238
Contingency (Stefura)	\$	281,819				
Food Service Equipment (TDA)	\$	28,000	\$ 28,000	\$	28,000	\$ 69,044
Ch. 74 Furn & Equip (TDA)	\$	2,540,911		\$	1,793,291	\$ 1,297,093
Fitness Room New Equipment						\$ 166,074
Existing Ch 74 F&E reused (TDA) (cost for ref only - not in total)				\$	354,500	\$ 354,500
Rigging Existing Equipment (cost for ref only - not in total)				\$	10,000	\$ 10,000
Subtotal	\$	5,668,917	\$ 2,548,000	\$	4,619,183	\$ 3,822,684
	Technology		Technology	Technology		Technology
Technology (GGD)	\$	2,300,570		\$	1,588,050	\$ 1,916,749
Tech Installation (GGD)	\$	213,807		\$	158,805	\$ 191,675
Tech Contingency (GGD)	\$	251,438		\$	174,685	\$ 105,421
Tech System Engineer (GGD)	\$	15,000		\$	15,000	
Subtotal	\$	2,780,815	\$ 2,548,000	\$	1,936,540	\$ 2,213,845
Total	\$	8,449,731	\$ 5,096,000	\$	6,555,723	\$ 6,036,529
Delta from Budget	\$	3,353,731		\$	1,459,723	\$ 940,529
Delta from Budget with 10% Rebid Contingency						\$ 1,034,582
Potential FF&E Cost Management Strategies (to be reviewed with SBC)						
Re-Use Existing General Classroom Student Desks/Chairs						\$ 264,366
Re-Use Existing General Classroom Teachers Desks						\$ 40,947
Re-Use Existing General Classroom Teachers Chairs						\$ 15,634
Tables & Chairs In Lieu of Banquet Seating in Dining Commons						\$ 10,500
No all new laptops for Teachers/Admin- maintain existing replace program						\$ 169,200
Defer Equipment Purchase for new CTE Programs (HVAC and Plumbing)						\$ 112,107
Re-use Existing Musical Instruments						\$ 115,207
All Existing CTE Programs Defer 10% of new Equipment Purchases						\$ 118,499
All Academic Programs Defer 10% of new Equipment Purchases						\$ 45,944
Re-Use Existing Shelving and/or Defer Procurement						\$ 96,850
Total Proposed Savings						\$ 989,254
Potential Delta from Budget with Cost Management Strategies						\$ 45,328

5/21/19 Equipment Bid Breakdown			
	Bid	No Bids Received - 5% Contingency	Total
Academic Eq			
Gym/PE	\$ 121,416		\$ 121,416
Metal Shelving	\$ 91,600	\$ 5,250	\$ 96,850
Custodial/Maint	\$ 20,588		\$ 20,588
Nurse	\$ 18,049	\$ 8,498	\$ 26,547
Misc Equipment	\$ 5,801		\$ 5,801
Music	\$ 109,957	\$ 5,250	\$ 115,207
Art	\$ 77,969		\$ 77,969
Special Education	\$ 7,698		\$ 7,698
Science	\$ 123,163		\$ 123,163
	\$ 576,241	\$ 18,998	\$ 595,238
Main Kitchen	\$ 53,137	\$ 15,908	\$ 69,044
Chapter 74 Eq			
Auto Tech	\$ 157,332		\$ 157,332
Carpentry	\$ 128,924		\$ 128,924
Cosmetology/Barb	\$ 68,592	\$ 4,154	\$ 72,746
Drafting	\$ 2,683		\$ 2,683
Early Ed	\$ 19,616		\$ 19,616
Electrical	\$ 11,294		\$ 11,294
Graphic Design	\$ 1,950	\$ 10,165	\$ 12,115
Health Assisting		\$ 18,080	\$ 18,080
HVAC	\$ 20,479		\$ 20,479
Machine Tech/Fab Lab	\$ 254,164	\$ 74,998	\$ 329,162
Metal Fabrication	\$ 255,409	\$ 177,626	\$ 433,035
Plumbing	\$ 83,349	\$ 8,279	\$ 91,628
	\$ 1,003,791	\$ 293,303	\$ 1,297,093
Totals	\$ 1,633,168	\$ 328,208	\$ 1,961,376
Compare to TDA Letter (incl. fitness equipment)	\$ 1,799,242		

City of Somerville

Somerville High School

81 Highland Ave., Somerville MA
Job #: 50302

100% CD Variance Report

Date: 6/12/19

Arch Est: Doreen Crowley

MEP Est: MC/TJL

			GMP dated 6/12/19	GMP dated 6/12/19 Allowances	GMP dated 6/12/19 - Holds	GMP dated 6/12/19 TOTALS
SCCI Code	MSBA Code	Gross Building Area:	377,406 gsf	377,406 gsf	377,406 gsf	377,406 gsf
02000	05020200	Demolition / Haz Material Removal	\$6,931,400			\$6,931,400
02000	05020200	Demo Hold #1 - Additional Temp Shoring			\$50,000	\$50,000
02000	05020200	Demo Hold #2 - MEP Make Safe Adjustments			\$10,000	\$10,000
02000	05020200	Demo Hold #3 - Pre-Demo Survey			\$20,000	\$20,000
02000	05020200	Demo Hold #4 - Remove & Salvage Brick at Gym Beams			\$0	\$0
02000	05020200	Demo Allowance #1 - Unforeseen Abatement		\$50,000		\$50,000
02000	05020200	Demo Allowance #2 - Exploratory		\$20,000		\$20,000
02000	05020200	Demo Allowance #3 - Coating Behind Classroom Univents		\$31,000		\$31,000
02000	05020200	Demo Allowance #4 - Foundation Coating Suspect ACM		\$30,000		\$30,000
02000	05020200	Demo Allowance #5 - Subsurface Transite Suspect ACM		\$67,500		\$67,500
02000	05020200	Demo Allowance #6 - Chimney Firebrick or Lining ACM		\$66,176		\$66,176
02000	05020200	Demo Allowance #7 - Vapor Barrier Below Floor ACM		\$0		\$0
02000	05020200	Demo Allowance #8 - Fire Details Allowance		\$0		\$0
02000	05020200	Demo Allowance #9 - Future COR / Design Development		\$0		\$0
02420	05020200	Remove & Salvage of Construction Materials (Allowance)		\$300,000		\$300,000
03300	05020300	Concrete, Formwork, & Rebar	\$16,084,000			\$16,084,000
03300	05020300	Concrete Hold #1 - Additional Picks from Steel Sub			\$165,000	\$165,000
03300	05020300	Polished Concrete	\$43,726			\$43,726
03400	05020300	Precast Concrete	\$290,000			\$290,000
03300	05020300	Precast Hold #1 - Supplemental Steel			\$10,000	\$10,000
03300	05020300	Precast Hold #2 - Additional Panels Not Bought w/ Steel			\$15,300	\$15,300
03300	05020300	Precast Hold #3 - Mock-Ups for Approval			\$15,000	\$15,000
03300	05020300	Precast Hold #4 - Joint Sealants for Backer Rods & Sealant			\$3,900	\$3,900
03300	05020300	Precast Allowance #1 - Precast Plank to be Salvaged		\$50,000		\$50,000
04200	05020400	Masonry	\$7,067,000			\$7,067,000
04200	05020400	Masonry Hold #1 - Masonry Storage			\$8,000	\$8,000
04200	05020400	Masonry Hold #2 - Lintels Not Shown			\$20,000	\$20,000
04200	05020400	Masonry Allowance #1 - Install Salvaged Brick to Allow for Setting Beams at Gym		\$0		\$0
05100	05020500	Structural Steel	\$10,034,100			\$10,034,100
05100	05020500	Steel Hold #1 - Neoprene Pad at Sloped Beams on S-403			\$10,000	\$10,000
05100	05020500	Steel Hold #2 - Picks for Rebar & Mesh			\$50,000	\$50,000
05100	05020500	Steel Allowance #1 - Precast Supports / Conn. Not Shown		\$20,000		\$20,000
05100	05020500	Steel Allowance #2 - Steel Beam Pens Per S-401		\$15,900		\$15,900
05500	05020500	Miscellaneous Metals	\$3,899,999			\$3,899,999
06200	05020600	Finish Carpentry & Millwork	\$3,238,448			\$3,238,448
07100	05020700	Waterproofing / Joint Sealants	\$1,057,000			\$1,057,000
07410		Metal Panels/Terracotta/Louvers				\$0
07500	05020700	Roofing Systems	\$3,721,000			\$3,721,000
07500	05020700	Temp Roof Protection Hold			\$75,000	\$75,000
07420	05020700	Metal Panels/Terracotta/Louvers/CW	\$14,219,000			\$14,219,000
07420	05020700	Facade Hold #1 - Sealants Between Dissimilar Materials			\$10,000	\$10,000
07810	05020700	Fireproofing	\$1,288,620			\$1,288,620
07810	05020700	Fireproofing Hold #1 - Touch-up / Patching			\$30,000	\$30,000
07810	05020700	Fireproofing Hold #2 - Prime Existing Steel to Receive Intumescent			\$25,000	\$25,000
08200	05020800	Doors, Frames, & Finish Hardware	\$1,214,500			\$1,214,500
08200	05020800	Doors Hold #1 - Temp Doors & Modify Existing			\$25,000	\$25,000
08200	05020800	Doors Allowance #1 - Wood Doors to Match Paneling		\$3,000		\$3,000
08360	05020800	Overhead Doors & Loading Dock Equip	\$151,886			\$151,886
08422	05020800	Aluminum Windows	\$2,039,000			\$2,039,000
08422	05020800	Interior Glazing	\$656,075			\$656,075
08422	05020700	Moisture Mitigation - Incl. in 09670 Epoxy Flooring	\$0			\$0
09290	05020900	Gypsum Drywall	\$13,916,700			\$13,916,700
09290	05020900	Drywall Hold #1 - Upgrade GWB Tops to Fiberglass-Mat			\$100,000	\$100,000
09290	05020900	Drywall Hold #2 - Temp Weather Protection at D Windows			\$0	\$0
09290	05020900	Drywall Hold #3 - Build Temp Partitions Not Shown			\$0	\$0
09300	05020900	Tile	\$2,176,775			\$2,176,775
09660	05020900	Terrazzo	\$1,274,700			\$1,274,700
09510	05020900	Acoustical Ceilings	\$1,357,200			\$1,357,200
09520	05020900	Acoustical Wall & Ceiling Systems	\$198,000			\$198,000
09600	05020900	Resilient Flooring	\$1,930,963			\$1,930,963
09600	05020900	Carpet Tile	\$284,400			\$284,400
09910	05020900	Painting	\$1,000,000			\$1,000,000
09670	05020900	Epoxy Flooring	\$440,110			\$440,110
09670	05020900	Epoxy Flooring Hold #1 - Floor Protection			\$21,170	\$21,170
09670	05020900	Epoxy Flooring Hold #2 - Moisture Mitigation			\$94,266	\$94,266
09670	05020900	Epoxy Flooring Allowance #1 - Area B Floor Leveling		\$100,000		\$100,000
09620	05020900	Wood Floor Systems	\$160,000			\$160,000
10000	05021000	Specialties	\$1,995,906			\$1,995,906
11130	05021100	Projection Screens	\$105,400			\$105,400
11400	05021100	Food Service Equipment	\$1,379,212			\$1,379,212
11400	05021100	Food Service Hold #1 - Temp Protection / Sanitization / Phased Protection			\$20,000	\$20,000
11400	05021100	Food Service Hold #2 - Misc Connections & MEP Coordination			\$20,000	\$20,000
11400	05021100	Food Service Hold #3 - Removal, Storage & Clean of Existing Equipment to be Relocated			\$10,000	\$10,000

Epoxy hold #3 for
\$74,310 removed
(gym slab RH tested OK)

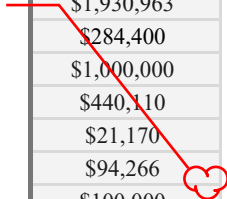

Was \$385,916, reduced per RTA #24

Was 1,335,415
Reduced by \$190,762 per RTA #25 athletic equip



11001	05021100	Equipment		\$1,144,653				\$1,144,653
11001	05021100	Climbing Walls Hold #1 - Protection of Gym Flooring & Other Finishes					\$10,000	\$10,000
11001	05021100	Climbing Walls Hold #2 - Route Setting of Hand Holds (NIC)					\$10,000	\$10,000
12357	05021200	Casework		\$1,800,000				\$1,800,000
12357	05021200	Casework Hold #1 - Hoist Cabinets to 5th Floor					\$10,000	\$10,000
12357	05021200	Casework Hold #2 - Office Storage for Cabinets					\$10,000	\$10,000
12490	05021200	Window Treatments		\$360,000				\$360,000
12610	05021200	Auditorium Seating		\$237,260				\$237,260
14200	05021400	Elevators		\$812,568				\$812,568
15300	05022100	Fire Protection		\$2,655,340				\$2,655,340
15400	05022200	Plumbing		\$8,026,000				\$8,026,000
15500	05022300	HVAC & Automatic Temp Controls		\$21,923,000				\$21,923,000
15500	05022300	HVAC Hold #1 - Pre-Purchase Equipment					\$71,693	\$71,693
16050	05022600	Electrical		\$13,350,000				\$13,350,000
16050	05022600	Electrical Hold #1 - Pre-Purchase Equipment					\$20,334	\$20,334
31000	05023100	Sitework & Earthwork/SOE		\$13,700,000				\$13,700,000
31000	05023100	Sitework Hold #1 - Irrigation Sleeves					\$15,000	\$15,000
31000	05023100	Sitework Hold #2 - Installation of DMP's Including PR-30					\$15,000	\$15,000
31000	05023100	Sitework Allowance #1 - Monuments - Storage, Transport & Delivery Within 10 Miles			\$172,400			\$172,400
31000	05023100	Summer 2018 Site Enabling Work		\$750,000				\$750,000
31000	05023100	Soils Management Allowance			\$2,600,000			\$2,600,000
32000	05023200	Landscaping & Site Improvements		\$6,293,300				\$6,293,300
32000	05023200	Landscaping Hold #1 - Wood Deck w/ Transfer Rail					\$75,000	\$75,000
32000	05023200	Landscaping Hold #2 - Trellis Fence System					\$120,000	\$120,000
32000	05023200	Landscaping Hold #3 - Arborist Service for Existing Trees					\$15,000	\$15,000
	MULTIPLE	Early Work: Precon, Modular Classroom & Site Enabling - Amendment 1&2		\$4,023,611				\$4,023,611
		Amendment 1 and 2 (Markups) Reconciliation:						\$0
	05010000	Amendment 1 (precon Services - now below)		(\$646,199)				(\$646,199)
	05020030	Amendment 2 - Contingency		(\$62,837)				(\$62,837)
		Amendment 2 - Builders Risk Policy		(\$9,764)				(\$9,764)
	05020020	Amendment 2 - General Liability		(\$39,707)				(\$39,707)
	05020010	Amendment 2 - Fee		(\$73,231)				(\$73,231)
	05020100	General Cleaning / Labor Support (transfer from line items above - add to LS GRs)(Transferred to GC/GR Per BA #21 Amedment #9)		\$0				\$0
	Sub-Total			\$172,399,114	\$3,525,976	\$1,179,663	\$177,104,753	
	05010000	Schematic Design Estimating		\$50,000				\$50,000
	05010000	Preconstruction Services (BA #21, Amend. No. 9)		\$696,199				\$696,199
	05020100	GC/GRs - Buyout Authorization #21 (Amend. No. 9)						\$0
60903	05020100	Precon and Enabling	0.00%	\$1,017,227				\$1,017,227
60903	05020100	Phase 1 and 2	0.00%	\$9,371,461				\$9,371,461
60903	05020100	Phase 3	0.00%	\$1,859,404				\$1,859,404
60903	05020100	General Cleaning/Labor Support	0.00%	\$551,171				\$551,171
		Police Details & Fire Watches Allowance			\$756,073			\$756,073
		Ceremonial Costs Allowance			\$20,000			\$20,000
		Temp Heating & Cooling of Bldg Hold				\$150,000		\$150,000
60300		Winter Conditions Hold				\$600,000		\$600,000
		Utility Consumption - Lighting, Elec & Gas Allowance			\$389,608			\$389,608
60903		General Conditions	0.00%					\$0
60903		General Requirements	0.00%					\$0
60903		Design/Estimating Contingency	0.00%					\$0
60902		Escalation Contingency Phase 1	0.00%					\$0
60902		Escalation Contingency Phase 1a	0.00%					\$0
60902		Escalation Contingency Phase 1b	0.00%					\$0
60902		Escalation Contingency Phase 2	0.00%					\$0
60902		Escalation Contingency Phase 2a	0.00%					\$0
60902		Escalation Contingency Phase 3	0.00%					\$0
60901		Overtime Contingency						\$0
60900	05020030	Construction Contingency				\$3,310,688		\$3,310,688
60906		Overtime Allowance						\$0
01001		General Conditions	0.00%					\$0
	Sub-Total			\$185,944,576	\$4,691,657	\$5,240,351	\$195,876,584	
60050		Building Permit (Fee Waived)	0.00%					\$0
60450	05020020	Subcontractor (non-FSB) Bonds Allowance	1.00%		\$1,086,375			\$1,086,375
60400		CCIP	0.00%					\$0
60420		Builders Risk Insurance (below line per PMA)	0.00%					\$0
60100	05020020	General Liability Insurance	1.22%	\$2,207,793				\$2,207,793
60200	05020020	Performance & Payment Bonds	0.91%	\$1,646,796				\$1,646,796
98000	05020010	Construction Manager Fee	2.25%	\$4,071,749				\$4,071,749
	Total (Construction Costs)			\$193,870,914	\$5,778,032	\$5,240,351	\$204,889,297	
Supplementary Revisions								
		Schedule extension impact costs due to unforeseen site conditions / soil charaterization (uncertified)			\$7,268,511			\$7,268,511
		Approved (Owner Contingency) PCOs to date				\$917,590		\$917,590
60420		Builders Risk Insurance	0.00%	\$166,674				\$166,674
Total (Construction + Supplementary Revisions)				\$194,037,588	\$13,046,543	\$6,157,941	\$213,242,072	

Was \$7,583,417

Was \$745,044

Was \$213,716,484

PMA Construction Change Authorization Log

Key:	Approved	Under Review	Rejected	Pending
------	----------	--------------	----------	---------

PCO	Change Doc	Issued By/For	Description	Proposed Cost	Pending Cost GMP Risk	Pending Cost Owner Risk	Approved Cost Owner Contingency Draw	Approved Cost GMP Hold/Allowance/Conting	DELTA (Proposed- Approved)	PMA/SMMA Response & Notes	Ball in Court
TOTAL				\$18,181,448.65	\$379,420.66	\$11,234,679.73	\$960,834.51	\$2,703,769.61	(\$2,912,000.79)		
Owner 1		Lan-Tel	Add Cameras to Modular Trailers	\$20,000.00			\$5,054.00		(\$14,946.00)		PRE-GMP
Owner 2		SAS	Rerouting Secutiry Pannels	\$10,000.00			\$10,439.00		\$439.00		PRE-GMP
#001		WJGEI	Coring & Support for Fiber Backbone for Modulars	\$13,573.36			\$13,573.36		\$0.00	PCO Executed on 5/9/2018	PRE-GMP
#002		WJGEI, J. Derenzo	Electrical Service Adds and Credits for Modulars	\$11,520.84			\$9,617.94		(\$1,902.90)	PCO Executed on 7/10/18	PRE-GMP
#003		Triumph	Additional ramps, Added walls for SHIP classes and Teacher Planning, Added Disconnect	\$34,347.50				\$15,510.00	(\$18,837.50)	Comments issued 5/1/18. Awaiting response from Triumph. PMA team not copied on all correspondence. SCCI waiting on Triumph 11/29/18. SCCI waiting on Triumph still as of 12/13/2018. 1/17/19- SCCI still waiting on response from Triumph. 1/24/19 SCCI to email Triumph with hard date of Monday 1/28/19 for revised PCO or void. 2/7/19 SCCI forwarded Triumph Contract, SCCI waiting to hear from Triumph on ramps. 2/12/19 PMA sent comments for SMMA to review. 2/14/19 Additional ramps need to be reviewed/removed. SCCI to resubmit. PMA to send which ones are acceptable. 2/21/19- PMA issued comments back to SCCI on 2/20, SCCI revising (removing CO 1 from Triumph) and to issue response with approved items.	PRE-GMP
#003A		Triumph	Additional Ramps	\$18,837.50		\$18,837.50			\$0.00	2/28/19- SCCI has seperated ramps from previous PCO, to track cost with the associated risk here while they talk to Triumph. 03/07/19- SCCI to address with Triumph / internally with JF. 03/14/19- SCCI notified Triumph cost is rejected, waiting to hear back from Triumph. 03/21/19- Ongoing. 04/04/19- Ongoing. 04/11/19- Ongoing. 04/18/19- Ongoing. 04/25/19- Ongoing. 05/02/19- Ongoing. 05/16/19- Ongoing. 05/23/19- Ongoing. 05/30/19- Ongoing. 06/06/19- Ongoing. 06/13/19- Ongoing.	SCCI/HOLD
#004		Capital Carpet	Furnish and Install 1500SF of Ecore rubber tiles	\$11,610.00			\$11,610.00		\$0.00	PCO Executed on 5/9/2018	PRE-GMP
#005		J. Derenzo	Additional Mobilization costs for fill and grading South Side of Modulars	\$3,200.00					(\$3,200.00)	PCO was issued on 4/6/18. Issue was discussed during Summer 2017, Owner asked how long walkway could stay and Suffolk replied the walkway could be filled in during Winter 2018	REJECTED
#006		J. Derenzo	Replacing handicap parking spaces and surroudnig site repairs	\$29,020.00			\$29,020.00		\$0.00	Suffolk sent PCO on 4/12/18	PRE-GMP
#007		J. Derenzo	Form, Reinforce, and Pour concrete for sidewalks for handicap parking spaces	\$10,343.00			\$10,343.00		\$0.00		PRE-GMP
#008		J. Derenzo	Credit proposal for sand bedding under water line	(\$3,200.00)			(\$3,200.00)		\$0.00	PCO issued on 6/4/18 by Suffolk	PRE-GMP
#009		J. Derenzo	Credit for telecom line backfill per XE-002	(\$9,500.00)			(\$9,500.00)		\$0.00	PCO issued on 6/4/18 by Suffolk	PRE-GMP
#010		WJGEI	Additional grounding required by AHJ for the CT cabinet to be grounded water and fire mains	\$4,312.32			\$4,312.32		\$0.00		PRE-GMP
#011	PR #002	JDC Demo	PR #02 - Salvaging of existing precast floor slab planks on level 1 of 1986 CTE wing, Adjusted floor trenching demolition, additional existing structured slab removal on level 2 Part D for HVAC shafts	\$18,087.42			\$18,087.42		\$0.00	PCO issued 6/18, response issued 7/15. Subcontractor responded but PMA team not copied, no record of response in PMA file. SCCI subs reviewing and may be revising costs as of 11/29/18. JDC stands by their cost 12/6/18. DF still needs to issue comments 12/13/2018. 1/3/19 PMA reissued SMMA comments to SCCI. 1/17/19- BIC SMMA. 1/24/19 PMA forwarded SMMA coments to SCCI. SCCI to respond	PRE-GMP
#012		Triumph	Added ceiling soffits for HEPA filters, Relocate T Stats, Relocate 6 EBU's, and Computer car t charging stations	\$9,580.74				\$9,124.51	(\$456.23)	PCO issued on 7/2/18, SMMA provided comments on 8/2/18. SMMA/PMA forwarded on 11/30/18 to SCCI. SCCI waiting on Triumph response as of 12/13/2018. 1/17/19- SCCI still waiting on response from Triumph. 1/24/19 SCCI to email Triumph with hard date of Monday 1/28/19 for revised PCO or void. 2/7/19 SCCI forwarded Triumph Contract. 2/12/19 PMA sent comments to SMMA to review. 2/14/19 Missed buyout items funded by Amendement 2 hold. 2/21/19- PMA issued comments back to SCCI on 2/20, revise and resubmit. Jake F responded on markerboard location funding, team to review in PCO meeting, SCCI to issue PCO to be routing	PRE-GMP
#013		JDC Demo	Remove and Salvage the BAS relief Panels in advance of demolition of C wing buildings	\$32,824.10			\$26,456.35		(\$6,367.75)	PCO sent to PMA on 7/9/18. Suffolk chose to use JDC demo to get work started. Suffolk chasing V&G Ironworks for credit. PCO Signed on 11/9/18. SCCI issued revised PCO ON 12/12/2018 adding \$3000 to JDC Demo costs and removal of CM Fee (\$1500) for net change of \$1500 additional. PMA / SMMA approved on 12/13/2018	PRE-GMP
#014		JDC Demo	Remove and Abate unforeseen mastic on brick infills on C and D wing	\$62,288.46			\$59,322.34		(\$2,966.12)	PCO executed on 8/22/18	PRE-GMP
#015		Lighthouse	Costs to store historic masonry products	\$9,240.00					(\$9,240.00)	Suffolk sent PCO on 7/13/18, SMMA responded and rejected on 7/17/18. PMA reminder issued to SMMA on 11/29. Originally was rejected from LF email on 7/17/18, carried as such now	REJECTED
#016	PR #001	Beauce Atlas	PR #1 - Changes from Early Steel to 100% Drawings	\$8,185.80			\$7,227.00		(\$958.80)	PR #1 issued on 5/2/18. Suffolk submitted costs on 7/30/18. SMMA response 8/7. Suffolk requested meeting to review on 8/16, SMMA sent email to PMA of acceptable costs on	PRE-GMP
#017	CCD #002	JDC Demo	CCD-002 - Abatement of ACM at two areas on the B and D wings: east façade of the D wing between the ED line and the FD Line and west façade of the B Wing. Attachment: CDW report dated 8/7/1	\$2,700.00			\$2,678.32		(\$21.68)	required as CCD to allow for timely demolition of B&D wings	PRE-GMP
#018		V&G Iron	Temporary Stair @ Gymnasium - additional credit required for what was carried in original bid docs	\$113,216.46			\$107,825.20		(\$5,391.26)	Temporary stair at back of gymnasium for egress per TA-402. Misc metals used after finding that scaffold stair system would not support loads for the 240 person capacity. PCO executed on 10/09/2018	PRE-GMP
#019		J.Derenzo	PCO #019 - reconciliation pricing for the haul road scope along Medford Street.	\$217,487.00					(\$217,487.00)	PCO submitted on 9/11/18. PMA requested funding source 9/20. No SCCI response. PMA response issued and rejected 11/29. SCCI to review interally with PMA prior to adjusting), additional detail is required for review 12/6/18. CC- needs to be resubmitted and broken out. SCCI reviewing today 12/13/2018. SCCI sent revision on 12/19/18. Removed stripping and Hauling and will be sent as separate PCO. SMMA/PMA reviewing as of 12/20/18. 1/2/19 SMMA reissued comments to PMA to be discussed at meeting. 1/4/19 PMA Formal Rejection Issued. 1/17/19- MEETING scheduled for 1/22 with PMA/SMMA/SCCI/J Derenzo. 1/24/19 PMA sent email questioning the additional \$16/Ton for loam that appears to be previously paid for. 1/31/2019 Reconciled in PCO #056R1	VOID
#020	SK TS-1 & 2	Marguerite	Concrete Footings for temporary stair SK TS-1 & SK TS-2	\$6,932.00			\$6,932.00		\$0.00	PCO executed on 10/9/18.	PRE-GMP
#021		Beauce Atlas	Changes in design from Submittals and RFI's through Sequence 18.	\$77,294.00			\$43,370.55		(\$33,923.45)	PMA sent comments to SMMA on 10/23/2018. Awaiting response from SMMA. Per DF email 11/26 comments to be provided by EOW. SMMA provided comments on 11/30/18 and was forwarded to SCCI on 12/3/18. 12/13/2018 SCCI- out of office Beauce Atlas this week. Follow up next week. SCCI to send revised PCO & comments back for PL/SMMA to review and then schedule a meeting onsite for review. 1/3/19 PMA Comments Issued, SCCI to respond. 1/17/19- SCCI resubmitted on 1/10. 1/31/2019 SMMA to provide comments by EoW. 2/7/2019 SMMA to have comments by Monday 2/11/2019. 2/14/19 SMMA to have comments by next meeting. 2/21/19- SMMA/SCCI to set up a phone call. 2/28- Phone call with SMMA, SCCI, and Beauce Atlas still needs to be scheduled. 03/07/19- Beauce Atlas coming to site next Wednesday, meeting tentatively @ 2:00 P.M. with SMMA/SCCI/BA 03/13. 03/14/19- BA meeting with SMMA/SCCI/PMA yesterday 3/13. BA to provide back up on some costs, ball in court SCCI. 03/21/19- No change, B.I.C. SCCI. 3/28/19- SCCI has received some revised proposals, will wait until they have al comments back and will send to team. 04/04/19- SCCI received information from BA, to issue response back to SMMA/PMA. 04/11/19- SCCI formal revision imminent. 04/18/19- SCCI issued revision on 04/11, SMMA sent comments back to PMA on 04/16. PMA to issue comments to SCCI today. 04/25/19- PMA issued comments to SCCI, SCCI responded with reason for increase on one of the COR (Labor cost was forgotten at first), B.I.C SMMA for review. 05/02/19- No change, B.I.C SMMA for review. 05/09/19- PCO is approved, signatures routing.	PRE-GMP
#022R2	N/A	JDC Demo	Additional costs to mobilize abatement crew to abate 50 LF of asbestos containing pipe insulation and abate 250 LF of subsurface transite pipe	\$11,000.00			\$5,575.00		(\$5,425.00)	SCCI sent PCO on 9/21/18. PMA responded on 9/24/18. SCCI sent revised pricing on 9/24/18. PCO executed on 10/10/18Not to Exceed Allowance. FINAL cost determined based on actual quantity and unit prices. Ben Carawan resubmitted R2 on 11/2/2018. PCO executed on 11/9/18	PRE-GMP
#23R1	N/A	Fire Equipment Inc.	Fire Equipment Invoices for Summer Enabling work	\$23,249.19			\$23,249.19		\$0.00	See email correspondence between PMA, SCCI, & FEI for information. Invoices include SIN063394, SIN063810, SIN065991, SIN062631, SIN062921. PCO executed on 11/14/18	PRE-GMP
#23A	N/A	Fire Equipment Inc.	Fire Equipment Co.- Plug in Plug out Part 2	\$5,374.56		\$5,374.56			\$0.00	05/16/19- SCCI to formally submit PCO ASAP. 05/23/19- Ongoing. 05/30/19- Ongoing, B.I.C. SCCI to submit PCO. 06/06/19- Ongoing, SCCI to submit PCO. SCCI submitted PCO on 06/07. 06/13/19- B.I.C. PMA/SMMA for review.	PMA/SMMA
#024		K&K Acoustical	Temporary ceiling work completed on 8/14/18 and 8/25/18 and Temporary ceiling work completed on 8/20/18	\$17,633.90				\$16,794.19	(\$839.71)	PMA added to PCO log on 11/14/2018 to reconcile with SCCI log. SCCI submitted PCO on 11/13/18. PMA returned comments to SCCI on 11/21/18. SCCI response issued 11/27. SMMA provided response that removal was called out and SCCI chose to install new ceilings to cover work. SCCI to resubmit as \$0 PCO CM contingency. 12/13/2018- SCCI providing revised cover letter, Executed on 12/13/18	PRE-GMP

PMA Construction Change Authorization Log

Key:	Approved	Under Review	Rejected	Pending
------	----------	--------------	----------	---------

#025	N/A	P.J. Spillane	COR #501 - Waterproof electrical room (1/2). COR #502 - Waterproof electrical room (2/2). COR #503 - Located at the temp roof of the lower level CTE electric room, dug down and sealed off pipes at new ductbank using liquid mastic to prevent water from leaking into the electrical room below	\$15,845.95				\$13,966.46	(\$1,879.49)	PMA added to PCO log on 11/14/2018 to reconcile with SCCI log. SCCI to submit PCO. SCCI submitted PCO on 11/13/18. PMA responded on 11/21/18. SCCI response issued 11/27, chasing update from Spillane on small tools. SCCI going to cut small tools out and resubmit (12/6/18). Review separately with regards to CM Cont vs. owner. Rates to be reviewed/compared. SCCI provided revision of the PCO addressing comments on 12/10/2018. 12/13/2018 PMA/SMMA to review revision. SCCI to have Spillane revise rates based on SB email from 12/13/18. PCO to be revised based on acceptable rates.1/9/19 PMA/SMMA comments issued to SCCI. 1/17/19- SCCI recieved revised tickets, rates are still needed. 1/24/19 Ready for signatures	PRE-GMP
#026R2	N/A	JDC Demo	JDC Demo COR #05.4 - Non-tradiitonal abatement of unforeseen asbestos tunnel and insulation (NTWP). Lump sum portion.	\$258,827.10			\$113,361.99		(\$145,465.11)	PMA added to PCO log on 11/14/2018 to reconcile with SCCI log. SCCI to submit PCO. SCCI submitted initial pricing on 11/13/18. PMA sent initial comments back on 11/14/18. SCCI sent revised PCO back on 11/23/18 and requested a meeting. Following meeting on 11/26/18 between SCCI/PMA/JDC Demo slips are to be provided daily. PMA bootleg comments issued to SMMA on 11/27, SMMA reviewing. PMA returned comments on 11/30/18. T&M work was recommended.Following meeting with PMA/SCCI/SMMA/JDC on 12/3/18 costs for work completed to date were negotiated and work yet to occur was determined to be split into second (268) for tracking. 12/13/2018- after meeting PCO was to be split lump sum and T&M. SCCI provided revision with only Lump Sum amount, T&M still needs to be reconciled. PMA to review, SCCI to provide signed copy. Approved on 12/13/18	PRE-GMP
#026R2A	N/A	JDC Demo	JDC Demo COR #05.4 - Non-traditonal abatement of unforeseen asbestos tunnel and insulation (NTWP). T&M portion						\$0.00	PMA added to PCO log on 11/14/2018 to reconcile with SCCI log. SCCI to submit PCO. SCCI submitted initial pricing on 11/13/18. PMA sent initial comments back on 11/14/18. SCCI sent revised PCO back on 11/23/18 and requested a meeting. Following meeting on 11/26/18 between SCCI/PMA/JDC Demo slips are to be provided daily. PMA bootleg comments issued to SMMA on 11/27, SMMA reviewing. PMA returned comments on 11/30/18. T&M work was recommended.Following meeting with PMA/SCCI/SMMA/JDC on 12/3/18 costs for work completed to date were negotiated and work yet to occur was determined to be split into second (268) for tracking. 12/13/2019- SCCI to provide signed copy. 1/17/19 T&M still being tracked, SCCI to issue PCO once work is complete. 1/31/2019 SCCI noted JDC wants to wait to submit final costs. 2/14/19 SCCI to submit costs once slips are recieved. 2/21/19- Once SCCI gets price will issue PCO. 2/28/19- NO change from previous week. 03/07/19- SCCI to follow up with JDC, JDC possibly waiting on WM TREE load counts, PMA/SMMA can review T/M costs separte in advance if needed. 03/14/19- JDC sent pricing to SCCI, SCCI vetting and then will forward over to PMA/SMMA. 03/21/19- No change, B.I.C. SCCI. 04/18/19- No change B.I.C. SCCI. 04/25/19- PCO WAS CAPTURED AS PCO #132, VOID.	VOID
#027	Field Condiiton	JDC Demo	JDC Demo COR #06 - Abate unofreseen transite pipe found on 10/19/2018	\$14,450.00			\$5,850.47		(\$8,599.53)	Latent condition - Mobilization and Excavation. SCCI to review/resubmit based on actual linear footage. Soils Management Allowance (To be reconciled for linear footage). PMA sent comments back to SCCI on 11/14/18. Work proceeding T&M, actuals to be reconciled. SCCI to resubmit (12/6/18). SCCI resubmitted PCO on 12/7. PMA/SMMA to review/confirm pricing 12/13/2018- SCCI to provide signed copy.	PRE-GMP
#028	Field Condiiton	JDC Demo	JDC DEMO COR #03 - Premuim time for summer demolition work; JDC DEMO COR #04 - Down Time waiting to demolish remaining C wing corridor while other trades perform cut and cap of the fire sprinkler line running into original B wing; JDC DEMO COR #05 - Sawcut and demo E wing slab for unforeseen electrical utilities	\$19,082.31			\$8,181.05	\$7,342.26	(\$3,559.00)	PMA added to PCO log on 11/14/2018 to reconcile with SCCI log. SCCI submitted PCO on 11/15/18. PMA returned comments to SCCI on 11/21/18. 12/20/2018- SCCI still reviewing and chasing. 1/15/19 SCCI resubmitted same costs. 1/17/19- SCCI issued revised PCO on 1/15. 1/31/2019 PMA/SMMA comments sent. 2/7/2019 SCCI to review with JDC Demo and respond to comments. 2/13/19 SCCI responded, PMA/SMMA reviewing. 2/21/19- PMA issued comments SCCI today 2/21, SCCI to review. 2/28/19- ROUTING	PRE-GMP
#029R2	N/A	Simplex	Simplex CR #1 - Premium time for work on Saturday 8/4/18. Simplex CR #2 - Premium time for work on Saturday 8/11/18. Simplex CR #3 - Drop sprinkler heads in D wing lower corridor - Ceiling lowered due to coordination	\$3,995.47				\$2,875.37	(\$1,120.10)	PMA added to PCO log on 11/14/2018 to reconcile with SCCI log. SCCI to submit PCO. SCCI Submitted PCO on 11/20/18. PMA returned comments to SCCI on 11/21/18. SCCI to review and reubmit. SCCI resubmitted PCO on 12/10 with revised / lowered hours and attached rates. PMA/SMMA to review new cost. SB comments revised, should be good to go. SCCI adjusting for contingency draw 12/20/18 and rates are acceptable. All backup to be included. 1/3/19 SCCI revising and resubmitting for CM contingency. 1/7/19 #029R2 submitted by SCCI.	PRE-GMP
#030	N/A	Dow	SOMR Soils 2018-1 Haul to Al Saugus	\$286,703.00				\$286,703.00	\$0.00	Soils Management Allowance. SCCI submitted PCO on 11/20/18. PMA responded with comments on 11/21/18. SCCI returned additional slips missing from original on 11/26/18. Awaiting CDW confirmation of soil classification. CDW provided response on 11/29/18. Routing. PMA forwarded signed cover sheet on 12/6 to Ben/Jake from Suffolk.	PRE-GMP
#031	N/A	P.J. Kennedy	PJK PCO #002 - Repair EF-9 Motor which had failed serving existing boys and girls bathrooms & PCO #003 - Replace cracked heating coil in athletic trainers room	\$2,889.82			\$772.77	\$2,025.11	(\$91.94)	SCCI submitted PCO on 11/26/18. SMMA responded that PCO #004 portion to be removed (coil cracked during demolition). Revised PCO issued 11/27. Need city signature 11/29/18	PRE-GMP
#032		J. Derenzo	Derenzo COR #10, 10A, 11 - Soil haul out to WM Tree & Coventry (Loam)	\$254,680.16				\$254,680.00	(\$0.16)	Soils Management Allowance. Rec'd 11/28, PMA reviewing. SMMA found costs acceptable on 12/6/18. PMA checking tipping fees and will respond. 12/13/2018- SCCI provided unit rate back up. PCO executed on 12/13/18	PRE-GMP
#033	N/A	DOW	Additional soil export from soil management allowance (Coventry, Saugus) (Premium time opening Saturday and tonnage fee)	\$81,412.00				\$81,412.00	\$0.00	SCCI submitted PCO on 12/5/18. PMA reviewed slips and they match. Unit prices to be checked. 12/13/2018- PMA ready to sign PCO, SMMA ball in court for possible CDW review.. PCO executed on 12/13/18	PRE-GMP
#034		SCCI	This PCO represents the reconciliation of the Amendment #2 to the actual costs for the scopes of work included in this Amendment per the enclosed documentation.	(\$35,213.92)			(\$25,687.27)		\$0.00	SCCI issued PCO on 04/30/19. 05/02/19- PMA/SMMA to review. 05/09/19- No change, B.I.C. PMA/SMMA. 05/16/19- PMA reviewing internally. 05/23/19- PCO is signed.	PRE-GMP
#035	PR #005	V&G Iron	Costs to pickup and relocate BAS Owl Panels	\$3,865.99				\$3,606.30	(\$259.69)	SCCI submitted costs on 11/29/18. PMA/SMMA provided comments on 11/30/18. 12/13/2018- issue with Dow moving OWLs to street for V&G. PCO on hold for now. 1/31/2019 On hold still. 2/21/19- OWLS 18/23 have been removed, SCCI to review V/G costs associated with Dow slip. 2/28/19- SCCI to touch base with JA. 03/07/19- As of now no costs have been associated to this work, PCO is rejected. 04/11/19- SCCI received formal revision from V/G today, to submit. 04/18/19- PCO revision imminent from SCCI. 04/25/19- SCCI still to issue PCO revision, working with Dow/V&G. 05/02/19- No change, B.I.C. SCCI to issue PCO for review. 05/16/19- No change, B.I.C. SCCI to submit PCO for review.	PRE-GMP
#038	N/A	Lighthouse	Lighthouse PCO #12 - Furnish and install hand set precast pieces not tagged to FSB	\$84,093.06			\$78,190.64		(\$5,902.42)	SCCI submitted costs on 11/30/18. PMA provided comments to SCCI on 12/3/18. SCCI to provide breakdown of material. SCCI provided breakdown of costs on 12/7. PMA/SMMA to review breakdown, Suffolk to reconcile \$200 when all comments are back. PMA sent follow up to SMMA on 12/26. 1/2/19 SMMA issued comments to PMA to be discussed at meeting. 1/3/19 PMA to review and issue comments. 1/3/19 SCCI to remove Fee Markup and resubmit. See DF email 1/2/19 regarding Beton potential ownership of some scope, need clarification from SMMA. 1/9/19 SCCI issued revision removing markups	PRE-GMP
#039	N/A	Lighthouse	Lighthouse PCO #006 - Remove existing door frame and infill with CMU at corridor CTA wing basement. Lighthouse PCO #007 - Fixing existing gym door back patio and infilling penetrations. Lighthouse PCO #008 - Demo, tooth, and parge gym entrances for temp stair. Lighthouse PCO #009 - Repair stairs for egress at Building D (library Steps). Lighthouse PCO #010 - Demo unsafe brick above arched windows that were removed for historical society	\$23,165.22				\$20,583.19	(\$2,582.03)	SCCI submitted PCO on 12/4/18. PMA/SMMA reviewed and responded to SCCI on 12/12 with comments on PCO for different items approved for CM contingency / rejected. SCCI to issue back revision/comments. 12/12/2018 PMA issued comments back to Suffolk. Suffolk to review. 12/13/2018- SCCI to address comments issued on 12/12/2018. 1/17/19- SCCI actively working with Lighthouse. 1/24/19 No Update. 1/31/2019 SCCI waiting on comments. 2/7/2019 SCCI reviewing. 2/21/19- SCCI still chasing Lighthouse, will follow up. 2/28/19- SCCI/Lighthouse to send revised PCO. 03/07/19- SCCI has missing slips, needs to update, and resubmit PCO. 03/14/19- JF to follow up with BC on update. 03/21/19- SCCI to compile tickets (received) and issue to PMA/SMMA. 04/04/19- PCO was approved last week for funding out of SCCI's contingency.	PRE-GMP
#047	N/A	WJGEI	WJGEI Proposal #3, 11, 13, 14, 15, 16, 17, 18, 19, 20, 25, 26, 27, 28, 29, 30, 31, 37	\$84,034.52			\$43,383.65	\$19,620.00	(\$21,030.87)	SCCI submitted PCO on 12/5/18. PMA/SMMA reviewing as of 12/13/2018. SMMA comments rec'd 1/3/19, PMA response issued 1/8/19. 1/10/2019 PMA reviewing portion rejected for premium time. SCCI resubmitted with \$19,620 to be funded from Contingency and remaining \$43,383.65 to be funded from owner. 1/17/19 PCO approved from PMA/SMMA.	PRE-GMP
#048		Pavilion Flooring	Pavilion Flooring PCO #048- install black cover base at temp walls and finished spaces during Summer 2018 enabling. Example being a temp. Fitness room and other areas in the B Wing Offices and D Wing / Ewing Spaces.	\$3,496.12				\$3,009.88	(\$486.24)	SCCI submitted PCO on 12/11/2018. 12/13/2018 PMA sent comments rejecting PCO until back up on PCO is submitted from SCCI. SCCI to address and itemize scope. 1/17/19- SCCI to document plan with locations of base installed. 1/24/19 No Update. 1/31/2019 SCCI working with pavilion to provide backup. 2/7/2019 SCCI reviewing OT charges. 2/12/19 SCCI resubmitted with photos, PMA/SMMA reviewing. 2/21/19- SMMA issued comments to PMA 2/20, PMA added comments and issued back to SCCI today, PCO was sent back as rejected as work is owned under contract drawings.	PRE-GMP
#049		Dow Company	Dow Company PCO #049- proposal for inefficiency during the mass excavation for Phase 1 Foundations in October.	\$44,789.76		\$44,789.76			\$0.00	SCCI submitted PCO on 12/11/2018. PMA/SMMA ball in court to review. 1/8/19 PMA response issued, need more productivity data to analyze & respond. 1/17/19- PMA issued comments back to SCCI on 1/9. 1/8/19 PMA emailed SCCI notifying that PMA is unable to verify Dow's claim until productivity data can be compiled and reviewed. 1/24/19 PMA working to reconcile with all other PCO's and daily reports. 2/21/19- PCO still on hold, review schedule impact cost. 2/28/19- PCO still on hold, review schedule impact cost. 03/07/19- PCO still on hold, review with schedule impact cost. 03/14/19- PCO still on hold, to be reviewed with schedule impact cost. 03/21/19- PCO still on hold, to be reviewed with schedule impact cost. 04/04/19- PMA letter issued on 03/27 formally rejects Dow's ineffieny PCOs. SCCI to follow up with Dow, and risk to still be tracked here until (if) a formal response from Dow is heard. 04/11/19- SCCI met with Dow Monday 04/08 on Schedule Impact cost, meeting with Dow will be needed in the future to discuss costs. 04/18/19- SCCI following up with Dow, meeting needed to discuss with Dow from all parties needed. 04/25/19- SCCI still working with Dow, meeting between all parties is still needed for discussion. 05/02/19- SCCI stil working with Dow, meeting between all parties is still needed for discussion. 05/09/19- SCCI stil working with Dow, meeting between all parties is still needed for discussion. 05/16/19- SCCI still working with Dow, meeting between all parties is still needed for discussion. 05/23/19- Ongoing, no change from last week. 05/30/19- Ongoing, no change from last week. 06/06/19- Ongoing, no change. 06/13/19- Ongoing, no change.	SCCI/HOLD

PMA Construction Change Authorization Log

Key:		Approved	Under Review	Rejected	Pending							
#050	RFI #139, PR #022	WJGEI	T&M Work for Summer enabling. WJGEI Proposal #07 - Rework fire alarm equipment and devices located in the gym not shown on the electrical drawings. WJGEI Proposal #08 - Rework and re-wire 1600A SWBD-2 not shown on the electrical drawings. WJGEI Proposal #09 Rework and re-wire electrical panels and associated branch wiring located in the gym not shown on electrical drawings. Proposal #10 - Summer premium time to accelerate work	\$202,918.70		\$200,085.33			(\$2,833.37)	SCCI submitted PCO on 12/11/2018. Link provided does not contain the PCO, PMA responded to SCCI on 12/13 for new link. SCCI sent new link, GGD comments due by 1/8/19. 1/10/2019 SMMA to issue comments by end of week. 1/17/19- SMMA still working on finalizing comments. 1/24/19 GGD/SMMS comments are ready, PMA hopes to have comments to SCCI today. 1/29/2019 PMA sent comments to SCCI. 1/31/2019 WJGEI reviewing, SCCI to update when WJGEI comments recieved. 2/7/2019 SCCI/WJGEI to provide response. PMA to provide foreman rate response. 2/21/19- SCCI to issue response on rate, review other PCO comments. 2/28/19- SCCI reviewing still. 03/07/19- WJGEI has to provide credit, resubmit to SCCI, SCCI to revise and resubmit. 03/14/19- WJGEI revising one proposal. SCCI wants separete meeting with this PCO. SCCI possibly to break out approved/unapproved costs. 03/21/19- SCCI to follow up internally and schedule team meeting. 3/28/19 - SCCI estimator to review. 04/04/19- SCCI estimating to see if work done to see if T&M slips are accurate. 04/11/19- SCCI working on estimation still. 04/18/19- SCCI still working on estimate. 04/25/19- SCCI still working on estimate. 05/02/19- SCCI still working on estimate. 05/09/19- SCCI estimator reviewing now. 05/16/19- B.I.C. SCCI estimating department. 05/23/19- No change, B.I.C. SCCI. 05/30/19- No change, B.I.C. SCCI estimating. 06/06/19- SCCI ball in court/estimator. 06/13/19- JF to follow up with estimator.	SCCI	
#051	RFI #253	JDC Demo	JDC Demo PCO #051- proposal for additional beam pockets per RFI 253. Pricing includes labor, equipment, materials and disposal necessary to expose steel beam connections in the locations shown for new construction. PMA NOTE- IT SHOULD BE RFI 253 REFERENCED.	\$25,337.81			\$19,422.95		(\$5,914.86)	SCCI submitted PCO on 12/12/2018. 12/13/2018- DF issued back comments to SCCI today on quantities. SCCI to review with JDC and get back to team with quantities to enable team review. DF reviewing and to respond as soon as possible. Infill of beam pockets to be tracked as separate PCO if/as required. 1/4/19 comments issued to SCCI. 1/17/19- SCCI issued revised PCO, SMMA approved, PMA to review. 1/24/19 PCO Routing	PRE-GMP	
#052		JDC Demo	JDC Demo PCO #052- change order represents mechanism to remove the \$598,500 of allowances from the JDC Demo subcontract into individual allowances to be managed within the GMP.	\$0.00			\$0.00		\$0.00	SCCI submitted PCO on 12/12/2018. PMA /SMMA ball in court to review.	PRE-GMP	
#053A		Dow Company	Dow Company PCO #053- attached back up for T&M from the Dow Company working around Wall #16 and the unforeseen pipes that were encountered. Ticket 103240- Down time waiting for car to be moved / towed, and double handle of soils that were not yet classified by CDW. Ticket 103241- Over ex unsuitable material and recharge with 3/4 stone per direction of Geotech. Ticket 103242- Excavate around and over ex for unforeseen drain and water lines based upon sketches issued by SMMA. Ticket 103243- Excavate around and over ex for unforeseen drain and water lines down to suitable material.	\$19,583.00			\$9,924.42		\$2,446.18	(\$7,212.40)	SCCI submitted PCO on 12/12/2018. 1/10/2019 PMA/SMMA issued comments back to SCCI. 1/15/19 SCCI questioned PMA/SMMA comments. 1/15/19 PMA sent \$28.5/CY for over excavation and \$30/CY for Granular Backfill, not SCCI \$123/CY. All to review. 1/17/19- SMMA issued comments 1/9. SCCI to re-issue PCO with unit rates / bill against allowance. 1/24/19 SCCI to adjust cover sheet showing correct allowance draw/Need to tie out qualification if it exists. Update 1/31/2019 DG to call dow to discuss rates. 2/7/2019 SCCI still working on this. 2/21/19- SCCI ball in court. 2/28/19- SCCI to separete approved/unapproved slips, resubmit. 03/07/19- SCCI/DOW to revise labor rates, equipment rates, and resubmit PCO. 03/14/19- JF to follow up with JA next week. 03/21/19- Dow is updating pricing, SCCI to resubmit PCO once they receive this information 3/28/19 : 53A ok, 53B broekn out	PRE-GMP
#053B		Dow Company	Dow Company PCO #053- attached back up for T&M from the Dow Company working around Wall #16 and the unforeseen pipes that were encountered. Ticket 103240- Down time waiting for car to be moved / towed, and double handle of soils that were not yet classified by CDW. Ticket 103241- Over ex unsuitable material and recharge with 3/4 stone per direction of Geotech. Ticket 103242- Excavate around and over ex for unforeseen drain and water lines based upon sketches issued by SMMA. Ticket 103243- Excavate around and over ex for unforeseen drain and water lines down to suitable material.	\$5,474.54	\$1,290.27					(\$4,184.27)	04/04/19- SCCI working on formal PCO for disputed costs on SL 103241. 04/11/19- Ongoing, SCCI to submit PCO. 04/18/19- Ongoing, SCCI to submit PCO. 04/25/19- Ongoing, SCCI to submit PCO. 05/02/19- Ongoing, SCCI to submit PCO. 05/09/19- SCCI to formally submit PCO. 05/16/19- SCCI to formally submit PCO. 05/23/19- PCO was submitted on 05/21, PMA responded rejecting PCO, back and forth ongoing between parties. PMA/SMMA to review. 05/30/19- PMA to respond w/ unit price discussion from last week. 06/06/19- No change, PMA to respond. PMA responded on 06/11 for PCO to be revised based of unit pricing, SCCI/Dow responded with unit price they think is applicable. PMA responded asking for further explanation on unit price differences. 06/13/19- PMA/SMMA/SCCI agreed on unit price for work, PCO is ROUTING.	ROUTING
#054	N/A	WJGEI	Added wall pack lighting at mods	\$10,422.09			\$10,422.09		\$0.00	PMA authorized T&M for installation. SCCI submitted costs on 12/17/18	PRE-GMP	
#055		PJK	Add a thermostat to the dead space, wire, and program alarms for low temps PER rfi 151.1. Wiring is needed to be run to the nearest AHU controller to interface for alarm feedback.	\$2,715.81					(\$2,715.81)	12/18/18- PCO issued from SCCI per RFI 151.1. 01/03/2019- Ball in court for review is PMA. 1/17/19- PCO on hold, review during cold days	VOID	
#056		J Derenzo	J Derenzo PR #10 - Strip & Dispose of Loam . See PR as requested to split the loam strip and dispose from the original PCO #019. Attached back-up includes the breakdown of labor and equipment needed.	\$198,205.80			\$50,190.04	\$76,016.00	(\$71,999.76)	12/19/2018- PCO #056 originated on this date. 01/03/2019- Ball in court PMA to review. 1/4/19 - PMA rejection issued. 1/17/19- Meeting with SCCI, PMA, SMMA, and J Derenzo on 1/22. 1/24/19 PCOs 19, 32, and 56 may be tied together at this point, PMA is reconciling	PRE-GMP	
#057	CCD #001	Henniger Door	Revisions associated with temporary egress door swings and hardware as a result of RFI #129 and RFI #150. Reversal of swing for the door leading from the autobody shop out to the exterior vehicle tunnel, as well as the addition of a panic bar exit device and exterior lever on that door. Adjustment of luminescent striping from the fab lab to pass through the swigning door as opposed to the overhead coiling door. Removal of the existing door leaves from the door frame leading from the fab lab into the autobody space. Addition of a panic bar exit device on the door leading from the hallway outside the fab lab into the fab lab (Door #TC-2). Deletion of the need to reverse the swings of door #'s TC-13 and TC-14. Revisions to the reported design occupancies of the automotive tech shop, the carpentry classroom and the early education shop to better reflect the planned tmeporary usage of the space until April 2019 when phase 1A begins	\$13,175.50			\$4,003.59	\$8,100.00	(\$1,071.91)	CCD #001 executed on 8/8/2018. T&M Slips forthcoming from SCCI. 1/15/2019 SCCI submitted costs. SCCI proposing \$5,075.50 out of Owner Contingency and \$8,100 out of Allowance. 1/17/19- PCO in review from PMA/SMMA. 1/24/19 Waiting for SMMA comments before sending to SCCI. 1/30/2019 PMA/SMMA comments sent to SCCI. 2/7/2019 SCCI reviewing and responding. 2/21/19- SCCI to provide more backup. 2/28/19- SCCI to revise PCO to distinguish between cost/ no cost items. 03/07/19- SCCI issued PCO revision on 2/28/19, SMMA/PMA to review. 03/14/19- SMMA sent comments to PMA on 3/13. Ball in Court PMA to review. 03/21/19- SCCI to issue revised PCO, PCO to be approved after revision.	PRE-GMP	
#058		Dow Company	Allowance transfer authorization request represents the costs associated with the soil export to the enclosed facilities as outlined in the attached tickets.	\$58,787.00				\$58,787.00	\$0.00	01/03/19- PCO #058 issued. 01/10/2019 PMMA issued comments to SCCI. 01/10/2019 SCCI responded with \$100 correction	PRE-GMP	
#060		JDC Demo	Allowance transfer authorization - subsurface transite, ACM foundation mastic, vapior barrier	\$30,700.00				\$30,700.00	\$0.00	01/03/19- PCO #058 issued. Ball in Court PMA/SMMA for review	PRE-GMP	
#061		Dow Company	Dow Excavation Inefficiency Costs for November 2018	\$95,358.19		\$95,358.19			\$0.00	SCCI issued PCO on 01/16/19. 1/8/19 PMA emailed SCCI notifying that PMA is unable to verify Dow's claim until productivity data can be compiled and reviewed. 01/17/19- PCO under review from PMA/SMMA. 1/24/2019. 2/21/19- PCO still on HOLD, review with schedule impact. 02/28/19- PCO still on hold, to be reviewed with schedule impact. 03/07/19- PCO still on hold, to be reviewed with schedule impact. 03/14/19- PCO still on hold, to be reviewed with schedule impact costs. 03/21/19- PCO still on hold, to be reviewed with schedule impact costs. 04/04/19 PMA letter issued on 03/27 formally rejects Dow's ineffiency PCOs. SCCI to follow up with Dow, and risk to still be tracked here until a formal response from Dow is heard. 04/18/19- SCCI following up with Dow, meeting needed to discuss with Dow from all parties needed. 04/25/19- SCCI still working with Dow, meeting between all parties is still needed for discussion. 05/02/19- SCCI stil working with Dow, meeting between all parties is still needed for discussion. 05/09/19- SCCI stil working with Dow, meeting between all parties is still needed for discussion. 05/16/19- SCCI still working with Dow, meeting between all parties is still needed for discussion. 05/23/19- Ongoing, no change from last week. 05/30/19- Ongoing, no change from last week. 06/06/19- Ongoing, no change. 06/13/19- Ongoing, no change.	SCCI/HOLD	
#062		JDC Demo	JDC Downtime on T&M from GRs	\$3,212.00				\$0.00	(\$3,212.00)	Funded from Suffolk Lump Sum GRs (PMA to track in Master Budget	PRE-GMP	
#063		Proscan	Proscan for Latent Subsurface Conditions	\$1,114.78			\$1,114.78		\$0.00	Issued 1/7/19. PMA approved 1/7/19.	PRE-GMP	
#064		Greenwood	Install Temp Roof Curb for EF #09	\$1,220.76				\$1,220.76	\$0.00	Issued 1/7/19. PMA approved 1/7/19.	PRE-GMP	
#066	Field Condiiton	Boston Chimney	Demo down and brace the chimney	\$54,892.51					(\$54,892.51)	SCCI submitted costs on 1/09/2019. 01/17/19- PMA issued comments back regarding other pricing for this work and credit from JDC demo. PCO review is ongoing for this item from all parties. 1/24/19 Replaced by PCO #069. 1/31/2019 SCCI reviewing and resubmitting pricing following discussions (DG working with JDC, firming up to Boston Chimney to \$50K, Take cost for protection of breaching in GC/GR, PMA to discuss with TP)	VOID	
#067	N/A	Beauce Atlas	Steel Beam Penetration Allowance Transfer (\$15,900)	\$0.00				\$0.00	\$0.00	PCO Submitted on 2/1/19 for a \$0 PCO. Allownace transfer of \$15,900. 2/7/2019 PCO is routing	PRE-GMP	
#069	Field Condiiton	JDC Demo, Boston Chimney	Demolish top 20' of existing chimney	\$34,369.24			\$34,369.24		\$0.00	SCCI submitted costs on 1/14/2019. 1/15/2019 PMA sent comments back. SCCI to review. 1/17/19- SMMA issued comments regarding de scope not matching proposed demolition plan. Revised PCO from JDC needed. 1/24/19 SCCI working with JDC to address SMMA comments regarding descope. 1/31/2019 SCCI reviewing and resubmitting pricing following discussions (DG working with JDC, firming up to Boston Chimney to \$50K, Take cost for protection of breaching in GC/GR, PMA to discuss with TP)	PRE-GMP	

PMA Construction Change Authorization Log

Key:	Approved	Under Review	Rejected	Pending
------	----------	--------------	----------	---------

#070	PR #023	Grasseschi	CO 2P - Premium time on summer work, CO 3P - Investigate and test gas line, added ball valves on temp water service	\$40,267.38		\$24,491.81			(\$15,775.57)	SCCI submitted costs on 1/15/2019. 1/17/19- PMA/SMMA reviewing. 1/24/19 PMA sent comments this morning. 2/7/2019 SCCI broke out into two PCO's, SCCI reviewing PCO #070. 2/21/19- SCCI to coordinate response with Grasseschi, revise and resubmit. 2/28/19- SCCI told Grasseschi to justify their position, rejected as of now and risk will be tracked here. 03/07/19- SCCI to address with Grasseschi / internally with Jake Forsaith (JF). 03/14/19- SCCI chasing wage rate breakdown from Grasseschi. Once wage rates are finalized, the PCO will be reviewed again. As of right now PCO is rejected, cost exposure is being tracked here. 03/21/19- SCCI to resubmit PCO. PMA to review wage rates. 04/11/19- PMA to review updated wage rates, SCCI still reviewing with Grasseschi. 04/18/19- Ongoing B.I.C. SCCI / Grasseschi, wage rate comments sent back to SCCI from PMA. 04/25/19- Ongoing B.I.C. SCCI / Grasseschi. 05/02/19- Ongoing, B.I.C. SCCI/ Grasseschi. 05/09/19- No change, SCCI waiting for any response from Grasseschi. 05/16/19- No change, B.I.C. SCCI/Grasseschi. 05/23/19- No change, B.I.C. SCCI. 05/30/19- No change, B.I.C. SCCI/Grasseschi. 06/06/19- No change, B.I.C. SCCI/Grasseschi. 06/13/19- No change, SCCI chasing Grasseschi daily.	SCCI/HOLD	
#070A	PR #023	Grasseschi	Plumbing summer 2018 T&M Part 2 - PR #23 Installing new ball valves on existing systems for water piping. 4" vent rework	\$15,944.66				\$12,447.61	(\$3,497.05)	SCCI issued PCO on 2/5/19. PMA disagrees with OT hours included. 2/14/19 PMA/SMMA comments sent to SCCI. 2/21/19- SCCI to revise and resubmit, vent work straight time disputes to be carried on PCO 70. 04/04/19- PCO signed and approved.	PRE-GMP	
#070B		Grasseschi	This contingency authorization request represents the costs associated with the gas piping investigation work that was completed by Grasseschi. This PCO represents paying for 16hrs of straight time per the Grasseschi estimate prior to the work being completed. This PCO is proposed to be funded by the Construction Contingency.	\$3,104.68				\$3,104.68	\$0.00	SCCI issued PCO on 3/22/2019. 04/04/19- PCO was approved last week and signed.	PRE-GMP	
#071		Lauretano	Additional temporary signage	\$1,151.17				\$1,151.17	\$0.00	Additional temporary signage received quote from Suffolk on 9/4/2018. BC noted that signs have been ordered on 9/18 and shop drawings are forthcoming. SCCI submitted on 1/15/2019. PMA approved on 1/15/2019. PCO Routing for signature	PRE-GMP	
#072		Marguerite	Marguerite PCO #002 - Down time forming footings for generator walls, Marguerite PCO #003 - Form and install sacrificial form around 12" RCP pipe and 12" DI pipe at wall #16 (Unforeseen condition	\$8,286.94				\$4,124.72	(\$4,162.22)	PMA added to PCO log on 11/14/2018 to reconcile with SCCI log. SCCI to submit PCO. PMA has record of no down time. On 01/14/2019 SCCI submitted costs. 1/17/19- PMA/SMMA reviewing. 1/24/19 SMMA to provide comments. 1/29/19 PMA/SMMA sent comments to SCCI. 1/31/2019 Awaiting JA/SCCI write-up. 2/7/2019 SCCI still to issue. 2/14/19 SCCI to respond. 2/21/19- SCCI ball in court. 2/28/19- SCCI to follow up, possibly break up approved and not approved slips. 03/07/19- SCCI to address internally with JF. 03/14/19- JF to break out approved / unapproved costs, track unapproved costs here. 03/21/19- JF sent revised PCO which removed the disputed T/M slips which will be covered under a sepearate revision. SMMA has recommended for approval, PMA to review. 03/21/19- Signatures routing. 04/04/19- PCO was approved and signed last week.	PRE-GMP	
#072A		Marguerite	Marguerite Concrete Misc T&M Part 2. - Disputed Costs tracked here.	\$4,162.23		\$4,162.23			\$0.00	SCCI to issue PCO #072A tracking disputed T&M costs. 3/28 - SCCI to issue 072A. 04/04/19- SCCI to formally issue PCO. 04/11/19- SCCI to submit PCO ASAP. 04/18/19- SCCI to submit PCO ASAP.04/25/19- Ongoing, SCCI to submit PCO ASAP. 05/02/19- Ongoing, SCCI to submit PCO ASAP. 05/09/19- SCCI to formally submit PCO. 05/16/19- SCCI to formally submit PCO. 05/23/19- No change, B.I.C. SCCI. 05/30/19- No change, B.I.C. SCCI to formally submit PCO. 06/06/19- No change, B.I.C SCCI to submit PCO. 06/13/19- No change, SCCI following up internally.	SCCI	
#073	Field Condiiton	Dow Company	Soil export to enclosed facilities	\$70,608.00				\$70,608.00	\$0.00	SCCI submitted costs on 1/14/2019. 1/17/19- PMA/SMMA reviewing. 1/24/19 PCO routing	PRE-GMP	
#074	Field Condiiton	Liberty	Liberty rental of seasonal ground thaw machine (12/19/18-3/12/19)	\$22,281.00				\$22,281.00	\$0.00	SCCI submitted on costs on 1/15/2019. SCCI requesting winter conditions allowance draw. 1/17/19- PMA issued comments, SCCI to follow up with Liberty. 1/24/19 PCO routing	PRE-GMP	
#075	Field Condiiton	JDC Demo	1,500 SF of ACM concrete (Allowance)	\$24,000.00				\$4,320.00	(\$19,680.00)	SCCI submitted on 1/14/19. 1/17/19- PMA/SMMA review. 1/24/19 PMA awaiting response from Smith & Wessel. 1/30/2019 PMA sent comments and takeoff. 1/31/2019 SCCI reviewing takeoff as work is not yet completed. PMA noted Square Footage Costs at \$4,608. SCCI resubmitted costs on 2/1/18. Routing for signatures	PRE-GMP	
#078	Field Condiiton	JDC Demo	1,200 SF for lower stair case foundation & footing from F wing.	\$20,500.00				\$11,000.00	(\$9,500.00)	SCCI submitted on 1/15/2019. SCCI proposing utilizing remaining \$19,500 of the \$30,000 allowance for foundation coating ACM and the remaining \$1,000 to be funded by the \$31,000 Allowance for coating behind classroom univents suspect ACM. SCCI requested a quick turnaround to get this work moving. 1/17/19- Smith and Wessel to confirm quantities match. 1/24/19 PMA awaiting response from Smith & Wessel. 1/30/2019 PMA sent preliminary review to SCCI. 1/31/2019 SCCI reviewing takeoff as work is not yet completed. PMA noted Square Footage costs at \$7,020. 2/7/2019 Approved to proceed up to \$11K on 2/1/19, SCCI to provide revised PCO today. 2/14/19 PCO Routing as of today	PRE-GMP	
#079	PR #033R2	WJGEI	Emergency Telephone System Direction, Hands Free Auto Dialer, Security Panic Button	\$24,282.79		\$18,905.32			(\$5,377.47)	PR #33R issued on 11/26/18. SCCI submitted pricing on 1/15/2019. 1/17/19- GGD reviewing. 1/24/19 SMMA to provide comments. 1/31/19 SMMA reaching out to WJGEI to confirm \$6K savings are attainable and will then issue new PR. 2/7/2019 SMMA to provide update. 2/14/19 SMMA wwaiting for WJGEI (Barboza/Cunha) to respond. 2/21/19- SMMA back and forth with WJGEI ongoing, to re-issue PR / WJGEI to revise cost proposal. 2/28/19- SCCI recieved revised PR, SCCI to get costs from WJGEI and resubmit. 03/07/19- WJGEI to resubmit to SCCI, SCCI to issue revised PCO. 03/14/19- SCCI still waiting on revised pricing from WJGEI fo the PR. 03/21/19- No change. 3/28- suffolk has revised pricing from WJGEI, will submit. 04/04/19- SCCI issued revised PCO per updated PR on 3/28. B.I.C. SMMA/PMA. 04/11/19- PMA to review SMMA sign off. 04/18/19- PMA sent minor comments back to SCCI, SCCI to follow up with WJGEI. 04/25/19- SCCI still coordinating with WJGEI. 05/02/19- Ongoing, SCCI still coordinating with WJGEI. 05/09/19- WJGEI revising PCO per agreed upon comments on email on 5/2 from Jake F. 05/16/19- No change, B.I.C. SCCI. 05/23/19- No change, B.I.C. SCCI/WJGEI. 05/30/19- No change, B.I.C. SCCI/WJGEI. 06/06/19- SCCI submitted PCO revision end of day, B.I.C PMA to review. 06/13/19- No change, B.I.C PMA for review.	PMA	
#082	RFI #005, #212, #217	Beauce Atlas	COP #013 - Suffolk RFI #005 - Added moment connections, COP #014 - Changes from sequence 19 thorough 23, COP #15 - Costs related to RFI #202 and #217, COP #16 - Costs related to comments on returned submittal sequence 26-29, COP #017	\$18,080.98				\$7,275.05	(\$10,805.93)	SCCI submitted costs on 1/16/2019. 1/17/19- SMMA Reviewing. 1/31/2019 SMMA to provide comments by EoW. SMMA provided comments on 2/1/19. 2/7/19 PMA to review SMMA comments and issue to SCCI. 2/13/19 PMA sent comments to SCCI. 2/21/19- SCCI to review with Beauce Atlas. 2/28/19- SCCI to follow up with Beauce Atlas, possibly break out approved costs. 03/07/19- Meeting 2:00 P.M. 03/14/19- Comments sent to BA from SCCI yesterday, SCCI to follow up with BA. 03/21/19- SCCI issued comments back to BA for review 3/28/19 - SCCI has received some revised proposals, will wait until they have al comments back and will send to team. 04/04/19- SCCI waiting for more comments. SCCI to follow up with BA. 04/11/19- SCCI said revised pricing is due back next week. 04/18/19- B.I.C. SCCI still for revised pricing. 04/25/19- SCCI B.I.C, coordinating with Beauce Atlas. 05/02/19- Ongoing, SCCI still working with Beauce Atlas. 05/09/19- Ongoing, SCCI still working with Beauce Atlas. 05/16/19- No change, B.I.C SCCI. 05/23/19- No change, B.I.C. SCCI. 05/30/19- SCCI to break out disputed costs, PCO is routing only with approved costs.	ROUTING	
#082A	N/A	Beauce Atlas	This proposed change order represents the costs associated with the following steel revisions: COP #14- Revs per submittal #015200-20.0 SEQ 19 to 23. COP #017- Revs per Submittal #051200-24.0 SEQ 30-36.	\$10,560.45		\$10,560.45			\$0.00	05/30/19- SCCI to review changes with BA, follow up with team. 06/06/19- SCCI submitted PCO in the afternoon, B.I.C SMMA to review. 06/13/19- No change, B.I.C. SMMA for review.	SMMA	
#083	N/A	Delta Beckwith	Bond for Elevator Contractor Delta Beckwith	\$2,432.00				\$2,432.00	\$0.00	SCCI submitted costs on 1/16/19. 1/17/19- PMA/SMMA reviewing. 1/24/19 PMA reviewing. 2/7/2019 PCO is routing	PRE-GMP	
#084A	Field Condiiton	Flett	Flett CR #1 - Prep School Street for lay down area, Flett CR #2 - Manage stockpile on School Street (1/2), Flett CR #3 - Premium Time for temp utility trench, Flett CR #4 - Build temporary egress at school street (1/2), Flett CR #5 - Build temporary agress to school street (2/2), Flett CR #6 - Manage stockpile on school street (2/2), Flett CR #7 - Premium time on soil nail wall install, Flett CR #8 - Crosswalk striping at mods and down to library, Flett CR #9 - Additional tree cutting of 16 trees requested by SCCI, Flett CR #10 - Pave handicap ramp on concourse where busses drop off, Flett CR #11 - Steet sweeping for entire project (before school opened), Flett CR #12 - Create temp access road to allow fence company to safely install the fence from School St. construction gate down to GLX property, Flett CR #13 - Striping handicap symbols and added walkway striping	\$89,292.24				\$30,547.97	\$2,250.36	(\$56,493.91)	SCCI submitted PCO on 1/16/19. 1/17/19- PCO under PMA/SMMA review. 1/24/19 SMMA to have comments today. 1/31/2019 PMA to review SMMA comments and provide to SCCI. 2/14/19 PMA sent comments to SCCI. 2/21/19- SCCI to respond to SMMA/PMA. 2/28/19- SCCI status quo have to speak with Flett, possibly break out approved costs. 03/07/19- SCCI to review comments / address with Flett. 03/14/19- SCCI to compile responses from Flett and issue to SMMA/PMA. 03/21/19- SCCI to revise and resubmit PCO with more descriptions and clarifications. 3/28 - BIC suffolk. chase credit from DOW. 04/04/19- 84a in for approval, B.I.C. PMA/SMMA. 84b to have contested costs, SCCI to issue 84B. 04/04/2019- B.I.C. SMMA/PMA still to review Part A, SCCI still to issue Part B. 04/11/19- PMA/SMMA to review ASAP. 04/18/19- SMMA sent comments back to PMA on 04/16. PMA to compile and issue comments back to SCCI. 04/25/19- B.I.C PMA/SMMA, to issue comments back ASAP. 05/02/19- PMA/SMMA issued comments back to SCCI on 04/30. SCCI following up with Flett. 05/09/19- Ongoing, SCCI reviewing comments back with Flett. Flett submitted wage rates to SCCI, SCCI to review. 05/16/19- SCCI revised PCO per PMA/SMMA comments, PCO is routing.	ROUTING
#084B	Field Condiiton	Flett	Flett CR #1 - Prep School Street for lay down area, Flett CR #2 - Manage stockpile on School Street (1/2), Flett CR #3 - Premium Time for temp utility trench, Flett CR #4 - Build temporary egress at school street (1/2), Flett CR #5 - Build temporary agress to school street (2/2), Flett CR #6 - Manage stockpile on school street (2/2), Flett CR #7 - Premium time on soil nail wall install, Flett CR #8 - Crosswalk striping at mods and down to library, Flett CR #9 - Additional tree cutting of 16 trees requested by SCCI, Flett CR #10 - Pave handicap ramp on concourse where busses drop off, Flett CR #11 - Steet sweeping for entire project (before school opened), Flett CR #12 - Create temp access road to allow fence company to safely install the fence from School St. construction gate down to GLX property, Flett CR #13 - Striping handicap symbols and added walkway striping	\$18,011.26		\$18,011.26				\$0.00	04/04/19- SCCI to submit #084B with disputed costs. 04/11/19- SCCI reviewing with Dow and Flett. 04/18/19- No change B.I.C. SCCI. 04/25/19- Ongoing, B.I.C. SCCI. 05/02/19- Ongoing, B.I.C. SCCI to formally submit PCO. 05/09/19- SCCI to formally submit PCO, working with Dow to compile credits. 05/16/19- SCCI to formally submit PCO. 05/30/19- No changes, B.I.C. SCCI. to submit PCO. 06/06/19- No change, B.I.C. SCCI to submit PCO (working with Flett on tree removal issue). 06/13/19- No change, B.I.C. SCCI.	SCCI

PMA Construction Change Authorization Log

Key:										
				Approved	Under Review	Rejected	Pending			
#086	Field Condiiton	Dow Company	Dow Excavation Inefficiency December 2018	\$91,828.26		\$91,828.26		\$0.00	SCCI submitted costs on 1/25/19 with a note that the review of this PCO cannot be compelled until all information is received. 1/8/19 PMA emailed SCCI notifying that PMA is unable to verify Dow's claim until productivity data can be compiled and reviewed. 2/21/19- Status quo. 2/28/19- PCO still on hold, to be reviewed along with schedule impact costs. 03/07/19- PCO still on hold, to be reviewed along with schedule impact costs. 03/14/19- PCO still on hold, to be reviewed along with schedule impact costs. 03/21/19- PCO still on hold, to be reviewed along with schedule impact costs. 04/04/19- PMA letter issued on 03/27 formally rejects Dow's ineffency PCOs. SCCI to follow up with Dow, and risk to still be tracked here until a formal response from Dow is heard. 04/18/19- SCCI following up with Dow, meeting needed to discuss with Dow from all parties needed. 04/25/19- SCCI still working with Dow, meeting between all parties is still needed for discussion. 05/02/19- SCCI still working with Dow, meeting between all parties is still needed for discussion. 05/09/19- SCCI stil working with Dow, meeting between all parties is still needed for discussion. 05/16/19- SCCI still working with Dow, meeting between all parties is still needed for discussion. 05/23/19- Ongoing, no change from last week. 05/30/19- Ongoing, no change from last week. 06/06/19- Ongoing, no change. 06/13/19- Ongoing, no change.	SCCI/HOLD
#087	PR #035	Marguerite	Additional 1 sided concrete wall required at the existing B wing foundation	\$42,964.30			\$37,609.14	(\$5,355.16)	SCCI submitted PCO on 1/23/19. 1/29/19 PMA/SMMA sent comments to SCCI. 1/31/2019 SMMA to review Structural Engineer, SCCI to review with Marguerite as well to try to meet at \$35K. Following Meeting PCO was ready for execution	PRE-GMP
#087A		Marguerite	Premium Time for Additional 1 sided concrete wall required at the existing B wing foundation	\$1,848.76				(\$1,848.76)	SCCI to submit PCO #087A with premium time costs ASAP. 04/11/2019- Ongoing. 04/18/19- No change B.I.C. SCCI. 04/25/19- Ongoing, B.I.C. SCCI. 05/02/19- Ongoing, SCCI to submit PCO ASAP. 05/09/19- SCCI to formally submit PCO. 05/16/19- SCCI to formally submit PCO. 05/30/19- No change, SCCI to formally submit PCO. 06/13/19- PCO is void, captured in Marg. schedule impact cost.	VOID.
#088	Field Condiiton	Dow	Soil export to the enclosed facilities as outlined in the attached tickets	\$361,751.00			\$361,751.00	\$0.00	SCCI submitted PCO on 2/1/19. 2/7/2019 PMA has SMMA comments and is reviewing. 2/14/19 PMA to review by EoW. 2/21/19- PMA waiting for SMMA confirmation to process PCO. 2/21/19- PCO is routing.	PRE-GMP
#089		JDC Demo	This allowance transfer authorization request represents the costs associated with the abatement of the unforeseen air cell vapor barrier that was encountered on 12/05/18. This abatement work was completed by JDC Demo on a Time and Materials basis as verified by Suffolk and PMA. This PCO excludes the export of all soils which will be submitted under separate cover as necessary. This PCO is proposed to be funded by the \$50,000 "Unforeseen Abatement" Allowance that was established in the JDC Dem	\$47,746.95			\$47,134.07	(\$612.88)	SCCI submitted PCO on 02/04/19. PCO was executed on 2/7/2019 after minor comments from PMA/SMMA.	PRE-GMP
#090	Field Condiiton	JDC Demo	11/21/18 ACM Pipe Abatement	\$19,253.08			\$18,018.75	(\$1,234.33)	SCCI submitted PCO on 2/4/2019. 2/7/2019 PMA issued comments on 2/5/19 and 2/6/19, SCCI to send revised PCO. 2/14/19 Routing today	PRE-GMP
#091	N/A	J. Derenzo	Derenzo COR #5 - Premium time slips for weekend work over April vacation at concourse. Derenzo COR #6 - Break up and dispose of concrete underslab under bricks during April concourse work. Derenzo COR #7 - Prep, Pave, Cut and Tap trench in Parking lot. Derenzo COR #8 - Excavate water line, tap, shutdown for C wing Demo. Derenzo COR #9 - Exploration of 8" fire service for cut and cap, includes backfill	\$24,460.32			\$4,102.31	(\$16,735.73)	SCCI submitted PCO on 2/1/19. Premium time portion funded from Construction Contingency. 2/7/2019 PMA reviewing. 2/14/19 PMA reviewing. 2/21/19- PMA to send SCCI comments from PMA/SMMA today. 2/28/19- SCCI said ball in court is J. Derenzo. 03/07/19- SCCI said B.I.C is still J. Derenzo, SCCI to follow up. 03/14/19- SCCI to compile responses, issue over to SMMA/PMA. 03/21/19- Certified Payroll issues corrected yesterday to match billing, SCCI to revise and resubmit. 3/28 - SCCI sent copy 3/26 9:02 AM. SMMA/PMA to review. 04/04/19- 91 submitted for approval, B.I.C. PMA/SMMA for approval. 91A to be submitted with disputed costs. 04/11/2019- SMMA sent comments to PMA, PMA to review and send back to SCCI. 04/11/19- PMA reviewing with DCAAM on certified payroll. 04/18/19- PMA to follow up with DCAAM again for certified payroll question. 04/25/19- PMA to follow up internally ASAP. 05/02/19- B.I.C. PMA to follow up with DCAAM again. 05/09/19- PMA still trying to get ahold of DCAAM, will review PCO based off merit for approval. If DCAAM does get back to PMA with different response on certified payroll question, PMA will take necessary measures to recoup any costs. 05/16/19- SCCI revised PCO with updated rates, PCO is routing. If DCAAM does get back to PMA with different response on certified payroll question, PMA will take necessary measures to recoup any costs.	PRE-GMP
#91A	N/A	J. Derenzo	Derenzo COR #5 - Premium time slips for weekend work over April vacation at concourse. Derenzo COR #6 - Break up and dispose of concrete underslab under bricks during April concourse work. Derenzo COR #7 - Prep, Pave, Cut and Tap trench in Parking lot. Derenzo COR #8 - Excavate water line, tap, shutdown for C wing Demo. Derenzo COR #9 - Exploration of 8" fire service for cut and cap, includes backfill	\$17,434.21			\$15,623.23	(\$1,810.98)	3/28 - Dow credit portion, SCCI to submit. 04/04/19- SCCI to submit PCO ASAP. 04/11/19- Ongoing. 04/18/19- No change B.I.C. SCCI. 04/25/19- SCCI issued PCO revision, SMMA B.I.C. for review. 05/02/19- PMA issued comments over to SCCI today, SCCI to follow up with J. Derenzo. 05/09/19- SCCI ongoing work with J Derenzo. 05/16/19- SCCI worked with J. Derenzo and revised rates / revised PCO per SMMA comments, PCO is now routing.	PRE-GMP
#092	Field Condiiton	Axiom, Procut	Coring of chimney and coring gunite samples	\$3,494.43			\$3,260.00	(\$234.43)	SCCI submitted PCO on 2/1/19. PMA requested to be funded from Chimney Allowance, SCCI sent revised. 2/7/2019 PCO is routing	PRE-GMP
#093	N/A	Homer	Prevailing wage rate increase for painting trade (9500 Hours x \$8.2/Hr = \$78,000)	\$78,000.00				(\$78,000.00)	Homer Contracting email sent on 1/24/19. PMA responded on 1/25/19 that this was rejected	REJECTED
#094	N/A	WJGEI	Costs associated with transformer pad required for Summer enabling work	\$2,036.59			\$2,036.59	\$0.00	WJGEI submitted costs on 10/20/2017. SCCI submitted costs on 2/1/2019. 2/14/19 PMA sent comments to SMMA, SMMA reviewing. 2/21/19- PCO approved / to be processed today.	PRE-GMP
#095	Field Condiiton	Dow Company	Changes in SOE Design due to differing site conditions - Dry set stone foundations at 1895 B Wing	\$395,881.89		\$330,381.71		(\$65,500.18)	SCCI submitted costs on 2/1/19. 2/14/18 SMMA to have comments by EoW. 2/21/19- PMA sent back comments to SCCI today, ball in court SCCI. 2/28/19- SCCI reviewing with DOW/HUB, PMA tracking T/M in the field as work is ongoing. 03/07/19- H piles have been installed, PCO comments have not been addressed. SCCI to get comments back from HUB/DOW, address with PMA/SMMA and possibly set up conference call for review. Added 75k for T/M exposure. 03/14/19- SCCI sent revised PCO w/ Dow addressing comments to PMA/SMMA on 3/11. PMA/SMMA to review, teams to meet to discuss PCO. 03/21/19- PMA sent tracked hours, SCCI to resubmit based off meeting 03/18/19. 3/28 - BIC Hub/Dow to resubmit. 04/04/19- SCCI to chase DOW/HUB for response. 04/11/19- SCCI received revised cost, waiting on cost for chipping out work as well and reissue to PMA/SMMA. 04/18/19- SCCI to issue PCO revision ASAP to PMA/SMMA. 04/25/19- SCCI submitted revised PCO on 04/24, T&M part of PCO is needed SCCI to follow up. PMA/SMMA to begin preliminary review. 05/02/19- No change, B.I.C PMA/SMMA for review, SCCI to submit T&M costs. 05/09/19- SMMA to issue comments to PMA, PMA to review tracked T&M slips, SCCI to submit their T&M slips. 05/16/19- No change for all parties. 05/30/19- PMA to finish review, compile comments with SMMA and issue over to SCCI. 06/06/19- PMA owed comments back to SCCI, PMA issued comments to SCCI on 6/7. B.I.C SCCI to review with Dow/HUB. 06/13/19- SCCI following up with HUB/Dow.	SCCI
#096	Field Condiiton	Hardware Specialties	Temporary Doors PO for summer enabling work	\$36,100.00			\$36,100.00	\$0.00	PMA added to PCO log on 11/14/2018 to reconcile with SCCI log. SCCI submitted PCO on 2/8/19. Proposed to come out of Construction Contingency	PRE-GMP
#097	PR #036R2	Dow Company	GLX Coordination Revisions: Grading and excavation associated with new wall #10 near northeast corner of the gym; Grading, drainage, and sanitary sewer revisions as a result of GLX coordination including; new temporary drainage pipe and doghouse manhole near north corner of gym; additional existing drain pipe removal along Medford St; grading and drainage revisions along northeast side of the site, including four (4) connections to new GLX drainage structures; revised infiltration system #4; and revised sanitary sewer connection near northwest corner of site	\$103,572.00		\$47,027.90		(\$56,544.10)	SCCI submitted costs on 2/8/19. 2/14/19 PMA/SMMA returned comments to SCCI. 2/21/19- SCCI said Dow waiting for approved rates before revising and resubmitting, SCCI following up with Dow on rates. 2/28/19- Dow has approved rates, will update and resubmit PCO. 03/07/19- SCCI said Dow is actively working on it, SCCI to revise and resubmit PCO once Dow forwards over update. 03/14/19- Dow to update PCO to SCCI, SCCI to send over revised PCO to SMMA/PMA. 03/21/19- SCCI to follow up with Dow on equipment rates, revise PCO and issue to SMMA/PMA. 3/28 - Dow to R&R. 04/04/19- No change. 04/11/19- No change. 04/18/19- SCCI issued revised PCO on 4/16, B.I.C. PMA/SMMA for review. 04/25/19- SMMA issued comments to PMA, PMA to review/add any comments and submit to SCCI (revision and meeting will be needed). 05/02/19- B.I.C. PMA for final review, meeting needed for review between all parties. 05/09/19- PR #036R1 was issued from SMMA on 5/6, SCCI to get PCO from Dow. 05/16/19- PR #036R2 revision coming due to GLX coordination, SMMA B.I.C. 05/30/19- PR #036R2 was issued, B.I.C. SCCI/Dow. 06/06/19- No change, B.I.C. SCCI/Dow. 06/13/19- SCCI to contact Dow to price PR #036R1, SMMA to follow up if this is the correct version to price.	SCCI
#098	PR #039	WJGEI	This proposed change order represents the Electrical costs associated with the SMMA PR #039 dated 10/12/18 for the additional site lighting work per RFI #210. This change order is proposed to be funded by the Owner's Contingency	\$5,944.31			\$3,309.56	(\$2,634.75)	SCCI submitted costs on 2/8/19. 2/14/19 PMA/SMMA reviewing. 2/21/19- SMMA/PMA issued comments back to SCCI today 2/21, B.I.C SCCI. 2/28/19- Dow has updated rates, revising and resubmitting PCO. 03/07/19- SCCI said Dow is working on revision, to resubmit once received. 03/14/19- Dow to update PCO to SCCI, SCCI to send over revised PCO to SMMA/PMA. 03/21/19- SCCI to break out costs for WJGEI, track Dow as PCO #098A. SCCI submitted PCO #098 with WJGEI costs only later in the day on 03/21/19, signatures routing	PRE-GMP
#098A	PR #039, RFI #210	Dow Company	This proposed change order represents the Sitework costs associated with the SMMA PR #039 dated 10/12/18 for the additional site lighting work per RFI #210. This change order is proposed to be funded by the Owner's Contingency	\$2,634.76			\$1,590.55	(\$1,044.21)	SCCI to issue PCO imminently to track costs appropriately. 04/04/19- SCCI issue PCO ASAP. 04/11/2019- Ongoing, waiting on updated Dow pricing. 04/18/19- SCCI issued PCO to PMA/SMMA on 04/16, B.I.C. PMA. 04/25/19- PCO EXECUTED.	PRE-GMP
#099	Field Condiiton	Flett	Flett COR #16 & COR #17 - Delta for soils to go to Saugus in lieu of clean export for Flett based on soil classification results	\$3,515.52			\$3,515.52	\$0.00	SCCI submitted costs on 2/11/19. This is proposed to be funded by the \$2,600,000 Allowance that was established in Buy authorization #12. 2/21/19- SMMA sent response approving PCO to PMA on 2/19, PMA issued comments to SCCI requesting back up on tipping rate. SCCI to follow up with Flett. 2/28/19- SCCI provided back up, PCO is routing.	PRE-GMP

PMA Construction Change Authorization Log

Key:											
Approved				Under Review		Rejected	Pending				
#100	PR #011	Grasseschi	PR #11 - Plumbing coordination revisions on Lower Level and Level 1 Part A. Additional chase walls were created to enclose relocated plumbing in the main kitchen area and IDF room	\$21,474.64		\$20,087.57			(\$1,387.07)	PR #11 issued on 7/20/18. SCCI submitted costs on 2/11/19. 2/21/19- SMMA issued comments to PMA on 2/18, PMA reviewed/added comments and issued back to SCCI today 2/21 revise and resubmit. 2/28/19- SCCI said it is back with Grasseschi to address comments. 03/07/19- SCCI said it is still with Grasseschi, Ben Carawan to follow up with JF on update. 03/14/19- SCCI sent revised PCO which addressed PMA/SMMA comments. Ball in court PMA/SMMA to review. 03/21/19- SMMA reviewing comments back with engineer, SCCI reviewing production rates with Grasseschi. PMA/SMMA issued comments back to SCCI later in the day on 3/21/19. 3/28 - MCCA rates. 04/04/19- SCCI to revise some comments. SCCI reviewing other disputed costs and to issue response to PMA. 04/11/19- SCCI to issue revision to PMA/SMMA with backup on pricing. 04/18/19- SCCI issued revision on 04/11, B.I.C. PMA/SMMA. 04/25/19- PMA issued comments back to SCCI on 04/23, SCCI to address with Grasseschi. 05/02/19- PMA/SMMA to review for full comments. 05/09/19- B.I.C. PMA for review. 05/16/19- SCCI reviewing price with Grasseschi. 05/30/19- No change, B.I.C. SCCI /Grasseschi. 06/06/19- No change, B.I.C. SCCI /Grasseschi. 06/13/19- No change, B.I.C. SCCI/ Grasseschi.	SCCI
#100A	PR #011	Dow Company	PR #011 Plumbing Coordination Revs Lower Level Part A Part 2	\$18,052.03		\$18,052.03			\$0.00	06/06/19- SCCI to formally submit PCO. 06/13/19- SCCI reviewing Dow cost before submitting PCO.	SCCI
#101	PR #034	Homer	PR #034 Painting of Structural Brace in Duct Plenum	\$829.65			\$829.65		\$0.00	04/18/19- SCCI to formally issue PCO ASAP. 04/25/19- Ongoing, B.I.C. SCCI. 05/02/19- Ongoing, B.I.C. SCCI to submit PCO for review. 05/09/19- SCCI to formally submit PCO. 05/16/19- SCCI formally submitted PCO on 05/09, SMMA/PMA approved PCO- signatures routing.	PRE-GMP
#102	PR #019	Marguerite	PR #19 - Revisions associated with conflict between a new structural column and existing electrical duct bank in part D, related to RFI-139 and RFI-145.	\$1,843.68			\$1,843.68		\$0.00	PR #19 issued on 8/6/18. SCCI submitted costs on 2/11/19. 2/21/19- SMMA issued response to PMA on 2/15 to accept PCO, PMA reviewed and agreed/approved PCO to SCCI on 2/21.	PRE-GMP
#102A	PR #019	Dow Company	PR #019 Steel Column Footing at Existing Ductbank Part 2	\$6,848.44		\$6,848.44			\$0.00	SCCI first added to change meetings on 06/06/19, SCCI to follow up with Dow. 06/13/19- No change, B.I.C. SCCI/Dow.	SCCI
#103	ASI #038	Marguerite	Additional slab pitch at the loading dock trench drain shown in ASI #038	\$3,658.43			\$1,838.33		(\$1,820.10)	ASI #038 issued on 12/10/18. SCCI submitted costs on 2/10/19. 2/21/19- BIC SMMA to review slab elevations and verify if required, possibly issue ASI revision. 2/28/19- SMMA to reissue ASI to clarify. 03/07/19- Revised ASI was issued from SMMA on 03/06. SCCI to follow up with Marguerite if this is indeed added cost. 03/14/19- SCCI to follow up with Marguerite on this cost. 03/21/19- Ongoing B.I.C. SCCI. 3/28 - SCCI to forward revised pricing. 04/04/19- Revised ASI issued from SMMA, SCCI to get revised pricing from Marguerite. 04/11/19- SCCI to follow up with Marguerite. 04/18/19- No change, B.I.C. SCCI. 04/25/19- SCCI following up weekly with Marguerite. 05/02/19- Ongoing, SCCI following up with Marguerite. 05/09/19- PMA issued comments to SCCI on 5/7, SCCI to review with Marguerite. 05/16/19- No change, B.I.C. SCCI. 05/23/19- Team/ Marguerite agreed to split costs, PCO is signed.	PRE-GMP
#105		Sweeney	PR #020 Fire Rated Shaft Assembly Revs & FSDs	(\$1,894.15)		(\$1,894.15)			\$0.00	04/18/19- SCCI to formally issue PCO ASAP. 04/25/19- Ongoing, B.I.C. SCCI. 05/09/19- SCCI to formally submit PCO. 05/16/19- SCCI to formally submit PCO. 05/30/19- No change, B.I.C. SCCI. 06/06/19- No change, B.I.C. SCCI. 06/13/19- No change, B.I.C. SCCI to formally submit PCO.	SCCI
#107		Homer	Includes the cost associate with the enclosed T&M slips from Summer 2018 for temporary walls that were requested to be painted by SCCI. See attached photos of areas completed for back-up.	\$11,592.71				\$10,465.73	(\$1,126.98)	SCCI submitted PCO on 2/15/19. 2/21/19- SMMA issued comments to PMA on 2/15, PMA issued comments back to SCCI on 2/15. SCCI to follow up internally. 2/28/19- SCCI to revise to contingency and re-submit PCO. 03/07/19- SCCI still needs to revise/resubmit to const. contingency. 03/14/19 SCCI to revise/resubmit to const. contingency. 03/21/19- SCCI to revise PCO and submit to SMMA/PMA. 03/28/19- SCCI issued revised PCO on 3/22, signatures routing. 04/04/19- PCO signed and executed.	PRE-GMP
#110	CCD #003R2	Marguerite	CCD-003 Added Concrete Wall at Gym Stair Foundation	\$58,727.80		\$58,727.80			\$0.00	SCCI submitted PCO on 2/15/19. 2/21/19- PMA/SMMA to review and issue any comments to SCCI. 2/28/19- SMMA issued revision to CCD, SCCI to review and PMA/SMMA to continue this PCO review. 03/07/19- SMMA sent back comment to PMA saying they are unable to review PCO, PMA to forward comments to SCCI after their review. 03/14/19- PMA sent comments over to SCCI from SMMA. Breakdown from subcontractor needed. 03/21/19- SCCI has followed up with Marguerite, awaiting response. 3/28 - resubmitted on 3/27. 04/04/19- PMA/SMMA working on PCO review, SMMA to issue comments today to PMA. 04/11/2019- SMMA sent comments to PMA yesterday, PMA issued comments to SCCI last night but need to provide comments to SCCI from PMA. 04/18/19- No change, B.I.C. PMA. 04/25/19- CCD #003 revision from SMMA imminent, this PCO on hold for now. 05/02/19- CCD revision was issued on 4/25, SCCI to chase pricing from Marguerite. 05/09/19- SCCI to get revised PCO from Marguerite, coordinate T&M. 05/16/19- SCCI to continue T&M and chasing credit. 05/30/19- Ongoing T&M, SCCI to continue chasing credit. 06/06/19- Ongoing T&M, SCCI to continue chasing credit. 06/13/19- Ongoing, SCCI chasing credit.	SCCI
#111		Dow	Dow Company's proposal for inefficiancy during the mass excavation activity for Phase 1 Foundations in January 2019.	\$79,493.64		\$79,493.64			\$0.00	SCCI submitted PCO on 2/22/19. 2/28/19- PCO is on hold, to be reviewed with schedule impact costs. 03/07/19- PCO is on hold, to be reviewed with schedule impact costs. 03/14/19- PCO is still on hold, to be reviewed with schedule impact costs. 03/21/19- PCO is still on hold, to be reviewed with schedule impact costs. 04/04/19- PMA letter issued on 03/27 formally rejects Dow's inefficiency PCOs. SCCI to follow up with Dow, and risk to still be tracked here until a formal response from Dow is heard. 04/18/19- SCCI following up with Dow, meeting needed to discuss with Dow from all parties needed. 04/25/19- SCCI still working with Dow, meeting between all parties is still needed for discussion. 05/02/19- SCCI stil working with Dow, meeting between all parties is still needed for discussion. 05/09/19- SCCI stil working with Dow, meeting between all parties is still needed for discussion. 05/16/19- SCCI still working with Dow, meeting between all parties is still needed for discussion. 05/23/19- Ongoing, no change from last week. 05/30/19- Ongoing, no change from last week. 06/06/19- Ongoing, no change. 06/13/19- Ongoing, no change.	SCCI/HOLD
#112	PR #021	PJK	Additional HVAC costs for revised H&V-15 and 18 locations per the SMMA PR-021 dated 11/21/18. The T&M slips included in this COR have been verified by Suffolk Construction.	\$17,118.39					(\$17,118.39)	SCCI issued PCO on 2/21/19. 2/28/19- SCCI reviewing comments back, BIC SCCI. SCCI to follow up to clear up confusion on added cost to the owner, should be no cost as it was a decision made by team and was recommended from SCCI as promised for no added cost. PCO as of now is rejected.	REJECTED
#113		Proscan	Summer 2018 concrete cutting and scanning. Scan slab in fitness room outside of Fitness room to locate unforeseen buried electric lines - OWNER. Sawcut existing fitness room slab to expose electrical conduits feed to CTE Wing Electrical Room (unforeseen)- OWNER. 20 LF cut of concrete wall at Stair by CTE Wing loading dock for emergency egress- CONST CONT. Sawcut, cut and dice for electrical trench and cribbed footing redesign per PR #19- OWNER. Core hole for EF-9 ductwork through Level 2 S.O.D.- CONS CONT.	\$10,940.00			\$7,546.24	\$1,950.00	(\$1,443.76)	SCCI issued PCO on 2/24. 2/28/19- SMMA/PMA to review. 03/07/19- SMMA/PMA ball in court, review still needed. 03/14/19- B.I.C still SMMA/PMA. 03/21/19- B.I.C. still SMMA/PMA for review/comments	PRE-GMP
#115		JWG	This PCO represents the backcharge to JWG Restoration for the costs associated with Liberty providing a union carpenter to support their operation. This PCO does not have any cost impacts to the City of Somerville and is just being sent for transparency for the deductive change order to JWG Restoration and the corresponding increased GR's for Suffolk	\$0.00				\$0.00	\$0.00	SCCI issued PCO on 2/27/19. SMMA/PMA reviewed and approved, PCO is routing for signatures.	PRE-GMP
#116		Marguerite	This allowance transfer authorization request represents the costs associated with the Marguerite Concrete scope of work that was completed on a Time and Materials basis as verified by Suffolk and PMA. This PCO is proposed to be funded by the \$600,000 Winter Conditions Allowance.	\$29,306.00				\$29,306.00	\$0.00	SCCI issued PCO on 03/19/19. 03/21/19- B.I.C. PMA/SMMA to review. 04/04/19- PCO was approved and signed last week.	PRE-GMP
#116A	Field Condiiton	Marguerite	This allowance transfer authorization request represents the costs associated with the Marguerite Concrete scope of work that was completed on a Time and Materials basis as verified by Suffolk and PMA. This PCO is proposed to be funded by the \$600,000 Winter Conditions Hold.	\$4,714.00				\$4,714.00	\$0.00	SCCI issued PCO on 04/11/19. 04/18/19- B.I.C. PMA for review. 04/25/19- PMA to review ASAP. 05/02/19- B.I.C. PMA for review. 05/09/19- PCO was approved, signatures routing.	PRE-GMP
#116B	Field Condiiton	Marguerite/Liberty	This hold transfer authorization request represents the costs associated with the Marguerite Concrete and Liberty scopes of work that was completed on a Time and Materials basis as verified by Suffolk and PMA. This also includes the Liberty Winter Conditions Material and Equipment costs per enclosed. This PCO is proposed to be funded by the \$600,000 Winter Conditions Hold.	\$37,143.30				\$35,329.74	(\$1,813.56)	SCCI issued PCO on 05/01. 05/02/19- B.I.C PMA for review. 05/09/19- Ongoing, PMA reviewing. 05/16/19- PMA ongoing review. 05/30/19- Ongoing PMA review.	ROUTING
#116C	Field Condiiton	Marguerite	This hold transfer authorization request represents the costs associatedwith the enclosed Marguerite Concrete concrete additives. This PCO is proposed to be funded by the \$600,000 Weather Conditions Hold.	\$7,490.00	\$7,490.00				\$0.00	SCCI issued PCO on 05/30/2019. 06/06/19- B.I.C. PMA to review. 06/13/19- No change, B.I.C. PMA to review.	PMA

PMA Construction Change Authorization Log

Key:	Approved	Under Review	Rejected	Pending
------	----------	--------------	----------	---------

#116D	Field Condiiton	Marguerite	This hold transfer authorization request represents the costs associated with the enclosed Marguerite Concrete winter conditions T&M scope. This PCO is proposed to be funded by the \$600,000 Weather Conditions Hold.	\$1,514.81				\$1,514.81	\$0.00	SCCI issued PCO on 06/07/2019, PMA SMMA to review. PMA/SMMA approved PCO on 06/11/19.	ROUTING
#117	Field Condiiton	Dow Company	Cost to remove the wall along xO line per directive in CCD #003R and RFI #337. Per RFI #337 response, Dow is to remove the remaining wall along xO line. Dow includes sawcutting, hoe ramming, and disposing of the concrete wall in question once abated by others.	\$11,625.94		\$11,625.94			\$0.00	SCCI issued PCO on 03/07/2019. 03/14/2019- B.I.C SMMA/PMA to review, and send comments if any to SCCI. 04/04/19- SMMA /PMA to get comments to SCCI ASAP. 04/11/19- PCO on hold, team reviewing with Paul L from SMMA. 04/18/19- No change, PCO on hold due to review from Paul L from SMMA and SCCI teams for best option. 04/25/19- CCD #003 revision is imminent from SMMA, PCO on hold for now. 05/02/19- CCD revision was issued on 4/25, B.I.C. , Price is VOID from Dow. 05/30/19- SCCI believes there is some added work for Dow, potential PCO is being tracked here. SCCI to follow up with Dow. 06/06/19- No change, SCCI to follow up with Dow. 06/13/19- No change, B.I.C. SCCI/Dow.	SCCI
#123		PJK/WJGEI	Hold Transfer Authorization request represents the costs associated with the enclosed HVAC and Electrical Pre-Purchased Equipment. This PCO is proposed to be funded by the Holds within the Electrical and HVAC GMP budgets	\$92,027.00				\$92,027.00	\$0.00	SCCI issued PCO on 03/14/19. 03/21/19- B.I.C. SMMA/PMA for review. 04/04/19- PCO was approved and signed last week.	PRE-GMP
#124		Dow Company	Allowance transfer authorization request represents the costs associated with the soil export to the enclosed facilities as outlined in the attached tickets. This work has been completed according to the unit prices and allowance value established in the Buyout Authorization Request #12 for Soils Management Allowance. This is proposed to be funded by the \$2,600,000 Allowance that was established in this Buyout Authorization Request #12.	\$46,356.36			\$42,029.08		(\$4,327.28)	SCCI issued PCO on 03/15/19. 03/21/19- B.I.C. PMA for review. 04/04/19- PCO comment from PMA disputing tipping fee/ Saturday charge to open facility. Rest of PCO was approved, signatures routing.	PRE-GMP
#125		Dow Company	See attached back-up, and spreadsheet detailing the Dow Company's proposal for inefficiency during the mass excavation activity for Phase 1 Foundations in February 2019.	\$15,125.72		\$15,125.72			\$0.00	SCCI issued PCO on 03/21/19. 03/21/19- PCO is on hold, to be reviewed with schedule impact costs. SCCI noted this PCO cost is NOT included in Dow's schedule impact costs (unlike PCOs 49,61,86,111). 04/04/19- PMA letter issued on 03/27 formally rejects Dow's ineffiency PCOs. SCCI to follow up with Dow, and risk to still be tracked here until a formal response from Dow is heard. 04/18/19- SCCI following up with Dow, meeting needed to discuss with Dow from all parties needed. 04/25/19- SCCI still working with Dow, meeting between all parties is still needed for discussion. 05/02/19- SCCI stil working with Dow, meeting between all parties is still needed for discussion. 05/09/19- SCCI stil working with Dow, meeting between all parties is still needed for discussion. 05/16/19- SCCI still working with Dow, meeting between all parties is still needed for discussion. 05/23/19- Ongoing, no change from last week. 05/30/19- Ongoing, no change from last week. 06/06/19- Ongoing, no change. 06/13/19- Ongoing, no change.	SCCI/HOLD
#126		Flett	This allowance transfer authorization request represents the costs associated with the soil export to the enclosed facilities as outlind in the attached tickets. This PCO represents the delta for the soils to go to Saugus in lieu of clean export for Flett based on the soil classification results. This is proposed to be funded by the \$2,600,000 Allowance that was established in this Buyout Authorization Request 312.	\$6,870.46			\$6,870.46		\$0.00	SCCI issued PCO on 03/18/19. 03/21/19- B.I.C. PMA for review. 04/04/19- PCO was reviewed and approved, signatures routing	PRE-GMP
#128	PR #067	Sweeney/Pavilion	PR #067 Shop Areas Wall Base & Finish Revs	\$35,057.16		\$0.00			(\$35,057.16)	04/18/19- SCCI to issue formal PCO ASAP. 04/25/19- No change, B.I.C. SCCI. 05/02/19- Ongoing, B.I.C SCCI to formally issue PCO. 05/09/19- SCCI to formally submit PCO. 05/16/19- SCCI submitted PCO on 05/15, PMA/SMMA to review. 05/23/19- SCCI coordinating with subs to get PCO to net zero. 05/30/19- SCCI actively working with subs to resolve PCO. 06/06/19- No change, B.I.C. SCCI to closeout. 06/13/19- Ongoing for SCCI.	SCCI
#129	PR #071	WJGEI	This proposed change order represents the Electrical costs associated with the revised Boiler Power Requirements per the SMMA PR #071 dated 02/11/2019.	\$841.69					(\$841.69)	SCCI issued PCO on 04/06/2019. 04/11/2019- PMA sent comments to SMMA, SMMA to review/add any comments and send back to PMA for issuance to SCCI. 04/18/19- PMA/SMMA sent comments to SCCI on 4/16, SCCI following up with WJGEI. 04/25/19- WJGEI/SCCI coordinated with vendor, change is no cost and is void.	REJECTED
#130	PR #062	PJ Kennedy	This proposed change order represents the costs associated with the HVAC scope of work per the SMMA PR#062 dated 01/04/2019	\$4,842.94		\$4,842.94			\$0.00	SCCI issued PCO on 04/06/2019. 04/11/2019- B.I.C. PMA/SMMA for review. 04/18/19- No change, B.I.C. PMA. 04/25/19- PMA issued both comments to SCCI, PJK reviewing. 05/02/19- No change, PJK reviewing. 05/09/19- No change, PJK reviewing. 05/16/19- No change, PJK reviewing. 05/30/19- No change, PJK reviewing with SCCI. 06/06/19- SCCI/PJK issued PCO revision on this date justifying positions and not reducing price, B.I.C. PMA/SMMA to review. 06/13/19- B.I.C. PMA/SMMA to review.	PMA/SMMA
#131	PR #007	WJGEI	This proposed change order represents the costs associated with the Electrical Costs per the SMMA PR #007 for the Telecom Revisions.	\$2,468.11			\$2,468.11		\$0.00	SCCI issued PCO on 03/22/2019. 03/28/19- GGD to review. 04/04/19- SMMA approved, PMA review before signatures routing. 04/11/2019- PMA to review today. 04/18/19- B.I.C. PMA/SMMA. 04/25/19- B.I.C. PMA/SMMA. 05/02/19- No change, B.I.C PMA/SMMA. 05/09/19- SMMA confirmed PCO is acceptable, PMA to perform final review. 05/16/19- No change, B.I.C PMA to review for sign off. 05/30/19- Ongoing PMA review. 06/06/19- PMA/SMMA approved PCO.	PRE-GMP
#132		JDC Demo	This PCO represents the associated with the reconciliation of the transportation and disposal of soil commingled with ACM that was previously submitted in approved PCO #026. In the previous PCO #026, JDC Demo included \$37,200 of costs for the anticipated 240 tons of Materials and this PCO represents the reconciliation to the actual quantities encountered. This PCO is proposed to be funded by the \$190,000 "Chimney Firebrick or Lining Suspect ACM" Allowance that was established in the JDC Demo Subcontract.	\$62,916.00				\$62,916.00	\$0.00	SCCI issued PCO on 03/19/19. 03/21/19- B.I.C. PMA/SMMA to review. 04/04/19- SCCI to reissue PCO with new scans, PMA/SMMA to begin review. 04/11/2019- SCCI issued revision with new scans, B.I.C. PMA/SMMA for review. 04/11/2019- Meeting needed for SMMA/PMA/SCCI. 04/18/19- PMA follow up internally. 04/25/19- Signatures routing.	PRE-GMP
#133	Field Condiiton	JDC Demo	This allowance transfer authorization request represents the costs associated with the removal of the truck wash used for the abatement of the unforeseen air cell vapor barrier that was encountered on 12/05/18. This work was completed by JDC Demo on a Time and Materials basis as verified by Suffolk and PMA. Additional Costs related to this scope were previously approved in PCO #089. This PCO is proposed to be funded by the following sources: - Utilize the remaining \$2,865.93 of the \$50,000 "Unforeseen Abatement" Allowance that was established in the JDC Demo subcontract. - Remainder to be funded by the \$67,500 "Subsurface Transite Suspect ACM" Allowance that was established in the JDC Demo subcontract	\$6,341.94			\$6,241.89		(\$100.05)	SCCI issued on PCO on 03/21/19. 03/21/19- B.I.C. PMA/SMMA to review. 04/04/19- PMA/SMMA to review. 04/18/19- approved wage rates needed before sign off, SCCI followed up with Mike Clarke. 04/25/19- No change, B.I.C. SCCI for wage rates. 05/02/19- No change, B.I.C. SCCI for wage rates. 05/09/19- PMA reviewing wage rates, to respond to SCCI. 05/16/19- PMA/SMMA issued comments back to SCCI today. 05/23/19- PCO was revised for wage rates and approved from PMA/SMMA.	PRE-GMP
#134		JDC Demo	This allowance transfer authorization request represents the costs associated with the additional mastic removal per the SMMA CCD #003R dated 02/27/19. The costs for other subcontractors related to CCD #003R are excluded and will be submitted under seperate cover. This PCO is proposed to be funded by the following sources: - Utilize the remaining \$8,500 of the \$30,000 "Foundation Coating Suspect ACM" Allowance that was established in the JDC Demo subcontract. - Remainder to be funded from the \$31,000 "Coating Behind Classroom Univents Suspect ACM" Allowance that was established in the JDC Demo Subcontract	\$16,250.00				\$16,250.00	\$0.00	SCCI issued PCO on 03/20/19. 03/21/19- B.I.C. PMA/SMMA to review. 04/04/19- PCO was approved and signed last week.	PRE-GMP
#134A		JDC Demo	This allowance transfer authorization request represents the costs associated with the additional mastic removal per the SMMA CCD #003R dated 02/27/19. In the PCO #134, SMMA/PMA approved \$16,250 of costs for this scope of work at the \$15/sf Unit price for the mastic grinding in the subcontract. This PCO represents the remaining portion of the JDC Demo claim for this scope of work as they contend that the Unit Price in the contract was for bulk loading and not intended to be utilized for this hand grinding specific scope. The costs for other subcontractors related to CCD #003R are excluded and will be submitted under seperate cover. This PCO is proposed to be funded by the \$31,000 "Coating Bheind Classroom Univents Suspect ACM" Allowance that was established in the JDC Demo Subcontract.	\$17,825.65				\$0.00	(\$17,825.65)	SCCI issued PCO on 05/23/19. PMA responded with PCO is rejected per previous conversations to Suffolk this same day.	REJECTED

PMA Construction Change Authorization Log

Key:	Approved	Under Review	Rejected	Pending
------	----------	--------------	----------	---------

#135		SCCI	This allowance transfer authorization request represents the costs associated with the Ceremonial Shovels and Breakfast that were provided for the Groundbreaking Ceremony. This PCO is strictly the mechanism to authorize the utilization of the \$20,000 Ceremonial Allowance within the Lump Sum GR's to cover these costs.	\$2,274.75				\$2,274.75	\$0.00	SCCI issued PCO on 03/21/19. 03/21/19- PCO was approved from PMA/SMMA. Signatures routing.	PRE-GMP
#136		Bartlett Tree Experts	This hold transfer authorization request represents the costs associated with Bartlett Tree Experts to protect existing trees on site. This PCO represents the transfer from the Hold/Contingency to the Suffolk GR's to fund this work. This work is proposed to be funded by the following sources: - Utilize the \$15,000 "Arborsity Service for Existing Trees" Hold that is included in the Landscaping Budget. - Remaining \$400 to be funded from Construction Contingency	\$15,400.00				\$15,400.00	\$0.00	SCCI issued PCO on 03/21/19. 04/04/19- SCCI to revise cover sheet and resubmit PCO.	PRE-GMP
#137		Flett	This allowance transfer authorization request represents the costs associated with the Non-FSB subcontractors that have obtained bonds to date. Additional subcontractors will be submitted under separate cover if required after ongoing discussions with Suffolk and PMA/City of Somerville. This PCO is proposed to be funded by the Payment and Performance Bonds Allowance.	\$13,728.00				\$10,875.00	(\$2,853.00)	SCCI issued PCO on 03/21/19. 04/04/19- PMA to review. 04/18/19- PMA to review. 04/18/19- PMA B.I.C. 04/25/19- PCO EXECUTED.	PRE-GMP
#137A	N/A	JDC, Beton, Beauce Atlas, Millwork One, Sunrise, East Coast, Eaton, Kittredge, Walker, NEIS, Dow	This allowance transfer authorization request represents the costs associated with the enclosed Payment & Performance Bonds for the Non-FSB Subcontractors. This PCO is proposed to be funded by the Payment and Performance Bonds Allowance. NOTE- Bond costs for any additional subcontractors will be submitted under seperate cover.	\$584,476.80				\$584,476.80	\$0.00	SCCI issued PCO on 04/02/19. 04/04/19- PMA/SMMA to review. 04/18/19- PMA B.I.C. 04/25/19- PCO EXECUTED. 05/16/19- PCO was updated for Beton's full bond cost.	PRE-GMP
#137B	NA	Sweeney Drywall	This allowance transfer authorization request represents the costs associated with the enclosed Payment & Performance Bonds for the Non-FSB Subcontractors. This PCO is proposed to be funded by the Payment and Performance Bonds Allowance. NOTE- Bond costs for any additional subcontractors will be submitted under seperate cover.	\$102,500.00				\$102,500.00	\$0.00	SCCI issued PCO on 05/10/19. 05/16/19- B.I.C. PMA for approval. 05/23/19- PCO is signed	PRE-GMP
#138	CCD #004	Marguerite	See attached cost from Marguerite Concrete for the added formwork, rebar, concrete, labor, and equipment to reinforce, form, and pour the one sided wall due to impacts and added scope described in CCD #004.	\$41,689.79		\$48,000.00			\$6,310.21	SCCI issued PCO on 03/21/19. 04/04/19- PMA/SMMA to review and issue comments. 04/11/2019- SMMA sent comments to PMA last week, PMA to review and get comments to SCCI. 04/18/19- PMA issued comments back to SCCI today. 04/25/19- Ongoing, PMA to meet with SCCI/Marguerite. 05/02/19- B.I.C. SCCI for review with Marguerite, review with Dow and Spillane for any credits. 05/09/19- No change, B.I.C. SCCI to review with Marguerite and chase Dow/Spillane for credits. 05/16/19- SCCI reviewing revised PCO, to submit PMA/SMMA. 05/30/19- No change, SCCI to submit revised PCO to PMA/SMMA ASAP. 06/06/19- SCCI/Marguerite compiling PCO, price has gone up for a total of 48k, to be reviewed from PMA/SMMA once submitted. 06/13/19- No change, SCCI to issue revision ASAP.	SCCI
#139		Boston Chimney	This PCO represents the transfer of funds from the General Requirements budget to Boston Chimney to cover the costs associated with additional Chimney Make-safe requested by Suffolk. This PCO represents the mechanism to notify PMA/SMMA of the transfer of costs between the GR and Chimney (existing conditions) Budgets.	\$0.00			\$0.00	\$0.00	\$0.00	SCCI issued PCO on 03/22/2019. 03/28/19- PCO is being funded from GRs. Signatures are routing.	PRE-GMP
#140	PR #014	WJGEI	This proposed deductive change order represents the credit associated with the deleted light fixtures per the SMMA PR #014 dated 07/30/18.	(\$3,222.52)			(\$3,222.52)		\$0.00	SCCI issued PCO on 03/22/2019. 03/28/19- GGD OK. 04/04/19- PMA final sanity check then print for signatures if OK. 04/18/19- PMA B.I.C.	PRE-GMP
#141		WJGEI	PR #006 Added No Smoking Signs	\$1,071.91		\$1,071.91			\$0.00	04/18/19- SCCI to formally issue PCO ASAP. 04/25/19- Ongoing, B.I.C. SCCI. 05/02/19- Ongoing, B.I.C. SCCI to submit PCO for review. 05/09/19- SCCI to formally submit PCO. 05/16/19- SCCI to formally submit PCO. 05/30/19- SCCI to formally submit PCO. 06/06/19- No change, B.I.C. SCCI. 06/13/19- No change, B.I.C. SCCI.	SCCI
#142	ASI #007R2	WJGEI	This proposed change order represents the Electrical costs associated with the changes made to the lighting plans in the SMMA ASI #007 dated 07/24/18.	\$18,965.70		(\$2,500.00)			(\$21,465.70)	SCCI issued PCO on 03/22/2019. 03/28/19- GGC under review. 04/04/19- SMMA still reviewing PCO. 04/11/2019- SMMA to issue revised ASI for pricing clarity purposes. 04/18/19- Revised ASI ongoing, B.I.C. SMMA. 04/25/19- Ongoing, B.I.C. SMMA. 05/02/19- SMMA issuing revised ASI, overall change to a credit. 05/09/19- ASI #007R2 was issued on 5/2, SCCI to review with WJGEI for credit. 05/16/19- SCCI working with WJGEI on credit. 05/30/19- Ongoing, no change. 06/06/19- No change, B.I.C. SCCI / WJGEI. 06/13/19- No change, B.I.C. SCCI/WJGEI.	SCCI
#145		Dow Company	Dow Premium Time	\$3,197.89		\$3,197.89			\$0.00	04/18/19- SCCI to formally issue PCO ASAP. 04/25/19- Ongoing, B.I.C. SCCI. 05/09/19- SCCI to formally submit PCO. 05/16/19- SCCI to formally submit PCO. 05/30/19- No change, B.I.C. SCCI. 06/06/19- No change, B.I.C. SCCI. 06/13/19- No change, B.I.C. SCCI.	SCCI
#146	Field Condiiton	Dow & Flett	This allowance transfer authorization request represents the costs associated with the soil export premiums to the enclosed facilities as outlined COR's. This work has been completed according to the unit prices and allowance value established in the Buyout Authorization Request #12 for Soils Management Allowance. This is proposed to be funded by the \$2,600,000 Allowance that was established in this Buyout Authorization Request #12	\$9,614.78	\$13,942.06				\$4,327.28	SCCI issued PCO on 03/29/2019. 04/04/19- SCCI to revise PCO to include Dow facility premium costs from PCO #124. 04/11/2019- SCCI reissued PCO with disputed costs (costs associated to Saturday trucking and facility openings) on 04/06/2019 and will be on Hold as PMA/SCCI/Dow review with schedule impact costs. 04/18/19- No change, PCO on hold as PMA/SCCI/Dow review with schedule impact costs. 04/25/19- No change, PCO on hold as PMA/SCCI/Dow review with schedule impact costs. 05/16/19- No change, PCO on hold as PMA/SCCI/Dow review with schedule impact costs. 05/30/19- Ongoing, no change from last week. 06/06/19- Ongoing, no change. 06/13/19- Ongoing, no change.	SCCI/HOLD
#147	PR #068, RFI #318	Simplex	This proposed change order represents the costs associated with the Fire Protection scope revisions per the SMMA PR #068 dated 02/12/19.	\$13,399.32					(\$13,399.32)	SCCI issued PCO on 03/29/2019. 04/04/19- SMMA/PMA to review. 04/11/2019- SMMA sent PMA approval email last week, PMA to review before routing for signatures. 04/18/19- No change, B.I.C. PMA. 04/25/19- No change, B.I.C. PMA. 05/02/19- PMA sent comments to SMMA, SMMA reviewing. 05/09/19- PMA issued comments over to SCCI on 5/8, PCO is rejected.	REJECTED
#148		SCCI	This proposed change order represents the reconciliation of the correct Suffolk mark-ups (Bond, GLPD, Fee) on the enclosed Approved PCO's that were signed previously. The attached matrix lists all of the approved PCO values with the corresponding correct mark-up reconciliation values required to match the contract mark-up percentages.	\$26,050.82			\$20,807.56		(\$5,243.26)	SCCI issued PCO on 03/29/2019. 04/04/19- SMMA/PMA to reviewed, comments sent back. SCCI revised per PMA/SMMA comments, PCO revision to be reviewed for signatures	PRE-GMP
#149		Dow/Flett	This allowance transfer authorization request represents the costs associated with the soil export to the enclosed facilities as outlined in the attached tickets. This work has been compelted according to the unit prices and allowance value established in the Buyout Authorization Request #12 for Soils Management Allowance. This is proposed to be funded by the \$2,600,000 Allowance that was established in this Buyout Authorization Request #012.	\$55,827.60				\$51,807.90	(\$4,019.70)	SCCI issued PCO on 04/06/2019. 04/11/2019- B.I.C. PMA for review. 04/18/19- No change, B.I.C. PMA. 04/25/19- PMA issued comments back to SCCI, SCCI to follow up. 05/02/19- SCCI provided backup for missing items, PMA to review. 05/09/19- PMA responded to SCCI requesting back up info on certain dates of trucking, SCCI to coordinate with Dow. 05/16/19- SCCI/PMA followed up with CDW, received back up for dates needed. PCO is routing.	ROUTING
#150		Dow Company	This PCO represents the budget transfer from GR's toDow to cover the costs of sitework required to set up the field office trailer and jersey barriers. The transfer for the electrical costs will be submitted under separate cover.	\$0.00					\$0.00	SCCI issued PCO on 04/17/19. 04/18/19- B.I.C PMA/SMMA for review. 04/25/2019- PCO EXECUTED.	PRE-GMP
#151		WJGEI	RFI #400- Phase 1A/1B Existing Electrical Panel FB1	\$5,359.55		\$5,359.55			\$0.00	04/18/19- SCCI to formally issue PCO ASAP. 04/25/19- Ongoing, B.I.C. SCCI. 05/02/19- Ongoing, B.I.C. SCCI to submit PCO for review. 05/09/19- SCCI to formally submit PCO. 05/16/19- SCCI to formally submit PCO. 05/30/19- No change, B.I.C. SCCI. 06/06/19- No change, B.I.C. SCCI. 06/13/19- No change, B.I.C. SCCI/WJGEI.	SCCI
#152	ASI #001, PR #018	WJGEI	This proposed change order represents the costs associated with the Audiovisual Equipment adds/deducts per the ASI #001 dated 06/28/18 PR #018 dated 08/03/2018.	\$23,769.03			\$11,327.37		(\$12,441.66)	SCCI issued PCO on 04/06/2019. 04/11/2019- PMA sent comments back to SCCI on 04/10. B.I.C. SCCI for review. 04/18/19- Comments sent back to SCCI/WJGEI. 04/25/19- No change B.I.C. SCCI. 05/02/19- No change, B.I.C. SCCI for review. 05/09/19- No change, B.I.C. SCCI for review. 05/16/19- No change, B.I.C. SCCI for review of comments. 05/30/19- SCCI submitted revised PCO on 5/20, PMA/SMMA reviewed and approved PCO on 05/21.	PRE-GMP
#153	PR #087	Marguerite	This proposed change order represents the enclosed concrete costs associated with the increased footing size at the Sub-Level Part A Footing at CC line due to the SMMA PR #087 dated 03/20/19.	\$4,747.48		\$4,747.48			\$0.00	SCCI issued PCO on 04/06/2019. 04/11/2019. B.I.C. PMA/SMMA for review. 04/18/19- B.I.C SMMA. 04/25/19- SMMA issued comments to PMA on 4/24, PMA to review. 05/02/19- PMA/SMMA issued comments to SCCI yesterday, SCCI to review. 05/09/19- SCCI reviewing PCO with Marguerite. 05/16/19- No change, B.I.C SCCI. 05/30/19- No change, B.I.C. SCCI to review with Marguerite. 06/06/19- No change, B.I.C. SCCI/Marguerite. 06/13/19- No change, B.I.C. SCCI/Marguerite.	SCCI

PMA Construction Change Authorization Log

			Key:	Approved	Under Review	Rejected	Pending				
#154	PR #029	WJGEI	This proposed deductive change roder represents the credit associated with the revised lightning at Corridor A013.1 per the SMMA PR #029 dated 09/13/18 and RFI #182 dated 09/13/18.	(\$580.13)			(\$580.13)		\$0.00	SCCI issued PCO on 04/06/2019. 04/11/2019. B.I.C. PMA/SMMA for review. 04/18/19- B.I.C. PMA. 04/25/19- No change, B.I.C. PMA. 05/02/19- PCO was executed yesterday.	PRE-GMP
#155		WJGEI	This proposed changer order represents the costs associated with the Electrical T&M work that was completed for repairs of the unforeseen electrical conduits as listed below: - Electrical Conduits Along Highland Ave per PMA E-Mail dated 01/11/19. -Auto Shop Conduit Repair damaged by CDW cORING. - Unforeseen Conduit Near Monument/Concourse Area on Highland Ave for Sight Light Pole. This work was completed on a time and materials basis as verified by Suffolk and PMA.	\$3,145.62			\$3,145.62		\$0.00	SCCI issued PCO on 04/06/2019. 04/11/2019- B.I.C. PMA/SMMA for review. 04/18/19- B.I.C. PMA/SMMA. 04/25/2019- B.I.C PMA for review.	PRE-GMP
#156	PR #092	Marguerite/JDC Demo	This proposed change order represents the enclosed Demo & Concrete costs for the additional slab demo and replacement to allow for the Electrical floor boxes per the SMMA PR #092 dated 04/02/19. This PCO excludes all costs for other trades which we wil be submitted under seperate cover if required.	\$11,367.75		\$11,367.75			\$0.00	SCCI issued PCO on 04/06/2019. 04/11/2019- PMA/SMMA reviewed and sent comments back to SCCI on 04/10 revise and resubmit. 04/18/19- SCCI to get JDC wage rates, PMA to follow up formally for direction on Marguerite. 04/25/19- No change for both SCCI and PMA. 05/09/19- PMA issued comments over to SMMA, SMMA to add any comments and issue back to PMA. 05/16/19- SCCI still working with subs on revised PCO. 05/30/19- SCCI still coordinating with JDC/Marguerite. 06/06/19- SCCI was still coordinating with JDC/Marguerite. 06/13/19- SCCI working out this PCO and PCO #159 to be compiled as one with subs, work out pricing deal with Marg. / JDC Demo.	SCCI
#157		WJGEI	This proposed change order represents the costs associated with Griffin Electric providing the dedicated troubleman for the Eversource shutdown scheduled at 12 AM on 12/08/18 per the enclosed email correspondence.	\$1,503.47				\$1,402.61	(\$100.86)	SCCI issued PCO on 04/09/2019. 04/11/2019- B.I.C. SMMA/PMA for review. 04/18/19- SCCI to follow up internally. 04/25/19- PCO being funded from construction contingency, signatures routing.	PRE-GMP
#158		WJGEI	This proposed change order represents the costs associated with the Electrical Premium Time Only for the electrical shutdown performed on Sunday 11/16/18 as coordianted with PMA and the City of Somerville to not impact operations per the enclosed email documentation. This work was completed on a Time and Materials basis as verfied by Suffolk	\$6,508.91			\$3,254.46		(\$3,254.45)	SCCI issued PCO on 04/09/2019. 04/11/2019- B.I.C. SMMA/PMA for review. 04/18/19- PMA issued comments to SCCI, SCCI following up with WJGEI. 04/25/19- No change, B.I.C. SCCI. 05/02/19- No change, B.I.C. SCCI. 05/09/19- SCCI submitted revised PCO per PMA/SMMA comments, PCO was approved. Signatures Routing.	PRE-GMP
#159	ASI #024	JDC Demo	This proposed change order represents the additional slab demo required per the SMMA ASI #024 dated 09/28/18.	\$3,500.62		\$3,500.62			\$0.00	SCCI issued PCO on 04/11/19. 04/18/19- SCCI to get JDC wage rates. 04/25/19- PMA sent comments back on 4/16, B.I.C. SCCI. 05/02/19- SCCI to follow up with Marguerite response, SCCI also chasing JDC wage rates. 05/09/19- SCCI stil following up with Marguerite, JDC wage rates were submitted. 05/16/19- No change, SCCI ongoing work with subs for revised PCO. 05/30/19- No change, SCCI still coordinating with JDC / Marguerite. 06/06/19- SCCI was still coordinating with JDC/Marguerite. 06/13/19- SCCI compiling costs/credits with PR #008 for this PCO and PCO #156.	SCCI
#160		SCCI	This proposed change order represents the credit associated with the enclosed highlighted Value Engineering items that have been agreed upon per the meeting 03/26/19. This PCO is to memorialize the credit associated with these Holds & Allowances that were established in the previous Buyout Authorizations and draft GMP budgets.						\$0.00	SCCI issued PCO on 04/12/19. 04/18/19- B.I.C. PMA/SMMA for review. 04/25/19- No change, B.I.C. PMA/SMMA	PRE-GMP
#161	PR #042	Grasseschi	PR #042 Plumbing Revisions due to coordination	\$148,398.65		\$148,398.65			\$0.00	SCCI submitted PCO on 04/18/19. 04/25/19- No change, B.I.C. PMA/SMMA. 05/02/19- SMMA issued comments to PMA, PMA to review/addy any comments and issue to SCCI. 05/09/19- PMA issued comments over to SCCI, large discrepancy for what Grasseschi is submitting and what engineer is calculating. SCCI estimator to review PCO, coordinate with Grasseschi. 05/16/19- SCCI/ estimator coordinating with Grasseschi. 05/30/19- SCCI/Estimator still coordinating with Grasseschi. 06/06/19- No change, B.I.C. SCCI estimating / Grasseschi. 06/13/19- No change, B.I.C. SCCI/Grasseschi.	SCCI
#163	Field Condiiton	Dow Company / J Derenzo	This allowance transfer authorization represents the costs associated with the soil export to the enclosed facilities as outlined in the attached tickets. This work has been completed according to the unit prices and allowance value established in the Buyout Authorization #12 for Soils Management Allowance. This is proposed to be funded by the \$2,600,000 Allowance that was established in this Buyout Authorization Request #12.	\$177,647.68				\$174,602.81	(\$3,044.87)	SCCI issued PCO on 04/18/19. 04/18/19- B.I.C. PMA for review. 04/25/19- No change, B.I.C. PMA. 05/02/19- No change, B.I.C. PMA. 05/09/19- PMA actively reviewing PCO. 05/16/19- No change, PMA actively reviewing. 05/30/19- PMA finishing review. 06/06/19- PMA wrapped up review, SCCI revised PCO per comments and PCO was executed on 06/07/19.	PRE-GMP
#165	ASI #034	PJK	This proposed change order represents the HVAC costs associated with the revised duct routing at the grease trap at Part A Level 1 per the SMMA ASI #034 dated 11/15/2018.	\$3,610.27		\$3,212.74			(\$397.53)	SCCI issued PCO on 04/19/2019. 04/25/19- No change, B.I.C. PMA/SMMA. 05/02/19-PMA issued comments to SMMA, will issue to SCCI once SMMA comments are captured. 05/09/19- PMA issued comments over to SCCI, revise and resubmit. 05/16/19- No change, SCCI coordinating with subs for revised PCO. 05/30/19- No change, SCCI still coordinating with subs. 06/06/19- SCCI vetted PJK response, issued PCO revision. PMA/SMMA to review. 06/13/19- B.I.C. PMA/SMMA to review.	PMA/SMMA
#166	Field Condiiton	Dow Company	This proposed change order represents the costs associated with backfilling and paving the school street water connection due to the request to hold off for GLX per the attached email dated 04/19/19. This work was tracked on a Time and Materials basis as verified By Suffolk and PMA. NOTE: This PCO includes the costs to backfill & pave this location which will not be charged when the permanent configuration is completed. Please note that Dow may submit a bill under seperate cover for the excavation when the permanent work is completed as they already completed their contract obligation with the initial excavation for this scope.	\$10,411.89		\$10,411.89			\$0.00	04/25/19- SCCI to issue PCO formally. 05/02/19- No change, B.I.C SCCI. 05/09/19- SCCI to formally submit PCO. 05/16/19- SCCI to formally submit PCO. 05/30/19- SCCI to formally submit PCO still. 06/06/19- No change, SCCI to formally submit PCO still. 06/13/19- SCCI submitted PCO on 06/11, PMA/SMMA to review. 06/13/19- B.I.C. PMA/SMMA to review.	PMA/SMMA
#167	PR #047	Dow Company, Grasseschi	This proposed change order represents the costs associated with the additional Sitework and Plumbing scopes of work per the SMMA PR #047 dated 11/26/18.	\$93,713.87		\$93,713.87			\$0.00	SCCI issued PCO on 04/19/2019. 04/25/19- No change, B.I.C. PMA/SMMA. 05/02/19-SMMA issued comments to PMA, PMA to add any comments and issue to SCCI. 05/09/19- PMA issued comments over to SCCI, large discrepancy for what Grasseschi is submitting and what engineer is calculating. SCCI estimator to review PCO, coordinate with Grasseschi. 05/16/19- No change, SCCI/estimator working with Grasseschi. 05/30/19- No change, SCCI/estimator still working with Grasseschi. 06/06/19- No change, SCCI/estimator still working with Grasseschi. 06/13/19- No change, B.I.C. SCCI.	SCCI
#168	RFI #327	Flett	This proposed change order represents the costs associated with the DMH 4-7 ivnert modifications that were required due to the conflicts with the existing water line per the SMMA response to RFI #327 dated 02/04/2019. This work was completed on a Time and Materials basis as verified by Suffolk and PMA.	\$3,240.66			\$2,844.85		(\$395.81)	SCCI issued PCO on 04/19/2019. 04/25/19- No change, B.I.C. PMA/SMMA. 05/02/19-SMMA issued comments to PMA, PMA to add any comments and issue to SCCI. 05/09/19- PMA issued comments back to SMMA. Once PMA/SMMA comments are finalized, PMA to issue comments over to SCCI. 05/16/19- SCCI revised PCO per SMMA/PMA comments, PCO is routing.	ROUTING
#169	RFI #308, RFI #355, RFI #350, RFI #381 CCD#004	Marguerite	This proposed change order represents the costs associated with the enclosed miscellaneous concrete T&M slips that were verified by Suffolk and PMA. This PCO includes T&M associated with the following RFI responses: RFI #308- Sonotube Coordination Near Electrical Ductbank. RFI #335 - 12" Storm Riser in Foundation Wall Clarification. RFI #350- Pilaster and Anchor Bolt Conflict at HS-XQ. RFI #381 - CCD #004 issue at Grade Beam with Existing Footing at Pier L-11.	\$5,525.69		\$5,525.69			\$0.00	SCCI issued PCO on 04/19/2019. 04/25/19- No change, B.I.C. PMA/SMMA. 05/02/19-PMA issued comments to SMMA, will issue to SCCI once SMMA comments are captured. 05/09/19- PMA issued comments over to SMMA, SMMA to add any comments and PMA will submit comments back to SCCI. 05/16/19- PMA to issue comments over to SCCI. 05/30/19- PMA to issue comments over to SCCI still. 06/06/19- B.I.C PMA/SMMA to review PCO. 06/13/19- PMA to respond to SCCI on PCO.	PMA
#170		Dow Company	This construction contingency authorization request represents the costs associated with constructing the added ramp to provide access around the sublevel footing excavations at FF line. This work is required to provide access around the FF Footings and was not part of the site logistics anticipated and included in the Sitework Buyout.	\$28,345.00					(\$28,345.00)	SCCI issued PCO on 05/02/19. 05/09/19- SCCI is reviewing offline after SMMA/PMA/SCCI meeting on 05/08. 05/16/19- PCO is void as of 5/16 per SCCI internal discussions	REJECTED
#171	PR #101R1	Pavilion Flooring	Gym Flooring Change costs from PR #101R1.	\$164,541.63		\$163,087.69			(\$1,453.94)	SCCI issued PCO on 05/08/19. 05/09/19- SMMA/PMA beginning review of PCO. 05/16/19- No change, PMA/SMMA reviewing. 05/30/19- Ongoing review from PMA/SMMA. 06/06/2019- PCO is approved from all parties, SCCI reviewing schedule impact from floor change. 06/13/19- To be reviewed w/ schedule and discussed at BC meeting.	PMA
#171a	PR #101R1	WJGEI	Electrical Credit associated with PR #101R1	(\$5,000.00)		(\$5,000.00)			\$0.00	06/06/19- SCCI chasing WJGEI for credit associated with PR #101R1, to submit PCO once approved. 06/13/19- SCCI chasing WJGEI on credit.	SCCI
#172	PR #077	PJK, Marguerite, Dow Company	See attached credit for the deletion of the breeching, attachments, and supports for the generator exhaust stack.	(\$65,959.19)		(\$65,959.19)			\$0.00	SCCI issued PCO on 05/10. 05/16/19- PMA/SMMA to review PJK credit, SCCI to chase Marg./Dow for credits. 05/30/19- No change, PMA/SMMA still reviewing and SCCI still chasing Marg./Dow for credits. 06/06/19- SCCI chasing Marguerite for credit, Dow's part is in. SMMA sent comments to PMA on 06/05 with comments on PJK piece. PMA to review and issue comments over to SCCI. 06/13/19- PMA issued comments over to SCCI on PJK piece, Suffolk to review/compile with Marg./Dow pieces.	ALL

PMA Construction Change Authorization Log

Key:	Approved	Under Review	Rejected	Pending
------	----------	--------------	----------	---------

#174	PR #097	PJ Kennedy	This proposed change order represents the mechanism to memorialize that PJ Kennedy has confirmed there are no cost impacts for the additional scope included in the SMMA PR #097 dated 04/02/19.	\$0.00			\$0.00		\$0.00	SCCI issued PCO on 05/16/19, no cost thus PMA/SMMA approved.	PRE-GMP
#175	Field Condiiton	Dow Company	This allowance transfer authorization request represents the costs associated with the soil export to the enclosed facilities as outlined in the attached tickets. This work has been completed according to the unit prices and allowance value established in the Buyout Authorization Request #12 for Soils Management Allowance. This is proposed to be funded by the \$2,600,000 Allowance that was established in this Buyout Authorization Request #12	\$42,793.03	\$42,793.03				\$0.00	SCCI issued PCO on 05/23/2019, PMA to review. 05/30/19- PMA review ongoing. 06/06/19- Ongoing review from PMA. 06/13/19- Ongoing review from PMA.	PMA
#176	PR #094	Eaton	This proposed change order represents the mechanism to confirm that there are no cost impacts for the SMMA PR #094 dated 04/22/2019.	\$0.00			\$0.00		\$0.00	SCCI issued PCO on 05/17/19, no cost thus PMA/SMMA approved.	PRE-GMP
#178	CCD #009	JDC Demo	This allowance authorizaiton request represents the costs associated with Unforseen Mastic found behind gym wall per Ben Carawan email dated 05/21/19. This PCO includes completing this scope within 2 containment setups as outlined in the JDC Demo Qualifications. This PCO is proposed to be funded by the following sources: -Utilize the remaining \$23,350 of the \$31,000 Allowance for "Coating Behind Classroom Univents Suspect ACM 2000SF". -Utilize the remaining \$40,705.29 of the \$67,500 Allowance for "Subsurface Transite Suspect ACM 1,500 LF". -Remainder to be funded by the \$300,000 Allowance to "Remove & Salvage of Construction Materials"	\$99,010.72	\$99,010.72				\$0.00	SCCI issued PCO on 05/30/2019, PMA/SMMA to review. 06/06/19- PMA/SMMA disagreed with the price, CCD #009 was cut to get the work going. SCCI to coordinate T&M tracking with PMA. 06/13/19- SCCI coordinating tracking with PMA.	ALL
#179	PR #008	JDC Demo/Marguerite	PR #008 Temp. Heat Exchanger Room Credits for Trenching/Patching Slab & Floor Drain.	(\$9,424.67)		(\$9,424.67)			\$0.00	05/30/19- SCCI to formally submit PCO ASAP. 06/06/19- No change, SCCI to submit PCO formally (chasing Grasseschi credit). 06/13/19- SCCI to wrap this up into PCOs #156 and #159 compilation.	SCCI
#180		SCCI	This proposed change order represents the costs associated with providing the additional OxBlue camera for the remainder of the project. This PCO is proposed to have funding split 50/50 between Construction and Owner Contingency. NOTE: This PCO is strictly for the OxBlue costs, any additional costs for Griffin Electric are excluded and will be submitted under seperate cover.	\$21,386.00	\$11,461.93	\$10,693.00			\$768.93	SCCI issued PCO on 05/23/19. PMA/SMMA take no objection, PCO approval is contingent upon approval from the Building Committee.	ROUTING
#181		King Painting	This PCO represents the budget transfer from GR's to King Painting to cover the costs of Painting the field offices which was completed on a Time and Materials basis.	\$6,313.00					(\$6,313.00)	PCO was issued on 05/28/2019. 05/30/19- PCO was approved from SMMA/PMA.	ROUTING
#182		Boston Chimney	This PCO represents the budget transfer from GR's to Boston Chimney for the miscellaneous T&M work completed as verified by Suffolk	\$5,703.79					(\$5,703.79)	PCO was issued on 05/28/2019. 05/30/19- PCO was approved from SMMA/PMA.	ROUTING
#183		Dow/Marguerite	Unsuitable Fill at AA Line Sub Level Footing	\$15,000.00		\$15,000.00			\$0.00	06/13/19- SCCI to submit PCO ASAP.	SCCI.
#184	PR #096	WJGEI	This proposed deductive change order represents the credit associated with the revised light fixture type per the SMMA PR #096 dated 04/02/19.	(\$2,048.91)		(\$2,048.91)			\$0.00	PCO was issued on 05/28/2019. 05/30/19- PMA/SMMA to review. 06/06/19- PMA/SMMA still reviewing, SMMA issued response to PMA approving PCO on 06/11, PMA to review for final check. 06/13/19- B.I.C. PMA for review.	PMA
#185	Field Condiiton	Bowline, NE Engineers, V&G Iron	This hold transfer authorization request represents the costs associated with providing the temporary shoring towers to allow the Electrical Room demolition work per the enclsod invoices. This PCO is proposed to be funded by the \$50,000 Hold for Additional Temp Shoring that was established in the Demolition Buyout Authorization #1 dated 04/25/18.	\$32,259.94	\$32,259.94				\$0.00	PCO was issued on 06/04 from SCCI. 06/06/19- B.I.C. PMA/SMMA to review. 06/13/19-	PMA/SMMA
#186		WJGEI	This PCO represents the transfer of costs from the Suffolk GR's to the enclosed subcontractors for the miscellaneous work required in the Electrical Room.	\$46,215.73					(\$46,215.73)	PCO was issued on 05/29/2019. 05/30/19- PCO was approved from SMMA/PMA.	ROUTING
#187	PR #078R	Dow Company	This proposed deductive change order represents the credit associated with the tree removal scope change (5 EA to remain) per the SMMA PR #078R dated 03/07/2019.	(\$5,361.83)		(\$5,631.83)			\$0.00	PCO was issued on 05/29/2019. 05/30/19- PMA/SMMA reviewing. 06/06/19- PMA/SMMA were reviewing, SMMA sent approval to PMA on 06/07. PMA to review for final check. 06/13/19- B.I.C. PMA for review.	PMA
#188	PR #105	PJK	See attached costs from PJK and Worcester Air to re-model changes to the ductwork and H-pipe due to revised gym joists. Suffolk comments and email attached as well.	\$3,640.85		\$3,640.85			\$0.00	PCO was issued on 05/29/2019. 05/30/19- PMA/SMMA reviewing. 06/06/19- SMMA/SCCI going back and forth with WAC on model hours. SCCI proposed reduction in hours, B.I.C. SMMA to review. 06/13/19- B.I.C. SMMA to respond on hours dispute.	SMMA
#189	PR #111	Dow Company	This proposed change order represents the costs associated with the additional 14 EA tree removals per the SMMA PR #111 dated 05/14/2019.	\$14,470.79		\$14,470.79			\$0.00	PCO was issued on 05/30/2019, PMA/SMMA to review. 06/06/19- PMA/SMMA were stil reviewing, SMMA sent approval to PMA on 06/11. PMA to review for final check. 06/13/19- B.I.C. PMA for review.	PMA
#190	PR #103	Sweeney	This proposed deductive change order represents the credit associated with the revised ceiling type per the SMMA PR #103 dated 05/31/2019.	(\$1,774.00)		(\$1,774.00)			\$0.00	PCO was issued on 5/31/2019. 06//06/19- SMMA reviewed PCO and found acceptable, PMA to review for final check. 06/13/19- B.I.C. PMA for review.	PMA
#191	CCD #005	Marguerite	CCD #005- Modification of Part D, lower level foundation walls along grid lines 1 & 3 and adjacent to K line due to location of SOE walls. Note the elimination of H-1 column and associated pier & footing including the (4) shortened Level 1 steel beams.	\$163,622.77		\$163,622.77			\$0.00	06/06/19- SCCI to submit PCO formally ASAP. 06/13/19- SCCI to submit PCO ASAP.	SCCI
#192	CCD #006	Zichelle	CCD #006 Structural Revisions at Gym Roof	\$246,172.71	\$171,172.71	\$75,000.00			\$0.00	06/06/19- SCCI to submit PCO formally ASAP. 06/13/19- SCCI to submit PCO ASAP.	SCCI
#193	CCD #007	Marguerite	CCD #007 Lower Level B, Phase 1A-1B Existing Trench Infills (RFI #408)	\$53,595.50		\$53,595.50			\$0.00	06/06/19- SCCI to submit PCO formally ASAP. 06/13/19- SCCI to submit PCO ASAP.	SCCI
#194	CCD #008	Beauce Atlas	CCD #008 Part D Brace Modifications (RFI #414)	\$2,679.78		\$2,679.78			\$0.00	06/06/19- SCCI to submit PCO formally ASAP. 06/13/19- SCCI to submit PCO ASAP.	SCCI
#195	RFI #357	WJGEI	This proposed change order represents the costs associated with the additional demolition efforts and remobilization required for the Motor Control Center (MCC) to remain operational until Phase 2 per the SMMA response to RFI #357 dated 03/01/19.						\$0.00	SCCI submitted PCO on 05/30/2019. 06/06/2019- PMA/SMMA to review. 06/13/19- No change, PMA/SMMA reviewing.	PMA/SMMA
#196	PR #015	PJK	This proposed change order represents the credit associated with the deleted temporary roof drain scope of work per the SMMA PR #015 dated 08/07/18.	(\$18,383.40)		(\$18,383.40)			\$0.00	SCCI submitted PCO on 05/30/2019. 06/06/2019- on 06/05 SMMA sent comments to PMA stating review cannot happen until costs are broken out. PMA forwarded this response to SCCI on 06/11, SCCI to revise and resubmit. 06/13/19- No change, B.I.C SCCI.	SCCI
#197	Field Condiiton	WJGEI	This proposed change order represents the costs associated with the speaker that was added per the PMA email request on 04/13/19. This work was completed on a Time & Materials basis as verified by Suffolk and PMA.	\$315.15			\$315.15		\$0.00	SCCI submitted PCO on 05/31/2019, PMA approved the PCO the same day.	PRE-GMP
#198	PR #043	Grasseschi, Dow Company, WJGEI	PR #043 Plumbing, Civil, & Electrical Revs.	(\$3,599.52)		(\$3,599.52)			\$0.00	06/06/19- SCCI to formally submit PCO. 06/13/19-	SCCI
#199	PR #013	WJGEI	This proposed deductive change order represents the credit associated with reduced lighting scope of work per the SMMA PR #013 dated 07/28/18.	(\$280.60)		(\$280.60)			\$0.00	SCCI submitted PCO on 05/31/2019. 06/06/19- PMA/SMMA were to review, SMMA sent an email on 06/11 approving PCO. PMA to review for final check. 06/13/19- B.I.C. PMA for review.	PMA/SMMA
#200	PR #016	Lighthouse	Salvage of Band Room Plaster Crest & New Loc., Addl Plaques.	\$16,050.77		\$16,050.77			\$0.00	06/06/19- SCCI to formally submit PCO. 06/13/19- No change, SCCI to formally submit PCO.	SCCI
#202	PR #025	WJGEI	This proposed change order represents the mechanism to memorialize that WJGEI has confirmed there are no cost impacts for the additional scope included in the SMMA PR #025 dated 09/07/18.	\$0.00		\$0.00			\$0.00	SCCI submitted PCO on 05/31/19. 06/06/19- B.I.C. PMA/SMMA to review, PMA sent approval to SMMA. SMMA to review for final check. 06/13/19- B.I.C PMA to review.	PMA
#203	PR #026	PJK/WJGEI	This proposed change order represents the costs associated with the Exhaust Fan Revisions per the SMMA PR #026 dated 08/31/18. (no cost from WJGEI)	\$622.63		\$622.63			\$0.00	06/06/19- SCCI submitted PCO on 05/31/19, PMA/SMMA to review. 06/13/19- No change, PMA/SMMA reviewing.	PMA/SMMA
#205	PR #031	Lighthouse	This proposed change order represents the mechanism to confirm there are no additional cost impacts associated with the SMMA PR #031 dated 09/07/18.	\$0.00		\$0.00			\$0.00	06/06/19- SCCI submitted PCO on 06/04/19, SMMA approved PCO on 06/04. PMA to review for final check. 06/13/19- B.I.C. PMA for review.	PMA

PMA Construction Change Authorization Log

		Key:	Approved	Under Review	Rejected	Pending					
#206	PR #032	Eaton, Sweeney	This deductive change order represents the credit associated with the reduced size of the Trainers Office HM C134 Door per the SMMA PR #032 dated 09/25/18. Sweeney Drywall has confirmed that although there is additional scope in this PR #032, they will not be submitting a COR.	(\$456.28)		(\$456.28)			\$0.00	SCCI submitted PCO on 06/07/19, PMA/SMMA to review. 06/13/19- No change, PMA/SMMA reviewing.	PMA/SMMA
#207	PR #027	V&G Iron	This deductive change order represents the credit associated with the deleted countertop supports in the Culinary Arts Restaurant A236 per the SMMA PR #027 dated 09/07/18. NOTE: There credit for the Millwork has already been realized in the Millwork Buyout Authorization #16 where this scope of work was excluded from the Buyout.	(\$2,324.27)		(\$2,324.27)			\$0.00	06/06/19- SCCL submitted PCO this morning, B.I.C. PMA/SMMA to review. SMMA sent comments on PCO to PMA on 6/11, PMA to review/add any comments and issue back to SCCL. 06/13/19- B.I.C. PMA for review.	PMA
#208	PR #035	Dow/Marguerite	PR #035 Revs to Retaining Walls 6, 9 & 10 from GLX.	\$162,544.43		\$162,544.43			\$0.00	06/06/19- SCCL to submit PCO formally ASAP. 06/13/19- No change, SCCL to formally submit PCO.	SCCL
#209	PR #049R	WJGEI	This proposed deductive change order represents the credit associated with adjusting the multi-connection box closer to the Eversource transformer per the SMMA PR #049R dated 11/15/18.	(\$20,823.51)		(\$20,823.51)			\$0.00	06/06/19- SCCL submitted PCO on 05/31/19, SMMA sent approval to PMA on 06/05. PMA to review for final check. 06/13/19- B.I.C. PMA for review.	PMA
#210	PR #081	PJK	This proposed change order represents the costs associated with the furnishing the HV3 thru HV11 shop equipment per the SMMA PR #081 dated 03/25/2019.	\$16,996.72		\$16,996.72			\$0.00	06/06/19- SCCL submitted PCO on 05/31/19, SMMA sent approval to PMA on 06/11. PMA to review for final check. 06/13/19- B.I.C. PMA for review.	PMA
#211	PR #054	Grasseschi	PR #054 Plumbing Revisions due to MEP Coordination	\$12,194.05		\$12,194.05			\$0.00	06/06/19- SCCL to formally submit PCO. 06/13/19- No change, SCCL to formally submit PCO.	SCCL
#212	PR #056	Simplex Grinnell	PR #056 Sprinkler Piping Credits (RFI #316 & #317)	(\$5,106.50)		(\$5,106.50)			\$0.00	06/06/19- SCCL to formally submit PCO. 06/13/19- No change, SCCL to formally submit PCO.	SCCL
#213	ASI #049	Grasseschi	This proposed change order represents the additional costs to upgrade and add pressure reducing valves per the SMMA ASI #049 dated 01/07/19.	\$13,315.27		\$13,315.27			\$0.00	06/06/19- SCCL submitted PCO on 05/31/19, PMA/SMMA to review. 06/13/19- No change, PMA/SMMA reviewing.	PMA/SMMA
#214	PR #113	Pavilion Flooring, Homer	This proposed deductive change order represents the net credit associated with revising the flooring material in C009 Storage from linoleum to sealed concrete per the SMMA PR #113 dated 05/17/19.	(\$6,166.95)		(\$6,166.95)			\$0.00	06/13/19- SCCL submitted PCO on 06/11/19, PMA/SMMA to review.	PMA/SMMA
#215	PR #085R1	WJGEI	This proposed change order represents the costs adds/deducts associated with the Electrical Revisions included in the SMMA PR #085R1 dated 04/09/19. NOTE: This PCO includes the rental of the Temp Generator for a 1 year Duration. Any cost impacts associated with extended rental duration or additional service required on the temp generator will be tracked and submitted separately.	\$23,453.93		\$23,453.93			\$0.00	06/06/19- SCCL submitted PCO yesterday 06/05, PMA/SMMA to review. 06/13/19- No change, PMA/SMMA reviewing.	PMA/SMMA
#218	PR #059	SCCL	PR #059 Revisions in Fitness Room A318	\$22,622.65					(\$22,622.65)	06/13/19- Item first appeared in change meeting on this date, SCCL to formally submit PCO.	SCCL
#219	PR #103	Sweeney	PR #103 EMR Ceiling Height & Type Revs (RFI #407 & #408)							06/13/19- Item first appeared in change meeting on this date, SCCL to formally submit PCO. AL followed up with JF after meeting when updating log to see if this was a duplicate for PCO #190, and JF confirmed it was. PCO is VOID.	VOID
#220	PR #038R	Sweeney	PR #038R Fire Smoke Damper Revs & Partition Rating (RFI #196, #199 & #285)	\$3,274.14		\$3,274.14			\$0.00	06/13/19- Item first appeared in change meeting on this date, SCCL to formally submit PCO.	SCCL
#222	PR #040	Kittredge	PR #040 Culinary Arts Kitchen Equipment Revs	\$11,303.46		\$11,303.46			\$0.00	06/13/19- Item first appeared in change meeting on this date, SCCL to formally submit PCO.	SCCL
#223	PR #066R	Grasseschi	PR #066R Added Foundation Drains	\$20,014.71		\$20,014.71			\$0.00	06/13/19- Item first appeared in change meeting on this date, SCCL to formally submit PCO.	SCCL
#224	PR #055	WJGEI	PR #055 Auditorium Control D351 Projection Power Rev	\$1,071.91		\$1,071.91			\$0.00	06/13/19- Item first appeared in change meeting on this date, SCCL to formally submit PCO.	SCCL
#225	PR #065R1	Grasseschi	PR #065R1 Auto Shop Entry Vest A090-7 Emergency Shower & Eyewash	\$3,215.73		\$3,215.73			\$0.00	06/13/19- Item first appeared in change meeting on this date, SCCL to formally submit PCO.	SCCL
#226	PR #074	Grasseschi	PR #074 Revised Daycare Toilets to Comply with Age Appropriate Height Req	\$3,215.73		\$3,215.73			\$0.00	06/13/19- Item first appeared in change meeting on this date, SCCL to formally submit PCO.	SCCL
#227	PR #072	Grasseschi	PR #072 Added Sanitary, Water & Water Recirculating Piping Conn to Risers (RFI #314)	\$5,359.55		\$5,359.55			\$0.00	06/13/19- Item first appeared in change meeting on this date, SCCL to formally submit PCO.	SCCL
#228	PR #073	Grasseschi	PR #073 Emergency Eye Wash Shower Type Change in pH Neutral & Boiler Rms.	\$2,143.82		\$2,143.82			\$0.00	06/13/19- Item first appeared in change meeting on this date, SCCL to formally submit PCO.	SCCL
#229	PR #125	Dow Company	PR #125 Phase 2 Tree Removal Revision - Zelkova to Remain	(\$1,021.30)		(\$1,021.30)			\$0.00	06/13/19- Item first appeared in change meeting on this date, SCCL to formally submit PCO.	SCCL
#TBD	PR #003	PJK	PR #3 - Delete the two VFD's noted on the temporary condensate/receiver pumps as shown on TE101, floor plan E1 at the temporary Heat Exchanger Room, EF-16 revisions: Specification section 23 34 16 paragraph 2.01 replace F.1 with "Variable pitched sheaves" (Revisions are incorporated in approved submittal (RFI-074 response)	(\$5,000.00)		(\$5,000.00)			\$0.00	PR #3 issued on 6/28/18	SCCL
#TBD	PR #009		PR #9 - Revised brick veneer support along column grid line 5 at exterior Stair A5. Revisions include the addition of a steel relieving angle between column grid lines D & G with associated flashing, additional vertical masonry expansion joints, revisions to the masonry veneer base detail along the stair, revisions to the edge of slab dimensions in the affected area and a change from CMU to metal stud backup for the short infill veneer backup walls between the lower slab and Level 2 in the affected area. Refer to RFI-105 response for dimensional location and extent of relieving angle (revision was noted on structural steel shop drawings also). (RFI-089 and 89.1 response). A-021a, A-211, A-310, A-502	\$5,000.00		\$5,000.00			\$0.00	PR #9 issued on 7/17/18	SCCL
#TBD	PR #010		PR #10 - Added keynotes and detail tags for benches in Hallway AH331, CH303 and BH230 (RFI-098 response). Clarification on drawing A-275, interior elevation D2 for an environmental graphic not shown on Conformed set.	\$2,500.00		\$2,500.00			\$0.00	PR #10 issued on 7/20/18	SCCL
#TBD	PR #012		PR #12 - Revisions resulting from coordination between confirmed set and addendum documents. Robot arm room C009.3: Provide (1) MC 58 casework assembly instead of (2) MC 62 casework assemblies. SCC control booth D 159 changes as well	\$2,500.00		\$2,500.00			\$0.00	PR #12 issued on 8/6/18	SCCL
#TBD	PR #017	Sweeney, Millwork One	PR #17 - RFI #140 - Edge of slab revisions in part A: Modifications to adjacent walls, ceilings, finishes, an exterior window and millwork	\$7,500.00		\$7,500.00			\$0.00	PR #17 issued on 8/21/18, RFI #140	SCCL
#TBD	PR #020	Suffolk	Revisions to the locations of fire rated shaft wall assemblies on Lower Level and Level 1 resulting from additional code review as a result of RFI #125, RFI #137, RFI #142	(\$1,894.15)		(\$1,894.15)			\$0.00		SCCL
#TBD	PR #024	Delta Beckwith	PR #024- Revisions to the top of the hoistway construction for the Part D elevator due to clear override coordination with the elevator sub-contractor during the buyout process. The hoist beam in this hoistway has been omitted and the roof beam will be used for the hoisting purposes. The hoist/roof beam is to relieve intumescent fireproofing (2 hour rating), and the structural deck in this area (Above the hoistway only) has been changed from normal metal roof deck to the composite metal/concrete deck to avoid any spray applied fire proofing being exposed to the hoistway, While maintaining the required fire rating of the roof assembly.	\$5,000.00		\$5,000.00			\$0.00		SCCL
#TBD	PR #028	Beauce Atlas	Modification of the quantity and locations of beam pipe penetrations in the culinary arts kitchen A234, level 2, Part A. Twelve beam penetrations were deleted and 1 was added for sanitary line (Invert provided in two locations)	(\$7,500.00)		(\$7,500.00)			\$0.00		SCCL
#TBD	PR #029	WJGEI	Light fixture revisions in corridor A013.1 as a result of RFI #182 response	\$2,500.00		\$2,500.00			\$0.00		SCCL
#TBD	PR #030	SCCL	Added deformation monitoring points (DMP on North side of existing gym building near emergency generator location	\$1,500.00		\$1,500.00			\$0.00		SCCL

PMA Construction Change Authorization Log

Key:	Approved	Under Review	Rejected	Pending
------	----------	--------------	----------	---------

#TBD	PR #037	SCCI	Provide a credit proposal associated with the clarified and revised quantities for salvage of the historic elements from the exterior 1929 vintage construction, as noted in the attached updated salvage matrix that was included with section 02 42 00 removal and salvage of construction materials.	(\$5,000.00)		(\$5,000.00)			\$0.00	PR #37 issued on 11/27/18. SCCI to submit pricing	SCCI
#TBD	PR #041	Greenwood	Removal of roof cant at parapet details as a result of not being required on single ply membrane roofing systems. (RFI-229 response). A-540	(\$2,500.00)		(\$2,500.00)			\$0.00	PR #41 issued on 11/20/18. SCCI to submit pricing	SCCI
#TBD	PR #050	Sunrise	Modification of the terracotta details including the expansion joints in Part A, added detail at Auditorium roof to the fly loft wall at Part D and added detail at the Science Prep Rooms at Part C as a result of the shop drawing review process.	\$5,000.00		\$5,000.00			\$0.00	PR #50 issued on 11/30/18	SCCI
#TBD	PR #052	Grasseschi	Owner directed changes modified the equipment within Machine Technology Shop B033, including the absorptioin of Simulation Room B033.1 into the footprint of the B033 space, eliminating the wall and door seperating those two spaces. Due to the shop equipment changes, it became apparent the small air compressor located in the associated Tool Storage Room B033.2 did not have sufficient capacity for the revised equipment. To address the air compressor capacity and achieve some overall savings, the individual point-of-use compressors that were designed for all of the CTE shops on the lower level were eliminated in favor of a centralized air compressor system that will be located in the sub-level mechanical area and piped to the indivudal shops. In addition to eliminating the point-of-use air compressors from the various CTE shop tool storage rooms, the elevated miscellaneous metals platforms that were designed to house the compressors have also been eliminated. SEE PR FOR MORE DETAIL	\$15,000.00		\$15,000.00			\$0.00	PR #052 issued on 02/27/2019	SCCI
#TBD	PR #053	SCCI	Summer 2018 enabling work scope for the existing D wing that was avoided due to alternative construction methods being suggested by Suffolk and approved by SMMA and the Owner	(\$5,000.00)		(\$5,000.00)			\$0.00	PR #53 issued on 12/10/18, SCCI to submit pricing	SCCI
#TBD	PR #057	Sunrise	Exterior envelope and curtainwall modifications as a result of the curtainwall shop drawing review process. Attachments A-205, A-316, A-528, A-616	\$25,000.00		\$25,000.00			\$0.00	PR #057 issued on 03/26/2019.	SCCI
#TBD	PR #058	SCCI	Due to the revised phase 1 completion date, a credit proposal is requested for the omission of temporary work associated with the cosmetology program that was previously to be located in the new main kitchen space from the completion of Phase 1 until the completion of Phase2A. The cosmetology program will now be located off-site by the owner until Phase 2A is complete, so there is no temporary project work required for this program	(\$40,000.00)		(\$40,000.00)			\$0.00	PR #058 issued on 01/07/2019. SCCI to submit costs.	SCCI
#TBD	PR #060	Grasseschi	Plumbing Revisions due to the water heater relocation as a result of recirculating piping pressures and riser location moved closer to the Water Room D096, Part D Phase 1. Attachments: A-101d, AR101d, P-100a, P100c, P-100d, P-102c, P-401, P-408, P-505, P-602	TBD		TBD				PR #060 issued on 03/25/2019. SCCI to submit costs.	SCCI
#TBD	PR #063	WJGEI	Lighting revisions as a result of the light fixtures submittal review. Lecture Hall D336: Revised head detail at the sliding marker boards to iuncorporate light fixture (fixture shown on lighting plan). Transition Skills D154: Revised Lighting layout. Counseling Conf Room C302.4 and Re-direct Classroom C201: Added Fixture type F08A at exterior soffit. Attachments: A-593, EL-102c, EL-101d, and EL 103c.	\$10,000.00		\$10,000.00			\$0.00	PR #063 issued on 03/28/2019.	SCCI
#TBD	PR #064	PJK	PR #064 - Added vent riser in Main Kitchen as a result of RFI #289	\$2,000.00		\$2,000.00			\$0.00	PR #064 issued on 1/9/19, SCCI to submit pricing	SCCI
#TBD	PR #069	Lighthouse	Revisions to glazing types and interior partition types resulting from review of & coordination with the Phase 1, 1A, & 1B hollow metal frame shop drawings. Attachments: A101a, A104a, A414, A417, A602, A612	\$5,000.00		\$5,000.00			\$0.00	PR #069 was issued on 02/20/19, SCCI to submit costs	SCCI
#TBD	PR #070	V&G Iron	Added guard rail adjacent to the NWFC entrance, Part A. Attachments: C-614, C-615.	\$7,500.00		\$7,500.00			\$0.00	PR #070 was issued on 02/26/19, SCCI to submit costs	SCCI
#TBD	PR #076	Millwork One	Lowering and simplification of millwork ceiling over the bakery counter in Culinary Arts Restaurant A236, as a result o RFI-330. The height of the millwork shelving below the affected millwork ceiling has also been reduced. Attachment: A-572	(\$5,000.00)		(\$5,000.00)			\$0.00	PR #076 issued on 2/20/19. SCCI to submit costs	SCCI
#TBD	PR #079	PJ Kennedy	Elimination of the temporary air compressors and associated appurtenances for the existing Machine Technology and Metal Fabrication shop equipment on the Lower Level. CM stated the existing central air compressors and lines servicing these two shop spaces are to be maintained until the beginning of Summer 2019.	(\$5,000.00)		(\$5,000.00)			\$0.00	PR #079 issued on 05/10/19. SCCI to submit costs	SCCI
#TBD	PR #080	Dow Company	Rain water harvesting system revisions as a result of the shop drawing submittal review including changes to pump station, filter structure, associated inverts, and electrical provisions. Attachments C-131, 232	\$20,000.00		\$20,000.00			\$0.00	PR #080 issued on 03/19/2019. SCCI to submit costs.	SCCI
#TBD	PR #082	A&A	Replacement of insulated glazing units with insulated aluminum spandrel panels at top of CW21 in Part B as a result of RFI #362 response. Attachment A-204	(\$2,500.00)		(\$2,500.00)			\$0.00	PR #082 issued on 03/28/2019. SCCI to submit costs.	SCCI
#TBD	PR #084	Lighthouse/Sweeney	Revisions along grid line 6, Part D, Level 1: CMU wall removal, adjustment to EPA-1B structure and modification of a detail under the Lecture hall exterior stair as a result of rebar shop drawing process. Attachment: A-004, A-101d, A-322, A-455, A-519	\$2,500.00		\$2,500.00			\$0.00	PR #084 issued on 04/04/2019. SCCI to submit costs.	SCCI
#TBD	PR #089	JDC Demo	Phase 1A, Part B, Lower Level existing under slab piping and fixtures removal revised to keep the piping in place and avoid added scope to demolish slab not shown on contract documents. The fixtures will be removed and pipes filled with concrete, patching required at these locations. (RFI #385 response). Attachment: PD-019	(\$10,000.00)		(\$10,000.00)			\$0.00	PR #089 issued on 04/10/2019. SCCI to submit costs.	SCCI
#TBD	PR #095	Sweeney, Homer, Lighthouse	Finish Schedule revisions for MF/MT Office B031.5: "wall finish" revised from block wall to painted gwb and wall base revised from epoxy base to rubber base. (partition types do not change). Attachment: A-707	\$0.00		\$0.00			\$0.00	PR #095 issued on 04/04/2019. SCCI to submit costs	SCCI
#TBD	PR #098, RFI #413	Grasseschi	Raised inverts of traps to comply with code requirements which resulted in added beam penetrations and added cold water riser to serve trap primers moved to higher locations (RFI #413 response) Part A, 4th floor.	\$7,500.00		\$7,500.00			\$0.00	PR #098 was issued on 04/08/2019. SCCI to submit costs.	SCCI
#TBD	PR #099	Walker Specialties	Provide a credit proposal for omission of the climbing wall located in the Dining Commons as well as the associated spot lighting including infill finishes, materials, and lighting where the climbing wall was previously located. Attachments: A-101a, A-102a, A-252, A-573, A-574, AR-102a, EL-102a	N.A		N/A				PR #099 issued on 04/17/2019. SCCI to submit costs	SCCI

PMA Construction Change Authorization Log

Key:				Approved	Under Review	Rejected	Pending				
#TBD	PR #100	Grasseschi	Removal of approx. 50 feet of sanitary piping, FYE connector and floor clean out as a result of RFI #457.	(\$5,000.00)		(\$5,000.00)			\$0.00	PR #100 issued on 05/14/2019.	SCCI
#TBD	PR #102	V&G Iron, Lighthouse, Beauce Atlas	Revisions to Lower Level part D in the loading dock associated with the grid lines 1, K, and 2 foundation walls. This includes one concrete stair and metal handrails being changed to a metal ladder, the removal of two CMU chase walls and revisions to the brick shelf dimensions in the area, (refer to CCD #005 for structural revisions). Attachments: A-020d, A-100d, A-424, A-503, AR100d.	(\$5,000.00)		(\$5,000.00)			\$0.00	PR #102 issued on 04/12/2019. SCCI to submit costs.	SCCI
#TBD		Beauce Atlas	Steel Beam Damaged Paint due to extended period of storage	\$40,000.00		\$40,000.00			\$0.00	SCCI notified team of potential issue on 05/14/19.	SCCI
#TBD	Ongoing	SCCI	GMP Overrun funded from Owner Contingency (PENDING COST: 06/13 GMP \$204,783,416) - (PS&B Construction Budget + Modular Swing Space + Precon \$202,287,908))	\$2,829,725.00		\$2,495,508.00			(\$334,217.00)	Number updated as of 06/12/2019.	PRE-GMP
#TBD	Ongoing	SCCI	Schedule extension impact costs due to unforeseen site conditions / soil characterizations (PENDING COST: uncertified- \$7,268,511 - \$326,595.57 which is Dow inefficiency PCOs 49, 61, 86, 111, 125 and - WJGEI verbal reduction of \$718K))	\$7,271,947.15		\$6,223,915.43			(\$1,048,031.72)	See email from Dennis Garriepy on 10/12/18. Costs associated with 03/01 GMP. 04/04/2019- Number was updated per latest discussions. 06/13/19- Number updated from latest schedule impact pricing discussions with SCCI.	PRE-GMP
#TBD	PR #045	SCCI	GLX Coordination: Upsize crane / OH prot at 1986 Wing (uncertified)	\$257,641.00		\$0.00			(\$257,641.00)	Costs associated with 03/01 GMP. 04/04/19- Upsized crane now deemed to believe not required from coordination with GLX.	PRE-GMP
#TBD	Ongoing	City	Builder's Risk Insurance	\$166,674.00		\$166,674.00			\$0.00	City buying out builder's risk, cost being tracked here to factor into total exposure.	PRE-GMP
#TBD	Ongoing	SCCI	VE Yet to be factored into GMP numbers.	(\$943,830.00)		(\$943,830.00)			\$0.00	VE to be factored into GMP as team progress through buyouts and PRs. UPDATED as of 06/12/2019	PRE-GMP
#TBD	Ongoing	SMMA	FF&E Equipment Overage	\$1,034,581.90		\$1,034,581.90			\$0.00	FF&E Equipment Budget Overrun from SMMA Compilation	PRE-GMP
#TBD	Ongoing	City	Upgrades to Gym Finishes	\$83,926.00		\$83,926.00			\$0.00	Upgrades to Gym Finishes	PRE-GMP