

Somerville High School Building Committee Info Session Notes

PROJECT: Somerville HS Project

MEETING DATE: May 20, 2019

LOCATION: Modular Trailer Complex, 81 Highland

ATTENDEES: (*Absent in Italics*)

- | | | | |
|------------------------|--|---|--|
| <u>Bldg. Cmte:</u> | <input type="checkbox"/> Mayor Curtatone (<i>JC</i>) | <input type="checkbox"/> Tony Pierantozzi (TP) | <input type="checkbox"/> Tony Ciccariello (TC) |
| | <input type="checkbox"/> Rich Raiche (RR) | <input type="checkbox"/> Mary Skipper (MS) | <input type="checkbox"/> Stan Koty (<i>SK</i>) |
| | <input type="checkbox"/> Max Nadeau (MN) | <input type="checkbox"/> Ed Bean (EB) | <input type="checkbox"/> Alumdene Abeyta (<i>AA</i>) |
| | <input type="checkbox"/> Tom Bent (TB) | <input type="checkbox"/> Adda Santos(<i>AS</i>) | <input type="checkbox"/> Mary-Jo Rossetti (MJR) |
| | <input type="checkbox"/> Leo DeSimone (LD) | <input type="checkbox"/> Sebastian LaGambina (SL) | <input type="checkbox"/> Laura Pitone (LP) |
| | <input type="checkbox"/> Carlos Contreras | | |
| <u>PMA:</u> | <input type="checkbox"/> Anthony Lopresti | <input type="checkbox"/> Chad Crittenden | <input type="checkbox"/> Sean Burke |
| <u>SMMA:</u> | <input type="checkbox"/> Alex Pitkin | <input type="checkbox"/> Lorraine Finnegan | <input type="checkbox"/> Matt Rice |
| | <input type="checkbox"/> Tony Iacovino | <input type="checkbox"/> Peter Lukaic | <input type="checkbox"/> Dave Fanuele |
| <u>Suffolk (SCCI):</u> | <input type="checkbox"/> Denis Garriepy | | |
| <u>Others:</u> | <input type="checkbox"/> SEE ATTACHED SIGN-IN SHEET | | |

Meeting called to order by Chair Tony Pierantozzi at 4:38 PM.

Motion to approve minutes of the April 29, 2019 meeting **M:RR S:MS D:None V:9-0-1**

General

Item	Responsible	Due	Notes
9/09:01	SBC		General Update: TP:
9/09:01	SBC		Design Update: SMMA: FF&E bids are closed. 89 bids across 8 different categories. SMMA is reviewing to find the most responsible and responsive bidder. We are tracking the tariff issue which may increase our cost. TC: Will the design team consult with staff to review any alternates presented as part of the FF&E? SMMA: If there are specific items that would provide significant cost savings we would review them with the staff. We would focus on big ticket items, there are too many items (1000s) to review all of them with the staff.
	SCCI		Construction Update : with schedule

Cost / Schedule

Item	Responsible	Due	Notes
09:11	PMA		<p>Schedule – TP: Steel has arrived for the gym roof; trusses and steels decks. Phase 1: We are past the window for winter break move in. We are investigating phase occupancy, with attention to the CTE programs and getting them in the building early. The building was always planned to be a phased occupancy. We are now looking moving phase one occupancy from December to Jan 2020. The temp provisions will be presented by SCCI.</p> <p>The plan must be accepted by ISD and DESE before we open.</p> <p>MS: Commented that the district should bid transportation for the year. TP: agreed, and noted that an escape clause should be included. TB: Asked if December guaranteed? Noted that he was hearing June. SCCI: we are still on track for December. TB: When is C of O scheduled for? SCCI: Temporary CofO Late December to support a Jan 1 move in.</p>

			<p>LP: Are we limited on how many people can come through the building? SCCI: All stairs as designed will be open. TB: Once the new phase one is open, will the students still have to walk outside? PMA: Yes, this is the way the project was originally planned. MJR: Asked if the elevator will still go up? SCCI: The elevator can be locked out and allow access only to occupied floors.</p> <p>TP: We will continue to investigate contingency plans in case the building doesn't open. TB: Automotive seems to be the biggest issue. We might need to talk with Herb chambers about extending the use of their space.</p> <p>SCCI: Noting is 100% certain but nothing is indicating that we can't do this. There is some risk, namely weather. End of steel is currently scheduled for August, weather tight is October 5. We have some GLX impacts getting things into the site.</p>
2/15:01	TC		<p>School/Community Interactions : MJR: Ongoing discussions with DESE have been reported, how are the going? LD: Talks are going well. DESE will come in and review in August to inspect the new spaces. TB: When are the DESI inspection of the new spaces? TB: They will have one preliminary inspection and a final inspection after CO. SMMA: DESE will come through at 60% inspection. We will use VR goggles to help them walk through the space. MS: We have been working with DESI through the design process. They have been receptive to our plans; as long as we keep them informed of our progress we should be ok.</p> <p>MS: Communications to parents will be sent out next week. LD&SL will offer an open house.</p> <p>MRJ: Heard a complaint that work was starting at 6AM, very noisy. RR: GLX starts at 6:30AM, we start at 7AM. TP: Workers may be showing up prior to 7AM. TB: has seen loaders driving down the street, but those might be GLX. DG: Wide loads are required to be moved off hours. Another typical complaint is backup alarms, we can't shut those off per OSHA regulations.</p> <p>TB: Asked if we could use cobble hill for subcontractor parking. MS: No, the agreement is for school staff use only.</p>
3/26:02	ALL		<p>GLX: RR: We jointly closed Medford street behind the high school, the closure will continue for several months. We continue to meet and coordinate our projects.</p>
10/22:1			<p>GMP Discussion: MJR: noted that per the cash flow, we appear to be doing better than planned. PMA: we have not spend as much money as planned because the schedule is behind. We will re-baseline the cashflow.</p> <p>SCCI: We have reconciled cost of some of the open items. The largest open item is the schedule delay claim. Steel cost is coming this week. The concrete contractor has hired a claims consultant to review their claim. This should help filter out some items from their claim. Electrical cost reconciliation meeting is next week; Plumbing, HVAC, façade tomorrow. MJR: Will we be able to review the claims analysis at the June meeting? SCCI: We will have some more information in June. We should have some of the subcontractors squared away. Hoping for site, concrete, electrical, possibly steel. We will provide an update of where we are at the June meeting. TP: Commended the work SCCI is doing to help reduce the schedule impact cost and thanked them for their efforts.</p>
3/28:01			<p>Change Orders/Budget: TP: Our change order total has increase by \$240K, \$200K for gym equipment, \$40K for steel priming. TB: Commented on the</p>

			<p>large amount of change orders and asked who is reviewing them. PMA: SCCI first review and vets the change order. PMA and SMMA then review and approve or provide comments back to SCCI.</p> <p>TB: Reviewed the contaminated soils PCO value. Of the \$2.24MM budget we have set aside for contaminated soils, we have spent \$1.64MM.</p>
2/15/03	ALL		Public Comment: None
			<p>Upcoming Meetings : ALL meetings at 4:30PM unless otherwise noted</p> <p>06/17 – HS Mods</p> <p>07/15 – HS Mods</p> <p>08/12 – HS Mods</p>

Meeting Adjourned: Motion to Adjourn **M:RR S:LP V: 11-0-1 PASS 6:00 PM**

The author of these minutes assumes, to the best of his or her knowledge, that the above content of these Meeting Minutes depict all that transpired during this Project meeting. All attendees are required to address by memo or via e-mail, any omissions, errors or inconsistencies in the reporting of these Meeting Minutes, to the writer, within two (2) business days of receipt of these Meeting Minutes.

Prepared By: Sean Burke, PMA Consultants

Signed: Sean Burke

Date: 06/03/19;

Somerville HS School Building Committee Agenda

Monday, May 20, 2019 - 4:30 P.M.

Location : 81 Highland Ave, Somerville MA

The meeting will be held in the Somerville High School Modular Trailers located in front of the High School Main Entrance

	Estimated Time Frame
I. Chair Tony Pierantozzi Call to Order	4:30 P.M.
II. 04-29-19 Meeting Minutes Discussion Motion and Second Needed Vote to Approve	4:35 P.M.
III. Overview of Meeting Agenda Tony Pierantozzi – SBC Chair	4:40 P.M.
IV. Old Business a. Construction Update i. Schedule Update ii. Phase 1 Occupancy Plan iii. GLX Coordination b. Community Update i. School Interaction Update c. Design Update i. FF&E Update	4:45 P.M.
V. GMP Update a. GMP Update b. Update on Delay Claim Process	5:00 P.M.
VI. New Business a. New Business (TBD) b. Change Orders c. Any unanticipated items	5:45 P.M.
VII. Public Comment Period	6:00 P.M.

Authorized Person: Rich Raiche, Capital Projects

Somerville High School Building Committee Info Session Notes

PROJECT: Somerville HS Project
LOCATION: Modular Trailer Complex, 81 Highland

MEETING DATE: April 29, 2019

ATTENDEES: (*Absent in Italics*)

-
- Bldg. Cmte:** *Mayor Curtatone (JC)* Tony Pierantozzi (TP) Tony Ciccariello (TC)
 Rich Raiche (RR) *Mary Skipper (MS)* *Stan Koty (SK)*
 Max Nadeau (MN) Ed Bean (EB) *Alumdena Abeyta (AA)*
 Tom Bent (TB) *Adda Santos(AS)* Mary-Jo Rossetti (MJR)
 Leo DeSimone (LD) Sebastian LaGambina (SL) Laura Pitone (LP)
 Carlos Contreras
- PMA:** Anthony Lopresti Chad Crittenden Sean Burke
SMMA: Alex Pitkin *Lorraine Finnegan* Matt Rice *Dave Fanuele*
 Tony Iacovino *Peter Lukaic*
- Suffolk (SCCI):** Denis Garriepy
Others: SEE ATTACHED SIGN-IN SHEET

Meeting called to order by Chair Tony Pierantozzi at 4:30 PM.

Motion to approve minutes of the April 08, 2019 meeting **M:RR S:SL D:None V:9-0-1**

General

Item	Responsible	Due	Notes
9/09:01	SBC		General Update: TP: Tony asked the committee to take the agenda out of order in order to move design update and change orders to the beginning of the meeting. No Objections.
9/09:01	SBC		Design Update: Gym Floor – The committee reviewed a memo about the gym floor. The cost for the original floor is \$309,890, the cost for the new floor is estimated to be \$511,000. The track layout is unchanged. The original material selected for the track gave the track teacher concerns. The new layout has a wood parquet floor in the center of the gym with a poured rubber floor around. It is similar to the floor at Swampscott High School and the Reggie Lewis Center. Nicole Viele: reviewed installations of the original floor design, neither school they looked at used that floor for competition. TP: Did not feel the original design was not a good choice for a running track. TB: asked why this is coming up now. We told everyone they had their last shot, now they are changing. Is MSBA paying for this? What is the maintenance? SMMA: The floor is a 50-75 year floor. Swampscott refinished their floor 10 years after the install. The poured floor has not been touched. TP: Asked if everyone is in agreement. Nicole Viele: Yes, there is agreement that this is the best layout for all sports in the gym. Motion: Add up to \$250K to pay for the flooring system as described M:EB S:RR D: TP: asked if there are other funding sources identified. SL: We will look into it V: 9-0-0
	SCCI		Construction Update - SCCI: The month of April has 20 days of rain, our current schedule shows making an December opening is a long shot. We can make it, second shift and weekend work are required. We are focusing on getting the CTE programs back on site in December rather than pushing to get the upper floors complete. We will focus on the first and second floor, getting a temp CO for those spaces and not spending money to open unnecessary areas. MJR: Is there a cost impact DG: This scenario would decrease some of the schedule pressure. It should not make the cost impact worse. LP: How

			<p>realistic is the schedule? Will students be in the building during construction? I have a feeling the schedule is highly ambitious, and we should talk about pushing the entire project to a February to take more pressure off the scheduled. SCCI: Students in the building during construction is not an issue, we do it all the time, normally in hospitals. We would need ISD signoff on all life safety prior to occupancy. TB: is concerned. 8 months to open the building does not seem doable. SCCI was chosen because the cut a year off the schedule. TB toured the temp spaces, they are not an ideal learning environment. A lot of kids are at SHS because of the CTE program. How does this effect other programs? LP: Lower levels opening would be the biggest help. TB: If the building isn't ready, how much notice will we have? TP: Asked that PMA/SMMA/SCCI to review schedule and respond if it is achievable. TB: Stacking of all trades will be an issue. I don't like pushing the February, but it looks like it is the best option. MJR: Wants to make sure the superintendent id kept in the loop. LD: Has been keeping the Superintendent informed. SL: The CTE programs are the priority as they are the hardest spaces to displace temporarily. We also need to focus on reopening the gym. LP: Appreciates TB's advocacy for the for the students would suggest a contingency period on the school side for not moving into the building in December, be prepared just in case. LD: If we can get the shops back into the building, it would be a huge help. We are planning on having most of the shops out of the building for a year except for Automotive and Carpentry. There is also a cost component that needs to be reviewed.</p>
--	--	--	--

Cost / Schedule

Item	Responsible	Due	Notes
09:11	PMA		Schedule – We will review in detail the phasing schedule at the May 20 th meeting.
2/15:01	TC		School Interactions : No issues with student/worker interaction. MJR: Parking is still an issue. PMA: Issued a memo to SCCI . PMA/SCCI will provide a parking exclusion zone. PMA asked SCCI to put together a program to deter parking on or near the site. SCCI: suggested a series of increasing fines to deter parking around the site. TB: Asked if the Cobble Hill lot is open. Jeff Curley: yes, teachers only parking, there is a shuttle service in place. TP: Asked if the contractors are using the temple street lot. SCCI: yes
3/26:02	ALL		GLX: RR: We continue to coordinate work. The latest Medford street bridge closure, we are planning on a one lane reduction starting May 1, and shutting down the bridge on May 17 th .
10/22:1			GMP Discussion: SCCI: has reviewed the first round of responses to the subs. \$6.7-7.5MM is the current exposure. We are expecting revised costs back now, Site and Steel this week, Concrete- May 6. This cost is the final step in finalizing and signing the GMP. Late June is the target for an executable GMP. We have \$180MM under contract and are operating in a GMP capacity. TB: Any issues with the MSBA? PMA: They are interested in us signing a GMP. The project is better off holding off until the costs are closer to final.
3/28:01			Change Orders/Budget: TP: We currently have hard cost contingency of \$637,577, last meeting we had -\$173,530 so we are moving in the right direction. We provided \$811k in cost avoidance, we need \$8MM. TB: is there concern over the amount of change orders. PMA: Yes, but we need to note that of the \$12.1MM in contingency usage, \$4MM +/- was for bid overruns, \$7.2MM is for schedule delay claim. TB: The Change order report is becoming voluminous. PMA to look into alternative reporting methods.

			SMMA: We found a plaster cast in the band room. That space used to be part of the gym/auditorium and the cast was located above the stage. The cast would cost \$12,000 to replicate.
2/15:03	ALL		Public Comment: RR: We currently have a large excavation at Union square. If anyone would like a tour RR would be happy to arrange.
			Upcoming Meetings : ALL meetings at 4:30PM unless otherwise noted 05/20 – HS Mods 06/17 – HS Mods 07/15 – HS Mods 08/12 – HS Mods

Meeting Adjourned: Motion to Adjourn **M:RR S:TB V: 08-0-0 PASS** 6:20 PM

The author of these minutes assumes, to the best of his or her knowledge, that the above content of these Meeting Minutes depict all that transpired during this Project meeting. All attendees are required to address by memo or via e-mail, any omissions, errors or inconsistencies in the reporting of these Meeting Minutes, to the writer, within two (2) business days of receipt of these Meeting Minutes.

Prepared By: Sean Burke, PMA Consultants

Signed: Sean Burke

Date: 05/10/19;





Somerville High School Building Committee

Meeting Sign in Sheet

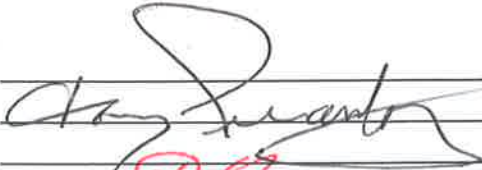
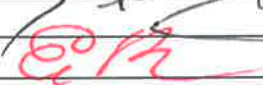
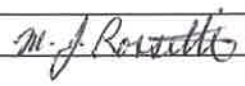

PROJECT: Somerville HS
LOCATION: Somerville HS
MEETING DATE: April 29, 2019

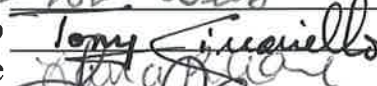
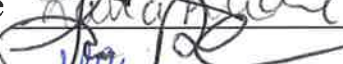
Building Committee

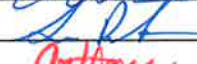

Signature

Mayor J. Curtatone _____
Chair T. Pierantozzi  _____
Adda Santos _____
Ed Bean  _____
Mary Skipper _____
Mary-Jo Rossetti  _____
Max Nadeau _____
Richard Raiche  _____
Stan Koty _____
Tom Bent  _____
Tony Ciccarriello  _____
Laura Pitone  _____
Leo DeSimone  _____
Sebastian Lagambina  _____
Almudena Abeyta _____
Carlos Contreras _____



OPM: PMA Consultants

Chris Carroll _____
Chad Crittenden  _____
Sean Burke  _____
Anthony Lopresti  _____



Architect: SMMA

Alex Pitkin  _____
Lorraine Finnegan _____
Matt Rice  _____
Erin Prestileo _____

CM: Suffolk

Chris Walenten  _____
Doreen Crowley  _____
Denis Garriepy  _____

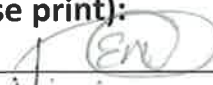
Guests (please print):

Ed Nuzzo  _____  _____
Natalie Vieira _____
Nicole Viee  _____

Temporary Certificate of Occupancy (Phased Occupancy) Planning

1. The project always included some Phased Occupancy scenarios (base plan)
2. The current Phased Occupancy planning is ONLY for Phase 1 (all other phases remain unchanged from base plan) and allows for access to:
 - **Lower Level CTE areas**
 - **Gymnasium**
3. Phased Occupancy period: *late December 2019 through February Break 2020*
4. Phased Occupancy was reviewed with Inspectional Services Dept. (ISD) and the Somerville Fire Department (authorities having jurisdiction), as well as with SMMA, and PMA Consultants.
5. **Required** for Temporary Certificate of Occupancy:
 - *Completion of all life safety systems (fire alarm, sprinklers)*
 - *Completion of all required egress paths / EXITS*
 - *Testing and inspection of the above*
 - *Sign off by SMMA (architects of record), and ISD / SFD*

Temporary Certificate of Occupancy (Phased Occupancy) Planning

Risk Factors

- ***Weather impacts to productivity (example: rain / steel erection)***

- * *This becomes a diminishing risk as the building becomes enclosed*

- ***Site Access / Material Deliveries impacted by GLX Constructors***

- * *There is a weekly / daily coordination effort (including the City, PMA, SMMA) underway for the past month to mitigate this risk.*

Proposed Temporary Certificate of Occupancy

December 2019

May 14, 2019

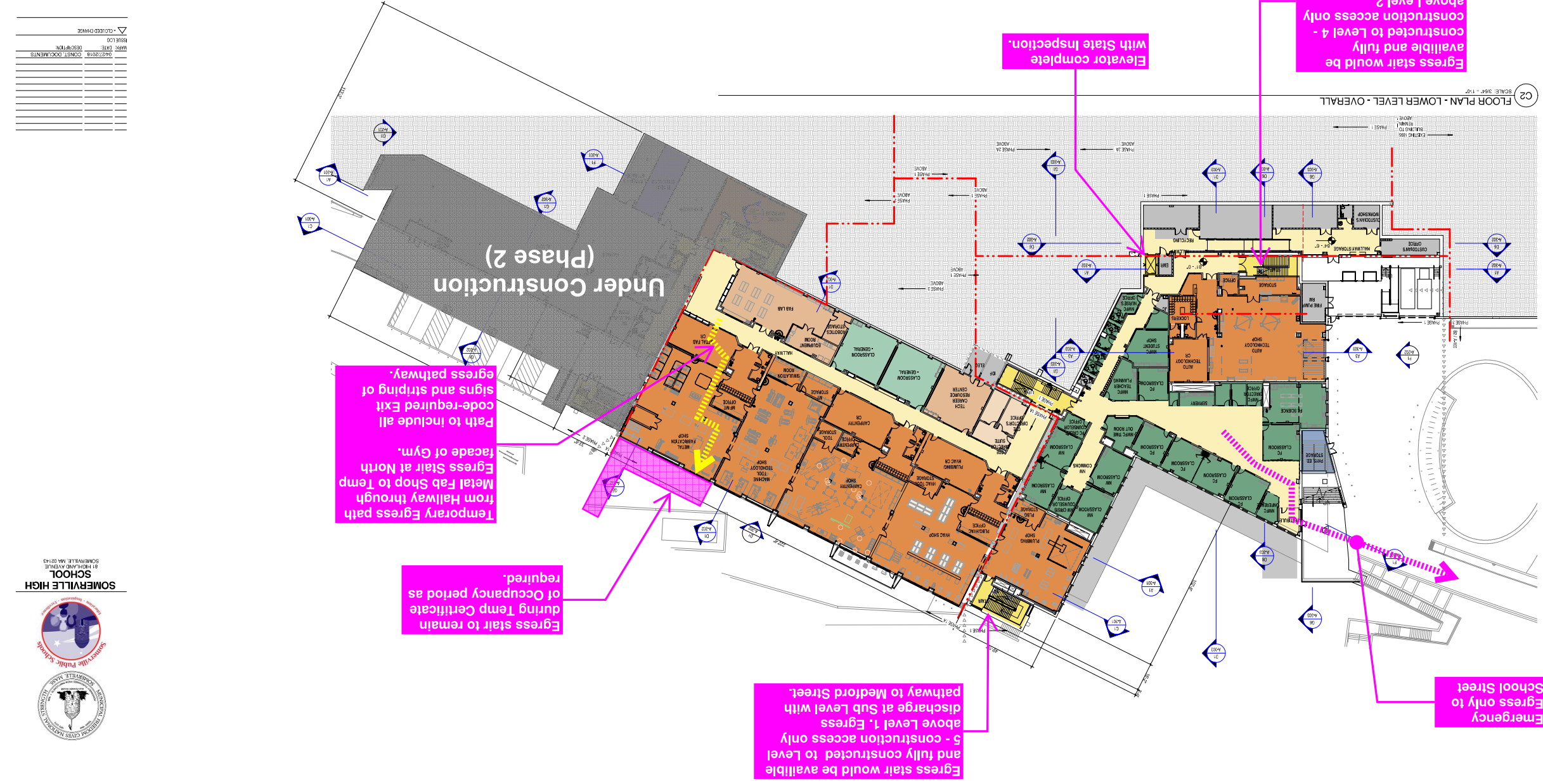

KEY PLAN

GROSS FLOOR AREA - LOWER LEVEL

PHASE 1	31,000 SF
PHASE 2	45,000 SF
TOTAL	76,000 SF

GROSS FLOOR AREA - SUB LEVEL

PHASE 1	10,000 SF
PHASE 2	15,000 SF
TOTAL	25,000 SF

FLOOR PLAN - LOWER LEVEL - OVERALL

DATE	05/14/19
SCALE	1/8" = 1'-0"
PROJECT	SOMERVILLE HIGH SCHOOL
OWNER	SOMERVILLE PUBLIC SCHOOLS
ARCHITECT	SYMES, BURN & MOORE ASSOCIATES, INC.

NO.	DATE	DESCRIPTION



Proposed Temporary Certificate of Occupancy December 2019

May 14, 2019

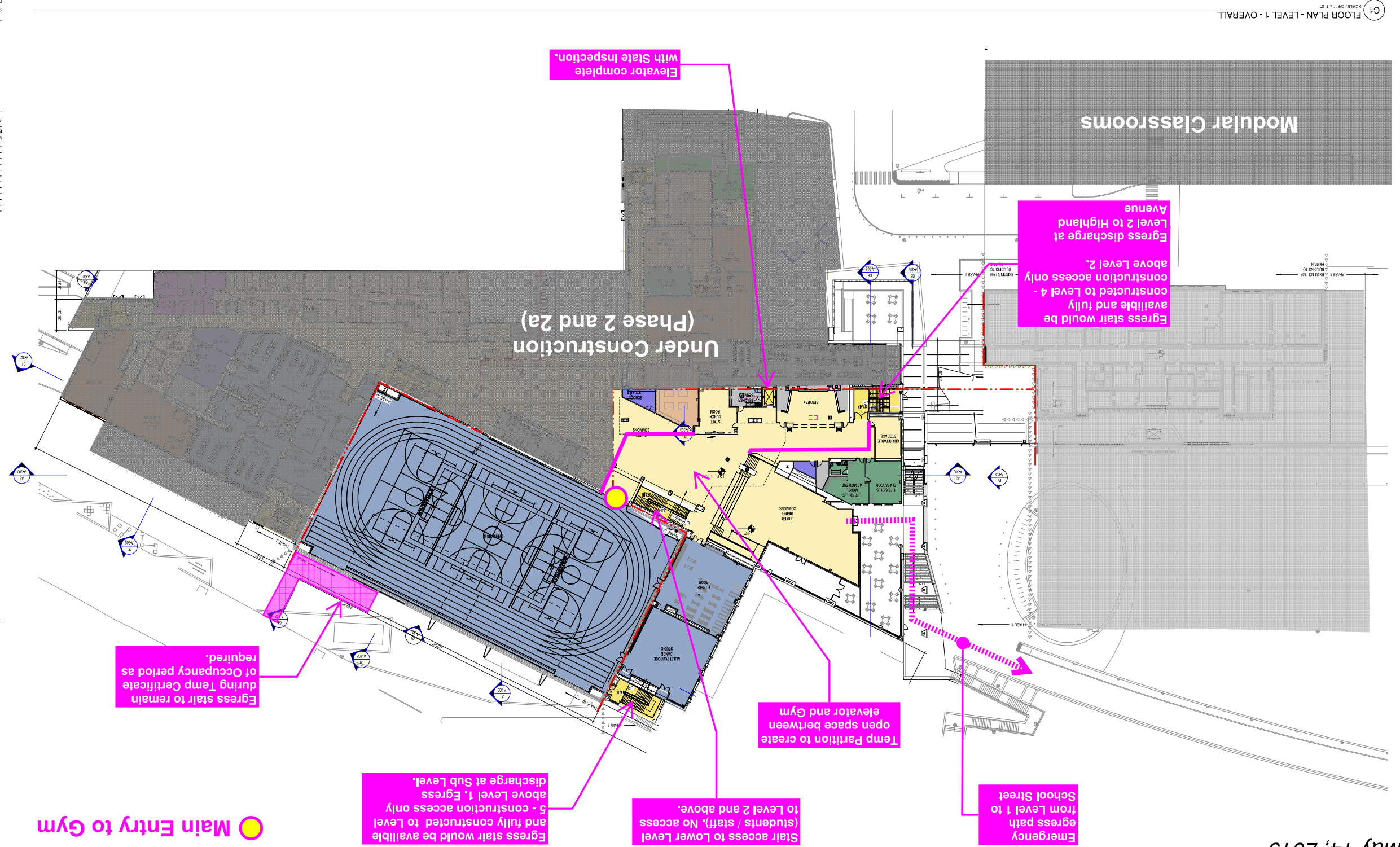

C1 FLOOR PLAN - LEVEL 1 - OVERALL
SCALE: 3/8" = 1'-0"

GROSS FLOOR AREA - LEVEL 1	
GROSS AREA TYPE	AREA
SOUTH - PHASE 1	
3/6/2019	38,228 SF
NORTH - PHASE 2	
3/6/2019	27,022 SF
WEST - PHASE 3	
3/6/2019	1,450 SF
TOTAL	
	66,700 SF

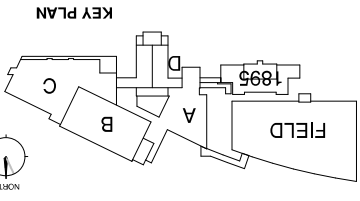

FLOOR PLAN - LEVEL 1 - OVERALL

SYMMES HAIN & MCKEE ASSOCIATES, INC. 2018
 SCALE: 3/8" = 1'-0"
 DATE: 05/14/19
 DRAWN BY: [Redacted]
 CHECKED BY: [Redacted]
 PROJECT: [Redacted]
 TITLE: [Redacted]
 JOB NO.: [Redacted]
 FLOOR PLAN - LEVEL 1 - OVERALL

NO.	DATE	DESCRIPTION



SYMMES HAIN & MCKEE ASSOCIATES
 1000 Massachusetts Avenue
 Cambridge, Massachusetts 02138
 P: 617.547.5400 F: 617.546.4920

Proposed Temporary Certificate of Occupancy December 2019

May 14, 2019

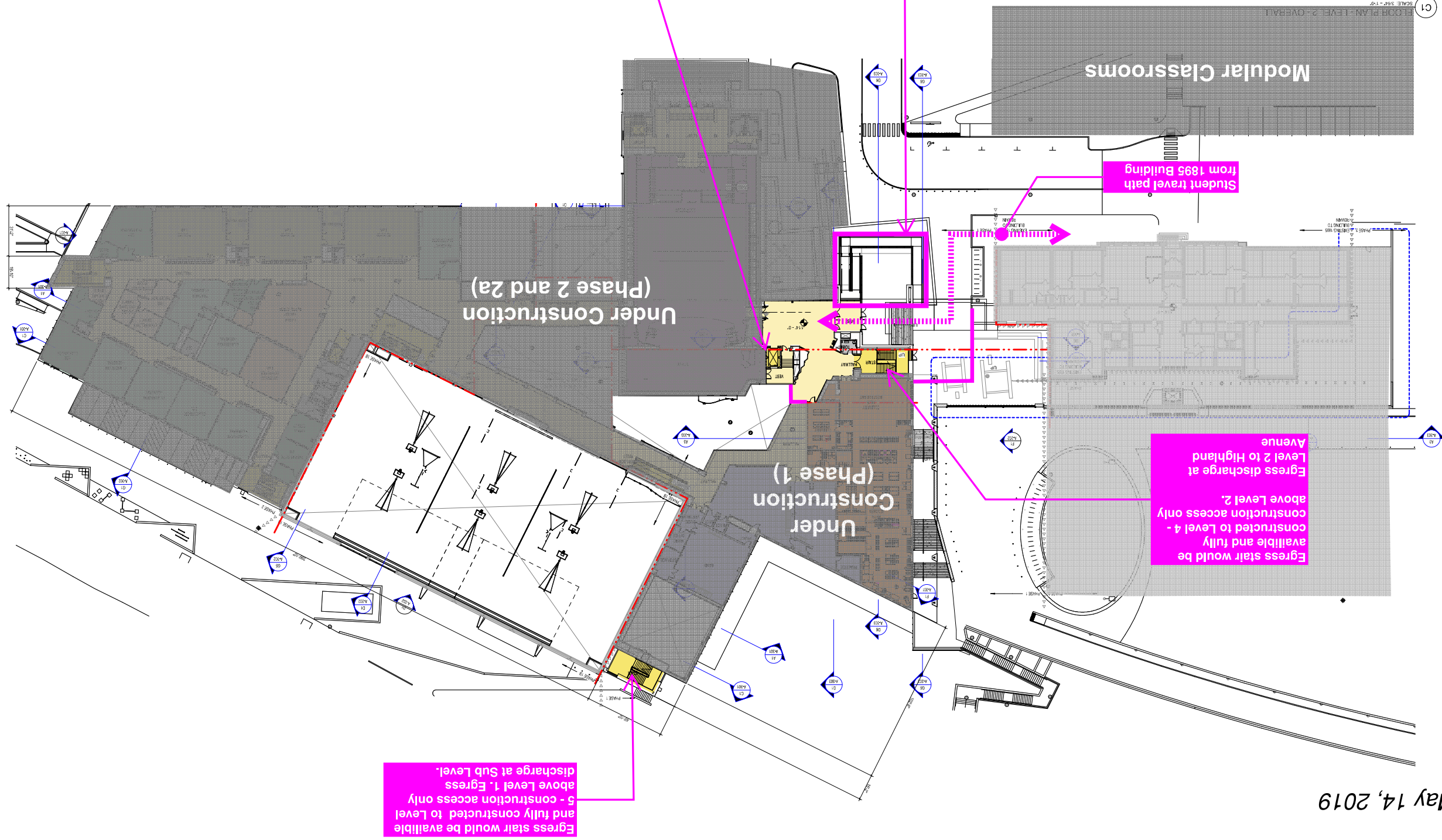

GROSS FLOOR AREA - LEVEL 2	
AREA	16,188 SQ. FT.
AREA - PHASE 1	16,188 SQ. FT.
AREA - PHASE 2	16,188 SQ. FT.
AREA - PHASE 2A	16,188 SQ. FT.

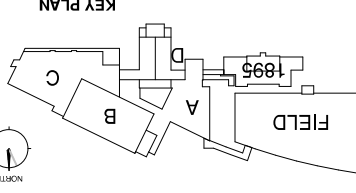

FLOOR PLAN - LEVEL 2
-OVERALL

DATE	DESCRIPTION

NO.	DATE	DESCRIPTION



**SOMERVILLE HIGH SCHOOL
CONTAMINATED SOILS UPDATE
5/20/2019 BUILDING COMMITTEE MEETING**

UPDATED NUMBERS AS OF 03/28/19			
Facility- Soil Type	Estimated (Tons)	Actual Trucked to Date	Percentage Gone
Group I-2/3 - 41% of total soils (basis: Saugus Facility unit rate)	44,431	43580.01	98.1%
Group II-1- 33% of total soils (basis: Coventry Facility unit rate)	35,761	19,360.06	54.1%
Group II-3/4- 7% of total soils (basis: ARC Facility unit rate)	7,586	4,891.14	64.5%
TOTAL Tons Trucked to Date	87,778	67,831.21	77.3%

Contaminated Soils Budget Spent to Date (03/28/19)	
Total Contaminated Export Cost to date	\$ 1,368,409.07
Total Budget for Contaminated Soils	\$ 2,249,000.00
TOTAL Budget Spent to Date	60.84%

PMA Construction Change Authorization Log

Key:

Approved	Rejected	Under Review	Pending
----------	----------	--------------	---------

GMP Value	\$12,764,470.00	Hard Cost:	\$11,095,603.00	Soft Costs:	\$1,672,199.00
GMP (ESTIMATED)	\$11,095,603.00		\$2,723,790.93		\$0.00
Total Exposure	\$12,366,240.34		\$8,371,812.07		\$1,672,199.00
Remaining	\$398,229.66				

PCO	Change Doc	Issued By/For	Description	Proposed Cost	Pending Cost	Owner Risk	Pending Cost	Owner Contingency	Approved Cost	Delta (Proposed-Approved)	PMA/SMM/MA Response & Notes	Ball in Court
Owner 1		Lan-Tei	Add Cameras to Modular Trailers	\$20,000.00				\$5,054.00				
Owner 2		SAS	Rerouting Security Panels	\$10,000.00				\$10,439.00				
#001		W/GEI	Coring & Support for Fiber Backbone for Modulares	\$13,573.36				\$13,573.36				
#002		W/GEI, J. Derenzo	Electrical Service Adds and Credits for Modulares	\$11,520.84				\$9,617.94				
#003		Triumph	Additional ramps, Added walls for SHIP classes and Teacher Planning, Added Disconnect	\$34,347.50					\$15,510.00	(\$18,837.50)		
#003A		Triumph	Additional Ramps	\$18,837.50				\$18,837.50				
#004		Capital Carpet	Furnish and Install 1500SF of Ecure rubber tiles	\$11,610.00				\$11,610.00				
#005		J. Derenzo	Additional Mobilization costs for fill and grading South Side of Modulares	\$3,200.00						(\$3,200.00)		
#006		J. Derenzo	Replacing handicap parking spaces and surrounding site repairs	\$29,020.00				\$29,020.00				
#007		J. Derenzo	Form, Reinforce, and Pour concrete for sidewalks for handicap parking spaces	\$10,343.00				\$10,343.00				
#008		J. Derenzo	Credit proposal for sand bedding under water line	(\$3,200.00)				(\$3,200.00)				
#009		J. Derenzo	Credit for telecom line backfill per XE-002	(\$9,500.00)				(\$9,500.00)				
#010		W/GEI	Additional grounding required by AHJ for the CT cabinet to be grounded water and fire mains	\$4,312.32				\$4,312.32				
#011	PR #002	JDC Demo	PR #02 - Salvaging of existing precast floor slab planks on level 1 of 1986 CTE wing, Adjusted floor trenching demolition, additional existing structured slab removal on level 2 Part D for HVAC shafts	\$18,087.42				\$18,087.42				
#012		Triumph	Added ceiling soffits for HEPA filters, Relocate T Stats, Relocate 6 EBU's, and Computer car t charging stations	\$9,580.74					\$9,124.51	(\$456.23)		
#013		JDC Demo	Remove and Salvage the BAS relief Panels in advance of demolition of C wing buildings	\$32,824.10				\$26,456.35		(\$6,367.75)		
#014		JDC Demo	Remove and Abate unforeseen mastic on brick infills on C and D wing	\$62,288.46				\$59,322.34		(\$2,966.12)		
#015		Lighthouse	Costs to store historic masonry products	\$9,240.00						(\$9,240.00)		
#016	PR #001	Beauce Atlas	PR #1 - Changes from Early Steel to 100% Drawings	\$8,185.80				\$7,227.00		(\$958.80)		
#017	CCD #002	JDC Demo	Attachment: CDW report dated 8/7/18 the D wing between the ED line and the FD line and west facade of the B Wing. CCD-002 - Abatement of ACM at two areas on the B and D wings: east facade of	\$2,700.00				\$2,678.32		(\$21.68)		
#018		V&G Iron	Temporary Stair @ Gymnasium - additional credit required for what was carried in original bid docs	\$113,216.46				\$107,825.20		(\$5,391.26)		

PMA Construction Change Authorization Log

Key:

Approved	Rejected	Pending
----------	----------	---------

#019	J. Derenzo	PCO #019 - reconciliation pricing for the haul road scope along Medford Street.	\$217,487.00					PCO submitted on 9/11/18. PMA requested funding source 9/20. NO SCCI response. PMA response issued and rejected 11/29. SCCI to review internally with PMA prior to adjusting, additional detail is required for review 12/6/18. CC- needs to be resubmitted and broken out. SCCI reviewing today 12/13/2018. SCCI sent revision on 12/19/18. Removed striping and Hauling and will be sent as separate PCO. SMMA/PMA reviewing as of 12/20/18. 1/2/19 SMMA reissued comments to PMA to be discussed at meeting. 1/4/19 PMA Formal Rejection issued. 1/17/19- MEETING scheduled for 1/22 with PMA/SMMA/SCCI/J. Derenzo. 1/24/19 PMA sent email questioning the additional \$16/Ton for loam that appears to be previously paid for. 1/31/2019 Reconciled in PCO #05681.	VOID	PRE-GMP
#020	Marguerite	Concrete Footings for temporary stair SK TS-1 & SK TS-2	\$6,932.00	\$6,932.00				PCO executed on 10/9/18.	PRE-GMP	
#021	Beauce Atlas	Changes in design from Submittals and RFI's through Sequence 18.	\$77,294.00	\$43,370.55				PMA sent comments to SMMA on 10/23/2018. Awaiting response from SMMA. Per DF email 11/26 comments to be provided by EOW. SMMA provided comments on 11/30/18 and was forwarded to SCCI on 12/3/18. 12/13/2018 SCCI- out of office Beauce Atlas this week. Follow up next week. SCCI to send revised PCO & comments back for PL/SMMA to review and then schedule a meeting onsite for review. 1/3/19 PMA Comments issued, SCCI to respond. 1/17/19- SCCI resubmitted on 1/10. 1/31/2019 SMMA to provide comments by EOW. 2/7/2019 SMMA to have comments by Monday 2/11/2019. 2/14/19 SMMA to have comments by next meeting. 2/21/19- SMMA/SCCI to set up a phone call. 2/28- Phone call with SMMA, SCCI, and Beauce Atlas still needs to be scheduled. 03/07/19- Beauce Atlas coming to site next Wednesday, meeting tentatively @ 2:00 P.M. with SMMA/SCCI/BA to 03/13. 03/14/19- BA meeting with SMMA/SCCI/PMA yesterday 3/13. BA to provide back up on some costs, ball in court SCCI. 03/21/19- No change. B.I.C. SCCI. 3/28/19 - SCCI has received some revised proposals, will wait until they have all comments back and will send to team. 04/04/19- SCCI received information from BA, to issue response back to SMMA/PMA. 04/11/19- SCCI formal revision imminent. 04/18/19- SCCI issued revision on 04/11. SMMA sent comments back to PMA on 04/16. PMA to issue comments to SCCI today. 04/25/19- PMA issued comments to SCCI, SCCI responded with reason for increase on one of the COR (Labor cost was forgotten at first), B.I.C SMMA for review. 05/02/19- No change. B.I.C SMMA SCCI sent PCO on 9/21/18. PMA responded on 9/24/18. SCCI sent revised pricing on 9/24/18. PCO executed on 10/10/18 Not to Exceed Allowance. Final cost determined based on actual quantity and unit prices. Ben Carawan resubmitted R2 on 11/2/2018. PCO executed on 11/9/18. See email correspondence between PMA, SCCI, & FEI for information. Invoices include SIN063810, SIN063810, SIN06394, SIN062921. PCO executed on 11/14/18	PRE-GMP	
#022R2	JDC Demo	Additional costs to mobilize abatement crew to abate 50 LF of asbestos containing pipe insulation and abate 250 LF of subsurface transite pipe	\$11,000.00	\$5,575.00				PCO executed on 11/14/18	PRE-GMP	
#23R1	Fire Equipment Inc.	Fire Equipment Invoices for Summer Enabling work	\$23,249.19	\$23,249.19					PRE-GMP	
#23A	Fire Equipment Inc.	Fire Equipment Co.- Plug in Plug out Part 2	\$6,743.92	\$6,743.92					SCCI	
#024	K&K Acoustical	Temporary ceiling work completed on 8/14/18 and 8/25/18 and Temporary ceiling work completed on 8/20/18	\$17,633.90	\$16,794.19					PRE-GMP	
#025	P.J. Spillane	COR #501 - Waterproof electrical room (1/2). COR #502 - Waterproof electrical room (2/2). COR #503 - Located at the temp roof of the lower level CTE electric prevent water from leaking into the electrical room below	\$15,845.95	\$13,966.46					PRE-GMP	
#026R2	JDC Demo	JDC Demo COR #05.4 - Non-traditional abatement of unforeseen asbestos tunnel and insulation (NTWP). Lump sum portion.	\$258,827.10	\$113,361.99					PRE-GMP	

PMA Construction Change Authorization Log

Key: Approved Under Review Rejected Pending

Item ID	Location	Description	Original Estimate	Revised Estimate	Change Amount	Status	Comments
#026R2A	N/A	JDC Demo			\$0.00	Approved	PMA added to PCO log on 11/14/2018 to reconcile with SCCI log. SCCI to submit PCO. SCCI submitted initial pricing on 11/13/18. PMA sent initial comments back on 11/14/18. SCCI sent revised PCO back on 11/23/18 and requested a meeting. Following meeting on 11/26/18 between SCCI/PMA/JDC Demo slips are to be provided daily. PMA bootleg comments issued to SMMMA on 11/27, SMMMA returned comments on PMA/SCCI/SMMMA/JDC on 12/3/18 costs for work completed to date were negotiated and work yet to occur was determined to be split into second (268) for tracking. 12/13/2018- SCCI to provide signed copy. 1/17/19 T&M (768) for tracking. 12/13/2018- SCCI to provide signed copy. 1/17/19 T&M still being tracked, SCCI to issue PCO once work is complete. 1/31/2019 SCCI noted JDC wants to wait to submit final costs. 2/14/19 SCCI to submit costs once slips are received. 2/21/19 - Once SCCI gets price will issue PCO. 2/28/19 NO change from previous week. 03/07/19- SCCI to follow up with JDC, JDC possibly waiting on WMTREE load counts, PMA/SMMMA can review T/M costs separate in advance if needed. 03/14/19- JDC sent pricing to SCCI, SCCI vetting and then will forward over to PMA/SMMMA. 03/21/19- No change, B.I.C. SCCI. 04/18/19- No change B.I.C. SCCI. 04/25/19- PCO WAS CAPTURED
#027	Field Condition	JDC Demo	\$14,450.00	\$5,850.47	(\$8,599.53)	Approved	Latent condition - Mobilization and Excavation. SCCI to review/resubmit reconciled for linear footage. PMA sent comments back to SCCI on 11/14/18. Work proceeding T&M, actuals to be reconciled. SCCI to resubmit (12/6/18). SCCI resubmitted PCO on 12/7. PMA/SMMMA to review/confirm pricing 12/13/2018- SCCI to provide signed copy.
#028	Field Condition	JDC Demo	\$19,082.31	\$8,181.05	(\$3,559.00)	Approved	PMA added to PCO log on 11/14/2018 to reconcile with SCCI log. SCCI submitted PCO on 11/15/18. PMA returned comments to SCCI on 11/21/18. 12/20/2018- SCCI still reviewing and chasing. 1/15/19 SCCI resubmitted same comments. 1/17/19- SCCI issued revised PCO on 1/15. 1/31/2019 PMA/SMMMA comments sent. 2/7/2019 SCCI to review with JDC Demo and respond to electrical utilities
#029R2	N/A	Simplex	\$3,995.47	\$2,875.37	(\$1,120.10)	Approved	PMA added to PCO log on 11/14/2018 to reconcile with SCCI log. SCCI to submit PCO. SCCI submitted PCO on 11/20/18. PMA returned comments to SCCI on 11/21/18. SCCI to review and resubmit. SCCI resubmitted PCO on 12/10 with revised / lowered hours and attached rates. PMA/SMMMA to review new cost. 5B comments revised, should be good to go. SCCI adjusting for contingency draw 12/20/18 and rates are acceptable. All backup to be included. 1/3/19 SCCI revising and resubmitting for CM contingency. 1/7/19 #029R2 submitted by SCCI
#030	N/A	Dow	\$286,703.00	\$286,703.00	\$0.00	Approved	resubmitted with comments on 11/21/18. SCCI returned additional slips missing from original on 11/26/18. Awaiting CDW confirmation of soil classification. CDW provided response on 11/29/18. Routing. PMA forwarded signed cover sheet on 12/6 to Ben/Jake from Suffolk.
#031	N/A	P.J. Kennedy	\$2,889.82	\$2,025.11	(\$91.94)	Approved	Need city signature 11/29/18
#032		J. Derenzo	\$254,680.16	\$254,680.00	(\$0.16)	Approved	Soils Management Allowance. Rec'd 11/28, PMA reviewing. SMMMA found costs acceptable on 12/6/18. PMA checking tipping fees and will respond. 12/13/2018- SCCI provided unit rate back up. PCO executed on 12/13/18
#033	N/A	DOW	\$81,412.00	\$81,412.00	\$0.00	Approved	SCCI submitted PCO on 12/5/18. PMA reviewed slips and they match. Unit prices to be checked. 12/13/2018- PMA ready to sign PCO. SMMMA ball in court for possible CDW review. PCO executed on 12/13/18
#034	SCCI	SCCI	(\$35,213.92)	(\$35,213.92)	\$0.00	Approved	SCCI issued PCO on 04/30/19. 05/02/19- PMA/SMMMA to review. 05/09/19- No change, B.I.C. PMA/SMMMA. 05/16/19- PMA reviewing internally.
#035	PR #005	V&G Iron	\$3,865.99	\$3,865.99	\$0.00	Approved	SCCI submitted costs on 11/29/18. PMA/SMMMA provided comments on 11/30/18. 12/13/2018- issue with Dow moving OWLS to street for V&G. PCO on hold for now. 2/21/19- OWLS 18/23 have been removed, SCCI to review V/G costs associated with Dow slip. 2/28/19- SCCI to touch base with JA. 03/07/19- As of now no costs have been associated to this work, PCO is rejected. 04/11/19- SCCI received formal revision from V/G today, to submit. 04/18/19- PCO revision imminent from SCCI. 04/25/19- SCCI still to issue PCO revision, working with Dow/V&G. 05/02/19- NO change, B.I.C. SCCI to issue PCO for review. 05/16/19- No change, B.I.C. SCCI to submit PCO for review
#038	N/A	Lighthouse	\$84,093.06	\$78,190.64	(\$5,902.42)	Approved	SCCI submitted costs on 11/30/18. PMA provided comments to SCCI on 12/3/18. SCCI to provide breakdown of material. SCCI provided breakdown of costs on 12/7. PMA/SMMMA to review breakdown, Suffolk to reconcile \$200 when all comments are back. PMA sent follow up to SMMMA on 12/26. 12/19 SMMMA issued comments to PMA to be discussed at meeting. 1/3/19 PMA to review and issue comments. 1/3/19 SCCI to remove Fee Markup and resubmit. See DF email 1/2/19 regarding Beton potential ownership of some scope, need clarification from SMMMA. 1/9/19 SCCI issued revision removing Page 7 of 34

PMA Construction Change Authorization Log

Key: Approved Under Review Rejected Pending

#039	N/A	Lighthouse	Lighthouse PCO #006 - Remove existing door frame and infill with CMU at corridor CTA wing basement. Lighthouse PCO #007 - Fixing existing gym door back patio and infilling penetrations. Lighthouse PCO #008 - Demo, tooth, and page gym entrances for temp stair. Lighthouse PCO #009 - Repair stairs for egress at Building D (Library Steps). Lighthouse PCO #010 - Demo unsafe brick above arched windows that were removed for historical society	\$23,165.22			\$20,583.19	(\$2,582.03)	PRE-GMP	SCCI submitted PCO on 12/4/18. PMA/SMMA reviewed and responded to SCCI on 12/12 with comments on PCO for different items approved for CM contingency / rejected. SCCI to issue back revision/comments. 12/12/2018 PMA issued comments back to Suffolk. Suffolk to review. 12/13/2018- SCCI to address comments issued on 12/12/2018. 1/17/19- SCCI actively working with Lighthouse. 1/24/19 No Update. 1/31/2019 SCCI waiting on comments. 2/7/2019 SCCI reviewing. 2/21/19- SCCI still chassing Lighthouse. will follow up. 2/28/19- SCCI/Lighthouse to send revised PCO. 03/07/19- SCCI has missing slips, needs to update, and resubmit PCO. 03/14/19- JF to follow up with BC on update. 03/21/19- SCCI to compile tickets (received) and issue to PMA/SMMA. 04/04/19- PCO was approved last week for funding out of
#047	N/A	WJGEI	WJGEI Proposal #3, 11, 13, 14, 15, 16, 17, 18, 19, 20, 25, 26, 27, 28, 29, 30, 31, 37	\$84,034.52			\$43,383.65	(\$21,030.87)	PRE-GMP	SCCI submitted PCO on 12/13/2018. PMA/SMMA reviewing as of 12/13/2018. SMMA comments rec'd 1/3/19, PMA response issued 1/8/19. 1/10/2019 PMA reviewing portion rejected for premium time. SCCI resubmitted with funded from owner. 1/17/19 PCO approved from PMA/SMMA. SCCI submitted PCO on 12/11/2018. 12/13/2018 PMA sent comments rejecting PCO until back up on PCO is submitted from SCCI. SCCI to address and itemize scope. 1/17/19- SCCI to document plan with locations of base installed. 1/24/19 No Update. 1/31/2019 SCCI working with pavilion to provide backup. 2/7/2019 SCCI reviewing OT charges. 2/12/19 SCCI resubmitted with photos, PMA/SMMA reviewing. 2/21/19- SMMA issued comments to PMA 2/20, PMA added comments and issued back to SCCI today. PCO was sent back as rejected as work is owned under contract drawings
#048		Pavilion Flooring	Pavilion Flooring PCO #048- install black cover base at temp walls and finished spaces during Summer 2018 enabling. Example being a temp. fitness room and other areas in the B Wing Offices and D Wing / Ewing Spaces.	\$3,496.12			\$3,009.88	(\$486.24)	PRE-GMP	SCCI submitted PCO on 12/11/2018. PMA/SMMA ball in court to review. 1/8/19 PMA more productivity data to analyze & respond. 1/17/19- PMA issued comments back to SCCI on 1/9. 1/8/19 PMA emailed SCCI notifying that PMA is unable to verify Dow's claim until productivity data can be compiled and reviewed. 1/24/19 PMA working to reconcile with all other PCO's and daily reports. 2/21/19- PCO still on hold, review schedule impact cost. 2/28/19- PCO still on hold, review schedule impact cost. 03/07/19- PCO still on hold, review with schedule impact cost. 03/14/19- PCO still on hold, to be reviewed with schedule impact cost. 03/21/19- PCO still on hold, to be reviewed with schedule impact cost. 04/04/19- PMA letter issued on 03/27 formally rejects Dow's inefficiency PCs. SCCI to follow up with Dow, and risk to still be tracked here until (if) a formal response from Dow is heard. 04/11/19- SCCI met with Dow Monday 04/08 on schedule impact cost, meeting with Dow will be needed in the future to discuss costs. 04/18/19- SCCI following up with Dow, meeting needed to discuss with Dow from all parties needed. 04/25/19- SCCI still working with Dow, meeting between all parties is still needed for discussion. 05/09/19- SCCI still working with Dow, meeting needed for discussion. 05/09/19- SCCI still working with Dow, meeting between all parties is still needed for discussion. 05/16/19- SCCI still working with Dow, meeting between all parties is still needed for discussion.
#049		Dow Company	Dow Company PCO #049- proposal for inefficiency during the mass excavation for Phase 1 Foundations in October.	\$44,789.76			\$44,789.76	\$0.00	SCCI/HOLD	SCCI submitted PCO on 12/11/2018. Link provided does not contain the PCO, GGD responded to SCCI on 12/13 for new link. SCCI sent new link, GGD comments due by 1/8/19. 1/10/2019 SMMA to issue comments by end of week. 1/17/19- SMMA still working on finalizing comments. 1/24/19 GGD/SMMA comments are ready, PMA hopes to have comments to SCCI today. 1/29/2019 PMA sent comments to SCCI. 1/31/2019 WJGEI reviewing, SCCI to update when WJGEI comments received. 2/7/2019 SCCI/WJGEI to provide response. PMA to provide foreman rate response. 2/21/19- SCCI to issue response on rate, review other PCO comments. 2/28/19- SCCI reviewing still. 03/07/19- WJGEI has to provide credit, resubmit to SCCI, SCCI to revise and resubmit. 03/14/19- WJGEI revising one proposal. SCCI wants separate meeting with this PCO. SCCI possibly to break out approved/unapproved costs. 03/21/19- SCCI to follow up internally and schedule team meeting. 3/28/19 - SCCI estimator to review. 04/04/19- SCCI estimating to see if work done to see if T&M slips are accurate. 04/11/19- SCCI working on estimation still. 04/18/19- SCCI still working on estimate. 04/25/19- SCCI still working on estimate. 05/02/19- SCCI still working on estimate. 05/09/19- SCCI estimator reviewing now. 05/16/19- B.I.C. SCCI
#050	RFI #139, PR #022	WJGEI	T&M Work for Summer enabling. WJGEI Proposal #07 - Rework fire alarm equipment and devices located in the gym not shown on the electrical drawings. WJGEI Proposal #08 - Rework and re-wire 1600A SWBD-2 not shown on the electrical drawings. WJGEI Proposal #09 Rework and re-wire electrical panels and associated branch wiring located in the gym not shown on electrical drawings. Proposal #10 - Summer premium time to accelerate work	\$202,918.70			\$200,085.33	(\$2,833.37)	SCCI	SCCI submitted PCO on 12/12/2018. DF issued back comments to SCCI today on quantities. SCCI to review with JDC and get back to team with quantities to enable team review. DF reviewing and to respond as soon as possible. Infill of beam pockets to be tracked as separate PCO if/as SMMA approved. PMA to review. 1/24/19 PCO Rountine required. 1/4/19 comments issued to SCCI. 1/17/19- SCCI issued revised PCO,
#051	RFI #253	JDC Demo	JDC Demo PCO #051- proposal for additional beam pockets per RFI 253. Pricing includes labor, equipment, materials and disposal necessary to expose steel beam connections in the locations shown for new construction. PMA NOTE- IT SHOULD BE RFI 253 REFERENCED.	\$25,337.81			\$19,422.95	(\$5,914.86)	PRE-GMP	JDC Demo PCO #052- change order represents mechanism to remove the \$598,500 of allowances from the JDC Demo subcontract into individual allowances to be managed within the GMP.
#052		JDC Demo	JDC Demo	\$0.00			\$0.00	\$0.00	PRE-GMP	SCCI submitted PCO on 12/12/2018. PMA/SMMA ball in court to review.

PMA Construction Change Authorization Log

Key: Approved Under Review Rejected Pending

Item #	Category	Description	Amount	Status	Comments
#053A	Dow Company	Dow Company PCO #053- attached back up for T&M from the Dow Company working around Wall #16 and the unforeseen pipes that were encountered. Ticket 103240- Down time waiting for car to be moved / towed, and double handle of soils that were not yet classified by CDW. Ticket 103241- Over excavate around and over ex for unforeseen drain and water lines based upon sketches issued by SMMA. Ticket 103243- Excavate around and over ex for unforeseen drain and water lines down to suitable material.	\$9,924.42	Approved	
#053B	Dow Company	Dow Company PCO #053- attached back up for T&M from the Dow Company working around Wall #16 and the unforeseen pipes that were encountered. Ticket 103240- Down time waiting for car to be moved / towed, and double handle of soils that were not yet classified by CDW. Ticket 103241- Over excavate around and over ex for unforeseen drain and water lines based upon sketches issued by SMMA. Ticket 103243- Excavate around and over ex for unforeseen drain and water lines down to suitable material.	\$5,474.54	Approved	
#054	N/A	Added wall pack lighting at mods	\$10,422.09	Approved	
#055	PJK	PER rfi 151.1. Wiring is needed to be run to the nearest AHU controller to interface for alarm feedback.	\$2,715.81	Rejected	
#056	J Derenzo	J Derenzo PR #10 - Strip & Dispose of Loam - See PR as requested to split the loam strip and dispose from the original PCO #019. Attached back-up includes revisions associated with temporary egress door swings and hardware as a result of RFI #129 and RFI #150. Reversal of swing for the door leading from the auto body shop out to the exterior vehicle tunnel, as well as the addition of a luminescent striping from the fab lab to pass through the swinging door as opposed to the overhead coiling door. Removal of the existing door leaves from the door frame leading from the fab lab into the auto body space.	\$13,175.50	Approved	
#057	CCD #001	Added wall pack lighting at mods	\$4,003.59	Approved	
#058	Dow Company	Allowance transfer authorization request represents the costs associated with the soil export to the enclosed facilities as outlined in the attached tickets.	\$58,787.00	Approved	
#060	JDC Demo	Allowance transfer authorization - subsurface transite, ACM foundation mastics, vapor barrier	\$30,700.00	Approved	
#061	Dow Company	Dow Excavation Inefficiency Costs for November 2018	\$95,358.19	Approved	
#062	JDC Demo	JDC Downtime on T&M from GRs	\$3,212.00	Approved	
#063	Proscan	Proscan for Latent Subsurface Conditions	\$1,114.78	Approved	
#064	Greenwood	Install Temp Roof Curb for EF #09	\$1,220.76	Approved	
#066	Field Condition	Boston Chimney	\$54,892.51	Rejected	
#067	N/A	Steel Beam Penetration Allowance Transfer (\$15,900)	\$0.00	Approved	
#053A	PRE-GMP	SCCI submitted PCO on 12/12/2018. 1/10/2019 PMA/SMMA issued comments back to SCCL. 1/15/19 SCCL questioned PMA/SMMA comments. 1/15/19 PMA sent \$28.5/CY for over excavation and \$30/CY for granular Backfill, not SCCL \$123/CY. All to review. 1/17/19- SMMA issued comments 1/9, SCCL to re-issue PCO with unit rates / bill against allowance. 1/24/19 SCCL to adjust cover sheet showing correct allowance draw/Need to the out qualification if it exists. Update 1/31/2019 DG to call dow to discuss rates. 2/7/2019 SCCL still working on this. 2/21/19- SCCL ball in court. 2/28/19- SCCL to separate approved/unapproved slips, resubmit. 03/07/19- SCCL/DOW to revise labor rates, equipment rates, and resubmit PCO. 03/14/19- JF to follow up with JA next week. 03/21/19- Dow is updating pricing, SCCL to resubmit PCO once they receive this information 3/28/19 : 53A ok, 53B broken out	\$2,446.18	Approved	
#053B	SCCI	04/04/19- SCCL working on formal PCO for disputed costs on SL 103241. 04/11/19- Ongoing, SCCL to submit PCO. 04/18/19- Ongoing, SCCL to submit PCO. 04/25/19- Ongoing, SCCL to submit PCO. 05/02/19- Ongoing, SCCL to submit PCO. 05/09/19- SCCL to formally submit PCO. 05/16/19- SCCL to formally submit PCO.	\$0.00	Approved	
#054	PRE-GMP	PMA authorized T&M for installation. SCCL submitted costs on 12/17/18	\$0.00	Approved	
#055	VOID	12/18/18- PCO issued from SCCL per RFI 151.1. 01/03/2019- Ball in court for review is PMA. 1/17/19- PCO on hold, review during cold days	(\$2,715.81)	Rejected	
#056	PRE-GMP	12/19/2018- PCO #056 originated on this date. 01/03/2019- Ball in court PMA to review. 1/4/19 - PMA rejection issued. 1/17/19- Meeting with SCCL, PMA, SMMA, and J Derenzo on 1/22. 1/24/19 PCOS 19, 32, and 56 may be tied together at this point, PMA is reconciling	(\$71,999.76)	Rejected	
#057	PRE-GMP	CD #001 executed on 8/8/2018. T&M Slips forthcoming from SCCL. 1/15/2019 SCCL submitted costs. SCCL proposing \$5,075.50 out of Owner Contingency and \$8,100 out of Allowance. 1/17/19- PCO in review from PMA/SMMA. 1/24/19 Waiting for SMMA comments before sending to SCCL. Responding. 2/21/19- SCCL to provide more backup. 2/28/19- SCCL to revise PCO to distinguish between cost/ no cost items. 03/07/19- SCCL issued PCO revision on 2/28/19, SMMA/PMA to review. 03/14/19- SMMA sent comments to PMA on 3/13. Ball in Court PMA to review. 03/21/19- SCCL to issue revised PCO, PCO to be approved after revision.	(\$1,071.91)	Rejected	
#058	PRE-GMP	01/10/2019 SCCL responded with \$100 correction	\$0.00	Approved	
#060	JDC Demo	Allowance transfer authorization - subsurface transite, ACM foundation mastics, vapor barrier	\$30,700.00	Approved	
#061	SCCI/HOLD	SCCL issued PCO on 01/16/19. 1/8/19 PMA emailed SCCL notifying that PMA is unable to verify Dow's claim until productivity data can be compiled and reviewed. 01/17/19- PCO under review from PMA/SMMA. 1/24/2019. 2/21/19- PCO still on HOLD, review with schedule impact. 02/28/19- PCO still on hold, to be reviewed with schedule impact. 03/07/19- PCO still on hold, to be reviewed with schedule impact. 03/14/19- PCO still on hold, to be reviewed with schedule impact costs. 03/21/19- PCO still on hold, to be reviewed with schedule impact costs. 04/04/19- PMA letter issued on 03/27 formally rejects Dow's inefficiency PCOS. SCCL to follow up with Dow, and risk to still be tracked here until a formal response from Dow is heard. 04/18/19- SCCL following up with Dow, meeting needed to discuss with Dow from all parties needed. 04/25/19- SCCL still working with Dow, meeting between all parties is still needed for discussion. 05/02/19- SCCL still working with Dow, meeting between all parties is still needed for discussion. 05/09/19- SCCL still working with Dow, meeting between all parties is still needed for discussion. 05/16/19- SCCL still working with Dow, meeting between all parties is still needed for discussion.	\$0.00	Approved	
#062	PRE-GMP	Funded from Suffolk Lump Sum GRs (PMA to track in Master Budget	\$0.00	Approved	
#063	PRE-GMP	Issued 1/7/19. PMA approved 1/7/19.	\$0.00	Approved	
#064	PRE-GMP	Issued 1/7/19. PMA approved 1/7/19.	\$0.00	Approved	
#066	VOID	SCCL submitted costs on 1/09/2019. 01/17/19- PMA issued comments back regarding other pricing for this work and credit demo. PCO review is ongoing for this item from all parties. 1/24/19 Replaced by PCO #069. 1/31/2019 SCCL reviewing and resubmitting pricing following discussions (DG working with JDC, firming up to Boston Chimney to \$50K, Take cost for protection of breaching in GC/GR. PMA to discuss with TP)	(\$54,892.51)	Rejected	
#067	PRE-GMP	PCO Submitted on 2/1/19 for a \$0 PCO. Allowance transfer of \$15,900. 2/7/2019 PCO is routing	\$0.00	Approved	

PMA Construction Change Authorization Log

Key:

Approved	Under Review	Rejected	Pending
----------	--------------	----------	---------

#699	Field Condition	JDC Demo, Boston Chimney	Demolish top 20' of existing chimney	\$34,369.24	\$34,369.24	\$0.00	<p>SCCI submitted costs on 1/14/2019. 1/15/2019 PMA sent comments back. SCCI to review. 1/17/19 - SMMA issued comments regarding de scope not matching proposed demolition plan. Revised PCO from JDC needed. 1/24/19 SCCI working with JDC to address SMMA comments regarding descope. 1/31/2019 SCCI reviewing pricing following discussions (DG) working with JDC, firming up to Boston Chimney to \$50K. Take cost for protection of breathing in GC/BB. PMA to discuss with JDC.</p>
#700	PR #23	Grasseschi	CO 2P - Premium time on summer work, CO 3P - Investigate and test gas line, added ball valves on temp water service	\$40,267.38	\$24,491.81	(\$15,775.57)	<p>SCCI submitted costs on 1/15/2019. 1/17/19 - PMA/SMMMA reviewing. 1/24/19 PMA sent comments this morning. SCCI broke out into two PCOs, SCCI reviewing PCO #070. 2/21/19 - SCCI to coordinate response with Grasseschi, revise and resubmit. 2/28/19 - SCCI told Grasseschi to justify their position, rejected as of now and risk will be tracked here. 03/07/19 - SCCI to address with Grasseschi / internally with Jake Forsath (JF), 03/14/19 - SCCI chasing wage rate breakdown from Grasseschi. Once wage rates are finalized, the PCO will be reviewed again. As of right now PCO is rejected, cost exposure is being tracked here. 03/21/19 - SCCI to resubmit PCO. PMA to review wage rates. 04/11/19 - PMA to review updated wage rates, SCCI still reviewing with Grasseschi. 04/18/19 - Ongoing B.I.C. SCCI / Grasseschi, wage rate comments sent back to SCCI from PMA. 04/25/19 - Ongoing B.I.C. SCCI / Grasseschi. 05/02/19 - Ongoing, B.I.C. SCCI/ Grasseschi. 05/09/19 - No change, SCCI waiting for any response from Grasseschi. 05/16/19 - No change, B.I.C. SCCI/Grasseschi.</p>
#70A	PR #23	Grasseschi	Plumbing summer 2018 T&M Part 2 - PR #23 installing new ball valves on existing systems for water piping. 4" vent rework	\$15,944.66	\$12,447.61	(\$3,497.05)	<p>SCCI issued PCO on 2/5/19. PMA disagrees with OT hours included. 2/14/19 PMA/SMMMA comments sent to SCCI. 2/21/19 - SCCI to revise and resubmit, vent work straight time disputes to be carried on PCO 70. 04/04/19 - PCO signed and approved.</p>
#70B	PRE-GMP	Grasseschi	gas piping investigation work that was completed by Grasseschi. This PCO represents paying for 16hrs of straight time per the Grasseschi estimate prior to the work being completed. This PCO is proposed to be funded by the Construction Contingency.	\$3,104.68	\$3,104.68	\$0.00	<p>SCCI issued PCO on 3/22/2019. 04/04/19 - PCO was approved last week and signed.</p>
#71	PRE-GMP	Lauretano	Additional temporary signage	\$1,151.17	\$1,151.17	\$0.00	<p>Additional temporary signage received quote from Suffolk on 9/4/2018. BC noted that signs have been ordered on 9/18 and shop drawings are forthcoming. SCCI submitted on 1/15/2019. PMA approved on 1/15/2019. PCO Routing for signature</p>
#72	PRE-GMP	Marguerite	Marguerite PCO #002 - Down time forming footings for generator walls, Marguerite PCO #003 - Form and install sacrificial form around 12" RCP pipe and 12" DI pipe at wall #16 (Unforeseen condition	\$8,286.94	\$4,124.72	(\$4,162.22)	<p>PMA added to PCO log on 11/14/2018 to reconcile with SCCI log. SCCI to submit PCO. PMA has record of no down time. On 01/14/2019 SCCI submitted costs. 1/17/19 - PMA/SMMMA reviewing. 1/24/19 SMMA to provide comments. 1/29/19 PMA/SMMMA sent comments to SCCI. 1/31/2019 Awaiting JA/SCCI write-up. 2/7/2019 SCCI still to issue. 2/14/19 SCCI to respond. 2/21/19 - SCCI ball in court. 2/28/19 - SCCI to follow up, possibly internally with JF. 03/14/19 - JF to break out approved / unapproved costs, track unapproved costs here. 03/21/19 - JF sent revised PCO which removed the disputed T/M slips which will be covered under a separate revision. SMMA has recommended for approval, PMA to review. 03/21/19 - Signatures routing. 04/04/19 - PCO was approved and signed last week.</p>
#72A	SCCI	Marguerite	Marguerite Concrete Misc T&M Part 2 - Disputed Costs tracked here.	\$4,162.23	\$4,162.23	\$0.00	<p>SCCI to issue PCO #072A tracking disputed T&M costs. 3/28 - SCCI to issue 072A. 04/04/19 - SCCI to formally issue PCO. 04/11/19 - SCCI to submit PCO ASAP. 04/18/19 - SCCI to submit PCO ASAP.04/25/19 - Ongoing. SCCI to submit PCO ASAP. 05/02/19 - Ongoing. SCCI to submit PCO ASAP. 05/09/19 - SCCI to formally submit PCO. 05/16/19 - SCCI to formally submit PCO.</p>
#73	Field Condition	Dow Company	Soil export to enclosed facilities	\$70,608.00	\$70,608.00	\$0.00	<p>SCCI submitted costs on 1/14/2019. 1/17/19 - PMA/SMMMA reviewing. 1/24/19 PCO routing</p>
#74	Field Condition	Liberty	Liberty rental of seasonal ground thaw machine (12/19/18-3/12/19)	\$22,281.00	\$22,281.00	\$0.00	<p>SCCI submitted on costs on 1/15/2019. SCCI requesting winter conditions allowance draw. 1/17/19 - PMA issued comments, SCCI to follow up with Liberty. 1/24/19 PCO routing</p>
#75	Field Condition	JDC Demo	1,500 SF of ACM concrete (Allowance)	\$24,000.00	\$4,320.00	(\$19,680.00)	<p>SCCI submitted on 1/14/19. 1/17/19 - PMA/SMMMA review. 1/24/19 PMA awaiting response from Smith & Wessel. 1/30/2019 PMA sent comments and takeoff. 1/31/2019 SCCI reviewing takeoff as work is not yet completed. PMA noted Square Footage Costs at \$4,608. SCCI resubmitted costs on 2/1/18. Routing for signature</p>
#78	Field Condition	JDC Demo	1,200 SF for lower stair case foundation & footing from F wing.	\$20,500.00	\$11,000.00	(\$9,500.00)	<p>SCCI submitted on 1/15/2019. SCCI proposing utilizing remaining \$19,500 of the \$30,000 allowance for foundation coating ACM and the remaining \$1,000 to be funded by the \$31,000 Allowance for coating behind classroom units suspect ACM. SCCI requested a quick turnaround to get this work moving. 1/17/19 - Smith and Wessel to confirm quantities match. 1/24/19 PMA awaiting response from Smith & Wessel. 1/30/2019 PMA sent preliminary review to SCCI. 1/31/2019 SCCI reviewing takeoff as work is not yet completed. PMA noted Square Footage costs at \$7,020. 2/7/2019 Approved to proceed up to \$11K on 2/1/19. SCCI to provide revised PCO today. 2/14/19 PCO Routing as of today</p>

PMA Construction Change Authorization Log

Key:

Approved	Rejected	Pending
----------	----------	---------

Item #	Item Description	Original Amount	Change Amount	Net Amount	Item Type	Item Status	Comments
#079	Emergency Telephone System Direction, Hands Free Auto Dialer, Security Panic Button	\$24,282.79	\$21,137.01	(\$3,145.78)	SCCI	Approved	<p>FR #333 issued on 1/20/19. SCCI submitted pricing on 1/19/19. PMA reviewed, 1/31/19 SMMA to provide comments. 1/31/19 SMMA reaching out to WJGEI to confirm \$6k savings are attainable and will then issue new PR. 2/7/2019 SMMA to provide update. 2/14/19 SMMA waiting for WJGEI (Barboza/Cunha) to respond. 2/21/19- SMMA back and forth with WJGEI ongoing, to re-issue PR / WJGEI to revise cost proposal. 2/28/19- SCCI received revised PR, SCCI to get costs from WJGEI and resubmit. 03/07/19- WJGEI to resubmit to SCCI, SCCI to issue revised PCO. 03/14/19- SCCI still waiting on revised pricing from WJGEI for the PR. 03/21/19- No change. 3/28- Suffolk has revised pricing from WJGEI, will submit. 04/04/19- SCCI issued revised PCO per updated PR on 3/28. B.I.C. SMMA/PMA. 04/11/19- PMA to review SMMA sign off. 04/18/19- PMA sent minor comments back to SCCI, SCCI to follow up with WJGEI. 04/25/19- SCCI still coordinating with WJGEI. 05/02/19- Ongoing, SCCI still coordinating with WJGEI. 05/09/19- WJGEI revising PCO per agreed upon comments on email on 5/2 from Jake F. 05/16/19- No change. B.I.C. SCCI</p>
#082	Beauce Atlas	\$18,080.98	\$18,080.98	\$0.00	SCCI	Approved	<p>SCCI submitted costs on 1/16/2019. SMMA Reviewing. 1/31/2019 SMMA to provide comments by EOW. SMMA provided comments on 2/1/19. 2/7/19 PMA to review SMMA comments and issue to SCCI. 2/13/19 PMA sent comments to SCCI. 2/21/19- SCCI to review with Beauce Atlas. 2/28/19- SCCI to follow up with Beauce Atlas, possibly break out approved costs. 03/07/19- Meeting 2:00 P.M. 03/14/19- Comments sent to BA from SCCI yesterday, SCCI to follow up with BA. 03/21/19- SCCI issued comments back to BA for review 3/28/19 - SCCI has received some revised proposals. Will wait until they have all comments back and will send to team. 04/04/19- SCCI waiting for more comments. SCCI to follow up with BA. 04/11/19- SCCI said revised pricing is due back next week. 04/18/19- B.I.C. SCCI still for revised pricing. 04/25/19- SCCI B.I.C. coordinating with Beauce Atlas. 05/02/19- Ongoing, SCCI still working with Beauce Atlas. 05/09/19- Ongoing, SCCI still working with Beauce Atlas. 05/16/19- No change. B.I.C. SCCI</p>
#083	Delta Beckwith	\$2,432.00	\$2,432.00	\$0.00	PRE-GMP	Approved	<p>SCCI submitted costs on 1/16/19. 1/17/19- PMA/SMMA reviewing. 1/24/19 PMA reviewing. 2/7/2019 PCO routing. SCCI submitted PCO on 1/16/19. 1/17/19- PMA/SMMA reviewing. 1/24/19 SMMA to have comments today. 1/31/2019 PMA to review SMMA comments and provide to SCCI. 2/14/19 PMA sent comments to SCCI. 2/21/19- SCCI to respond to SMMA/PMA. 2/28/19- SCCI status quo have to speak with Flett, possibly break out approved costs. 03/07/19- SCCI to review comments / address with Flett. 03/14/19- SCCI to compile responses from Flett and issue to SMMA/PMA. 03/21/19- SCCI to revise and resubmit PCO with more descriptions and clarifications. 3/28 - BIC Suffolk. chase credit from DOW. 04/04/19- 848 in for approval, B.I.C. PMA/SMMA. 848 to have contested costs, SCCI to issue 848. 04/04/2019- B.I.C. SMMA/PMA still ASPAP. 04/18/19- SMMA sent comments back to PMA on 04/16. PMA to complete and issue comments back to SCCI. 04/25/19- B.I.C. PMA/SMMA, to issue comments back ASAP. 05/02/19- PMA/SMMA issued comments back to SCCI on 04/30. SCCI following up with Flett. Flett submitted wage rates to SCCI, reviewing comments back with Flett. Flett submitted wage rates to SCCI, SCCI to review. 05/16/19- SCCI revised PCO per PMA/SMMA comments, PCO</p>
#084A	Flett	\$89,292.24	\$30,547.97	(\$56,493.91)	ROUTING	Approved	<p>Flett CR #1 - Prep School Street for lay down area, Flett CR #2 - Manage stockpile on School Street (1/2), Flett CR #3 - Premium Time for temp utility trench, Flett CR #4 - Build temporary egress at school street (1/2), Flett CR #5 - school street (2/2), Flett CR #7 - Premium time on soil nail wall install, Flett CR #8 - Crosswalk striping at mods and down to library, Flett CR #9 - Additional tree cutting of 16 trees requested by SCCI, Flett CR #10 - Pave handicap ramp on concourse where buses drop off, Flett CR #11 - Steet sweeping for entire project (before school opened), Flett CR #12 - Create temp access road to allow fence company to safely install the fence from School St. construction gate down to GLX property, Flett CR #13 - Striping handicap symbols and added walkway striping</p>
#084B	Flett	\$48,911.54	\$48,911.54	\$0.00	SCCI	Approved	<p>Flett CR #1 - Prep School Street for lay down area, Flett CR #2 - Manage stockpile on School Street (1/2), Flett CR #3 - Premium Time for temp utility trench, Flett CR #4 - Build temporary egress at school street (1/2), Flett CR #5 - school street (2/2), Flett CR #7 - Premium time on soil nail wall install, Flett CR #8 - Crosswalk striping at mods and down to library, Flett CR #9 - Additional tree cutting of 16 trees requested by SCCI, Flett CR #10 - Pave handicap ramp on concourse where buses drop off, Flett CR #11 - Steet sweeping for entire project (before school opened), Flett CR #12 - Create temp access road to allow fence company to safely install the fence from School St. construction gate down to GLX property, Flett CR #13 - Striping handicap symbols and added walkway striping</p>

PMA Construction Change Authorization Log

Item #	Category	Item Description	Amount	Change Order #	Change Order Description	Approval Status	Comments
#086	Field Condition	Dow Excavation Inefficiency December 2018	\$91,828.26	\$91,828.26		Approved	SCCI submitted costs on 1/25/19 with a note that the review of this PCO cannot be completed until all information is received. 1/8/19 PMA emailed SCCI notifying that PMA is unable to verify Dow's claim until productivity data can be compiled and reviewed. 2/21/19 - Status quo. 2/28/19 - PCO still on hold, to be reviewed along with schedule impact costs. 03/07/19 - PCO still on hold, to be reviewed along with schedule impact costs. 03/14/19 - PCO still on hold, to be reviewed along with schedule impact costs. 03/21/19 - PCO still on hold, to be reviewed along with schedule impact costs. 04/04/19 - PMA letter issued on 03/27 formally rejects Dow's inefficiency PCOs. SCCI to follow up with Dow, and risk to still be tracked here until a formal response from Dow is heard. 04/18/19 - SCCI following up with Dow, meeting needed to discuss with Dow from all parties needed. 04/25/19 - SCCI still working with Dow, meeting between all parties is still needed for discussion. 05/02/19 - SCCI still working with Dow, meeting needed for discussion. 05/09/19 - SCCI still working with Dow, meeting between all parties is still needed for discussion. 05/16/19 - SCCI still working with Dow, meeting between all parties is still needed for discussion.
#087	PR #035	Additional 1 sided concrete wall required at the existing B wing foundation	\$42,964.30	\$37,609.14		Approved	SCCI submitted PCO on 1/23/19. 1/29/19 PMA/SMMMA sent comments to SCCI. 1/31/2019 SMMMA to review Structural Engineer, SCCI to review with Marguerite as well to try to meet at \$35K. Following Meeting PCO was ready for execution
#087A	Field	Premium Time for Additional 1 sided concrete wall required at the existing B wing foundation	\$1,848.76	\$1,848.76		Approved	SCCI to submit PCO #087A with premium time costs ASAP. 04/11/2019 - Ongoing. 04/18/19 - No change B.I.C. SCCL. 04/25/19 - Ongoing. B.I.C. SCCL. 05/02/19 - Ongoing. SCCL to formally submit PCO
#088	Field Condition	Soil export to the enclosed facilities as outlined in the attached tickets	\$361,751.00	\$361,751.00		Approved	SCCI submitted PCO on 2/1/19. 2/7/2019 PMA has SMMMA comments and is reviewing. 2/14/19 PMA to review by EOW. 2/21/19 - PMA waiting for SMMMA confirmation to process PCO. 2/21/19 - PCO is routing.
#089	JDC Demo	JDC Demo	\$47,746.95	\$47,134.07		Approved	SCCI submitted PCO on 02/04/19. PCO was executed on 2/7/2019 after minor comments from PMA/SMMMA.
#090	Field Condition	JDC Demo	\$19,253.08	\$18,018.75		Approved	SCCI submitted PCO on 2/4/2019. 2/7/2019 PMA issued comments on 2/5/19 and 2/6/19, SCCL to send revised PCO. 2/14/19 Routing today
#091	N/A	J. Derenzo	\$24,460.32	\$4,102.31		Approved	SCCI submitted PCO on 2/1/19. Premium time portion funded from Construction Contingency. 2/14/19 PMA reviewing. 2/14/19 PMA reviewing. 2/21/19 - PMA to send SCCL comments from PMA/SMMMA today. 2/28/19 - SCCL said ball in court is J. Derenzo. 03/07/19 - SCCL said B.I.C. is still J. Derenzo, SCCL to follow up. 03/14/19 - SCCL to compile responses, issue over to SMMMA/PMA. 03/21/19 - Certified Payroll issues corrected yesterday to match billing, SCCL to revise and resubmit. 3/28 - SCCL sent copy 3/26 9:02 AM. SMMMA/PMA to review. 04/04/19 - 91 submitted for approval, B.I.C. PMA/SMMMA for approval. 91A to be submitted with disputed costs. 04/11/2019 - SMMMA sent comments to PMA, PMA to review and send back to SCCL. 04/11/19 - PMA reviewing with DCAAM on certified payroll. 04/18/19 PMA to follow up with DCAAM again for certified payroll question. 04/25/19 - DCAAM again. 05/09/19 - PMA still trying to get a hold of DCAAM, will review PCO based off merit for approval. If DCAAM does get back to PMA with different response on certified payroll question, PMA will take necessary measures to recoup any costs. 05/16/19 - SCCL revised PCO with updated rates, PCO is routing. If DCAAM does get back to PMA with different response on certified payroll question, PMA will take necessary measures to
#091A	N/A	J. Derenzo	\$17,434.21	\$15,623.23		Approved	ASAP. 04/11/19 - Ongoing. 04/18/19 - No change B.I.C. SCCL. 04/25/19 - SCCL 3/28 - Dow credit portion, SCCL to submit. 04/04/19 - SCCL to submit PCO and revised rates / revised PCO per SMMMA comments. PCO is now routing. SCCL ongoing work with J. Derenzo. 05/16/19 - SCCL worked with J. Derenzo comments over to SCCL today, SCCL to follow up with J. Derenzo. 05/09/19 - SCCL shutdown for C wing Demo. Derenzo COR #9 - Exploration of 8" fire service for cut and cap. Includes backfill
#092	Field Condition	Axiom, Procut	\$3,494.43	\$3,260.00		Approved	Allowance, SCCL sent revised. 2/7/2019 PCO is routing
#093	N/A	Homert	\$78,000.00	(\$78,000.00)		Rejected	Homert Contracting email sent on 1/24/19. PMA responded on 1/25/19 that this was rejected
#094	N/A	WJGEI	\$2,036.59	\$2,036.59		Approved	WJGEI submitted costs on 10/20/2017. SCCL submitted costs on 2/1/2019. 2/14/19 PMA sent comments to SMMMA, SMMMA reviewing. 2/21/19 - PCO approved / to be processed today.

PMA Construction Change Authorization Log

Key:

Approved	Rejected	Pending
----------	----------	---------

ID	Category	Description	Amount	Status	Comments
#103	SCCI	Additional slab pitch at the loading dock trench drain shown in ASI #038	\$3,658.43	Approved	ASI #038 issued on 12/10/18. SCCL submitted costs on 2/10/19. 2/21/19- BIC. SMMA to review slab elevations and verify if required, possibly issue ASI revision. 2/28/19- SMMA to reissue ASI to clarify. 03/07/19- Revised ASI was issued from SMMA on 03/06. SCCL to follow up with Marguerite if this is indeed added cost. 03/14/19- SCCL to follow up with Marguerite on this cost. 03/21/19- Ongoing B.I.C. SCCL. 3/28 - SCCL to forward revised pricing from Marguerite. 04/11/19- SCCL to follow up with Marguerite. 04/18/19- No change. B.I.C. SCCL. 04/25/19- SCCL following up weekly with Marguerite. 05/02/19- Ongoing. SCCL following up with Marguerite. 05/09/19- PMA issued comments to SCCL on 5/7, SCCL to review with Marguerite. 05/16/19- No change. B.I.C. SCCL.
#105	SCCI	PR #20 Fire Rated Shaft Assembly Revs & FSDs	(\$1,894.15)	Rejected	04/18/19- SCCL to formally issue PCO ASAP. 04/25/19- Ongoing. B.I.C. SCCL. 05/09/19- SCCL to formally submit PCO. 05/16/19- SCCL to formally submit PCO.
#107	PRE-GMP	Includes the cost associate with the enclosed T&M slips from Summer 2018 for temporary walls that were requested to be painted by SCCL. See attached photos of areas completed for back-up.	\$11,592.71	Approved	SCCL submitted PCO on 2/15/19. 2/21/19- SMMA/SMMA to review and issue any comments to SCCL. 2/28/19- SMMA issued revision to CCD, SCCL to review and PMA/SMMA to continue this PCO review. 03/07/19- SMMA sent back comment to PMA saying they are unable to review PCO, PMA to forward comments to SCCL after their review. 03/14/19- PMA sent comments over to SCCL from SMMA. Breakdown from subcontractor needed. 03/21/19- SCCL has followed up with Marguerite, awaiting response. 3/28 - resubmitted on 3/27. 04/04/19- PMA/SMMA working on PCO review, SMMA to issue comments today to PMA. 04/11/2019- SMMA sent comments to PMA yesterday, PMA issued comments to SCCL last night but needed to provide comments to SCCL from PMA. 04/18/19- No change. B.I.C. PMA. 04/25/19- CCD #003 revision from SMMA imminent, this PCO on hold for now. 05/02/19- CCD revision was issued on 4/25, SCCL to chase pricing from Marguerite. 05/09/19- SCCL to get revised PCO from Marguerite, coordinate T&M. 05/16/19- SCCL to continue T&M and chasing credit, SCCL submitted PCO on 05/16/19. 2/28/19- PCO is on hold, to be reviewed with schedule impact costs. 03/07/19- PCO is on hold, to be reviewed with schedule impact costs. 03/14/19- PCO is still on hold, to be reviewed with schedule impact costs. 03/21/19- PCO is still on hold, to be reviewed with schedule impact costs. 04/04/19- PMA letter issued on 03/27 formally rejects Dow's inefficiency PCOs. SCCL to follow up with Dow, and risk to still be tracked here until a formal response from Dow is heard. 04/18/19- SCCL following up with Dow, meeting needed to discuss with Dow from all parties needed. 04/25/19- SCCL still working with Dow, meeting needed. 05/02/19- SCCL still working with Dow, meeting is still needed for discussion. 05/09/19- SCCL still working with Dow, meeting between all parties is still needed for discussion. 05/16/19- SCCL still working with Dow, meeting between all parties is still needed for discussion.
#110	SCCI	CCD-003 Added Concrete Wall at Gym Stair Foundation	\$58,727.80	Approved	SCCL submitted PCO on 2/15/19. 2/21/19- PMA/SMMA to review and issue any comments to SCCL. 2/28/19- SMMA issued revision to CCD, SCCL to review and PMA/SMMA to continue this PCO review. 03/07/19- SMMA sent back comment to PMA saying they are unable to review PCO, PMA to forward comments to SCCL after their review. 03/14/19- PMA sent comments over to SCCL from SMMA. Breakdown from subcontractor needed. 03/21/19- SCCL has followed up with Marguerite, awaiting response. 3/28 - resubmitted on 3/27. 04/04/19- PMA/SMMA working on PCO review, SMMA to issue comments today to PMA. 04/11/2019- SMMA sent comments to PMA yesterday, PMA issued comments to SCCL last night but needed to provide comments to SCCL from PMA. 04/18/19- No change. B.I.C. PMA. 04/25/19- CCD #003 revision from SMMA imminent, this PCO on hold for now. 05/02/19- CCD revision was issued on 4/25, SCCL to chase pricing from Marguerite. 05/09/19- SCCL to get revised PCO from Marguerite, coordinate T&M. 05/16/19- SCCL to continue T&M and chasing credit, SCCL submitted PCO on 05/16/19. 2/28/19- PCO is on hold, to be reviewed with schedule impact costs. 03/07/19- PCO is on hold, to be reviewed with schedule impact costs. 03/14/19- PCO is still on hold, to be reviewed with schedule impact costs. 03/21/19- PCO is still on hold, to be reviewed with schedule impact costs. 04/04/19- PMA letter issued on 03/27 formally rejects Dow's inefficiency PCOs. SCCL to follow up with Dow, and risk to still be tracked here until a formal response from Dow is heard. 04/18/19- SCCL following up with Dow, meeting needed to discuss with Dow from all parties needed. 04/25/19- SCCL still working with Dow, meeting needed. 05/02/19- SCCL still working with Dow, meeting is still needed for discussion. 05/09/19- SCCL still working with Dow, meeting between all parties is still needed for discussion. 05/16/19- SCCL still working with Dow, meeting between all parties is still needed for discussion.
#111	SCCI/HOLD	Dow Company's proposal for inefficiency during the mass excavation activity for Phase 1 Foundations in January 2019.	\$79,493.64	Approved	SCCL issued PCO on 2/21/19. 2/28/19- SCCL reviewing comments back, BIC should be no cost as it was a decision made by team and was recommended from SCCL as promised for no added cost. PCO as of now is rejected.
#112	REJECTED	PR #021	\$17,118.39	Rejected	Additional HVAC costs for revised H&V-15 and 18 locations per the SMMA PR-021 dated 11/21/18. The T&M slips included in this COR have been verified by Suffolk Construction.
#113	PRE-GMP	Proscon	\$10,940.00	Approved	Summer 2018 concrete cutting and scanning. Scan slab in fitness room outside of Fitness room to locate unforeseen buried electric lines - OWNER. Sawcut Electrical Room (unforeseen)- OWNER. 20 LF cut of concrete wall at Stair by CTE Wing existing fitness room slab to expose electrical conduits feed to CTE Wing Electrical Room (unforeseen)- OWNER. 20 LF cut of concrete wall at Stair by CTE Wing loading dock for emergency egress- CONST CONT. Sawcut, cut and dice for electrical trench and cribbed footing redesign per PR #19- OWNER. Core hole for FF-9 ductwork through Level 2 S.O.D.- CONS CONT.
#115	PRE-GMP	JWG	\$0.00	Approved	This PCO represents the backcharge to JWG Restoration for the costs associated with Liberty providing a union carpenter to support their operation. This PCO does not have any cost impacts to the City of Somerville and is just being sent for transparency for the deductive change order to JWG Restoration and the corresponding increased GR's for Suffolk
#116	PRE-GMP	Marguerite	\$29,306.00	Approved	This allowance transfer authorization request represents the costs associated with the Marguerite Concrete scope of work that was completed on a Time and Materials basis as verified by Suffolk and PMA. This PCO is proposed to be funded by the \$600,000 Winter Conditions Allowance.
#116A	Field Condition	Marguerite	\$4,714.00	Approved	This allowance transfer authorization request represents the costs associated with the Marguerite Concrete scope of work that was completed on a Time and Materials basis as verified by Suffolk and PMA. This PCO is proposed to be funded by the \$600,000 Winter Conditions Hold.

Key: Approved Under Review Rejected Pending

#116B	Field	Condition	Marguerite/Liberty	This hold transfer authorization request represents the costs associated with the Marguerite Concrete and Liberty scopes of work that was completed on a Time and Materials basis as verified by Suffolk and MA. This also includes the Liberty Winter Conditions Material and Equipment costs per enclosed. This PCO is proposed to be funded by the \$600,000 Winter Conditions Hold.	\$37,143.30	\$37,143.30																
#117			Dow Company	Cost to remove the wall along xD line per directive in CCD #003R and RFI #337. Per RFI #337 response, Dow is to remove the remaining wall along xD line. Dow includes sawcutting, hoe ramming, and disposing of the concrete wall in question once abated by others.	\$11,625.94																	
#123			PJK/WIGEI	Hold Transfer Authorization request represents the costs associated with the enclosed HVAC and Electrical Pre-purchased Equipment. This PCO is proposed to be funded by the Holds within the Electrical and HVAC GMP budgets Allowance transfer authorization request represents the costs associated with the soil export to the enclosed facilities as outlined in the attached tickets. This work has been completed according to the unit prices and allowance value established in the Buyout Authorization Request #12 for Soils Management Allowance. This is proposed to be funded by the \$2,600,000 Allowance that was established in this Buyout Authorization Request #12.	\$46,356.36	\$42,029.08																
#124			Dow Company	See attached back-up, and spreadsheet detailing the Dow Company's proposal for inefficiency during the mass excavation activity for Phase 1 Foundations in February 2019.	\$15,125.72	\$15,125.72																
#125			Dow Company	This allowance transfer authorization request represents the costs associated with the soil export to the enclosed facilities as outlined in the attached tickets. This PCO represents the delta for the soils to go to Saugus in lieu of clean export for Flett based on the soil classification results. This is proposed to be funded by the \$2,600,000 Allowance that was established in this Buyout Authorization Request #12.	\$6,870.46	\$6,870.46																
#126			Flett	PR #067 Shop Areas Wall Base & Finish Revs	\$35,057.16	\$35,057.16																
#128			Sweeney/Pavilion	SCCI issued PCO on 04/18/19- SCCI to issue formal PCO ASAP. 04/25/19- No change, B.I.C. SCCI. 05/02/19- Ongoing, B.I.C. SCCI to formally issue PCO. 05/09/19- SCCI to formally submit PCO. 05/16/19- SCCI submitted PCO on 05/15, PMA/SMMA to review.	\$0.00																	
#129			WIGEI	This proposed change order represents the Electrical costs associated with the revised Boiler Power Requirements per the SMMA PR #071 dated 02/11/2019.	\$841.69																	
#130			PJ Kennedy	This proposed change order represents the costs associated with the HVAC scope of work per the SMMA PR#062 dated 01/04/2019	\$4,842.94	\$4,842.94																
#131			WIGEI	This proposed change order represents the costs associated with the Electrical Costs per the SMMA PR #007 for the Telecom Revisions.	\$2,468.11	\$2,468.11																
#132			JDC Demo	This PCO represents the associated with the reconciliation of the transportation and disposal of soil commingled with ACM that was previously submitted in approved PCO #026. In the previous PCO #026, JDC Demo included \$37,200 of costs for the anticipated 240 tons of Materials and this PCO represents the reconciliation to the actual quantities encountered. This PCO is proposed to be funded by the \$190,000 "Chimney Firebrick or Lining Suspect ACM" Allowance established in the JDC Demo Subcontract.	\$62,916.00	\$62,916.00																
#133			JDC Demo	that was established in the JDC Demo Subcontract. - Remainder to be funded by the \$67,500 "Subsurface Transite Suspect ACM" Allowance that was established in the JDC Demo subcontract. - Utilize the remaining \$2,865.93 of the \$50,000 "Unforeseen Abatement" Allowance PCO #089. This PCO is proposed to be funded by the following sources: - Utilize completed by JDC Demo on a Time and Materials basis as verified by Suffolk air cell vapor barrier that was encountered on 12/05/18. This work was with the removal of the truck wash used for the abatement of the unforeseen PCO #089. Additional Costs related to this scope were previously approved in and PMA. This PCO is proposed to be funded by the following sources: - Utilize established in the JDC Demo subcontract.	\$6,341.94	\$6,341.94																
			SCCI	SCCI issued PCO on 05/01. 05/02/19- B.I.C. PMA for review. 05/09/19- Ongoing, PMA reviewing. 05/16/19- PMA ongoing review.	\$0.00																	
			VOID	SCCI issued PCO on 03/07/2019. 03/14/2019- B.I.C. SMMA/PMA to review, and send comments if any to SCCL. 04/04/19- SMMA/PMA to get comments from SCCL ASAP. 04/11/19- PCO on hold, team reviewing with Paul L from SMMA. 04/18/19- No change, PCO on hold due to review from Paul L from SMMA and SCCL teams for best option. 04/25/19- CCD #003 revision is imminent from SMMA, PCO on hold for now. 05/02/19- CCD revision was issued on 4/25. B.I.C. Price is VOID from Dow.	(\$11,625.94)																	
			PRE-GMP	SCCI issued PCO on 03/14/19. 03/21/19- B.I.C. SMMA/PMA for review. 04/04/19- PCO was approved and signed last week.	\$0.00	\$92,027.00																
			PRE-GMP	SCCI issued PCO on 03/15/19. 03/21/19- B.I.C. PMA for review. 04/04/19- PCO comment from PMA disputing tipping fee/ Saturday charge to open facility. Rest of PCO was approved, signatures routing.	(\$4,327.28)	\$42,029.08																
			SCCI/HOLD	SCCI issued PCO on 03/27/19- SCCI to follow up with Dow, meeting needed to discuss schedule impact costs. SCCI noted this PCO cost is NOT included in Dow's schedule impact costs (unlike PCOs 49,61,86,111). 04/04/19- PMA letter issued on 03/27 formally rejects Dow's inefficiency PCOs. SCCI to follow up with Dow, and risk to still be tracked here until a formal response from Dow is heard. 04/18/19- SCCI following up with Dow, meeting needed to discuss with Dow from all parties needed. 04/25/19- SCCI still working with Dow, meeting between all parties is still needed for discussion. 05/02/19- SCCI still working with Dow, meeting between all parties is still needed for discussion. 05/09/19- SCCI still working with Dow, meeting between all parties is still needed for discussion. 05/16/19- SCCI still working with Dow, meeting between all parties is still needed for discussion.	\$0.00	\$15,125.72																
			PRE-GMP	SCCI issued PCO on 03/18/19. 03/21/19- B.I.C. PMA for review. 04/04/19- PCO was reviewed and approved, signatures routing.	\$0.00	\$6,870.46																
			PMA/SMMA	SCCI issued PCO on 04/06/2019. 04/11/2019- PMA sent comments to SMMA, SMMA to review/add any comments and send back to PMA for issuance to SCCL. 04/18/19- PMA/SMMA sent comments to SCCL on 4/16, SCCL following up with WIGEI. 04/25/19- WIGEI/SCCL coordinated with vendor, change is no cost and is void.	(\$841.69)																	
			SCCI	SCCI issued PCO on 04/06/2019. 04/11/2019- B.I.C. PMA/SMMA for review. 04/18/19- No change, B.I.C. PMA. 04/25/19- PMA issued both comments to SCCL, PJK reviewing. 05/02/19- No change, PJK reviewing. 05/09/19- No change, PJK reviewing. 05/16/19- No change, PJK reviewing.	\$0.00	\$4,842.94																
			PMA	SCCI issued PCO on 03/22/2019. 03/28/19- GGD to review. 04/04/19- SMMA approved, PMA review before signatures routing. 04/11/2019- PMA to review today. 04/18/19- B.I.C. PMA/SMMA. 04/25/19- B.I.C. PMA/SMMA. 05/02/19- No change, B.I.C. PMA/SMMA confirmed PCO is acceptable, PMA to perform final review. 05/16/19- No change, B.I.C. PMA to review for sign off.	\$0.00																	
			PRE-GMP	SCCI issued PCO on 03/19/19. 03/21/19- B.I.C. PMA/SMMA to review. 04/04/19- SCCI to reissue PCO with new scans, PMA/SMMA to begin review. 04/11/2019- SCCI issued revision with new scans, B.I.C. PMA/SMMA for follow up internally. 04/25/19- Signatures routing.	\$0.00	\$62,916.00																
			SCCI	SCCI issued on PCO on 03/21/19. 03/21/19- B.I.C. PMA/SMMA to review. 04/04/19- PMA/SMMA to review. 04/18/19- approved wage rates needed before sign off. SCCI followed up with Mike Clarke. 04/25/19- No change, B.I.C. SCCI for wage rates. 05/02/19- No change, B.I.C. SCCI for wage rates. 05/16/19- PMA/SMMA issued comments back to SCCL today.	\$0.00																	

PMA Construction Change Authorization Log

Key: Approved Under Review Rejected Pending

#134	JDC Demo		\$16,250.00	\$16,250.00	SCCI issued PCO on 03/20/19. 03/21/19- B.I.C. PMA/SMMA to review. 04/04/19- PCO was approved and signed last week.	PRE-GMP				This allowance transfer authorization request represents the costs associated with the additional mastic removal per the SMMA CCD #003R dated 02/27/19. The costs for other subcontractors related to CCD #003R are excluded and will be submitted under separate cover. This PCO is proposed to be funded by the following sources: - Utilize the remaining \$8,500 of the \$30,000 "Foundation Coating Suspect ACM" Allowance that was established in the JDC Demo subcontract. - Remainder to be funded from the \$31,000 "Coating Behind Classroom Unvents Suspect ACM" Allowance that was established in the JDC Demo Subcontract
#135	SCCI		\$2,274.75	\$2,274.75	SCCI issued PCO on 03/21/19. 03/21/19- PCO was approved from PMA/SMMA. Signatures routing.	PRE-GMP				This allowance transfer authorization request represents the costs associated with the Ceremonial Shovels and Breakfast that were provided for the Groundbreaking Ceremony. This PCO is strictly the mechanism to authorize the utilization of the \$20,000 Ceremonial Allowance within the Lump Sum GR's to cover these costs.
#136	Bartlett Tree Experts		\$15,400.00	\$15,400.00	SCCI issued PCO on 03/21/19. 04/04/19- SCCI to revise cover sheet and resubmit PCO.	PRE-GMP				This hold transfer authorization request represents the costs associated with Bartlett Tree Experts to protect existing trees on site. This PCO represents the transfer from the Hold/Contingency to the Suffolk GR's to fund this work. This work is proposed to be funded by the following sources: - Utilize the \$15,000 "Arborist Service for Existing Trees" Hold that is included in the Landscaping Budget. - Remaining \$400 to be funded from Construction Contingency
#137	Flett		\$13,228.00	\$10,875.00	SCCI issued PCO on 03/21/19. 04/04/19- PMA to review. 04/18/19- PMA to review. 04/25/19- PMA B.I.C. 04/25/19- PCO EXECUTED.	PRE-GMP				This allowance transfer authorization request represents the costs associated with the Non-F5B subcontractors that have obtained bonds to date. Additional subcontractors will be submitted under separate cover if required after ongoing discussions with Suffolk and PMA/City of Somerville. This PCO is proposed to be funded by the Payment and Performance Bonds Allowance.
#137A	Sunrise, East Coast, Atlas, Millwork One, JDC, Beton, Beauce	N/A	\$584,476.80	\$584,476.80	SCCI issued PCO on 04/02/19. 04/04/19- PMA/SMMA to review. 04/18/19- PMA B.I.C. 04/25/19- PCO EXECUTED. 05/16/19- PCO was updated for Beton's full bond cost.	PRE-GMP				This allowance transfer authorization request represents the costs associated with the enclosed Payment & Performance Bonds for the Non-F5B Subcontractors. This PCO is proposed to be funded by the Payment and Performance Bonds Allowance. NOTE- Bond costs for any additional subcontractors will be submitted under separate cover.
#137B	Sweeney Drywall	NA	\$102,500.00	\$102,500.00	SCCI issued PCO on 05/10/19. 05/16/19- B.I.C. PMA for approval.	PMA				This allowance transfer authorization request represents the costs associated with the enclosed Payment & Performance Bonds for the Non-F5B Subcontractors. This PCO is proposed to be funded by the Payment and Performance Bonds Allowance. NOTE- Bond costs for any additional subcontractors will be submitted under separate cover.
#138	Marguerite		\$41,689.79	\$41,689.79	SCCI issued PCO on 03/21/19. 04/04/19- PMA/SMMA to review and issue comments. 04/11/2019- SMMA sent comments to PMA last week, PMA to review and get comments to SCCI. 04/18/19- PMA issued comments back to SCCI today. 04/25/19- Ongoing, PMA to meet with SCCI/Marguerite. 05/02/19- B.I.C. SCCI for review with Marguerite, review with Dow and Spillane for any credits. 05/09/19- No change, B.I.C. SCCI to review with Marguerite and chase Dow/Spillane for credits. 05/16/19- SCCI reviewing revised PCO. to submit PMA/SMMA	SCCI				See attached cost from Marguerite Concrete for the added formwork, rebar, concrete, labor, and equipment to reinforce, form, and pour the one sided wall due to impacts and added scope described in CCD #004.
#139	Boston Chimney		\$0.00	\$0.00	SCCI issued PCO on 03/22/2019. 03/28/19- PCO is being funded from GRs. Signatures are routing.	PRE-GMP				This PCO represents the transfer of funds from the General Requirements budget to Boston Chimney to cover the costs associated with additional Chimney Make-safe requested by Suffolk. This PCO represents the mechanism to notify PMA/SMMA of the transfer of costs between the GR and Chimney (existing conditions) Budgets.
#140	WIGEI	PR #014	\$3,222.52	(\$3,222.52)	SCCI issued PCO on 03/22/2019. 03/28/19- GGC under review. 04/04/19- SCCI check then print for signatures if OK. 04/18/19- PMA B.I.C.	PRE-GMP				This proposed deductive change order represents the credit associated with the deleted light fixtures per the SMMA PR #014 dated 07/30/18.
#141	WIGEI		\$1,071.91	\$1,071.91	SCCI issued PCO on 03/22/2019. 03/28/19- GGC under review. 04/04/19- SCCI to formally submit PCO. 05/16/19- SCCI to formally submit PCO.	SCCI				PR #006 Added No Smoking Signs
#142	WIGEI	ASI #007R2	\$18,965.70	(\$2,500.00)	SCCI issued PCO on 03/22/2019. 03/28/19- GGC under review. 04/04/19- SMMA still reviewing PCO. 04/11/2019- SMMA to issue revised ASI for pricing clarity purposes. 04/18/19- Revised ASI ongoing. B.I.C. SMMA. 04/25/19- Ongoing. B.I.C. SMMA. 05/02/19- SMMA issuing revised ASI, overall change to a credit. 05/09/19- ASI #007R2 was issued on 5/2, SCCI to review with WIGEI for credit. 05/16/19- SCCI working with WIGEI on credit.	SCCI				This proposed change order represents the Electrical costs associated with the changes made to the lighting plans in the SMMA ASI #007 dated 07/24/18.
#145	Dow Company		\$3,197.89	\$3,197.89	SCCI issued PCO on 03/29/2019. 04/04/19- SCCI to formally submit PCO. 05/09/19- SCCI to formally submit PCO.	SCCI				Dow Premium Time
#146	Dow & Flett		\$9,614.78	\$13,942.06	SCCI issued PCO on 03/29/2019. 04/04/19- SCCI to revise PCO to include Dow facility premium costs from PCO #124. 04/11/2019- SCCI reissued PCO with disputed costs (costs associated to Saturday trucking and facility openings) on 04/06/2019 and will be on hold as PMA/SCCI/Dow review with schedule impact costs. 04/18/19- No change, PCO on hold as PMA/SCCI/Dow review with schedule impact costs. 04/25/19- No change, PCO on hold as PMA/SCCI/Dow review with schedule impact costs. 05/02/19- No change, PCO on hold as PMA/SCCI/Dow review with schedule impact costs. 05/16/19- No change, PCO on hold as PMA/SCCI/Dow review with schedule impact costs.	SCCI/HOLD				This allowance transfer authorization request represents the costs associated with the soil export premiums to the enclosed facilities as outlined COR's. This work has been completed according to the unit prices and allowance value established in the Buyout Authorization Request #12 for Soils Management Allowance. This is proposed to be funded by the \$2,600,000 Allowance that was established in this Buyout Authorization Request #12
#147	Simplex	PR #068, RFI #318	\$13,399.32	(\$13,399.32)	SCCI issued PCO on 03/29/2019. 04/04/19- SCCI to formally submit PCO. 05/09/19- SCCI to formally submit PCO.	REJECTED				This proposed change order represents the costs associated with the Fire Protection scope revisions per the SMMA PR #068 dated 02/12/19.

Key: Approved Under Review Rejected Pending

#148	SCCI	\$26,050.82	\$20,807.56	(\$5,243.26)	SCCI issued PCO on 03/29/2019. 04/04/19- SMMA/PMA to reviewed, comments sent back. SCCI revised per PMA/SMMA comments, PCO revision to be reviewed for signatures	PRE-GMP
#149	Dow/Flett	\$55,827.60	\$51,807.90	(\$4,019.70)	SCCI issued PCO on 04/06/2019. 04/11/2019- B.I.C. PMA for review. SCCI, SCCI to follow up. 05/02/19- SCCI provided backup for missing items, PMA to review. 05/09/19- PMA responded to SCCI requesting back up info on certain dates of trucking. SCCI to coordinate with Dow. 05/16/19- SCCI/PMA followed up with CDW, received back up for dates needed. PCO is routing.	ROUTING
#150	Dow Company	\$0.00			SCCI issued PCO on 04/17/19. 04/18/19- B.I.C. PMA/SMMA for review. 04/25/2019- PCO EXECUTED.	PRE-GMP
#151	WIGEI	\$5,359.55	\$5,359.55	\$0.00	04/18/19- SCCI to formally issue PCO ASAP. 04/25/19- Ongoing, B.I.C. SCCI. 05/02/19- Ongoing, B.I.C. SCCI to submit PCO for review. 05/09/19- SCCI to formally submit PCO.	SCCI
#152	WIGEI	\$23,769.03	\$11,641.06	(\$12,127.97)	SCCI issued PCO on 04/06/2019. 04/11/2019- PMA sent comments back to SCCI on 04/10. B.I.C. SCCI for review. 04/18/19- Comments sent back to SCCI/WIGEI. 04/25/19- No change B.I.C. SCCI. 05/02/19- No change, B.I.C. SCCI for review. 05/09/19- No change, B.I.C. SCCI for review. 05/16/19- No change, B.I.C. SCCI for review of comments.	SCCI
#153	Marguerite	\$4,747.48	\$4,747.48	\$0.00	SCCI issued PCO on 04/06/2019. 04/11/2019. B.I.C. PMA/SMMA for review. 04/18/19- B.I.C. SMMA. 04/25/19- SMMA issued comments to PMA on 4/24, PMA to review. 05/02/19- PMA/SMMA issued comments to SCCI yesterday, SCCI to review. 05/09/19- SCCI reviewing PCO with Marguerite. 05/16/19- No change, B.I.C. SCCI.	SCCI
#154	WIGEI	(\$580.13)		(\$580.13)	SCCI issued PCO on 04/06/2019. 04/11/2019. B.I.C. PMA/SMMA for review. 04/18/19- B.I.C. PMA. 04/25/19- No change, B.I.C. PMA. 05/02/19- PCO was executed yesterday.	PRE-GMP
#155	WIGEI	\$3,145.62	\$3,145.62	\$0.00	SCCI issued PCO on 04/06/2019. 04/11/2019- B.I.C. PMA/SMMA for review. 04/18/19- B.I.C. PMA/SMMA. 04/25/2019- B.I.C. PMA for review.	PRE-GMP
#156	Marguerite/JDC	\$11,367.75	\$11,367.75	\$0.00	SCCI issued PCO on 04/06/2019. 04/11/2019- PMA/SMMA reviewed and sent comments back to SCCI on 04/10 revise and resubmit. 04/18/19- SCCI to get JDC wage rates, PMA to follow up formally for direction on Marguerite. 04/25/19- No change for both SCCI and PMA. 05/09/19- PMA issued comments over to SMMA, SMMA to add any comments and issue back to PMA. 05/16/19- SCCI still working with subs on revised PCO.	SCCI
#157	WIGEI	\$1,503.47	\$1,402.61	(\$100.86)	SCCI issued PCO on 04/09/2019. 04/11/2019- B.I.C. SMMA/PMA for review. 04/18/19- SCCI to follow up internally. 04/25/19- PCO being funded from construction contingency. signatures routing.	PRE-GMP
#158	WIGEI	\$6,508.91	\$3,254.46	(\$3,254.45)	SCCI submitted revised PCO per PMA/SMMA comments, PCO was approved. 04/25/19- No change, B.I.C. SCCI. 05/02/19- No change, B.I.C. SCCI. 05/09/19- 04/18/19- PMA issued comments to SCCI, SCCI following up with WIGEI. SCCI issued PCO on 04/09/2019. 04/11/2019- B.I.C. SMMA/PMA for review.	PRE-GMP
#159	JDC Demo	\$3,500.62	\$3,500.62	\$0.00	SCCI issued PCO on 04/11/19. 04/18/19- SCCI to get JDC wage rates. 04/25/19- PMA sent comments back on 4/16. B.I.C. SCCI. 05/02/19- SCCI to follow up with Marguerite response, SCCI also chasing JDC wage rates. 05/09/19- SCCI still following up with Marguerite, JDC wage rates were submitted. 05/16/19- No change, SCCI ongoing work with subs for revised PCO.	SCCI
#160	SCCI			\$0.00	SCCI issued PCO on 04/12/19. 04/18/19- B.I.C. PMA/SMMA for review. 04/25/19- No change, B.I.C. PMA/SMMA	PRE-GMP
#161	Grasseschi	\$159,710.52	\$159,710.52	\$0.00	SCCI submitted PCO on 04/18/19. 04/25/19- No change, B.I.C. PMA/SMMA. 05/02/19- SMMA issued comments to PMA, PMA to review/addy any comments and issue to SCCI. 05/09/19- PMA issued comments over to SCCI, calculating. SCCI estimator to review PCO, coordinate with Grasseschi. 05/16/19- SCCI/ estimator coordinating with Grasseschi.	SCCI
#163	Dow Company / J Derenzo	\$177,647.68	\$177,647.68	\$0.00	SCCI issued PCO on 04/18/19. 04/18/19- B.I.C. PMA for review. 04/25/19- No change, B.I.C. PMA. 05/02/19- No change, B.I.C. PMA. 05/09/19- PMA actively reviewing PCO. 05/16/19- No change, PMA actively reviewing.	PMA

PMA Construction Change Authorization Log

Key: Approved Under Review Rejected Pending

#165	ASI #034	PJK	This proposed change order represents the HVAC costs associated with the revised duct routing at the grease trap at Part A Level 1 per the SMMA ASI #034 dated 11/15/2018.	\$3,610.27	\$3,610.27	\$0.00	SCCI issued PCO on 04/19/2019. 04/25/19- No change, B.I.C. PMA/SMMA. 05/02/19-PMA issued comments to SMMA, will issue to SCCI once SMMA comments are captured. 05/09/19- PMA issued comments over to SCCI, revise and resubmit. 05/16/19- No change, SCCI coordinating with subs for revised PCO.	SCCI	PMA/SMMA
#166		Dow Company	School Street Water Connection	\$5,395.55	\$5,395.55	\$0.00	04/25/19- SCCI to issue PCO formally. 05/02/19- No change, B.I.C. SCCI. 05/09/19- SCCI to formally submit PCO.	SCCI	PMA/SMMA
#167	PR #047	Dow Company, Grasseschi	This proposed change order represents the costs associated with the additional Siterwork and Plumbing scopes of work per the SMMA PR #047 dated 11/26/18.	\$93,713.87	\$93,713.87	\$0.00	05/02/19- SMMA issued comments to PMA, PMA to add any comments and issue to SCCI. 05/09/19- PMA issued comments over to SCCI, large discrepancy for what Grasseschi is submitting and what engineer is calculating. SCCI estimator to review PCO, coordinate with Grasseschi. 05/16/19- No change. SCCI/estimator working with Grasseschi.	SCCI	PMA
#168	RFI #327	Flett	This proposed change order represents the costs associated with the DMH 4-7 invert modifications that were required due to the conflicts with the existing water line per the SMMA response to RFI #327 dated 02/04/2019. This work was completed on a Time and Materials basis as verified by Suffolk and PMA.	\$3,240.66	\$2,844.85	(\$395.81)	SCCI issued PCO on 04/19/2019. 04/25/19- No change, B.I.C. PMA/SMMA. 05/02/19- SMMA issued comments to PMA, PMA to add any comments and issue to SCCI. 05/09/19- PMA issued comments back to SMMA. Once PMA/SMMA comments are finalized, PMA to issue comments over to SCCI. 05/16/19- SCCI revised PCO per SMMA/PMA comments. PCO is routing.	ROUTING	PMA
#169	RFI #308, RFI #355, RFI #350, RFI #381 CCD#004	Marquette	This proposed change order represents the costs associated with the enclosed miscellaneous concrete T&M slips that were verified by Suffolk and PMA. This PCO includes T&M associated with the following RFI responses: RFI #308- Sonotube Coordination Near Electrical Ductbank, RFI #335 - 12" Storm Riser in Foundation Wall Clarification, RFI #350- Plaster and Anchor Bolt Conflict at H5-XQ, RFI #381 - CCD #004 issue at Grade Beam with Existing Footing at Pier L-11.	\$5,525.69	\$5,525.69	\$0.00	SCCI issued PCO on 04/19/2019. 04/25/19- No change, B.I.C. PMA/SMMA. 05/02/19-PMA issued comments to SMMA, will issue to SCCI once SMMA comments are captured. 05/09/19- PMA issued comments over to SMMA, SMMA to add any comments and PMA will submit comments back to SCCI. 05/16/19- PMA to issue comments over to SCCI.	PMA	PMA
#170		Dow Company	This construction contingency authorization request represents the costs associated with constructing the added ramp to provide access around the sublevel footing excavations at FF line. This work is required to provide access around the FF Footings and was not part of the site logistics anticipated and included in the Siterwork Buyout.	\$28,345.00		(\$28,345.00)	SCCI issued PCO on 05/02/19. 05/09/19- SCCI is reviewing offline after SMMA/PMA/SCCI meeting on 05/08. 05/16/19- PCO is void as of 5/16 per SCCI internal discussions	REJECTED	PMA/SMMA
#171	PR #101R1	Pavilion Flooring	Gym Flooring Change costs from PR #101R1.	\$164,541.63	\$164,541.63	\$0.00	SCCI issued PCO on 05/08/19. 05/09/19- SMMA/PMA beginning review of PCO. 05/16/19- No change, PMA/SMMA reviewing.		PMA/SMMA

MONTHLY STATUS REPORT
April 2019

Project: Somerville High School	Building Size: 377,406 SF	Phase 1 Completion: December 24 th 2019
Current Phase: Construction Administration	Project Budget: \$255,982,704	Phase 2 Completion: July 31 st 2020
Construction Type: 78% New / 22% Reno	Design Enrollment: 1,590	Phase 3 Completion: May 28 th 2021
Phase 1 Start: April 23 rd 2018	Reimbursement Rate: 75.29%	Day 373 of 1132 to Ph.3 Substantial: 32.95%

BUDGET STATUS

Total Project Budget: \$255,982,702
Actual Costs Incurred to Date: \$44,871,571 (17.53%)

PROJECT STATUS

April 2019 Progress

- Site Work- excavation/export of soil to new building footing foundation elevations continued throughout the month. Backfilling/Compacting behind new building foundation walls began the end of the month
- Cast-in-Place Concrete: foundation footings / walls continued being formed and poured along the west and east sides of the site for new building lower/sub levels
- Demolition / Abatement: Subcontractors began abatement and demolition of the lower level/field house in the 1986 wing.
- Mechanical, Electrical, Plumbing: Subcontractors began/finished MEP makesafe of the lower level/field house of the 1986 wing.
- GMP Negotiations continued throughout the month. Final contracts are being reviewed/awarded to subcontractors.

May 2019 Forecasted Items

- Site Work: excavation/export of soil to new building footing foundation elevations to continue throughout the month. Backfilling/Compacting behind new building foundation walls to continue. Construction of temporary SOE wire mesh wall road for School Street construction access to begin.
- Cast-in-Place Concrete: foundation footings / walls to continue to be formed and poured along the east side of the site for both new building sub level and lower level.
- Demolition / Abatement: Subcontractors to continue abatement and demolition of the lower level/field house of the 1986 Wing.
- Mechanical, Electrical, Plumbing (MEP): Electrical contractor to begin placing conduit behind foundation walls.
- GMP Negotiations to continue throughout the month. Final contracts are being reviewed/awarded to subcontractors.

PROJECT NOTES

- All filed sub trade contracts have been awarded. Suffolk is currently reviewing non-filed sub trade packages. GMP negotiations began on 08/10/2018, have continued throughout April 2019.

MILESTONE DATES

Milestone Dates	Forecast	Actual	Status	Schedule Notes
Substantial Completion Phase 1 New Addition	24Dec19			Revised per 01/18 Schedule
Substantial Completion Phase 1A Tech Space Reno	26Nov19			Revised per 01/18 Schedule
Substantial Completion Phase 1B Gymnasium Reno	03Jan20			On target
Substantial Completion Phase 2 New Addition	31Jul20			On target
Substantial Completion Phase 2A Auditorium	21May20			On target
Substantial Completion Phase 3A Demo /Field	28May21			On target

PROJECT CASHFLOW PROJECTION

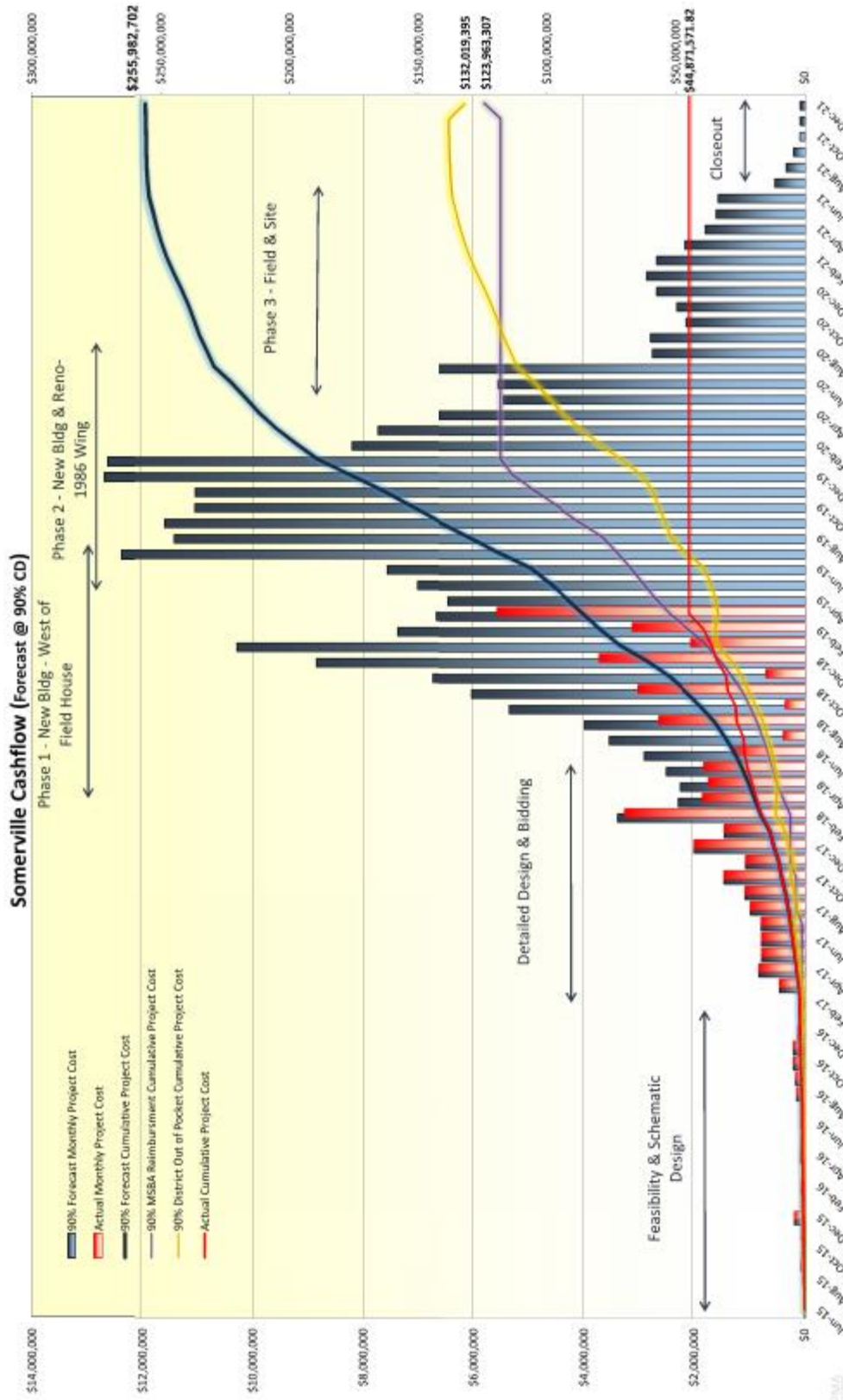

PROJECT PHOTOS

**April 14, 2018 – December 2019
Phase 1 Construction Limit of Work**

**April 2019: Rebar for Lower Level Foundation Wall
(Rebar, Forms, Bracing)**

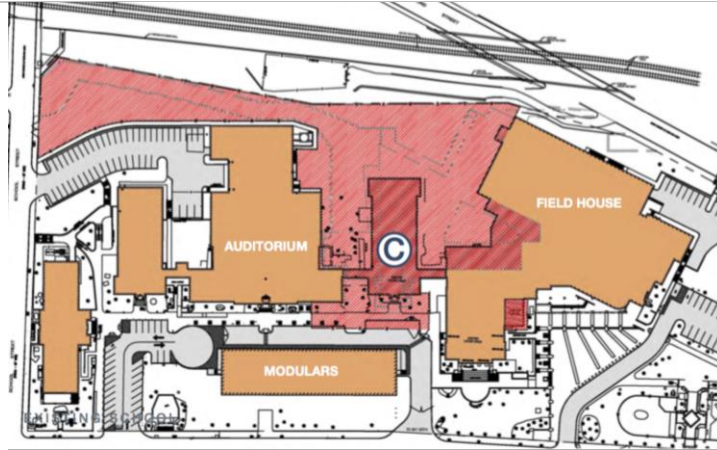

**April 2019: Lower Level Foundation Wall (Parallel to
Highland Avenue)**

**April 2019: Lower Level Foundation Wall Rebar (Next to
1895 Building)**



**April 2019: Lower Level Foundation Wall (One Sided
Forms/Bracing)**

**April 2019: Sub Level Foundation Wall (Parallel to
Highland Avenue / Rail Tracks)**

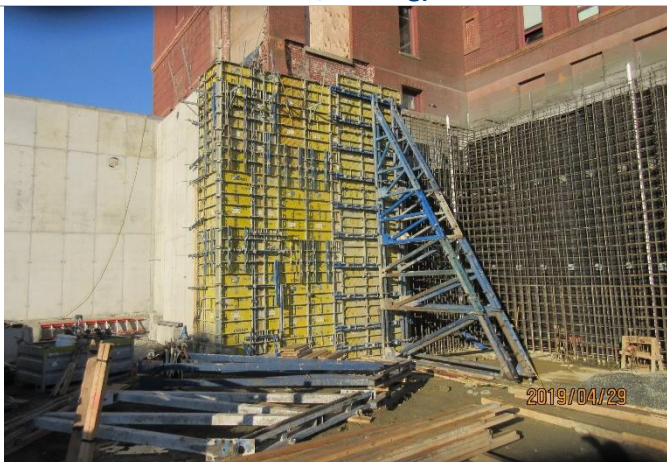

CONSTRUCTION PHASING & LIMIT OF WORK BY PHASE

Existing Condition

April 2018 – Commence Phase 1 – New Bldg West

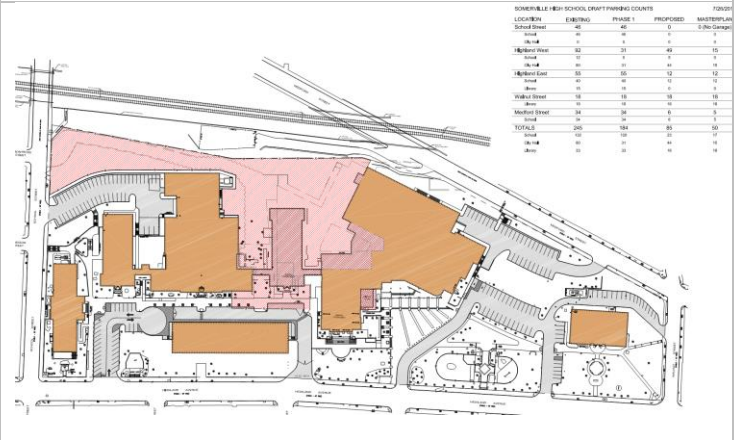
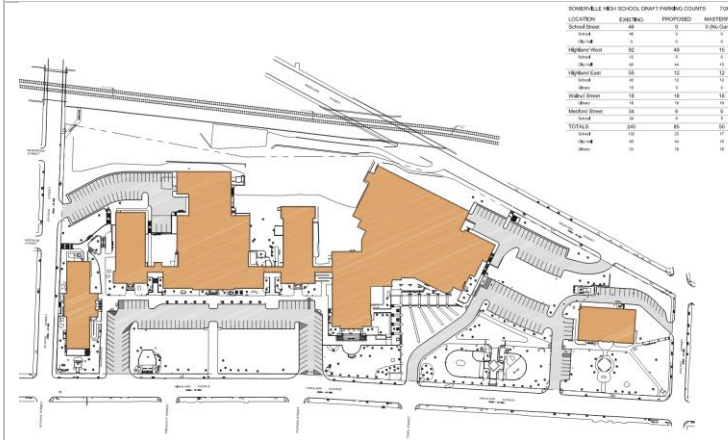

April 2019 – January 2020 – Site Improvements & Commence Phase 1A/1B

June 2019 – Commence Phase 2 – New Bldg East

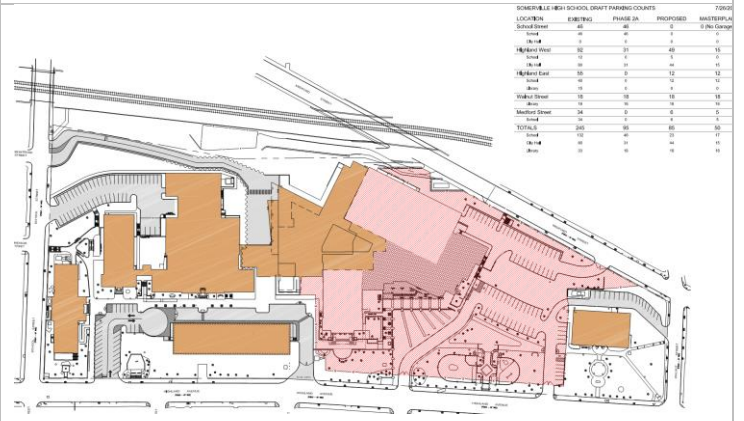
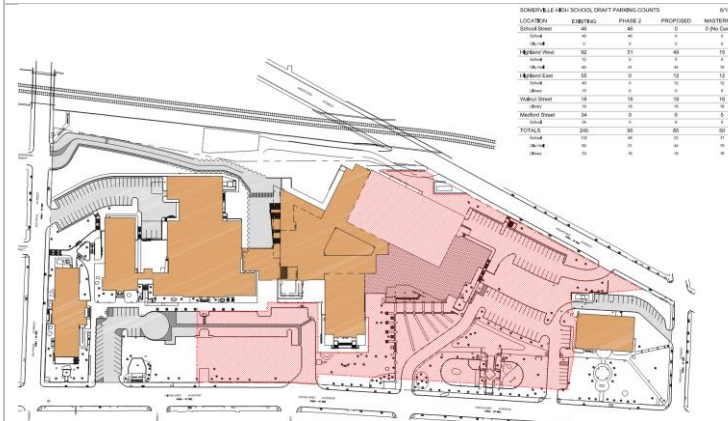

June 2020 – Commence Phase 3 – Athletic Field

Summer 2021 – High School Project Complete

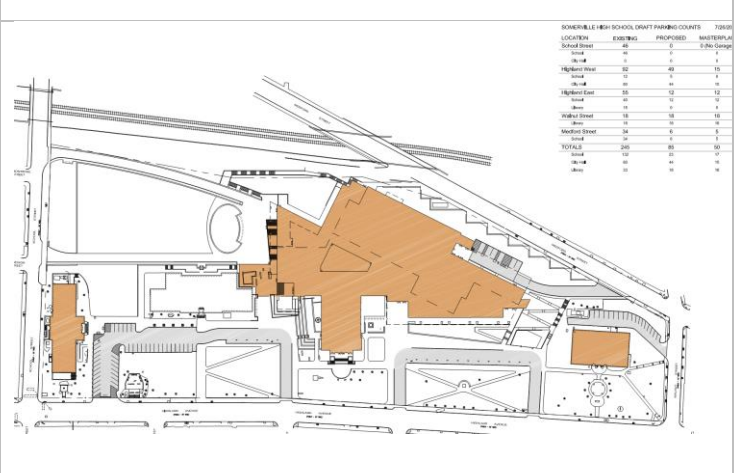
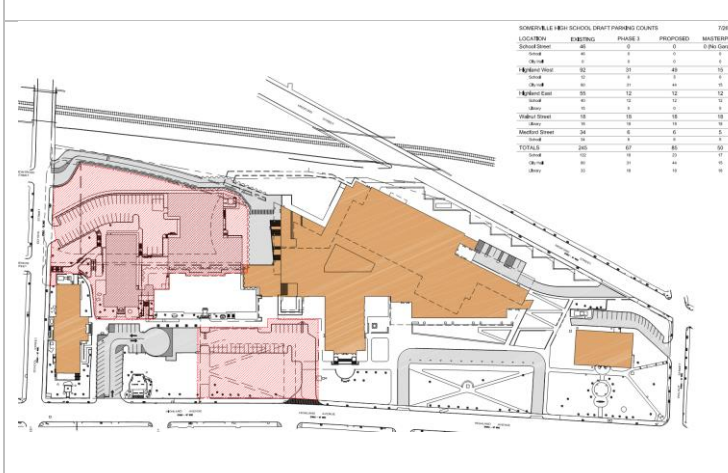

PROACTIVE MEASURES RELEVANT TO COMMUNITY INTERACTION DURING CONSTRUCTION



Conduct of Contractor Personnel

All Construction Personnel must be CORI checked. The Contractor must establish and enforce rules as are appropriate to ensure the safety of the school programs and appropriate demeanor in the presences of the students, staff, parents and other visitors. Personnel must wear identification badges when on site. Workers are forbidden from intermingling with students or entering a school occupied area except with prior approval of the Owner.



Working Hours

The Contractor is allowed to work on site between 7:00AM to 7:00PM Monday-Friday and between 9:00AM and 7:00PM on Saturdays. Work on Sunday and Legal Holidays is prohibited. Any deviation from this plan requires a request made by the contractor 72 hours in advance of the work being performed and the approval of the DPW Commissioner.



Use of Site

Site Work and Work outside the building may be performed while school is in session if it does not interfere with or impede school activities, including but not limited to arrivals and departures of students and staff, and outdoor athletic and play activities. Before performing work in any area that is immediately outside an occupied area of the building, the contractor must notify the Owner and obtain written authorization.

Any operations that would result in high levels of noise, vibration, odors or other disruption to the school must be coordinated to with school prior to the activity commencing. Any operation causing interruptions to the school activities will be stopped as required by the school.

Prior to execution of the work, the contractor is required to submit a site utilization plan, weather protection and heating plan, dust containment plan, and traffic and hauling plan.



Existing Utility Interruptions

Utilities serving the property are not allowed to be interrupted. When utilities connections need to be modified, temporary services must be provided and put in place to insure uninterrupted utility service to the school, unless otherwise approved by the Owner.



Indoor Air Quality

The contractor will develop and enforce procedures for preventing construction activities from creating unacceptable Indoor Air Quality within occupied areas. This includes use of dust protection, filters, containment, ventilation and negative air pressurization. The contractor is required to monitor work practices and have systems in place for early detection of potential Indoor Air Quality issues. The contractor is required to provide monthly monitoring of the building indoor air quality with additional monitoring required when construction operations generate higher levels of potential contaminants.



Noise Control

The contractor is required to develop and maintain a noise abatement program and enforce strict discipline over personnel to minimize noise. The must employ construction methods and equipment which reduce excess noise

