

Central Hill Campus Parking

Public Meeting
June 20, 2018

Presented by:
Mike Tremblay
Senior Transportation Planner
Transportation & Infrastructure - OSPCD



Agenda

- Review of project timeline
- Preview of 2018 Parking Study data
 - Existing supply
 - Methodology
 - Occupancy
 - Rapid collection
 - Snow
 - Next steps
- Off-site Lot Considerations
- Resident Survey
- Question and Answer

Changes to Central Hill over 3-year Period: Timing & Amount of Parking Loss

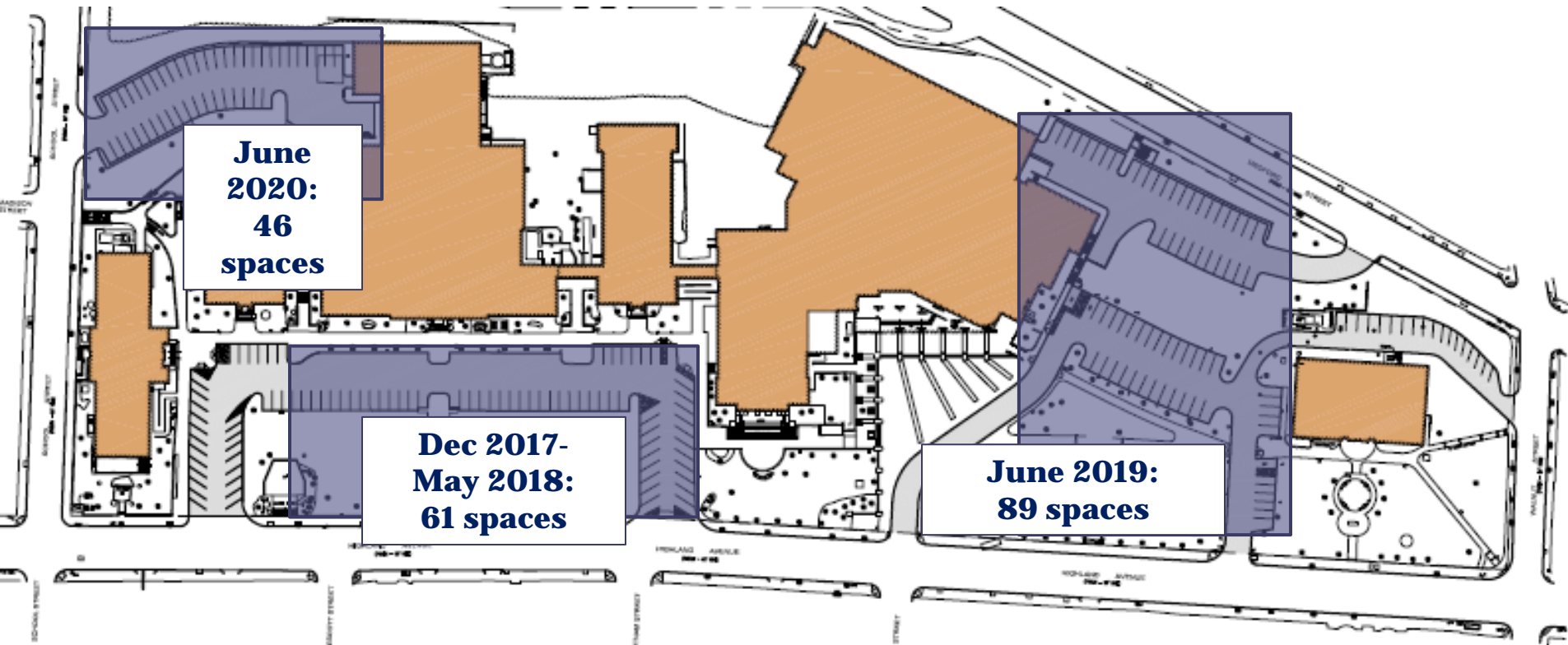

Pre-project: 245 total spaces
Post-project: ~85 total spaces

Study Area- Street Sweeping Zones

Engineers + Planners



Study Area- Parking Regulations

Engineers + Planners



What data was collected?

- Two “typical” Tuesdays (no street sweeping)
- One day during each street sweeping period (arterials, Zone 1, Zone 2)
- Nighttime periods during “light” and “significant” nighttime activity on campus
 - “Heavy” nighttime event to be collected in September
- “Rapid collection” every half hour on key study area streets
- Spot counts 1-4 days after snowstorms in January/March



Existing Supply Inventory

- **Length of legal on-street parking curb measured between each exclusion:**
 - No Parking regulations
 - MBTA bus stops
 - Fire hydrants
 - Driveways
 - Crosswalks
 - Intersections
 - Bridges
- **18 feet per parking space, with a minimum of 15 feet for single spaces**



Existing Supply Inventory

■ Exclusions:

- Within 2 feet of a driveway
- Within 10 feet of a fire hydrant
- Within 10 feet of a crosswalk
- Within 20 feet of an intersection



Illegal parking along Pearl Street.



Existing Supply Inventory

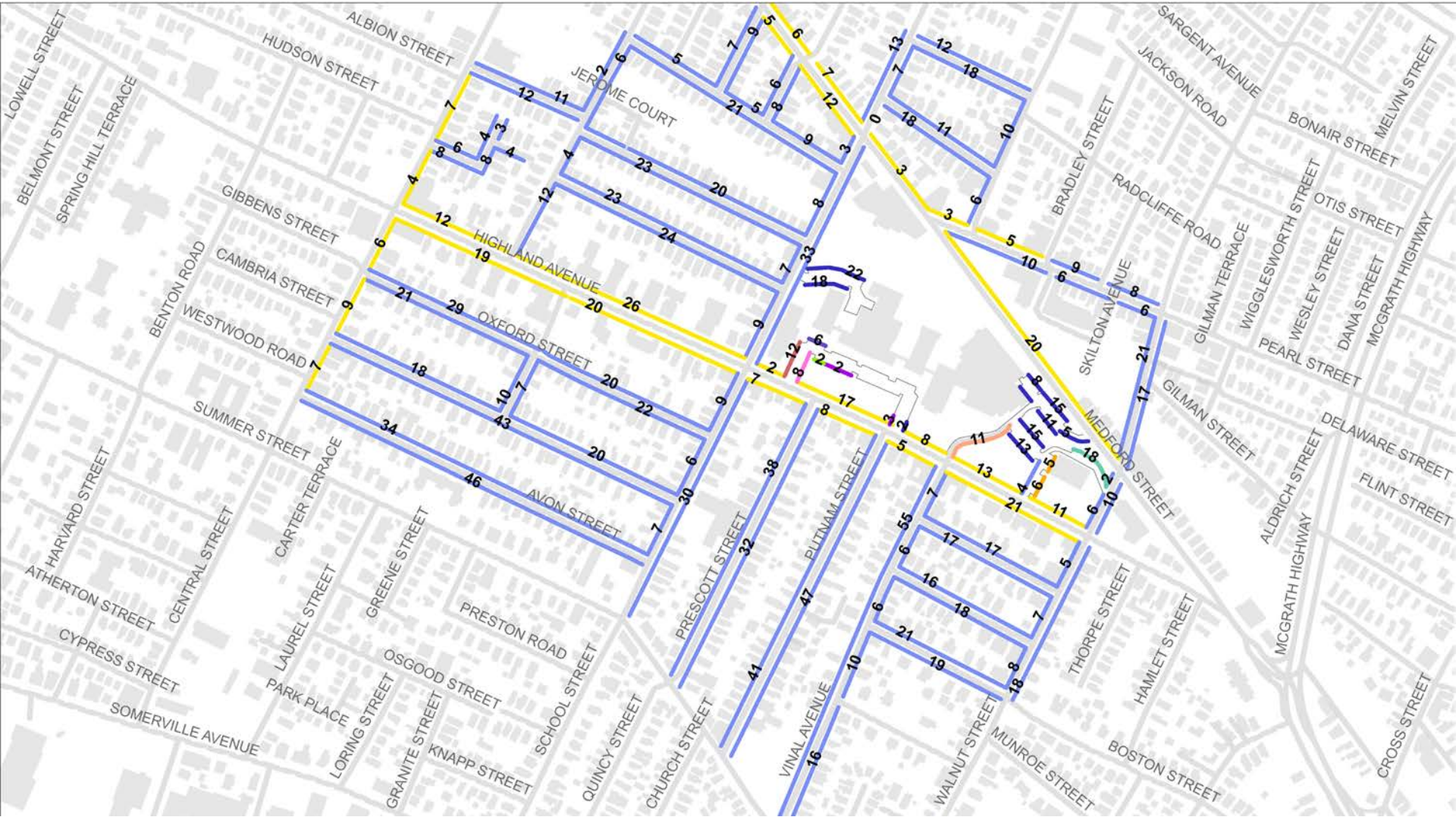

Occupancy by Time and Day

Engineers + Planners

Day	Tuesday, May 8	Monday, May 14	Tuesday, May 15	Thursday, May 17	Tuesday, May 22	Thursday, May 24
a.m.	68%	69%	65%	65%	-	-
Midday	64%	63%	65%	60%	-	-
p.m.	64%	75%	-	68%	78%	67%

■ This data was taken:

- On days unaffected by street sweeping
- Before the school year ended for seniors
 - *Last day was May 25*
- Varied nighttime activity
 - *Tuesday May 22 – Highlander Awards Night and BoA Finance Committee Meeting*
 - *Thursday May 24 – Evening of Song and BoA Regular Meeting*



Occupancy on Monday May 14, AM Peak

Engineers + Planners

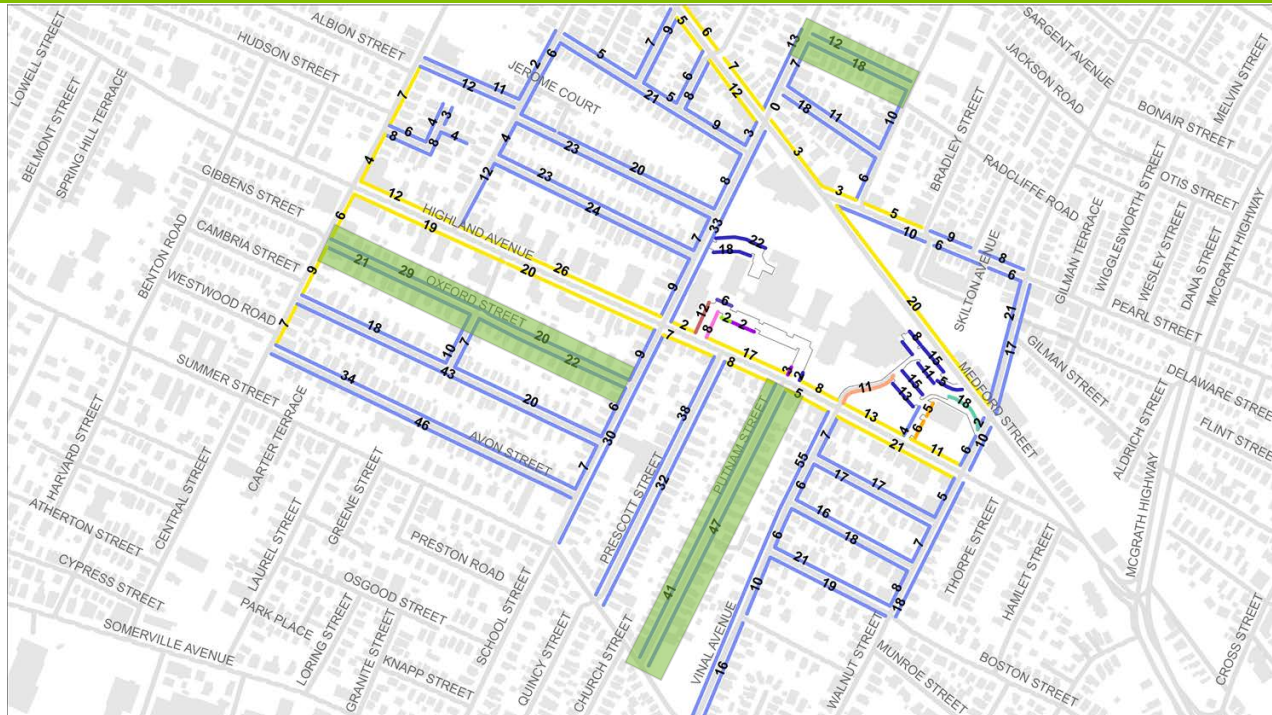

Street	Occupied	Vacant	Occupancy Rate	Deviation from Average (68.8%)
Putnam Street	57	31	64.8%	-4%
Oxford Street	57	35	62.0%	-8.8%
Stickney Avenue	31	0	100%	+31.2%



Occupancy on Tuesday May 15, Midday

Engineers + Planners

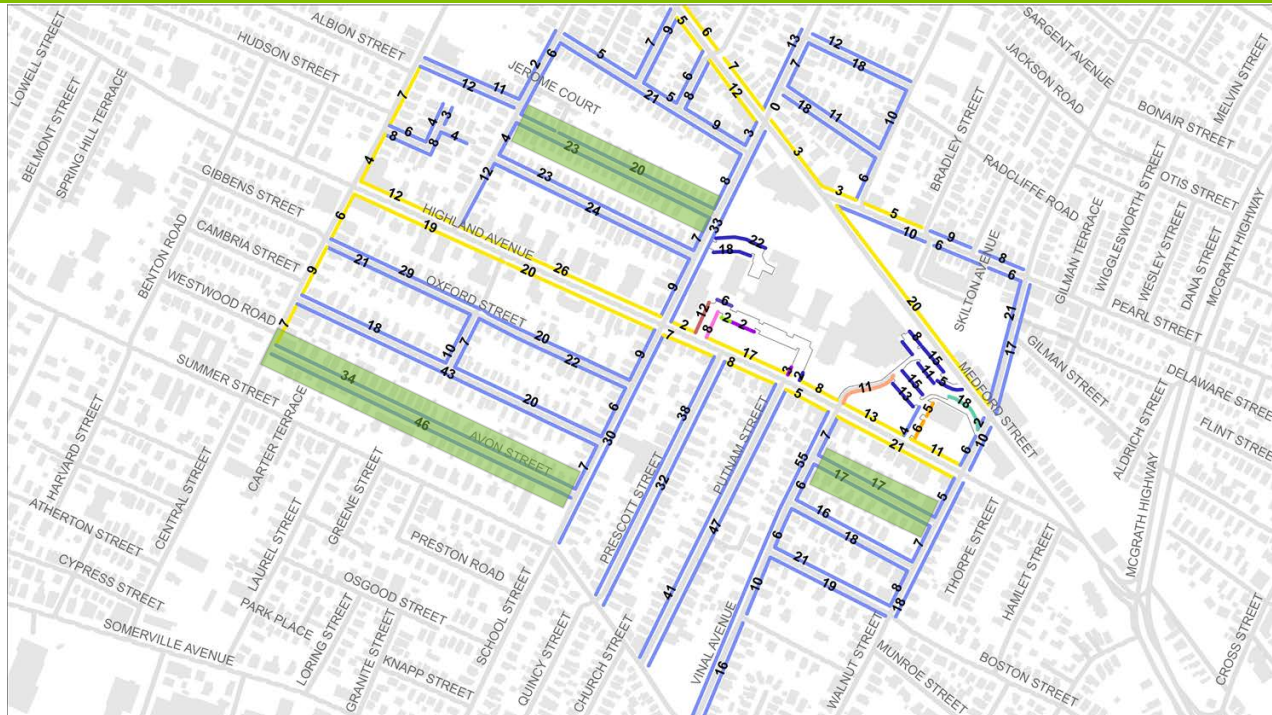

Street	Occupied	Vacant	Occupancy Rate	Deviation from Average (65.1%)
Montrose Street	41	2	95.3%	+30.2%
Pleasant Avenue	17	17	50.0%	-15.1%
Avon Street	42	38	52.5%	-12.6%



Occupancy on Tuesday May 22, PM Peak*

Engineers + Planners



Street	Occupied	Vacant	Occupancy Rate	Deviation from Average (77.7%)
Highland Ave	154	15	91.1%	+13.4%
School Street	75	57	56.8%	-20.9%
Sycamore Street	28	0	100%	+22.3%

- 6:30PM During Evening Meeting at City Hall – Finance Committee of the Whole and event at SHS Auditorium – Awards Night



HOWARD STEIN HUDSON

Rapid Collection (method)

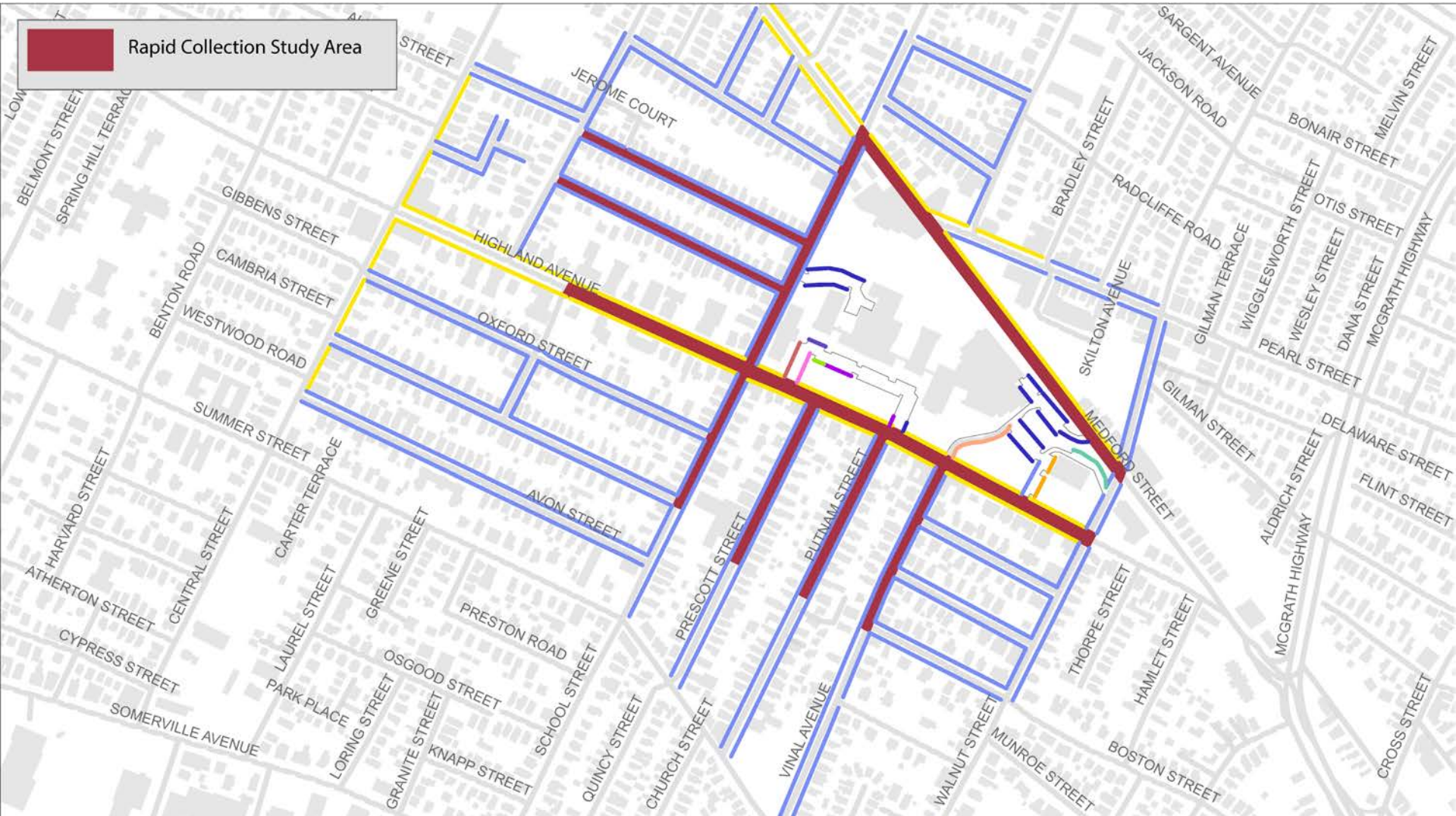

Rapid Collection- AM (Sample Streets)

Engineers + Planners



Street	7:30 a.m.	8:00 a.m.	8:30 a.m.
Prescott Street (43 spaces)	27 (63%)	29 (67%)	28 (65%)
Highland Avenue (131 spaces)	91 (69%)	96 (73%)	116 (89%)
Madison Street (47 spaces)	41 (87%)	32 (68%)	46 (98%)



Rapid Collection- Monday, May 14 (7:30a.m.)

Engineers + Planners

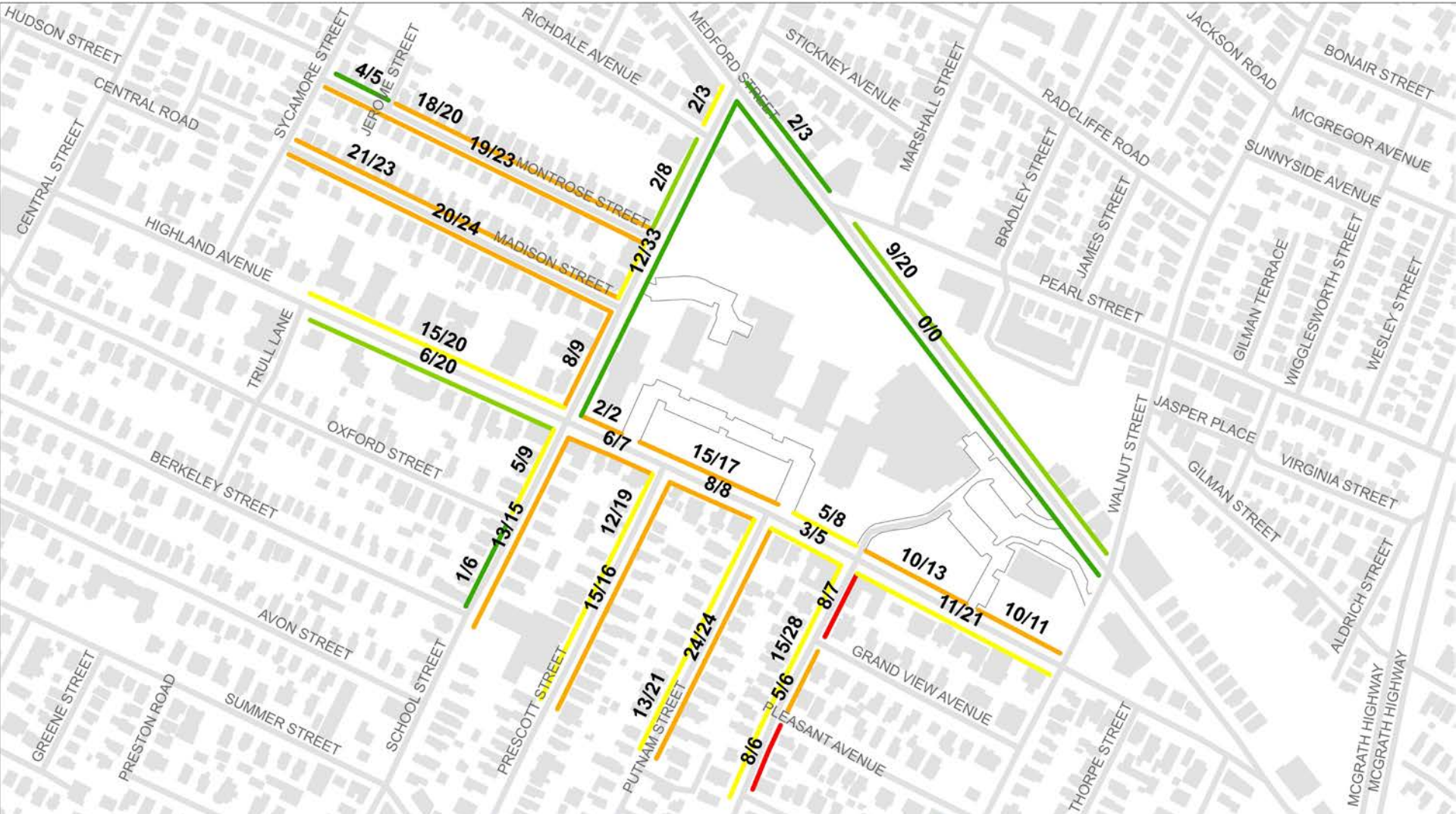

Rapid Collection- Monday, May 14 (8:00a.m.)

Engineers + Planners



Rapid Collection- Monday, May 14 (8:30a.m.)

Engineers + Planners

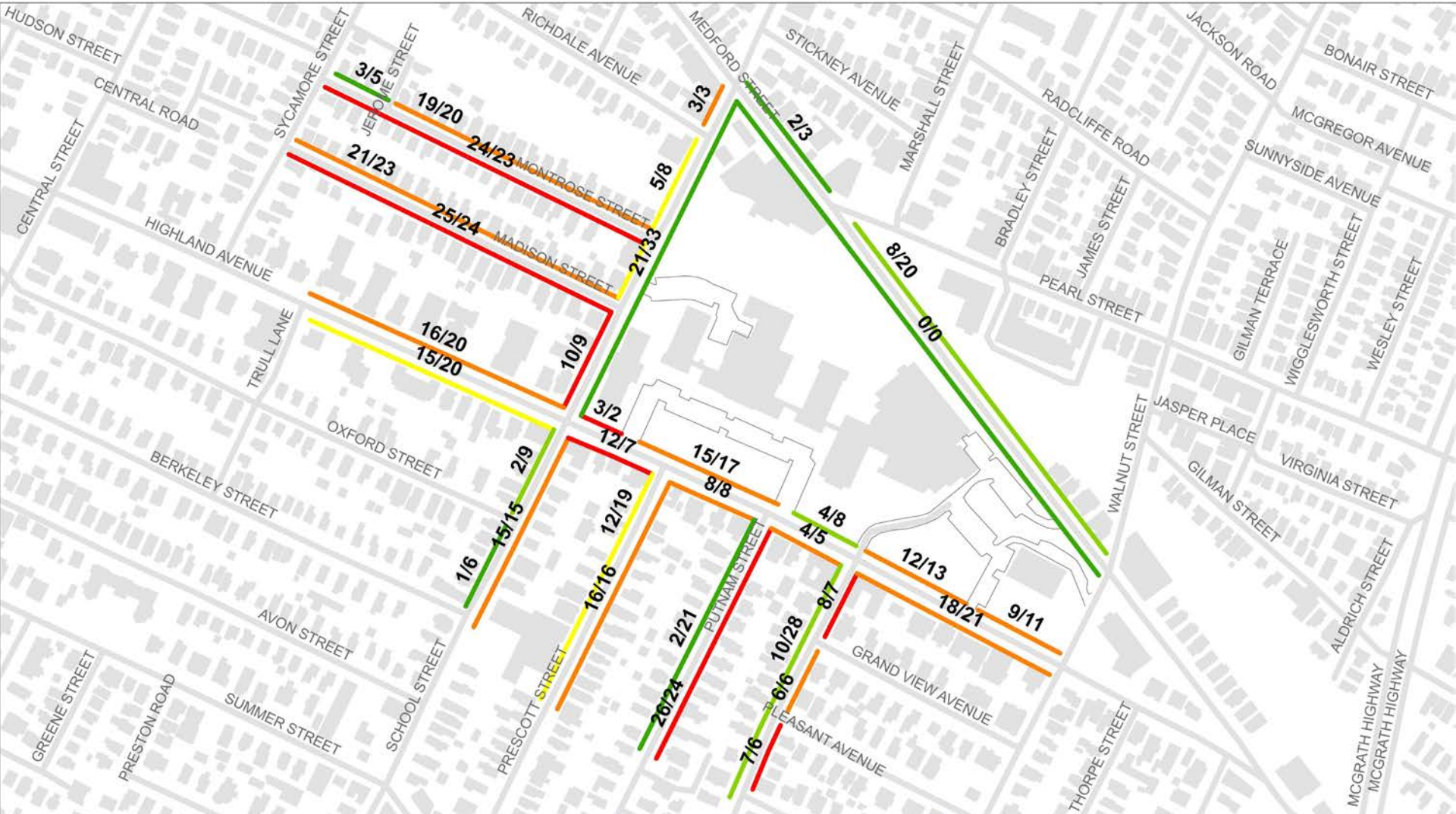

Rapid Collection- AM (Study Area)

Engineers + Planners

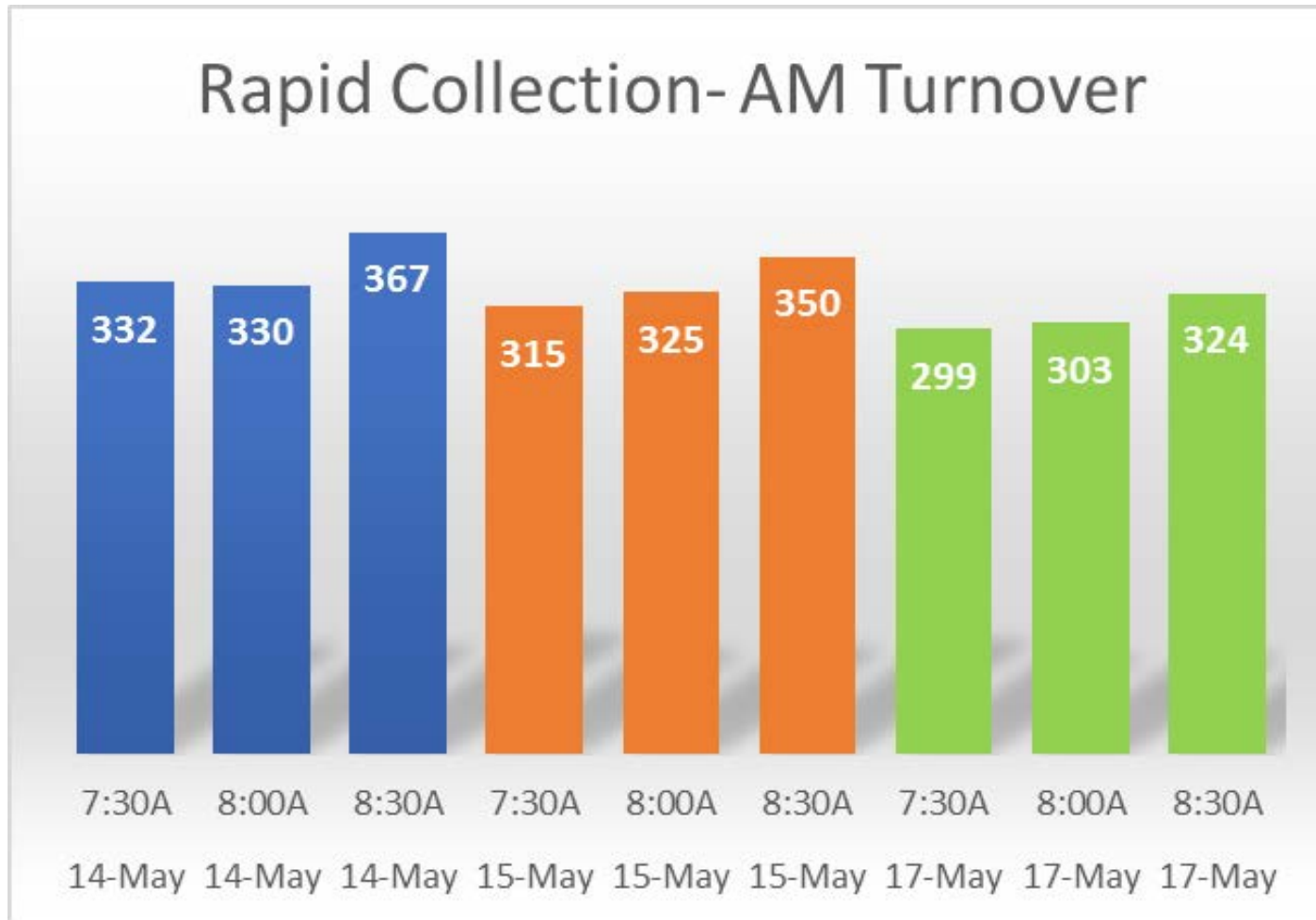

Next Steps

- **Finish analyzing data**

- Street sweeping days
- Comparison to 2017 study data

- **Collect additional data**

- Survey of residents
- Survey of City and School staff upcoming
- Parking counts during major SHS event – Parent-Teacher night in September
- More complete parking counts after snow event





Potential Parking Demand Management strategies

- Subsidized MBTA passes
- Provide Hubway passes
- Carpool ride matching and incentives
- Additional City vehicles for staff use
- Shuttle from MBTA stations
- Provide parking “stipend”
- Carpool spaces
- Provide showers/lockers
- Manage staff arrival/departure times
- Zone residential parking in vicinity of campus/future Gilman Square station
- Encourage Work from Home



Potential Parking Supply strategies

- Acquire parking lots/ land for parking lots within walking distance
- Satellite lots
- Shuttle services
- Allow employees to park along 80 and 88 bus routes
- Further manage parking zones to accommodate employees who can't walk long distances
- Revisit street sweeping zones/frequency

Off-site lot considerations

- Homan's Building
 - 750 feet from existing School Street lot
 - Most of site to be used by GLX
 - Potentially ~20 spaces
 - Potentially available this summer
 - Temporary – Available until GLX done



- Other lots
 - Considering RFP to explore potential lease or purchase of off-site lots
 - Competitive process required unless spaces are free to the city
 - Some lots may not be possible due to zoning
 - Design Consultants lot, Hamlet Street, ABJ Auto all mentioned as possibilities
 - Some sites may be



Resident Survey

Resident survey live at somervillema.gov/shsparking

Survey intended to discover resident parking patterns and satisfaction with level of availability of on-street parking

Direct survey link:

<https://www.surveymonkey.com/r/CentralHillParkingSurveyResidents>

Printed versions available at City Hall

Spanish, Portuguese, and Haitian Creole versions available

Discussion

Occupancy by Permit Type (method)

- Vehicle permits tallied for each block
- Time Periods
 - 6:00-7:30AM
 - 9:00AM-12:00PM
 - 6:30-8:00PM
- Days
 - Tuesday, May 8
 - Monday, May 14
 - Tuesday, May 15 (no PM)
 - Thursday, May 17 (PM only)

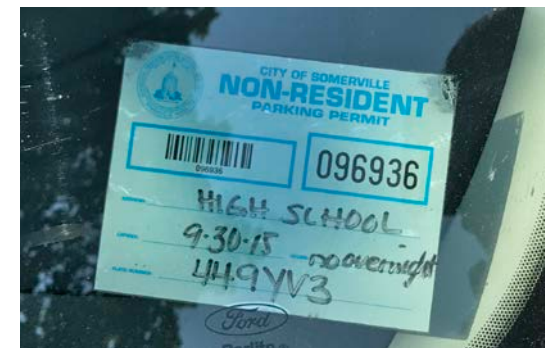

Snow Parking Capacity

Winter 2018 Spot Counts

- Primary purpose to estimate approximate reduction in usable spaces due to snow
- Spot study by City staff prior to full consultant study
- Would apply to the days before DPW is able to remove snow from parking lane
- Walnut, Vinal, Putnam, and Prescott



Snow Parking Capacity

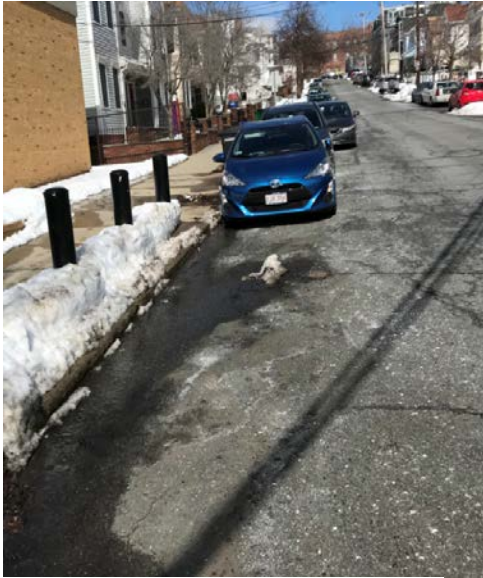

Counted as a space



Not counted as a space



Counted as a space

Snow Parking Capacity

	Monday, January 8 4 days after "Bomb Cyclone"		Wednesday, March 14 One day after 15" blizzard No School				Thursday, March 15 Two days after 15" blizzard School in session			
Street	<u>Prescott</u> 2-way 32ft	<u>Putnam</u> 2-way 32ft	<u>Prescott</u> 2-way 32ft	<u>Putnam</u> 2-way 32ft	Vinal 1-way NB, 28ft	Walnut* 1-way NB, 26ft	<u>Prescott</u> 2-way 32ft	<u>Putnam</u> 2-way 32ft	Vinal 1-way NB, 28ft	Walnut* 1-way NB, 26ft
No Snow Capacity	67	81	67	81	105	42	67	81	105	42
Snow Capacity	33	61	41	67	88	21	56	81	102	28
Spaces lost due to snow	34	20	26	14	17	21	11	0	3	14
% lost due to snow	51%	25%	39%	17%	16%	50%	16%	0%	3%	34%