

CMU

**CENTRAL MICHIGAN
UNIVERSITY**

CMU Health Professions Building Addition

Exterior Elevations



SOUTH ELEVATION - SCHEMATIC MATERIALS

CMU Health Professions Building Addition

First Floor

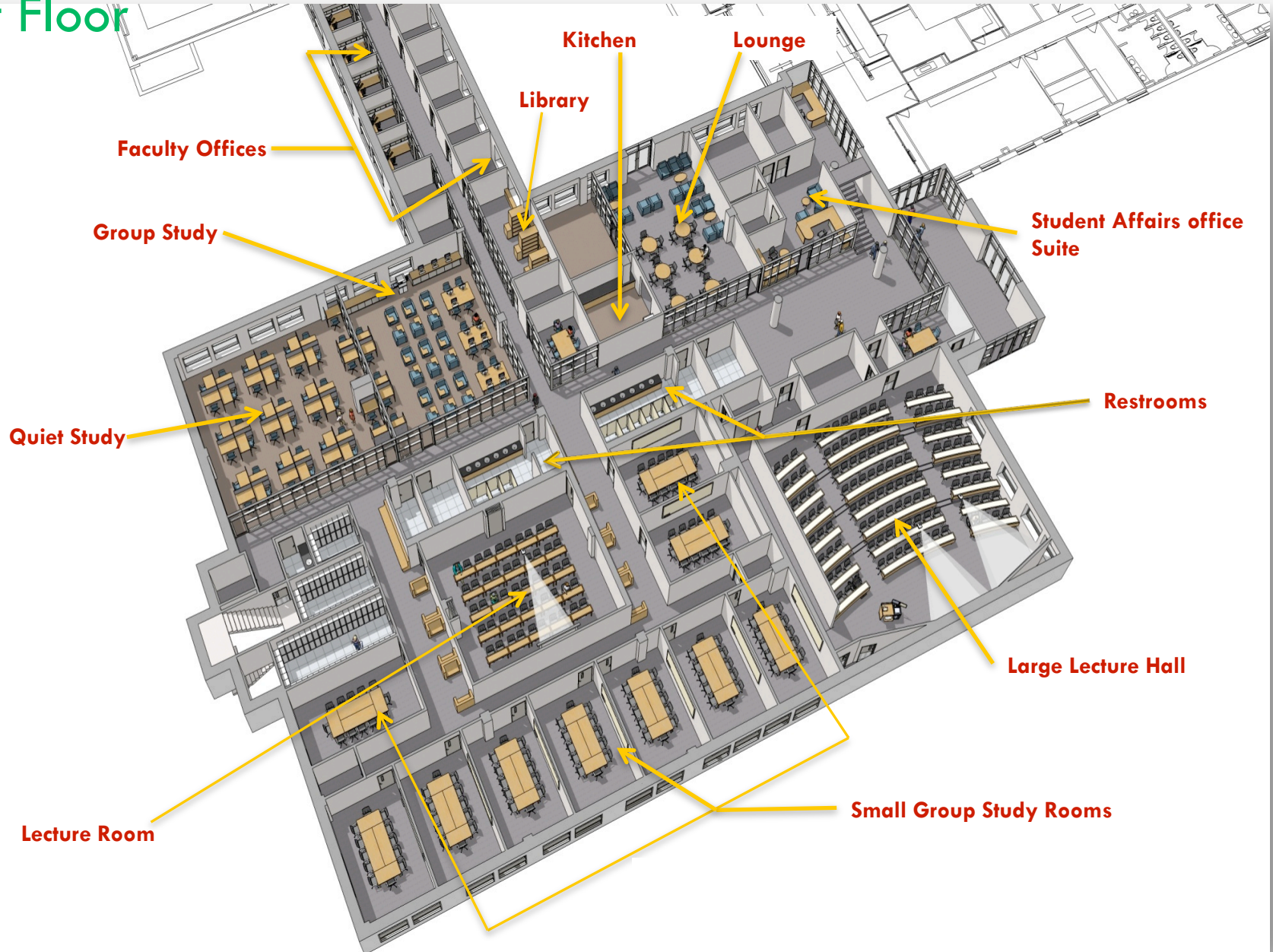

CMU Health Professions Building Addition

Second Floor

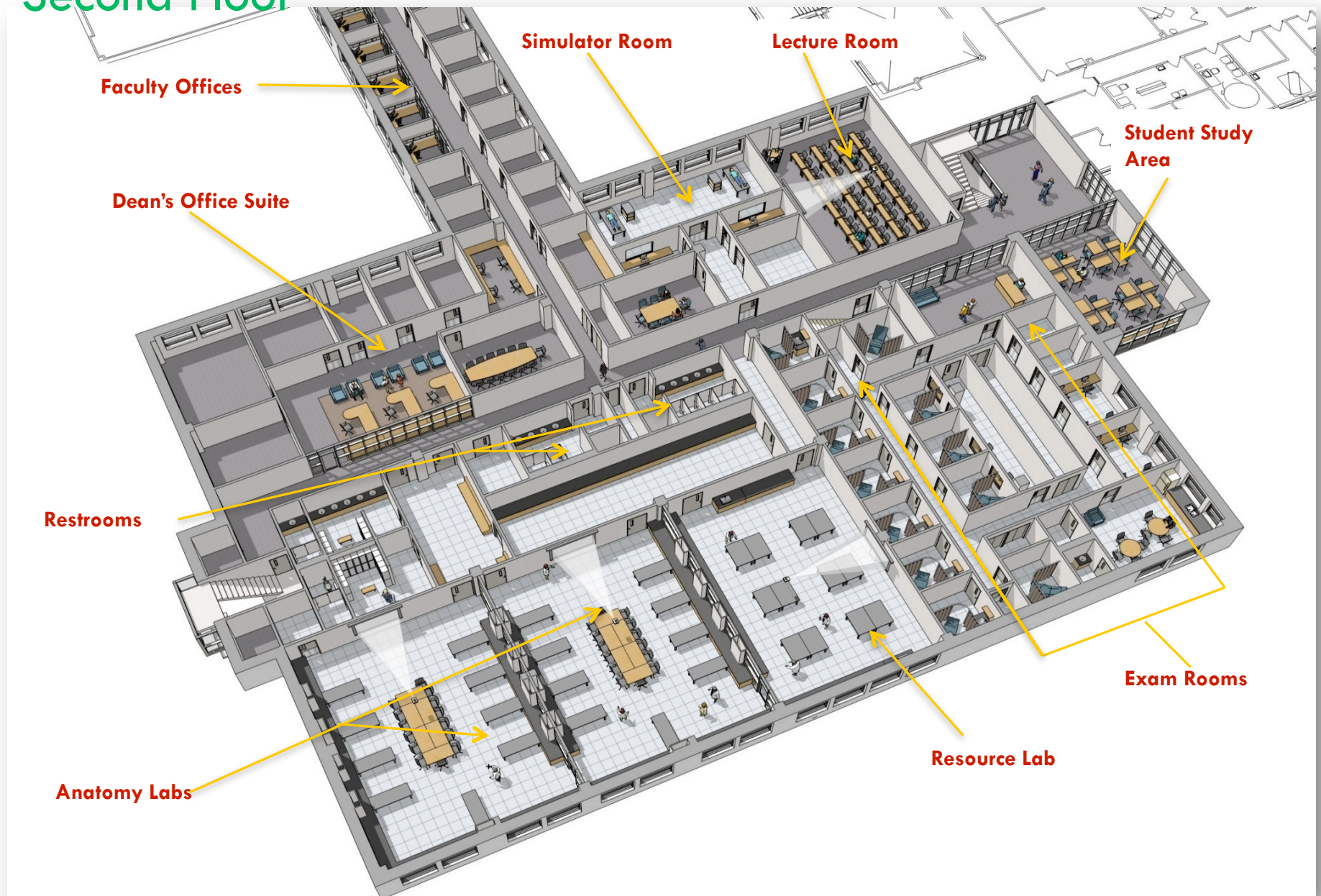

School of Medicine Facility

- Approx. 60,000 sq. ft. addition to HP Building
 - Teaching Space: 20,905 sq. ft.
 - Lecture Hall (125 person)
 - Small Group Rooms (11)
 - Discussion Rooms (2)
 - Cadaver Lab (2)/Resource Room
 - Simulation Rooms (2)
 - Clinical Skills Exam Rooms (12)
 - Faculty/Administrative Space: 6,770 sq. ft.
 - Student Affairs (admissions/financial aid)
 - Faculty Offices (25)
 - Dean's Office
 - Student Services Space: 7,200 sq. ft.
 - Library – Collection/Reserves
 - Learning Commons
 - Quiet Study
 - Lounge/Kitchen
- \$24M total cost (University Reserves, Gifts, Grants)
- School of Medicine initial use then revert to College of Health Professions