

## Hynes Convention Center ROOM 312

**Theatre Seating: 500**

**Length: 56'10"**

**Width: 70'2"**

**Area (sq ft): 3,987**

**Ceiling Height: 18'**

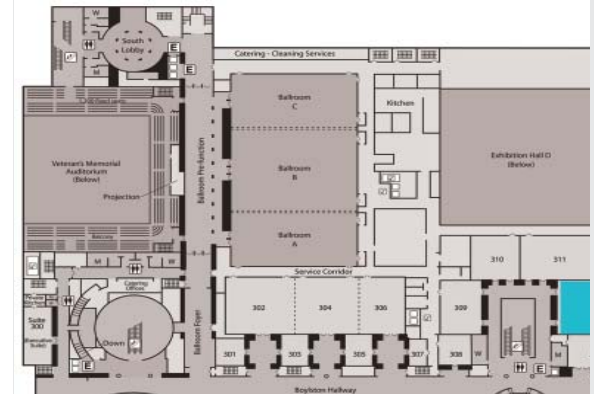
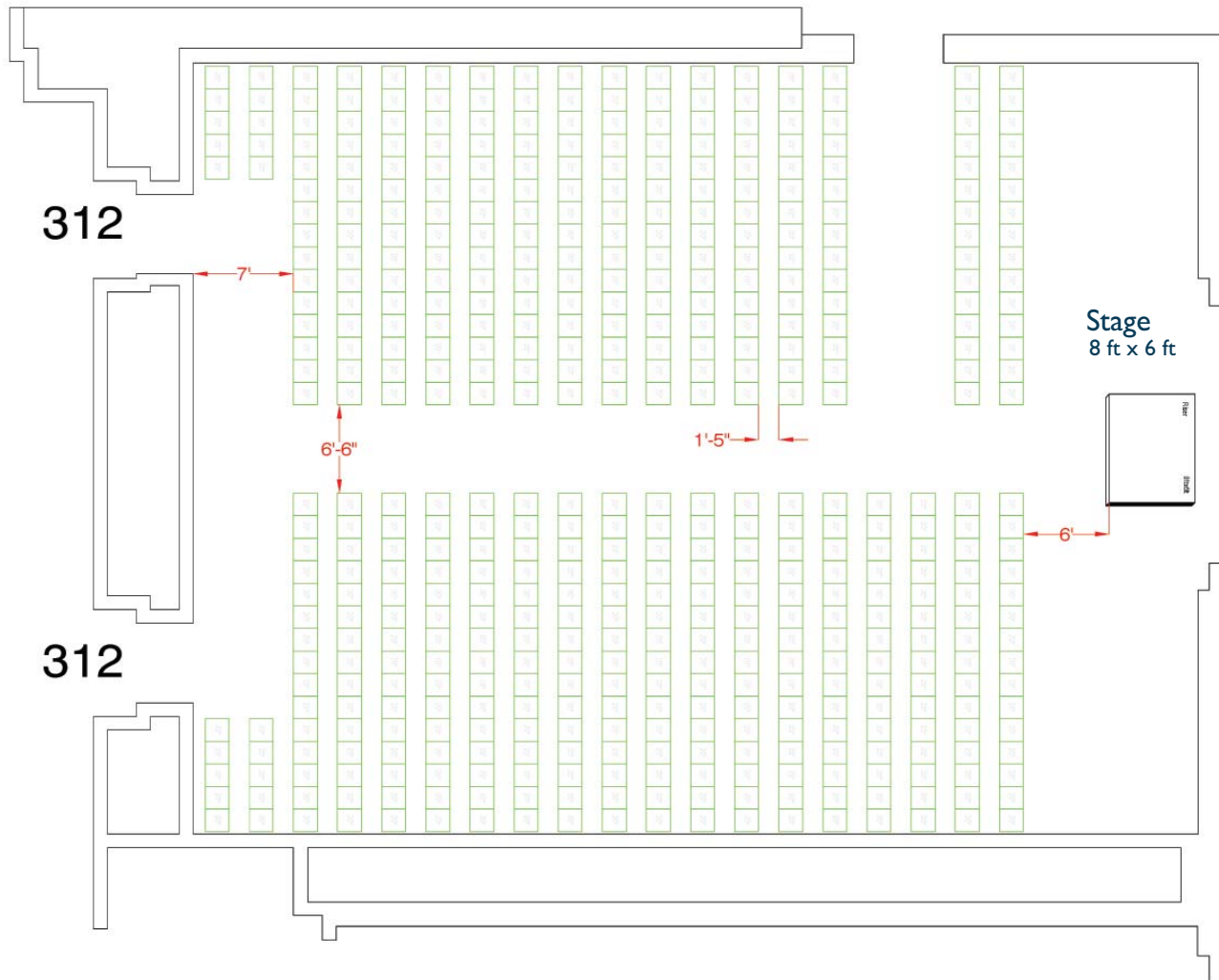

Location within the  
Hynes Convention Center

*Signature*  
**BOSTON™**

## Hynes Convention Center ROOM 312

**Classroom Seating: 308**

**Length: 56'10"**

**Width: 70'2"**

**Area (sq ft): 3,987**

**Ceiling Height: 18'**

**Tables: 28 6' x 18" and 56 8' x 18" tables**

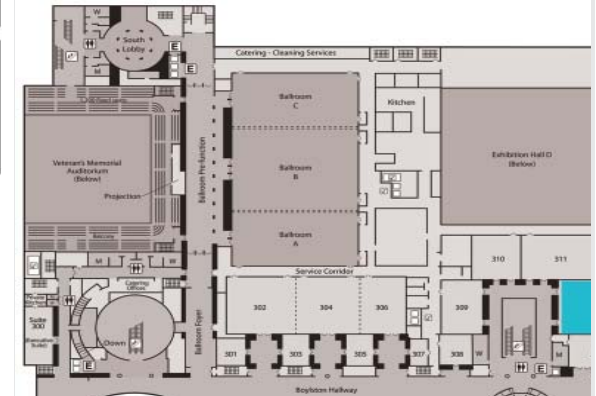
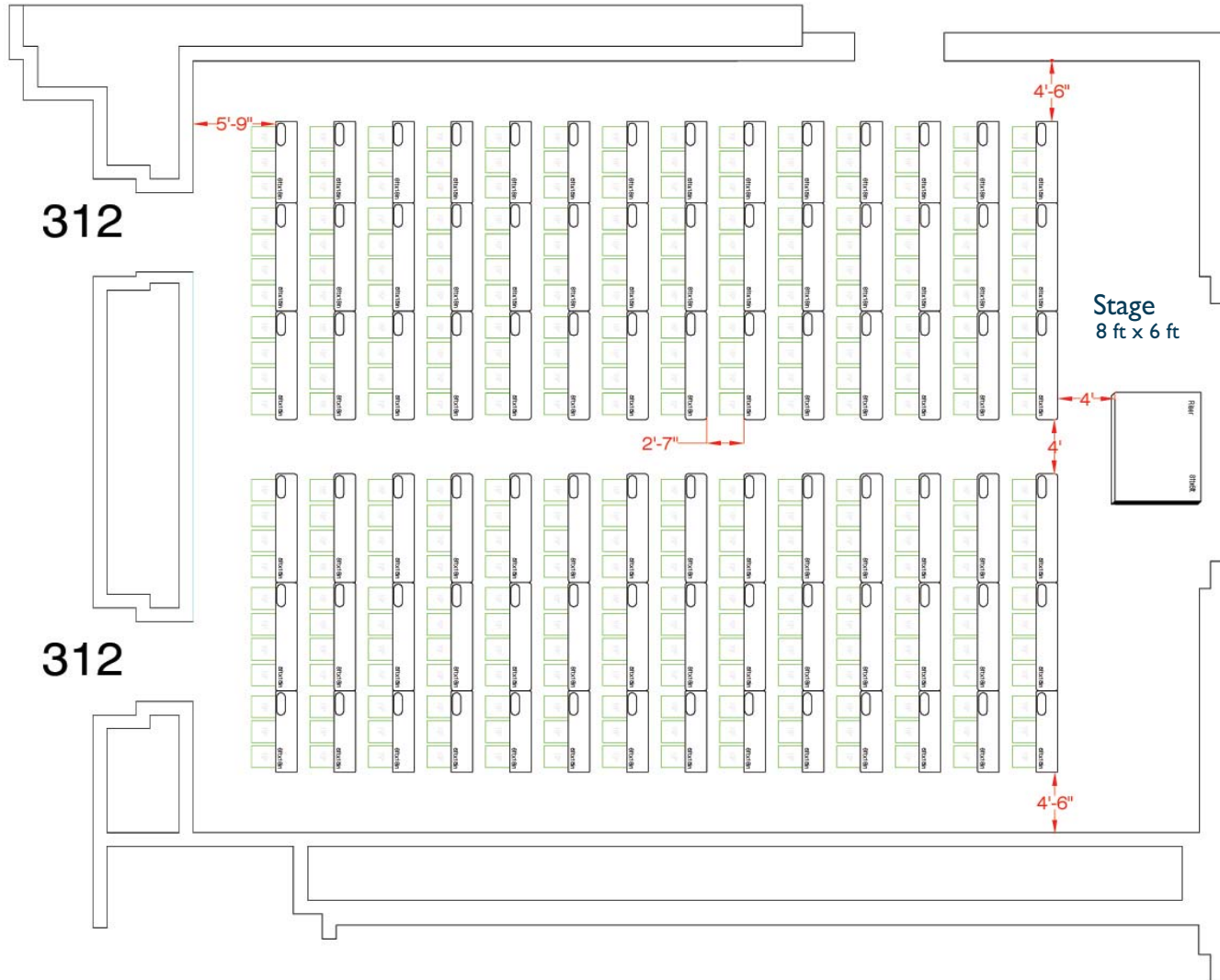

Location within the  
Hynes Convention Center

*Signature*  
**BOSTON™**

**Hynes Convention Center**  
**ROOM 312**

**Banquet Seating: 300**

**Length:** 56'10"

**Width: 70'2"**

**Area (sq ft):** 3,987

**Ceiling Height: 18'**

**Tables:** 30 rounds of 10

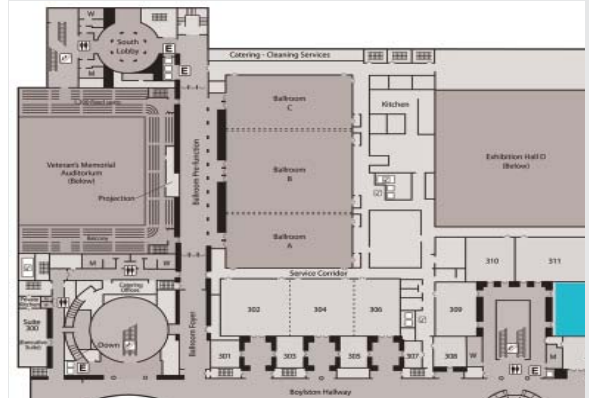
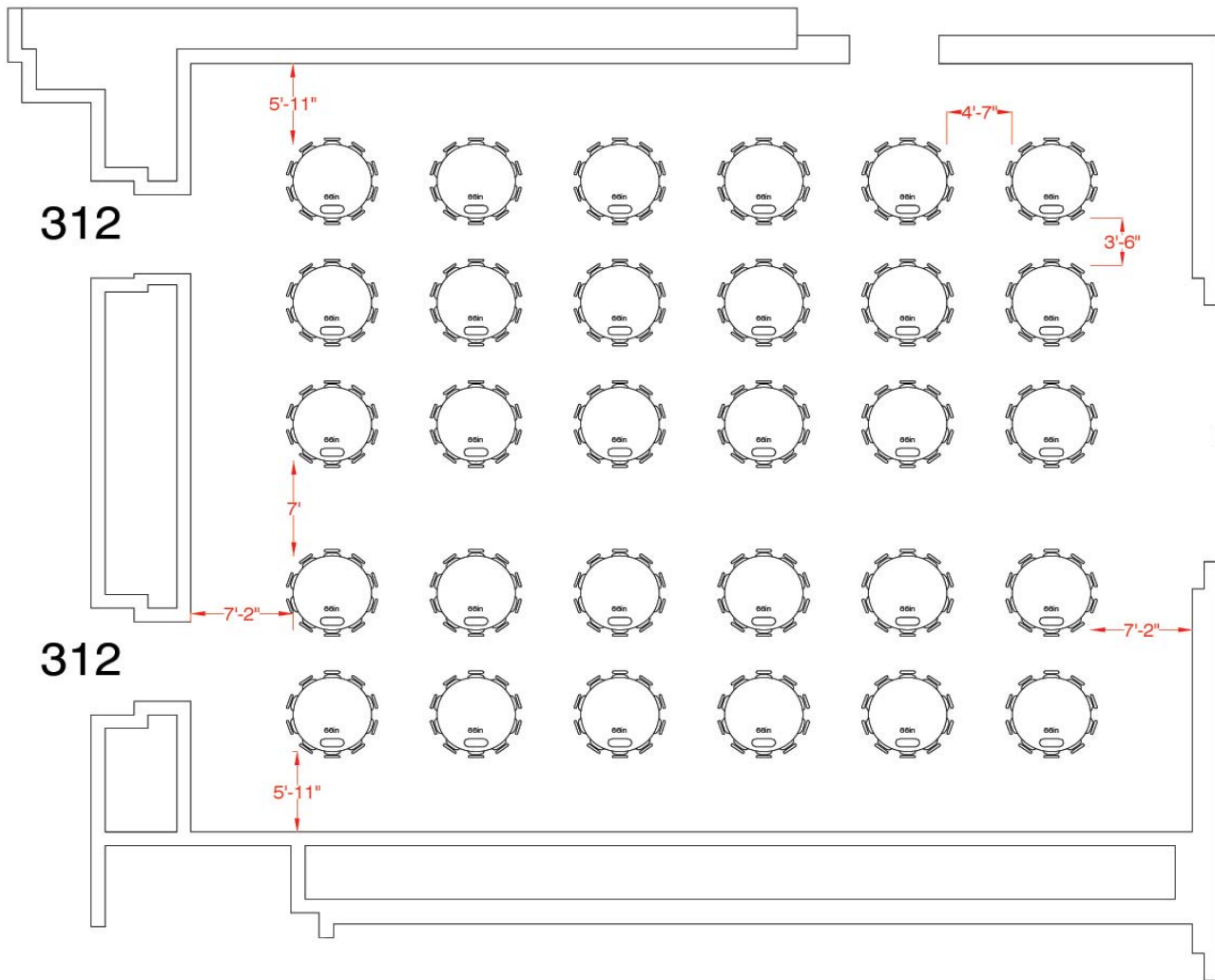

Location within the  
Hynes Convention Center

The logo for Signature BOSTON, featuring the word "Signature" in a blue script font and "BOSTON" in a bold, red, sans-serif font.