

## Hynes Convention Center ROOM 300

**Theatre Seating: 192**

**Length: 63'6"**

**Width: 23'6"**

**Area (sq ft): 1,492**

**Ceiling Height: 20'6"**

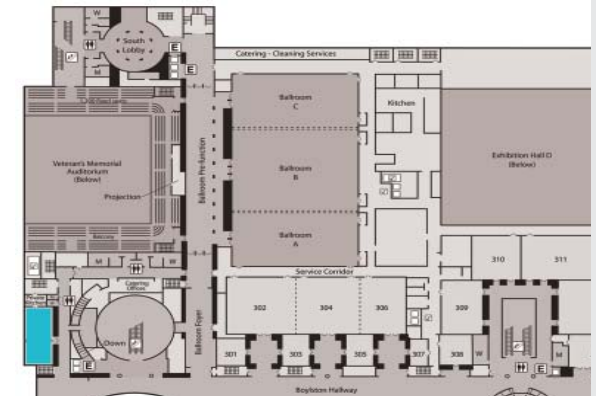

Location within the  
Hynes Convention Center

*Signature*  
**BOSTON™**

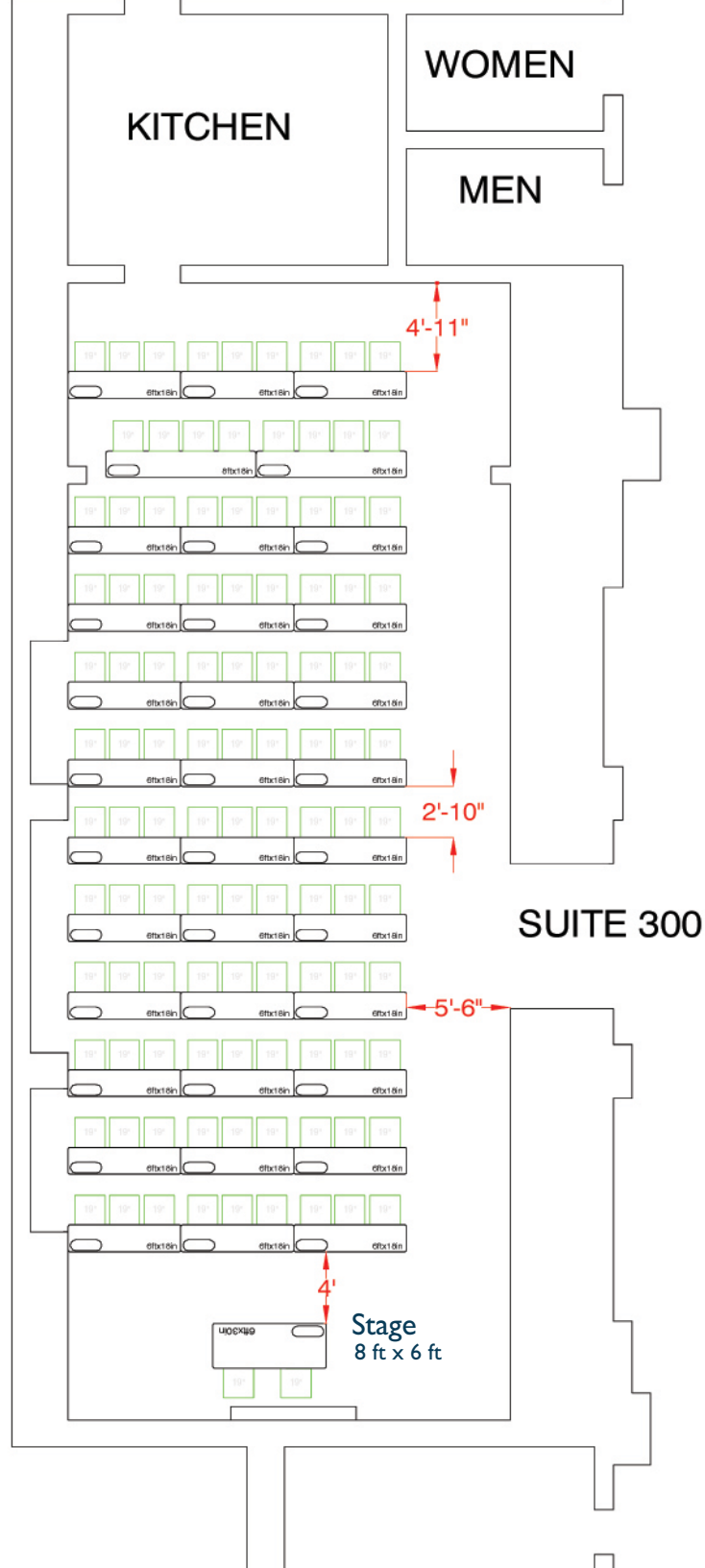

## Hynes Convention Center ROOM 300

### Classroom Seating: 107

Length: 63'6"

Width: 23'6"

Area (sq ft): 1,492

Ceiling Height: 20'6"

Tables: 33 6' x 18" and 2 8' x 18" tables

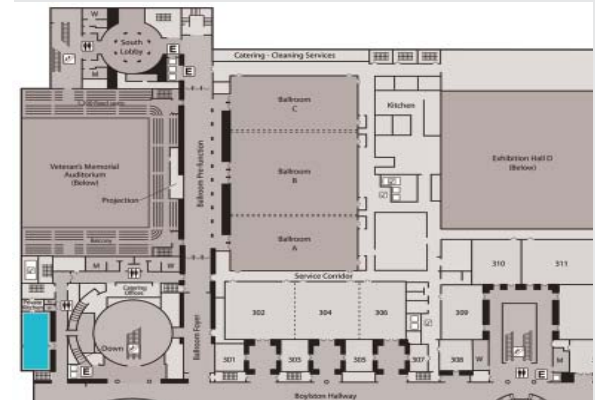

Location within the  
Hynes Convention Center

*Signature*  
**BOSTON™**

MEN

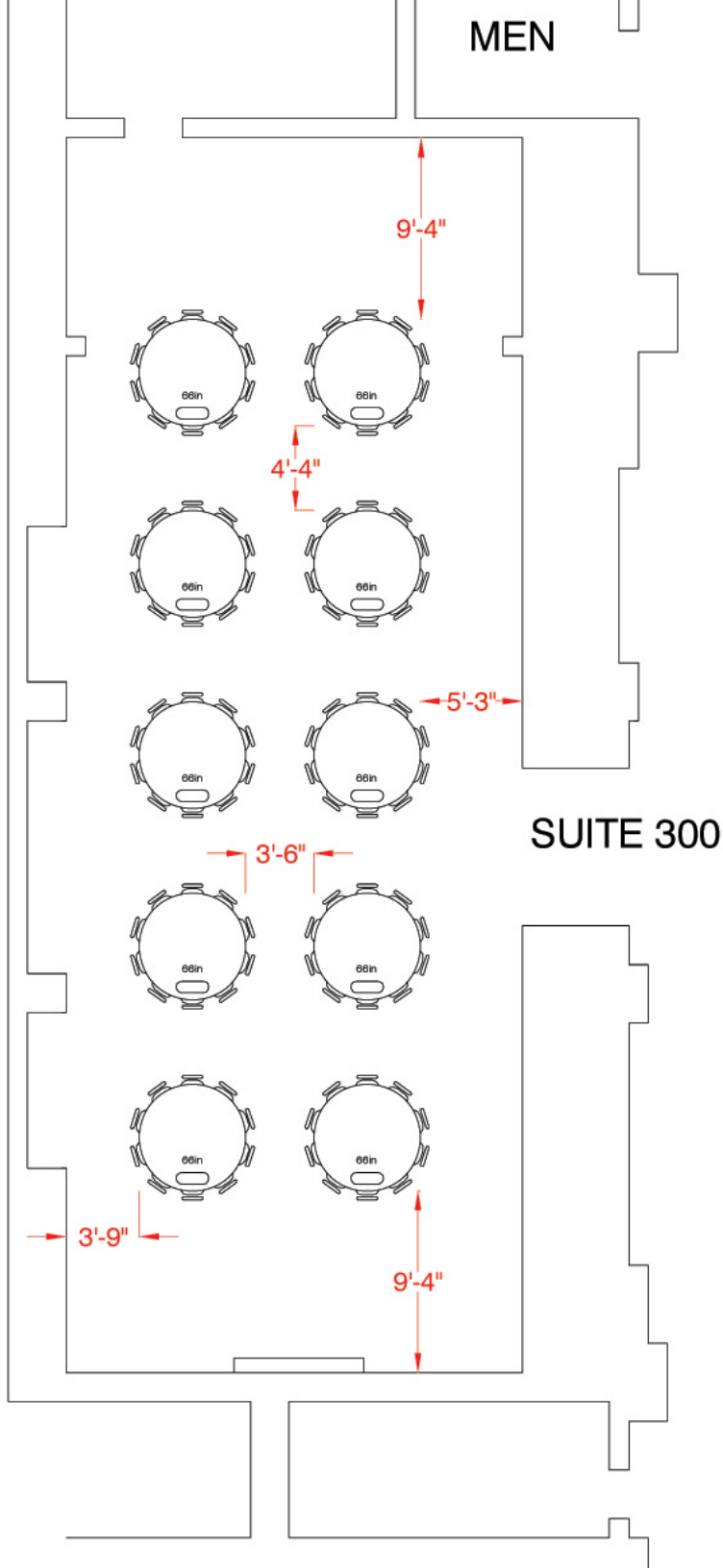

## Hynes Convention Center ROOM 300

**Banquet Seating: 100**

**Length: 63'6"**

**Width: 23'6"**

**Area (sq ft): 1,492**

**Ceiling Height: 20'6"**

**Tables: 10 rounds of 10**

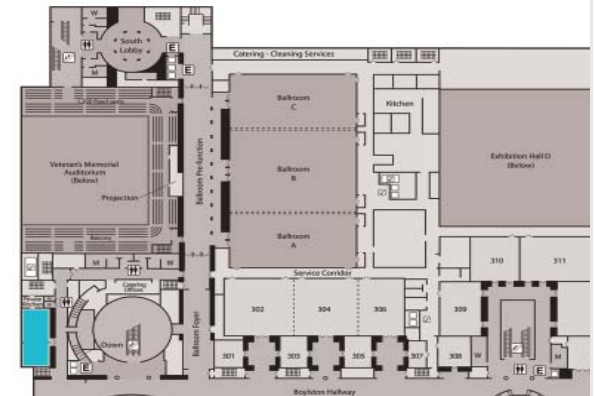

Location within the  
Hynes Convention Center

*Signature*  
**BOSTON™**