

# Hynes Convention Center ROOM 207

**Theatre Seating: 310**

**Length: 56'9"**

**Width: 38'6"**

**Area (sq ft): 2,184**

**Ceiling Height: 18'**

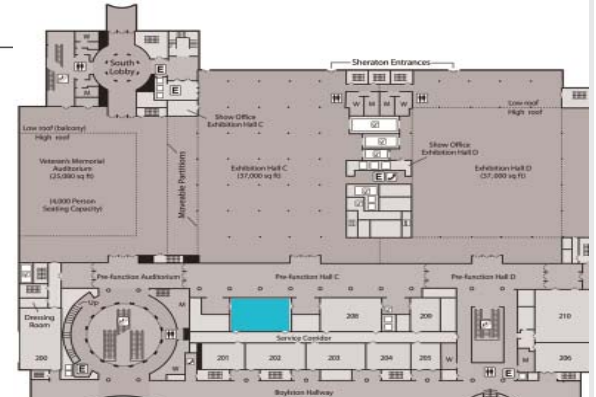
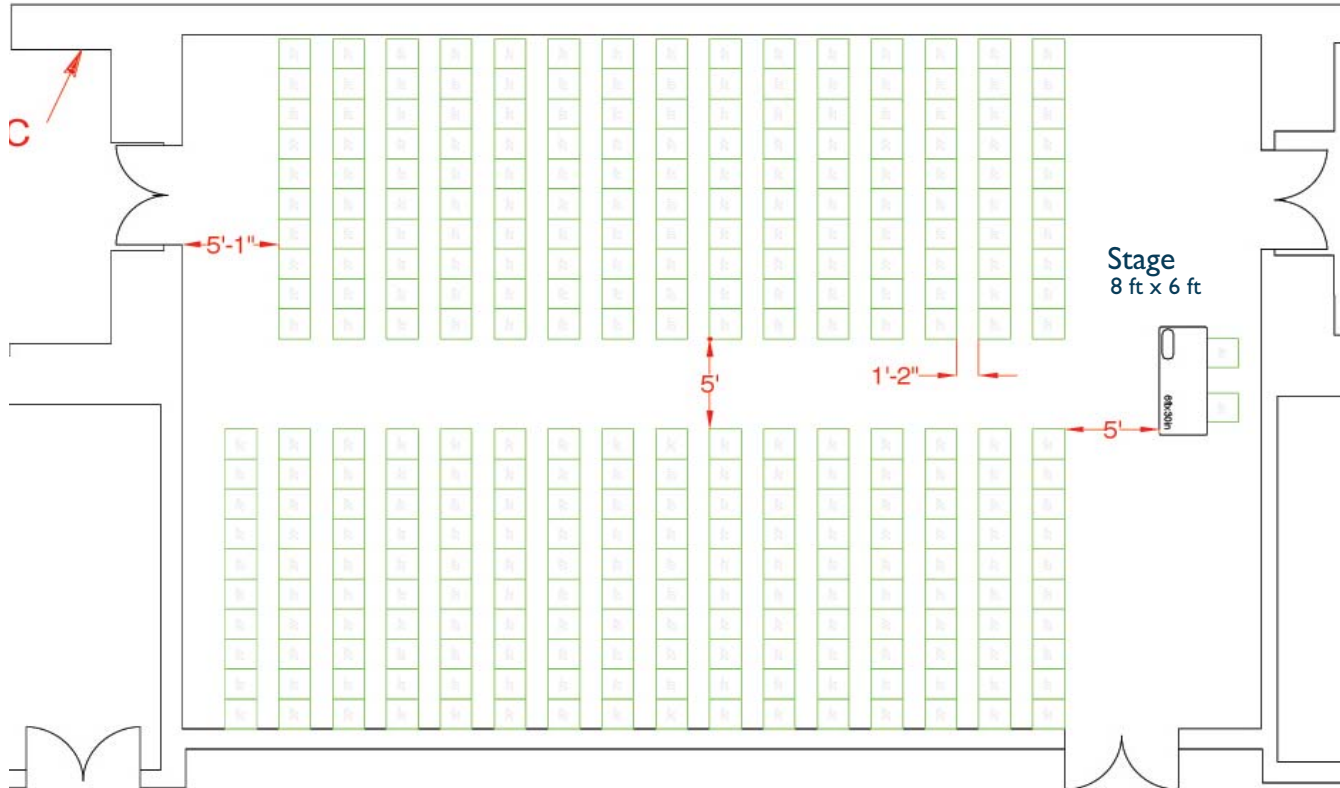

Location within the  
Hynes Convention Center

*Signature*  
**BOSTON™**

# Hynes Convention Center ROOM 207

**Classroom Seating: 170**

**Length: 56'9"**

**Width: 38'6"**

**Area (sq ft): 2,184**

**Ceiling Height: 18'**

**Tables: 30 6' x 18" and 20 8' x 18" tables**

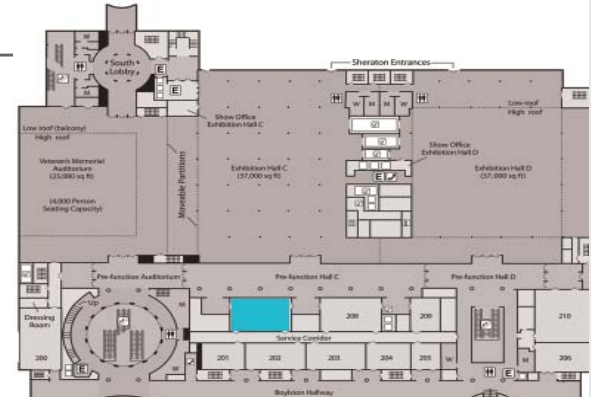

Location within the  
Hynes Convention Center

*Signature*  
**BOSTON™**

# Hynes Convention Center ROOM 207

**Banquet Seating: 150**

**Length: 56'9"**

**Width: 38'6"**

**Area (sq ft): 2,184**

**Ceiling Height: 18'**

**Tables: 15 rounds of 10**

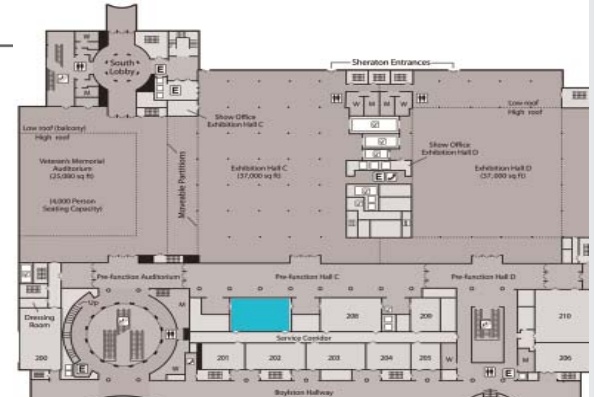
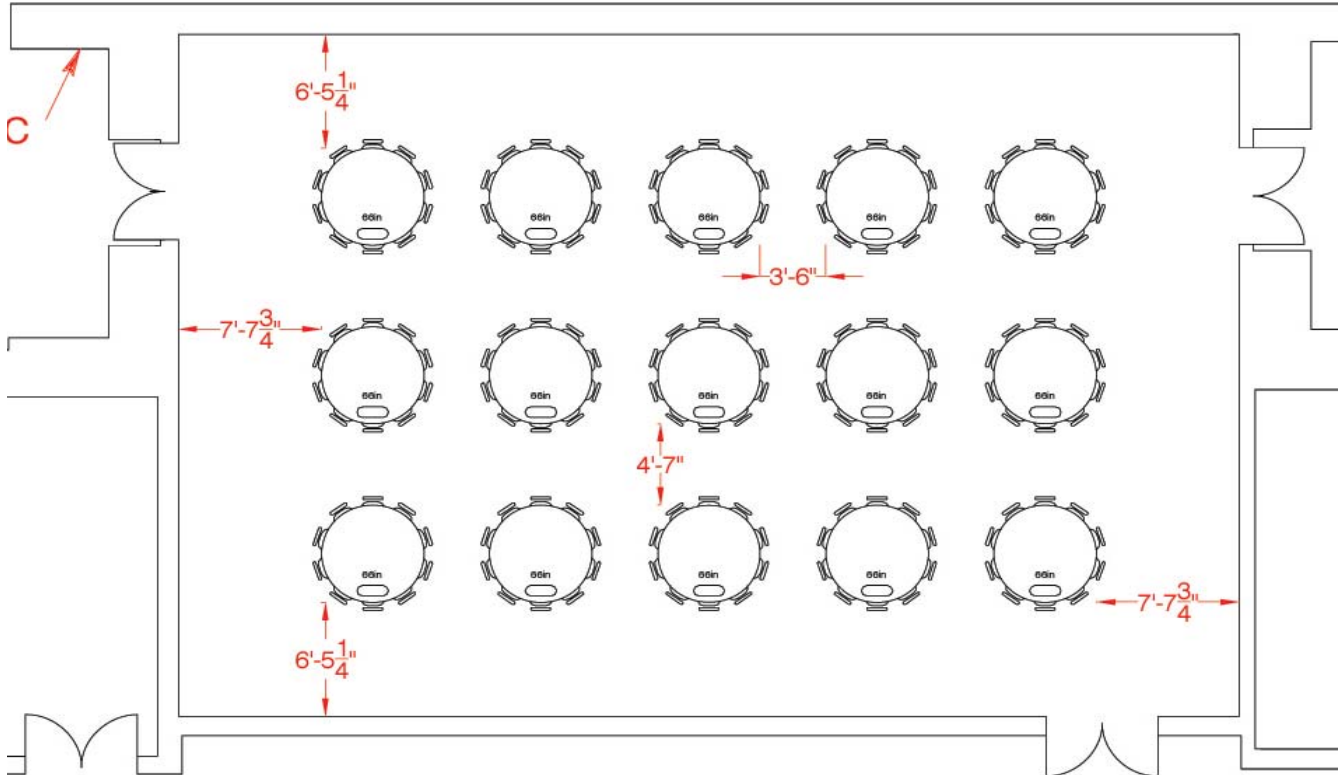

Location within the  
Hynes Convention Center

*Signature*  
**BOSTON™**