

# THE WESTIN COPLEY PLACE, BOSTON

10 Huntington Avenue  
Boston, Massachusetts 02116  
p: (617) 262-9600 | f: (617) 424-7483  
[www.westincopleyplaceboston.com](http://www.westincopleyplaceboston.com)



*The Westin Copley Place, Boston - a distinguished four-diamond hotel, effortlessly blends the dynamic energy of a world-class convention destination with the sophistication of a contemporary urban retreat in the heart of Boston's iconic Back Bay. Each of its 803 expansive guestrooms is designed for comfort and style, featuring the signature Westin Heavenly® Bed and showcasing sweeping views of the city skyline or the Charles River. With an impressive 54,000 square feet of flexible, state-of-the-art meeting space, the hotel provides an exceptional setting for events of every scale—from intimate gatherings to large conventions.*

## HOTEL QUICK FACTS

- Number of Rooms** 803
- Number of Suites** 143
- Number of Db/Dbles** 308
- Number of ADA Rooms** 34
- Distance to MCEC** 2.1 miles
- Distance to Hynes** Connected - 3 blocks
- Distance to Logan Airport** 4.5 miles
- Closest MBTA Station** Copley – Green Line or Back Bay – Orange Line
- AAA Rating** 4 Diamond
- Labor Status** Union

## GUESTROOM AMENITIES

- Westin Heavenly® Bed
- Hairdryer
- River/City view room
- The Heavenly Crib
- Mini-refrigerator
- Voicemail
- In-room safe
- The Westin Heavenly Dog Bed available
- Rollaway beds
- Cable channels
- Bathrobes
- Deluxe bath amenities
- Iron and ironing board
- High speed internet access
- In-room movies
- Coffee maker - Starbucks coffee

## RESTAURANTS & BARS

- Bar 10
- Fogo de Chao
- Ingredients
- In-Room Dining

## GUEST SERVICES

- Westin Club Lounge
- Running concierge
- Laundry/valet service
- Car rental service
- Valet Parking
- Aescape Robotic Massage
- In-room massage
- Airport Transportation (fee)



The Westin Copley Place, Boston

# Meeting Rooms & Specifications

ROOM NAME	ROOM DIMENSIONS	SQUARE FEET	CEILING HEIGHT	THEATER	CLASSROOM 3 PER 6	CONFERENCE	U-SHAPE	HOLLOW SQUARE	RECEPTION	ROUNDS (OF 10)
<b>SEVENTH FLOOR</b>										
Adams/ Parliament/Baltic	79' x 24'	2,640	8'	120	60	50	45	50	180	150
Adams	43' x 24'	960	8'	60	38	35	35	35	64	50
Baltic	33' x 34'	827	8'	30	18	14	14	14	55	40
Courier	24' x 28'	622	8'	40	24	20	20	20	45	40
Defender	30' x 45'	888	8'	45	30	28	18	18	60	50
Empire	23' x 45'	974	8'	60	40	35	35	35	64	60
Great Republic	24' x 43'	974	8'	60	40	35	35	35	64	60
Helicon	24' x 28'	646	8'	40	24	20	20	20	45	40
Mastiff	24' x 28'	646	8'	-	-	14	-	-	-	-
North Star	29' x 40'	853	8'	50	30	28	24	26	50	50
Parliament	30' x 40'	853	8'	50	30	28	24	26	50	40
<b>FOURTH FLOOR</b>										
America Ballroom	152'2" x 101'10"	15,337	18' 4"	1,800	900	-	-	-	2,000	1,200
America North	46'6" x 101'10"	4,685	18' 4"	450	250	96	70	80	500	320
America Center	46'2" x 101'10"	4,701	18' 4"	450	250	96	70	80	500	320
America South	58'6" x 101'10"	5,890	18' 4"	500	300	96	78	90	600	450
America Ballroom Foyer	116' x 81'13"	6,530	11'	-	-	-	-	-	600	-
Independence A	-	700	10'	50	30	26	20	28	50	40
Independence B	-	608	10'	50	30	24	20	28	50	40
Independence AB	-	1,308	10'	100	60	32	40	42	100	80
<b>THIRD FLOOR</b>										
Essex Ballroom	110'9" x 73'8"	8,200	15'	850	428	-	-	-	1,030	590
Essex Center	73'8" x 29'	2,142	15'	200	100	66	60	78	270	150
Essex South	73'8" x 52'10"	3,912	15'	380	200	66	60	78	490	300
Essex North	73'8" x 29'	2,142	15'	200	100	66	60	78	270	150
Essex North - Sections	-	714	15'	50	40	26	18	24	80	50
Essex Ballroom Foyer	106'3" x 107'10"	5,746	11' 2"	-	-	-	-	-	600	-
Staffordshire Ballroom	73'7" x 63'11"	4,055	13' 2"	270	165	66	62	78	400	260
St. George	86'6" x 31'5"	2,707	11'	200	140	-	70	74	300	220
St. George A	22'5" x 31'5"	725	11'	50	40	26	28	32	80	50
St. George B	22'5" x 31'5"	716	11'	50	40	26	28	32	80	50
St. George C	20'10" x 31'5"	612	11'	50	35	24	26	30	75	50
St. George D	20'10" x 31'5"	651	11'	50	40	26	28	32	80	50
<b>SECOND FLOOR</b>										
Gloucester	20' x 29'	506	12'	50	23	16	14	16	48	48
Newbury	28' x 35'	768	12'	48	36	20	24	24	48	48
Gloucester/ Newbury	35' x 57'	1,274	12'	90	50	40	40	40	112	100
Huntington AB	23' x 58'	1,374	12'	-	-	-	-	-	100	-
The Huntington Ballroom	23' x 115'	2,574	12'	-	-	-	-	-	250	-

The Westin Copley Place, Boston

# Meeting Rooms & Specifications

SECOND FLOOR

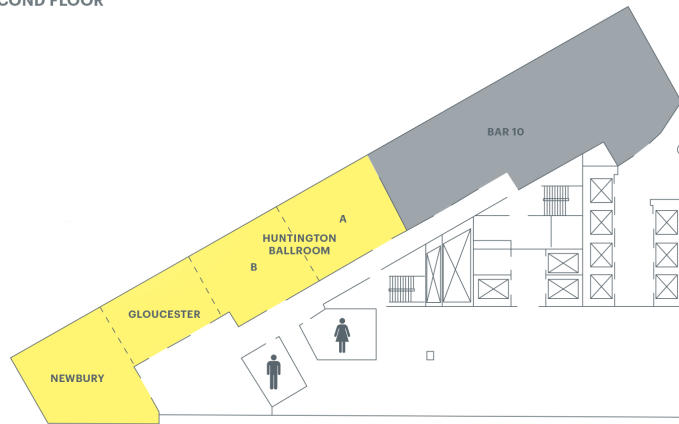

THIRD FLOOR

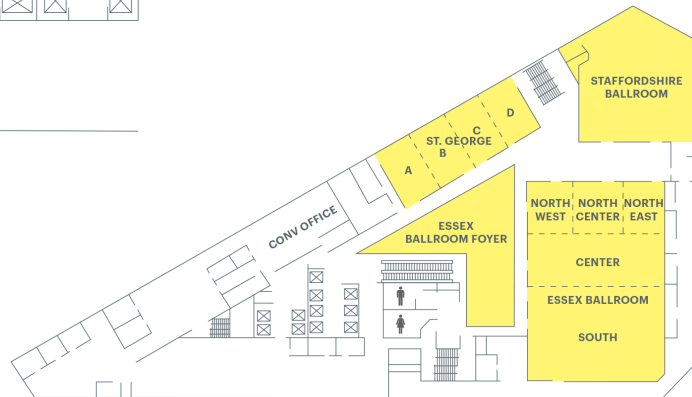

FOURTH FLOOR

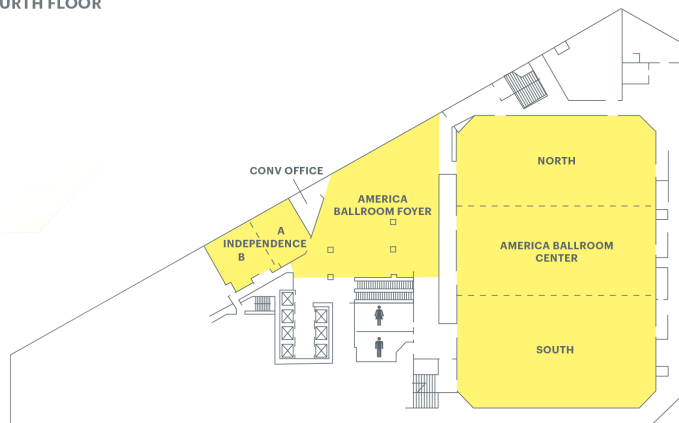

SEVENTH FLOOR

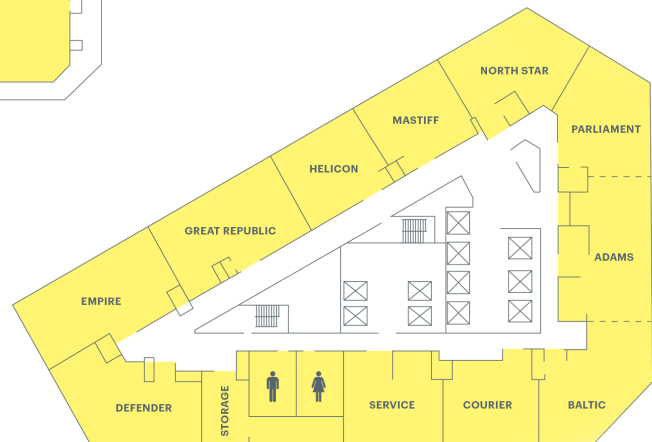

Updated: April 2026