

MDC	WIRING	MIN
PIN #		PIN #
1	-----	3
2	N/A	N/A
3	-----	1
4	-----	2

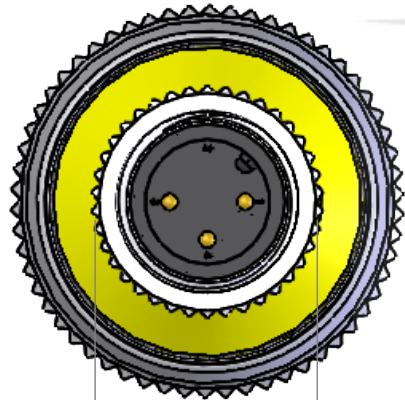

[15]
.6

M12x1
MALE THREAD

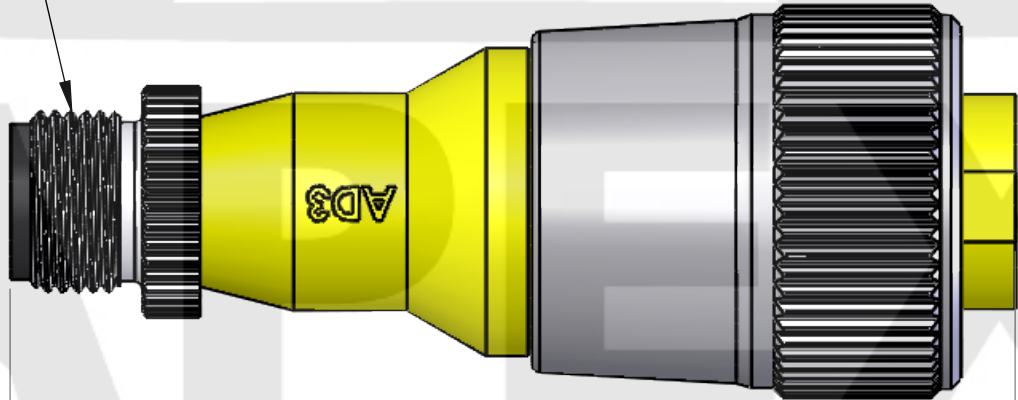

[66]
2.6

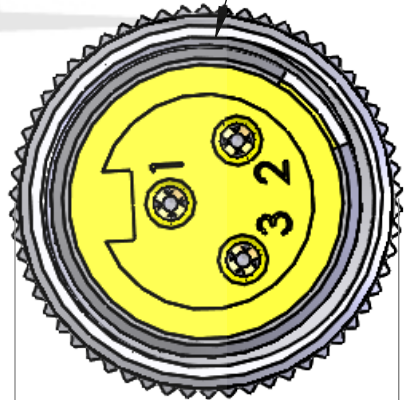

7/8-16 UN2B
FEMALE THREAD

[25]
1.0

MATERIALS:	
BODY:	YELLOW PVC
MIN COUPLING:	NICKEL PLATED BRASS
MDC COUPLING:	NICKEL PLATED BRASS
CONTACTS:	GOLD PLATED COPPER ALLOY
MDC INSULATOR:	POLYAMIDE

PROPRIETARY AND CONFIDENTIAL
THE INFORMATION CONTAINED IN THIS
DRAWING IS THE SOLE PROPERTY OF
MENCOM CORPORATION. ANY
REPRODUCTION IN PART OR AS A WHOLE
WITHOUT THE WRITTEN PERMISSION OF
MENCOM CORPORATION IS
PROHIBITED.

VOLTS	300V
AMPS	4A
TEMP:	105C

UNLESS OTHERWISE SPECIFIED:
DIMENSIONS ARE IN INCHES AND [MM]
MATERIAL
FINISH
DO NOT SCALE DRAWING

DRAWN BY	ADM
DRAWN DATE	05/10/2019
CHECKED BY	JJH
CHECK DATE	05/10/2019
COMMENTS:	

MENCOM CORPORATION		
TITLE:		
SIZE	DWG. NO.	REV
B	MDCIN-3MFP-AD3	B
SCALE: 1:1	WEIGHT:	SHEET 1 OF 1