

## C7 - C7A and M7 - M7A IP67 enclosures V-TYPE lever version

inserts		page:
CDD	42 poles + ⊕	78
CDS	18 poles + ⊕	-
CDSH	18 poles + ⊕	87
CNE	10 poles + ⊕	111
CSE	10 poles + ⊕	-
CSH	10 poles + ⊕	111
CSH S	10 poles + ⊕	123
CCE	10 poles + ⊕	131
CMSH	3+2 (aux) poles + ⊕	136
CMCE	3+2 (aux) poles + ⊕	137
CSS	10 poles + ⊕	149
CT, CTSE (16A) *)	10 poles + ⊕	161
CQE	18 poles + ⊕	169
CX	8/24 poles + ⊕	194
MIXO	3 modules	262 - 317

\*) can be used only in bulkhead mounting housings

bulkhead mounting housings  
with 2 levers in stainless steelsurface mounting housings  
with 2 levers in stainless steel

description	part No.	part No.	entry Pg	part No.	entry M
with levers and gasket, size "57.27"	<b>C7I 10</b>				
with levers, size "57.27"		<b>C7P 10</b>	16	<b>M7P 10.20</b>	20
with levers, size "57.27"		<b>C7P 10.2</b>	16 x 2	<b>M7P 10.220</b>	20 x 2
with levers, high construction, size "57.27"		<b>C7AP 10.21</b>	21	<b>M7AP 10.32</b>	32
with levers, high construction, size "57.27"		<b>C7AP 10.221</b>	21 x 2	<b>M7AP 10.232</b>	32 x 2
with levers, high construction, size "57.27"		<b>C7AP 10.29</b>	29	<b>M7AP 10.40</b>	40
with levers, high construction, size "57.27"		<b>C7AP 10.229</b>	29 x 2	<b>M7AP 10.240</b>	40 x 2

## panel cut-out for bulkhead mounting housings

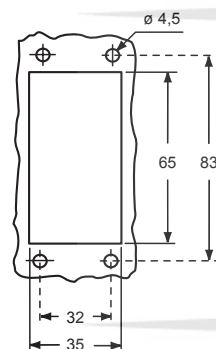

The lever, due to the vertical closing movement, offers an IP66/IP67/IP69 degree of protection (according to EN 60529) when fitted with a complete and coupled connector and used with ILME standard hoods in die cast aluminum with pegs (without adapter).

Hoods  
(page 395)Hoods  
(pages 468-469)

**CAUS** Type 4/4X/12



insulating cable gland or fittings  
without gasket



cable gland  
with O-Ring gasket

## C7I

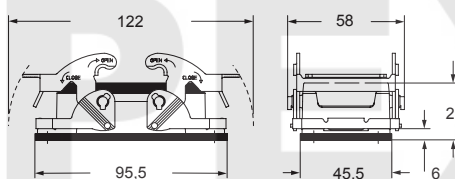

For bulkhead mounting housings, IP66/IP67/IP69 degree of protection is guaranteed for mounting on a sufficiently rigid panel; use suitable length M4 screws (negligible surface buckling when subjected to tightening couple on the fixing screws of 0,8 - 1,2 Nm or deformation caused by the weight of the complete connector). In case of insufficient rigidity use of C7.. FL counterflanges (page 443) is recommended, in which case use suitable length M4 screws and M4 (on the enclosure) and M4 (on the counterflange) flat/spring washers with M4 locknut. In addition, the panel surface in contact with the counterflange gasket of the bulkhead mounting housings must be free from defects (deep scratches, grooves, burrs) that could negatively affect the performance of the gasket.

## C7P - C7AP and M7P - M7AP

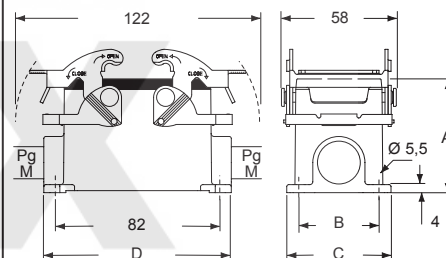

type	A	B	C	D
<b>C7P/M7P 10</b>	57	40	52	93,5
<b>C7AP/M7AP 10</b>	74	45	57	94