



CI and MI C-TYPE standard version

inserts		page:
CD	64 poles + ⊕	72
CDD	108 poles + ⊕	81
CDS	42 poles + ⊕	-
CDSH	42 poles + ⊕	89
CNE	24 poles + ⊕	113
CSE	24 poles + ⊕	-
CSH	24 poles + ⊕	113
CSH S	24 poles + ⊕	125
CCE	24 poles + ⊕	133
CMSH	10+2 (aux) poles + ⊕	140
CMCE	10+2 (aux) poles + ⊕	141
CSS	24 poles + ⊕	151
CQE	46 poles + ⊕	171
CQEE	64 poles + ⊕	177
CX	4/8 and 6/6 poles + ⊕	204 and 206
MIXO	6 modules	262 - 317

inclined hoods for 2 levers
with side entry



inclined hoods for 2 levers
with top entry



description	part No.	entry Pg	part No.	entry M	part No.	entry Pg	part No.	entry M
used with enclosures size "104.27" with pegs for two levers, side entry with pegs for two levers, side entry	CIO 24.36	36	MIO 24.40 MIO 24.50	40 50				
used with enclosures size "104.27" with pegs for two levers, top entry with pegs for two levers, top entry					CIV 24.36	36	MIV 24.40 MIV 24.50	40 50

IP degrees are according to the type of lever of the counterpart enclosures.
Alternatively, hoods with pegs may be coupled with fixed enclosures:

- C-TYPE, IP65 or IP66/IP69 stainless steel lever, from page 412 to page 422
- C7, IP66/IP67/IP69 stainless steel lever, page 441
- CV, IP65 or IP66/IP69 stainless steel lever, page 460 and 461

CIO and MIO

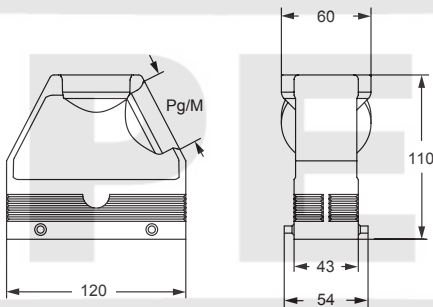

CIV and MIV

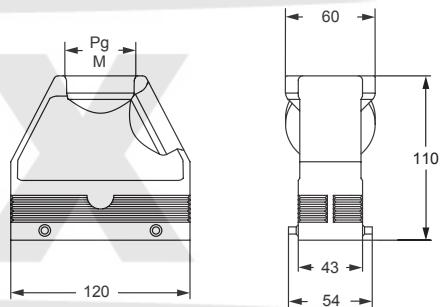

CALUS® Type 4/4X/12



insulating cable gland or fittings
without gasket



cable gland with O-Ring gasket
according to the type of lever