

CKA - MKA and CKAX - MKAX standard metallic version

inserts		page:
CK	3 poles + ⊕	58
CK	4 poles + ⊕	58
CKS	3 poles + ⊕	-
CKS	4 poles + ⊕	-
CKSH	3 poles + ⊕	63
CKSH	4 poles + ⊕	63
CD	8 poles	67
CQ4	2 poles + ⊕	182
CQ4 H	2 poles + ⊕	183
CQ4	3 poles + ⊕	184
CQ	5 poles + ⊕	186
CQ	7 poles + ⊕	187
CQ	12 poles + ⊕	189
CQ	21 poles + ⊕	190

hoods



covers

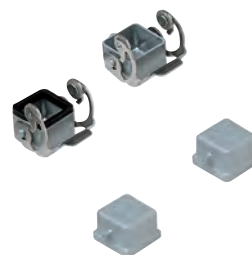

description	part No. (entry Pg 11)	part No. (entry M20)	part No. (with eyelet)	part No. (with loop)
with pegs, top entry	CKA 03 VS	MKA V20		
angled hoods, with pegs, side entry	CKA 03 VAS	MKA VA20		
with galvanized steel lever, top entry	CKA 03 VGS	MKA VG20		
with stainless steel lever, top entry	CKAX 03 VGS	MKAX VG20		
with pegs and gasket, for female inserts ¹⁾			CKA 03 C	CKA 03 CS
with pegs, for male inserts ¹⁾			CKA 03 CA	CKA 03 CAS
with stainless steel lever and gasket, for female inserts				CKAX 03 CX
with stainless steel lever, for male inserts				CKAX 03 CXA
gasket and screw kit for IP66/IP67/IP69 ²⁾	CKR 65		CKR 65	
gasket and screw kit for IP66/IP67/IP69 ²⁾ specific for CD 08 inserts	CKR 65 D		CKR 65 D	

¹⁾ Preferably be used with enclosures CKAX (stainless steel lever).

²⁾ To obtain the IP66/IP67/IP69 degree of protection, a kit with insert fixing screw and gasket can be purchased separately. Several inserts size "21.21" are already supplied with fixing screw and gasket, which ensures IP66/IP67/IP69 degree of protection. See list below, not including any special version:

- CQF/M 07, CQF/M 12
- CJ KF/M
- CJK 8FT /8IFT /8MT /8IMT, CJK 8M
- CUK 2FT /3FT
- CX 1/2 BDF/M
- CLK 04 SCF /SCF-H /SCM
- CXL 2/4 PF /PM /PFH /PMH /SF /SM, CXL SF/M

NOTE: Housing type and colour may vary upon specific part No.



CKA VS and MKA V

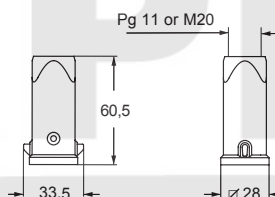

CKA VAS and MKA VA

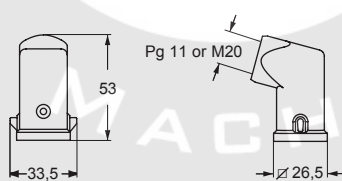

CKA VGS and MKA VG

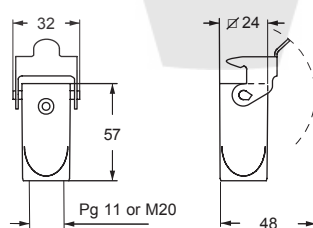

CKAX VGS and MKAX VG

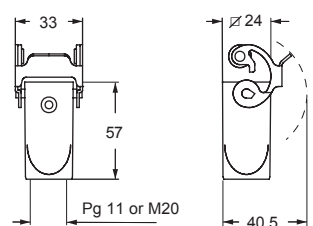

CKA C - CKA CS

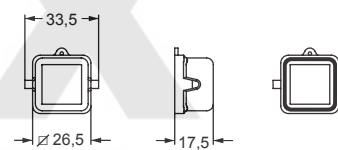

CKA CA - CKA CAS

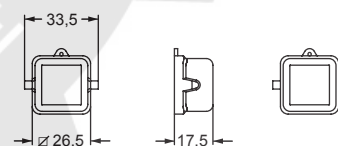

CKAX CX

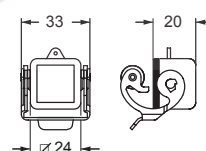

CKAX CXA

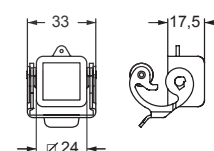
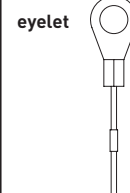
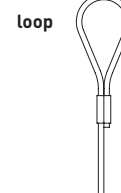
For fixing
on housingsFor fixing
on hoods

CE US

Type 12
Type 4/4X only
with CKR 65 (D)



IP66/IP67/IP69 with CKR 65 (D) ¹⁾