

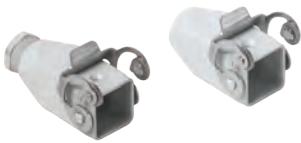

CKX standard insulating version

inserts		page:
CK	3 poles + ⊕	58
CK	4 poles + ⊕	58
CKS	3 poles + ⊕	-
CKS	4 poles + ⊕	-
CKSH	3 poles + ⊕	63
CKSH	4 poles + ⊕	63
CD	7 poles + ⊕	66
CD	8 poles	67
CQ4	2 poles + ⊕	182
CQ4 H	2 poles + ⊕	183
CQ4	3 poles + ⊕	184
CQ	5 poles + ⊕	186
CQ	7 poles + ⊕	187
CQ	12 poles + ⊕	189
CQ	21 poles + ⊕	190

hoods



description	part No. (entry Pg 11)
-------------	---------------------------

with stainless steel lever, top entry
without cable gland and stainless steel lever, top entry

CKX 03 VG
CKX 03 VGS

gasket and screw kit
for IP66/IP67/IP69 1)

CKR 65

gasket and screw kit for IP66/IP67/IP69 1)
specific for CD 07/08 inserts

CKR 65 D

1) To obtain the IP66/IP67/IP69 degree of protection,
a kit with insert fixing screw and gasket can be
purchased separately.
Several inserts size “21.21” are already supplied with
fixing screw and gasket, which ensures IP66/IP67/IP69
degree of protection. See list below, not including any
special version:
- CQF/M 07, CQF/M 12
- CJ KF/M
- CJK 8FT /8IFT /8MT /8IMT, CJK 8M
- CUK 2FT /3FT
- CX 1/2 BDF/M
- CLK 04 SCF /SCF-H /SCM
- CXL 2/4 PF /PM /PFH /PMH /SF /SM, CXL SF/M

CKX VG - CKX VGS

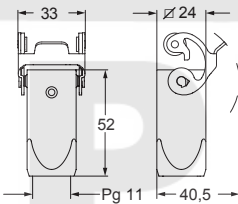

NOTE: Housing type
and colour may vary upon
specific part No.

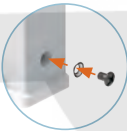

IP66/IP67/IP69 with CKR 65 (D) 1)