

2019 BOND BREAKDOWN

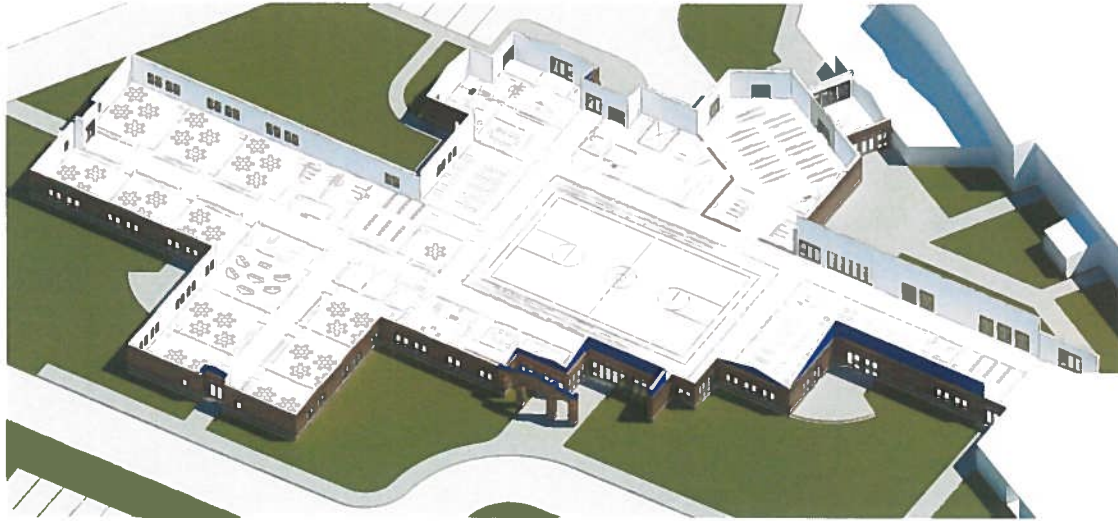

Included in 2019 Bond:

» New High School/Middle School

- Secure Entrance
- Administration Offices
- Classrooms
- Computer Labs
- Science Lab
- Connects to Existing Elementary School and Gymnasium

» For ALL AGES

- New Gymnasium
- New Library
- New Cafeteria/FEMA Rated Community Storm Shelter

» Additional Site Improvements

- New Stage Curtain and Air Conditioning for Auditorium
- Drainage Improvements at Auditorium

IMPACT ON PROPERTY TAX

2018-2019	2019-2020		Increase	
	Amount	Annual	Monthly	Daily
\$100.00	\$157.69	\$57.69	\$4.81	\$0.16
\$500.00	\$788.46	\$288.46	\$24.04	\$0.80
\$1,000.00	\$1,576.91	\$576.91	\$48.08	\$1.60

PROPERTY TAX MILLAGE RATE COMPARISON

DISTRICTS	TOTAL	IF BOND ISSUE PASSES
Shidler Schools	58.97	92.95
Pawhuska Schools	89.78	
Barnsdall Schools	84.70	
Hominy Schools	94.25	
McCord Schools	84.88	
Woodland Schools	74.92	
Blackwell Schools	95.13	
Newkirk Schools	95.87	
Ponca City Schools	98.01	
Tonkawa Schools	94.65	
Caney Valley Schools	98.53	

**More than 60% of cost is paid
by the Wind Industry**