



GOULOFF - JORDAN SURVEYING AND DESIGN, INC.

1133 BROADWAY FORT WAYNE, IN 46802
PH (260) 424-5362 FAX (260) 424-4916

BOUNDARY RETRACEMENT SURVEY

Lot 7 - Deerfield Estates, Section "A"
1326 Stag Drive, Fort Wayne, IN 46804

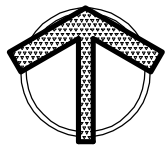

SCALE: 1" = 40'



ILLINOIS ROAD

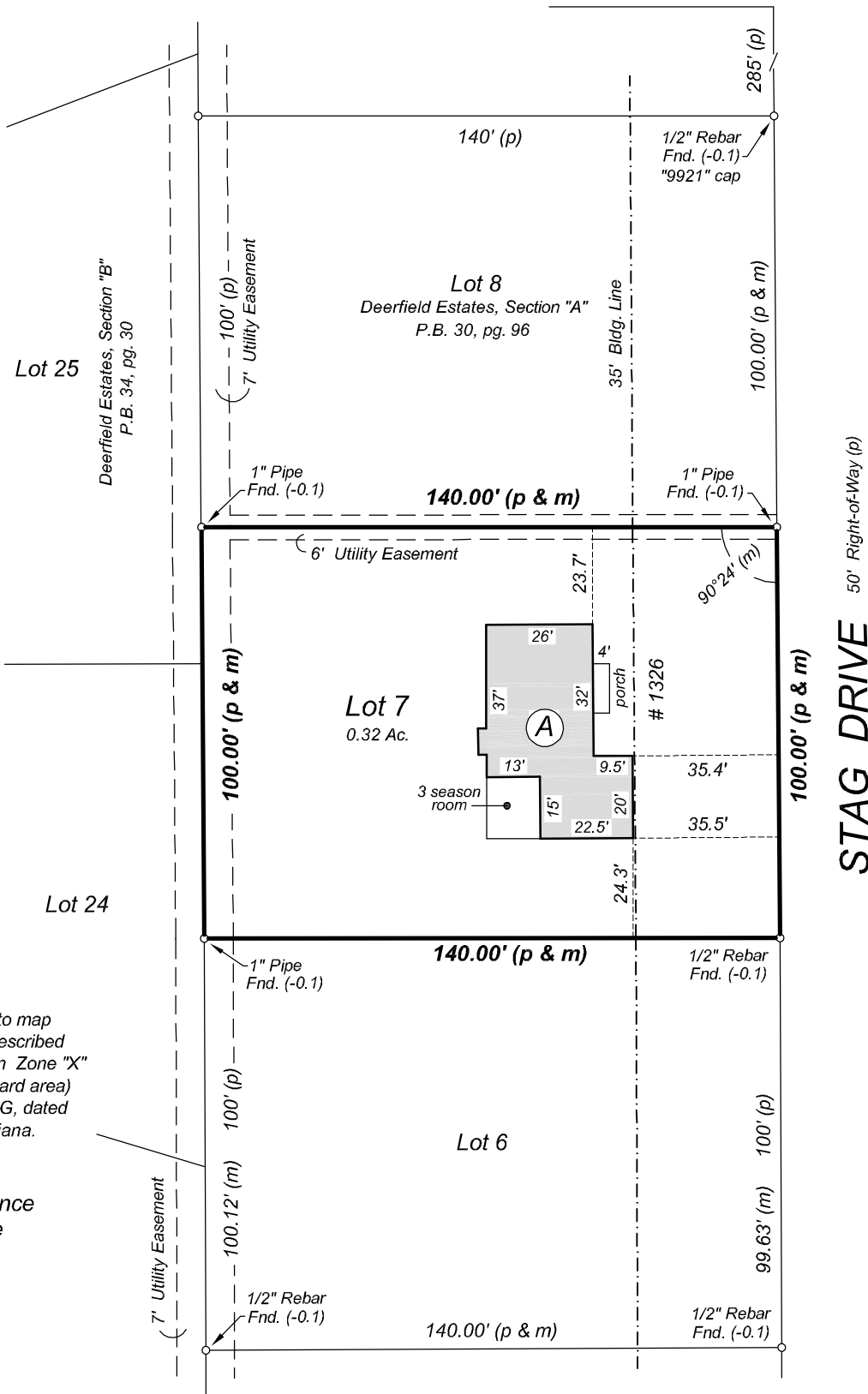

LEGEND

- (m) MEASURED
- (r) RECORDED
- (c) CALCULATED
- (p) PLATTED INFORMATION

Flood Note:

By graphic plotting only and subject to map scale uncertainties, the real estate described and depicted hereon appears to lie in Zone "X" (NOT considered a special flood hazard area) on FIRM Map Number 18003C0260G, dated August 3, 2009 for Allen County, Indiana.

(A) 2 Story Framed Residence with Attached Garage

For the exclusive use of:

Kleek

Date: May 29, 2019

Job No.: 20190114