

# EXPLODED VIEW - DC PUMP SYSTEM SERVICE PARTS

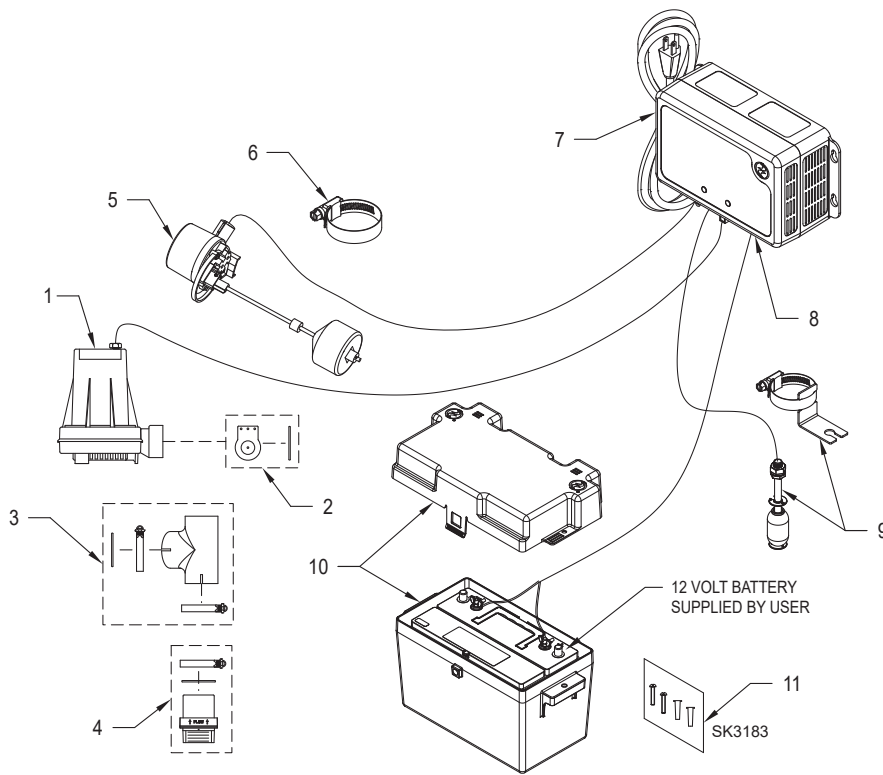

| Model 508 Fit Service Parts |  |     |                               |
|-----------------------------|--|-----|-------------------------------|
| Item                        | Description                                  | Qty | 508-C<br>8/18<br>thru Current |
| 1                           | Pump 12 V DC / Backup (service part)         | 1   | 155652                        |
| 2                           | Flapper asm, (service part)                  | 1   | 152970                        |
| 3                           | Fitting, 1.5" X 2" Bull-head tee PVC/SCH 40  | 1   | 153766                        |
| 4                           | Valve, check / 1.5" (DN40) Inline / vertical | 1   | 153772                        |
| 5                           | Operational float, N.O.                      | 1   | 155654                        |
| 6                           | Clamp, #28 Worm-SS (for float switch)        | 2   | 004287                        |
| 7                           | Fit controller                               | 1   | 155368                        |
| 8                           | Fuse, 30 amp automotive, blade-type          | 1   | 016918                        |
| 9                           | High water float, N.C.                       | 1   | 155653                        |
| 10                          | Battery box asm (box and cover)              | 1   | 10-0764                       |
| 11                          | Hardware pak, charger /switch mode           | 2   | 152864                        |
| 12                          | Pump, M53/115V                               | 1   | 53-0001                       |
|                             | Pump, M63/115V                               | 1   | 63-0001                       |
|                             | Pump, M98/115V                               | 1   | 98-0001                       |

## AQUANOT® FIT FLOAT SWITCH

FIGURE 3

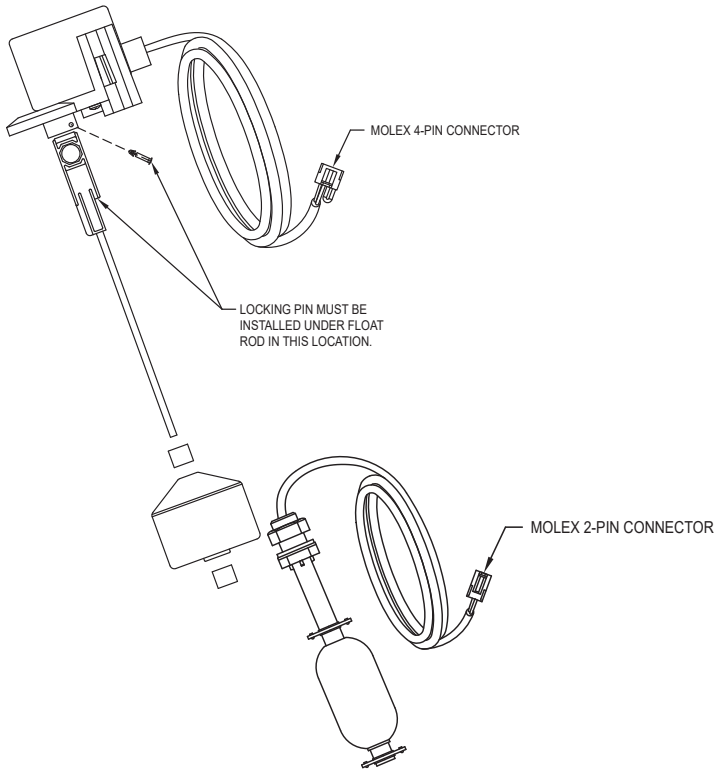

Note: Upper rubber stop is usually not needed.

SK3186

FIGURE 4

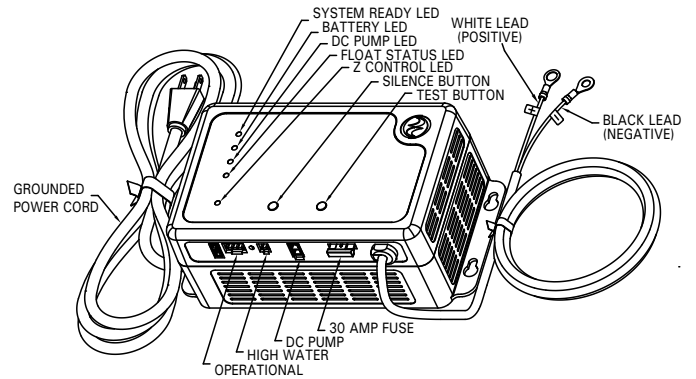

SK3187