

CGa - Series 1
Control Parts Continued

Standing Pilot Conversion Kits			
These Kits Will Retrofit CG/CGM - Series 4 Thru 12			
N/S	510-811-363	Conversion Kit: Natural To Propane CGa 7-8 (Standing Pilot Only)	
	510-811-356	Conversion Kit: Propane To Natural CGa 25-6 (Standing Pilot Only)	
	510-811-357	Conversion Kit: Propane To Natural CGa 7-8 (Standing Pilot Only)	
	510-811-362	Conversion Kit: Natural To Propane CGa 25-6 (Standing Pilot Only)	
Spark Ignition Components For Natural Gas			
Spark Ignition Cannot Be Used With Propane Gas For Series 1			
6	511-044-381	Gas Valve, 1/2" x 1/2"	25-6
	511-044-382	Gas Valve, 3/4" x 3/4"	7, 8
7	511-330-218	Pilot Assembly Kit With Orifice, Aluminum Pilot Gas Tubing, And Spark Wire and Sense Wire	All
8	511-330-079	Ignition Control Module	All
9	511-842-370	24 Volt Step Down Transformer, 40 VA	All
N/S	591-391-900	Wire Harness, Power Supply	All
	591-391-905	Wire Harness, Spark Ignition, Controls	All

CGa - Series 2 Control Parts

Spark-ignited pilot controls

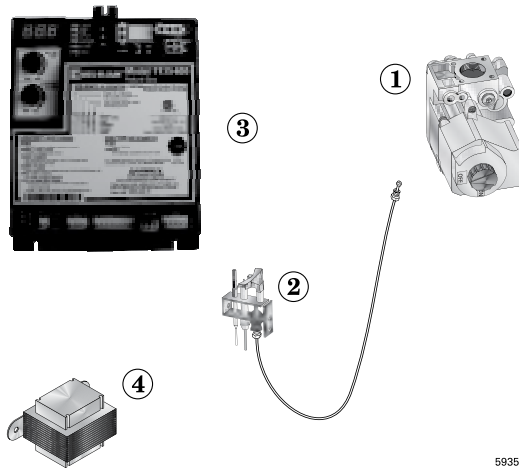

59354

CGa - Series 2			
Fig. No.	Part No.	Description	Boiler Size
Spark Ignition Components For Natural Gas			
1	511-044-381	Gas Valve, 1/2" x 1/2",	25-6
	511-044-382	Gas Valve, 3/4" x 3/4", 1.2" Step Open	7, 8
2	511-330-218	Pilot Assembly Kit - (Includes, Orifice, and Pilot Tubing)	All
N/S	381-330-035	LWCO Function Disable Kit - (Includes Temperature Sensor, Sensor Harness, Label, And Instructions) - CP Range - CP7528674 - CP7540455	
3	381-330-026	Integrated Boiler Control - (Includes, Sensor Harness) - Use On Boilers With A CP Range Less Than CP7529278	All
	381-330-024	Integrated Boiler Control - Use only If 381-330-035 Kit Was Already Installed, And CP Range Is Greater Than CP7529279	All
Spark Ignition Components For Propane Gas			
1	511-044-356	Gas Valve 3/4" X 3/4" - 2.5" Step Open	25-7
	511-044-366	Gas Valve 3/4" X 3/4" - Slow Open	8
2	511-330-273	Pilot Assembly Kit - (Includes Orifice, and Pilot Tubing)	All
N/S	381-330-035	LWCO Function Disable Kit - (Includes Temperature Sensor, Sensor Harness, Label, And Instructions) - CP Range - CP7528674 - CP7540455	
3	381-330-027	Integrated Boiler Control - (Includes, Sensor Harness) - Use On Boilers With A CP Range Less Than CP7540389	All
	381-330-021	Integrated Boiler Control - Use only If 381-330-035 Kit Was Already Installed, And CP Range Is Greater Than CP7540390	All

GAS

EG - Series 5 Control Parts

Fig. No.	Part No.	Description	EG Series 5 Boiler Size							
			30	35	40	45	50	55	65	75
Control Components For Water Boiler, Natural Gas - No Tankless										
N/S	381-330-036	LWCO Function Disable Kit - (Includes Temperature Sensor, Sensor Harness, Label, And Instructions) - CP Range - CP7499291 - CP7499308								
N/S	381-330-031	Integrated Boiler Control - (Includes, Sensor Harness) - Use On Boilers With A CP Range Less Than CP7499291	X	X	X	X	X	X	X	X
	381-330-024	Integrated Boiler Control - Use only If 381-330-035 Kit Was Already Installed, And CP Range Is Greater Than CP7499291								
N/S	381-356-577	Boiler Temperature Sensor, 1/2" N.P.T	X	X	X	X	X	X	X	X
	381-356-578	Control Transformer, 24 VAC, 40 VA. Foot Mounted	X	X	X	X	X	X	X	X
	591-391-975	Wire Harness, Power, J Box To Module	X	X	X	X	X	X	X	X
	381-356-528	Circulator Harness With Molex	X	X	X	X	X	X	X	X
	591-392-006	Thermostat Harness	X	X	X	X	X	X	X	X
	591-391-990	Controls To Module Harness	X	X	X	X	X	X	X	X
	591-392-036	Temperature Sensor Wire Harness	X	X	X	X	X	X	X	X
	381-356-586	Outdoor Temperature Sensor Kit - (Includes Sensor, Wire Harness, And Instructions)	X	X	X	X	X	X	X	X
Control Components For Steam Boiler - No Tankless										
N/S	511-330-097	Ignition Control Module Without Molex	X	X	X	X	X	X	X	X
	510-312-166	Combination Transformer-Relay Receptacle, 120/24 VAC, 40 VA	X	X	X	X	X	X	X	X
Common Components For Both Steam And Water										
N/S	511-044-381	Natural Gas Valve , 1/2" X 1/2"	X	X	X	X	X			
			X	X	X	X	X			
	511-044-382	Natural Gas Valve, 3/4" X 3/4"						X	X	X
								X	X	X
	511-330-218	Pilot Assembly Kit-(Orifice, Spark and Sense Wire,and Pilot Tubing.)	X	X	X	X	X	X	X	X
	560-742-860	Pilot Tubing With Fittings 1/8" X 22 3/4"	X	X	X	X	X	X	X	X
	510-512-337	Vent Damper Motor With Molex	X	X	X	X	X	X	X	X
			X	X	X	X	X	X	X	X
591-391-795	Damper Wiring Harness	X	X	X	X	X	X	X	X	

GAS